

香港大學校外課程手冊
一九六八至一九六九

University of Hong Kong



Extra Mural Studies



PROSPECTUS
1968 - 1969

THE UNIVERSITY OF HONG KONG
LIBRARIES

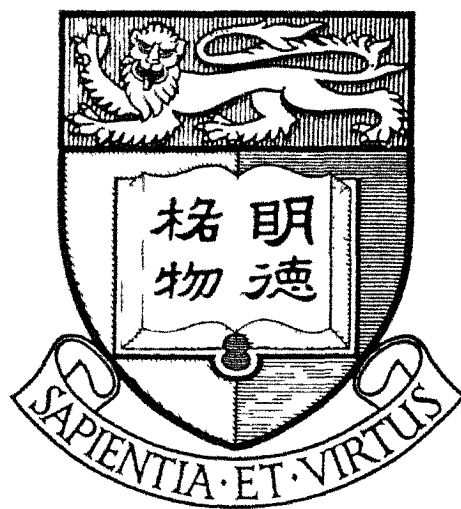

Hong Kong Collection

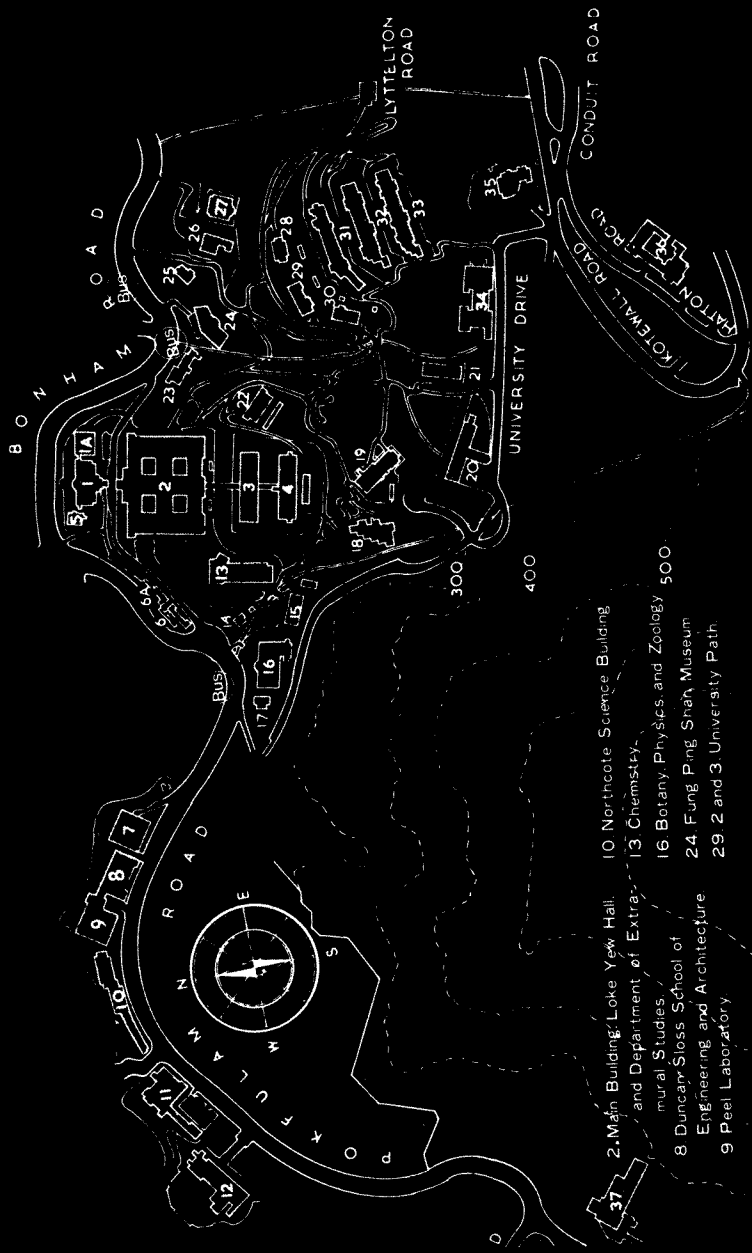

- 2. Main Building, Loke Yew Hall, and Department of Extramural Studies
- 8. Duncan Sloss School of Engineering and Architecture
- 9. Peel Laboratory
- 10. Northcote Science Building
- 13. Chemistry
- 16. Botany, Physics, and Zoology
- 24. Fung Ping Shan Museum
- 29. 2 and 3. University Path

UNIVERSITY OF HONG KONG GENERAL LAYOUT
 Please see inside of rear cover for enlarged plan of Main Building (2) and room locations

University of Hong Kong



Extra Mural Studies



STAFF *Director*

R.A. Williams, M.A. (Wales)

Senior Lecturer

G.H. Mahood, M.A. (London) (*on
secondment*)

Assistant to the Director

(Mrs.) Priscilla Tso, B.A., Dip. Ed. (H.K.)
Dip. Ad. Ed. (Manch.)

Staff Tutors

(Mrs.) Nana Tsao, B.A., Dip. Ed. (H.K.)
C.K. Leung B.A. (H.K.)
Jon A. Prescott, B.Arch., M.C.D. (Liv),
A.R.I.B.A., A.M.T.P.I.
J.W. England, B.A. (Nottingham)

Lecturers in Law

J. Rear. M.A. (Oxon); Barrister-at-law.
V. Shepherd, LL.M. (London)

Secretary

Mrs. Yvonne Wong

ACKNOWLEDGEMENTS

We would like to record our grateful acknowledgement to the following individuals, schools and organizations for permission to use their premises:-

The British Council

U.S.I.S.

The Management of City Hall

Wah Yan College Kowloon

Caritas

St. Mary's Canossian College

GENERAL INFORMATION

1. There are normally no entry requirements except that applicants should be over 18 years of age. Occasionally to have the full benefit of a course applicants must possess certain defined qualifications. Applicants are therefore, advised to read the description of a course carefully. Professional courses usually have clearly defined entry requirements.
2. The Director may at his discretion refuse to admit an applicant.
3. Unless otherwise arranged no Extra-Mural lectures will be held:-
 - a) on any public holidays.
 - b) at a storm warning signal of No. 5 or above.
 - c) during the following holiday periods:
23rd December to 2nd January 1969 (Christmas and New Year)
17th to 22nd February 1969 (Chinese New Year)
4. The course fee will cover the entire duration of a course or part of a course. Fees are not refundable once the course has commenced.
5. Certificates of Attendance are issued on payment of 50 cents, to those who have attended not less than two thirds of a course of at least 20 meetings duration.
6. Closing date for enrolment: *One week before the starting date of a course.* Late enrolments may not be accepted
7. For enquiries, please ring either 458161-Ext 310 or 226529 during office hours.

HOW TO ENROL

1. Complete the attached enrolment form and mail it to the Director, Department of Extra-Mural Studies, University of Hong Kong. Forms are also available on request. To ensure that a class can take place, the Department would appreciate early enrolment by applicants.
2. You should send your application form together with the appropriate fee either in the form of a postal order, money order or crossed cheque made out in favour of the UNIVERSITY OF HONG KONG.
3. *You will be notified if you are not admitted because of over-subscription or other reasons. The Department will NOT notify successful applicants who are expected to attend the first meeting of the class at the place and time advertised*
4. Applicants can also enrol in person at the following places:-
 - (i) Department of Extra-Mural Studies
University of Hong Kong, University
Main Building, Ground Floor Pokfulam
Road. (during office hours) (Buses No.
3, 4, 7, 23) Tel: 458161 Ext 310.
 - (ii) Extra-Mural Town Centre, Universal
House, 11th Floor, 151 Des Voeux Road
Central, entrance from Gilman Street
(next to Tamaya Dept. Store) Tel. 226529.

入學須知

1. 學員申請資格，除特別規定學歷之課程外，其他課程，祇需要年齡超過十八歲者，不限資格，均可申請入學。學員應詳閱課程簡介。
2. 學員被取錄與否概由校外課程部主任審核報名申請書後決定之。
3. 除特殊情形外，本部在下列期間不授課：
 - 甲、本港公眾假期。
 - 乙、本港天文臺懸掛五號或以上風球之後。
 - 丙、聖誕節及新年假期：一九六八年十二月廿三日至一九六九年一月二日
 - 丁、農曆新年假期：一九六九年二月十七日至廿二日。
4. 本手冊內之學費係指課程之全期學費。課程開始後，學費通常不能退回。
5. 授課時間通常每講一小時。
6. 凡課程在廿講以上而學員上課次數超過三分之二者，得向本部繳費五角後申請發給聽講證書。
7. 學員應於開課一星期前報名，過期報名可能不被接受。又任何課程額滿後，即隨時截止報名，故學員應儘早報名。
8. 本部詢問電話458161（內線310）
或226529

報名手續

1. 填妥附於本手冊之報名申請書後，逕寄香港大學校外課程部主任收。申請書可隨時向本部索取。
2. 繳費可用支票，銀行本票，或郵政滙票，抬頭「香港大學」隨同申請書逕寄港大校外課程部主任收。如用現金則請至本部繳納。
3. 如申請人已獲取錄，本部不再通知，可依時上課。如未獲取錄，則另函通知。
4. 申請人亦可親往下列地點報名：
 - 甲、薄扶林道香港大學校外課程部（辦公時間內）。
 - 乙、香港德輔道中一百五十一號環球大廈十二樓（入口在機利文街，玉屋百貨公司右側）校外課程部市區中心。



Contents

DAYTIME PROGRAMME	6
ARCHAEOLOGY	7
ARCHITECTURE & BUILDING SCIENCE	8
Building Science Practice & Management	
Certificate Course in Housing Management	
Appreciation	
ART & DESIGN	12
Certificate Courses in Art & Design	
Pre-Certificate & Foundation Courses	
Practice	
Vocational	
History & Appreciation	
Daytime Courses	
Other Art Classes	
CHINESE STUDIES	29
Literature	
History & Philosophy	
Art	
ECONOMICS & COMMERCE	33
Economics	
Accountancy	
Commerce	
Management	
Hospital Administration	
Chartered Institute of Secretaries	
EDUCATION	43
ENGLISH STUDIES	44
English for Teachers	
English as a Second Language	
English for Critical Appreciation	
English Studies for Commercial Use	
GEOGRAPHY & GEOLOGY	49
HISTORY & INTERNATIONAL AFFAIRS	51
LANGUAGES	53
Daytime Courses	
LAW, LL.B. LONDON	58
LIBRARIANSHIP	60
Library Association	
Certificate Course for Library Assistants	
MATHEMATICS	62
MUSIC PHILOSOPHY	63
PSYCHOLOGY	65
TECHNOLOGY & SCIENCES	68
Botany & Biology	
Certificate Course in Computer Science	
Certificate course in Television	
Certificate Course in Electronics	
Health Sciences	
SOCIOLOGY & ANTHROPOLOGY	72
URBAN & REGIONAL PLANNING	73
SPECIAL TRAINING COURSES	76
PUBLIC LECTURES	76
PROFESSIONAL & VOCATIONAL COURSES	77
INDEX	79

Page

the general
INDEX
is to be found at
the end of the
Prospectus
please turn over
for Day time
Courses

DAYTIME COURSES

ARCHITECTURE	11	22	Chinese Architectural Tradition
ART	26	51	Ceramics I
	26	52	Ceramics II
	26	53	Ikebana I — A Study of Basic Philosophy & Practical Application
	26	54	Ikebana III — A Study of Basic Philosophy & Practical Application
	27	57	Painting I
	27	56	Pattern Design
	25	49	Traditional Chinese Painting, Theory Techniques I
	25	50	Traditional Chinese Painting, Theory Techniques II
CHINESE STUDIES	32	71	Theory and Art of Chinese Calligraphy
EXUCATION	43	104	Living with Pre-School Children
ENGLISH	47	133	Growing Up with Books
GEOGRAPHY	50	121	China — Its Land and People
HISTORY	51	125	Modern China and the Two Revolution
	52	128	Angkor — Art & Civilization
LANGUAGE	57	147	Cantonese II
	56	146	Foundations in Cantonese
	56	149	French for Beginners
	56	148	German I
PHILOSOPHY	64	165	Athenian Days & Nights
SOCIOLOGY	72	179	Understanding Chinese Customs & Traditions

Page
Course

PRIOR ENROLMENT IS ESSENTIAL

Failure to enrol prior to the opening of a particular course, may mean the cancellation of that course. Prior enrolment is the only way the Department of Extra-Mural Studies has of judging the response to its courses. Your cooperation is therefore invited in sending your application forms to the Department as soon as possible.

Archaeology

Staff Tutor in charge: Jon A. Prescott, B.Arch M.C.D., (Liv.), A R I B A., A M.T.P.I.;
Telephone No. 458161 *Ext* 308 or 226613

AN INTRODUCTION TO ARCHAEOLOGY Dr. S.M. Bard, M.B., B.S. (H.K.), Hong Kong Archaeological Society *Wednesdays, 5 30 p.m. to 6 30 p.m. starting October 2, 1968* Extra Mural Town Centre. 12 meetings plus 2 museum visits and 2 site visits. Enrolment is limited to 30 persons. *Fee:* \$50

14

The museum visits will be arranged during the course at times to be announced, the other visits will take place on Sundays in November to sites in Lamma and Lantau Islands. The cost of the course does not include expenses in connection with field visits

Instruction will deal with the fossil record of early man and the general field of prehistory, archaeological techniques and questions of chronology in relation to tools and pottery. Special reference will be made to the prehistory of China and to sites in Hong Kong. An introductory study of method and techniques in archaeology will precede the site visits. The talks will be illustrated by exhibits which can be handled by the students and many slides.

CERAMICS IN THE CITY HALL MUSEUM James Watt, B.A. (Oxon.) Asst Curator Art Gallery & Museum. *Monday August 26 to Wednesday August 28, 1968 6 00 to 7.00 p.m. nightly* City Hall. *Fee:* \$10 for three lectures, \$5 for persons attending single lectures only.

15

The Display of Antiquities currently arranged in the City Hall gives a good opportunity to review the Earthenware and porcelain of China with particular emphasis on the earlier periods. Mr Watt will give three talks to provide a background for discussion of the pieces on display and will augment his talk with additional pieces from the storeroom of the Museum

- 1 Monday, 26th August, 1968 Earthenware of the Han Period
- 2 Tuesday, 27th August, 1968 Earthenware and Stoneware of the Tang & Sung Periods.
- 3 Wednesday, 28th August, 1968 The 14th Century to the Present — porcelains of the Yuan Ming and Ching

Reference should also be made to
128 ANGKOR: ART & CIVILISATION (Page 52)

Architecture and Building Science

Staff Tutor in charge Jon A Prescott, B Arch., M C D (Liv.), A R.I.B.A.; A.M.T.P.I.,
Telephone No 458161 Ext 308 or 226613

These courses are of two types. Group A is aimed at professional persons, building developers and others involved in the building operation. The courses are either in the nature of mid-career instruction of the refresher type, or provide an opportunity for professionals to discuss relevant and new issues.

Group B is related to the appreciation and understanding of Architecture as a Fine Art and is intended mainly for interested laymen, though professionals may well find them of value.

A Building Science, Practice and Management

"The Building and its Services" and "Structures and Techniques" continue the series of courses begun last year. Each is complete in itself.

16 THE BUILDING AND ITS SERVICES — FIRE CONTROL Commencing in January 1969. *Fee: \$45*

The ten lectures will discuss requirements of local and other codes of practice and will explain the technical basis of equipment available for control and prevention of fire.

17 STRUCTURES AND TECHNIQUES — SLIPFORM 14th to 15th November, 1968. The Extra-Mural Town Centre and visits.

A two day short course consisting of a series of lectures on the theory and practice of the slip-form technique, using Hong Kong examples as illustrative material. Lectures will be followed by a seminar discussion and visits. Full particulars will be published nearer to the proposed date.

THE NEW FORM OF BUILDING CONTRACT Mr. Peter Sanderson, F.R.I.C.S., F.I.S. (F.M.), F.I.Arb., Resident Partner of Messrs Langdon & Every. *Mondays, 5.30 p.m. to 7.00 p.m., starting September 30, 1968* The City Hall, Committee Room North, 8th Floor. Opening lecture plus 10 meetings, once weekly. *Fee: \$5 (for initial meeting), \$50 (all meetings)*

18

The work of the Joint Co-ordinating Committee for the drafting of a Standard Form of Building Contract for Hong Kong has now been completed and the new standard form is available for use by Architects in their dealings with Developers and Contractors. The Committee was composed of representatives nominated by the Hong Kong Society of Architects, the Society of Builders (Hong Kong) and the Hong Kong & China Branch of the Royal Institute of Chartered Surveyors.

This new form differs in many ways from the R.I.B.A. Standard Form of 1963 which has been used as the basis of the new document. The talks by Mr Sanderson will be presented in two parts:

- (a) The opening lecture will cover only the fundamental difference between the two contracts and no further detailed explanation will be given.
- (b) The subsequent ten lectures will deal clause by clause with the ramifications of the entire document.

THE BUILDING INDUSTRY — AN ANALYSIS Mr. M.G. Munday, Dip. Arch., A.R.I.B.A., Lecturer in Building Technology, Department of Architecture, University of Hong Kong. *Mondays, 5.45 p.m. to 6.45 p.m., starting September 30, 1968.* Extra-Mural Town Centre. 10 meetings. *Fee: \$45*

19

Few durable consumer products are as unique, as expensive, as complex, as large, as permanent and as influential as buildings. Few are designed and made by such a diverse group of people, in such a wide range of materials and techniques, for so many differing needs.

These products are the Building Industry's very reason for being, and this short but provocative illustrated review aims to show that, as an organisation designed to produce them, and so meet a very important social and economic need, it has no grounds for complacency. Yesterday's criteria for success will be shown as being inappropriate for tomorrow and reappraisal, re-organisation and rethinking by all concerned in the building process is essential.

This course is strongly recommended as an introduction to the Symposium on Building Industry Documentation, (see Course No 21) and adequate attendance will entitle the participant to at least observer membership.

POTENTIALITY OF THE COMPUTER FOR THE BUILDING INDUSTRY *Wednesday, December 18th, 1968.* Extra-Mural Town Centre and Computer Centre. One whole day. *Fee: \$40*

20

Many members of the Building Team are at a loss when discussing the potentiality of the Computer. (as distinct from the programming thereof). Applications are therefore invited from members of the various professions involved in the Building Industry for a one day study session to be held on Wednesday the 18th December, 1968, when a series of talks and demonstrations will be given. Applications should be made before Monday the 25th November, 1968 so that final arrangements can be completed.

This study session should also be of interest to persons wishing to participate in the Symposium on Technical Documentation.

SYMPOSIUM ON TECHNICAL DOCUMENTATION FOR THE BUILDING INDUSTRY IN HONG KONG Organisers Jon A. Prescott, B.Arch., M.C.D., A R I B A , A M T P I , Department of Extra-Mural Studies, University of Hongkong. M G Munday, Dip Arch , A R I B A , Lecturer in Building Technology, Department of Architecture, University of Hong Kong Extra-Mural Town Centre. Spring, 1969.

Between now and the end of the century, the Building Industry faces an enormous increase in demand for its products. It is known that it will be necessary to at least double the present stock of buildings within this period, if only to meet the growth in population, let alone achieve improvements in standards. The Industry is also aware that, to meet these needs and challenges in a world of increasingly rapid social, economic and technical change and advance, it must be properly organised and equipped. That it has cause for concern in this respect is evidenced by the extensive self-analytical studies it has felt necessary to initiate in recent years in many countries. In all cases a recognition of their inter-dependence by contractor, architect, supplier, engineer, surveyor, manufacturer, planner and government agency alike is seen as a pre requisite to the re-organisation needed to achieve such improvements.

Inter-dependent relationships require an organisation based on a sound network of communications, and it is the formal technical aspect of this, plus the documentation that goes with it, that is the subject of particularly close attention and spectacular change in the Industry today. Developments in documentation automation, standardisation and coding and their effects on the building process are of special significance.

This Symposium, which continues the series on vital aspects of Hong Kong industries, is linked to research studies which are already under way in the University of Hong Kong. It aims to bring together local and overseas experts in this field both to review developments in other parts of the world and to discuss their inevitable relevance to the current and future working of the Building Industry in Hong Kong.

Participation in the Symposium will be by invitation, and details will be published in due course. In the meantime persons interested in it, or in the research studies mentioned, are requested to contact the organisers for further particulars.

CERTIFICATE COURSE IN HOUSING MANAGEMENT

Due to factors outside our control, the Certificate course will not commence, as had been hoped in October 1968, but will now begin in 1969.

The course will be in two parts, Intermediate and Final and will involve instruction on at least two evenings per week plus a half day release requirement with employers. A Certificate will be awarded for the Final Examination only.

The Syllabus will have the approval of leading Managers of Real Estate, The Hong Kong Branch of the Institute of Housing Managers and several Government Departments.

Full details are available by writing to the Director of Extra Mural Studies.

THE CHINESE ARCHITECTURAL TRADITION Mr. C.H. Wong, M.C.D. (Liv.), B. Arch. (Sun Yat Sen), Senior Lecturer in the Department of Architecture, University of Hong Kong. *Wednesdays, 3.00 p.m. to 4.00 p.m. starting October 2, 1968.* Extra-Mural Town Centre. 10 meetings. *Fee: \$40*

22

The Tutor will touch upon theories and beliefs affecting architectural forms from Han to Ching Dynasties, and will discuss not only the development of buildings and their details but also the larger issues of layout and building relationships in town design. The lectures will be copiously illustrated.

BACKGROUND TO JAPAN — THE ARTS AND ARCHITECTURE Lectures and Study Tour.

23

Japan will become the Mecca of tourists in 1970 when the "Expo" is scheduled to be held in Osaka. Since the best of today's Architecture and Industrial Design to be found in Japan is of world significance this will be of great importance to persons having design interests.

It is proposed in 1970 to conduct a Study Tour of Japan which will allow for a series of visits to "Expo" but will also take into account the wider traditions and culture of the country as a whole.

This preliminary announcement is made now since the question of booking will obviously be of great importance. We shall invite applications for places simultaneously with a course of background lectures covering physical and geographical structure, basic religion and philosophy, traditional design, the growth of the modern movement in Architecture and its relationship to world developments and the Japanese problems and solutions in City and Regional Planning. The courses will begin in the Spring Term of 1969 and continue throughout the year in preparation for the tour which will be held in March/April 1970 coincident with the Easter vacation.

The number of enrolments for the Study Tour will be limited to 20 persons, priority being given to those attending the pre-study tour lectures and in order of booking. Prices will be held as low as practical and accommodation arranged in traditional Japanese Inns wherever possible.

A VISION OF GREECE Philosophy, Classics — Mr. George Mahood, M.A. (London), Architecture — Mr. Jon Prescott, B.Arch., M.C.D., A.R.I.B.A., A.M.T.P.I. Greek Art — Miss Marcia Vale B.A. (Brit. Col.), M.A. (Kent). *Wednesday, 8.15-9.30 p.m., starting October 16, 1968.* Extra-Mural Town Centre. 10 meetings. *Fee: \$35*

63

Much of the character and tradition of ancient Greece is mirrored in her plastic art and architecture: vases and statues celebrate the gods and heroes of myth, or sometimes the Greek love of athletics or again that popular and essential ingredient of Athenian life — the drinking-party or symposium; great buildings (such as the Parthenon) commemorate past legends and present glory

The three lecturers will collaborate in each session, Mr. Prescott and Miss Vale providing illustrations of architecture and plastic art and Mr. Mahood commenting on these as keys to Greek life and society from the feudal aristocracy of Ulysses' time to the democratic era enshrined in the Athens of Pericles, Socrates and Plato. It is hoped that a special showing of a film based on the Greek heritage can be arranged to add interest to the series.

Art and Design

Staff Tutor in Charge: Jon A Prescott, B Arch (Liv); M.C.D., A.R.I.B.A., A.M.P.T.I
Telephone No 458161 *Ext.* 308 or 226613

Instruction in Art and Design is planned primarily for the needs of the bona fide student who wishes to follow the three year programme leading to a Certificate in Fine Art, Advertising Design or Interior Design on a part-time basis. These courses provide for the essential skills and knowledge required of an artist or designer, together with a basic training in the professional aspects of the students chosen specialty.

Many courses are open to other than certificate students particularly in the Pre-Certificate Term I and day time courses are provided for those wishing to pursue art studies for personal pleasure or discovery.

Owing to limitations of space in the studios of the Town Centre and in the interests of good teaching the numbers accepted for courses primarily planned for certificate students will be restricted to the numbers mentioned with each course and priority will be given to certificate students over those wishing to attend only single courses.

For persons having a non-professional interest the series of lectures entitled "Grammar of Visual Form" would however provide a theoretical nucleus from which an attitude to design can grow and a sound grasp of the principles there expounded coupled with a knowledge gained from pre-certificate foundation courses in Form, Colour, Draughting and Theory would be of immeasurable value whatever practical classes are chosen in, for example, painting, ceramics, drawing or design.

Certificate Courses in Art and Design

Advisory Panel

MICHAEL F GRIFFITH, A.T.D.
KWOK CHIU LEUNG, DIP. A.D.
KWONG YIU TING, M.A. (KANSAS)
HENRY STEINER, M.F.A. (YALE)
JOHN WARNER, A.T.D., N.T.D.

Director of Studies

Jon A Prescott, B. Arch., M.C.D., A.R.I.B.A., A.M.T.P.I.

Course Tutors

Ruth Addison, Dipl. Arch., A.R.I.B.A.	Hon Chi-Fun
R.K. Cheng, B.A. (Econ.) St John's Tech Cert Printing C & G London	Kwok Chiu Leung, Dipl. A.D. Kwong Yiu Ting, M.A. (Kansas)
Chung Wah Nan, Dipl. Arch. (U.C.L.), A.R.I.B.A.	Julian A. Losinski, M.S.I.A., N.D.D., Dip. A.D.
David W. Crowe, Dipl. Arch. (Liv.), A.R.I.B.A.	P.W. Printer, N.D.D.
Michael F. Griffith, A.T.D.	Paul Selinger, M.F.A. (San Francisco Art Institute)
Cesar Guillen-Nunes, B.A. (Hons), Courtauld Institute of Art, University of London	Henry Steiner, M.F.A. (Yale)
Albert H. Hill, I.A. Dip.	Wucius C.K. Wong, M.F.A. (Maryland)
Tao Ho, B.A. (Williams), B. Arch. (Harvard)	Additional Tutors will be appointed as required

Entry Requirements

Hong Kong School Certificate or equivalent with a good working knowledge of the English language. Appropriate experience or ability will be taken into consideration. This includes satisfactory participation in a relevant Extra-Mural art course with at least 75% attendance.

Satisfactory completion of the studio work and courses included in the Pre-Certificate training will be necessary and final acceptance will depend upon interview and approval of the Advisory Panel.

Course Syllabuses and Examinations

Each complete Certificate Course covers three years. A year consists of two unequal length terms, the first of 12 weeks and the second of 15 weeks, making a total of 27 weeks in all. In courses which are predominately studio orientated, the work produced during the terms plus any vacation period tasks will be assessed as a whole at the end of each year by the Examining Board, consisting of the Advisory Panel and Course Tutors as relevant. It is particularly important at this portfolio examination that *all* work should be shown, in as far as progress can only be judged by comparison of good and bad and early and later exercises. Certain other subjects will be examined by written papers. At the moment these are:

- Year 1 History of Art I
Grammar of Visual Form A & B
Perspective and Sciagraphy
Lighting and Room Acoustics (Interior Design)
- Year 2 History of Art II (Interior Design & Fine Art)
Grammar of Visual Form C & D
Printing Technology (Advertising Design)
Construction & Materials I (Interior Design)
Development of Furnishing (Interior Design)
- Year 3 History of Art III (Fine Art)
Advertising Organisation & Professional Practice (Advertising Design)
Construction & Materials II (Interior Design)
Professional Practice (Interior Design)

Detail requirements for written examinations will be made known as the course proceeds and adjustments in the syllabus and requirements may be made from time to time at the discretion of the Director of Studies and the Board.

SCHEMATIC PATTERN OF COURSES FOR PRE-CERTIFICATE AND CERTIFICATE STUDY IN ART AND DESIGN

The actual courses to be taken in the current term are prescribed in detail on page 16 and particulars relating to each individual course are given in the following pages alongside other Art and Design courses available.

YEAR ONE

Term 1 **PRE-CERTIFICATE COURSE**
(12 weeks) Lectures on Form, Colour, Techniques of Draughting (free and mechanical), Theory, Modes of Vision

Term 2 **CERTIFICATE COURSE**
(15 weeks)

Fine Art Grammar of Visual Form A B Life Drawing & Anatomy I Painting Studio I History of Art Introduction Summer vacation work will be set including drawing notebook and research for projects	Advertising Design Grammar of Visual Form A/B Life Drawing & Anatomy I Advertising Studio I History of Art, Introduction Summer vacation work will be set including reading, essay, painting and drawing notebook and research for projects	Interior Design Grammar of Visual Form A/B Life Drawing & Anatomy I Interior Studio I/space & setting History of Art, Introduction Summer vacation work will be set including reading, essay, painting and drawing notebook and research for projects
---	--	--

YEAR TWO

Terms 3 & 4

Grammar of Visual Form C D Life Drawing & Anatomy II History of Art 20th Century Painting Studio II Seminar Painting Inquiry Introduction to Three Dimensional Design Summer vacation work will be set including reading, essay, notebook and research for final projects	Grammar of Visual Form C/D Life Drawing & Anatomy II History of Art 20th Century Advertising Studio II / limitations costing Printing Technology Photography Drawing in Mixed Media Summer vacation work will be set including reading, essay, notebook and research for final projects	Grammar of Visual Form C/D Life Drawing & Anatomy II History of Art 20th Century Interior Studio II, /lighting and room acoustics Materials and Detailing I Development of Furnishing Summer vacation work will be set including reading, essay, notebook and research for final projects
---	--	---

YEAR THREE

Terms 5 & 6

Painting Studio III History of Art III (special) Three Dimensional Design Modelling Special Study	Advertising Studio III Printing, Technology, machines specifications Professional Practice Cost Analysis & contracts Special Study	Interior Studio III Materials & Detailing II, / ergonomics and furniture Professional Practice Costing, Contracts & Management Special Study
---	--	--

The areas described above do not necessarily imply courses with a similar name will be directly correlated, and the syllabus will be modified from time to time as the Panel and Director feel is necessary. The above may be taken as an indication of the range of work which will need to be covered. Some courses will be provided in different order to the schematic layout.

PRE-CERTIFICATE TRAINING

All students wishing to enter upon the certificate courses will now be asked to undergo pre-certificate training. The prescribed courses are as follows:

Introduction to Aesthetics	(24)	Henry Steiner M.F.A.
Relationships of Form & Colour	(25)	Tao Ho, B.A., B.Arch.
Basic Vision & Experimental Drawing	(26)	Wucius C.K. Wong, M.F.A.
Drawing Board Techniques	(27)	Ruth A. Addison, Dipl. Arch., A.R.I.B.A.
Free Drawing & Painting	(28)	Paul Selinger, M.F.A.

After completion of this initial term the student will select one out of the three present streams of Fine Art, Advertising Design or Interior Design, and will take the lecture series and studio sessions which have been grouped so as to provide a scheme of systematic study leading, over three years, to the Certificate in Art and Design. The choice of streams may well be eventually enlarged by adding other subject areas as this becomes possible.

Materials and Equipment

All students will be required to have a portfolio (size 35" x 25" min.) for storage of studio work during the term. This is particularly important as *all* work is required for the examination at the end of each year. Facilities are provided adjacent to the studios for storing these on the premises to save constant transportation of a bulky item. In addition students will be required to purchase:

- A double elephant size T square
- A double elephant drawing board (for home use)
- 45° and 60° set squares
- Drawing scales, instruments and pens (a basic minimum only)
- Brushes, poster paint, water colours, pencils, etc. as required
- Drawing paper of various types

Advice will be given on equipment needed prior to the commencement of each course and students should wait until they have been so briefed before they purchase, to avoid buying needlessly complex or expensive equipment not required by the tutors or lecturers.

A retail shop is open on the premises for the convenience of students at times suited to the lectures and studio periods, so that purchases can be made during the time of instruction as required. Prices are very competitive with other shops in town.

Fees

The prescribed Pre-certificate Courses will be available as a group for the reduced overall fee of \$300

- The Course fee for terms of 12 weeks will be \$200
- The Course fee for terms of 15 weeks will be \$250

Fees are to be paid in advance. Registration will be accepted for a **WHOLE YEAR** only. *Examination fees are extra.*

PREScribed COURSES FOR CERTIFICATE STUDENTS YEAR TWO TERM 3

October to December, 1968

FINE ART

- | | | |
|---|------|------------------------|
| 1. Life Drawing & Anatomy IIA | (29) | Michael F. Griffith |
| 2. Painting Studio IIA | (32) | Y.T. Kwong |
| 3. History of Art IIA | (30) | Cesar A. Guillen-Nunes |
| 4. Painting Inquiry, Seminar A | (33) | Hon Chi Fun |
| a. Colour Practice | (31) | Tao Ho |
| b. Basic Vision & Experimental
Drawing | (26) | Wucius C.K. Wong |

ADVERTISING DESIGN

- | | | |
|--------------------------------|------|---------------------|
| 1. Life Drawing & Anatomy IIA | (29) | Michael F. Griffith |
| 2. Advertising Studio IIA | (34) | Julian Losinski |
| 3. Printing Technology | (35) | R.K. Cheng |
| 4. Drawing Board Techniques II | (37) | Ruth A. Addison |
| a. Colour Practice | (31) | Tao Ho |
| b. Painting Inquiry, Seminar A | (33) | Hon Chi Fun |

INTERIOR DESIGN

- | | | |
|----------------------------|------|---------------------|
| Life Drawing & Anatomy IIA | (29) | Michael F. Griffith |
|----------------------------|------|---------------------|

(This class is prescribed for certain students who have been so informed following Portfolio Examination I. It is however highly recommended as an optional course and the time table has been arranged accordingly)

- | | | |
|--|------|------------------------|
| 1. Interior Studio IIA | (36) | Tao Ho |
| 2. Nature of Materials & Detailing | (38) | Chung Wah Nan |
| 3. History of Art IIA | (30) | Cesar A. Guillen-Nunes |
| 4. Drawing Board Technique II | (37) | Ruth A. Addison |
| a. Colour Practice | (31) | Tao Ho |
| b. Painting Inquiry, Seminar A | (33) | Hon Chi Fun |
| a. This was omitted last year | | |
| b. Highly recommended course, but optional | | |

**PRESCRIBED COURSES FOR CERTIFICATE STUDENTS
YEAR ONE TERM 2**

January to April, 1969

FINE ART

- | | | |
|---------------------------------|------|-----------------------------------|
| 1. Grammar of Visual Form A/B | (39) | Jon A. Prescott & Kwok Chiu Leung |
| 2. Life Drawing & Anatomy I | (40) | Michael Griffith |
| 3. Painting Studio I | (63) | Kwong Yiu Ting |
| 4. History of Art, Introduction | (41) | Cesar Guillen-Nunes |

ADVERTISING DESIGN

- | | | |
|---------------------------------|------|------------------------------------|
| 1. Grammar of Visual Form A/B | (39) | Jon. A. Prescott & Kwok Chiu Leung |
| 2. Life Drawing & Anatomy I | (40) | Michael Griffith |
| 3. Advertising Studio 1 | (42) | Patrick W. Printer |
| 4. History of Art, Introduction | (41) | Cesar Guillen-Nunes |

INTERIOR DESIGN

- | | | |
|---------------------------------|------|-----------------------------------|
| 1. Grammar of Visual Form A/B | (39) | Jon A. Prescott & Kwok Chiu Leung |
| 2. Life Drawing & Anatomy I | (40) | Michael Griffith |
| 3. Interior Studio 1 | (43) | Ruth A. Addison |
| 4. History of Art, Introduction | (41) | Cesar Guillen-Nunes |

**PRESCRIBED COURSES FOR CERTIFICATE STUDENTS
YEAR TWO TERM 4**

January to April, 1969

FINE ART

- | | | |
|--|------|------------------------|
| 1. Life Drawing & Anatomy IIB | (64) | Paul Selinger |
| 2. Painting Studio IIB | (32) | Kwong Yiu Ting |
| 3. History of Art IIB | (30) | Cesar A. Guillen-Nunes |
| 4. Painting Inquiry, Continuing Seminar B | (33) | Hon Chi Fun |
| a Introduction to Three Dimensional Design | (45) | Paul Selinger |

ADVERTISING DESIGN

- | | | |
|--|------|------------------------|
| 1. Advertising Studio IIB | (34) | Julian Losinski |
| 2. Printing Technology | (35) | R.K. Cheng |
| 3. History of Art, Introduction | (41) | Cesar A. Guillen-Nunes |
| 4. Drawing Techniques, Mixed Media, Use of Photography | (47) | Albert Hill |
| a Life Drawing & Anatomy IIB | (64) | Paul Selinger |

INTERIOR DESIGN

- | | | |
|------------------------------------|------|------------------------|
| 1. Interior Studio IIB | (36) | Tao Ho |
| 2. Nature of Materials & Detailing | (38) | Chung Wah Nan |
| 3. History of Art IIB | (30) | Cesar A. Guillen Nunes |
| 4. Development of Furnishing | (48) | David W. Crowe |
| a Life Drawing & Anatomy IIB | (64) | Paul Selinger |

a Highly recommended course, but optional

Pre-Certificate and Foundation Courses

- 24** **INTRODUCTION TO AESTHETICS** Mr. Henry Steiner, M.F.A. (Yale). *Thursdays, 6.00 p.m. to 7.00 p.m. starting 3rd October, 1968.* Extra-Mural Town Centre. 12 meetings. *Fee: \$50.*

Aesthetics is usually considered to be the study of beauty in art, but as standards of beauty have altered through history, it might more broadly be defined as the study of the rules that make art 'Art'. Accepting the idea that there are laws of perception, as well as ideals of proportion, contrast and harmony — which even the most apparently 'formless' and 'meaningless' modern art acknowledges by rebelling against them — this course seeks to examine these underlying rules as they apply to the visual arts. Through lectures, slides and discussion this course will attempt to awaken those with little previous background or training to the rational basis of art and equip them with a set of standards to use in judging for themselves the merits of works of 'pure' or applied visual art.

- 25** **RELATIONSHIPS OF FORM AND COLOUR** Mr. Tao Ho, B.A. (Williams), B. Arch. (Harvard). *Mondays, 6.00 p.m. to 7.30 p.m., starting 30th September, 1968.* Extra-Mural Town Centre. 12 meetings. *Fee: \$75*

The two parts of this course will consider two dimensional formal relationships basic to any understanding of visual pattern making, Composition, and also theories of colour and systems of organisation (Oswald and Munsell) which help to explain basic phenomena such as contrast, harmony, discord, transparency, etc.

Instruction will be given in the form of a series of exercises which will be used as a starting point for discussion each week, but this is basically a lecture series having no studio work during the period of instruction.

- 26** **BASIC VISION AND EXPERIMENTAL DRAWING** Mr. Wucius C.K. Wong, M.F.A. (Maryland). *A. Wednesdays, 5.45 p.m. to 7.45 p.m. starting 2nd October, 1968. B. Fridays, 5.45 p.m. to 7.45 p.m. starting 4th October, 1968.* Extra-Mural Town Centre. 12 meetings, once weekly. *Limit of enrolment for any one class 25 students.* *Fee: \$75*

A systematic exploration of differing ways of "seeing" an object will be made and alternative ways of presenting the intellectual appreciation of the "forms" will be discussed. A series of exercises will allow students to appreciate the problems of each concept of presentation and these exercises will form the basis of discussion as part of the week's work.

A model will be used on alternate evenings for which there will be a small extra charge. This course is intended equally for beginners as well as searching artists interested in intense observation of the objective world.

- 27** **DRAWING BOARD TECHNIQUE I** Mrs. Ruth A. Addison, Dipl. Arch. (U.C.L.), A.R.I.B.A. *A. Wednesdays, 8.00 p.m. to 10.00 p.m., starting 2nd October, 1968. B. Thursdays, 8.00 p.m. to 10.00 p.m., starting 3rd October, 1968.* Extra-Mural Town Centre. 12 meetings, once weekly. *Limit of enrolment for any one class 25 students.* *Fee: \$75*

Students will be initiated into the use of general drafting equipment and by means of various graduated exercises will learn the process of draughting for various projections — orthographic, isometric and axonometric and basic methods of setting up different perspectives and sciagraphy. Emphasis will be given to general lettering, layout and presentation of drawings.

FREE DRAWING AND PAINTING Mr. Paul Sellinger, M.F.A. (San Francisco Art Institute). A. *Mondays, 8.00 p.m. to 10.00 starting 30th September, 1968.* B *Fridays, 8.00 p.m. to 10.00 p.m., starting 4th October, 1968.* Extra-Mural Town Centre. 12 meetings, once weekly. *Limit of enrolment for any one class 25 students.* *Fee: \$75*

28

Various media will be systematically explored to give students the opportunity of personal experiment in using them. The use of objects and a model will be alternated with imaginative and abstract concepts as a basis for the exercises. The aim of the course is to 'free' the student of any preconceived approach and to allow him to understand the contribution of his personality and the media itself in the creation of visual representations.

LIFE DRAWING & ANATOMY I Mr. Michael F. Griffith, A.T.D.

40

A course of 15 two hourly periods. A beginner's class. Special attention will be given to basic anatomy and techniques of drawing. Commencing in January 1969.

GRAMMAR OF VISUAL FORM Mr. Jon A. Prescott, B.Arch., M.C.D., A.R.I.B.A., A.M.T.P.I. Mr. Kowk Chiu Leung, N.T.D.

39

Parts A and B will be given during the Spring Term 1969 and Parts C and D will be given in the 1969-70 sessions.

The aim of a Grammar of Visual Form is to provide a training in visual understanding. The Course which consists of four sections, is based on the studies of Kurt Rowland, whose work for the Council of Industrial Design in England has resulted in a textbook on visual education. Parts C and D show how the "grammar" formulated in Parts A and B may be applied.

Certain sessions will conclude with the setting of a small practical exercise which will be discussed briefly at the following meeting.

Part A, Year 1, Pattern and Shape

In the visual world everything can be reduced to patterns and shapes. A study of their nature and functions enables us to look at our surroundings with deeper insight. Patterns are effected by the materials used and are deeply influenced by the social, economic and cultural backgrounds of the pattern makers.

Part C, Year 2, The Shapes We Need

There are two strands in all design—the rational, scientific and analytical aspect and the intuitive, inspired, human influence. The man-made world is a synthesis of these two and the balance will vary. Discussion will centre on how these elements are combined, how they influence results and what principles are involved.

Part B, Year 1, Development of Shape

Form is the outcome of forces acting on material—when the material and the forces change, the forms they create must also change. Consideration will be given to Form based on technology, the effect of traditional and modern materials on form, natural development and function, and to the relationship between shape, materials, processes and function.

Part D, Year 2, the Shape of Towns

The town is the most complicated and ambitious man-made set of shapes and its study brings out the importance of the variety and a vast scale of design problems. Town design is an art form, though we look at it chiefly as a means of solving the problems of organised urban living. However, as in all design, the intuitive element is still required in order to restore those qualities of delight which are an essential element of our well being.

Practice

- 37** **DRAWING BOARD TECHNIQUE II** Mrs. Ruth A. Addison, Dipl. Arch. (U.C.L.) A.R.I.B.A. *Thursdays, 5.45 p.m. to 7.45 p.m., starting 3rd October, 1968.* Extra-Mural Town Centre. 12 meetings. *Limit of enrolment 25 students.*
fee: \$90

The graphic presentation of ideas is an essential basic requirement in all design work, of key importance in communicating the intention of the designer to his lay client. These studio periods will by way of a series of exercises introduce a variety of methods of presentation for the schemes undertaken. Emphasis will be given to the effective presentation of plans, sectional elevations as well as to the most important descriptive method the perspective.

The course will build on the knowledge which is the subject of Drawing Board Technique I (Course No 27) and non-certificate students wishing to do so could enrol for both courses.

-
- 29** **LIFE DRAWING AND ANATOMY IIA** Mr. Michael Griffith, A.T.D. *Tuesdays, 8.00 p.m. to 10.00 p.m., starting 1st October, 1968.* Extra-Mural Town Centre. 12 meetings.. Continuing in term 4 (Spring 1969) for a further 15 periods. *Enrolment is limited to 25 students, A model will be used for which there will be additional charge of approximately \$25. Fee: \$70 (12 periods), \$90 (15 periods), \$150 (27 periods).*

The discipline of drawing from life has long been recognised as the finest training in the correlation of hand and eye for any artist or designer. Stress will be laid on the underlying structural framework of the human form through a knowledge of basic anatomy. The use of different media will be encouraged.

This course is aimed at students who have had some previous experience. There will be a Life Drawing & Anatomy I course commencing in January 1969 for beginners.

-
- 31** **COLOUR PRACTICE** Mr. Tao Ho, B.A. (Williams), B.Arch. (Harvard). *Thursdays, 8.00 p.m. to 10.00 p.m., starting 3rd October, 1968.* Extra-Mural Town Centre. 6 meetings. *Fee \$45*

An understanding of theories of colour and systems of organisation (Oswald, Munsell and others) followed by critical discussion and study work in basic phenomena such as contrast, harmony, discord, modulation, transparency and spatial effect.

The studio exercises which will be a part of each instructional exercise will be facilitated by the use of special colour coded papers, which are available in the Department shop.

-
- 32** **PAINTING STUDIO IIA** Mr. Y.T. Kwong, M.Sc. (Kansas). *Mondays, 5.45 p.m. to 7.45 p.m., starting 30th September, 1968.* Extra-Mural Town Centre. 12 meetings. Continuing in Term 4 (Spring 1969) for a further 15 periods. *Fee: \$70 (12 periods), \$90 (15 periods), \$150 (27 periods).*

An intermediate level class for continued painting experience in various media. The aim is to allow individual students to develop at their own pace under expert guidance. Non-certificate students who have taken Part I Painting or who have a little experience already will be welcome.

PAINTING INQUIRY — A CONTINUING SEMINAR AND STUDIO Mr. Hon Chi Fun and Guest Tutors. *Tuesdays, 5.45 p.m. to 7.45 p.m., starting 1st October, 1968.* Extra-Mural Town Centre. 12 meetings. Continuing in Term 4 (Spring 1969) for a further 15 periods. *Fee: \$70 (12 periods), \$90 (15 periods), \$150 (27 periods).*

33

This continuing seminar will consist of organised discussion combined with studio practice, the whole emphasis being on the discussion of expression of ideas, methods of work and approach to conceptually creative thinking.

Under the general direction of Mr. Hon Chi Fun various well known Hong Kong Artists will participate from time to time.

There will be a limited enrolment of 15 students who should be either registered certificate students or have considerable painting experience to their credit.

INTRODUCTION TO THREE DIMENSIONAL DESIGN Mr. Paul Selinger, M.F.A. (San Francisco Art Institute)

45

A course of 15 studio/workshop sessions introducing students to three dimensional considerations of design, modelling and sculpture. Commencing in January 1969.

Please cut along this line

PAINTING AND DRAWING CLASSES IN VARIOUS MEDIA

55

Persons who are interested in joining a beginners class in painting, using oil, acrylic or watercolour media or in handprint making, monotype, block printing and so on are asked to write to the Tutor in Charge giving the details asked for below, and an attempt will be made to build up a class of 15 to 20 members for the Autumn term of 12 weeks in any one or two subjects.

Previous experience has shown that a large number of people would like to attend certain classes but that it is quite impossible for them to attend at the time announced and many classes of this type have been cancelled through lack of support. The fee for a 12 week course of two hours per session would be \$70 exclusive of materials, which must be provided by the student.

Name.....Telephone No. (home).....

Address.....:.....Telephone No. (office).....

.....

Please complete reverses side of this slip

VOCATIONAL: Advertising Design

Training the Advertising Designer is usually associated with vocational entry into industry, advertising organisations or freelance work. The primary problem is one of visual communication and the values associated with "pure art" need to be correlated with an appreciation of business acumen, of client requirements and market response. A broad background of liberal studies and Fine Art is of importance.

STUDIO

The special lectures in the subject will be followed in all years by Studio periods. Such practical sessions under guidance form an important part of teaching bringing together all aspects of the work.

42 ADVERTISING STUDIO I Mr. Patrick. W. Printer. N.D.D. (Graphic Design)

A vocational class consisting of 15 two hourly studio sessions as an introduction to the work of an advertising studio. The work will consist of practical exercises but the outline organisation of an agency will be discussed in formulating the problems involved. Commencing in January 1969.

34 ADVERTISING STUDIO IIA Julian A. Losinski, M.S.I.A., N.D.D., Dip. A.D. & A.D. Mondays, 8.00 p.m. to 10.00 p.m., starting 30th September, 1968. Extra-Mural Town Centre. 12 meetings. Continuing in term 4 (Spring 1969) for a further 15 periods. Fee: \$100 (12 periods), \$140 (15 periods), \$220 (27 periods).

Studio facilities provide the core of the Advertising Design students work bringing together all aspects from printing technology to abstract formal considerations. As, however, advertising relies very greatly on "ideas" as well as Graphic Design it is important to appreciate what ideas mean, why they are good, how they sell, how to get and exploit them. Within the framework of a series of carefully conceived exercises the student will apply ideas, in terms of layout, copy and photographic application for both advertisement and packaging designs.

Type of class required—painting
—drawing
—print making

Special interest e.g. portraits, sketching, etc.

Time of class required: Daytime or Evening

State days and times when you would be available.....

State days and times when you would *not* be available.....

Do you wish for instruction to be in Cantonese or English or is either acceptable?

Cantonese... ..English

Either.....

Please return this form before Monday, 16th September, 1968

PRINTING TECHNOLOGY IIA Mr R K Cheng B A (Econ) St Johns Tech Cert in Printing C & G London *Mondays, 6 00 p m to 7 00 p m, starting 30th September, 1968* Extra-Mural Town Centre and Government Printing Works 12 meetings The course will continue into Term 4 (Spring 1969) for a further 15 periods and will be completed in Terms 5 and 6. *Fee \$70 (12 periods), \$95 (15 periods) \$150 (27 periods)*

35

Many of these lectures will take place on the workshop floor so that students can become familiar with the practical problems of printing technology They will provide a study in some depth of the features of printer's type, his type case, type setting and justification, point systems and classification, preparation of copy, casting off of copy, page layout, composition, paper and paper calculation, lino types and monotypes etc The study will be closely coordinated with studio exercises provided in Course 34

DRAWING TECHNIQUES- MIXED MEDIA & USE OF PHOTOGRAPHY
Mr Albert Hill I A Dip

46

An introduction in 15 sessions to the usefulness of photography as an aid in advertising This will be considered in conjunction with presentation in various media Commencing in January 1969

VOCATIONAL: Interior Design

"The profession of interior design has had a long struggle to free itself from the image of the interior decorator There is a growing appreciation that transference of the interior designer from the atmosphere of the boutique to the architectural design studio is not enough and that there is a need to establish far more scientific basis for interior decisions "

Like all creative work, interior design depends on an understanding of the principles and disciplines which can be scientifically outlined but it depends on something more—an intuitive element without which the results can be sterile

The special courses to be provided over three years will introduce a scientific attitude to design and although the lecture series will be independent they will be correlated to form a whole

STUDIO

Studio periods will form an essential part of the Interior Design courses when exercises will be discussed In the studio all aspects of the work coalesce and for this reason such work forms perhaps the most important part of the instruction and the subsequent portfolio examination

INTERIOR DESIGN STUDIO Mrs Ruth A Addison Dip Arch (UCL), A R I B A
Commencing in January 1969

43

A course of 15 two hourly studio sessions consisting of graded exercises in simple interior design with emphasis on space and colour Students should have taken Course 27 as a prerequisite

-
- 36** **INTERIOR STUDIO II** A Mr Tao Ho B.A. (Williams), B.Arch. (Harvard). *Wednesdays, 5.45 p.m. to 7.45 p.m., starting 2nd October, 1968.* Extra-Mural Town Centre 12 Meetings Continuing in Term 4 (Spring 1969) for a further 15 periods *Fee \$100 (12 periods), \$140 (15 periods), \$220 (27 periods)*

A series of graded exercises throughout the year will be set in co-ordination with studies in various lecture courses and organised so as to develop the student's ability to present a carefully worked out scheme for differing types of interior. Part of the work this year will be to develop technical drawings in association with the lectures on the nature of materials and detailing and these will be worked out in conjunction with certain schemes of the student's own design.

-
- 38** **THE NATURE OF MATERIALS AND DETAILING** Mr. Chung`Wah Nan, Dip Arch (UCL), A.R.I.B.A. *Wednesdays, 8.00 p.m. to 10.00 p.m. starting 2 October 1968.* Extra-Mural Town Centre 12 meetings. Continuing term 4 (Spring 1969) for a further 15 periods *Fee \$90 (12 periods), \$140 (15 periods), \$220 (27 periods)*

In all design work an understanding of the nature of materials is fundamental. The essential characteristics of materials predominantly used in interior work will be discussed and problems of achieving satisfactory jointings and junctions, the structural implications of using different materials and the effects to be achieved by different methods of detailing, will be co-ordinated with various research projects of collation of data together with exercises so arranged to reveal the problems and solutions involved. Application of this data will be made in the studio technical drawings.

-
- 48** **DEVELOPMENT OF FURNISHING** Mr. David W. Crowe, Dip. Arch. (Liv.), A.R.I.B.A. Commencing in January 1969.

A consideration in 15 sessions of the historical development of furniture and the associated interior furnishing to give a basic understanding of principle styles.

History and Appreciation

- 41** **HISTORY OF ART I** Mr. Cesar A. Guillen-Nunes, B.A. (Hons.) Courtauld Institute of Art. London University.

A course of 15 lectures and seminars following an Introduction to the study of History of Art with particular concentration on the roots of the modern movement. Parallel consideration will be given to developments in painting, sculpture and architecture. Commencing in January 1969.

HISTORY OF ART IIA Mr. Cesar A. Guillen-Nunes, B.A. (Hons.) Courtauld Institute of Art, London University. *Fridays, lecture 6 00 p m to 7 00 p m., tutorial 7.00 p.m. to 8.00 p.m., starting October 4th 1968.* Extra-Mural Town Centre. 12 meetings, once weekly, *one hour of lecturing, and on alternate weeks one hour of tutorial, i.e. the tutorial will be by groups of half of the total enrolment on alternate meetings* Continuing in Term 4 (Spring 1969) for a further 15 periods *Fee: \$70 (12 periods), \$90 (15 periods), \$150 (27 periods).*

30

The lectures in this course and in History of Art IIB (commencing in January 1969) will be devoted to parallel developments in painting, architecture and sculpture in the twentieth century.

Tutorial sessions will be used to encourage detailed consideration of certain aspects and student participation.

Reference should also be made to

128 ANGKOR: ART & CIVILISATION (Page 52)

Daytime Courses

TRADITIONAL CHINESE PAINTING THEORY AND TECHNIQUES I 49
Professor C.Y. Wang, M.A. *Tuesdays, 3.00 to 5.00 p m starting 2nd October, 1968.* Extra-Mural Town Centre. 20 meeting. *Enrolment limited to 20 students.* *Fee: \$120*

Students will provide their own materials which will be discussed at the first meeting.

This will very largely be a practical class with considerable individual instruction following an explanation of the choice of the basic materials and techniques. The handling of brushes and the use of inks will be discussed and demonstrated and fundamental brush work and composition based on traditional principles explained.

Although instruction will be in English, a limited understanding of the Chinese language will be an advantage in order to appreciate explanations of certain technical phraseology.

TRADITIONAL CHINESE PAINTING THEORY AND TECHNIQUES II 50
Professor C.Y. Wang, M.A. *Fridays, 3.00 p.m. to 5.00 p.m., starting 4th October, 1968.* Extra-Mural Town Centre. 20 meetings. *Enrolment limited to 20 students.* *Fee: \$120*

Students will provide their own materials which will be discussed at the first meeting

Instruction in this class will build on the principles and practice laid down in the introductory course. Explanation will be given of certain principles and literary ideas developed by painters during various historical periods, and greater stress will be laid on overall composition than was possible in Part I. The class will be essentially a practical one with considerable individual instruction.

51 CERAMICS I Mrs. M. Mellor. *Tuesdays, 10.00 a.m. to 12 noon starting October 1, 1968.* 2 University Path, Hong Kong. 12 meetings. *Enrolment is limited to 10-12 students. Fee: \$110 plus \$40 fee (for materials and firing*)*

**Any student whose material and firing fee is exceeded will be asked to pay for any additional clay at 60c per 100 grms.*

Students will be taught various methods of building pottery by hand and of decorating and glazing the ware they produce. Discussion of the materials and processes involved, the quality and texture of the clay unfired and fired will precede practical experiment with clay as a plastic material using traditional hand forming techniques, stretching, joining, slabbing and coiling

52 CERAMICS II Mrs. M. Mellor. *Wednesday, 10.00 a.m. to 12 noon, starting 2nd October, 1968* 2 University Path, Hong Kong. 12 meetings.
*Fee. \$120 plus \$40 fixed for materials and firing**

**Any student whose material and firing fee is exceeded will be asked to pay for any additional clay at 60c per 100 grms.*

Enrolment will be restricted to persons having some previous experience or who have attended the beginners' class. Further development of hand forming techniques will be undertaken together with an analysis of glazes and techniques of decoration. Limited wheel work will be undertaken.

53 IKEBANA I A STUDY OF BASIC PHILOSOPHY AND PRACTICAL APPLICATION Mrs. Margery Fong, Professor 3rd Degree Sogetsu School, Japan Studies of Chiko School, Ikebana, Japan Studies of Koryu School, Ikebana. *Thursdays, 10.00 a.m. to 12 noon, starting 3rd October, 1968.* Extra-Mural Town Centre. 10 meetings. *Enrolment will be limited to a maximum of 14 students. Fee: \$150*

A preliminary course introducing new students to the basic concepts of Ikebana. The basic study will cover the eight standard variations of the Sogetsu School and will be a prerequisite for subsequent participation in further courses.

Provision of Nageire and Moribana containers, kensen and other equipment will be arranged by the Tutor and an allowance of about \$50 should cover this. Provision of materials for practical exercises will cost about \$3 or \$4 per session.

54 IKEBANA III A FURTHER STUDY OF PRACTICAL APPLICATION Mrs. Margery Fong, Professor 3rd Degree Sogetsu School, Japan. Studies of Chiko School, Ikebana, Japan Studies of Koryu School, Ikebana *Fridays, 10.00 a.m. to 12 noon, starting 4th October, 1968.* Meeting place to be announced. 10 meetings. *Enrolment will be limited to a maximum of 14 students. Fee: \$150*

Ikebana III is only open to students who have completed Parts I and II to the satisfaction of the Tutor or have the award of the 1st and 2nd beginners certificate of the Sogetsu School Japan.

PATTERN DESIGN Mrs. F. Wong, Cert. Textile Design, Boras, Sweden. Cert. Stockholm Tillskatar Academi, Stockholm. *Wednesdays, 3.00 p.m. to 5.00 p.m. Starting 2 October 1968.* Extra-Mural Town Centre. 20, meetings
Fee: \$150

56

General principles of pattern design, in particular for printed fabrics, but also in other relevant media, will be given. Studio work will be accompanied by critiques and discussion. Emphasis will be placed in the later stages, on the theory of colour combinations. The course will be of general interest but in particular will interest the freelance designer.

Students will be given information as to the materials required at the first meeting.

PAINTING I Mr. Peter Lam. *Saturdays, 9.30 a.m. to 11.30 a.m., starting 5th October, 1968.* (The studio will be available for private working to 1.00 a.m.). Extra-Mural Town Centre. 24 meetings. *Enrolment is limited to 25 students.*
Fee: \$140

57

An introductory course for persons having no previous experience. The Tutor will introduce various subjects, techniques and media and will discuss practical colour mixing, palette organisation, materials, texture and treatment of surface and will analyse historical and present day examples of relevance to the techniques introduced.

Students will be given information as to the materials required at the first meeting.

WATERCOLOUR PAINTING Commencing in Spring 1969. Mrs. Rosamund Brown will continue her classes in watercolour painting which began in 1967-8.

62

Other Art Classes

- 58** CERAMICS I Mrs. M. Mellor. *Tuesdays, 6.00 to 8.00 p.m. starting October 1, 1968. 2 University Path, Hong Kong. 12 meetings. Enrolment is limited to 10-12 students. Fee: \$110 plus \$40 fixed for materials and firing**
**Any student whose material and firing fee is exceeded will be asked to pay for any additional clay at 60c. per 100 grms.*

Students will be taught various methods of building pottery by hand and of decorating and glazing the ware they produce. Discussion of the materials and processes involved, the quality and texture of the clay unfired and fired will precede practical experiment with clay, as a plastic material using traditional hand forming techniques, stretching, joining, slabbing and coiling.

- 59** CERAMICS II Mrs. M. Mellor. *Wednesdays, 6.00 to 8.00 p.m. starting October 2, 1968. 2 University Path, Hong Kong. 12 meetings. Enrolment is limited to 10-12 students. Fee: \$120 plus \$40 fixed fee for materials and firing**
**Any student whose material and firing fee is exceeded will be asked to pay for any additional clay at 60c. per 100 grms.*

Enrolment will be restricted to persons having some previous experience or who have attended the beginners class (Ceramics I). Further development of hand-forming techniques will be undertaken together with an analysis of glazes and techniques of decoration.

- 60** IKEBANA I A STUDY OF BASIC PHILOSOPHY AND PRACTICAL APPLICATION Mrs. Margery Fong, Professor 3rd Degree Sogetsu School, Japan Studies of Chiko School, Ikebana, Japan Studies of Koryu School, Ikebana. *Thursdays, 6.00 p.m. to 8.00 p.m., starting 3rd October, 1968. meeting place to be announced. 10, meetings. Enrolment will be limited to a maximum of 14 students. Fee: \$150*

A preliminary course introducing new students to the basic concepts of Ikebana. The basic study will cover the eight standard variations of the Sogetsu School and will be a prerequisite for subsequent participation in further courses.

Provision of Nageire and Moribana containers, kensen and other equipment will be arranged by the Tutor and an allowance of about \$50 should cover this. Provision of materials for practical exercises will cost about \$3 or \$4 per session.

- 61** IKEBANA II A STUDY OF BASIC PHILOSOPHY AND PRACTICAL APPLICATION Mrs. Margery Fong, Professor 3rd Degree Sogetsu School, Japan Studies of Chiko School, Ikebana, Japan Studies of Koryu School, Ikebana. *Mondays 6.00 p.m. to 8.00 p.m., starting 30th September, 1968. meeting place to be announced. 10, meetings. Enrolment will be limited to a maximum of 14 students. Fee: \$150*

The completion of Ikebana I and II should bring the student to the level of competence of the 4th Beginner's Certificate of the Sogetsu School, if full attendance has been fulfilled and the work satisfactory.

Acceptance for Ikebana II will depend on successful completion of Ikebana I and will be at the discretion of the Department and the Tutor.

Chinese Studies

Staff Tutor in Charge: C.K. Leung B.A. (H.K.) Telephone No. 226529

國學研究

國學課程分文學，哲學，歷史及藝術各門，文、史、哲課程重欣賞，創作與研究，藝術方面除介紹各種不同藝術之源流發展外，理論與實習並重。學者可細閱課程內容簡介，選科修讀。

主理導師梁志强先生

Literature 文學

AN APPRECIATION OF THE WORKS OF CHU YUEN Mr. K.N. Leung.
Wednesdays, 8.15 p.m. to 9.15 p.m., starting 25th September, 1968. Extra
Mural Town Centre. 12 Meetings. Fee: \$30

64

屈原賦選

本課程共十二講，於屈原賦二十五篇中，拔其尤者，詳為講授，而於其去國之思，貞潔之質，三致意焉；亦為詞章學者必修之課程也。印發講義。

主講人：梁簡能先生

講授語言：粵語

地點：香港大學校外課程部市區中心。

時間：一九六八年九月廿五日起
每星期三下午八時十五分
至九時十五分。

學費：三十元

65

APPRECIATION OF CHINESE POETRY Mr. K.N. Leung. Wednesdays, 7.00 p.m. to 8.00 p.m., starting 25th September, 1968. Extra Mural Town Centre. 12 Meetings. Fee: \$30

詩學通論

本課程共十二講於魏晉作者中分別論列其生平與其作品之成就以及其影響。與暑期進修之魏晉詩，可收表裏之效云。印發講義。
主講人：梁簡能先生
講授語言：粵語
地點：香港大學校外課程部市區中心。
時間：一九六八年九月廿五日起每星期三下午七時至八時。
學費：三十元。

66

CHUAN-TZU Mr. K.K. Ho. Tuesdays, 7.00 p.m. to 8.00 p.m., starting 1st October, 1968. Committee Room South, City Hall. 12 Meetings. Fee: \$30

莊子

莊子義理精，文章美妙。本課程即從此兩點，作深入淺出之闡明。以次講述逍遙遊，齊物論，大宗師，天下等篇。以探討其義理指歸，文章奇異之所在，並印發講義以資互證。(十二講)
主講人：何敬羣先生
講授語言：國語
地點：香港大會堂南會議室。
時間：一九六八年十月一日起每星期二下午七時至八時。
學費：三十元

67

THEORY AND PRACTICE IN TRANSLATION OF CHINESE CLASSICS Mr. S.W. Li. Tuesdays 8.00 p.m. to 9.00 p.m., starting 15th October, 1968. Committee Room South, City Hall. 20 Meetings. Fee: \$50

翻譯之理論與實習

本課程本期二十講，每週一次。學理及實習平等講授，英譯漢及漢譯英併重。在實習時，英譯漢部份取材於英文小說，散文，戲劇，詩詞，現代名人傳記及時事論文等；漢譯英部份取材於先秦哲學散文，唐代短篇小說，宋代雜劇及歷代名人傳記等。
主講人：李聖五先生
講授語言：國英語
地點：香港大會堂南會議室
時間：一九六八年十月十五日起每星期二下午八時至九時
學費：五十元

History and Philosophy 歷史與哲學

THE BOOK OF CHANGES Mr. S.W. Li Mondays, 7.00 p m to 8 00 p m , starting 14th October, 1968. Committee Room South City Hall. 20 Meetings.

68

Fee: \$60

易經研究 (一)

易經爲中國之第一部書，亦未遭秦火之唯一原著，其內容包括宇宙論及人事論，儒道兩家之學術思想，均導源於此，且係最優美之古典文。

本課程定爲二十講，由八卦之形成及含義，至六十四卦之詳解及聯繫性，用以說明人生由生至死之全部變遷。所謂吉凶悔吝。絕非一般學說如宿命論等所可加以詮釋。凡遇凶化吉，居吉逢凶，倫理問題及自然問題等。卦、爻、象對之均有明確之指示。

主講人：李聖五先生

講授語言：國粵語

地點：香港大會堂南會議室

時間：一九六八年十月十四日起

每星期一下午七時至八時

學費：六十元

A HISTORY OF THE DEVELOPMENT OF CHINESE POETIC LITERATURE

Mr. C.L. Teng. Thursdays, 7.00 p.m. to 8.00 p.m., starting 3rd October, 1968. Extra-Mural Town Centre. 12 Meetings.

69

Fee: \$30

中國詩歌演變 (漢魏六朝三部)

自來談中國詩歌者，僅著重在一字一句之自我欣賞，而不及分析。文學史作者所論，亦僅爲一大堆資料之陳列，而於其中演變過程，則茫然無所知。陳陳相因，輾轉相授，而詩道乃愈趨晦暗。本課程乃特別著重於闡揚時代之流變，詩家之風格，及其相互間之影響關係，要在着眼於何以變與如何變。(共十二講)

主講人：鄧中龍先生

講授語言：粵語

地點：港大校外課程部市區中心

時間：一九六八年十月三日起每

星期四下午七時至八時。

學費：三十元

中國近百年史

本課程分十六講，由清道光間中英戰爭起講，中述太平天國、洋務運動、中法之役、甲午之役、戊戌政變、拳民之亂、辛亥革命、民國成立、軍閥割據，以至國民政府統一中國為止。其間政治演變之因果，西方文化之輸入，社會風俗之趨向，皆詳加說明，使明瞭中國近百年來之大勢。

主講人：黎傑先生

講授語言：粵語

地點：香港大會堂南演講廳

時間：一九六八年十月十四日起
每星期一下午七時至八時

學費：五十元

Reference should also be made to

- 125 MODERN CHINA AND THE TWO REVOLUTIONS (Page 51)
121 CHINA—ITS LAND AND PEOPLE (Page 50)
126 ECONOMIC DEVELOPMENT OF MAINLAND CHINA (Page 52)
177 UNDERSTANDING CHINESE CUSTOMS & TRADITIONS (Page 72)
179

藝術 Art

THEORY AND ART OF CHINESE CALLIGRAPHY Mr. K.H. Fung. Wed-
nesdays, 2.30 p.m. to 4.30 p.m., starting 2nd October, 1968. Extra Mural
Town Centre 16 Meetings. Fee: \$50

書法源流

本課程共十六講，每週一次，每次二小時，專為愛好研究中國書法者而設，理論與實習並重主要講題如下

- (一) 書法與文字之關係
- (二) 書法演變
- (三) 篆隸行楷之書法介紹
- (四) 執筆、運筆、結體。
- (五) 各體書法示範

時間：一九六八年十月二日起
星期三下午二時半至四時半。

主講人：馮康侯先生

講授語言：粵語

地點：香港大學校外課程部市區中心

學費：五十元

Economics Commerce Management

Staff Tutor in Charge: J.W. England (Nottm.) Telephone No. 458161 Ext 309

The courses in this section are aimed at all levels of industry, commerce and the public service. They are designed for two types of student:

- (a) Those who wish to prepare for professional examinations;
- (b) Those who wish to acquire skills and knowledge appropriate to their present responsibilities and future development.

Some courses are more advanced than others and require prior participation in basic courses for admission. In particular, students are advised not to enter for courses geared to examination requirements unless they already have a basic knowledge of the subject and fully intend to take the examination.

There will be other courses arranged during the year at the request of professional societies and industrial firms for which details cannot now be given. Suggestions or proposals for courses are welcome. The Department is always willing to consider arranging special courses for members of a particular firm or organisation or for a group of such bodies.

Economics

ECONOMICS FOR INTERMEDIATE EXAMINATIONS Mr. N.C. Owen,
B.A., M.Sc. (Econ.). *Tuesdays, 6-7 p.m., starting Oct. 1, 1958.* University
Main Building, H.K.U. 30 meetings. *Fee: \$100*

72

The fundamental concepts and tools of modern economic analysis will be discussed in detail. Topics to be considered include general principles governing production, distribution and consumption, theories of price, income and employment, money and banking, international trade, public finance and economic growth.

This course is specially designed for those who are preparing for professional examinations, such as C.I.S. and A.C.C.A.

-
- 73** **ECONOMICS FOR SCHOOL TEACHERS** Dr. John Wong, Ph.D. (Lond.); Lecturer, Dept. of Economics, H.K.U. *Thursdays, 7-8 p.m., starting Sept. 26, 1968.* Extra Mural Town Centre. 20 meetings. *Fee: \$70*

This course is intended for school teachers who will in the near future be teaching Economics and Public Affairs at 'A' level. It will be based upon the Economics syllabus (Paper I) for the Advanced Level Examination 1969. Basic concepts, essential economic institutions, and problems in international economics will be discussed. In addition, students will also be introduced to elements of economic reasoning, and the application of economic analysis to the economy of Hong Kong.

Teachers applying for the course who wish to have their fees refunded should submit an application (on a form obtainable from the Extra-Mural Department) to the Director of Education well in advance of the commencement of the course.

-
- 74** **HONG KONG'S MONETARY AND BANKING SYSTEM AND WORLD FINANCE** Mr. K.L. Ng, B.A. (H.K.); Statistician, Census & Statistics Department. *Tuesdays, 7.50-9.20 p.m., starting October 1, 1968.* Committee Room North, City Hall, 7th Floor, Hong Kong. 12 meetings.

Fee: \$65

This series of lectures is especially suitable for bank personnel. Topics to be considered include money supply, the Banking Ordinance, clearing house, inter-bank call, money market, foreign exchange market, exchange control, export credit insurance, structure of interest rates, sterling area and external financial relations, theory and practice of foreign exchange, rates of exchange, trade financing, international key currencies, international balance of payments, gold standard, I.M.F., the World Bank and regional monetary arrangements.

Reference should also be made to

128 ECONOMIC DEVELOPMENT OF MAINLAND CHINA (Page 52)

Accountancy

The courses in this section provide an opportunity for students to proceed from a beginners' class (General Accounting) to classes preparing them for the Intermediate and Final Examinations of the professional bodies. In addition, classes concerned with special problems are included, e.g. Managerial Accounting, Auditing, Costing, and Taxation.

-
- 75** **GENERAL ACCOUNTING** Mr. D.A. Glass, Chartered Accountant. *Wednesdays, 5.45-7.15 p.m., starting Oct. 16, 1968.* Extra Mural Town Centre. 20 meetings. *Fee: \$100*

Preparation of books of prime entry including day books, journals, cash books and ledgers, preparation of trial balance, profit & loss account and balance sheet of sole proprietors and partnerships will be explained. Detailed consideration of elementary book-keeping procedures and partnership and limited company accounting.

Suitable for those wanting a basic knowledge of book-keeping and of accountancy.

Recommended reading: *E.F. Castle: Practical Bookkeeping and Accounts: Advanced Stage, University Tutorial Press*

ACCOUNTANCY FOR INTERMEDIATE EXAMINATIONS Mr. G.J.M. McLeod, Member of Institute of Chartered Accountants, Member of Institute of Cost & Works Accountants. *Thursdays, 7-9 p.m., starting Oct. 17, 1968.* Extra Mural Town Centre. 15 two-hour sessions. *Fee: \$100*

76

This course is specifically designed for students who will soon be taking intermediate examinations of a professional body such as the C I S or A C C A , and it is *essential* that students should have completed the course on General Accounting or can satisfy the tutor that they have sufficient knowledge of basic accounting. For this purpose the tutor is willing to meet prospective students at the Extra Mural Town Centre from 7-7 30 p m on October 10th

The functions of accounting and the pattern of business accounts, trial balance, profit and loss account, balance sheet, accounts of sole traders, partnerships, and joint stock companies. Time will be spent working on examination questions.

Recommended reading: *E.F. Castle: Practical Bookkeeping and Accounts: Advanced Stage, University Tutorial Press.*

ACCOUNTANCY FOR FINAL EXAMINATIONS Mr. L. Howson, A.C.A., Chartered Accountant. *Tuesdays, 7-8 and 8.15-9.15 p.m., starting Oct. 1, 1968.* Extra Mural Town Centre. 20 two-hour sessions, once weekly *Fee: \$140*

77

The following topics will be covered—

Principles of advanced accountancy; amalgamations and reconstructions, liquidations and taxation in company accounts, consolidated accounts, capital structure of companies, sources of company finance; capitalization of profits; financial budgets & forecasting, the Companies Act 1948; investment accounts; interpretation and criticisms of accounts

Applications for this course must either have passed the Intermediate level or else in the opinion of the tutor have acquired sufficient knowledge of accountancy (e.g. by previous satisfactory attendance at appropriate accountancy courses)

COST ACCOUNTING Mr. Y.Y. Lam, A.A.C.C.A. *Tuesdays, 6.40-7.40 p.m., starting Oct. 1, 1968.* Committee Room North, City Hall, 7/F., Hong Kong. 24 meetings. *Fee: \$80*

78

The classification of cost accounts and of expenditure, costing for materials including stock control costing for wages including remuneration system, costing for overhead including treatment of indirect expenses, budgetary control and standard costing, and marginal costing will be discussed in detail. It is suitable for those wanting a basic knowledge of cost accounting. Enrolment will be limited to 30 students

AUDITING Mr. A.R. Hamilton, Chartered Accountant. *Wednesdays 7.30-9.00 p.m., starting Oct. 16, 1968.* Extra Mural Town Centre. 20 meetings. *Fee: \$100*

79

A comprehensive explanation of the principles and objects of auditing, the audit of cash transactions, the audit of trading transactions, the audit of outstanding assets and liabilities, the audit of limited company, and the liability of auditors will be discussed. The course is designed for those who want a basic knowledge of auditing, as well as those preparing for professional examinations.

- 80 ECONOMICS FOR ACCOUNTING STUDENTS** Mr. J.P. Lee, B.A., and Mr S.K. Chan, B.A. *Mondays, 8-10 p.m., starting Sept. 23, 1968.* Committee Room South, City Hall, 7/F, H.K. 12 two-hour sessions. *Fee: \$70*

The following topics will be covered:

Scope and method; theory of value; supply and demand; factors of production; national income, business cycle, money, banking and finance; Government intervention; international trade; gold standard and subsequent systems; monetary and economic institutions.

Suitable for those preparing for intermediate examinations.

Recommended reading. J.L. Hanson, *A Textbook of Economics*, published by MacDonal and Evans 20s.

- 81 STATISTICS FOR ACCOUNTING STUDENTS**
This course will commence in January 1969

- 82 MANAGERIAL ACCOUNTING** Mr. G.J.M. McLeod, Member of Institute of Chartered Accountants, Member of Institute of Cost & Works Accountants. *Thursdays, 5.45 to 6.45 p.m., starting Oct. 17, 1968.* Extra Mural Town Centre. 16 Meetings. *Fee: \$60*

Preparation, presentation and interpretation of financial and appropriate statistical information, both routine and special, for use by the Board and all levels of management for the purpose of planning and controlling will be discussed. The principles and operation of financial analysis used by management including those for budgeting, operation controlling inventories, assessing return on capital employed, evaluation of cash flows etc. will be explained.

Students should be either accountants responsible for preparing accounting data, budgets etc. for management interpretation, or executive staff who must make decisions from data supplied to them by the accounting section of the organisation.

- 83 TAXATION AND ACCOUNTING PROBLEMS** Mr. Lo Nai Wai, B.A. (H.K.) A.A.C.C.A. *Fridays, 5.45 p.m. — 6.45 p.m., starting October 4, 1968.* Extra Mural Town Centre. 20 Meetings. *Fee: \$65*

稅務與會計問題

本課程共廿講，研究本港稅務法例所課徵之物業稅，薪俸稅，利得稅，利息稅，個人入息稅，及與稅例有關各項問題。各問題之研討以適應學員之程度與興趣，酌予增刪。

主講人：盧乃惠先生

講授語言：粵語（術語講章，兼用英文）

地點：香港大學校外課程部市區中心。

時間：一九六八年十月四日起每星期五下午五時四十五分至六時四十五分

學費：六十五元

COMPANY SECRETARYSHIP Mr. J.K.S. Thong, F.C.I.S., F.A.C.C.A.
Fridays, 8.15-9.15 p.m., starting Sept. 27, 1968. Extra Mural Town Centre.
 24 meetings. **84**
Fee: \$80

The practical work of the company secretary with particular reference to internal administration, business management, and office organisation will be discussed in detail. It is suitable for all wanting a basic knowledge of secretarial practice, as well as those preparing for Final professional examinations.

ADVANCED SECRETARIAL PRACTICE Mr. J.K.S. Thong, F.C.I.S., F.A.C.C.A.
Thursdays, 8.15-9.15 p.m., starting Oct. 3, 1968. Extra Mural Town Centre.
 12 meetings. **85**
Fee: \$50

Topics will include the application of company legislation, with special reference to the procedure and administration of companies registered under the Company Act 1948, from their promotion to dissolution. The responsibilities and duties of the secretary and officers of a company and the practice involved will be explained in detail. It is suitable for executive staff as well as those preparing for professional examinations.

APPLIED JOURNALISM Mr. Yu-long Cheng. *Mondays, 7.00 p.m. to 8.00 p.m. starting September 23, 1968.* Extra Mural Town Centre. 12 meetings, **86**
Fee: \$40

應用新聞學

我們天天要看報，所以對於報紙的了解，是最有用的常識。應用新聞課程特爲此而設。本課程共十二講，內容包括報紙的起源，中國及香港報業簡史，新聞的來源，電訊、編輯、標題、採訪、判斷、副刊、廣告、新聞與法律等。本課程適合將從事新聞事業及已從事新聞工作的人士及所有各界閱報人士選讀。

主 講 人：鄭郁郎先生

講授語言：粵語

地 點：香港大學校外課程部市區中心

時 間：一九六八年九月廿三日起
 每星期一下午七時至八時

學 費：四十元

PUBLIC RELATIONS Mr. B. Wythe, Member of the Public Relations Institute of Australia; Eric White Associates. *Tuesdays, 5.40-6.40 p.m., starting Oct. 1, 1968.* U.S.I.S. Cultural Centre, Ice House Street, H.K. 10 meetings. **87**
Fee: \$35

The necessity for good public relations is becoming increasingly evident in Hong Kong and is vital to the well-being of the community. Its role as an aid to modern marketing, as a means of conveying ideas and policies, and in assisting companies and institutions in developing sound reputations and relationships will be discussed. There will be some examination of the techniques of public relations and the qualifications that help to make a successful public relations officer or consultant. No previous knowledge of the subject is assumed.

- 88** **PRINCIPLES OF HONG KONG TAXATION** Mr. J.K.S. Thong, F.C.I.S., F.A.C.C.A. *Fridays 7-8 p.m., starting Sept. 27, 1968.* Extra Mural Town Centre: 20 meetings. *Fee: \$65*

A comprehensive explanation will be given of the principles of assessing income liable to Hong Kong income tax. Particular attention will be paid to various departments of the Inland Revenue, including the powers and duties of the Board of Inland Revenue and the Board of Review.

- 89** **INVESTMENT** Mr. Francis C.Y. Chan, M.B.A. *Thursdays, 7.00 p.m. to 8.00 p.m., starting September 26, 1968.* Committee Room North, City Hall, 7th Floor 12 meetings. *Fee: \$40*

投資學

本課程共十二講，對有關投資的研究與處理之問題，有詳盡之討論。內容包括投資的目的，證券，互惠投資基金，參考資料之取得，購售手續，證券市場，有價證券之分析，時效問題，經紀人關係等。

主講人：陳暢餘碩士

(工商管理學)

講授語言：粵語

地點：香港大會堂八樓北會議室

時間：一九六八年九月廿六日起

學費：四十元 每星期四下午七時至八時

- 90** **PRACTICAL BANKING** Mr. T.Y. Chan, B.A. *Tuesdays, 7.00 p.m. to 8.00 p.m., starting October 1, 1968.* Extra Mural Town Centre. 12 meetings. *Fee: \$40*

銀行實務

本課程共十二講，適合擬求取基本銀行實務知識之一般人士。內容包括銀行意義，功能，管理及組織之普通討論。並充份研究銀行會計；出納部及營業部之工作過程；外匯；滙款；押滙；信用證等。

主講人：陳天元先生

講授語言：粵語(輔以英語)

地點：香港大學校外課程部市區中心

時間：一九六八年十月一日起每

學費：四十元 星期二下午七時至八時

These courses offer an introduction to some of the main management functions and techniques. They are conducted on a lecture-discussion basis and outside reading is encouraged. Although most of them are introductory they are of sufficient duration to be serious courses of study, and by careful planning a student can follow an integrated programme over a period of years.

BUSINESS MANAGEMENT I Dr. T.C. Lee, D.C.S. (New York). *Tuesdays, 7-8 p.m., starting October 1, 1968.* Extra-Mural Town Centre. 12 meetings. *Fee: \$40*

91

A compact introduction to the principles and techniques of management, which recognises the increasing interest of industry in scientific management. It should be of interest to persons working either in industry or commerce. Part I discusses basic concepts. Part II, which will be offered in the spring, emphasises techniques.

FACTORY OPERATION AND SCIENTIFIC MANAGEMENT Part I: *Factory Operation.* Mr. Wong Man-tun, M.A. (Econ.) *Tuesdays, 8.15 p.m., — 9.15 p.m., starting October 1, 1968.* Extra Mural Town Centre. 12 meetings. *Fee: \$40*

92

工廠建設與科學管理

本課程分兩階段進行教學，第一階段講「工廠建設」，研究如何投資建廠；第二階段講「科學管理」，研究如何在工廠建設完成後進行科學管理，以求不斷提高生產力和增加盈利。

本課程適合有志投資建廠及實際從事工廠管理之人士選讀。

(一) 工廠建設

本階段共十二講，主要研究工業在香港經濟結構中之地位，建廠計劃之編製，主要產品種類與生產規模之確定，廠區、廠址之選擇，廠址總體設計，車間（工場）設計等。本階段之部份內容且為下一階段學習之基礎。印發講課提綱。

主講人：王文敦碩士

講授語言：粵語（輔以英語）

地點：香港大學校外課程部市區中心

時間：一九六八年十月一日起每星期二下午八時十五分至九時十五分

學費：四十元

INDUSTRIAL RELATIONS WORKSHOP Mr. J.W. England, B.A.; Staff Tutor in Industrial Relations. *Thursdays, 6-7.30 p.m., starting October 17, 1968.* Government Training Division, 2nd Floor, Lee Gardens, Hysan Avenue, Hong Kong. 10 meetings. *Enrolment will be limited to 20 persons.* *Fee: \$40*

93

Intended for those actively engaged in industrial relations such as factory managers, Labour Department staff, trade union officials, and personnel managers. Not suitable for those who lack responsibility or whose experience is insufficient to enable them to relate theory to the circumstances and problems they face every day.

Topics include trade union functions; the tasks of management; collective bargaining; joint consultation; dispute procedures; labour legislation

94

MOTION & TIME STUDY Mr. Wong Man-tun, M.A. (Econ.) *Wednesdays, 8.00 — 9.00 p.m., starting October 2, 1968.* Lecture Room South, 8/F., City Hall. 14 meetings. *Fee: \$50*

工作研究 (動作與時間研究)
 本課程共十四講，主要探討如何在工業生產方面進行動作研究 Motion Study 與時間研究 Time Study 藉以消除工作中之多餘動作和費力動作，改善操作方法；消除無效時間，縮短生產週期；減少物力虛耗，降低生產成本；製訂時間定額，建立獎勵制度；不斷提高生產力，促進生產發展。

「工作研究」不僅對工業生產計劃管理，成本控制及獎勵制度之實施有重大意義，而且對任何其他方面工作之改進，提高工作效率，亦可獲得顯著成果。

本課程適合各行業工廠各級主管，技術人員，工作研究人員，以及其他興趣人士選讀。印發講課提綱。

主講人：王文敦碩士

講授語言：粵語

地點：香港大會堂九樓南演講廳

時間：一九六八年十月二日起
 每星期三下午八時至九時

學費：五十元

95

OFFICE PROCEDURES AND ORGANISATION Various Tutors will lecture. *Fridays, 7.00-8.30 p.m., starting October 11, 1968.* Extra-Mural Town Centre. 10 meetings. *Fee: \$50*

The principles and practice of good office management may and should be applied wherever there are offices; in industry, commerce and in government. In this course the office environment will be examined — the purpose of the office, office procedures, machines and equipment, the layout of the work place — and then an account will be given of Organisation and Methods. Suitable for office supervisors and managers.

96

MARKETING MANAGEMENT Dr. Francis K. Pan, D.C.S. (New York) *Tuesdays, 6.00-7.00 p.m., starting October 8, 1968.* Government Training Division, 2nd Floor Lee Gardens, Hysan Avenue, Hong Kong. 24 meetings. *Fee: \$80*

The theory and practice of marketing management will be dealt with in detail. Topics to be covered include scope and definition, consumers' acceptance, marketing organisation, market research, marketing channels, salesmanship, publicity and advertising, price policies, credit information, marketing management and socio-legal relationships. It is especially suitable for business executives interested in marketing and distribution.

97

PERSONNEL MANAGEMENT I Mr. Cecil C. Luk, M.B.A. (New York); A.M.B.I.M.; M.I.S.M. *Fridays, 5.45-6.45 p.m., starting Oct. 4, 1968.* Extra Mural Town Centre. 15 meetings. *Fee: \$50*

An appreciation of and insight into modern personnel management techniques will be given for those who are engaged in personnel or supervisory positions, or those who are being prepared for these responsibilities. Topics to be covered include personnel administration, supervision skills, training and performance appraisal and labour relations. Case Studies will be considered and ample time given for discussion. *A follow-up course will be offered in the Spring.*

COMPUTER APPLICATIONS IN BUSINESS AND MANAGEMENT
Dr. K.C.Y. Po, B.Sc., Ph.D. *Thursdays, 6.15-8.15 p.m., starting October 17, 1968.* Government Training Division, 2nd Floor, Lee Gardens, Hysan Avenue, Hong Kong. 17 meetings. *Fee: \$400*

98

The increasing use of computers in Hong Kong industry and commerce means that management must understand how they can be used to solve problems. In this practical course members will be required to submit a business problem for analysis, and will be shown how to programme the problem for the computer. Discussions will then be held on the results obtained from the computer.

The course is intended for those who have taken an introductory course on FORTRAN programming, who are experienced in industry or commerce, and who are interested in the practical use of computers for solving business problems. Seven 1-hour lectures and then ten 2-hour working seminars.

EXPORT DOCUMENTATION AND PROCEDURES Various Tutors will lecture. *Fridays, 5.45-6.45 p.m. starting September 27, 1968.* Extra-Mural Town Centre. 20 meetings. *Fee: \$70*

99

More than any other economy Hong Kong lives by its exports. To help businessmen with the many problems which arise in exporting, the Extra-Mural Department has brought together a team of lecturers from Government and commerce who will provide guidance on legal and technical difficulties. Special topics include: effects of tariffs and controls, documentation, insurance, transportation, finance, and overseas markets selection.

Hospital Administration

AN INTRODUCTION TO HOSPITAL ADMINISTRATION Mr. A.E. Starling, F.H.A., F.C.C.S., F.R.S.H., Senior Hospital Secretary. *Wednesdays, 6-7 p.m., starting Oct. 16, 1968.* Extra Mural Town Centre. 20 meetings, *Fee: \$65*

100

This course is designed for those who are connected with or who have some interest in Hospital Administration. It will, so far as is possible, follow the syllabus laid down for the Diploma of the Institute of Hospital Administrators and will cover the evolution of the modern general hospital; the basic principles of the National Health Service in the United Kingdom: hospital organisation; internal administration and the relationship of hospital departments one with another.

PRACTICAL ASPECTS OF HOSPITAL ADMINISTRATION Mr. A.E. Starling, F.H.A., F.C.C.S., F.R.S.H., Senior Hospital Secretary. *Wednesdays, 7.10-8.10 p.m., starting Oct. 16, 1968.* Extra Mural Town Centre. 20 meetings. *Fee: \$70*

101

Applicants for this course should indicate that they have completed the Introductory Course or hold senior posts in Hospital administrations. It is intended to study the practical aspects of hospital administration and students must be equipped to join in discussions on all aspects of hospital organisation, including supplies, development, financial administration, statistics, the staffing organisation of hospitals and the functions and duties of the principal officers. Students will be expected to prepare an essay on some aspect of the subject for discussion and analysis by other members of the class.

Chartered Institute of Secretaries - C.I.S.

The Department, by special agreement with the Chartered Institute of Secretaries, London, acts as local examiner for the four subjects in their Intermediate Examination, namely, Economic Theory, Accountancy, General Principles of English Law and English. This "Intermediate Sessional Examination" will be held in May each year. Successful candidates will then be recognised by the Chartered Institute of Secretaries, London, as having satisfied their Intermediate Examination requirements. However only registered students of the Chartered Institute of Secretaries who have enrolled for and attended 75% of each of the above four courses, organised by the Department of Extra-Mural Studies, are eligible to sit for it. The purpose of this agreement is to enable the course syllabuses and the examination papers to be more closely related to local conditions; the questions are set and examination papers are marked by the tutors who lecture on the subjects. Both the examination questions and the papers are sent to the Institute for moderation and approval of results.

INTERMEDIATE EXAMINATION

The following courses are offered:

- 72 Economics for Intermediate Examinations
- 117 English for Higher Commercial Studies
- 76 Accountancy for Intermediate Examinations
- 152 General Principles of English Law

FINAL EXAMINATION

The following courses are offered:

- 84 Company Secretaryship
- 77 Accountancy for Final Examinations
- 155 Company Law and Partnership

EDUCATION (see page 43 opposite)

Reference should also be made to

- 73 ECONOMICS FOR SCHOOL TEACHERS (Page 34)
- 157 'A'—LEVEL MATHEMATICS (Page 62)
- 158 MODERN MATHEMATICS FOR PARENTS I (Page 62)
- 167 CHILD PSYCHOLOGY—THE FIRST FIVE YEARS (Page 65)
- 106 MODERN TRENDS IN THE TEACHING OF GRAMMAR (Page 44)
- 108 ENGLISH TEACHING TECHNIQUES (Page 45)
- 168 EDUCATIONAL AND PSYCHOLOGICAL TESTS MEASUREMENT
(Page 65)
- 169 INTRODUCTION TO EDUCATIONAL PSYCHOLOGY (Page 66)

Education

Staff Tutor in Charge: Nana Tsao B.A., Dip. Ed. (H.K.) Telephone No. 458161 Ext. 306

PSYCHOLOGY FOR MODERN EDUCATION Prof. N.K. Henderson, 102
Ph.D (London); B.A., M.Ed. (Melb.); A.B.Ps.S.; F.C.P.; Professor of Education,
H.K.U. *Thursdays, 5.45-6.45 p.m., starting October 3, 1968.* University Main
Building, H.K.U. 12 meetings. *Fee: \$35*

Teachers at all levels in primary and secondary schools, and parents who want to help and understand their school-age children, will find this course most beneficial. It deals with psychological matters which are also the concern of youth club leaders, tutors, social workers, and all who are concerned with the education or social development of youth.

Topics to be discussed will be mainly those practical day to day problems that arise in the classroom e.g., dealing with individual pupils, discipline, how learning takes place, problems of remembering and forgetting, improving pupils' study habits and examination performance, how to discover and help backward and mentally handicapped pupils, emotional problems, and the desire to learn.

Lectures will be illustrated wherever possible. Ample time will be available for discussion.

RESEARCH METHODS IN EDUCATION & PSYCHOLOGY Prof. N.K. 103
Henderson, Ph.D. (London), B.A., M.Ed. (Melb.); A.B.Ps.S.; F.C.P.; Professor of
Education, H.K.U. *Wednesdays, 5.45-6.45 p.m., starting October 2, 1968.*
University Main Building, H.K.U. 20 meetings. *Fee: \$60*

An introduction to the main methods and results of modern educational and psychological research, as well as a non-mathematical introduction to statistical techniques and experimentation. Topics include the nature and problems of research, test construction methods, how to write a thesis or research report, studies of method, and results of some outstanding modern research studies in these fields.

The course is suitable for graduates (and near graduates) working for higher degrees and others interested in systematic research. It will also prepare M.A. (Ed.) candidates for their qualifying examination in Research Methods.

LIVING WITH PRE-SCHOOL CHILDREN Mrs. Grace Tsao, B.A. (Whit- 104
worth College, Wash.), M.A. (Teachers College, N.Y.), U.S.A. *Mondays, 10-11*
a.m., starting October 14, 1968. Extra-Mural Town Centre. 10 meetings.
Fee: \$30

How should we handle the "little devils" who are not old enough to go to school? Is there any guide to better our understanding and management of preschool children? Mrs. Tsao will discuss the development and characteristics of pre-school children, work and play; musical activities, story-telling and children's books, nature studies, parent & child relationships, discipline and pre-school education — (nursery & kindergarten).

TOWARDS BETTER SCHOOL MANAGEMENT A Course for School 105
Administrators, Principals and Senior Teachers. Commencing in January 1969.

Please note other courses of interest listed on page 42

English Studies

Staff Tutor in Charge: G. Mahood, M.A. (London) *Telephone No.* 458161 *Ext.* 304

The English programme is in four sections with classes suited to specific needs and interests. Section A is for teachers of English; B for all those learning and wishing to improve English as a second language; C for people wishing to develop their critical appreciation of written material, both of a general and a literary nature; D for those taking C.I.S. and similar examinations.

A. English for Teachers

- 106** MODERN TRENDS IN THE TEACHING OF GRAMMAR Mrs. Helen Kwok, B.A., Dip.Ed. (H.K.) Cert. Phon. For.St., Cert. Prof. Exp. Phon. (London) Mrs. Mimi Chan, M.A. (H.K.), M. Phil. (Lond.) *Wednesdays, 6-7 p.m., starting October 9, 1968.* University Main Building. 10 meetings. *Fee:* \$70

Modern developments in the field of Linguistics have provided teachers with new methods and techniques for grammar teaching. The course is an introduction to these developments from a practical point of view. Aspects to be dealt with include: word classes and function words; kinds of sentences, Immediate Constituent Analysis; Transformational Grammar; Comparative Linguistics (Chinese and English).

PRONUNCIATION CORRECTION AND SPEECH TRAINING Mr. Raymond Huang, M.A. (Leeds), I.P.A. Cert. Phon. (London), P.G.C. Ed. (London), I.R.A.M., L.T.C.L. (Lond.) *Fridays, 6-7 p.m., starting October 11, 1968.* University Main Building. 24 meetings. *Fee: \$75*

107

The course deals with common errors in English speech, common errors in Articulation, Intonation and Rhythm. The root causes of the difficulties encountered by Cantonese learners are analysed, methods of correction are suggested and graded aural-oral exercises are provided. *The tutor is Principal, Sir Robert Black College of Education Author of 'English Pronunciation Explained with Diagrams' & 'English Speech Training' and Co-author of 'Intonation in Idiomatic English'.*

ENGLISH TEACHING TECHNIQUES Mr. William Cheng, B.A., Dip.Ed. (H.K.U), Dip. in App. Ling. (Edin.) Education Officer. *Mondays, 6-7 p.m., starting October 14th, 1968.* University Main Building, H.K.U. 20 meetings. *Fee: \$70*

108

Planned to assist secondary school teachers of English this course will deal with up-to-date techniques applicable to the main areas of the curriculum. The basic problems of language teaching will be outlined and then dealt with in detail as follows -

- 1 Principles of limitation, arrangement and presentation
2. Reading. Intensive; English prose and poetry.
- 3 Vocabulary, dictation.
- 4 Composition: oral preparation, outlining and class discussion, marking.
- 5 Comprehension and precis writing.
6. The novel.

Recent developments in the teaching of grammar and syntax will be included

PRIOR ENROLMENT IS ESSENTIAL

Failure to enrol prior to the opening of a particular course, may mean the cancellation of that course. Prior enrolment is the only way the Department of Extra-Mural Studies has of judging the response to its courses. Your cooperation is therefore invited in sending your application forms to the Department as soon as possible.

B. English as a Second Language

A sound working mastery of the fundamentals of English is one of the greatest needs in Hong Kong life. To meet this, the Department, building on its experience of a wide variety of English teaching over recent years, has introduced a carefully integrated and intensive scheme. This programme — "Use of English" I and II — is designed to develop and improve skills in written and oral English for people such as clerks, secretaries, junior executives, post-secondary students, teachers and others whose work, e.g. in commerce, industry, government and teaching, requires a thorough command of basic English.

As with all Extra-Mural courses these are not intended for students in Secondary Schools.

The courses are examinable and those successfully completing Part II will qualify for a certificate in Advanced Use of English.

Details of entry requirements are given with the course particulars below. This is essentially a 2 year scheme with Part I leading by examination results to Part II. However, applicants wishing to enter Part II immediately can do so provided they satisfy the entry requirements (See "Use of English" II).

USE OF ENGLISH I

Classes will be held both in Hong Kong and Kowloon as follows:

- 109 HONG KONG:** A panel of University Graduates in English. *Tuesdays and Thursdays, 6-7.30 p.m., starting October 1, 1968.* University Main Building. 48 meetings, twice weekly. *Composite Fee:* (Tuition and Examination) \$215.

The aim of this course is to increase the Student's ability to handle the English language commencing with intensive oral work designed to eradicate faults in spoken English. This will be followed by drills of a remedial nature providing sound practice in the effective use of the language.

Entry Requirements:

Hong Kong English School Certificate or Hong Kong Chinese School Certificate pass in English. These should be of recent date. Preference will be given to those with a credit. Candidates are requested to enclose a photostat copy of the appropriate certificate along with their application form. Students will be allocated to classes according to qualifications to ensure the best teaching situation. There may be minor re-allocation after the first meeting with class tutors.

Parallel courses will be offered in Hong Kong and Kowloon and students should indicate their preference for location. This will be met if at all possible.

The number of classes offered is at the discretion of the Department, but every effort will be made to accommodate all those eligible.

Details of Syllabus:

A careful balance will be kept between spoken and written English, including essential revision of grammar and vocabulary-building. Use will be made of a wide range of selected reading material relevant to Hong Kong to develop powers of comprehension. More formal English practice will include precis, report and simple creative writing.

KOWLOON: A panel of University Graduates in English *Tuesdays and Thursdays, 6-7.30 p.m., starting October 1, 1968.* Wah Yan College Waterloo Rd., Kowloon. 48, meetings, twice weekly. *Composite Fee* (Tuition and Examination) \$215.

110

The course is examinable and intended to lead on to 'Use of English II'

USE OF ENGLISH II

Classes will be held both in Hong Kong and Kowloon as follows

111

HONG KONG: A panel of University Graduates in English *Mondays and Wednesdays, 6-7.30 p.m., starting October 2, 1968.* University Main Building. 48, meetings, twice weekly. *Composite Fee:* (Tuition and Examination) \$215

Entry Requirements:

Pass in terminal examination of "Use of English" I, Matriculation or recent G.C.E. O-Level English. There will also be selection by interview

Details of Syllabus:

The aim of the course is to improve the student's grasp of idiomatic English through exercises in advanced comprehension and interpretation. It will involve wide and careful reading, including books and cyclostyled material, of varied styles and content matter. This will develop the student's ability to read deeply and critically. Comprehension will be of two types: the writing of a precis after intensive study of a passage and the answering of brief questions after rapid reading of a prose passage on a general topic as training in quick assessment of essential points. The material used will include articles from newspapers or periodicals on social, political and economic themes. Essay work will involve writing explanations and reports on the basis of information supplied, the purpose of this being to expand the student's ability to write clearly and logically in a given set of circumstances familiar to him.

On completing the course students may sit the examination leading to the Certificate in Advanced Use of English.

KOWLOON: A panel of University Graduates in English *Mondays and Wednesdays, 6-7.30 p.m., starting October 2, 1968.* Wah Yan College, Waterloo Rd., Kowloon. 48, twice weekly. *Composite Fee:* (Tuition and Examination) \$215

112

On completing this course students may sit the examination leading to the Certificate in Advanced Use of English

English for Critical Appreciation C.

GROWING UP WITH BOOKS Mrs. P. Fitch. *Thursdays, 2-3 p.m., starting October 10, 1968.* Extra-Mural Town Centre. 8 meetings *Fee* \$30

113

A series of eight talks on children's literature mainly for the guidance of parents who wish to help and encourage their children's reading from the earliest years to adolescence

Mrs. Fitch, as Longman's representative for Penguin Books has an intimate knowledge of what books are available for various age groups of children

-
- 114 PRACTICAL THEATRE** Miss Christa Bergmann, B.A. (Berkeley, California).
Wednesdays, 8.15-9.45 p.m., starting October 9, 1968. University Main Building,
H.K.U. 10 meetings. *Enrolment will be limited to 20.* *Fee: \$50*

A course designed to be of practical use to all concerned with the production of plays, especially teachers responsible for school productions. Special attention will be paid to the various skills of acting, directing and staging a play. The class will work on scenes or short plays, following the various phases through from casting to curtain-calls. An additional session will be devoted to stage-setting, design and lighting.

-
- 115 SHORT STORY WORKSHOP** Miss M. Williams, B.A. (Wellesley College).
Tuesday, 7.30-9.00 p.m., starting October 8, 1968. Wah Yan College,
Kowloon. 10 meetings. *Fee: \$40*

The short story workshop is designed as a study of the art and craft of writing short stories. Each class period will be divided between a discussion of the work of a few major short story writers (e.g. De Maupassant, Chekhov, Hemingway, Joyce) and the writing and evaluation of short exercises, with the members of the workshop exchanging criticism among themselves. Work outside class will involve writing two short stories as well as five brief sketches during the term, and reading one short story each week.

-
- 116 READING AND DISCUSSION** Mr. John E. Clements, B.A. (Melbourne).
Tuesdays, 8-9.30 p.m., starting October 22, 1968. Extra-Mural Town Centre.
8 meetings. *Enrolment limited to 25 persons.* *Fee: \$30*

A further course principally for those in commerce and industry at middle management level designed to improve their fluency in English by reading and discussion of mainly "non-literary" material. A variety of styles of English writing will be presented by means of cyclostyled sheets — newspaper editorials, magazine articles and essays. These will cover a range of everyday, thought-provoking topics such as advertising, family-planning, social welfare. In addition to discussing these themes, students will be encouraged to write their considered opinions on particular issues. Thus a balance will be kept between oral discussion and written expression.

D English Studies for Commercial Use

- 117 ENGLISH FOR HIGHER COMMERCIAL STUDIES** To be announced.
Fridays, 6-8 p.m., starting October 4, 1968. University Main Building, H.K.U.
24, two-hour sessions, once weekly. *Fee: \$120*

A course specially designed for candidates preparing for the Chartered Institute of Secretaries Intermediate Examination but people taking other professional examinations may also find this course useful.

Preference will be given to students sitting professional examinations.

Geology and Geography

Staff Tutor in Charge: C.K. Leung B.A. (H.K.) *Telephone No.* 226529

The Geography and Geology programme is designed for both the professional and the layman. Teachers, for instance, will find useful refresher courses, such as that on Field Study Techniques. New arrivals and interested members of the public who want to know more about Hong Kong and China will find helpful introductory courses, such as that on Geography in the Field, while intending visitors and emigrants to Canada are recommended to a background course on that country.

AN INTRODUCTION TO FIELD STUDY TECHNIQUES Mr. Henry D. Talbot, B.Sc. (Lond.), Lecturer, Department of Geog. & Geol., University of Hong Kong. *Mondays 6-7 p.m., starting Oct. 14, 1968.* University Main Building, H.K.U. 10 meetings, once weekly, plus 5 Sunday excursions *Fee: \$45 (The course fee does not include expenses incurred on the excursions)*

118

For geography graduates who wish to further their knowledge of the techniques needed in investigating the landscape and other geographical phenomena at first-hand, as distinct from secondhand knowledge derived from maps, photographs and books

The course should be of particular interest to those teachers concerned with implementing the revised Advanced Level Syllabus in Geography and to those contemplating geographical research themselves

-
- 119** **GEOGRAPHY IN THE FIELD — (PHYSICAL)** Mr. Tam Sai Wing, B.A. (H.K.), Demonstrator, Dept. of Geography & Geology, H.K.U. *Tuesdays, 6-7 p.m., field trips on Saturdays Sundays, starting October 22, 1968.* University Main Building, H.K.U. 12 meetings. *Fee: \$40*

The course fee does not include expenses incurred on the excursions. *Enrolment is strictly limited to 30 persons.* Participants should be physically fit and capable of climbing and hiking.

The operation of physical processes on geological structure giving rise to special topographical features will be discussed in lectures and studied in detail during field trips. Methods of field investigation will be considered

There will be 6 indoor lectures and 6 field trips. Places to be visited include: Ma Sze Chau/Ping Chau, Deep Water Bay Road/Pokfulam Road, Castle Peak area, Yuen Long Plain, Lam Tsuen Valley, Rocky Harbour/Cheung Chau, Ma On Shan, Cha Ko Ling.

-
- 120** **GEOGRAPHY IN THE FIELD — (HUMAN)** Mr. Luke S.K. Wong, B.A. (H.K.), Research Asst., Centre for Asian Studies, H.K.U.

A series of 12 lectures and weekend field trips to parallel the course on physical geography. Similar requirements and limitations will apply. Commencing Spring 1969.

-
- 121** **CHINA — ITS LAND AND PEOPLE** Mr. C.K. Leung, B.A. (H.K.) *Thursdays, 3-4.30 p.m., starting Oct. 3, 1968.* Extra-Mural Town Centre. 10 meetings, Town Centre. *Fee: \$40*

An introductory course to the Geography of China. Topics to be discussed will include: its physical structure, climate, agriculture, industry, transport and population. It will be a useful background course for new comers to Hong Kong and for those who are interested in China. No prior knowledge of the subject is assumed.

-
- 122** **THE CANADIAN LANDSCAPE** Mr. Chow Wai-tong, B.A. (Hons.) Dip. Ed. (H.K.) F.R.G.S. and guest speakers. *Mondays, 5.45-6.45 p.m., starting Oct. 14, 1968.* Extra-Mural Town Centre. 8 meetings. *Fee: \$25*

An introductory course to Canadian landscape and life, designed for intending visitors, immigrants, and interested members of the public. The country's land, climate, economic activities, social and cultural life, education and research facilities will be discussed in detail. Lectures will be illustrated wherever possible.

History and International Affairs

Staff Tutor in Charge: Nana Tsao B.A., Dip. Ed. (H.K.) Telephone No. 458161 Ext 306

NATIONALISM IN SOUTHEAST ASIA Dr. L.R. Wright, A B (Middlebury), M.A. (New Hampshire), Ph.D. (London), Lecturer, Dept. of History, University of Hong Kong. **123**
Mondays, 7.15-8.15 p.m., starting October 14, 1968. Committee Room North, City Hall, 7/F., Hong Kong. 10 meetings. Fee: \$35

Nationalism in S E Asia has become a controversial subject to students of its recent history. The ideas of nationalism, the leadership of the nationalist movements and the problems of these emerging nations will be studied by examining the following topics

1. Ideas of nationalism with reference to the Indian 'model'
2. The response to European colonialism in Southeast Asia after 1900
3. Survey of nationalism in Burma, Malaya, Indonesia & Vietnam
4. *Social & economic scene of nationalism
5. Leadership of nationalist movements the role of the educated elite
6. The role of the people in the nationalist movement
7. Problems of nationalism in the emerging nation

BRITISH POLICIES IN SOUTHEAST ASIA 1800 onwards Commencing **124**
in January 1969.

MODERN CHINA AND THE TWO REVOLUTIONS The tutor will be announced. **125**
Wednesdays, 3-4 p.m., starting September 25, 1968. Extra-Mural Town Centre. 12 meetings. Fee: \$35

The Revolutions of 1911 and 1949 transformed a tradition-conscious China into a dynamic civilization. They brought to the fore conflicting ideas of nationalism and communism, democracy and totalitarianism. The decades prior to the Revolutions had seen the introduction of new political and ideological factors that came to dominate China. These provided the necessary stimulants for change and change she did. This series of lectures attempts to analyse in historical terms the reasons for this change

-
- 126 ECONOMIC DEVELOPMENT OF MAINLAND CHINA** Dr. John Wong, Ph.D. (Lond.), Lecturer, Dept. of Economics, H.K.U. *Tuesdays, 6-7.15 p.m., starting Sept 24, 1968.* University of Hong Kong Main Building. 15 meetings. *Fee: \$50*

Mainland China is going through one of the greatest economic and social upheavals of modern time. But the facts are difficult to discover. How reliable are the statistics? How have agriculture, trade and industry been re-organised? How successful has economic planning been? What are China's economic relations with the outside world? What are the problems which China faces on its forced march to economic development?

These are some of the questions and issues to be discussed in this course designed for all interested in modern China

-
- 127 HISTORY OF CHRISTIANITY IN CHINA** Rev. Canon S.K. Lee, B.A. (Hons.) (Lingnan), M.A. (Haverford). *Wednesdays, 5.45-6.45 p.m., starting October 16, 1968.* Extra-Mural Town Centre. 8 meetings. *Fee: \$25*

A general survey of the history of Christianity in China from the introduction of Nestorianism in the Tang Dynasty through the spread of Christianity under the Mongols, the achievements of the Jesuit Fathers (Ricci, Adam Schall) and the writings of early Chinese converts (Hsu Kuang-Ch'i, Li Chih-tsao) to the work of Protestant missionaries (Robert Morrison, Timothy Richard). Canon Lee will discuss the different periods of Christian missions against their cultural & literary milieu. The course will conclude with a study of the Chinese Church in the 20th century.

The Tutor was formerly Assistant Professor of History, Lingnan University, & is Lecturer in Church History, Union Theological College, Canon Theologian, Diocese of Hong Kong & Macao.

-
- 128 ANGKOR: ART AND CIVILIZATION** Mrs. Priscilla Tso, B.A., Dip. Ed. (HK), Dip. Ad. Ed. (Manch.), *Fridays, 3.00-4.30 p.m., starting October 25, 1968.* Extra-Mural Town Centre. 8 meetings. *Fee: \$20*

An illustrated course dealing with the history, art and culture of Cambodia between the 9th and 15th Centuries.

-
- 130 GREECE AND ROME** Dr. L.K. Young, B.A. (Birm.), M.A., D. Phil. (Oxon), Professor of History, University of Hong Kong. *Tuesdays, 7.00-8.00 p.m., starting October 15, 1968.* Lecture Room North, City Hall, 8/F., Hong Kong. 10 meetings. *Fee: \$35*

A survey of the history of early Greece and Rome, with an emphasis on the development of Graeco-Roman civilization to the 4th century A.D., This series of lectures has been designed as a refresher course for teachers, with some attention to recent interpretations and to the range of textbooks available in this subject.

Reference should also be made to

- 63 A VISION OF GREECE (Page 11)
70 CHINA IN THE LAST CENTURY (Page 32)
165 ATHENIAN, DAYS & NIGHTS (Page 64)

Languages

Staff Tutor in Charge: C.K. Leung B.A. H.K. Telephone No. 226529

All first year courses are designed for beginners.

All second year courses are designed for students who have satisfactorily completed a first year course or who can show that they have attained an equivalent standard. Final acceptance will be subject to interview by the tutor if necessary.

A good standard of English is required for admission.

MANDARIN I Mr. Shih Wan-chu, B.A.; Instructor in Language School, University of Hong Kong. *Mondays & Thursdays, 6-7 p.m., starting Oct. 10, 1968.* University Main Building, University of Hong Kong. 48 meetings, twice weekly.
Fee: \$200

131

The main emphasis will be on spoken Mandarin and ample opportunity will be given for practising pronunciation and short sentence construction orally.

Laboratory aid will be provided at Cantas House at an extra cost of \$20 for every 12 hours of study

Textbook: Beginning Chinese, by John De Francis, Yale University Press

MANDARIN II Mr. Shih Wan-chu, B.A., Instructor in Language School, University of Hong Kong. *Tuesdays, & Fridays, 6-7 p.m., starting Oct. 11, 1968.* University Main Building, University of Hong Kong. 40 meetings, twice weekly.
Fee: \$220

132

Enrolment is strictly limited to 40 persons.

Students who have completed Mandarin I or those who can prove that they have done a reasonable amount of Mandarin in the past are welcome to join to improve their ability to speak fluently. Some characters and idiomatic expressions will be introduced and students will be taught to read simple passages

Laboratory aid will be provided at Cantas House at an extra cost of \$20 for every 12 hours of study

Textbook Chinese Dialogues, Yale University, Mirror Series

-
- 133** CANTONESE I Mr. Paul Fong, B.A. Dip. Ed. (H.K.) *Mondays & Thursdays, 5:45-6:45 p.m., starting October 10, 1968.* Caritas House, 2-8 Caine Road, H.K. 48 meetings, twice weekly *Enrolment is strictly limited to 40 persons.*
Fee: \$200

Beginning with foundation work in Cantonese study, the course will aim at enabling students to understand and speak simple conversational Cantonese. Specially prepared texts covering grammatical usages and basic Chinese sentence structure will be supplied by the tutor.

Laboratory aid will be provided at an extra cost of \$20 for every 12 hours study.

-
- 134** CANTONESE II Mr. Paul Fong, B.A., Dip Ed. (H.K.) *Mondays & Thursdays, 7-8 p.m., starting October 10, 1968.* Caritas House, 2-8 Caine Road, H.K. 48 meetings, twice weekly. *Enrolment is strictly limited to 40 persons. Fee: \$220*

These lectures are intended for students who have completed Cantonese I or who can prove that they have had equivalent training in Cantonese. With the aim of developing thoroughly the students' conversational ability, the course will concentrate on the spoken language, expressions and idioms. Special prepared and graded texts will be supplied by the tutor.

Laboratory aid will be provided at an extra cost of \$20 for every 12 hours study.

-
- 135** CHINESE CHARACTERS Mr. Paul Fong, B.A., Dip. Ed. (H.K.) *Wednesdays 6-7 p.m., starting Oct. 16, 1968.* University Main Bldg., University of Hong Kong. 24 meetings. *Fee: \$120*

An adequate basic knowledge of Cantonese is assumed. The study of characters will include vocabulary, spoken and literary expressions and idioms, given in the form of simple prose passages. Etymology of Characters and classical reference of idioms will be touched on as the course progresses. Special effort will be made to give students practice in writing characters and to show the various ways of finding characters in Chinese dictionaries.

-
- 136** JAPANESE I Miss Ip Kock-hung, B.A. (CUHK); M.A. (Kyoto); Instructor, M.O.D. Chinese Language School. *Tuesdays & Fridays, 6:00-7:00 p.m., starting Oct. 8, 1968.* University Main Building, University of Hong Kong. 48 meetings, twice weekly *Fee: \$200*

The aim of this course is to provide beginners with a firm foundation in colloquial Japanese. Special notes will be prepared and supplied by the Tutor.

Textbook: Japanese Reader, by O. Vacari, (Maruzen)

-
- 137** JAPANESE II Miss Ip Kock-hung, B.A. (CUHK); M.A. (Kyoto); Instructor, M.O.D. Chinese Language School. *Tuesdays & Fridays, 7:10-8:10 p.m., starting Oct. 8, 1968.* University Main Building, University of Hong Kong. 48 meetings, twice weekly. *Fee: \$220*

Besides serving as an advanced course in colloquial Japanese, this course will include more common literary and colloquial expressions, simple grammatical exercises and Kanji. Special notes will be prepared and supplied by the Tutor.

Textbook: Japanese Reader, by O. Vaccari, (Maruzen)

(Students are advised to obtain either an English/Japanese or a Chinese/Japanese dictionary.)

SPANISH I Mr. Daniel Cavero, Licenciado, (St. Alphonsus College, Spain) **138**
Mondays, & Thursdays, 6-7 p.m., starting October 14, 1968. University Main Building, University of Hong Kong. 48 meetings, twice weekly. *Fee: \$200*

The main points of Spanish grammar will be tackled and exercises on these points in connection with the stories will be explained. Explanations are to be given in English and/or Cantonese when required.

Textbook: El Espanol Al Dia, Book One, by L.H. Turk & E.M. Allen, D.C. Heath & Co

SPANISH II Mr. Daniel Cavero, Licenciado, (St. Alphonsus College, Spain). **139**
Tuesdays & Fridays, 6-7 p.m., starting Oct. 18, 1968. University Main Building, University of Hong Kong. 48 meetings, twice weekly *Fee: \$220*

More detailed and advanced Spanish grammar will be studied along with application exercises. Students will be introduced to main features of Spanish-American life throughout the lessons, which will be given chiefly in Spanish. Ample time will be provided for oral drill.

Textbook: El Espanol Al Dia, Book Two, by L.H. Turk & E.M. Allen, D.C. Heath & Co

GERMAN I Dr. H. Baroness Von Hoyningen-Huene, Department of Modern Languages, University of Hong Kong. **140**
Mondays & Thursdays, 6-7 p.m. starting October 10, 1968. University Main Building, University of Hong Kong. 48 meetings, twice weekly. *Fee: \$200*

This beginners' course aims at giving a thorough grounding so as to enable students to read and speak simple German.

Text book: Deutsche Sprachlehre fur Auslander, by Schulz-Griesbach.

GERMAN II Dr. H. Baroness Von Hoyningen-Huene, Department of Modern Languages, University of Hong Kong. **141**
Mondays & Thursdays, 7.10-8.10 p.m., starting October 10, 1968. University Main Building, University of Hong Kong. 48 meetings, twice weekly. *Fee: 220*

This course aims at a further detailed study of German Grammar — such as style, syntax, tenses and precis writing. It will include practical exercises in conversation and newspaper-reading as well as the reading of prose passages by famous writers.

Text book: Deutsche Sprachlehre for Auslander. by Schulz-Griesbach.

ITALIAN I Dr. Giulio Costantini, LL.D. (Rome), **142**
Mondays & Thursdays, 6-7 p.m., starting Oct. 14, 1968. University Main Building, University of Hong Kong. 48 meetings, twice weekly. *Fee: \$200*

The beginners' course aims at giving a thorough grounding so as to enable students to read and speak simple Italian. The technique of language teaching in relation to the culture and literature of the country will be applied. Ample time will be provided for oral drill.

-
- 143** ITALIAN II : ITALIAN LITERATURE AND CULTURE Dr. Giulio Constantini, LL.D. (Rome.) *Mondays & Thursdays, 7.10-8.10 p.m., starting Oct. 21, 1968.* University Main Building, University of Hong Kong. 32, twice weekly. *Fee: \$160*

A second year course for students of Italian I or other beginners' course run by the Department and for those who have done some Italian. More advanced grammar, phrases and idioms will be studied, with oral and written exercises in reading, translation and composition. Materials are related to the history, architecture, literature, etc of Italy.

(In co-operation with the Italian Consulate General and the Italian Cultural Society Dante Alighieri.)

The Tutor is Head of Cultural Section, Italian Consulate General, formerly Professor of History of Western Culture in the Foreign Service Academy and the University of Indonesia.

-
- 144** FRENCH FOR BEGINNERS Mrs. Dominique McLachlan. *Wednesdays & Fridays, 6-7 p.m., starting Oct. 2, 1968.* University Main Building, University of Hong Kong. 48 meetings, twice weekly. *Fee: \$200*

Designed for students with no previous knowledge of the language, this course aims to give a thorough grounding in basic grammar and pronunciation so as to enable students to read and speak simple French.

Textbook: Living French by T.W. Knight

-
- 145** INTERMEDIATE FRENCH Mrs. Dominique McLachlan. *Wednesdays & Fridays, 7.10-8.10 p.m., starting Oct. 16, 1968.* University Main Building, University of Hong Kong. 48 meetings, twice weekly. *Fee: \$220*

This course is a continuation of the 1967/1968 Beginner's course and is designed to enable students to read and speak more advanced French. Attention will be paid to translation, composition, vocabulary and dictation.

Textbook: Living French by T.W. Knight (Chapter 15 to the end)

Daytime Courses

- 146** FOUNDATIONS IN CANTONESE Mr. Francis Sham, B.A., Language School, H.K.U. *Tuesdays & Fridays, 2-3 p.m., starting Oct. 11, 1968.* Extra-Mural Town Centre. 48 meetings, twice weekly. *Fee: \$200*

Enrolment is strictly limited to 40 persons.

With emphasis on the spoken language and the use of Chinese idioms, the students will be provided with a basic knowledge of pronunciation, tones, grammatical constructions, and a simple vocabulary for beginners. Ample time will be provided for oral practice. Supplementary notes and exercises will be supplied by the tutor.

Laboratory aid will be provided at Caritas House at an extra cost of \$20 for every 12 hours of study.

Text book: Cantonese Conversation Grammar, Book 1, by S.L. Wong.

CANTONESE II Mr. C.S. Hung, B.A. (Chinan), Instructor, Language School, H.K.U. *Mondays & Thursdays, 2-3 p.m., starting Oct. 10, 1968.* Extra-Mural Town Centre. 48 meetings, twice weekly. *Fee. \$220*

147

Enrolment is strictly limited to 40 persons.

An adequate basic knowledge of Cantonese is assumed. To equip students with the ability of speaking fluent Cantonese, more vocabulary, colloquial expressions, idioms and grammatical constructions will be taught. Apart from the text book, supplementary notes on conversational Cantonese as well as exercises will be supplied by the tutor. Ample time will be provided for oral practice.

Laboratory aid will be provided at Caritas House at an extra cost of \$20 for every 12 hours of study.

Textbook: Cantonese Conversation Grammar, Book II, by S.L. Wong

GERMAN I Dr. H. Baroness Von Hoyningen-Huene, Department of Modern Languages, University of Hong Kong. *Wednesdays & Fridays, 4-5 p.m., starting October 16, 1968.* Extra-Mural Town Centre. 48 meetings twice weekly. *Fee: \$200*

148

This beginners' course aims at giving a thorough grounding so as to enable students to read and speak simple German.

Textbook: Deutsche Sprachlehre for Auslander, by Schulz-Griesbach

FRENCH FOR BEGINNERS Mrs. F. Collin, M.A. (Montreal). *Mondays & Thursdays, 9.30 a.m. - 10.30 a.m. Starting Oct. 14, 1968.* Extra-Mural Town Centre. 48 meetings, twice weekly. *Fee: \$200*

149

Designed for students with no previous knowledge of the language, this course aims to give a thorough grounding in basic grammar and pronunciation so as to enable students to read and speak simple French.

Textbook: Living French by T.W. Knight

PRIOR ENROLMENT IS ESSENTIAL

The Department of Extra-Mural Studies would be grateful if intending students would send in their course application forms as soon as possible. Failure to do so may result in the cancellation of courses.

Law LL.B. London

Tutor in Charge: C.K. Leung B.A. (H K) *Telephone No* 226529

The courses in this section are designed to be of assistance to those preparing for the London University External LL.B. or for Solicitor or Bar Examinations, but those who intend to sit the various examinations should make their own arrangements for registration etc.

150 **LAW OF CONTRACT** Mr. T.J. Van Rees *Thursdays, 7-8 p.m., starting Oct. 10, 1968.* Extra-Mural Town Centre. 30 meetings. *Fee: \$100*

- (1) Formation of a valid contract: intention to create legal relations, offer and acceptance, consideration, capacity, form, misrepresentation, mistakes, duress, undue influence, illegality
- (2) Content interpretation of express terms, doctrine of the implied term, judicial and legislative control of exemption clauses.
- (3) Privity: rights, duties
- (4) Discharge: due performance, accord and satisfaction, varied performance, failure in performance — (a) frustration, (b) breach of contract.
- (5) Remedies for breach of contract damages, specific performance, injunction, Limitation of action.

Note: assignment, agency and quasi-contract are excluded.

CONSTITUTIONAL LAW Mr. Vincent Shepherd, LL.M. (London). Lecturer in Law. University of Hong Kong. *Mondays, 5.30-6.30 p.m., starting Oct. 14, 1968.* Extra-Mural Town Centre. 30 meetings. *Fee: \$100*

151

Books Recommended:

Wade & Philips "Constitutional Law" (7th Edition)

Kin & Lawson "Case Book in Constitutional Law" (1967 Edition)

The nature of constitutional law—sources and characteristics of English constitutional law—separation of powers — the supremacy of Parliament — constitutional conventions

Parliament, its meeting, composition, function, powers and procedure — control of national finance — parliamentary privilege.

The Executive — the monarchy — royal prerogative — The Privy Council — Cabinet government — the position of the Prime Minister — ministerial responsibility — the Crown and foreign relations.

The constitutional position of the Judiciary — administrative law in England — types of governmental powers — remedies against public authorities — the Crown in litigation — delegated legislation — the rule of law.

The British Commonwealth — the main forms of constitutional development and structure within the Commonwealth — relations of Commonwealth countries with the Crown and the United Kingdom — allegiance and citizenship in the Commonwealth — the Judicial Committee of the Privy Council.

GENERAL PRINCIPLES OF ENGLISH LAW Mr. Frank Addison, Senior Crown Counsel. *Thursdays, 5.45-6.45 p.m., starting Oct. 3, 1968.* Extra-Mural Town Centre. 30 meetings. *Fee: \$100*

152

This course covers the nature and sources of English Law, Common Law; equity and custom; the Judicature Acts; statute law; judicial precedent; legal persons and personal relations, real property and personal property; wills and intestacy; general principles of contract and torts

COMPANY LAW AND PARTNERSHIP Tutor to be announced. *Mondays, 8.15-9.15 p.m., starting Oct. 14, 1968.* Extra-Mural Town Centre. 30 meetings. *Fee: \$100*

153

The course will be divided into the following two parts:

Part One: Partnership — definition, formation, relations between parties, relations to third parties, liability of parties, dissolution.

Part Two: Company Law — formation memorandum and articles and alterations thereto, contracts and dealings with companies, share capital, allotment and transfer of shares, dividends, debentures, and directors and shareholders' meetings, private companies, winding up.

CRIMINAL LAW Mr. Winston Chu, LL.B., Solicitor. *Mondays, 7-8 p.m., starting Oct. 14, 1968.* Extra-Mural Town Centre. 30 meetings. *Fee: \$100*

154

This course covers the classification of crimes general principles of responsibility, general defences; offences against the person; offences against property, offences against public order and the administration of justice, highway offences, libel, bigamy

Librarianship

Staff Tutor in Charge: Priscilla Tso, B.A. Dip. Ed. (H.K.), Dip. Ad. Ed. (Manch.)
Telephone No. 458161 *Ext.* 303

The Intermediate Part I course, is designed for those wishing to take up Librarianship as their profession. The course of 11 months' duration, prepares candidates for the December 1969 United Kingdom Library Association Intermediate Part I examination.

Those who do not wish to take the professional examination but are working as Library Assistants or in school, children and government department libraries or are otherwise interested in the subject, are advised to take the certificate course for library assistants.

Library Association

- 155** LIBRARIANSHIP : Intermediate Part I Course. *Tuesdays & Fridays, 6-8.15 p.m., starting September 17, 1968. (ending approximately on Sept. 12, 1969 with 1 month's holiday in July).* University Main Building, University of Hong Kong. 76 Lectures twice weekly (2 hours each session), 9 sessions Practical Work (3 hours each). *Enrolment is limited to 20 persons.*

Tutors:

- Miss Colleen Cheung, B.A., Dip. Ed. (HK), A.L.A.,
Asst. Librarian, H.K.U. Library.
(Tutor-in-Charge).
- Miss L.B. Kan, B.Sc. (HK), M.A., M.L.S. (Calif.),
Sub-Librarian, H.K.U. Library.
(on leave after October)
- Mrs Euphine M. Chung, B.A., Dip. Ed. (HK), M.S.L.S.
(Col.), Asst. Librarian, H.K.U.
Library.
- Mrs. Lily H.S. Lee, B.A. (Nanyang), M.L.S. (Atlanta),
Asst. Librarian, H.K.U. Library.
- Mr. Timothy A. Chow, L.-Es-L (Aurora), Dip. Lib. (NSW),
Senior Librarian, Urban Council
Public Libraries.

A comprehensive course specially designed to prepare candidates for the United Kingdom Library Association Intermediate Part I Examination. The Examination can be taken in Hong Kong in June and December.

Students taking these courses now advertised are advised to sit for the Examination in December 1969.

Library Association Part I Examination:-

- Paper 1: The Library and the Community
Paper 2: Government and Control of Libraries
Paper 3: Organization of knowledge
Paper 4: Bibliographical control and service

Minimum qualifications: Hong Kong University Matriculation or its equivalent.

Certificate Course for Library Assistants

Mondays & Thursdays, 6-7 p.m., starting September 12, 1968. University Main Building, University of Hong Kong.

156

Tutors:-

- Miss Colleen Cheung, B.A., Dip Ed (HK), A.L.A.
Asst. Librarian, H.K.U. Library
(Tutor-in-Charge)
- Miss L.B. Kan, B.Sc. (HK), M.A., M.L.S. (Calif),
Sub-Librarian, H.K.U. Library,
(on leave after October)
- Mr. Bernard Kwan, B.A. (Laurentian), B.L.S. (Ottawa),
Asst. Librarian, H.K.U. Library
- Mrs. W. Steynberg, A.S.A.L.A.
Librarian, Fisheries Research Station
- Mrs. Frances M.H. Tong, B.Sc. (Shanghai), A.L.A.
Asst. Librarian, H.K.U. Library

The course consists of four sections:

- | | |
|--|------------|
| Part 1: Library Routines & Methods | |
| No. of Meetings: 38 | Fee: \$120 |
| Part 2: General Library Principles & Practice | |
| No. of Meetings: 14 | Fee \$ 45 |
| Part 3: Children's Libraries-including school libraries | |
| No. of Meetings: 10 | Fee. \$ 40 |
| Part 4: Practical Work & Visits to Libraries | |
| Time: April 1-3, 1969 and April 8-10, 1969. | |
| No. of Meetings: 6 morning and 2 afternoon sessions
of 3 hours each (excluding visits). | Fee \$110 |

The combined fee for the whole course is \$250

Enrolment is limited to 30 persons. Priority will be given to those working in libraries

The course is planned in co-operation with the Hong Kong Library Association and is designed to provide a non-professional training for Library Assistants and those working in children's libraries.

Examination Requirements:-

- (1) Hong Kong English School Leaving Certificate or Chinese School Leaving Certificate with Credit in English or its equivalent,
- (2) Hong Kong Library Association membership (tutors will assist students to apply for membership after the commencement of the course),
- (3) 75% attendance at lectures Practical work and visits are compulsory

Students are required to pay an examination fee

Date of Examination: June 14, 1969

If successful, candidates will be awarded a certificate issued jointly by the Hong Kong Library Association and the Department of Extra-Mural Studies

Applicants are advised not to take any other public examination in the same year

Mathematics

Staff Tutor in Charge: Priscilla Tso, B.A., Dip. Ed., (H.K.), Dip. Ad. Ed. (Manch.)
Telephone No. 458161 *Ext.* 308

-
- 157** 'A' — LEVEL MATHEMATICS Mr. Ko Lo Suen, M.A. (H.K.) Mr. Tsui See Ming, B.A., Dip. Ed. (H.K.), *Wednesdays, 7.30 — 9 00 p.m., starting October 9, 1968.* University Main Building, H.K.U. 20 meetings. *Fee: \$100*

The following topics, selected from the A-level Pure Mathematics syllabus, will be considered for the benefit of A-level teachers: Matrices, Algebraic Structures, Mappings

Teachers applying for the course who wish to have their fees refunded should submit an application (on a form obtainable from the Extra Mural Department) to the Director of Education well in advance of the commencement of the course.

-
- 158** MODERN MATHEMATICS FOR PARENTS I Mr. Tsui See Ming, B.A., Dip. Ed. (HK). *Wednesdays 5.45-6.45 p.m., starting September 25, 1968.* Wah Yan College, Kowloon. 15 meetings. *Fee: \$45*

The first of a series of three courses intended to introduce the basic principles of modern mathematics to parents and interested laymen. It will deal with topics taken from the syllabuses of lower forms in secondary schools.

-
- 159** MODERN MATHEMATICS FOR PARENTS I Mr. Tsui See Ming, B.A., Dip. Ed. (HK). *Thursdays, 5.45 - 6.45 p.m., starting September 26, 1968.* Extra-Mural Town Centre. 15 meetings. *Fee: \$45*

The first of a series of three courses intended to introduce the basic principles of modern mathematics to parents and interested laymen. It will deal with topics taken from the syllabuses of lower forms in secondary schools.

Music Philosophy

Staff Tutor in Charge: G. Mahood, M.A. (London) Telephone No 458161 Ext 304

Music

THE NATURE OF MUSIC Mr. P.E. Robinson, M.A. (Toronto) *Thursdays, 6-7.30 p.m., starting October 3, 1968.* Meeting place to be announced 12 meetings
Fee: \$40

160

This is a course designed for those with some experience in music who wish to increase their understanding. The lecturer will try to develop an awareness of the various levels of meaning in music by examining with the class, a wide variety of music from Gregorian Chant through Bach and Beethoven to Britten and Stockhausen.

Each session will consist of a lecture on one piece of music (e.g. Bartok's Music for Strings, Percussion and Celesta — 3rd movement) illustrated with recordings and piano and a discussion.

It is felt that those who have some training in music (ability to play an instrument and read a score would be an advantage) would benefit most from this course. To enable each student to participate more fully, registration will be limited.

Philosophy

FROM LOGIC TO SET THEORY Mr. Law Yip-wang, M.A. (Hawaii & NCLA) *Fridays, 8.00 p.m. to 9.00 p.m., starting October 4, 1968.* Extra Mural Town Centre. 12 Meetings.
Fee: \$35

161

從邏輯到集論
本課程共十二講，內容以現代邏輯為主，輔以初級集論，旨在介紹真值表方法，范恩圖解，語句邏輯及其證法，以及謂詞邏輯的一些基本概念，並由此以導出初級集論，故本課程可視為集論的預備知識。備有中文講義。

主講人：羅業宏碩士
講授語言：粵語

地點：香港大學校外課程部市區中心。

時間：一九六八年十月四日起每星期五下午八時至九時

學費：三十五元

-
- 162** **LAW AND MORALITY** Mr G H Mahood, M A (London), Fr. Peter Brady, S.J., M A. (Melb), Phil. L., S T L *Tuesdays, 8 15-9 15 p m, starting October 15 1968* Extra-Mural Town Centre 10 mee'ings *Fee \$30*

The conflict between the private sector of human conduct and the public has grown acutely with modern governments expanding their control over the individual's behaviour. How far should governments go in legislating for my life or yours and in what areas of living should they operate? To what extent are organised groups within society (e.g. churches, trade unions) entitled to oppose government action? Among topics to be analysed and discussed are freedom of speech and of demonstration, censorship, the divorce laws, racial legislation.

-
- 163** **SENTENTIAL LOGIC** Mr Law Yip-wang, M A (Hawaii & UCLA) *Fridays, 7-8 p m, starting October 4, 1968* Extra-Mural Town Centre 12 meetings *Fee \$30*

Taking the natural-deduction approach to an elementary portion of symbolic logic, i.e. sentential logic, the course aims at imparting a skill in proof construction techniques in translating informal arguments into logical symbolism, and thereby evaluating the correctness of those arguments. Topics to be discussed will include (1) symbolizing ordinary language, (2) construction and application of truth tables, (3) theorems in logic and methods of proving them, and (4) the use of punch cards in logical reasoning. Open to all beginners.

-
- 164** **THE NATURE OF POLITICAL DISAGREEMENT: LIBERAL DEMOCRACY AND COMMUNISM** Mr P E Robinson, M A (Toronto), Lecturer, Dept. of Philosophy & Psychology, University of Hong Kong *Thursdays, 8-9 p.m., starting October 10, 1968.* Committee Room North 7/F City Hall 10 meetings. *Fee \$35*

The background and theoretical content of opposing political ideologies in the modern world are worth looking at. It is not sufficiently realised that liberal democracy and communism have, despite the claims of propagandists, common areas of agreement. Clear thinking, rather than violence, could resolve many disputes.

Before dealing with contemporary political ideas Mr Robinson will deal briefly with the origins of liberal-democracy and of communism. Special attention will be given to the political thought of the under-developed countries, particularly on the question how far they can resist the existing ideologies by developing their own political ideas.

-
- 165** **ATHENIAN DAYS & NIGHTS** Mr. G H. Mahood, M A (London). *Thursdays, 11-12 a.m., starting October 24, 1968.* Extra-Mural Town Centre 6 meetings *Fee \$15*

The sub-title of these six talks centred on Athens in the 5th century B.C. could be "Socrates and his Circle", for this untiring talker and inquirer focuses the spirit of a city described by one of his contemporaries as "the School of Greece". In Socrates' encounters and conversations, beautifully recorded by his disciple Plato, we gain glimpses of perhaps the most creative place and period ever in Europe - the emergence of democracy, the fusion of classical myth with the new science in the plays of Euripides and Aristophanes, the birth of philosophy. Ever conscious of the spirit of place — he rarely left Athens — Socrates lived under the shadow of the Parthenon, Pericles' lasting monument to the heroic past and the glorious present. Socrates' career embodies the best of both.

Psychology

Staff Tutor in Charge: C.K. Leung B.A (HK) Telephone No 226529

INTRODUCTION TO PSYCHOLOGY Mr G Rochford, B.A. (Hons) (Hull),
Lecturer, Dept of Philosophy & Psychology, University of Hong Kong. *Tuesdays,*
7-8 p m starting Oct. 8, 1968. Extra-Mural Town Centre. 10 meetings
Fee \$30

166

The layman will be introduced to topics of interest in Psychology, including Memory Intelligence, Personality Testing, Psychotherapy and Psychoanalysis, Dreams, Telepathy Hypnosis and/or such other topics as the class may wish to hear about Ample time will be provided for discussion

CHILD PSYCHOLOGY — THE FIRST FIVE YEARS Mr. G. Rochford,
B.A. (Hons.) (Hull), Lecturer, Dept. of Philosophy and Psychology, University
of Hong Kong. Commencing February 1969.

167

EDUCATIONAL AND PSYCHOLOGICAL TESTS AND MEASUREMENTS
Dr. Tam Wai-hon, M.A.; Ed.D. (Calif.) U.S.I.S *Tuesdays, 6.45 p.m. to 7.45 p m,*
starting October 1, 1968. 12 Meetings. Fee: \$30

168

教育及心理測驗

教育及心理測驗與測量為近代從事教育工作者之不可缺少之知識與技能。本課程特將此兩類之測驗與測量作一種扼要的介紹，使對此等知識及技能有清楚的概念。全課程共十二講包括下列各要目：

一、教育心理測驗的重要 二、教育及心理測驗的分類 三、測驗之原理 四、測驗之構造 五、各科測驗 六、美國大學入學試之 *Sat Test* 及 *A.P.T.* 七、智力測驗 八、人格測驗 九、興趣測驗 十、態度測驗。

主講人：譚維漢博士

時間：一九六八年十月一日起每星期二下午六時四十五分至七時四十五分

地點：香港都爹利街八號二樓美國文化館

學費：三十元

169

INTRODUCTION TO EDUCATIONAL PSYCHOLOGY (I) Mr. C.K. Leong, M.A. (Ed.) (H.K.); Dip. Ed. Ps. (Q'ld.) *Thursdays, 5.45 p.m. to 6.45 p.m., starting October 3, 1968.* Extra Mural Town Centre. 12 Meetings. Fee: \$30

教育心理學概論(甲)

本課程共十二講每週一次，目的在增進學校行政人員，教師及家長對兒童及有關教學問題的認識。課程內容包括：

- (1) 刺激與反應
- (2) 動機
- (3) 學習的原則與方式
- (4) 學習與成長
- (5) 學習與羣性關係
- (6) 記憶、遺忘

本課程具有完整性，但亦可與一九六九年春季開課之「教育心理學概論(乙)」相銜接。

主講人：教育司署研究測驗輔導中心梁子勤先生

地點：香港大學校外課程部市區中心

時間：由一九六八年十月三日起

每星期四下午五時四十五分至六時四十五分

學費：三十元

170

INTRODUCTION TO EDUCATIONAL PSYCHOLOGY (II) Mr. C.K. Leong, B.A.; M.A. (Ed.) (H.K.), Dip. Ed. Ps. (Q'ld.). *Thursdays, 5.45 p.m. to 6.45 p.m. starting January 9, 1969.* Extra Mural Town Centre. 12 Meetings. Fee: \$35

教育心理學概論(乙)

本課程共十二講，每週一次，目的在增進學校行政人員教師及家長對教學一般問題的認識。課程內容包括：

- (1) 個別差異
- (2) 「智力」的概念及測驗
- (3) 學科測驗
- (4) 考核及分數的意義
- (5) 學校紀錄
- (6) 兒童指導

本課程具有完整性，但亦可與一九六八年九月開課之「教育心理學概論(甲)」相銜接。

主講人：教育司署研究測驗輔導中心梁子勤先生

地點：香港大學校外課程部市區中心

時間：一九六九年春季

學費：三十五元

Reference should also be made to

102 PSYCHOLOGY FOR MODERN EDUCATION (Page 43)

103 RESEARCH METHODS IN EDUCATION & PSYCHOLOGY (Page 43)

PRIOR ENROLMENT IS ESSENTIAL

Failure to enrol prior to the opening of a particular course, may, mean the cancellation of that course. Prior enrolment is the only way the Department of Extra-Mural Studies has of judging the response to its courses. Your co-operation is therefore invited in sending your application forms to the Department as soon as possible.

Technology and Science

Staff Tutor in Charge: Friscilla Tso, B.A., Dip. Ed. (H.K.), Dip. Ad. Ed. (Manch.)
Telephone No. 458161 Ext. 303

Botany and Biology

- 173 MAMMALS OF HONG KONG** Mr. Chung Ka Bun. *Thursdays 6.00 p.m. to 7.00 p.m., starting September 26, 1968.* University of Hong Kong Main Building. 8 Meetings. *Fee: \$20*

香港哺乳動物

本課程共八講，旨在介紹現存港島及新界區的各種野生哺乳動物；着重它們的數量，鑑別特徵，棲居環境和習性，彼此間生存的關係及有關捕捉，觀察和攝取照片的簡單技術。

本課程適合一般生物學教員及對自然歷史有興趣的人仕參加。

各講均附幻燈片說明，室內剝製標本的展覽及野外旅行觀察亦可據需要而籌備。

主講人：香港大學動物系助教鍾家彬先生

講授語言：粵語

地點：香港大學校本部

時間：一九六八年九月廿六日起
每星期四下午六時至七時

學費：二十元

- 174 HONG KONG BIRDS** Mr. M.A. Webster. B.A. (Camb.); M.B.O.U. *Tuesdays, 5.45-6.45 p.m., starting Oct. 15, 1968.* Extra-Mural Town Centre. 6-8 meetings. *Fee: \$30*

Among the various topics to be examined are Hong Kong's faunistic position in the western Pacific, habitat and identification, birds in Hong Kong, city birds, and conservation. Methods of faunistic study and classification will also be discussed.

Certificate Course in Computer Science

CERTIFICATED COURSE ON FUNDAMENTALS OF DIGITAL COMPUTERS *Wednesdays, 6.30-8.30 p.m., starting September 25, 1968.* Lecture Room & Laboratory of Department of Electrical Engineering, H.K.U. 50 lecture period; plus 12 laboratory instruction periods. Each period will be of 2 hours duration. *Fee: \$350*

12

Enrolment limited to 40 persons.

Tutors:

Mr. C.F. Ho, D.C.T. (Batt.), M.Sc. (Man), C Eng, M.I.E.R.E., Mem. I.E.E.E., Lecturer, Department of Electrical Engineering. (Tutor-in-Charge).

Mr. W. Szeto, B.Sc. (Tsing Hua).

Mr. W.N. Cheung, B.Sc. (Eng) (HK), M.Sc. (Eng) (London), Assistant Lecturer, Department of Electrical Engineering, University of Hong Kong

A course designed for graduates in Electrical Engineering or Physics who wish to enter the field of Digital Computers.

Outline syllabus:

- | | |
|--|-----------------------------------|
| 1. Introduction to Digital Computer System | 7. Computer Circuits |
| 2. Machine language Programming | 8. Counters and Shift Registers |
| 3. Number Systems | 9. Computer Timing and Control |
| 4. Codes | 10. Computer Arithmetic Operation |
| 5. Boolean Algebra | 11. Computer Memory |
| 6. Computer Logic Gates | 12. Input and Output Equipment |

Only applicants with a Bachelor's degree, or equivalent, in Physics or Electrical Engineering will be considered for admission.

Certificate Course in Television

CERTIFICATED COURSE ON TELEVISION ENGINEERING *Fridays, 6.30-8.30 p.m., starting September 27, 1968.* Lecture Room & Laboratory of Department of Electrical Engineering, H.K.U. 50 lecture periods plus 12 laboratory instruction periods. Each period will be of 2 hours duration. *Enrolment limited to 40 persons.* *Fee: \$350*

11

Tutors:

Mr. C.F. Ho, D.C.T. (Batt.), M.Sc. (Man), C Eng, M.I.E.R.E., Mem. I.E.E.E., Lecturer, Dept. of Electrical Engineering (Tutor-in-Charge).

Mr. J.T. Shih, B.Sc. (Eng) (Chen Kung), Mem. I.E.E.E., Project Engineer, TV Dept Sylvania (Far East) Ltd

Mr. W.N. Cheung, B.Sc. (Eng) (HK), M.Sc. (London), Asst Lecturer, Dept of Electrical Engineering, University of Hong Kong

Outline of Syllabus

- | | |
|--|----------------------------------|
| 1. Introduction to TV receiving system | 8. Picture tube circuits |
| 2. Tuner & R.F. Stages | 9. A.F. signal stages |
| 3. Video IF amplifiers | 10. Power Supplies |
| 4. Video detector | 11. Antenna & Transmission Lines |
| 5. Automatic gain control system | 12. Measurements and alignments |
| 6. Synchronization Separation | 13. Manufacturing techniques |
| 7. Vertical & horizontal Deflection circuits | |

This course is intended for graduates in Electrical Engineering or equivalent who wish to acquire a practical knowledge in television receiver design. Applications with a background knowledge of transistor operating principles will be given preference.

Certificate Course in Electronics

- 10** **CERTIFICATE COURSE IN APPLIED TRANSISTOR ELECTONICS** *Thursdays, 6.30-8.30 p.m., starting September 26, 1968.* Lecture Rooms & Laboratory of the Dept. of Electrical Engineering, H.K.U. 30 lecture periods plus 6 laboratory instruction periods. Each period will be of 2 hours duration.
Fee: \$200

Tutors:

Mr. C.F. Ho, B.C.T. (Batt), M.Sc. (Man), C. Eng., M.I.E.R.E., Mem.I.E.E.E., Lecturer, Dept of Electrical Engineering (Tutor-in-Charge)
Dr. J.T.H. Chang, B.S. (Col), Ph.D. (Cal) Lecturer, Dept of Physics
Mr. W.N. Cheung, B.Sc. (Eng) (H.K.), M.Sc. (Lond), Asst Lecturer, Dept of Electrical Engineering, University of Hong Kong
Mr W.K. Chan, B.Sc. (H.K.), Asst Lecturer, Dept of Electrical Engineering, University of Hong Kong.

Outline of Syllabus

1. General Network Theorems
 - a) Network Theorems and Analysis
 - b) Introduction to Matrix Algebra
2. Introduction to Semiconductor Physics
3. Circuit Models of Transistors
4. Transistor Biasing Techniques
5. Low Frequency Amplifier Analysis and Design
6. High Frequency Amplifier Analysis and Design
7. Feedback Oscillator Circuits
8. AM/FM Radio Receivers
9. High Input impedance Circuits
10. Regulated Power Supply
11. Switching Circuits
12. Electronic Counter

This course is designed for graduates or practising engineers in the electronics industry to familiarize them with the necessary basic and practical tools in Applied Transistor Electronics and will be offered on an annual basis.

-
- 13** **BASIC ELECTRONICS** *Tuesdays, 7-9.15 p.m., starting September 24, 1968.* Department of Electrical Engineering, H.K.U. 25 lecture periods plus 5 laboratory instruction periods. Each period will be of 2 hours duration. *Enrolment limited to 60 persons.* *Fee: \$180*

Tutors:

Mr. C.F. Ho, D.C.T. (Batt.), M.Sc. (Man.), C.Eng., M.I.E.R.E., Mem.I.E.E.E., Lecturer Dept. of Electrical Engineering. (Tutor-in-Charge).
Mr. W.N. Cheung, B.Sc. (Eng.) (HK), M.Sc. (Lond.), Asst. Lecturer, Dept. of Electrical Engineering, University of Hong Kong.
Mr. W.K. Chan, B.Sc., M. Sc. (HK). Asst. Lecturer, Dept. of Electrical Engineering.
Mr. R.Y.P. Ma, B.Sc. (Eng.) (Lond.), M.S. (B.M.E.E.) (Penn.), M.I.E.R.E., Mem.I.E.E.E. Electronic Engineer, Dept. of Electrical Engineering, University of Hong Kong.

The course will deal with the fundamentals of electricity; A.C. circuit analysis; valves, principles of electronic voltmeters, oscilloscopes and transducers; elementary digital measurement.

Applicants are expected to have A-level Physics or Mathematics, or equivalent, and a good knowledge of English.

Health Sciences

ASPECTS OF OCCUPATIONAL HEALTH Dr. J.W.B. Palmer. *Fridays, 5.45-6.45 p.m., starting December 6, 1968.* Extra-Mural Town Centre. 8 meetings. *Fee. \$30*

175

Aimed at managerial level and doctors engaged by factories and commercial establishments this course will examine the concept and measures of occupational health, especially in an urban setting such as in Hong Kong

Ample time will be provided for discussion and examination of specific problems of occupational health.

NUTRITION IN EVERDAY LIFE (II) Mrs. Jennie Lau Ng, B.Sc. (Toronto), Dip. Dietetics (Chicago). *Wednesdays, 5.45 p.m., to 6 45 p.m., starting October 9, 1968.* Extra Mural Town Centre. 8 Meetings. *Fee \$20*

176

本課程共八講，續講甲部未完之營養問題如嬰兒，兒童，發育青年，成人及老人日常營養之需要作詳細研究，並討論烹製過程對食物營養成份之影響。

主講人：劉少珊女士

講授語言：粵語

地點：香港大學校外課程部市區中心。

時間：一九六八年十月九日起每星期三下午五時四十五分至六時四十五分。

學費：二十元

日常營養學（乙部）

Sociology and Anthropology

Staff Tutor in Charge: C.K. Leung, B.A. (H.K.) Telephone No. 226529

-
- 177** UNDERSTANDING CHINESE CUSTOMS & TRADITIONS Dr. M. Topley, B.Sc. Econ. (Lond.); Ph.D. (Lond.) *Wednesdays, 6.15-7.15 p.m., starting Oct. 16, 1968.* British Council Library, Gloucester Building, H.K. 12 meetings. *Fee: \$40*

This series of lectures is designed for those who wish to learn something of the role of Chinese customs and traditional ways of thought in Hong Kong life today. It will discuss also changes in some of the traditional patterns of thought and behaviour. Topics to be included are Chinese family and marriage, child-rearing and the position of women, Chinese names, clan and ancestor worship; geomancy; Chinese traditional medicine; and religion and popular festivals

-
- 178** THE ROLE OF RELIGION IN CHINESE SOCIETY Dr. M. Topley, B.Sc. Econ. (Lond.); Ph.D. (Lond.) Commencing Spring, 1969.

-
- 179** UNDERSTANDING CHINESE CUSTOMS AND TRADITIONS Mrs. Nana Tsao, B.A. (H.K.); Dip. Ed. (H.K.); *Tuesdays, 2.45-4.00 p.m., starting Oct. 1st, 1968.* Extra-Mural Town Centre. 12 meetings. *Fee: \$40*

This series of lectures is designed for those who wish to learn something of Chinese life and culture, and will deal with traditional Chinese customs and ways of life existing in Hong Kong. Chinese family structure and kinship; position of women; wedding and burial ceremonies; ancestor worship; religions and the main festivals celebrated during the year; Chinese etiquette and common courtesy. The lectures will be illustrated with slides

Urban & Regional Planning

Staff Tutor: Jon A. Prescott, B. Arch. (Liv.); M.C.D.; A.R.I.B.A.; A.M.T.P.I.
Telephone No. 458161 Ext. 308 or 226613

Certain courses in this section will be of use to candidates for the examinations of the Town Planning Institute (London) as well as for others who are interested, including those whose professional work is in related fields.

Arrangements exist at the moment for those who wish to sit, in Hong Kong, for the examinations of the Town Planning Institute (London). Enquiry should be made to the Secretary of the Institute in London at least twelve months prior to the examination. (Full details are available from the Hon. Secretary of the Hong Kong Branch of the Town Planning Institute, P.O. Box 15299, Hong Kong.) *The present examination arrangements stand until 1970 only.*

The courses in Hong Kong Planning, Practice and Studio represent a co-ordinated series of lectures and studio sessions which will be directly applicable to our own situation and have been worked out for the guidance and training of junior Assistant Planning Officers and others who are either involved in the governmental planning organisation or who wish to increase their understanding of the planning process in Hong Kong. It is intended that this linked arrangement of lectures and studio continue in future sessions as required.

HONG KONG PLANNING PRACTICE Mr. E.G. Pryor, B.A., Dip. T.P., M.N.Z.T.P.I., Mr. A.F. Meyers, A.R.I.C.S., M.T.P.I. *Fridays, 5.45 p.m. to 6.45 p.m., starting 4th October, 1968. Extra-Mural Town Centre. 20 meetings.* *Fee: \$90*

180

Discussion will be centred on relevant Hong Kong planning issues, standards capable of adoption within Hong Kong's limitations of space and finance, the relationship of these practical attitudes to ideal conceptions (where applicable), planning flexibility and general requirements of statutory and departmental planning documents

Term 1 will cover relevant data in connection with rural planning problems and rural detail layout for differing purposes

Term 2 will cover the requirements in connection with new urban areas contiguous with present urban development

It is intended in *Term 3* (October 1969) to cover Urban Renewal or Redevelopment as distinct from new areas

-
- 181 HONG KONG PLANNING STUDIO** *Fridays, 6.00 p.m. to 9.00 p.m., starting 4th October, 1968. The studio will remain open for students until 10.00 p.m. Extra Mural Town Centre. 20 meetings.*
Fee. \$180 Combined fee with Course No. 180. \$250

Tutors:

Mr E G Pryor, B A, Dip T P, M N Z T P I
Mr A F Meyers, A R I C S, M T P I
Mr Donald Laio, B Arch, Dip LD (Dunelm),
Mr Colin Bramwell, Dip Arch (Dunelm), A R I B A.
Mr Jon A Prescott B Arch, M C D, A R I B A, A M T P I

Students will be divided into small groups for the purpose of the practical exercises in relation to the two main subjects of rural and new urban areas outlined under "Hong Kong Planning Practice" Survey data will be presented for analysis and design. Additional time will be required for site reconnaissance and survey checking work. The evolution of differing imaginative solutions will be made under practical guidance and the ideas presented in the form of para official type layouts with written statements and quantitative assessments in support

-
- 182 STUDIO: TESTIMONIES OF STUDY- TOWN PLANNING INSTITUTE** *Tuesdays, 8.00 p.m. to 10.00 p.m., starting 1st October, 1968. Extra-Mural Town Centre. 10 meetings, once weekly. The Studio will continue in Spring 1969.*
Fee: \$50

Tutors:

Mr Chau Chan-son, B Arch, M C D, A M T P I
Mr Brian Hadland, A R I B A, Dip T P (U C L), A M T P I
Mr J D Moir, B A, A M T P I
Mr Jon A Prescott, B Arch, M C D, A R I B A, A M T P I.

The examinations of the Town Planning Institute as presently constituted provide for Testimonies of Study and Drawn Analysis and Design papers to be submitted. The studio sessions will be organised as required by registered students to discuss the personal studies which are being prepared for Intermediate and Final examinations and to give guidance in the execution of the work.

During the sessions basic principles of communication of ideas by maps and diagrams will be discussed and guidance given in presentation and draughting techniques, emphasis being laid on Town Planning Institute requirements. Where possible two Tutors will be present on anyone evening.

-
- 183 PLANNING THEORY** Jon A. Prescott, B. Arch., M.C.D., A.R.I.B.A., A.M.T.P.I. Visiting tutors will be arranged from time to time. *Thursdays, 8.00 p.m. to 9.00 p.m., starting 7th November, 1968. Extra-Mural Town Centre. 10 meetings.*
Fee: \$50

These meetings should be of direct interest to those taking the Town Planning Institute (London) examinations.

Physical planning problems of contemporary society will be discussed using a mixture of lecturing and seminar technique. These meetings are intended for persons wishing for a deeper knowledge of present theories of the organisation of settlement. For example centripetal, linear and grid structures will be discussed as well as neighbourhood design, Christaller and central place theory, settlement hierarchy and the emergence of metropolitan phenomena and the idea of the city region. The outline of historical reasoning as expressed in British planning theory will be used as a background for the discussion of the Planning Advisory Group report and planning for growth and change in an evolving situation which is the hallmark of recent ideas

Traffic Engineering

TRAFFIC ENGINEERING *Tuesdays, 7.00 p.m. to 9.00 p.m., starting 8th October, 1968.* Government Training Unit, 2nd Floor, Lee Gardens, Hysan Avenue. 40 meetings. *Fee: \$200*

184

Director of Studies

Mr. S.A. Barden, B.Sc. Eng. (Hons) A.M.I.C.E., Officer in Charge of the Traffic & Transport Survey Unit

Tutors:

Mr. W.C. Bell, D.I.C., A.M.I.C.E., Chief Engineer, Traffic Engineering Division, Public Works Department

Mr. K.F. Nip, M.A., M.Sc., A.M.I.C.E., A.M. Inst. H.E.

Dr. J.J. Raftery, M.E., N.U.I., Ph. D. (Leeds) A.M.I.C.E.

Mr. C.R. Saunders, B.Sc., M.Sc., D.I.C., A.M.I.C.E.

Mr. K.E. Softly, A.M.I.C.E., A.M.I. Mun. E.

The Traffic Engineering Course is designed to give the fundamentals of traffic engineering and instruction ranges from consideration of vehicle operating characteristics, geometric design of roadways and intersection design (Hong Kong practice), traffic signals, control devices and aids, grade separation, parking and the problems of long range urban traffic planning and the use of the computer. The course is planned particularly for officers of the Public Works Department.

COURSES FOR REGISTERED STUDENTS OF THE TOWN PLANNING INSTITUTE

Coverage of parts of the Syllabus for the written examinations of the Town Planning Institute will be made from time to time as required by the registered student members. *Please contact the Staff Tutor in Planning for details.*

CONFERENCE ON CONSERVATION AND DEVELOPMENT OF THE COUNTRYSIDE

The date of this Conference, which was advertised in our last brochure has now been established as 15th to 22nd MARCH 1969.

The Conference will be sponsored by the University of Hong Kong and invitations to give Papers and to participate have been issued to various internationally and locally known persons. A very full programme of meetings to discuss prepared Papers has been arranged. The emphasis of the Conference will be on consideration of the impact of Urban growth on the Rural areas in view of the former's explosive space requirements. The increasing mobility of urban populations, their sheer numbers and recreational needs, and the requirements of modern industry, services and communications as well as an earnest consideration of the principles of true Conservation and the urban impact on the plant and animal life- and even topography will be discussed.

One aim, will be to make the various contending interests aware of the overall problems of co-users of rural land and to generally inform the public of the significance of the countryside to future living standards.

Hong Kong will be seen as a casebook in the context of south east Asian and world problems, as a summary of the problem, in a world where compromise between spatial and other needs of the human being and his effect on his surroundings scream for attention every day.

The programme, further information and registration forms are available from the Conference Secretary, Conference on Conservation and Development of the Countryside, University of Hong Kong.

SPECIAL TRAINING COURSES

The department welcomes enquiries and requests from business organizations, government, voluntary bodies or private institutions for specially designed training courses, whether pre-service, in-service or up-grading, to meet their specific training needs.

PUBLIC LECTURES

THE HONG KONG ECONOMIC SCENE III Lecture Room North, 8th Floor, City Hall, Hong Kong. *Tuesdays, 8.15-9.30 p.m.*

Tutor in Charge: J.W. England, B.A. (Nottm.) *Tel.* 458161 *Ext.* 309

The aim of this annual public lecture series is to present to the public an up-to-date background to current economic problems, and to introduce the underlying principles and policies which may influence or determine economic thinking and action in Hong Kong.

<i>October</i>	15th	The Role of Manufacturing Industry in the Economy	Dr. The Hon. S Y. Chung, O.B.E., Ph D. <i>Managing Director, Sonca Industries Ltd.</i>
<i>October</i>	22nd	A Policy for Small-Scale Industries	Prof. D. Dwyer, Ph.D. <i>Professor of Geography, Hong Kong University.</i>
<i>October</i>	29th	The Importance of Computers to Hong Kong	Mr. G.B. Thomson, <i>Data Processing Adviser, Hong Kong Government.</i>
<i>November</i>	11th	Industrial Relations in a Developing Economy	Mr. D.E. Goodwin, <i>Labour Adviser, Hong Kong Government.</i>
<i>November</i>	12th	Industrial Training - Problems and Policies	Mr. Ian Grant, I.L.O. <i>I.L.O. Adviser on Vocational Training.</i>
<i>November</i>	19th	Trade Promotion 1968	Mr. J. Cater, <i>Executive Director, Hong Kong Trade Development Council.</i>
<i>February</i>	2nd 1969	Central Banking - What is it?	Mr. Leo Cole <i>Commissioner of Banking</i>

PROFESSIONAL and VOCATIONAL COURSES

Page
Course

1224-48 ART & DESIGN CERTIFICATE COURSES

CHARTERED INSTITUTE OF SECRETARIES INTERMEDIATE EXAMINATION

33	72	Economics for Intermediate Examinations
59	152	General Principles of English Law
35	76	Accountancy for Intermediate Examinations
48	117	English for Higher Commercial Studies

CHARTERED INSTITUTE OF SECRETARIES FINAL EXAMINATION

37	84	Company Secretaryship
35	77	Accountancy for Final Examinations
59	153	Company Law and Partnership

CORPORATION OF SECRETARIES INTERMEDIATE EXAMINATION

35	76	Accountancy for Intermediate Examinations
33	72	Economics for Intermediate Examinations
48	117	English for Higher Commercial Studies
59	152	General Principles of English Law

CORPORATION OF SECRETARIES FINAL EXAMINATION

<i>Part I</i>		
33	72	Economics for Intermediate Examinations
37	84	Company Secretaryship
<i>Part II</i>		
35	76	Accountancy for Intermediate Examinations
59	153	Company Law and Partnership
<i>Part III</i>		
39	91	Business Management (Parts I & II)

INSTITUTE OF BANKERS

<i>Part I</i>		
48	117	English for Higher Commercial Studies
33	72	Economics for Intermediate Examinations
34	75	General Accounting
59	152	General Principles of English Law
<i>Part II</i>		
35	76	Accountancy for Intermediate Examinations
38	90	Practical Banking

Page	Course	
		ASSOCIATION OF CERTIFIED AND CORPORATE ACCOUNTANTS INTERMEDIATE EXAMINATION
		<i>Part I</i>
35	76	Accountancy for Intermediate Examinations
36	80	Economics for Accounting Students
35	78	Cost Accounting
		<i>Part II</i>
35	76	Accountancy for Intermediate Examinations
35	79	Auditing

		ASSOCIATION OF CERTIFIED AND CORPORATE ACCOUNTANTS FINAL EXAMINATION
		<i>Part I</i>
35	77	Accountancy for Final Examinations
59	153	Company Law and Partnership
39	91	Business Management (Parts I & II)
35	78	Cost Accounting
		<i>Part II</i>
35	77	Accountancy for Final Examinations
36	82	Managerial Accounting
35	79	Auditing

		ASSOCIATION OF INTERNATIONAL ACCOUNTANTS INTERMEDIATE EXAMINATION
		<i>Part I</i>
35	76	Accountancy for Intermediate Examinations
35	79	Auditing
		<i>Part II</i>
59	153	Company Law and Partnership
33	72	Economics for Intermediate Examinations

		ASSOCIATION OF INTERNATIONAL ACCOUNTANTS FINAL EXAMINATION
		<i>Part I</i>
35	77	Accountancy for Final Examinations
35	79	Auditing
		<i>Part II</i>
59	153	Company Law and Partnership
35	78	Cost Accounting

		AUSTRALIAN SOCIETY OF ACCOUNTANTS
		<i>Part I</i>
35	76	Accountancy for Intermediate Examinations
35	79	Auditing
		<i>Part II</i>
59	153	Company Law and Partnership
		<i>Part III</i>
35	77	Accountancy for Final Examinations
35	79	Auditing

ART, History of, I
 ART, History of, IIA
 ACCOUNTANCY, for Intermediate Examination
 ACCOUNTING, Cost
 ACCOUNTING, General
 ACCOUNTING, Managerial
 ACCOUNTANCY, for Final Examinations
 ADVERTISING, Studio I
 ADVERTISING, Studio IIA
 AESTHETICS, Introduction to
 ANGKOR, Art & Civilization
 ARCHAEOLOGY, An Introduction to
 ASIA Southeast British Policies 1800 onwards
 ATHENIAN, Days & Nights
 AUDITING
 BANKING, Practical
 BASIC VISION AND CONCEPTS OF PRESENTATION
 BUILDING CONTRACT, The New Form of
 BUILDING INDUSTRY, The — An Analysis
 BUILDING INDUSTRY IN HONG KONG: Symposium on Technical Documentation
 BUILDING, The, & Its Services — Fire Control
 CANADIAN LANDSCAPE
 CANTONESE, Foundations in
 CANTONESE I (evening)
 CANTONESE II (day)
 CANTONESE II (evening)
 CERAMICS I (day)
 CERAMICS I (evening)
 CERAMICS II (day)
 CERAMICS II (evening)
 CERAMICS IN THE CITY HALL MUSEUM
 CHANGES, The Book of
 PSYCHOLOGY, Child — The first five years
 CHINA — Its Land & People
 CHINA, in the Last Century
 CHINESE ARCHITECTURAL TRADITION, The
 CHINESE CALLIGRAPHY, Theory & Art of
 CHINESE CLASSICS, Theory & Practice in the Translation of
 CHINESE CHARACTERS
 CHINESE CUSTOMS & TRADITIONS, Understanding
 CHINESE CUSTOMS & TRADITIONS, Understanding (day)
 CHINESE PAINTING, Traditional: Theory & Techniques I
 CHINESE PAINTING, Traditional: Theory & Techniques II
 CHINESE POETRY, Appreciation of
 CHINESE POETIC LITERATURE, a History of
 CHINESE Societies, Role of Religion in
 CHRISTIANITY IN CHINA, History of
 CHU YUEN, an appreciation of the works of
 CHUAN — Tzu

INDEX TO COURSES

37 84 COMPANY SECRETARYSHIP
 59 153 COMPANY LAW & PARTNERSHIP
 20 31 COLOUR PRACTICE
 41 98 COMPUTER APPLICATIONS IN BUSINESS & MANAGEMENT
 69 12 COMPUTERS, Digital: Certificated Course on Fundamentals
 9 20 COMPUTER, Potentially of, for the Building Industry
 21 45 DESIGN, Introduction to Three Dimensional
 23 43 DESIGN, Interior Studio
 27 56 DESIGN, Pattern
 18 27 DRAWING BOARD TECHNIQUES I
 20 37 DRAWING BOARD TECHNIQUES II
 19 40 DRAWING, Life & Anatomy I
 20 29 DRAWING, Life & Anatomy IIA
 19 28 DRAWING & PAINTING, Free
 36 80 ECONOMICS FOR ACCOUNTING STUDENTS
 33 72 ECONOMICS FOR INTERMEDIATE EXAMINATIONS
 52 126 ECONOMIC DEVELOPMENT OF MAINLAND CHINA
 34 73 ECONOMICS FOR SCHOOL TEACHERS
 43 103 EDUCATION & PSYCHOLOGY, RESEARCH METHODS IN
 65 168 EDUCATIONAL & PSYCHOLOGICAL TESTS & MEASUREMENTS
 70 13 ELECTRONICS, Basic
 59 152 ENGLISH LAW, General Principles of
 45 108 ENGLISH TEACHING TECHNIQUES
 46 109 ENGLISH, Use of. I See also 110
 47 111 ENGLISH, Use of: II see also 112
 48 117 ENGLISH for higher Commercial Studies
 40 96 EXPORT DOCUMENTATION & PROCEDURES
 49 118 FIELD STUDY TECHNIQUES, an Introduction to
 18 25 FORM & COLOUR, Relationship of
 57 149 FRENCH FOR BEGINNERS (day)
 55 144 FRENCH FOR BEGINNERS
 56 145 FRENCH, Intermediate
 24 48 FURNISHING, Development of
 57 148 GERMAN I (day)
 55 140 GERMAN I (evening)
 55 141 GERMAN II (evening)
 50 119 GEOGRAPHY IN THE FIELD (PHYSICAL)
 50 120 GEOGRAPHY IN THE FIELD (HUMAN)
 11 63 GREECE, a Vision of
 52 130 GREECE AND ROME
 47 113 GROWING UP WITH BOOKS
 68 174 HONG KONG BIRDS
 68 173 HONG KONG, MAMMALS of
 34 74 HONG KONG'S MONETARY & BANKING SYSTEM AND WORLD FINANCE
 41 100 HOSPITAL ADMINISTRATION, Introduction to

41	101	HOSPITAL ADMINISTRATION, Practical Aspects of	40	94	MOTION & TIME STUDY
10	—	HOUSING MANAGEMENT Certificate Course	63	160	MUSIC, <i>The nature of</i>
26	53	IKEBANA I A STUDY OF BASIC PHILOSOPHY & PRACTICAL APPLICATION (day)	51	123	NATIONALISM IN SOUTHEAST ASIA
28	60	IKEBANA I A STUDY OF BASIC PHILOSOPHY & PRACTICAL APPLICATION (evening)	71	176	NUTRITION IN EVERYDAY LIFE (II)
28	61	IKEBANA IIA STUDY OF BASIC PHILOSOPHY & PRACTICAL APPLICATION (evening)	71	175	OCCUPATIONAL HEALTH, <i>Aspects of</i>
26	54	IKEBANA III A STUDY OF BASIC PHILOSOPHY & PRACTICAL APPLICATION	40	95	OFFICE PROCEDURES AND ORGANIZATION
39	93	INDUSTRIAL RELATIONS WORKSHOP	27	57	PAINTING I
23	43	INTERIOR DESIGN STUDIO	27	62	PAINTING, Watercolour
24	36	INTERIOR STUDIO IIA	21	33	PAINTING INQUIRY — A CONTINUING SEMINAR AND STUDIO
38	89	INVESTMENT	20	32	PAINTING STUDIO IIA
55	142	ITALIAN I	73	180	PLANNING PRACTICE Hong Kong
56	143	ITALIAN II — ITALIAN LITERATURE AND CULTURE	74	181	PLANNING STUDIO, Hong Kong
11	23	JAPAN Background to — The Arts and Architecture	74	183	PLANNING THEORY
54	136	JAPANESE I	64	164	POLITICAL DISAGREEMENT, <i>The Nature of Liberal Democracy & Communism</i>
54	137	JAPANESE II	23	35	PRINTING TECHNOLOGY IIA
37	86	JOURNALISM, Applied	65	166	PSYCHOLOGY, Introduction to
58	150	LAW OF CONTRACT	66	169	PSYCHOLOGY, Introduction to Education I
59	154	LAW, <i>Criminal</i>	66	170	PSYCHOLOGY, Introduction to Education II
59	151	LAW, Constitutional	43	102	PSYCHOLOGY FOR MODERN EDUCATION
64	162	LAW AND MORALITY	45	107	PRONUNCIATION CORRECTION AND SPEECH TRAINING
61	156	LIBRARY ASSISTANTS, Certificate Course for	37	87	PUBLIC RELATION
60	155	LIBRARIANSHIP — Intermediate Part I Course	48	116	READING AND DISCUSSION
43	104	LIVING WITH PRE-SCHOOL CHILDREN	37	85	SECRETARIAL PRACTICE, <i>Advanced</i>
64	163	LOGIC, Sentential	43	105	SCHOOL MANAGEMENT, TOWARD BETTER
63	161	LOGIC from Logic to Set Theory	48	115	SHORT STORY WORKSHOP
53	131	MANDARIN I	55	138	SPANISH I
53	132	MANDARIN II	55	139	SPANISH II
39	91	MANAGEMENT, Business I	8	17	STRUCTURES AND TECHNIQUES — FORM
24	38	MATERIALS, Nature of, and Detailing	36	81	STATISTICS FOR ACCOUNTING STUDENTS
39	92	MANAGEMENT, Factory Operation & Scientific — Part I Factory Operation	36	83	TAXATION AND ACCOUNTING PROBLEMS
41	99	MANAGEMENT, Marketing	38	88	TAXATION Principles of Hong Kong
40	97	MANAGEMENT, Personnel I	44	106	TEACHING GRAMMAR, <i>Modern Trends</i>
62	157	MATHEMATICS, "A" Level	48	114	THEATRE, <i>Practical</i>
62	158	MATHEMATICS, Modern for Parents I (Wednesday)	69	11	TELEVISION ENGINEERING, Certificate Course on
62	159	MATHEMATICS, Modern for Parents I (Thursday)	74	182	TOWN PLANNING INSTITUTE STUDENT Testimonials of Study
23	46	MIXED MEDIA & USE, DRAWING TECHNIQUES	75	184	TRAFFIC ENGINEERING
51	125	MODERN CHINA AND THE TWO REVOLUTIONS	70	10	TRANSISTOR ELECTRONICS Certificate course in applied
			19	39	VISUAL FORM, Grammar of
			73	—	URBAN & REGIONAL PLANNING



Extra Mural Studies 校外課程

Application for Enrolment 報名申請書

每一種課程請用別紙填寫

A

PLEASE USE A SEPARATE FORM FOR EACH COURSE

課程號碼
課程名稱
姓名

COURSE NO. FEE ENCLOSED \$
附學費
CASH/CHEQUE NO.

NAME in full (Mr./Mrs./Miss) English
英文
Chinese 中文
in block letters—surname first

前已讀其他校外
課程名稱

What Extra Mural Courses have you previously attended?

姓名

NAME IN FULL (Mr./Mrs./Miss) English
英文
Chinese 中文
in block letters—surname first

通訊處

ADDRESS for correspondence

辦事處地址

OFFICE ADDRESS

電話

TELEPHONE NOS. Home 住宅 Office 辦事處

國籍

NATIONALITY Age 年齡 (please tick age group)

職業

OCCUPATION

學歷

SCHOOL and highest class reached

大專學歷

HIGHER and/or FURTHER EDUCATION

18-19
20-29
30-39
40-49
50-59
over 60

DATE 日期

SIGNATURE 簽字

X

DATE REG. NO. COURSE NO. AMOUNT

X

DATE REG. NO. COURSE NO. AMOUNT

If you are applying by post and require an acknowledgment of your application, please complete this part

Note: This application acknowledgment is not complete without validation by official printing machine entry of the details at X above at the University or Town Centre office of the Department of Extra-Mural Studies, University of Hong Kong.

NAME

FULL POSTAL ADDRESS

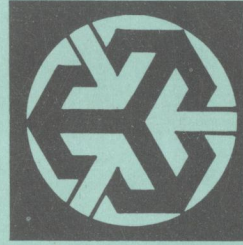

Fees are not refundable once the course has commenced.

Please see overleaf.

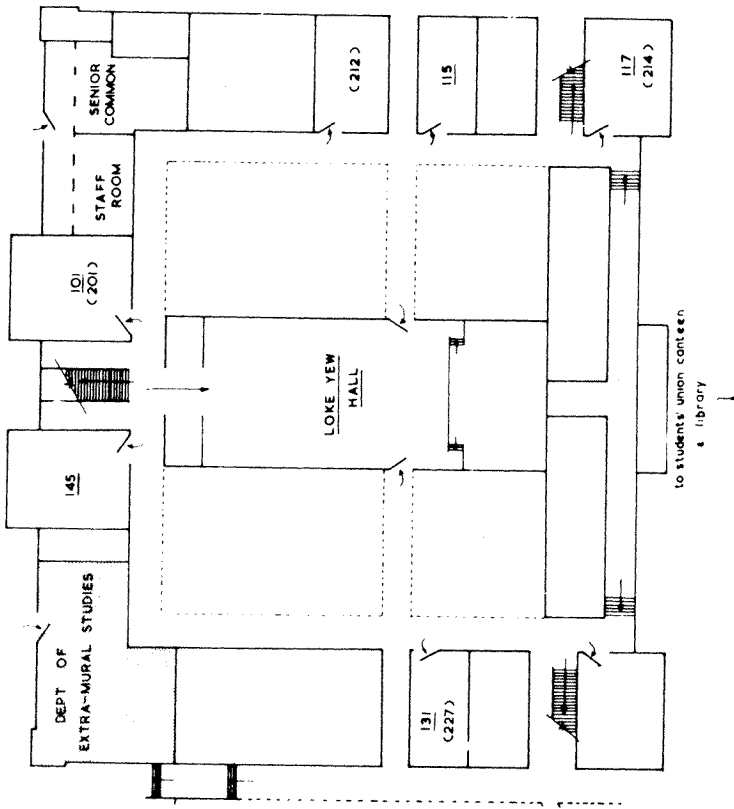

GROUND PLAN OF UNIVERSITY OF HONG KONG MAIN BUILDING
 Showing room locations used for Extra Mural Studies courses. Please see inside of front cover for University general layout.

香港大學校外課程手冊

一九六八至一九六九



University of Hong Kong



Extra Mural Studies

PROSPECTUS
1968 - 1969