

香港大學校外課程手冊

一九六八至一九六九

SPRING SUPPLEMENT

PROSPECTUS 1968 - 9



Extra Mural Studies

University of Hong Kong

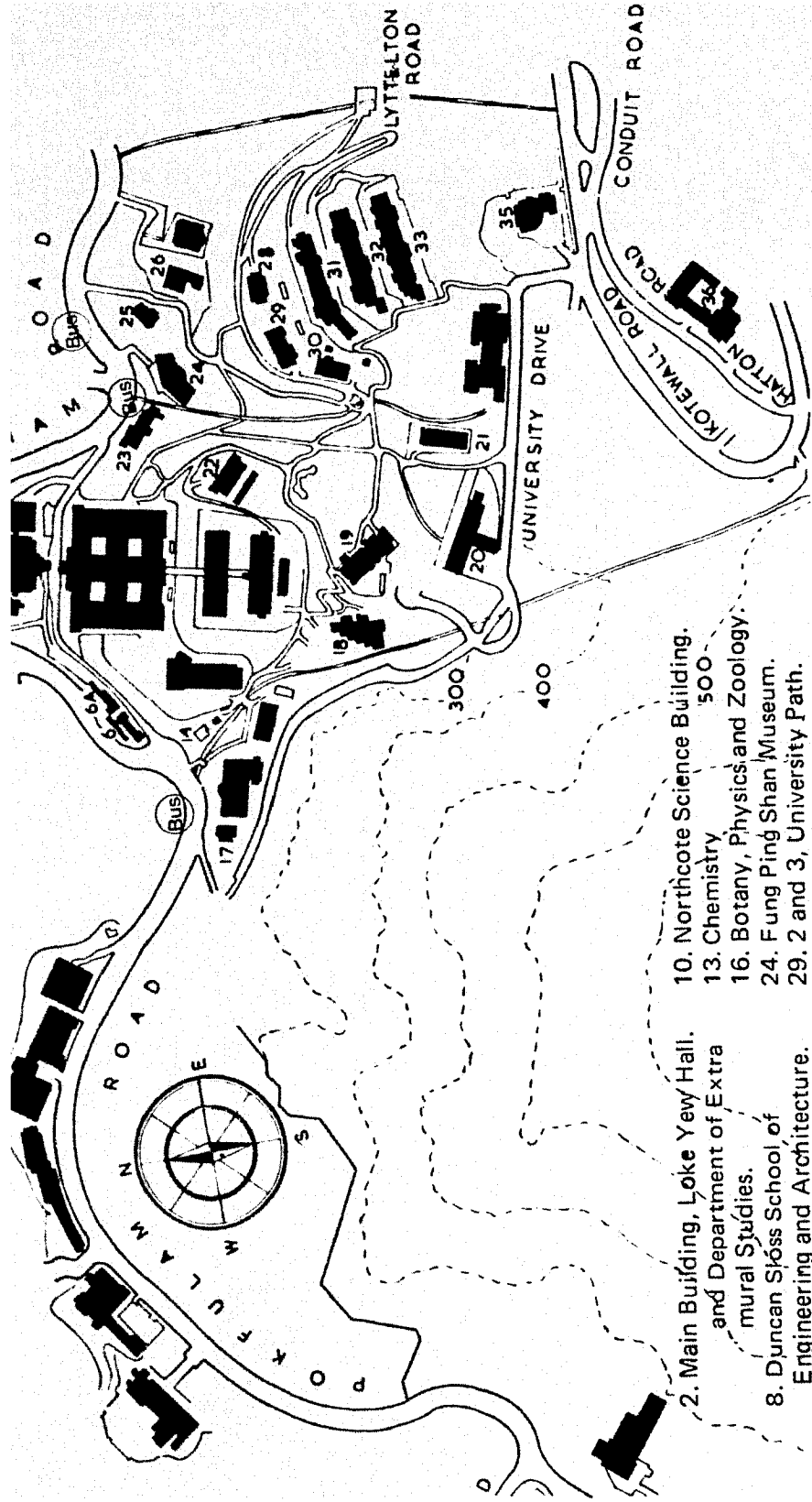

- 2. Main Building, Loke Yew Hall, and Department of Extra mural Studies.
- 8. Duncan Sloss School of Engineering and Architecture.
- 9. Peel Laboratory.
- 10. Northcote Science Building.
- 13. Chemistry 500
- 16. Botany, Physics and Zoology.
- 24. Fung Ping Shan Museum.
- 29. 2 and 3, University Path.

**UNIVERSITY OF HONG KONG GENERAL LAYOUT**

**University of Hong Kong**



---

**Extra Mural Studies**



**STAFF**

*Director*  
R.A. Williams, M.A. (Wales)

*Senior Lecturer*  
G.H. Mahood, M.A. (London) (*on  
secondment*)

*Assistant to the Director*  
(Mrs.) Priscilla Tso, B.A., Dip. Ed. (H.K.)  
Dip. Ad. Ed. (Manch.)

*Staff Tutors*  
(Mrs.) Nana Tsao, B.A. Dip. Ed. (H.K.)  
C.K. Leung B.A. (H.K.)  
Jon A. Prescott, B.Arch., M.C.D. (Liv),  
A.R.I.B.A., A.M.T.P.I.  
J.W. England, B.A. (Nottingham)

*Lecturers in Law*  
J. Rear. M.A. (Oxon); Barrister-at-law.  
V. Shepherd, LL.M. (London)

*Secretary*  
Mrs. Yvonne Wong

## **ACKNOWLEDGEMENTS**

We would like to record our grateful acknowledgement to the following individuals, schools and organizations for permission to use their premises:-  
*The British Council*  
*The Management of City Hall*  
*King's College*  
*The Goethe Institute*  
*Grantham College of Education*

## GENERAL INFORMATION

1. There are normally no entry requirements except that applicants should be over 18 years of age. Occasionally to have the full benefit of a course applicants must possess certain defined qualifications. Applicants are therefore, advised to read the description of a course carefully. Professional courses usually have clearly defined entry requirements.
2. The Director may at his discretion refuse to admit an applicant.
3. Unless otherwise arranged no Extra-Mural lectures will be held:-
  - a) on any public holidays.
  - b) at a storm warning signal of No. 5 or above.
  - c) during the following holiday periods:  
17th to 22nd February 1969 (Chinese New Year)
4. The course fee will cover the entire duration of a course or part of a course. Fees are not refundable once the course has commenced.
5. Certificates of Attendance are issued on payment of 50 cents, to those who have attended not less than two thirds of a course of at least 20 meetings duration.
6. Closing date for enrolment: *One week before the starting date of a course.* Late enrolments may not be accepted.
7. For enquiries, please ring either 468161- Ext 310 or 226529 during office hours
1. Complete the attached enrolment form and mail it to the Director, Department of Extra-Mural Studies, University of Hong Kong. Forms are also available on request.  
To ensure that a class can take place, the Department would appreciate early enrolment by applicants.
2. You should send your application form together with the appropriate fee either in the form of a postal order, money order or crossed cheque made out in favour of the UNIVERSITY OF HONG KONG
3. **YOU WILL BE NOTIFIED IF YOU ARE NOT ADMITTED BECAUSE OF OVER-SUBSCRIPTION OR OTHER REASONS. THE DEPARTMENT WILL NOT NOTIFY SUCCESSFUL APPLICANTS WHO ARE EXPECTED TO ATTEND THE FIRST MEETING OF THE CLASS AT THE PLACE AND TIME ADVERTISED.**
4. Applicants can also enrol in person at the following places:-
  - (i) Department of Extra-Mural Studies  
University of Hong Kong, University Main Building. Ground Floor Pokfulam Road. (during office hours) (Buses No. 3, 4, 7, 23) Tel: 468161 Ext 310.
  - (ii) Extra-Mural Town Centre, Universal House, 11th Floor, 151 Des Voeux Road Central, entrance from Gilman Street (next to Tamaya Dept. Store) Tel. 226529.

## HOW TO ENROL

## 入學須知

- 1 學員申請資格，除特別規定學年之課程外，其他課程，祇需要年齡超過十八歲者，不限資格，均可申請入學。學員應詳閱課程簡介。
- 2 學員被取錄與否概由校外課程部主任審核報名申請書後決定之。
- 3 除特殊情形外，本部在下列期間不授課。
  - 甲、本港公眾假期。
  - 乙、本港天文臺懸掛五號或以上風球之後。
  - 丙、農曆新年假期：一九六九年二月十七日至廿二日。
- 4 本手冊內之學費係指課程之全期學費。課程開始後，學費通常不能退回。
- 5 授課時間通常每講一小時。
- 6 凡課程在廿講以上而學員上課次數超過三分之二者，得向本部繳費五角後申請發給聽講證書。
- 7 學員應於開課一星期前報名，過期報名可能不被接受。又任何課程額滿後，即隨時截止報名，故學員應儘早報名。
- 8 本部詢問電話H-468161（內線310）或H-226529。

## 報名手續

- 1 填妥附於本手冊之報名申請書後，逕寄香港大學校外課程部主任收。申請書可隨時向本部索取。
- 2 繳費可用支票，銀行本票，或郵政滙票，抬頭「香港大學」隨同申請書逕寄港大校外課程部主任收。如用現金則請至本部繳納。
- 3 如申請人已獲取錄，本部不再通知，可依時上課。如未獲取錄，則另函通知。
- 4 申請人亦可親往下列地點報名。
  - 甲、薄扶林道香港大學校外課程部（辦公時間內）。
  - 乙、香港德輔道中一百五十一號環球大廈十二樓（入口在機利文街，玉屋百貨公司右側）校外課程部市區中心。

# Contents



<b>ARCHITECTURE &amp; BUILDING SCIENCE</b>	<b>6</b>
Building Science Practice & Management	
Appreciation	
<b>ART &amp; DESIGN</b>	<b>9</b>
Certificate Course in Art & Design	
Foundation Courses	
Practice	
Vocational Advertising Design	
Interior Design	
History and Appreciation	
Daytime Course	
Other Art Classes	
<b>CHINESE STUDIES</b>	<b>18</b>
Literature	
Religion & Customs	
<b>ECONOMICS COMMERCE MANAGEMENT</b>	<b>20</b>
<b>EDUCATION</b>	<b>23</b>
<b>ENGLISH STUDIES</b>	<b>24</b>
<b>GEOLOGY &amp; GEOGRAPHY</b>	<b>26</b>
<b>HISTORY &amp; INTERNATIONAL AFFAIRS</b>	<b>27</b>
<b>LANGUAGES</b>	<b>29</b>
<b>LAW LLB. LONDON</b>	<b>30</b>
<b>MATHEMATICS</b>	<b>31</b>
<b>MUSIC: PHILOSOPHY</b>	<b>32</b>
Music	
Philosophy	
<b>PSYCHOLOGY</b>	<b>34</b>
<b>URBAN &amp; REGIONAL PLANNING</b>	<b>35</b>
<b>PUBLIC LECTURES</b>	<b>36</b>

# Architecture and Building Science

*Staff Tutor in charge:* Jon. A Prescott, B. Arch.; M.C.D. (Liv.); A.R.I.B.A.; A.M.T.P.I.;  
*Telephone No.* 468161 Ext. 308 or 226613

These courses are of two types. Group A is aimed at professional persons, building developers and others involved in the building operation.

Group B is related to the appreciation and understanding of Architecture as a Fine Art.

## A Building Science, Practice and Management

"The Building and its Services" continues the series of courses begun last year. Each is complete in itself.

---

### 16 THE BUILDING AND ITS SERVICES—FIRE CONTROL

Tutors: G. Freeman, A.M.I.F.E.  
S.M. Elcock.  
T. Hood.  
R.A. Wheatley, A.M.I.F.E.  
Wong Wai-Tsoi, M.B.E., G.I.F.E.  
J.R.S. Pickett, M.A.S.E.E., A.A.S.H.R.A.E., M.I.T.E.  
T.D.C. Gardiner, M.I.F.E.

*Tuesdays, 5.45 p.m. to 6.45 p.m., starting 21 January, 1969.* Extra-Mural Town Centre, and Fire Prevention Training School, 323 Java Road, North Point, 10 meetings. *Fee: \$45*

A series of ten lectures on different aspects of the problem of Fire Control, each taken by an expert in the particular topic involved, followed by a terminal lecture period when all the Tutors will be in attendance to answer questions and when an extremely well made film "Setting Fires for Science" will be shown.

This discussion will cover legislation on means of escape, codes of practice, fire protection in building construction and prevention of spread of fire, legislation and details of fire service installations, building materials characteristics, ventilation and air conditioning special problems.

*Please note the two places of venue. The initial meeting will be at the Extra-Mural Town Centre when students will be given copies of the detailed time table.*

---



---

## SYMPOSIUM ON TECHNICAL DOCUMENTATION FOR THE BUILDING INDUSTRY IN HONG KONG

The symposium will take place either late in 1969 or early 1970. Persons interested in the research studies in progress are asked to contact the tutor in charge for further information.

---

## CERTIFICATE COURSE IN HOUSING MANAGEMENT

The Certificate course will commence in 1969. The course will be in two parts, Intermediate and Final and will involve instruction on at least two evenings per week plus a half day release requirement with employers.

The Syllabus has the approval of leading Managers of Real Estate, The Hong Kong Branch of the Institute of Housing Managers and several Government Departments.

*Full details are available by writing to the Director of Extra Mural Studies.*

*Applications for the 1969 course should be received before 1 May 1969.*

## Appreciation B

### BACKGROUND TO JAPAN

23

This series of courses has been arranged to provide a background for a planned Study Tour in Japan in 1970. It will coincide with the Osaka International Exposition 'Expo 70' which opens on the 15th March, 1970 and is the first world exposition to be held in Asia.

The Study Tour will concern itself with the man made environment and Arts and Architecture of Japan in the context of an emergent industrialised nation having powerful traditional ties, and will cover both these traditional elements and modern aspects of Japanese culture.

Lecture courses are planned to commence in January 1969 with basic studies of the historical outline up to the turn of the century and will allow a gradual build up of knowledge as indicated by the provisional programme given here.

### OUTLINE PROGRAMME OF STUDIES (subject to final confirmation)

#### Spring 1969

Pre-History: The Archaeology of Japan, Migration of peoples and early Anthropology Historical Outlines AD400-1912 Physical Geography and simple Geology, Regionalism, National Resources and Materials.

#### Autumn 1969

Traditional Architecture and Garden Design. The Supreme Craft of the Potter, Traditional Arts Painting and Sculpture. Religion: The Importance of Shinto, Zen and Buddhism generally, Noh Plays, Kabuki and Bunraku Theatre, Mythology & Literature.

23  
(cont.)

Spring 1970

Historical Outline: The Emergence of a New Nation 1900-1970  
Architecture: Modern Design of World Significance. Urban &  
Regional Planning Problems and Work Studies. Contemporary  
Trends in Fine and Applied Arts. Economic and Industrial and  
Commercial Organisation.

Participants wishing to take a Japanese language course at an elementary level and with emphasis on conversational everyday phrases will find a suitable course under languages during the Autumn and Spring Terms 1969-1970.

Full details of the arrangements for the Study Tour will be given in the 1969-70 main brochure published in August 1969.

Arrangements are being planned for a larger group to spend approximately one week in Osaka or Kyoto within easy access of the Exposition, yet close to the historic traditional centres of culture of Kyoto and Nara; whilst a smaller group who wish to stay longer may spend a further period in a more extensive study of the country.

*The lecture programme will be augmented from time to time both by additional items and an extensive programme of films commencing in Autumn 1969.*

The programme is presented with the co-operation of the Japan Cultural Centre.

---

23A

**I PRE-HISTORY OF JAPAN AND** Hiroaki Kani, M.A., Keio University, Japan  
**II HISTORICAL OUTLINES AD400 to 1912** W.E. Cheong, B.A., Ph.D. (London)  
*Mondays, 6.00 p.m. to 7.00 p.m., starting 20th January, 1969. 15 sessions,*  
Extra-Mural Town Centre. Fee: \$65 (Part I taken separately \$15, Part II taken  
separately \$55)

Part I will form a short introductory course of three lectures giving an outline of the archeology of Japan, early migration patterns, neolithic Jomon and Yayoi cultures and the mythology and folklore of the Nihongi.

Part II will build on this foundation and follow the history of the Japanese nation from the first recorded history of AD 400 to the beginning of this century. Mr. Kani is seconded from Keio University at Chung Chi College, Chinese University of Hong Kong and Mr. Cheong is lecturer in History in the University of Hong Kong.

These lectures will be followed in January 1970 by an analysis of the emergence of the modern nation as we know it today.

---

23B

**PHYSICAL GEOGRAPHY, REGIONAL PATTERNS & RESOURCES OF JAPAN**

C.K. Leung, B.A. (H.K.) additional tutors will lecture from time to time, *Mondays, 7.00 p.m. to 8.00 p.m., starting 17th March 1969.* Extra-Mural Town Centre,  
10 sessions. *Fee: \$45*

A series of background lectures ranging from the Geology, morphology and climatic variations within the country, its natural regions and resources and the settlement patterns, both traditionally and in association with the distribution of industrial development.

These lectures will provide a background for later discussion of planning problems and the economic and industrial development of modern Japan.

---

# Art and Design

*Staff Tutor in Charge:* Jon A Prescott, B. Arch (Liv.); M.C.D., A.R.I.B.A., A.M.P.T.I.  
*Telephone No.* 468161 Ext. 308 or 226613

Instruction in Art and Design is planned for the needs of the bona fide student who wishes to follow the three year programme leading to a Certificate in Fine Art, Advertising Design or Interior Design on a part-time basis.

Many courses are open to other than certificate students and day time courses are provided for those wishing to pursue art studies for personal pleasure or discovery.

Owing to limitations of space in the studios of the Town Centre and in the interests of good teaching the numbers accepted for courses primarily planned for certificate students will be restricted to the numbers mentioned with each course and priority will be given to certificate students over those wishing to attend only single courses.

## PRE-CERTIFICATE TRAINING

All students wishing to enter upon certificate courses have normally to take the pre-certificate training first.

The next opportunity for entry to such courses will be in Autumn 1969.

*Full particulars are available from the Director of Studies.*

## Certificate Courses in Art and Design

### *Advisory Panel*

MICHAEL F. GRIFFITH, A.T.D.  
KWOK CHIU LEUNG, DIP. A.D.  
KWONG YIU TING, M.A. (KANSAS)  
HENRY STEINER, M.F.A. (YALE)  
JOHN WARNER, A.T.D., N.T.D.

### *Director of Studies*

Jon A. Prescott, B. Arch., M.C.D., A.R.I.B.A., A.M.T.P.I.

### *Course Tutors*

Ruth Addison, Dipl. Arch., A.R.I.B.A.	Hon Chi-Fun
R.K. Cheng, B.A. (Econ) St. John's Tech. Cert. Printing C & G London.	Kwok Chiu Leung, Dipl. A.D.
David W. Crowe, Dipl. Arch. (Liv.), A.R.I.B.A.	Kwong Yiu Ting, M.A. (Kansas)
Ming Gi Fay M.F.A. (California)	Julian A. Losinski, M.S.I.A., N.D.D., Dip. A.D.
S.C. Fung B. Arch (Liv.)	P.W. Printer, N.D.D., M.S.I.A.
Michael F. Griffith, A.T.D.	Paul Selinger, M.F.A. (San Francisco Art Institute)
Cesar Guillen-Nunes, B.A. (Hons), Courtauld Institute of Art, University of London	Henry Steiner, M.F.A. (Yale)
Albert H. Hill, I.A. Dip.	Wucius C.K. Wong, M.F.A. (Maryland)
Tao Ho, B.A. (Williams), B. Arch. (Harvard)	Additional tutors will be appointed as required.

After completion of the Pre-Certificate Study the student will select one out of the three present streams of Fine Art, Advertising Design or Interior Design, and will take the lecture series and studio sessions which have been grouped so as to provide a scheme of systematic study leading, over three years, to the Certificate in Art and Design.

*The Course fee for terms of 15 weeks will be \$250*

Fees are to be paid in advance. Registration will be accepted for a WHOLE YEAR only. *Examination fees are extra.*

**PRESCRIBED COURSES FOR CERTIFICATE STUDENTS**  
**YEAR ONE TERM 2** *January to April, 1969*

**FINE ART**

- |   |      |                     |
|---|------|---------------------|
| 1. Grammar of Visual Form A/B               | (39) | Kwok Chiu Leung     |
| 2. Life Drawing & Anatomy I                 | (40) | Michael Griffith    |
| 3. Painting Studio I                        | (63) | Kwong Yiu Ting      |
| 4. History of Art, Introduction             | (41) | Cesar Guillen-Nunes |
| 5. Introduction to Three Dimensional Design | (45) | Paul Selinger       |

**ADVERTISING DESIGN**

- |                                 |       |                     |
|---------------------------------|-------|---------------------|
| 1. Grammar of Visual Form A/B   | (39)  | Kwok Chiu Leung     |
| 2. Life Drawing & Anatomy I     | (40)  | Michael Griffith    |
| 3. Advertising Studio I         | (42)  | Patrick W. Printer  |
| 4. History of Art, Introduction | (41)  | Cesar Guillen-Nunes |
| 5. Drawing Board Technique II   | (37B) | Ruth H. Addison     |

**INTERIOR DESIGN**

- |                                 |       |                     |
|---------------------------------|-------|---------------------|
| 1. Grammar of Visual Form A/B   | (39)  | Kwok Chiu Leung     |
| 2. Life Drawing & Anatomy I     | (40)  | Michael Griffith    |
| 3. Interior Studio I            | (43)  | Ruth H. Addison     |
| 4. History of Art, Introduction | (41)  | Cesar Guillen-Nunes |
| 5. Drawing Board Technique II   | (37B) | Ruth H. Addison     |

**PRESCRIBED COURSES FOR CERTIFICATE STUDENTS**  
**YEAR TWO TERM 4** *January to April, 1969*

**FINE ART**

- |   |      |                        |
|---|------|------------------------|
| 1. Life Drawing & Anatomy IIB               | (29) | Michael Griffith       |
| 2. Painting Studio IIB                      | (32) | Kwong Yiu Ting         |
| 3. History of Art IIB                       | (30) | Cesar A. Guillen-Nunes |
| 4. Painting Inquiry, Continuing Seminar B   | (33) | Hon Chi Fun            |
| 5. Grammar of Visual Form C/D               | (39) | Jon A. Prescott        |
| a. Introduction to Three Dimensional Design | (45) | Paul Selinger          |

**ADVERTISING DESIGN**

- |  |      |                        |
|--|------|------------------------|
| 1. Advertising Studio IIB                              | (34) | Julian Losinski        |
| 2. Printing Technology                                 | (35) | R.K. Cheng             |
| 3. History of Art, Introduction                        | (41) | Cesar A. Guillen-Nunes |
| 4. Drawing Techniques, Mixed Media, Use of Photography | (46) | Albert Hill            |
| 5. Grammar of Visual Form C/D                          | (39) | Jon A. Prescott        |
| a. Life Drawing & Anatomy IIB                          | (29) | Michael Griffith       |
| a. Painting Inquiry, Continuing Seminar B              | (33) | Hon Chi Fun            |

**INTERIOR DESIGN**

- |                                    |      |                        |
|------------------------------------|------|------------------------|
| 1. Interior Studio IIB             | (36) | Tao Ho                 |
| 2. Nature of Materials & Detailing | (38) | S.C. Fung              |
| 3. History of Art IIB              | (30) | Cesar A. Guillen-Nunes |
| 4. Development of Furnishing       | (48) | David W. Crowe         |
| 5. Grammar of Visual Form C/D      | (39) | Jon A. Prescott        |
| a. Life Drawing & Anatomy IIB      | (29) | Michael Griffith       |

- a. Highly recommended course, but optional

## Foundation Courses

**GRAMMAR OF VISUAL FORM** Jon A. Prescott, B. Arch., M.C.D., A.R.I.B.A., A.M.T.P.I. & Kwok Chiu Leung, N.T.D.

Parts A & B *Tuesdays, 6.00 p.m. to 7.30 p.m., starting 21 January, 1969.* Parts C & D *Fridays, 8.00 p.m. to 9.30 p.m., starting 24 January, 1969.* Extra-Mural Town Centre. 15 meetings. (each course) *Fee: \$75*

The aim of a Grammar of Visual Form is to provide a training in visual understanding. The Course which consists of four sections, is based on the studies of Kurt Rowland, whose work for the Council of Industrial Design in England has resulted in a textbook on visual education. Parts C and D show how the "grammar" formulated in Parts A and B may be applied.

Certain sessions will conclude with the setting of a small practical exercise which will be discussed briefly at the following meeting.

### *Part A, Year 1, Pattern and Shape*

In the visual world everything can be reduced to patterns and shapes. A study of their nature and functions enables us to look at our surroundings with deeper insight. Patterns are effected by the materials used and are deeply influenced by the social, economic and cultural backgrounds of the pattern makers.

### *Part C, Year 2, The Shapes We Need*

There are two strands in all design—the rational, scientific and analytical aspect and the intuitive, "inspired", human influence. The man made world is a synthesis of these two and the balance will vary. Discussion will centre on how these elements are combined, how they influence results and what principles are involved.

### *Part B, Year 1, Development of Shape*

Form is the outcome of forces acting on material—when the material and the forces change, the forms they create must also change. Consideration will be given to Form based on technology, the effect of traditional and modern materials on form, natural development and function, and to the relationship between shape, materials, processes and function.

### *Part D, Year 2, the Shape of Towns*

The town is the most complicated and ambitious man-made set of shapes and its study brings out the importance of the variety and a vast scale of design problems. Town design is an art form, though we look at it chiefly as a means of solving the problems of organised urban living. However, as in all design, the intuitive element is still required in order to restore those qualities of delight which are an essential element of our being.

---

## LIFE DRAWING & ANATOMY I

40

Michael F. Griffith, A.T.D., *Fridays, 6.00 p.m. to 8.00 p.m. and 8.00 p.m. to 10.00 p.m., (groups A & B) starting 24 January, 1969.* Extra-Mural Town Centre, 15 two hourly periods. (Students will be assigned to group A or B)

*Fee \$90, A model will be used for which there will be an additional charge of \$25. (Payable in advance)*

A beginners class. Stress will be laid on the underlying structural framework of the human form through a knowledge of basic anatomy, and on understanding both bone structure and muscle arrangement. The use of different media will be encouraged after a preliminary period of study of parts of the body in detail.

---

## Practice

- 37B** DRAWING BOARD TECHNIQUE II Mrs. Ruth H. Addison, Dipl. Arch. (U.C.L.) A.R.I.B.A. *Thursdays, 5.45 p.m. to 7.45 p.m., starting 23 January 1969.* Extra-Mural Town Centre. 15 meetings. *Limit of enrolment 25 students. Fee: \$90*

This class will be duplicated if necessary on *Tuesdays 8.00 p.m. to 10.00 p.m., starting 21 January, 1969.*

The graphic presentation of ideas is an essential basic requirement in all design work, of key importance in communicating the intention of the designer to his lay client. These studio periods will by way of a series of exercises introduce a variety of methods of presentation for the schemes undertaken. Emphasis will be given to the effective presentation of plans, sectional elevations as well as to the most important descriptive method the perspective.

The course will build on the knowledge which was the subject of Drawing Board Technique I (Course No. 27) and non-certificate students wishing to take it should have some previous experience.

- 
- 29** LIFE DRAWING AND ANATOMY IIB Mr. Michael Griffith, A.T.D. *Tuesdays, 8.00 p.m. to 10.00 p.m., starting 21 January 1969.* Extra-Mural Town Centre. 15 periods. *Enrolment is limited to 25 students, A model will be used for which there will be additional charge of approximately. \$30 (Payable in advance) Fee: \$90*

The discipline of drawing from life has long been recognised as the finest training in the correlation of hand and eye for any artist or designer. Stress will be laid on the underlying structural framework of the human form through a knowledge of basic anatomy. The use of different media will be encouraged.

This course is aimed at students who have had some previous experience. There is also a Life Drawing & Anatomy I course for beginners. (*see no. 40*)

- 
- 32** PAINTING STUDIO IIB Mr. Y.T. Kwong, M.Sc. (Kansas). *Mondays, 5.45 p.m. to 7.45 p.m., starting 20 January 1969.* Extra-Mural Town Centre. 15 periods. *Fee: \$90*

An intermediate level class for continued painting experience in various media. The aim is to allow individual students to develop at their own pace under expert guidance. Non-certificate students who have taken Part I Painting or who have a little experience already will be welcome.

---

**PAINTING INQUIRY—A CONTINUING SEMINAR AND STUDIO** Mr. Hon Chi Fun and Guest Tutors. *Tuesdays, 5.45 p.m. to 7.45 p.m., starting 21 January 1969* Extra-Mural Town Centre. 15 periods 33  
*Fee \$90*

This continuing seminar will consist of organised discussion combined with studio practice, the whole emphasis being on the discussion of expression of ideas, methods of work and approach to conceptually creative thinking.

Under the general direction of Mr. Hon Chi Fun various well known Hong Kong Artists will participate from time to time.

There will be a limited enrolment of 15 students who should be either registered certificate students or have considerable painting experience to their credit.

---

**INTRODUCTION TO THREE DIMENSIONAL DESIGN** Paul Selinger, M.F.A. (San Francisco Art Institute), *Thursdays, 6.00 p.m. to 8.00 p.m., starting 23 January, 1969.* Place to be announced. 15 periods. *Fee: \$90.* An extra charge will be made for materials used. 45

A series of studio/workshop sessions introducing students to the problems of three dimensional composition and sculpture. Students will work on practical problems in various media and should be prepared to devote additional time to that involved in formal tuition, to the further development of their work.

A general appreciation of formal composition and two dimensional applications is a prerequisite.

## VOCATIONAL: Advertising Design

**ADVERTISING STUDIO I** Mr. Patrick. W. Printer. N.D.D., M.S.I.A. *Fridays, 6.00 p.m. to 8.00 p.m., starting 24 January, 1969.* Extra-Mural Town Centre, 15 periods. 42  
*Fee: \$140*

Studio facilities provide a core to the Advertising Design students' work bringing together all aspects from printing technology to abstract formal considerations. This initial series of meetings will present an introduction to the work of an advertising agency. The work will consist of practical exercises, and the outline work of an agency will be discussed in formulating the problems involved.

---

**ADVERTISING STUDIO IIB** Julian A. Losinski, M.S.I.A., N.D.D., Dip. A.D.D. & A.D. *Mondays, 8.00 p.m. to 10.00 p.m., starting 20 January 1969.* Extra-Mural Town Centre. 15 periods. 34  
*Fee: \$140*

Studio facilities provide the core of the Advertising Design students work bringing together all aspects from printing technology to abstract formal considerations. As, however, advertising relies very greatly on "ideas" as well as Graphic Design it is important to appreciate what ideas mean, why they are good, how to get and exploit them. Within the framework of a series of carefully conceived exercises the student will apply ideas, in terms of layout, copy and photographic application for both advertisement and packaging designs.

---

- 
- 35 **PRINTING TECHNOLOGY IIB** Mr. R.K. Cheng, B.A. (Econ.) St Johns., Tech. Cert. in Printing C. & G. London. *Wednesdays 6.00 p.m. to 7.00 p.m., starting 22 January 1969.* Extra-Mural Town Centre and Government Printing Works. 15 periods  
Fee: \$95

Many of these lectures will take place on the workshop floor so that students can become familiar with the practical problems of printing technology. They will provide a study in some depth of the features of printer's type, his type case, type setting and justification, point systems and classification, preparation of copy, page layout, composition, paper and paper calculation, lino types and monotypes, etc. The study will be closely co-ordinated with studio exercises provided in Course 34.

- 
- 46 **DRAWING TECHNIQUES--MIXED MEDIA AND USE OF PHOTOGRAPHY** Albert Hill, I.A.Dip., *Wednesdays, 8.00 p.m. to 10.00 p.m., starting 22 January 1969.* Extra-Mural Town Centre, 15 periods.  
Fee: \$140

The Tutor who is well known for his book illustrations and advertising work will cover a wide range of techniques applicable to black and white illustrative work. Line drawing, scraperboard, use of various pens, airbrush techniques, will be analysed and compared and the usefulness of the camera demonstrated alongside the use of graphic arts material. The making of transparencies, photo composition, typography and use of camera for documentary work will be discussed. The course is envisaged as an introduction to this wide subject and will continue into next year.

Students would be at an advantage if they possessed a camera. The Tutor will provide a criticism of different makes relative to the work to be undertaken.

---

## VOCATIONAL: Interior Design

"The profession of interior design has had a long struggle to free itself from the image of the interior *decorator*. There is a growing appreciation that transference of the interior designer from the atmosphere of the boutique to the architectural design studio is not enough and that there is a need to establish far more scientific basis for interior decisions." This basic approach is fundamental to all interior classes offered.



---

**INTERIOR DESIGN STUDIO I** Mrs. Ruth H. Addison, Dip. Arch. (U.C.C.), A.R.I.B.A., *Thursdays, 8.00 p.m. to 10.00 p.m., starting 23 January, 1969.* Extra-Mural Town Centre. 15 periods. *Fee: \$90*

43

A series of graded exercises set in co-ordination with studies in various lecture series in simple interior design with emphasis on space and colour in relationship to an efficient organisation of plan forms and circulation. For practical reasons the completion of Course 27 during the Autumn Term is a prerequisite for effective participation in this course. (Course 27 was devoted to Drawing Board Techniques)

Work will continue into the 2nd Year, Term 3, for certificate students. Non-certificate students are welcome.

---

**INTERIOR STUDIO IIB** Mr. Tao Ho, B.A. (Williams), B. Arch. (Harvard). *Wednesdays, 5.45 p.m. to 7.45 p.m., starting 22 January 1969.* Extra-Mural Town Centre. 15 periods. *Fee: \$140*

36

A series of graded exercises throughout the term will be set in co-ordination with studies in various lecture courses and organised so as to develop the student's ability to present a carefully worked out scheme for differing types of interior. Part of the work this term will be to develop technical drawings in association with the lectures on the nature of materials and detailing and these will be worked out in conjunction with certain schemes of the student's own design.

---

**THE NATURE OF MATERIALS AND DETAILING** Mr. Fung Shiu Chuen B.Arch. (L'pl). *Wednesdays, 8.00 p.m. to 10.00 p.m., starting 22 January 1969.* Extra-Mural Town Centre. 15 periods. *Fee: \$140*

38

In all design work an understanding of the nature of materials is fundamental. The essential characteristics of materials predominantly used in interior work will be discussed and problems of achieving satisfactory jointings and junctions, the structural implications of using different materials and the effects to be achieved by different methods of detailing, will be co-ordinated with various research projects of collation of data together with exercises so arranged to reveal the problems and solutions involved. Application of this data will be made in the studio technical drawings.

---

**DEVELOPMENT OF FURNISHING** David W. Crowe, Dip. Arch (Liv.), A.R.I.B.A., *Tuesdays, 8.00 p.m. to 9.00 p.m., starting 21 January 1969.* Extra-Mural Town Centre. 15 sessions. *Fee: \$90*

48

Consideration will be given to the development of furniture and associated furnishing during a number of specific and wellknown periods of history. The unified treatment of furniture and setting will be discussed and comparisons made between different periods with emphasis on the links which bind together developments of quite different eras, for example ancient Greek and Egyptian design with that of the 18th and early 19th centuries.

The course will be illustrated by many slides.

## History and Appreciation

- 41** **HISTORY OF ART I** Cesar Guillen-Nunes, B.A. (Hons), Courtauld Institute of Art, London University, *Mondays, 6.00 p.m. to 7.00 p.m., starting 20 January, 1969.* Extra-Mural Town Centre, 15 periods plus tutorials in groups of 12 or so. Tutorials *7.00 p.m. to 8.00 p.m., following lecture by arrangement.* *Fee: \$90*

An introduction to the study of History of Art. Early lectures will be devoted to an outline of historical analysis and method, but the series is intended as a basis for a study of the roots of the modern movement and the "Moderns" themselves. Parallel consideration will be given to painting, sculpture and architecture. This course is continued in History of Art II. The next presentation of this series will be in 1970.

- 30** **HISTORY OF ART IIB** Mr. Cesar A. Guillen-Nunes, B.A. (Hons.) Courtauld Institute of Art, London University. *Fridays, lecture 6.00 p.m. to 7.00 p.m., tutorial 7.00 p.m. to 8.00 p.m., starting 24 January 1969.* Extra-Mural Town Centre. 15 periods, once weekly, *one hour of lecturing, and on alternate weeks one hour of tutorial, i.e. the tutorial will be by groups of half of the total enrolment on alternate meetings.* *Fee: \$90*

The lectures in this course will be devoted to parallel developments in painting, architecture and sculpture in the twentieth century.

Tutorial sessions will be used to encourage detailed consideration of certain aspects and student participation.

- 202** **CHINESE BLUE & WHITE PORCELAIN** James Watt, B.A. (Oxon.) Asst. Curator City Art Gallery & Museum. *Wednesdays, 7.45 p.m. to 8.45 p.m. and 9.00 p.m. to 10.00 p.m., starting 22 January, 1969.* Extra-Mural Town Centre 8 meetings, 4 evenings each of two sessions. *Fee: \$35*

A historical survey of Blue & White porcelain from the early 14th century to the 20th century; the process of manufacture, the export trade, evolution of shape and the relation of the decorative motifs to Chinese painting and allied branches of Chinese art. The discussion will be illustrated with slides and the break between the two parts will allow close examination of specimens which will be shown at the meetings.

## Daytime Course

**PAINTING I** Mr. Peter Lam. *Saturdays, 9.30 a.m. to 11.30 a.m. (The studio will be available for private working to 1.00 a.m.) starting 25 January 1969.* Extra-Mural Town Centre. 15 meetings. *Enrolment is limited to 25 students.* Fee: \$90

57

An introductory course for persons having no previous experience. The Tutor will introduce various subjects, techniques and media and will discuss practical colour mixing, palette organisation, materials, texture and treatment of surface and will analyse historical and present day examples of relevance to the techniques introduced.

Students will be given information as to the materials required at the first meeting.

## Other Art Classes

**A BEGINNER'S COURSE IN DRAWING & PAINTING** Peter Lam, *Wednesdays 6.00 p.m. to 8.00 p.m., starting 22 January, 1969* Kings College, Bonham Road, Hong Kong, 15 meetings, *enrolment limited to 25 students.* Fee: \$90

203

This introductory course has been prepared in response to the demand established last term by the return of the Form 55 from our Autumn brochure. Mr. Lam is Art Lecturer in Northcote College of Education. He will introduce various techniques and media; discuss practical colour mixing, palette organisation, materials, texture and treatment of surface and encourage students to develop along the lines they prefer after a basic period of discipline.

Students will be given information as to materials required at the first meeting

---

## SUGGESTIONS FOR THREE DIMENSIONAL DESIGN

204

Julian Chan Ping Tim, *Fridays, 6.00 p.m. to 8.00 p.m., starting 24 January, 1969.* Place to be announced, 12 meetings, once weekly, limit of enrolment 25 students. A small extra charge will be made for materials utilised. Fee: \$75

The Tutor, who has studied sculpture at Ravensbourne College of Art & Design, and is at present on the staff of the Grantham College of Education, will relate the instruction in this class primarily to the requirements of the teaching profession, leaders of youth groups and persons involved in social work.

The materials discussed will be used by participants for practical exercises and will include clay, plaster, cement, resin and p.v.c. as well as use of card of various forms. Stress will be laid on the inherent qualities of the nature of materials as a basis for creative work.

# Chinese Studies

Staff Tutor in Charge: C.K. Leung B.A. (H.K.) Telephone No. 468161 Ext. 305

## 國學研究

國學課程分文學，哲學，歷史及藝術各門，文、史、哲課程重欣賞，創作與研究，藝術方面除介紹各種不同藝術之源流發展外，理論與實習並重。學者可翻閱課程內容簡介，選目修習。

主理導師 梁志強先生

## Literature 文學

205

ON CORRECT CHINESE CHARACTER WRITING Mr. H.H. Fung. *Wednesdays*,  
8 - 10 p.m., starting Jan. 29, 1969. Lecture Room South, City Hall. 14 meetings  
Fee: \$60

### 文字正俗分析

本課程以通常應用之正俗字詳為

解說，內容分：(一)文字起源；(二)歷代演變化分；(三)說文正字；(四)說文所無之通俗字(五)俗字等等，每講二小時，共十四講。

主講人：馮康侯先生

時間：一九六九年一月廿九日起每

星期三下午八時至十時

地點：香港大會堂九樓南演講廳

講授語言：粵語

學費：六十元

## Religion & Customs 宗教及文化常識

**THE ROLE OF RELIGION IN CHINESE SOCIETY** Dr. M. Topley, B.Sc. Econ (Lond.); Ph.D. (Lond.). *Wednesdays, 6.15-7.15 p.m., starting Feb. 5, 1969.* British Council Library, Gloucester Building, H.K. 8 meetings. *Fee: \$30*

178

The focus will be on religion and its role in the life of ordinary people in Hong Kong today — rural and urban. Discussion will centre around the "situational" significance of religion: the traditional role of religion in accordance with different social requirements, e.g. in the family, in such occupations as farming, crafts and trades. In this context the emergence of different cults and sects, and the role of the priesthood in popular religious practices, and their formal organization will also be touched upon.

**UNDERSTANDING CHINESE CUSTOMS & TRADITIONS** Mrs. Nana Tsao, B.A. (H.K.); Dip.Ed. (H.K.). *Fridays, 6-7.15 p.m., starting Jan. 17, 1969.* University Main Building, University of Hong Kong 10 meetings. *Fee: \$35*

207

This series of lectures is designed for those who wish to learn something of Chinese life & culture. It will deal with traditional Chinese customs & ways of life existing in Hong Kong, and will also discuss changes in some of the traditional patterns of thought & behaviour. Topics to be included are Chinese family structure & kinship; position of women; wedding & burial customs; ancestor worship; religions & the main festivals celebrated during the year. The lectures will be illustrated with slides & films.

### PRIOR ENROLMENT IS ESSENTIAL

Failure to enrol prior to the opening of a particular course may mean the cancellation of that course. Prior enrolment is the only way the Department of Extra-Mural Studies has of judging the response to its courses. Your co-operation is therefore invited in sending your application forms to the Department as soon as possible.

# Economics Commerce Management

Staff Tutor in Charge: J.W. England, B.A. (Nottm.) Telephone No. 468161 Ext. 309

---

- X 81** **STATISTICS FOR ACCOUNTANTS** Mr. M.Y. Yeung, B.A. *Mondays, 7.45 - 10.00 p.m., starting January 13, 1969.* Committee Room North, City Hall, 7th Floor, 10 meetings. *Fee: \$65*

An appreciation of the use of statistics in the presentation and comparison of accounting information; collection and tabulation of data; methods of presentation; use of graphs in business.  
Suitable for those preparing for professional examinations.

---

- 209** **MANAGEMENT IN THE MODERN WORLD** Mr. D. Podmore, B.Sc. (Soc.) *Tuesdays, 5.45 - 6.45 p.m., starting January 21, 1969.* Extra-Mural Town Centre. 10 meetings. *Fee: \$40*

A wide-ranging approach to the principles and practice of management in the modern world. Emphasis will be placed on recent sociological and psychological research and its application for managers. Topics include: industrial psychology - motivation, attitudes, groups, leadership, the principles and practice of management; the structure of organisations; and the place of the individual in the organization.

---

- 210** **PERSONNEL MANAGEMENT II** Mr. J.W. England, B.A., and others. *Thursdays, 5.45 - 6.45 p.m., starting January 23, 1969.* Extra-Mural Town Centre. 6 meetings. *Fee: \$20*

A short follow-on course to Personnel Management I. Topics to be discussed include personnel policies, workers' attitudes, joint consultation, and factory legislation, with special emphasis on Hong Kong practices. Those who did not attend Personnel Management I but who are interested in these matters are welcome.

---

- 211** **TAXATION PROBLEMS IN HONG KONG** Mr. J.K.S. Thong, F.A.C.C.A., F.C.I.S. *Fridays, 7-8 p.m., starting January 17, 1969.* Extra-Mural Town Centre. 15 meetings. *Fee: \$55*

A full explanation will be given of the way in which income liable to Hong Kong income tax is assessed. The powers and duties of the Board of Inland Revenue and the Board of Review will also be carefully reviewed.

---

**SOCIAL PROBLEMS OF OUR TIME** Mr. D. Han, M.A. *Mondays, 7.10-8.40 p.m., starting January 13, 1969.* University Main Building, H.K.U. 10 meetings. *Fee: \$45*

212

Different types of societies have different types of problems. By comparing these societies and their problems we may be able to achieve a deeper understanding of them. Among the problems to be discussed are suicide, race relations, divorce, illegitimacy, prostitution, mental illness, and juvenile delinquency.

Recommended reading: Noel Timms: "A Sociological Approach to Social Problems". Routledge, Paperback 7/6.  
R.K. Merton ed.: "Contemporary Social Problems"

**PRACTICAL BANKING II** Mr. T.Y. Chan, B.A. *Tuesdays, 7 - 8 p.m., starting January 14, 1969.* Extra Mural Town Centre. 12 meetings. *Fee: \$40*

213

**銀行實務 (二)**  
本課程共十二講，繼續講述銀行實務，特別注意進出口押匯。關於香港銀行各項重要問題，亦加以研討。  
主講人：陳天元先生  
講授語言：粵語（輔以英語）  
地點：香港大學校外課程部市區中心  
時間：一九六九年一月十四日起  
每星期二下午七時至八時  
學費：四十元

**INVESTMENT** Mr. Francis Chan, M.B.A. *Fridays 6 - 7 p.m., starting January 17, 1969.* Lecture Room South City Hall, 8th Floor. 15 meetings. *Fee: \$60*

214

**投資學**  
本課程共十五講，對有關投資的研究與處理之問題，有詳盡之討論。內容包括投資的目的，證券，互惠投資基金，參考資料之取得，購售手續，證券市場，有價證券之分析，時效問題，經紀人關係等。  
主講人：陳暢餘碩士  
（工商管理學）  
講授語言：粵語  
地點：香港大會堂九樓南演講廳  
時間：一九六九年一月十七日起  
每星期五下午六時至七時  
學費：六十元

215

**BUSINESS STATISTICS** Mr. Wong Man-tun, M.A. (Econ.) *Wednesdays, 8.15 - 9.15 p.m., starting January 15, 1969.* Extra Mural Town Centre. 14 meetings.

Fee: \$50

### 工商統計

本課程共十四講，主要研究統計學原理在工商管理中之一般應用。講解之問題包括初級資料與次級資料之搜集，統計表之編製與統計圖之繪製，以及常用之平均數，離差及指數等之分析方法。

統計工作直接影響工商企業之科學管理及其經營決策，因而是工商管理中不可或缺之工作。

本課程適合於工商企業管理人員，統計工作人員及其他有興趣人士選讀。

主講人：王文敦碩士

講授語言：粵語（專門術語兼用英語）

地點：香港大學校外課程部市區中心

時間：一九六九年一月十五日起

每星期三下午八時十五分至九時十五分

學費：五十元

216

**MARKETING RESEARCH** Mr. Edward H. Lee, M.S.B.A. *Mondays, 7 - 8 p.m., starting January 13, 1969.* Committee Room South, City Hall, 7th Floor. 16 meetings.

Fee: \$65

### 市場工作研究

此一課程之基本目標在介紹有關市場工作之基本知識——其計劃，技術及應用；管理人員在解決市場工作問題時如何運用及評價，本課程亦計劃將重要及必需之市場工作研究資料加以介紹。

此課程乃為製造廠商及高級管理人員所準備者，但較低層之行政人員亦會認為此課程所提供之知識極為有用。（共十六講）

主講人：李海滋碩士

講授語言：粵語

地點：香港大會堂八樓南會議室

時間：一九六九年一月

十三日起每星期一下午七時至八時

學費：六十五元

217

**FACTORY OPERATION AND SCIENTIFIC MANAGEMENT Part II: Scientific Management.** Mr. Wong Man-tun, M.A. (Econ.) *Tuesdays, 8.15 - 9.15 p.m., starting January 14, 1969.* Extra Mural Town Centre. 12 meetings.

Fee: \$40

### 工廠建設與科學管理

(一) 科學管理

本階段共十二講，主要研究工廠科學管理之基本問題，包括科學管理之實質，基本原則與組織形式，生產過程（包括流水生產）之組織與計劃管理，勞動組織管理，原材料供應與產品銷售管理，技術管理（包括發展新產品管理，產品質量管理及設備維修管理），安全生產等。印發講課提綱。

本課程適合實際從事工廠管理之人士及其他有興趣人士選讀。

主講人：王文敦碩士

講授語言：粵語（輔以英語）

地點：香港大學校外課程部市區中心

時間：一九六九年一月

十四日起每星期一下午八時十五分至九時十五分

學費：四十元



# Education

Staff Tutor in Charge: Nana Tsao B.A., Dip. Ed. (H.K.) Telephone No. 468161 Ext. 306

---

**TOWARDS BETTER SCHOOL MANAGEMENT** Prof. N.K. Henderson, Ph.D. (London); B.A., M.Ed. (Melb.); A.B.Ps.S.; F.C.P.; Professor of Education, H.K.U. *Thursdays, 5.45 - 6.45 p.m., starting January 23, 1969.* University Main Building, H.K.U. 12 meetings. *Fee: \$40*

105

A symposium on the problems and procedures involved in the administration of schools and colleges. The course will proceed by lectures, discussions, film-sessions and assignment-projects, but will call for much inter-change of ideas. It will be ideally suited to the interests of school principals (both secondary and primary), college heads, subject-masters, and all those with special interests in the better professional management of educational institutions. The aim will be to apply modern management techniques, including sound social psychological principles and current professional practices, to the tasks of effective school administration in Hong Kong.

---

**INTRODUCTION TO EDUCATIONAL PSYCHOLOGY (II)** Mr. C.K. Leong, B.A.; M.A. (Ed.) (H.K.); Dip Ed. Ps. (Q'ld.). *Thursdays, 5.45 - 6.45 p.m., starting Jan. 16, 1969.* Extra Mural Town Centre, 12 meetings. *Fee: \$35*

170

**教育心理學概論(乙)**  
本課程共十二講，每週一次，目的在增進學校行政人員，教師及家長對教學一般問題的認識。課程內容包括：①個別差異②「智力」的概念及測驗③學科測驗④考核及分數的意義⑤學校紀錄⑥兒童指導

本課程具有完整性，但亦可與一九六八年十月開課之「教育心理學概論(甲)」相銜接。

主講人：教育司署研究測驗輔導中心 梁子勤先生

地點：香港大學校外課程部市中心

時間：一九六九年一月十六日起 每星期四下午五時四十五分至六時四十五分

學費：三十五元

# English Studies

Staff Tutor in Charge: G. Mahood, M.A. (London) Telephone No. 468161 Ext. 304

---

**220** A MODERN VIEW OF SIX POETS Mr. R. Kirkpatrick, B.A. (Oxon.), Asst. Lecturer, Dept. of English, University of Hong Kong. *Thursdays, 8.30 - 9.30 p.m., starting January 23, 1969.* City Hall, 8 meetings. *Fee: \$20*

In this series the lecturer will take a fresh look at a number of major poets who have influenced or been admired by modern poets. By reading and analysing each week a poem by Donne, Dryden, Pope, Wordsworth, Keats and Hopkins students will have a basis for judging the far-reaching effect of these on modern poets and critics like Eliot and Leavis. Cyclostyled copies of the poems will be available.

---

**221** READING IN TRANSLATION Mr. A. Wong, B.A. (Columbia). *Mondays, 8 - 9 p.m., starting January 20 1969.* City Hall, 10 meetings *Fee: \$30*

Many people feel debarred from reading foreign authors because their knowledge of language is non-existent or inadequate. But many internationally known writers are available in good English translations and through these the main streams of contemporary writing can be studied. These lectures provide an introduction to "literature in translation" by comparing the works of several French authors with those of English and American writers, mainly novelists and poets, whose thought and style reveal cross-influences.

Reading: French. A. Camus "The Stranger"  
H. de Montherlant "Selected Essays"

American: E. Hemingway "The Old Man and the Sea"

English: T.S. Eliot Poems  
Wilfred Owen

---

**GROWING UP WITH BOOKS** Mrs. P. Fitch. *Wednesdays, 11a.m. - 12noon, starting January 22, 1969.* Extra-Mural Town Centre. 8 meetings. *Fee: \$30*

222

This is a golden age of children's literature but the enormous yearly output makes it difficult for parents, unaided, to select the true gold from the dross. This course is designed to throw out some guide lines for those parents who have rather lost touch with the child's world of books but who, nevertheless, wish to encourage their own children to make good use of their reading.

Synopsis: Brief history of children's literature and mention of some old favourites.

Picturebooks and poetry in the nursery — and later.

The importance of myth, legend and folktale at various stages in a child's reading

Horror — what should be considered unsuitable? Problems of censorship.

New books & new authors, with a closer look at some recently published titles.

The use of libraries.

Widening horizons — some suggestions for adolescent reading.

Although the emphasis is on children's books as literature, it is intended to give practical advice and help to parents about books available locally, catalogues and booklists, and suggestions for encouraging reluctant readers. Books will be on exhibition at each talk.

For those who find an evening class more convenient Mrs. Fitch is prepared to offer an additional course on Wednesdays or Thursdays at 6.30 to 7.30. Please contact us if you are interested.

---

# Geology and Geography

*Staff Tutor in Charge: C.K. Leung B.A. (H.K.) Telephone No. 468161 Ext. 305*

---

- 120** **GEOGRAPHY IN THE FIELD – (HUMAN)** Mr. Luke S.K. Wong, B.A. (H.K.), Research Asst., Centre of Asian Studies, H.K.U. *Tuesdays, 6 - 7 p.m., field trips on Saturdays/Sundays, starting February 4, 1969.* University Main Building, H.K.U. 12 meetings. *Fee: \$40*

The course fee does not include expenses incurred on the excursions. Enrolment is strictly limited to 30 persons. Participants should be physically fit and capable of climbing and hiking.

The influence of geographical environment on the type of land use, both rural and urban, the impact of urbanisation on rural land use, and the development of new towns will be discussed in lectures and studied in detail during field trips. Methods of investigation and presentation of facts will be considered.

*There will be 6 indoor lectures and 6 field trips. Places to be visited include: Yuen Long Plain, Sai Kung Peninsula, Ngong Ping Plateau, urban districts, Plover Cove, and Satellite Towns.*

---

- 224** **CHINA – ITS LAND AND PEOPLE** Mr. C.K. Leung, B.A. (H.K.) *Wednesdays, 5.30 - 6.45 p.m., starting Jan. 22, 1969.* Extra-Mural Town Centre. 10 meetings. *Fee: \$40*

An introductory course to the Geography of China. Topics to be discussed will include: its physical structure, climate, agriculture, industry, transport and population. It will be a useful background course for new comers to Hong Kong and for those who are interested in China. No prior knowledge of the subject is assumed.

---

- 225** **SEMINAR ON HONG KONG'S TRANSPORT PROBLEMS** Mr. R. Butler, J.P., B.Sc. (Lond.), Senior Transport Officer/Economist, Transport Office. *Mondays, 5.45 - 7.15 p.m., starting Jan. 20, 1969.* Extra-Mural Town Centre. 10 meetings. *Fee: \$50*

Transport management & planning personnel, as well as interested laymen, are invited to attend this series of lectures & discussions on the many vexed problems relating to H.K.'s transport. Among the interesting topics to be considered will be the following: the economics of public passenger transport; coping with car ownership in H.K.; the implications of the H.K. Mass Transport Study; and the coordination of transport provision.

---

**PHYSICAL GEOGRAPHY, REGIONAL PATTERNS & RESOURCES OF JAPAN**  
See Course No. 23 pp7-8.

---

# History and International Affairs

*Staff Tutor in Charge: Nana Tsao B.A., Dip. Ed. (H.K.) Telephone No. 468161 Ext. 306*

---

**NATIONALISM IN SOUTHEAST ASIA** Dr. L.R. Wright, A.B. (Middlebury), M.A. (New Hampshire), Ph. D. (London), Lecturer, Dept. of History, University of Hong Kong. *Mondays, 6.40 - 7.40 p.m., starting January 13, 1969.* Committee Room North, City Hall, 7/F., Hong Kong. 10 meetings. *Fee: \$35*

123

Nationalism in S.E. Asia has become a controversial subject to those interested in its recent history. The ideas of nationalism, the leadership of the nationalist movements, and the problems of these emerging nations will be studied by examining the following topics:

1. Ideas of nationalism with reference to Indian "model".
2. The response to European colonialism in Southeast Asia after 1900.
3. Survey of nationalism in Burma, Malaya, Indonesia & Vietnam.
4. Social & economic scene of nationalism.
5. Leadership of nationalist movements: the role of the educated elite.
6. The role of the people in the nationalist movement.
7. Problems of nationalism in the emerging nation.

---

**BRITISH POLICIES IN SOUTH-EAST ASIA 1800 onwards** Dr. L.R. Wright, A.B. (Middlebury), M.A. (New Hampshire), Ph. D. (London), Lecturer, Dept. of History, University of Hong Kong. *Wednesdays, 7.00 - 8.00 p.m., starting January 22, 1969.* Lecture Room South, City Hall, 8/F., H.K. 12 meetings. *Fee: \$40*

124

Until late in the 19th century British positions in Southeast Asia were geared commercially and strategically to her larger interests in China and in the Indian subcontinent. With the intense imperial rivalry before World War I Southeast Asia became of territorial as well as strategic importance. Britain acquired her Southeast Asian empire of Burma and Malaya by wars of conquest, annexations, and protectorate treaties. She ruled the waters from her naval base in Singapore. After World War II Britain began to dismantle gradually her empire. This course will cover the policies of empire as laid down in London, the changes in policy as they occurred, and the implementation of policy in Southeast Asia during the century and a half following 1800.

---

---

**228** **THE BIRTH & GROWTH OF COMMUNISM IN CHINA** (From the May Fourth Movement to Yen-an & Peking) Dr. Lee Ngok, M.A., Dip. Ed. (H.K.); Ph. D. (London), Lecturer, Dept. of History, University of Hong Kong. *Thursdays, 7 - 8.15 p.m., starting January 23, 1969.* Committee Room North, City Hall, 7/F., Hong Kong. 12 meetings. *Fee: \$40*

The birth of Communism in China as a political reality and its subsequent developments affect the destinies of more than half of the world's population. This course provides a critical study of the communist movement during the 28 years of its growth. Dr. Lee will give a detailed review of the rise of both Chiang Kai-Shek & Mao Tse-Tung; how the KMT & CCP co-operated during the Northern expedition, the Long March; the role played by the Communists during the Sino-Japanese War; the early party-army relationship and co-operation between Mao & Liu Shao-Chi. This series of lectures ends with the expulsion of the Kuomintang from the mainland & the establishment of the People's Republic.

---

**229** **THE PROFILE OF HONG KONG** Staff Tutors of the Department of Extra-Mural Studies. *Wednesdays, 2.30 - 4.00 p.m., starting February 26, 1969.* Extra-Mural Town Centre. 10 meetings. *Fee: \$35*

This series of lectures, designed for those who wish to know more of Hong Kong to-day will deal with aspects of its founding history, geography, people, customs, current economic and social issues, housing and urbanization, which will be followed by visits to housing & resettlement estates.

*Course fee does not include expenses incurred on the visits.*

---

# Languages

Staff Tutor in Charge: C.K. Leung B.A. (H.K.) Telephone No. 468161 Ext. 305

---

**FOUNDATIONS IN CANTONESE** Mr. Francis Sham, B.A. (Sun Yat-sen), Language School, H.K.U. *Tuesdays & Fridays, 5.45 - 6.45 p.m., starting Jan. 21, 1969.* Extra-Mural Town Centre. 48 meetings. *Fee: \$220*

230

The fee includes \$20 for 12 hours of laboratory study at the Caritas House, of which at least 4 hours will be conducted by the tutor during course time.

With emphasis on the spoken language and the use of Chinese idioms, students will be provided with a basic knowledge of pronunciation, tones, grammatical constructions, and a simple vocabulary for beginners. Ample time will be provided for oral practice. Supplementary notes and exercise will be supplied by the tutor. Enrolment is strictly limited to 40 persons.

Text book: Cantonese Conversation Grammar, Book 1, by S.L. Wong.

---

## PRIOR ENROLMENT IS ESSENTIAL

Failure to enrol prior to the opening of a particular course, may, mean the cancellation of that course. Prior enrolment is the only way the Department of Extra-Mural Studies has of judging the response to its courses. Your co-operation is therefore invited in sending your application forms to the Department as soon as possible.

# Law

## LL.B. London

*Tutor in Charge:* Priscilla Tso, B.A. Dip. Ed. (H.K.), Dip. Ad. Ed. (Manch).  
*Telephone No.* 468161 Ext. 303

---

**200** ENGLISH MERCANTILE LAW Mr. Charles Lee, LL.M. (Lond.). *Wednesdays, 5.45 - 6.45 & 7 - 8 p.m., starting January 22, 1969.* Extra-Mural Town Centre. 15 meetings. *Fee: \$100*

A course preparing candidates for the Final Part I Examination of the Chartered Institute of Secretaries and the Intermediate Examination of the Association of Certified and Corporate Accountants. It will deal with general principles of the law of contract, negotiable instruments, sale of goods, hire purchase, carriage of goods by land, sea and air, agency, partnership, bankruptcy, guarantee and indemnity, insurance, bailment, lien, arbitration and bill of sale.

---

**201** ROMAN LAW Mr. F. Cooke, Barrister-at-Law, Senior Crown Counsel. *Tuesdays, 5.45 - 6.45 p.m., & 7 - 8 p.m., starting January 28, 1969.* Extra-Mural Town Centre. 15 meetings. *Fee: \$100*

This is a course preparing candidates for the London University External LL.B. Intermediate Examination in Laws.

---



# Mathematics

*Staff Tutor in Charge:* Priscilla Tso. B.A., Dip. Ed., (H.K.), Dip. Ad. Ed. (Manch.)  
*Telephone No.* 468161 *Ext.* 303

---

**MODERN MATHEMATICS IN PRIMARY SCHOOLS** Mr. Timothy E.E. Bleach,  
B.A. (Southampton). *Mondays, 5.45 - 6.45 p.m., starting January 20, 1969.*  
Extra-Mural Town Centre. 10 meetings. Enrolment limited to 25 students.

**231**

*Fee: \$35*

The course aims to introduce to parents and interested laymen some of the basic principles of modern mathematics and to examine recent changes in the approach to the teaching of mathematics in primary schools. It will deal with topics selected from the syllabus of primary schools. Students will be asked to participate in practical work.

---

**MODERN MATHEMATICS FOR PARENTS II** Mr. Tsui See Ming, B.A., Dip. Ed.  
(H.K.). *Mondays, 5.45 - 6.45 p.m., starting January 27, 1969.* Extra-Mural Town  
Centre. 15 meetings.

**232**

*Fee: \$ 45*

This is the second part of a series of courses intended to introduce the basic principles of modern mathematics to parents and interested laymen. Illustrations will be taken from the syllabus of lower forms in secondary schools.

---

# Music Philosophy

Staff Tutor in Charge: G. Mahood, M.A. (London) Telephone No. 468161 Ext. 304

## Music

- 233** **THE NINE SYMPHONIES OF BEETHOVEN** Mr. P.E. Robinson, M.A. (Toronto). *Wednesdays, 6 - 7.30 p.m., starting January 15, 1969.* Goethe Institute, Caxton House, Duddell St., Hong Kong. 10 meetings. *Fee: \$35*

A series of ten lectures designed for those who wish to understand better the greatest symphonies ever written. The lectures will be illustrated with recordings and piano. Some musical training would be useful as a prerequisite.

- 234** **THE HISTORY OF OPERA** Mr. P.E. Robinson, M.A. (Toronto). *Thursdays, 6 - 7.30 p.m., starting January 16, 1969.* Goethe Institute, Caxton House, Duddell St., Hong Kong. 8 meetings. *Fee: \$30*

In view of the great enthusiasm for opera in Hong Kong, it is felt that many listeners would appreciate a course on the subject. The lecturer will discuss and play excerpts from operas by Monteverdi, Gluck, Handel, Mozart, Bellini, Weber, Verdi, Wagner, Puccini, Berg, Debussy, Ginastera and Britten.

## Philosophy

**WHAT IS PHILOSOPHY?** Mr. G.H. Mahood, M.A. (London), Dr. Peter Brady, S.J., M.A. (Melb.), Phil. L., S.T.L. *Tuesdays, 8.15 - 9.15 p.m., starting January 21, 1969.* Extra-Mural Town Centre. 10 meetings. *Fee: \$30*

235

"Philosophy bakes no bread". "The Marxist's philosophy of history conflicts with the facts". "The philosopher does not supply answers: he clarifies the questions". "The scientist and the theologian clash in their basic philosophies". Few words are employed with such different senses. The history of the subject reveals many "types of philosophy" and it is the purpose of these lectures to clarify what it has meant to a number of thinkers deeply divided in their outlooks. Specific types to be referred to will include theism, existentialism, scientific humanism and linguistic philosophy.

---

**PSYCHOLOGY AND MORALITY** Mr. G.H. Mahood, M.A. (London), Dr. D.Y.F. Ho, Lecturer, Dept. of Psychology, University of Hong Kong. *Wednesdays, 7.00 - 8.00 p.m., starting January 22, 1969.* Extra-Mural Town Centre. 10 meetings. *Fee: \$30*

236

Though moral problems cannot be dealt with by the psychologist as such, the findings of psychology pose significant problems to the moral philosopher. In particular, the theories of Freud, rested on the assumption of psychological determinism, have a bearing on our conceptions of law and morality. The implications here have not yet been fully realised - specifically, what changes in our conceptions of free will and moral responsibility may result from the challenge of psychological discoveries? The weekly lectures will be given alternately by Dr. Ho and Mr. Mahood.

---

**CRITICAL THINKING AND LANGUAGE** Dr. D.Y.F. Ho, Lecturer, Department of Psychology, University of Hong Kong. *Fridays, 8.15 - 9.15 p.m., starting January 24, 1969.* Extra-Mural Town Centre. 10 meetings. *Fee: \$30*

237

Logic nowadays has become a specialised discipline with its own techniques and a rather forbidding language of its own. But there is an art of reasoning that can be applied to everyday matters and which can be studied with a minimum of specialist terminology. This course will attempt first to show the application of elementary logic to topics that people argue about in daily life and second to indicate how confusions in thinking can arise out of misunderstandings of language.

---

# Psychology

Staff Tutor in Charge: C.K. Leung B.A. (H.K.) Telephone No. 468161 Ext. 305

---

**238** **ABNORMAL PSYCHOLOGY** Mr. G. Rochford, B.A. (Hons.) (Hull), Lecturer, Dept. of Philosophy & Psychology, H.K.U. *Tuesdays, 7 - 8 p.m., starting January 28, 1969.* Extra-Mural Town Centre. 10 meetings. *Fee: \$35*

The main varieties of abnormal behaviour are described including the Neuroses, Psychoses, Social Deviations and the effects of brain damage. The causes of abnormal behaviour are also examined.

Psychological methods of treatment, including Psychoanalysis, Psychotherapy and Behaviour Therapy, are evaluated.

---

**167** **CHILD PSYCHOLOGY – THE FIRST FIVE YEARS** Mr. G. Rochford, B.A. (Hons.) (Hull), Lecturer, Dept. of Philosophy and Psychology, H.K.U., *Thursdays, 7 - 8 p.m., starting April 3, 1969.* Extra-Mural Town Centre. 10 meetings. *Fee: \$35*

Child development during the first five years is described. Particular attention is given to the development of language, thinking and social behaviour.

Some time will be spent on problems of abnormal development but the course is mainly concerned with the normal child and with 'normal' problems of psychological growth.

---

**239** **CHILD PSYCHOLOGY – THE FIRST FIVE YEARS** Mr. G. Rochford, B.A. (Hons.) (Hull), Lecturer, Dept. of Philosophy and Psychology, H.K.U. *Thursdays, 3.00 - 4.00 p.m., starting April 3, 1969.* Extra-Mural Town Centre. 10 meetings. *Fee: \$35*

Child development during the first five years is described. Particular attention is given to the development of language, thinking and social behaviour.

Some time will be spent on problems of abnormal development but the course is mainly concerned with the normal child and with 'normal' problems of psychological growth.

---

**SOCIAL PROBLEMS OF OUR TIME**  
See course no. 212 page 21.

---

# Urban & Regional Planning

*Staff Tutor: Jon A. Prescott, B. Arch. (Liv.); M.C.D.; A.R.I.B.A.; A.M.T.P.I.  
Telephone No. 468161 Ext. 308 or 226613*

---

## **COURSES FOR REGISTERED STUDENTS OF THE TOWN PLANNING INSTITUTE**

Coverage of parts of the Syllabus in conjunction with external arrangements of the Institute with Reading University, for the 1970 final examinations of the Town Planning Institute is being planned for registered student members and those having professional qualifications exempting therefrom. *Please contact the Staff Tutor in Planning for details.*

---

## **CONFERENCE ON CONSERVATION AND DEVELOPMENT OF THE COUNTRYSIDE**

The date of this Conference, will be 15th - 22nd, MARCH 1969.

The Conference is sponsored by the University of Hong Kong and invitations to give Papers and to participate have been issued to various internationally and locally known persons.

The emphasis of the Conference will be on consideration of the impact of Urban growth on the Rural areas in view of the former's explosive space requirements.

The aim, will be to make the various contending interests aware of the overall problems of co-users of rural land and to generally inform the public of the significance of the countryside to future living standards.

Hong Kong will be seen as a casebook in the context of south east Asian and world problems, as a summary of the problem, in a world where compromise between spatial and other needs of the human being and his effect on his surroundings scream for attention every day.

*The programme, further information and registration forms are available from the Conference Secretary, Conference on Conservation and Development of the Countryside, University of Hong Kong.*

---

## **SEMINAR ON HONG KONG'S TRANSPORT PROBLEMS** See course no. 225

page 26. This course is aimed at those having a general interest in transport problems.

---

# Public Lectures

1

## THE BRITISH CIVIL SERVICE

Sir Saville Garner, G.C.M.G., former Head of the British Diplomatic Service, in the Chemistry Theatre, University of Hong Kong, at *5.45 p.m. on Monday, 13th January, 1969.*

This is a topic which is likely to excite a lively interest in view of the eminence of the speaker and of the recent hard-hitting report of the Fulton Commission on the Civil Service.

*The Chairman will be Sir Charles Hartwell, Chairman of the Public Service Commission.*

**GENERAL BANKING**

Mr. Leo Cole, Commissioner of Banking, in the City Hall, Hong Kong, between 8.15 & 9.30 p.m., on Tuesday 11th February, 1969.

Further details will be made public closer to the time.

The Chairman will be J.W. England B.A. (Nottm.)



# Extra Mural Studies 校外課程 Application for Enrolment 報名申請書

每一種課程請用別紙填寫

PLEASE USE A SEPARATE FORM FOR EACH COURSE

**A**

課程號碼  
課程名稱  
姓名  
前已讀其他校外課程名稱

COURSE NO. FEE ENCLOSED \$  
附學費  
COURSE NAME CASH/CHEQUE NO.

NAME in full (Mr./Mrs./Miss) English  
英文  
Chinese  
中文  
in block letters—surname first

What Extra Mural Courses have you previously attended?

姓名

NAME IN FULL (Mr./Mrs./Miss) English  
英文  
Chinese  
中文  
in block letters—surname first

通訊處

ADDRESS for correspondence

辦事處地址

OFFICE ADDRESS

電話

TELEPHONE NOS. Home 住宅 Office 辦事處

國籍

NATIONALITY Age 年齡 (please tick age group)

職業

OCCUPATION

學歷

SCHOOL and highest class reached

大專學歷

HIGHER and/or FURTHER EDUCATION

18-19  
20-29  
30-39  
40-49  
50-59  
over 60

DATE 日期

SIGNATURE 簽字

X

DATE

REG. NO.

COURSE NO.

AMOUNT

X

DATE

REG. NO.

COURSE NO.

AMOUNT

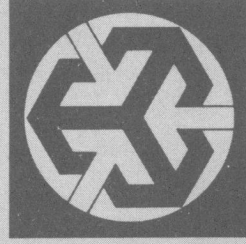

NAME  
FULL POSTAL  
ADDRESS

If you are applying by post and require an acknowledgment of your application, please complete this part

Note: This application acknowledgment is not complete without validation by official printing machine entry of the details at X above at the University or Town Centre office of the Department of Extra-Mural Studies, University of Hong Kong.

Fees are not refundable once the course has commenced.

Please see overleaf.



**預早報名之重要**

有志修讀本部課程者應儘早報名，如不預先報名可引致各該課程延期開課或取消。預先報名乃是使本部得知各界對種種課程反應之唯一途徑，故報名表格應從速寄回本部。

**PRIOR ENROLMENT IS ESSENTIAL**

Failure to enrol prior to the opening of a particular course, may mean the cancellation of that course. Prior enrolment is the only way the Department of Extra-Mural Studies has of judging the response to its courses. Your cooperation is therefore invited in sending your application forms to the Department as soon as possible.

香港大學校外課程部

**UNIVERSITY OF HONG KONG DEPARTMENT OF EXTRA-MURAL STUDIES**

A 與 B 聯填寫後附學費  
送交香港大學校外課程  
主任，

THE WHOLE OF THIS FORM TOGETHER WITH THE APPROPRIATE FEE SHOULD BE  
SENT TO THE DIRECTOR OF EXTRA MURAL STUDIES  
THE UNIVERSITY OF HONG KONG

繳費可用支票或現金，如  
用支票請抬頭「香港大學  
」并加橫線逕寄本部。

PAYMENT MAY BE MADE IN CASH OR BY CHEQUE AT THE UNIVERSITY OR BY POST  
CHEQUES SHOULD BE CROSSED AND MADE PAYABLE TO "UNIVERSITY OF HONG KONG"

除非課程臨時取消或改期，請依照公佈日期上課，本部不另通知。如報名申請未被接受，學費將退還，但課程開始後，學費通常不能退還。

THE ISSUE OF AN ENROLMENT APPLICATION ACKNOWLEDGMENT DOES NOT OF ITSELF  
CONSTITUTE ACCEPTANCE OF THE APPLICATION, BUT IF YOU DO NOT HEAR OTHERWISE  
BEFORE A COURSE STARTS, YOU MAY ASSUME YOU HAVE BEEN ACCEPTED IF FOR  
ANY REASON YOU ARE NOT ACCEPTED YOUR FEE WILL BE RETURNED, BUT OTHERWISE  
FEES ARE NOT NORMALLY REFUNDABLE

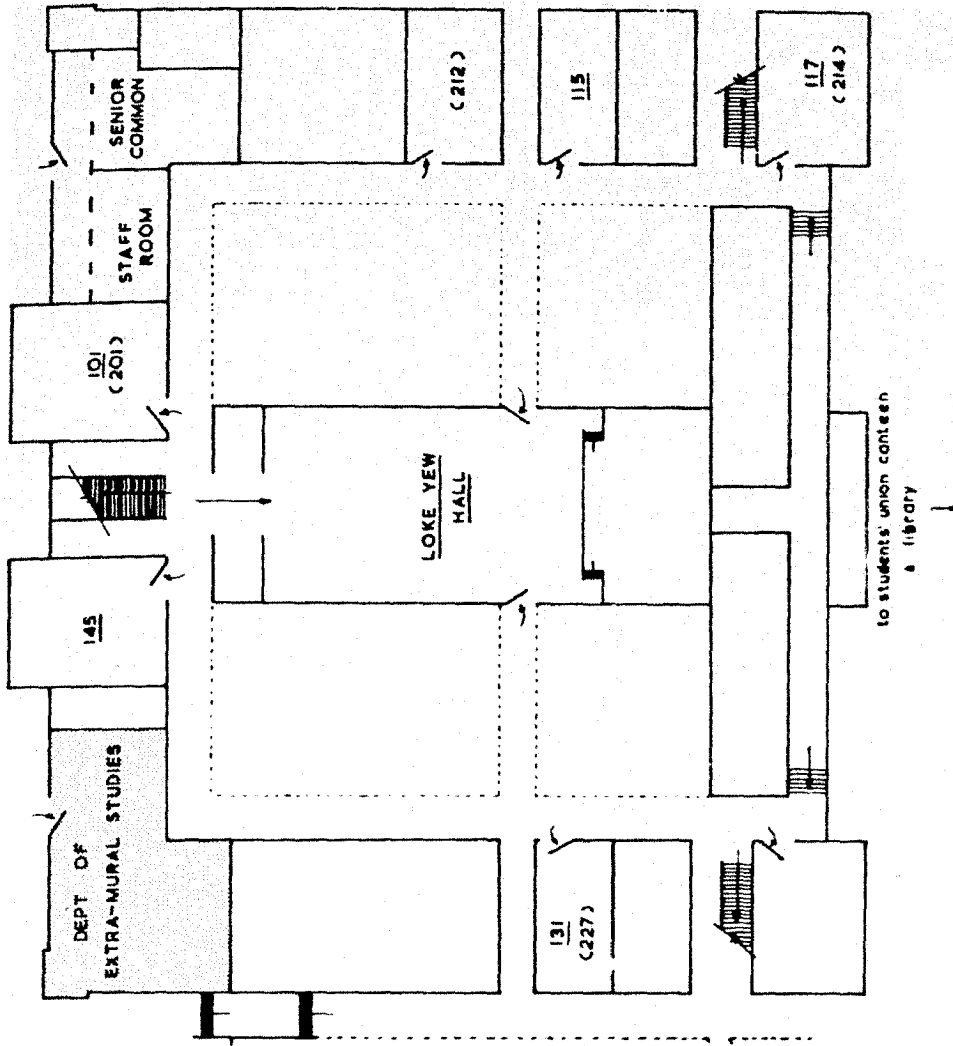

**GROUND PLAN OF UNIVERSITY OF HONG KONG MAIN BUILDING**  
 Showing room locations used for Extra Mural Studies courses. Please see inside of front cover for University general layout.



SPRING SUPPLEMENT

PROSPECTUS 1968-9

香港大學校外課程手冊  
一九六八至一九六九

Extra Mural Studies

University of Hong Kong