

Extra Mural Studies  
University of Hong Kong

一九六九至一九七零  
香港大學校外課程手冊



HKS  
374  
U5

Prospectus 1969-1970

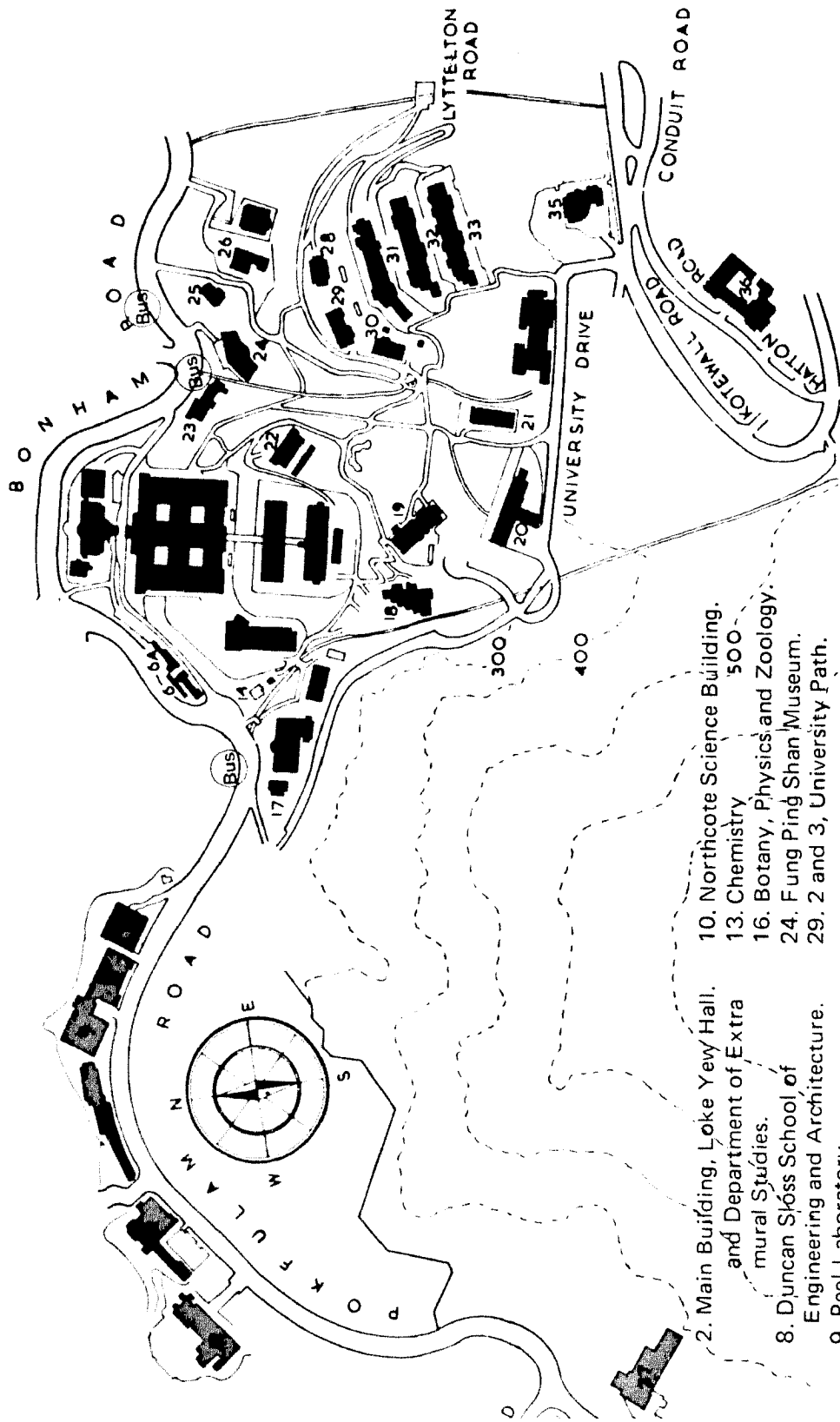

### UNIVERSITY OF HONG KONG GENERAL LAYOUT

Please see inside of rear cover for enlarged plan of Main Building (2) and room locations

**University of Hong Kong**



---

**Extra Mural Studies**



## STAFF

### *Director*

R.A. Williams, M.A. (Wales)

### *Deputy Director*

J.W. England, B.A. (Nottingham)

### *Assistant to the Director*

Mrs. Priscilla Tso, B.A., Dip. Ed. (H.K.)  
Dip. Ad. Ed. (Manch.)

### *Staff Tutors*

Mrs. Nana Tsao, B.A. Dip. Ed. (H.K.)  
C.K. Leung, B.A. (H.K.) (on leave)  
Jon A. Prescott, B.Arch., M.C.D. (Liv.),  
A.R.I.B.A., A.M.T.P.I.  
D.J.H. Macintosh, M.A. (Cantab.)

### *Assistant Staff Tutor*

Edward K.Y. Chen B.A. (H.K.)

### *Secretary*

Mrs. Yvonne Wong

## ACKNOWLEDGEMENTS

We would like to record our grateful acknowledgement to the following individuals, schools and organizations for permission to use their premises:-

*The British Council*

*Design + Research Co-ordinators Ltd.*

*Education Department, Government of Hong Kong*

*The Goethe Institute*

*The Government Printer*

*Grantham College of Education*

*King's College*

*The Management of City Hall*

*Resettlement Department, Government of Hong  
Kong*

*University Hall.*

## GENERAL INFORMATION

1. There are normally no entry requirements except that applicants should be over 18 years of age. Occasionally to have the full benefit of a course applicants must possess certain defined qualifications. Applicants are therefore advised to read the description of a course carefully. Professional courses usually have clearly defined entry requirements.
2. The Director may at his discretion refuse to admit an applicant.
3. Unless otherwise arranged no Extra-Mural lectures will be held:-
  - a) on any public holidays.
  - b) at a storm warning signal of No. 5 or above.
  - c) during the following holiday periods:- 24th December to 3rd January 1970 (Christmas and New Year)  
4th to 10th February 1970. (Chinese New Year)
4. The course fee will cover the entire duration of a course or part of a course. Fees are not refundable once the course has commenced.
5. Certificates of Attendance are issued on payment of 50 cents, to those who have attended not less than two thirds of a course of at least 20 meetings duration.
6. Closing date for enrolment: One week before the starting date of a course. Late enrolments may not be accepted.
7. For enquiries, please ring either H-468161 Ext. 309 or H-226529 during office hours.
1. Complete the attached enrolment form and mail it to the Director, Department of Extra-Mural Studies, University of Hong Kong. Forms are also available on request.  
To ensure that a class can take place, the Department would appreciate early enrolment by applicants.
2. You should send your application form together with the appropriate fee either in the form of a postal order, money order or crossed cheque made out in favour of the UNIVERSITY OF HONG KONG.
3. You will be notified if you are not admitted because of over-subscription or other reasons. The Department will NOT notify successful applicants who are expected to attend the first meeting of the class at the place and time advertised.
4. Applicants can also enrol in person at the following places:-
  - (i) Department of Extra-Mural Studies, University of Hong Kong, University Main Building, Ground Floor, Pokfulam Road. (during office hours) (Buses No. 3, 4, 7, 23) Tel: H-468161 Ext. 309.
  - (ii) Extra-Mural Town Centre, Universal House, 11th Floor, 151, Des Voeux Road Central, entrance from Gilman Street (next to Tamaya Department Store). Tel: H-226529. (From 12 noon to 8 p.m.)

## HOW TO ENROL

## 入學須知

1. 學員申請資格，除特別規定學歷之課程外，其他課程，祇需要年齡超過十八歲者，不限資格，均可申請入學。學員應詳閱課程簡介。
2. 學員被取錄與否概由校外課程部主任審核報名申請書後決定之。
3. 除特殊情形外，本部在下列期間不授課：
  - 甲、本港公眾假期。
  - 乙、本港天文臺懸掛五號或以上風球之後。
  - 丙、聖誕節及新年假期：一九六九年十二月廿四日至一九七〇年一月三日。
  - 丁、農曆新年假期：一九七〇年二月四日至十日。
4. 本手冊內之學費係指課程之全期學費。課程開始後，學費通常不能退回。
5. 授課時間通常每講一小時。
6. 凡課程在廿講以上而學員上課次數超過三分之二者，得向本部繳費五角後申請發給聽講證書。
7. 學員應於開課一星期前報名，過期報名可能不被接受。又任何課程額滿後，即隨時截止報名，故學員應儘早報名。
8. 本部詢問電話 H-468161 (內線309) 或 H-226529。

## 報名手續

1. 填妥附於本手冊之報名申請書後，逕寄香港大學校外課程部主任收。申請書可隨時向本部索取。
2. 繳費可用支票，銀行本票，或郵政滙票，抬頭「香港大學」隨同申請書逕寄港大校外課程部主任收。如用現金則請至本部繳納。
3. 如申請人已獲取錄，本部不再通知，可依時上課。如未獲取錄，則另函通知。
4. 申請人亦可親往下列地點報名：
  - 甲、薄扶林道香港大學校外課程部(辦公時間內) 電話：H-468161 (內線309)
  - 乙、香港德輔道中一百五十一號環球大廈十二樓(入口在機利文街，玉屋百貨公司右側) 校外課程部市區中心。電話：H-226529(正午至下午八時)

# Contents



ARCHAEOLOGY	7
ARCHITECTURE & BUILDING SCIENCE	8
Building Science, Practice & Management	
Certificate Course in Housing Management	
Appreciation	
ART & DESIGN	13
Certificate Course in Art & Design	
Foundation Courses	
Foundation Courses Complementary Studies	
Fine Art	
Complementary Courses, History, Appreciation	
Vocational: Interior Design	
Vocational: Advertising Design	
CHINESE STUDIES	29
Art	
Literature	
History	
Philosophy & Sociology	
ECONOMICS, COMMERCE, MANAGEMENT	34
Economics	
Commerce	
Hospital Administration	
Chartered Institute of Secretaries C.I.S.	
Accountancy	
Management	
EDUCATION	43
ENGLISH STUDIES	44
English as a Second Language	
English for Teachers	
English Studies for Commercial Use	
English for critical appreciation	

GEOLOGY & GEOGRAPHY	49
HISTORY & INTERNATIONAL AFFAIRS	52
LANGUAGES – ORIENTAL	54
Chinese Programme	
Daytime Programme	
Japanese Programme	
LANGUAGES – EUROPEAN	57
First Year Courses	
Second Year Courses	
Third Year Courses	
LAW	59
London External LL.B.	
LIBRARIANSHIP	61
Certificate Course for Library Assistants	
MATHEMATICS	63
PHILOSOPHY & PSYCHOLOGY	64
Philosophy	
Psychology	
SCIENCE	67
Botany & Biology	
University Certificate Courses in Engineering	
URBAN & REGIONAL PLANNING	70
Traffic Engineering	
PROFESSIONAL & VOCATIONAL COURSES	72
DAYTIME COURSE	74
INDEX TO COURSES	76

#### **PRIOR ENROLMENT IS ESSENTIAL**

Failure to enrol prior to the opening of a particular course, may mean the cancellation of that course. Prior enrolment is the only way the Department of Extra-Mural Studies has of judging the response to its courses. Your co-operation is therefore invited in sending your application forms to the Department as soon as possible.



# Archaeology

Staff Tutor in Charge: Jon A. Prescott, B. Arch., M.C.D., (Liv.); A.R.I.B.A.; A.M.T.P.I.;  
Telephone No. 226613

---

**A PRACTICAL INTRODUCTION TO ARCHAEOLOGY** Dr. S.M. Bard, M.B., B.S.,  
(H.K.), Hong Kong Archaeological Society *Wednesdays 5.45-7.00 p.m., starting  
17th September, 1969.* Extra Mural Town Centre. 12 meetings plus 2 museum visits  
and 3 site visits. *Enrolment is limited to 30 persons.* *Fee: \$50*

176

The museum visits will be arranged during the course at times to be announced, the other visits will take place on Sundays in November to sites in Lamma and Lantau Islands. The cost of the course does not include expenses in connection with field visits.

Instruction will deal with the fossil record of early man and the general field of prehistory, archaeological techniques and questions of chronology in relation to tools and pottery. Special reference will be made to the prehistory of China and to sites in Hong Kong. An introductory study of method and techniques in archaeology will precede the site visits. The talks will be illustrated by exhibits which can be handled by the students and by many slides.

---

**THE ART OF BRONZE AGE CHINA** James C.Y. Watt, B.A. (Oxon.) Assistant  
Curator Art Gallery & Museum *Mondays 8.00-10.00 p.m., beginning 6th October,  
1969.* Extra Mural Town Centre. 4 double sessions. *Fee: \$35*

177

An introduction to the bronze art of Shang and Chou China with special reference to the historical background and social organisation. The lectures will be well illustrated.

# Architecture and Building Science

*Staff Tutor in Charge:* Jon. A. Prescott, B. Arch.; M.C.D. (Liv.); A.R.I.B.A.; A.M.T.P.I.;  
*Telephone No.* 226613

These courses are of two types. Group A is aimed at professional persons, building developers and others involved in the building operation. The courses are either in the nature of mid-career instruction of the refresher type, or provide an opportunity for professionals to discuss relevant and new issues.

Group B is related to the appreciation and understanding of Architecture as a Fine Art and is intended mainly for interested laymen, though professionals may well find them of value.

## A Building Science, Practice and Management

- 17 **STRUCTURAL METHODS AND SLIPFORM TECHNIQUE IN HONG KONG BUILDING** Organizer Jon A. Prescott, B. Arch., M.C.D., A.R.I.B.A., A.M.T.P.I. Extra Mural Town Centre. *Wednesday, October 7, 1969.*

This one day Symposium will provide an opportunity for experts (engineers, contractors and architects) to discuss Slip Form Techniques in association with methods of construction associated with this system.

Papers will be read and discussions held as follows:-

**GENERAL PLANNING & STRUCTURAL CONCEPTS** including relationship of core, shear walls and other structural elements. Precasting of associated members. Economic feasibility.

**PRACTICAL PROBLEMS OF TECHNIQUE** including details of shuttering method. Constructional Sequence. Connections. Contracting problems.

**DETAILS OF ACTUAL PROJECTS IN HONG KONG** including reports by the designers and professional persons involved to assess the effectiveness, efficiency and general usefulness under Hong Kong conditions.

The Symposium will last for one day, but will be supported by a small Exhibition of relevant material.

Full details, a timetable and copies of contributory papers will be circulated to participants prior to the date of the Symposium.

Participation will be by invitation but persons wishing to take part are requested to apply for details to Mr. J.A. Prescott.

There will be a small charge to cover lunch and printing costs not more than \$15.

---

## Certificate in Housing Management

*Staff Tutor in charge:* Priscilla Tso B.A., Dip. Ed. (H.K.), Dip. Ad. Ed. (Manch).  
*Telephone No.* 468161 *Ext.* 303.

### CERTIFICATE IN HOUSING MANAGEMENT

The aim is to provide a local qualification in Housing Management for people already working in the field and for others hoping to take up housing management as a career. The course is intended to provide a firm grounding in the theory and practice of housing management.

The standard and content of the course and its examinations are designed to be the equivalent of the Diploma in Housing Management sponsored by the United Kingdom Institute of Housing Managers. The syllabus is related to that of the Institute but will be strongly geared to local relevance.

The course runs over three academic years. Year I and II prepares candidates for the Intermediate Examination and Year III for the Final Examination.

A Certificate in Housing Management issued by the Department of Extra-Mural Studies, University of Hong Kong, will be awarded to a candidate on passing the Final Examination and on producing evidence of having had at least two years' approved experience in housing management work.

Fee: Year I - \$600  
Year II - \$600  
Year III - \$800

Further details are available on request.

*No applications can be accepted this year as the course is already full. Applications for 1970-71 must be submitted between June 1 and August 1, 1970.*

---

## Appreciation B

### BACKGROUND TO JAPAN

*A Study in connection with Man Made Environment, Arts & Architecture.*

This series of courses has been arranged to coincide with the Osaka International Exposition 'Expo 70' which opens on the 15th March, 1970 and is the world exposition to be held in Asia.

The Study will concern itself with the man made environment and Arts and Architecture of Japan in the context of an emergent industrialised nation having powerful traditional ties, and will cover both these traditional elements and modern aspects of Japanese culture.

Lecture courses commenced in January 1969 and have covered basic studies of the historical outline up to the turn of the Century including archaeology and a limited discussion of geographical features.

Further studies are planned as follows in Spring 1970;

---

178

### THE NEW JAPAN

Historical Outline: The Emergence of a New Nation 1900-1970 Architecture: Modern Design of World Significance. Urban & Regional Planning Problems and Work Studies. Contemporary Trends in Fine and Applied Arts. Economic and Industrial and Commercial Organisation.

Participants wishing to take a Japanese language course at an elementary level and with emphasis on conversational everyday phrases will find a suitable course under languages during the Autumn and Spring Terms 1969-1970.

*The lecture programme will be augmented from time to time both by additional items and an extensive programme of films.*

*The programme is presented with the co-operation of the Japan Cultural Centre.*

---

---

**THE BASES OF JAPANESE TRADITIONAL DESIGN** Jon A. Prescott, B. Arch., M.C.D., A.R.I.B.A., A.M.T.P.I. general coordinator plus panel of lecturers. *Thursdays 7.00-8.00 p.m., starting 25th September 1969.* 10 Sessions. Extra Mural Town Centre. *Fee: \$45*

The theatre, Noh Plays, Kabuki and Bunraku, Mythology & Literature. Religion and its importance to design. Shinto, Zen and Buddhism. Traditional Architecture & Garden Design. The craft of the Potter, Traditional Arts, Painting, Printing & Sculpture.

---

..... please cut along this line .....

### VISIT TO EXPO '70

Tear off this slip and return to Jon A Prescott, Extra Mural Department, Town Centre, 151 Des Voeux Rd. Central, Universal House 12/F. Hong Kong.

Application for further information about the 'Expo' Visit including detailed itinerary.

Name

Telephone

Address

The 'Expo' Visit will take place between 26th or 27th March to 4th or 5th April 1970

The approximate cost will be about \$2,200 or less if it can be arranged.

**FULL APPLICATION MUST BE MADE BEFORE SEPTEMBER 15th 1969. NO APPLICATIONS WILL BE CONSIDERED AFTER THIS DATE AS FINAL BOOKINGS WILL HAVE TO BE MADE IN JAPAN.**

We shall require a definite signature and part payment (40%) at that time committing applicants to participation.

The tour is conditional on there being a minimum number of applicants.

It is hoped that arrangements can be made for participants to spend more time in Japan after their visit to Expo.

---

A SMALL EXHIBITION OF CERTIFICATE STUDENTS' WORK IN ART AND DESIGN SUBJECTS PREPARED DURING THE PAST TWO SESSIONS WILL BE HELD IN THE STUDIOS OF THE EXTRA MURAL TOWN CENTRE BETWEEN SEPTEMBER 8th - 19th 1969. ALL ARE WELCOME.

# Art and Design

*Staff Tutor in Charge:* Jon A Prescott, B. Arch (Liv.); M.C.D., A.R.I.B.A., A.M.P.T.I.  
*Telephone No.* 226613

The courses in Art & Design are primarily planned to give a balanced basic visual education (both practical and theoretical) on which subsequent study can be soundly based.

Commencing this year, the previous Pre-Certificate training, consisting of one term of 12 weeks will be extended to encompass a full academic year of 27 teaching weeks and this will be regarded as a FOUNDATION YEAR with, as a consequence, the vocational elements of the three year Certificate Course restricted to the two final years. Students will be given introductory talks on the vocational aspects of the Design Courses, which can be undertaken within the somewhat limited means at our disposal. The object of even the vocational aspect of these programmes is to provide a general rather than a particular study so as to open students' eyes to the wider opportunities rather than to provide a narrow specialism in terms of design.

It is emphasised that Design cannot be practised in a vacuum or without a full technical understanding of the media involved, and the inclusion of specific courses in for example technological subjects, or in management and costing techniques, is essential for students wishing to put their more intuitive skills, and their understanding of form and colour, to practical and business use.

The Integration of Design skills into the Management and Industry of Hong Kong is one of the present great needs of the community; and the courses are envisaged as being of practical use in helping to meet this requirement.

Art & Design Courses are arranged so as to be available on a Liberal Studies basis for the general student.

Owing to the limitations of space and in the interests of good teaching the numbers accepted will be limited, with priority, of course, given to Certificate Students over those wishing to attend individual courses in isolation.

## Certificate Courses in Art and Design

*Advisory Panel*

MICHAEL F. GRIFFITH, A.T.D.  
KWOK CHIU LEUNG, DIP. A.D.  
KWONG YEU TING, M.SC. (KANSAS)  
HENRY STEINER, M.F.A. (YALE)  
JOHN WARNER, A.T.D., N.T.D.

*Director of Studies*

Jon A. Prescott, B. Arch., M.C.D., A.R.I.B.A., A.M.T.P.I.

### *Course Tutors*

Ruth H. Addison, Dipl. Arch., A.R.I.B.A.  
Tomas Almqvist, Swedish National Diploma in Design (Stockholm)  
R. A. Callow P.I.S., Dip. Arch. (Lincs.), F.R.I.B.A., A.P.A.M.  
Martin Bradley  
John Burfield, Architekt S.I.A., Dip. Arch., A.R.I.B.A.  
R.K. Cheng, B.A. (Econ) St. John's Tech. Cert. Printing C & G. London  
David W. Crowe, Dipl. Arch. (Liv.), A.R.I.B.A.  
Michael F. Griffith, A.T.D.  
Cesar A. Guillen-Nunez, B.A. (Hons.) Courtauld Institute of Art, University of London  
Albert H. Hill, I.A. Dip.  
Tao Ho, B.A. (Williams) B. Arch. (Harvard)  
Kwok Chiu Leung, Dipl. A.D.  
Kwong Yeu Ting, M.Sc. (Kansas)  
Julian A. Losinski, M.S.I.A., N.D.D., Dip. A.D.  
Bryon Pederson, B. Arch., A.R.A.I.A.  
Jon A. Prescott, B. Arch., M.C.D., A.R.I.B.A., A.M.T.P.I.  
P.W. Printer, N.D.D., M.S.I.A.  
Paul Selinger, M.F.A., (San Francisco Art Institute)  
Henry Steiner, M.F.A. (Yale)  
B.S. Vaughan D.C.  
Marcia Tanner, B.F.A. (Oklahoma)  
Wucius C.K. Wong, M.F.A. (Maryland)  
Additional Tutors will be appointed as required.

### *Course Syllabuses and Examinations*

Each complete Certificate Course covers three years. A year consists of two unequal length terms, the first of 12 weeks and the second of 15 weeks, making a total of 27 weeks in all. In courses which are predominately studio orientated, the work produced during the terms plus any vacation period tasks will be assessed as a whole at the end of each year by an Examining Board, consisting of the Advisory Panel and Course Tutors as relevant. Certain subjects will be examined by written papers.

Detailed requirements for written examinations will be made known as the course proceeds and adjustments in the syllabus and requirements may be made from time to time at the discretion of the Director of Studies and the Board.

After completion of the initial year the student will select one out of the three present streams of Fine Art, Advertising Design or Interior Design, and will take the lecture series and studio sessions which have been grouped so as to provide a scheme of systematic study leading, over two years, to the Certificate in Art and Design. The choice of streams may well be eventually enlarged by adding other subject areas as this becomes possible.

### *Entry Requirements*

Evidence of a good working knowledge of English is an essential for most Certificate and other courses in Art & Design. In view of the few facilities in schools to make Art a subject for the Hong Kong or London Certificate of Education, Ordinary or Advanced level, no formal requirements in these subjects are made for entry to the Certificate Course. A sound general education up to Ordinary levels G.C.E. and compliance with the age requirements for Extra Mural enrolment, (18 years minimum), is necessary.

Candidates will be selected by interview and mature students will be admitted on evidence of interest or professional involvement without necessarily possessing G.C.E. passes.



It is only fair however to point out to candidates who wish to follow further courses of study, in for example the United Kingdom, that a minimum entry requirement of 5 "O" level passes plus 2 "A" level passes or 3 "A" level passes plus evidence of a good general educational background represent minimum standards for entry to 1st Degree or equivalent level courses in Art & Design overseas and for which a good portfolio from our Certificated; Foundation type, course might provide a background for entry.

#### ***Materials and Equipment***

All students will be required to have a portfolio (size 35" x 25" min.) for storage of studio work during the term. This is particularly important as *all* work is required for the examination at the end of each year. Facilities are provided adjacent to the studios for storing these on the premises to save constant transportation of a bulky item. In addition students will be required to purchase:

- A double elephant size T square
- A double elephant drawing board (for home use)
- 45° and 60° set squares
- Drawing, scales, instruments and pens (a basic minimum only)
- Brushes, acrylic or oil paint, poster paint, water colours, pencils, etc. as required
- Drawing paper of various types.

Advice will be given on equipment needed prior to the commencement of each course and students should wait until they have been so briefed before they purchase, to avoid buying needlessly complex or expensive equipment not required by the tutors or lecturers.

A retail shop is open on the premises for the convenience of students at times suited to the lectures and studio periods, so that purchases can be made during the time of instruction as required.

#### ***Acknowledgements***

The department and director of art and design studies would like to thank the under-mentioned for their generosity in donating equipment & material for the courses.

The British Council	14 Fine Art Prints by eminent British Artists.
Messrs Jackson Wain & Harper	A flatbed proofing press
Spence Robinson Architects	A large number of bound volumes of periodicals for the Design Library.

#### ***Fees:***

The course fee for the Foundation year will be \$550  
The course fee for Years II and III will be \$450

Fees are to be paid in advance. Registration will be accepted for a *whole year* only.

Examination fees are extra, payable in advance.

Special fees for hire of models and essential materials purchased will be paid in advance of the particular course requiring them.

**PRESCRIBED COURSES FOR CERTIFICATE STUDENTS  
YEAR ONE TERM 1 (FOUNDATION)**

---

1. Introduction to Ideas on Aesthetics	(28)	Jon A. Prescott
2. Formal Relationships & Textures	(20)	Tao Ho
3. Techniques of Draughtsmanship I	(22)	Ruth H. Addison
4. Basic Vision & Experimental Drawing	(23)	Martin Bradley
5. Anatomy for Art Students	(27)	B.S. Vaughan
6. Painting Studio	(24)	Marcia Tanner

---

**YEAR TWO TERM 3**

1. Society & Art	(41)	Tomas Almberg
2. History of Art II	(39)	Cesar A. Guillen-Nunez
3. Life Drawing	(30)	M.F. Griffith
<b>FINE ART</b>		
4. Painting Studio II	(32)	Y.T. Kwong
5. Three Dimensional Design	(33)	Paul Selinger
6. Painting Inquiry	(36)	Wucius C.K. Wong
a Chinese Painting (optional)	(43)	Lawrence C.S. Tam
<b>ADVERTISING DESIGN</b>		
4. Advertising Studio II	(50)	Julian Losinski
5. Printing Technology	(52)	R.K. Cheng
6. Basic Photographic Techniques & Illustration I	(54)	Albert Hill
<b>INTERIOR DESIGN</b>		
4. Interior Studio II	(44)	Ruth H. Addison
5. Nature of Materials & Detailing	(46)	Ruth H. Addison
6. Technical Services	(47)	R.A. Callow
a Three Dimensional Design (Optional)	(33)	Paul Selinger

---

**YEAR THREE TERM 5**

1. Society & Art	(41)	Tomas Almberg
2. History of Art (Special) III	(40)	Cesar A. Guillen-Nunez
3. Life Drawing & Modelling	(31)	Tomas Almberg
4. Special Study by arrangement	(individual tutor)	
<b>FINE ART</b>		
5. Fine Art Studio	(37)	Cheung Yee
6. Three Dimensional Design	(33)	Paul Selinger
7. Painting Inquiry	(36)	Wucius C.K. Wong
<b>ADVERTISING DESIGN</b>		
5. Advertising Studio III	(51)	Henry Steiner
6. Processes of Production	(56)	Patrick Printer
7. Photography Techniques II	(55)	Albert Hill
<b>INTERIOR DESIGN</b>		
5. Interior Studio III	(45)	Jon A. Prescott
6. Nature of Materials & Detailing II	(49)	John Burfield
7. Technical Services	(47)	R.A. Callow

---

## Foundation Courses

ALL STUDENTS WISHING TO TAKE THE CERTIFICATE COURSES WILL NORMALLY TAKE THE FULL FOUNDATION YEAR STUDIES.

---

**FORMAL RELATIONSHIPS AND TEXTURES** Tao Ho, B.A. (Williams) B. Arch. (Harvard) *Mondays 6.00-7.00 p.m., tutorial 7.00-8.00 p.m., starting 22nd September, 1969.* Extra Mural Town Centre. 12 meetings. 20  
*Fee: \$75*

The course will consider two dimensional formal relationships basic to any understanding of visual pattern making and composition. Analysis of textural quality will accompany the exploration of the sensual effect of different materials.

Instruction will be given in the form of a series of exercises which will be used as a starting point for discussion each week, but this is basically a lecture series having no studio work during the period of instruction.

---

**RELATIONSHIP OF COLOUR** Tao Ho, B.A. (Williams) B. Arch. (Harvard) *Commencing in January 1970.* 21

A complementary series of 15 lectures to follow up discussion on Form and Texture. Consideration will be given to theories of colour and organisation, and basic phenomenon such as contrast, harmony, discord and transparency.

---

**TECHNIQUES OF DRAUGHTSMANSHIP I** Ruth H. Addison, Dipl. Arch. (U.C.L.) A.R.I.B.A.. *A Wednesdays 6.00-8.00 p.m., B Wednesdays 8.00-10.00 p.m., starting 1969.* Extra Mural Town Centre. 12 meetings, once weekly continuing into Term 2 (Spring 1970) for a further 15 periods. Fee \$75 (12 periods) \$90 (15 periods) \$150 (27 periods). 22

Students will be initiated into the use of general drafting equipment and by means of various graduated exercises will learn the process of draughting for various projections, orthographic isometric and axonometric, and basic methods of setting up different perspectives and sciagraphy. Emphasis will generally be given to lettering, layout and presentation of these drawings and special study of letter forms in relation to communication and their visual relationships.

---

**BASIC VISION & TECHNIQUES OF DRAWING** Martin Bradley. *A Wednesdays 8.00-10.00 p.m., B Wednesdays 6.00-8.00 p.m., starting 24th September, 1969.* Extra Mural Town Centre. 12 meetings once weekly. *Enrolment is limited to 25 students.* 23  
*Fee: \$75*

The exploration of a wide variety of drawing tools on a diverse variety of paper and surfaces giving varied mark making exercises will be followed by an exploration of ways of "seeing" an object.

A series of exercises will allow students to appreciate the problems of each idea in terms of presentation.

- 
- 24** **PAINTING STUDIO I** Marcia Tanner, B.F.A. (Oklahoma) A *Tuesday 6.00-8.00 p.m.*, B *Tuesdays 8.00-10.00 p.m.*, starting *23rd September, 1969*. Extra Mural Town Centre. 12 meetings, once weekly (continuing into Term 2 for further 15 meetings). *Fee: \$70 (12 periods) \$90 (15 periods) \$150 (27 periods)*.

The purpose of the painting studio is to create a professional environment in which both directed and voluntary studies can be pursued. The tutor who is practising artist, will discuss the practical problems of different techniques, materials, brushes and tools and will use the student and other work for example and critical discussion. The Studio work is aimed at integrating the knowledge which is being acquired through parallel Foundation courses.

Students will provide their own materials.

- 
- 25** **LIFE DRAWING I** Michael F. Griffith, A.T.D. *Commencing in January 1970*.

A course of 15 two hourly periods. A beginners class. Special attention will be given to the interpretation of the previous study of Anatomy and to techniques of drawing. Students will not be accepted who have not pursued "Anatomy for Art Students".

- 
- 26** **INTRODUCTION TO THREE DIMENSIONAL DESIGN** Paul Selinger, M.F.A. (San Francisco Art Institute). *Commencing in January 1970*.

A course of 15 studio/workshop sessions introducing students to three dimensional considerations of design, modelling and sculpture.

Two groups limited to 25 students each will be accommodated.

## Foundation Courses-Complementary

THESE COURSES ARE INCLUDED IN THE FOUNDATION YEAR

- 
- 27** **ANATOMY FOR ART STUDENTS** Dr. B.S. Vaughan, D.C. A *Thursdays 8.00-10.00 p.m.*, B *Thursdays 6.00-8.00 p.m.*, starting *25th September 1969*. Extra Mural Town Centre. 12 meetings once weekly. *Limit of enrolment for any one class 25 students.*  
*Fee: \$75*

A small extra charge will be made on the evenings when a model is present – not in excess of \$3.00 per student, per evening.

An understanding of the structural framework of the human form, through a knowledge of basic anatomy is essential for all practising artists. Dr. Vaughan's course will provide a sound general background with instruction moving from consideration of overall aspects to detailed analysis of individual limbs and parts of the whole body – both in repose and in movement.

This course will *not* be a medical anatomy; bone structure, muscles and bloodvessels only being introduced in relation to their significance for the artist. Dr. Vaughan has considerable experience in illustration and is himself a painter. Students will spend a proportion of their time drawing from a model.

---

**INTRODUCTION TO IDEAS ON AESTHETICS** Jon A. Prescott, B. Arch., M.C.D., A.R.I.B.A., A.M.T.P.I. Henry Steiner, M.F.A. (Yale) *Mondays 8.00-9.00 p.m., starting Sept. 29th, 1969.* Extra Mural Town Centre. 10 meetings, once weekly. *Fee: \$50*

28

Aesthetics is usually considered to be the study of beauty in art, but as standards of beauty have altered through history, it might more broadly be defined as the study of the rules that make art "Art". Accepting the idea that there are laws of perception, as well as ideals of proportion, contrast and harmony – which even the most apparently "formless" and "meaningless" modern art acknowledges by rebelling against them – this course seeks to examine these underlying rules as they apply to the visual arts. Through lectures, slides and discussion the course will attempt to awaken those with little previous background or training to the rational basis of art and equip them with a set of standards to use in judging for themselves the merits of works of "pure" or applied art.

---

**HISTORY OF ART I INTRODUCTORY COURSE** Cesar A. Guillen Nunez, B.A. (Hons.) Courtauld Institute of Art, London University. *Commencing in January 1970.*

29

This course will cover a general analysis of methodology and a framework of History from Lascaux to the present day.

---

## Fine Art

*See also*

<b>FORMAL RELATIONSHIPS &amp; TEXTURES</b>	(20)
<b>RELATIONSHIP OF COLOUR</b>	(21)
<b>BASIC VISION &amp; TECHNIQUES OF DRAWING</b>	(23)
<b>PAINTING STUDIO I</b>	(24)
<b>LIFE DRAWING I</b>	(25)
<b>INTRODUCTION THREE DIMENSIONAL DESIGN</b>	(26)

---

**LIFE DRAWING II** Michael F. Griffith, A.T.D. and Tomas Almborg, Swedish National Diploma (Stockholm) *Mondays 8.00-10.00 p.m., starting 22nd September, 1969.* Extra Mural Town Centre. 12 meetings. Continuing in Term 4 (Spring 1970) for a further 15 periods. *Enrolment is limited to 25 students.* A model will be used for which there will be additional charge of approximately \$25 per term. *Fee \$70 (12 periods) \$90 (15 periods) \$150 (27 periods).*

30

**MODEL FEES MUST BE PAID AT THE SAME TIME AS THE CLASS FEE.**

Term 3 M.F. Griffith.

Term 4 Tomas Almborg.

The discipline of drawing from life has long been recognised as the finest training in the correlation of hand and eye for any artist or designer. The use of different media will be encouraged.

This course is aimed at students who have achieved an Intermediate level of competence.

- 
- 31** **LIFE DRAWING III AND MODELLING FROM LIFE** Tomas Almberg, Swedish National Diploma (Stockholm). *Fridays 8.00-10.00 p.m., starting 26th September, 1969.* Extra Mural Town Centre. 12 periods. Continuing into Term 6 (Spring 1970) for a further 15 periods. *Enrolment is limited to 20 students.* A model will be used for which there will be an additional charge of approximately \$25, per term. *Fee \$80 (12 periods) \$100 (15 periods) \$165 (27 periods)*  
MODEL FEES MUST BE PAID AT THE SAME TIME AS THE CLASS FEE

Studies will be made both in two and three dimensions. Stands and materials will be made available for use in modelling.

Students should have experience of life drawing.

- 
- 32** **PAINTING STUDIO II**  
Y.T. Kwong M.Sc. (Kansas) *Tuesdays 6.00-8.00 p.m., starting 23rd September, 1969.* Extra Mural Town Centre. 12 meetings. Continuing in Term 4 (Spring 1969) for a further 15 periods. *Fee \$70 (12 periods) \$90 (15 periods) \$150 (27 periods)*  
Enrolment is limited to 25 students.

An intermediate level class for continued painting experience. The aim is to allow individual students to develop at their own pace under expert guidance. Non certificate students who have taken Part I Painting or who have a little experience already will be welcome

- 
- 33** **THREE DIMENSIONAL DESIGN** Paul Selinger, M.F.A., (San Francisco Art Institute) and Cheung Yee. *Wednesdays 6.00-8.00 p.m., starting 24th September, 1969.* 12 periods. Continuing into Term 4 (Spring 1970) for a further 15 periods. *Enrolment limited to 25 students. Fee: \$90 (12 periods) \$90 (15 periods) \$150 (27 periods).*

Term 3 & 5 Paul Selinger      Term 4 & 6 Cheung Yee

A series of studio/workshop sessions enabling students to further explore the problems of three dimensional composition and sculpture Students will work on practical problems in various media and should be prepared to devote additional time to that involved in formal tuition, to the further development of their work. The studio will remain open until 10 p.m. after the completion of formal tuition and can be made available by arrangement.

If numbers are large these classes will be separated, on different evenings. Space having been reserved on thursdays.

- 
- 34** **A BEGINNER'S COURSE IN DRAWING & PAINTING** Peter Lam, *Saturdays 9.30-11.30 a.m. (The studio will be available for private working to 1.00 p.m.* Extra Mural Town Centre. 12 meetings. Continuing to Spring 1970 for a further 15 meetings. *Fee \$70 (12 periods) \$90 (15 periods) \$150 (27 periods).*

An introductory course for persons having no previous experience. The tutor will introduce various subjects, techniques and media and will discuss practical colour mixing, palette organisation, materials, texture and treatment of surface and will analyse historical and present day examples of relevance to the techniques introduced.

Students will be given information as to the material required at the first meeting.

---

---

**A BEGINNER'S COURSE IN DRAWING & PAINTING** Peter Lam, *Wednesdays 6.00-8.00 p.m., starting 24th September, 1969.* King's College, Bonham Road, Hong Kong. 12 meetings. Continuing into Spring 1970 for a further 15 periods. *Fee \$70 (12 periods) \$90 (15 periods) \$150 (27 periods).*

35

As course No. 34 but arranged for the evenings.

---

**PAINTING INQUIRY – A CONTINUING SEMINAR AND STUDIO** Wucrus C.K. Wong, M.F.A. (Maryland) and Guest Tutors, *Tuesdays 6.00-8.00 p.m., starting 23rd September, 1969.* Extra Mural Town Centre. Continuing in Term 4 (Spring 1970) for a further 15 periods. *Fee \$70 (12 periods) \$90 (15 periods) \$150 (27 periods).*

36

This continuing seminar will consist of organised discussion combined with studio practice, the whole emphasis being on the discussion of expression of ideas, methods of work and approach to conceptually creative thinking.

Under the general direction of Mr. C.K. Wong various well known Hong Kong Artists will participate from time to time.

*There will be a limited enrolment of 20 students who should be either registered certificate students or have considerable painting experience to their credit.*

---

**FINE ART STUDIO** Cheung Yee *Fridays 6.00-8.00 p.m., starting 26th September, 1969.* Extra Mural Town Centre. 12 meetings. Continuing into Term 6 for a further 15 periods. *Fee \$70 (12 periods) \$90 (15 periods) \$120 (27 periods).*

37

More advanced studio facilities to enable students to develop under profession tuition. Individual development will be encouraged and print making, and relief work introduce to extend the students painting experience. There will be a limited number of vacancies for non certificate students but these, however will be only open to persons having previous experience, evidence of which will be required before acceptance.

---

**HISTORY OF CHINESE PAINTING & BRUSH AND INK PAINTING** Lui Shou Kwan, *Thursdays 8.00-10.00 p.m., starting 25th September, 1969.* Extra Mural Town Centre. 48 meetings in all. A. 24 meetings (History) *Fee: \$150* B. 24 meetings (Technique) *Fee: \$150*

38

### (甲) 水 中 國 畫 史

本課程共廿四講，每講二小時，分析國畫源流及演變，以畫論史，以史證畫，從畫與史辯認國畫傳統之藝術意義與環境關係，理則和技法之運用變化，鑑往知來，貫通過去與現在，學以立己。

主 講 人：呂詩琨先生

講授語言：粵語

地 點：香港大學校外課程部市區中心

時 間：一九六九年九月廿五日起每星期四下午八時至十時

學 費：一百五十元

### (乙) 水 墨 畫

本課程共廿四講，每講二小時。

根據基本概念之水墨畫教育原則，注重講題實習，破除學徒式師承模仿習慣，從創己立體求自我之認同中，啓導個別繪畫之

## Complementary Courses History & Appreciation

*See also*

INTRODUCTION TO IDEAS ON AESTHETICS.	(28)
ANATOMY FOR ART STUDENTS.	(27)
HISTORY OF ART I INTRODUCTION COURSE	(29)

- 
- 39** HISTORY OF ART II Cesar A. Guillen Nunez, B.A. (Hons) Courtauld Institute of Art, London University *Fridays 6.00-7.00 p.m. Tutorial 7.00-8.00 p.m., starting 26th September, 1969.* Extra Mural Town Centre. 12 meetings, once weekly, one hour of lecturing, and on alternate weeks one hour of tutorial, i.e. the tutorial will be by groups of half of the total enrolment on alternate meetings. Continuing in Term 4 (Spring 1970) for a further 15 periods. *Fee: \$70 (12 periods), \$90 (15 periods), \$150 (27 periods).*

Lectures devoted to parallel developments in painting, architecture & sculpture in the late 19th and 20th centuries will be accompanied by advice on reading and private study coupled with tutorial sessions to encourage detailed consideration of special aspects, and student participation.

- 
- 40** HISTORY OF ART III Cesar A. Guillen Nunez, B.A. (Hons) Courtauld Institute of Art, London University. *Mondays lecture 8.00-9.00 p.m., tutorial 9.00-10.00 p.m., starting 22nd September, 1969.* Extra Mural Town Centre. 12 meetings, once weekly, one hour of lecturing, and on alternate weeks one hour of tutorial i.e. the tutorial will be by groups of half of the total enrolment on alternate meetings. Continuing in Term 4 (Spring 1970) for a further 15 periods. *Fee: \$70 (12 periods) \$90 (15 periods) \$150 (27 periods).*

Discussion of a special aspect or period of contemporary history with particular emphasis on the inter relationships of all creative phenomenon so as to explore their interlocking character. The particular subject area will be related to painting and sculpture in an architectural setting. Although this course is primarily related to the requirements of Certificate students other interested are welcome and are requested to apply for further details.

- 
- 41** SOCIETY & ART Tomas Almberg, Swedish National Diploma in Design Stockholm, Michael F. Griffith, A.T.D. *Tuesdays 8.00-9.00 p.m., starting 30th September, 1969.* 10 meetings. *Fee: \$50*

The relationship between Society and the Artist is a fact of History, trends in society being expressed by the artist, frequently ahead of their common acceptance. The lecturers see a gradual disintegration of "Art" in our time and will analyse contemporary works as an inseparable product of the culture of our period, whilst urging reincorporation of human values.

- 
- 42** GRAMMAR OF VISUAL FORM Jon A. Prescott, B. Arch., M.C.D., A.R.I.B.A., A.M.T.P.I. & Kwok Chiu Leung N.T.D. Parts A & B Pattern & Shape, Development of Shape will not be repeated until 1970-71 Parts C & D The Shapes we need, the Shapes of Towns will be given commencing (Term 4) January, 1970. Extra Mural Town Centre. 15 periods (each course).
-



---

**CHINESE PAINTING** An introduction to its technique and history. Mr. Laurence C.S. Tam B.A. (Hons.) London. *Fridays, 8.00-10.00 p.m., starting 26th September, 1969.* Extra-Mural Town Centre. 15 meetings, once weekly. *Limit of enrolment for any one class, 25 students.* *Fee: \$90*

43

Mr. Tam is a talented and lively contemporary painter in the Chinese manner who derives great strength from the traditions which he knows so well.

The division of time in this course will be such as to allow the earlier lectures of the series to be devoted to the technical problems related to materials, basic elements and composition of Chinese painting, as a prelude to the understanding of its history. Important theories of early masters and their influence, the systems of classification, the greater influence of certain 'masters' and a pictorial analysis of their painting will be related to this early technical analysis and to a weekly exercise, the criticism of which will form a basis for discussion to give the student a deeper understanding of the achievement of the past and its vitality as a basis for today's work.

The course will be illustrated both by actual paintings or reproductions and slides.

---

## VOCATIONAL: Interior Design

"The profession of interior design has had a long struggle to free itself from the image of the interior *decorator*."

Like all creative work, interior design depends on an understanding of the principles and disciplines which can be scientifically outlined but it depends on something more – an intuitive element without which the results can be sterile.

The courses provided over two years introduce to students a scientific attitude to design and although the lecture series are independent they will be correlated to form a whole.

### STUDIO

Studio periods will form an essential part of the Interior Design courses when exercises will be discussed. In the studio all aspects of the work coalesce and for this reason such work is perhaps the most important part of the instruction and, for Certificate Students, the subsequent portfolio examination.

---

- 
- 44** **INTERIOR STUDIO II** Ruth H. Addison, Dipl. Arch (U.C.L.) A.R.I.B.A. *Thursdays 6.00-8.00 p.m., starting 25th September, 1969.* Extra Mural Town Centre. 12 meetings. Continuing Term 4 for a further 15 periods. *Fee \$70 (12 periods) \$90 (15 periods) \$150 (27 periods).*

A series of graded exercises will be set throughout the year in co-ordination with studies in various lecture courses\*, organised so as to develop the student's ability to present a carefully worked out scheme for differing types of interior. Part of the work this year will be to develop technical drawings in association with the lectures in the nature of materials and detailing and these will be worked out in conjunction with certain schemes of the student's own design.

\* See courses nos. 46 and 47

- 
- 45** **INTERIOR STUDIO III** Jon A. Prescott, B. Arch., M.C.D., A.R.I.B.A., A.M.T.P.I. *Fridays 6.00-8.00 p.m., starting 26th September, 1969.* Extra Mural Town Centre. 12 meetings. Continuing into Term 6 for a further 15 periods. *Fee \$70 (12 periods) \$90 (15 periods) \$150 (27 periods).*

More advanced Studio facilities will provide further selected exercises for students having previous knowledge and experience. Emphasis will be placed on the achievement of good design solutions within the practical limitations imposed by economics and material availability as well as on the achievement of imaginative esquisses.

- 
- 46** **THE NATURE OF MATERIALS AND DETAILING** Ruth H. Addison, Dipl. Arch. (U.C.L.) A.R.I.B.A. *Thursdays 6.00-8.00 p.m., starting 25th September, 1969.* 12 meetings. Continuing in Term 4 for a further 15 periods. *Fee: \$100 (12 periods) \$140 (15 periods) \$220 (27 periods).*

In all design work an understanding of the nature of the materials used is fundamental. The essential characteristics of materials predominantly used in interior work will be discussed and problems of achieving satisfactory jointings and junctions, the structural implications of using different materials and the effects to be achieved by different methods of detailing, will be co-ordinated with various exercises. Application of this data will be made in the studio work.

- 
- 47** **TECHNICAL SERVICES** R.A. Callow P.I.S., Dip. Arch. (Leics), F.R.I.B.A. and J. Burfield Architekt S.I.A., Dip. Arch., A.R.I.B.A. *Mondays 6.00-8.00 p.m., starting 22nd September 1969.* Extra Mural Town Centre. 12 meetings. Continuing into Term 4 & 6 for a further 15 periods. *Fee: \$100 (12 periods) \$140 (15 periods) \$220 (27 periods).*

Interior Design is inseparably bound up with the problems of effective integration of various technical services, the existence of which is nowadays assumed. Ventilation, air conditioning, lighting, electrical circuiting, plumbing, telephone installation and so on. These lectures will cover basic principles of the different installations so that the designer understands the problems involved and can discuss intelligently the detailed requirements with the various services engineers involved. Standards and legal requirements will be explained.

- 
- 48** **PROFESSIONAL PRACTICE IN INTERIOR WORK.** *Commencing January, 1970.*

A course covering professional attitudes, arrangement of contracts, relationship with contracting work and cost analysis of work.

---

---

**THE NATURE OF MATERIALS AND DETAILING II** John Burfield Architekt S.I.A. Dip. Arch., A.R.I.B.A. & R. Zung, *Tuesdays 6.00-7.30 p.m., starting 23rd September, 1969.* Extra Mural Town Centre. 12 meetings. Continuing into Term 6 for a further 15 periods. *Fee \$70 (12 periods) \$90 (15 periods) \$150 (27 periods).*

49

A continuation of instruction in the nature of basic materials and their manufacturing, jointing and structural implications to the designer. Special emphasis will be given to interior fittings and furniture with consideration of ergonomics and the effects of design for machine and serial production on the detailing of furniture.

---

## VOCATIONAL: Advertising Design

### STUDIO

Studio periods form an essential co-ordinating element in the advertising courses, where all aspects of the work coalesce. For this reason such work is perhaps the more important part of the instruction and, for certificate students, the subsequent portfolio examination.

---

**ADVERTISING STUDIO II** Julian A. Losinski, M.S.I.A., N.D.D., Dip. A.D.D. & A.D. *Mondays 6.00-8.00 p.m., starting 22nd September, 1969.* Extra Mural Town Centre. 12 periods. Continuing into Term 4 for a further 15 periods. *Fee: \$150 (27 periods).*

50

Studio facilities provide the core of the Advertising Design students work bringing together all aspects from printing technology to abstract formal considerations. As, however, advertising relies very greatly on "ideas" as well as Graphic Design it is important to appreciate what ideas mean, why they are good, how to get and exploit them. Within the framework of a series of carefully conceived exercises the student will apply ideas, in terms of layout, copy and photographic application for both advertisement and packaging designs.

---

- 
- 51** **ADVERTISING STUDIO III** Henry Steiner, M.F.A. (Yale) *Tuesdays 6.00-8.00 p.m., starting 23rd September, 1969.* Extra Mural Town Centre. 12 meetings. Continuing into Term 6 for a further 15 periods. *Fee: \$150 (27 periods)*

More advanced studio facilities will provide further selected exercises for students having previous knowledge and experience. Emphasis will be placed on the achievement of good design solutions within the practical limitations of administrative and economic considerations. The demonstration of various production techniques will be invoked in the solutions to the different problems set.

- 
- 52** **PRINTING TECHNOLOGY** Mr. R. K. Cheng B.A. (Econ.) St. Johns. Tech. Cert. in Printing C. & G. London. *Thursdays 6.00-7.00 p.m., starting 25th September, 1969.* extra Mural Town Centre, and Government Printing Works. 12 meetings. Continuing into Term 4 for a further 15 periods. *Fee: \$150 (27 periods).*

Most of these lectures will take place on the workshop floor so that students can become familiar with the practical problems of printing technology. They will provide a study in some depth of the features of printer's type, his type case, type setting and justification, point systems and classification, preparation of copy, casting off of copy, page layout, composition, paper and paper calculation, lino types and monotypes, etc. The study will be closely co-ordinated with studio exercises provided in Course No. 50. Non Certificate students will be particularly welcome.

- 
- 53** **PROFESSIONAL PRACTICE IN ADVERTISING** *Commencing January 1970.*

A course covering professional attitudes, arrangement of contracts and costing analysis of work.

- 
- 54** **BASIC PHOTOGRAPHIC TECHNIQUES & ILLUSTRATION I** Albert Hill, J.A. Dip. *Tuesdays 6.00-8.00 p.m., starting 23rd September, 1969.* Dark Room, 412 Asia House, 1 Hennessy Road. 12 meetings. Continuing into Term 4 for a further 15 periods. *Fee: \$90 (12 periods) \$100 (15 periods) \$170 (27 periods).*

The cost of Dark Room materials only is included in the fee. Drawing and other materials will be provided by the student.

An introductory course to this wide subject. The usefulness of the camera will be demonstrated in relation to the use of graphic art material, basic photographic method and processing. A brief historical symopsis will be given. Transparencies, photo composition, typography and use of the camera for documentary work will be discussed.

Students should be prepared to provide themselves with a camera of the single lens reflex type with interchangeable lens mounting. The tutor will provide a criticism of different makes relative to the work to be undertaken in the initial lecture.

---

**PHOTOGRAPHIC TECHNIQUES II** Albert Hill, I.A. Dip. *Mondays 6.00-8.00 p.m., starting 22nd September, 1969.* Dark Room 412 Asian House, 1 Hennessy Road. 12 meetings, continuing into Term 6 for a further 15 periods. *Fee: \$90 (12 periods) \$100 (15 periods) \$170 (27 periods).*

55

The cost of Dark Room materials only is included in the fee. Any addition material required will be provided by the student.

The course will be a continuation of that provided by course no. with emphasis on film and papers used by the blockmaker and the relationship of camera techniques with work in the Graphics Arts.

Assignments will be set and a camera of the type described above course no. will be essential.

---

**PROCESSES OF PRODUCTION** Patrick W. Printer, M.S.I.A., N.D.D. and a panel of lecturers. *Mondays 8.00-9.30 p.m., starting 22nd September, 1969.* Extra Mural Town Centre. 12 meetings, continuing into Term 6 for a further 15 periods. *Fee: \$70 (12 periods) \$90 (15 periods) \$150 (27 periods).*

56

A comprehensive review of alternate production methods in relation to all work in the graphic and advertising design field. These lectures complete in themselves will at the same time be co-ordinated with the Studio work in this year.

---

#### **PRIOR ENROLMENT IS ESSENTIAL**

Failure to enrol prior to the opening of a particular course, may, mean the cancellation of that course. Prior enrolment is the only way the Department of Extra-Mural Studies has of judging the response to its courses. Your co-operation is therefore invited in sending your application forms to the Department as soon as possible.

# Chinese Studies

Staff Tutor in Charge: Mrs. Nana Tsao, B.A., Dip. Ed. (H.K.) Telephone No. H-468161 Ext. 306

## 國學

國學課程包括文學，歷史，哲學各部門，着重欣賞，分析研究，及寫作部份課程，如翻譯，應用文及書法等，以技術之掌握與應用為主。

主理導師：曹黃愛儀女士

## 藝術 Art

See also

HISTORY OF CHINESE PAINTING &  
BRUSH AND INK PAINTING.  
CHINESE PAINTING

(38) Page 21

(43) Page 23

---

THEORY AND PRACTICE OF CHINESE CALLIGRAPHY Mr. H.H. Fung. 57  
Wednesdays, 7.00-9.00 p.m., starting October 15, 1969. Extra-Mural Town Centre.  
14 meetings. Fee: \$120

### 書法源流

本課程共十四講，每週一次，每次二小時，專為愛好研究中國書法者而設，理論與實習並重，主要講題如下：

- (一) 書法與文字之關係
- (二) 書法演變
- (三) 篆隸行楷之書法介紹
- (四) 執筆、運筆，結體
- (五) 各體書法示範

主講人：馮康侯先生

講授語言：粵語

時間：一九六九年十月十五日起每星期三下午七時至九時

地點：香港大學校外課程部市區中心

學費：一百廿元（限收十四名）

---

THEORY AND PRACTICE OF CHINESE CALLIGRAPHY Mr. H.H. Fung. 58  
Wednesdays, 7.00-9.00 p.m., starting February 18, 1970. 14 meetings. Fee: \$120

### 書法源流

主講人：馮康侯先生

講授語言：粵語

時間：一九七〇年二月十八日起每星期三下午七時至九時

學費：一百廿元（限收十四名）

## Literature 文學

- 59 INTRODUCTION TO IMPORTANT WORKS IN CHINESE LITERATURE Dr. Kenneth P.H. Ho, M.A., (H.K.) D. Phil. (Oxon.) Part A: Thursdays, 7.30-9.00 p.m., starting October 2, 1969. Part B: Thursdays, 7.30-9.00 p.m., starting February 12, 1970. Extra-Mural Town Centre. 12 meetings for each part Fee: \$40 each. Reduced fee for Parts A & B: \$75.

### 中國文學要籍概論

本課程以提綱挈領方法介紹歷代文學要籍，述其內容，評其得失，以作研究中國文學梯階。

本課程分甲乙兩部。每部十二講，每講一小時半。甲部：先評述歷代之重要文章總集與別集。總集分「通代」（如昭明文選）與「斷代」（如唐代粹）言，別集以名家為主；再就詩、詞、歌、賦、散文、駢文、八股，傳奇，戲曲小說各類，分別論述其重要篇籍。乙部分「叢書」，「類書」，「詩文評」，「文學史」，「專著」五項。先簡述其源流發展，然後擇其要籍作一概要評述。

主講人：香港大學中文系講師何沛雄博士

講授語言：粵語

地點：香港大學校外課程部市區中心

時間：甲部：一九六九年十月二日起每星期四下午七時卅分至九時至九時

乙部：一九七〇年二月十二日起每星期四下午七時卅分至九時

學費：甲、乙部各收四十元，一次過繳費者減收七十五元

- 
- 60 CHUAN-TSU Mr. C.C. Chan, B.A. (Sun Yat Sen). Tuesdays, 6.00-7.00 p.m., starting September 30, 1969. Training Unit, Resettlement Dept., J. Hotung House, Hankow Road, Kowloon. 16 meetings. Fee: \$45

### 莊子選讀

本課程共十六講。昔明儒諸理齋謂莊子一部，禪書萬卷，曾不出此。莊生語妙天下，奇辭奧旨，玄遠闊深，豈惟其理之美耶，其文亦篇章之珠澤也。印發講義，義理詞章並重。

主講人：陳湛銓先生

講授語言：粵語

地點：九龍何鴻卿大廈徙置事務處訓練組講室

時間：一九六九年九月三十日起每星期二下午六時至七時

學費：四十五元



---

**SELECTED POEMS** Mr. K.N. Leung. *Tuesdays, 7.00-8.30 p.m., starting Oct. 14, 1969.* Extra-Mural Town Centre. 16 meetings. *Fee: \$70*

61

### 歷代詩選及習作

本課程共分十六講，每講一小時半，自魏晉六朝以至唐宋諸名家，各選若干篇講授，溯其源流明其影響；雖窺一斑，可測全豹矣。印發講義。

主 講 人：梁簡能先生

講授語言：粵語

地 點：香港大學校外課程部市區中心

時 間：一九六九年十月十四日起每星期二下午七時至八時三十分

學 費：七十元

---

**POEMS OF SU TUNG-PO** Mr. C.C. Chan, B.A. (Sun Yat-sen). *Tuesdays, 7.15-8.15 p.m., starting Sept. 30, 1969.* Training Unit, Resettlement Dept., J. Hotung House, Hankow Road, Kowloon. 16 meetings. *Fee: \$45*

62

### 蘇東坡七律

本課程共十六講，坡仙七言，詩家所重。其七古幾奪李杜韓之壘，此世之所知也；其七言律，或超妙精奇，或泓深博厚，曾滌生鈔古今詩僅十八家，不遺此體，卓識可領。印發講義。

主 講 人：陳湛銓先生

講授語言：粵語

地 點：九龍何鴻卿大廈徙置事務處訓練組講室

時 間：一九六九年九月三十日起每星期二下午七時十五分至八時十五分

學 費：四十五元

---

**THEORY AND PRACTICE IN TRANSLATION OF CHINESE CLASSICS** Mr. S.W. Li *Fridays, 8.00-9.00 p.m., starting October 17, 1969.* Lecture Room South, City Hall, Hong Kong. 20 meetings. *Fee: \$60*

63

### 翻譯之理論與實習

本課程本期二十講，每週一次，學理及實習平均講授，英譯漢及漢譯英並重。在實習時，英譯漢部份取材於英文小說，散文，戲劇，詩歌，現代名人傳記及時事論文等。漢譯英部份取材於先秦哲學散文，唐代短篇小說，元代雜劇及歷代名人傳記等。

主 講 人：李聖五先生

講授語言：國、英語

地 點：香港大會堂九樓南演講廳

時 間：一九六九年十月十七日起每星期五下午八時至九時

學 費：六十元

---

- 64 PRACTICAL WRITING IN CHINESE** Mr. K.K. Ho. *Wednesdays, 7.20-8.50 p.m., starting October 1, 1969.* Committee Room North, City Hall, 7/F., Hong Kong. 12 meetings. *Fee: \$50*

### 各體應用文習作

各體文包括頌詞贊詞詩文祝文祭文誄文碑記墓誌銘等文。亦即高級應用文學。其文體大率為韻文或駢偶文。凡研讀中國語文學者，不可不講求，凡為文牘書記者，尤不可不講求。本課程以六朝至近代名家作品為法式。注重體裁，聲情，聲韻，對仗，辭采之研討，與習作之指導及批改。共十二講，印發講義。

主講人：何敬羣先生

講授語言：國語

地點：香港大會堂八樓北會議室

時間：一九六九年十月一日起每星期三下午七時二十分至八時五十分

學費：五十元

## History 歷史

- 65 MAIN POINTS IN CHINESE HISTORY** Mr. K. Lai. *Fridays, 7.00-8.30 p.m., starting October 3, 1969.* Lecture Room North, City Hall, 8/F., Hong Kong. 12 meetings. *Fee: \$50*

### 國史要論——中國歷代治亂興亡之重點

史籍所記，多紛繁蕪雜，治史者往往有茫無頭緒之感。然能鉤玄提要，蠅會貫通，則史事雖繁，其一切演變亦未嘗無跡可尋。本課程在將中國歷代影響最大之史實，分代提出討論，使知每一朝代治亂興亡之重點，進而瞭解中國歷史演變之大勢。共十二講。

主講人：黎傑先生

講授語言：粵語

地點：香港大會堂九樓北演講廳

時間：一九六九年十月三日起每星期五下午七時至八時卅分

學費：五十元

- 66 CHINA IN THE LAST CENTURY** Mr. K. Lai. *Fridays, 7.00-8.30 p.m., starting Jan. 23, 1970.* 12 meetings. *Fee: \$50*

### 中國近百年史

主講人：黎傑先生

講授語言：粵語

時間：一九七〇年一月廿三日起每星期五下午七時至八時三十分

學費：五十元

**THE BOOK OF CHANGES** Mr. S.W. Li. *Fridays, 7.00-8.00 p.m., starting October 17, 1969.* Lecture Room South, City Hall, Hong Kong 20 meetings. *Fee: \$60*

**67**

**易 經 研 究 (一)**

易經為中國最古之書，亦未遭秦火之唯一原著，其內容包括宇宙論及人事論，儒道兩家之學術思想，均導源於此，且係優美之古典文。

本課程為二十講，由八卦之形成及含義，至六十四卦之詳解及聯繫性，用以說明人生由生至死之全部變遷。所謂吉凶悔吝，絕非一般學說如宿命論等所可加以詮釋。凡遇凶化吉，居吉逢凶，倫理問題，及自然問題等，卦、象、象對之均有明確之指示。

主 講 人：李聖五先生

講授語言：國、粵語

地 點：香港大會堂九樓南演講廳

時 間：一九六九年十月十七日起每星期五下午七時至八時

學 費：六十元

---

**UNDERSTANDING CHINESE CUSTOMS AND TRADITIONS** Dr. M. Topley, B.Sc. Econ. (Lond.); Ph. D. (Lond.) *Wednesdays, 6.15-7.15 p.m., starting October 1, 1969.* British Council Library, Gloucester Building, Hong Kong. 12 meetings. *Fee: \$40*

**68**

This series of lectures is designed for those who wish to learn something of the role of Chinese customs and traditional ways of thought in Hong Kong life today. It will discuss also changes in some of the traditional patterns of thought and behaviour. Topics to be included are Chinese family and marriage; child-rearing and the position of women; Chinese names; clan and ancestor worship; geomancy; Chinese traditional medicine; religion; and popular festivals.

---

**THE ROLE OF RELIGION IN CHINESE SOCIETY** Dr. M. Topley, B.Sc. Econ. (Lond.); Ph. D. (Lond.) *Wednesdays, 6.15-7.15 p.m., starting February 11, 1970.* British Council Library, Gloucester Building, Hong Kong. 8 meetings. *Fee: \$35*

**69**

# Economics Commerce Management

*Staff Tutor in Charge:* Edward K.Y. Chen, B.A. (H.K.) *Telephone No.* H-468161  
*Ext.* 309.

The courses in this section are aimed at all levels of industry, commerce and the public service. They are designed for two types of student:

- (a) Those who wish to prepare for professional examinations:
- (b) Those who wish to acquire skills and knowledge appropriate to their present responsibilities and future development.

Some courses are more advanced than others and require prior participation in basic courses for admission. In particular, students are advised not to enter for courses geared to examination requirements unless they already have a basic knowledge of the subject and fully intend to take the examination.

There will be other courses arranged during the year at the request of professional societies and industrial firms for which details cannot now be given. Suggestions or proposals for courses are welcome. The Department is always willing to consider arranging special courses for members of a particular firm or organisation or for a group of such bodies.

## Economics

- 70** **ECONOMICS FOR INTERMEDIATE EXAMINATIONS** Tutor to be announced.  
*Mondays, 6.15-7.45 p.m., starting September 29, 1969. University Main Building.*  
20 meetings. *Fee: \$100*

The fundamental concepts and tools of modern economic analysis will be discussed in detail. Topics to be considered include general principles governing production, distribution and consumption, theories of price, income and employment, money and banking, international trade, public finance and economic growth.

This course is specially designed for those who are preparing for professional examinations, such as CIS and ACCA.

---

**ECONOMICS FOR ACCOUNTING STUDENTS** Mr. J.P. Lee, B.A., and Mr. S.K. Chan, B.A. *Mondays, 6.00-7.30 p.m., starting September 29, 1969.* Extra Mural Town Centre. 20 meetings *Fee: \$100*

71

The following topics will be covered:

Scope and method, theory of value; supply and demand factors of production, national income, business cycle; money, banking and finance, Government intervention, international trade; gold standard and subsequent systems; monetary and economic institutions. Suitable for those preparing for intermediate examinations.

Recommended reading. J L. Hanson, *A Textbook of Economics*, published by MacDonald and Evans. 20s.

## Commerce

**COMPANY SECRETARYSHIP** Mr. J.K.S. Thong, F.C.I.S., F.A.C.C.A. *Fridays, 8.15-9.15 p.m. starting September 26, 1969.* Extra Mural Town Centre. 24 meetings. *Fee: \$80*

72

The practical work of the company secretary with particular reference to internal administration business management, and office organisation will be discussed in detail. It is suitable for all wanting a basic knowledge of secretarial practice, as well as those preparing for professional examinations.

---

**APPLIED JOURNALISM** Mr. Yu-long Cheng. *Fridays, 7.00-8.00 p.m., starting September 26, 1969.* Extra Mural Town Centre. 12 meetings. *Fee: \$45*

73

### 應 用 新 聞 學

我們天天要看報，所以對於報紙的了解，是最有用的常識。應用新聞課程特爲此而設。本課程共十二講，內容包括報紙的起源，中國及香港報業簡史，新聞的來源，電訊，編輯，標題，採訪，判斷，副刊，廣告，新聞與法律等。本課程適合將從事新聞事業及已從事新聞工作的人士及所有各界閱報人士選讀。

主 講 人：鄭郁郎先生

講授語言：粵語

地 點：香港大學校外課程部市區中心

時 間：一九六九年九月廿六日起每星期五下午七時至八時

學 費：四十五元

- 
- 74 PUBLIC RELATIONS** Mr. B. Wythe, Member of the Public Relations Institute of Australia, Eric White Associates. *Tuesdays, 7.00-8.00 p.m., starting September 30, 1969* Lecture Room South, 8/F., City Hall. 10 meetings. *Fee: \$35*

The necessity for good public relations is becoming increasingly evident in Hong Kong and is vital to the well-being of the community. Its role as an aid to modern marketing, as a means of conveying ideas and policies, and in assisting companies and institutions in developing sound reputations and relationships will be discussed. There will be some examination of the techniques of public relations and the qualifications that help to make a successful public relations officer or consultant. No previous knowledge of the subject is assumed.

- 
- 75 TAXATION IN HONG KONG** Mr. J.K.S. Thong, F.C.I.S., F.A.C.C.A. *Fridays, 7.00-8.00 p.m. starting September 26, 1969.* Extra Mural Town Centre. 15 meetings. *Fee: \$60*

A comprehensive explanation will be given of the principles which govern individual and corporate liabilities and claims. Particular attention will be paid to the powers and duties of the Board of Inland Revenue and the Board of Review.

- 
- 76 INVESTMENT** Mr. Francis C.Y. Chan, M.B.A. *Fridays, 6.00-7.00 p.m., starting September 26, 1969.* Lecture Room North, 8/F., City Hall, Hong Kong. 12 meetings. *Fee: \$45*

### 投 資 學

本課程共十二講，對有關投資的研究與處理之問題，有詳盡之討論。內容包括投資的目的，證券，互惠投資基金，參考資料之取得，購售手續，證券市場，有價證券之分析，時效問題，經紀人關係等。

主 講 人：陳暢餘碩士（工商管理學）

講 授 語 言：粵 語

地 點：香港大會堂九樓北演講廳

時 間：一九六九年九月廿六日起每星期五下午六時至七時

學 費：四十五元

- 
- 78 EXPORT DOCUMENTATION AND PROCEDURES** Various tutors will lecture. *Fridays 5.45-6.45 p.m., starting October 3, 1969.* Extra Mural Town Centre. 15 meetings. *Fee: \$65*

More than any other economy Hong Kong lives by its exports. To help businessmen with the many problems which arise in exporting, the Extra-Mural Department has brought together a team of lecturers from Government and commerce who will provide guidance on legal and technical difficulties. Special topics include: effects of tariffs and controls, documentation, insurance, transportation, finance, and overseas markets selection.

---

**PRACTICAL BANKING** Mr. T.Y. Chan, B.A. *Tuesdays, 7.00-8.00 p.m., starting September 30, 1969.* Extra Mural Town Centre. 12 meetings. *Fee: \$40*

77

## 銀行實務

本課程共十二講，適合擬求取基本銀行實務知識之一般人士。內容包括銀行意義，功能，管理及組織之普通討論。並充份研究銀行會計；出納部及營業部之工作過程；外匯；匯款；押匯；信用證等。

主講人：陳天元先生

講授語言：粵語（輔以英語）

地點：香港大學校外課程部市區中心

時間：一九六九年九月三十日起每星期二下午七時至八時

學費：四十元

---

## Hospital Administration

**AN INTRODUCTION TO HOSPITAL ADMINISTRATION** Mr. A.E. Starling, F.H.A., F.C.C.S., F.R.S.H., Senior Hospital Secretary. *Wednesdays, 6.00-7.00 p.m., starting October 8, 1969.* Extra Mural Town Centre. 20 meetings. *Fee: \$70*

79

This course is designed for those who are connected with or who have some interest in Hospital Administration. It will, so far as is possible, follow the syllabus laid down for the Diploma of the Institute of Hospital Administrators and will cover the evolution of the modern general hospital; the basic principles of the National Health Service in the United Kingdom; hospital organisation; internal administration and the relationship of hospital departments one with another.

---

**80** **PRACTICAL ASPECTS OF HOSPITAL ADMINISTRATION** Mr. A.E. Starling, F.H.A., F.C.C.S., F.R.S.H., Senior Hospital Secretary. *Wednesdays, 7.10-8.10 p.m., starting October 8, 1969.* Extra Mural Town Centre. 20 meetings. *Enrolment is limited to 15.* *Fee: \$75*

Applicants for this course should indicate that they have completed the Introductory Course or hold senior posts in Hospital administrations. It is intended to study the practical aspects of hospital administration and students must be equipped to join in discussions on all aspects of hospital organisation, including supplies, development, financial administration, statistics, the staffing organisation of hospitals and the functions and duties of the principal officers. Students will be expected to prepare an essay on some aspect of the subject for discussion and analysis by other members of the class.

---

## Chartered Institute of Secretaries - C.I.S.

The Department will not this year, or in future, be acting as local examiner for the Chartered Institute of Secretaries.

However, it will continue to offer courses suitable for those preparing for the examinations of that body.

---

### INTERMEDIATE EXAMINATION

The following courses are offered:

<b>ECONOMICS FOR INTERMEDIATE EXAMINATIONS</b>	<b>( 70) Page 34</b>
<b>ENGLISH FOR HIGHER COMMERCIAL STUDIES</b>	<b>(104) Page 47</b>
<b>ACCOUNTANCY FOR INTERMEDIATE EXAMINATIONS</b>	<b>( 82) Page 39</b>
<b>PRINCIPLES OF ENGLISH LAW</b>	<b>(147) Page 59</b>

---

### FINAL EXAMINATION

The following courses are offered:

<b>COMPANY SECRETARYSHIP</b>	<b>( 72) Page 35</b>
<b>ACCOUNTANCY FOR FINAL EXAMINATIONS</b>	<b>( 83) Page 39</b>
<b>COMPANY LAW</b>	<b>(148) Page 59</b>
<b>ENGLISH MERCANTILE LAW</b>	<b>(146) Page 59</b>

---



# Accountancy

The courses in this section provide an opportunity for students to proceed from a beginners' class (General Accounting) to classes preparing them for the Intermediate and Final Examinations of the professional bodies. In addition, classes concerned with special problems are included, e.g. Auditing, Costing, and Taxation.

---

**GENERAL ACCOUNTING** Mr. G.C.O. Kiddle, A.C.A. *Thursdays, 6.15-7.15 p.m., starting September 25, 1969.* University Main Building. 22 meetings. **81** *Fee: \$90*

Preparation of books of prime entry including day books, journals, cash books and ledgers, preparation of trial balance, profit and loss account and balance sheet of sole proprietors and partnerships will be explained. Detailed consideration of elementary book-keeping procedures and partnership and limited company accounting.

Suitable for those wanting a basic knowledge of book-keeping and of accountancy.

Recommended Reading: Munro: Bookkeeping and Accountancy.  
Published by Pitman.

---

**ACCOUNTANCY FOR INTERMEDIATE EXAMINATIONS** Mr. J.C. Broadley, C.A. *Tuesdays, 6.15-7.45 p.m., starting September 30, 1969.* University Main Building. 20 meetings. **82** *Fee: \$100*

Students for this course must already have a basic knowledge of accountancy. The intermediate examinations of professional bodies such as the CIS or ACCA are not easy, and only serious students will be admitted to the course. Time will be spent working on examination questions.

Recommended reading: Munro: Bookkeeping and Accountancy.  
Published by Pitman.  
Spicer and Pegler: Bookkeeping and Accounts. H.F.L. Publishers Ltd.

---

**ACCOUNTANCY FOR FINAL EXAMINATIONS** Mr. L. Howson, A.C.A. *Wednesdays, 5.45-7.15 p.m., starting November 5, 1969.* Extra Mural Town Centre. 22 meetings. **83** *Fee: \$110*

The following topics will be covered:-

Principles of advanced accountancy; amalgamations and reconstructions, liquidations and taxation in company accounts, consolidated accounts, capital structure of companies, sources of company finance capitalization of profits; financial budgets & forecasting, the Companies Acts 1948 and 1967; investment accounts; interpretation and criticisms of accounts.

Applicants for this course must either have passed the Intermediate level or else in the opinion of the tutor have acquired sufficient knowledge of accountancy. (e.g. by previous satisfactory attendance at appropriate accountancy courses.)

- 
- 84** **COST ACCOUNTING** Mr. H.P. Chan, A.A.C.C.A. *Fridays, 6.00-7.30 p.m., starting October 3, 1969.* Extra Mural Town Centre. 16 meetings. *Fee: \$80*

The classification of cost accounts and of expenditure, costing for materials including stock control, costing for wages including remuneration system, costing for overheads including treatment of indirect expenses, budgetary control and standard costing, and marginal costing will be discussed in detail. Designed for students taking professional accountancy examinations at intermediate level. Enrolment will be limited to 30 students.

- 
- 85** **AUDITING** Mr. Y.Y. Lam, A.A.C.C.A. *Wednesdays, 7.30-8.30 p.m., starting October 8, 1969.* Extra Mural Town Centre. 20 meetings. *Fee: \$70*

A comprehensive explanation of the principles and objects of auditing, the audit of cash transaction, the audit of trading transactions, the audit of outstanding assets and liabilities, the audit of limited companies, and the liability of auditors will be discussed. The course is designed for those who want a basic knowledge of auditing, as well as those preparing for professional examinations.

- 
- 86** **ELEMENTARY STATISTICS** Mr. M.Y. Yeung, B.A. *Wednesdays, 5.45-7.15 p.m., starting September 24, 1969.* Committee Room North, 7/F., City Hall Hong Kong. 16 meetings. *Fee: \$80*

An appreciation of the use of statistics in presenting information. Suitable for those preparing for accountancy professional examinations and for the Part One examination of the Institute of Statisticians.

- 
- 87** **TAXATION AND ACCOUNTING PROBLEMS** Mr. Lo Nai Wai, B.A., A.A.C.C.A. *Wednesdays, 5.45-6.45 p.m., starting October 1, 1969.* Extra Mural Town Centre. 24 meetings. *Fee: \$80*

### 稅務與會計問題

本課程共廿四講，研究本港稅務法例所課徵之物業稅，薪俸稅，利得稅，利息稅，個人入息課稅，及與稅例有關各項問題。各問題之研討以適應學員之程度與興趣，酌予增刪。

主 講 人：盧乃惠先生

講授語言：粵語（術語講章，兼用英文）

地 點：香港大學校外課程部市區中心

時 間：一九六九年十月一日起每星期三下午五時四十五分至六時四十五分

學 費：六十五元

# Management

The management courses offered by the Department fall into two main groups.

1. Those which provide an introduction to some of the main management responsibilities and techniques. They are conducted on a lecture-discussion basis and outside reading is encouraged. Although most of them are introductory they are of sufficient duration to be serious courses of study, and by careful planning a student can follow an integrated programme over a period of years.
2. Those which require sustained study over a long period and lead to a particular qualification, such as the Diploma in Management Studies or the Certificate in Personnel Management.

## THE LIONS MANAGEMENT LOAN FUND

Through the generosity of the Lions International, District 303, the Extra-Mural Department is able to offer loans to cover the cost of fees in the Diploma in Management Studies and the Certificate in Personnel Management. For further details write to the Director of Extra-Mural Studies, University of Hong Kong.

---

## DIPLOMA IN MANAGEMENT STUDIES

The Extra-Mural Department is responsible for this three-year part-time post-graduate University Diploma. No applications can be accepted this year as the course is already full.

---

**CERTIFICATE IN PERSONNEL MANAGEMENT** *Wednesdays, 6.00-7.30 p.m. and 8.00-9.30 p.m., starting October 1, 1969.* Extra-Mural Town Centre. 20 meetings.  
*First Year Fee: \$275.00*

88

Personnel Management is increasingly being recognised as of key importance in the development of the Hong Kong economy. The Department of Extra-Mural Studies, with the co-operation of the Hong Kong Management Association, is now offering a two-year part-time course in Personnel Management.

The following are eligible for acceptance as students:

- (a) University graduates
- (b) Non-graduates who are over the age of 24 and who have had practical experience which will enable them to benefit from the course.

The number of students accepted will be limited to 35.

Topics studied in *Part One (First Year)* will be The Hong Kong Economy, and Organisational Behaviour. In *Part Two (Second Year)* Industrial Relations and Labour Law, and Personnel Management – Principles and Practice.

For further details apply to Director of Extra-Mural Studies, University of Hong Kong.

- 
- 89** **INDUSTRIAL LAW** Mr. John Rear, M.A. (Oxon.), Barrister-at-Law *Fridays, 6.00-7.00 p.m., starting October 3, 1969.* Extra-Mural Town Centre. 6 meetings. *Fee: \$20*

An introduction to the basic principles of Industrial Law in Hong Kong. Topics will include the contract of employment; hours of work, holidays, and sickness; health and safety; compensation for injuries. This course is designed for managers, trade unionists, and Labour Department staff.

- 
- 90** **HEALTH AND SAFETY IN INDUSTRY** Various Speakers. *Mondays, 6.00-7.00 p.m., starting October 27, 1969.* Training Unit, Resettlement Department, J. Hotung House, Hankow Road, Kowloon. 8 meetings. *Fee: \$30*

The health and safety of the worker in industry depend on many different circumstances. Management has both a moral and legal responsibility for the safety of those it employs. Speakers will discuss causes of occupational disease, legal provisions on safety and medical care, and methods of securing a healthy and efficient labour force.

- 
- 91** **HOW TO MANAGE A NEW BUSINESS** Mr. William Cheng, M.B.A. (Harvard) *Fridays, 5.45-6.45 p.m., starting October 3, 1969.* Extra Mural Town Centre. 15 meetings. *Fee: \$60*

This course will have an appeal to persons interested in a wide variety of business fields. It is designed to illustrate problems of accounting, finance, production, marketing, and personnel, as they apply to the small firm. Typical case studies will be discussed.

- 
- 92** **INDUSTRIAL RELATIONS WORKSHOP** Mr. J.W. England, B.A. *Wednesdays, 5.45-7.15 p.m., starting October 8, 1969.* Extra-Mural Town Centre, University House, 151 Des Voeux Road Central, 11th Floor, Hong Kong. 10 meetings. *Fee: \$40*

A continuation of last year's course when senior managers, trade unionists, and Labour Department staff came together to discuss Industrial Relations in Hong Kong. Particular attention will be given to the structure and functions of the trade unions. New course members will be welcome.

- 
- 93** **MARKETING** Dr. Francis K. Pan, D.C.S. (N.Y.) *Wednesdays, 5.45-7.15 p.m., starting October 8, 1969.* Extra Mural Town Centre. 17 meetings. *Fee: \$100*

The theory and practice of marketing will be dealt with in detail. Topics to be covered include scope and definition, consumers' acceptance, marketing organisation, market research, marketing channels, salesmanship, publicity and advertising, price policies, credit information, marketing management and socio-legal relationships. Especially suitable for business executives interested in marketing and distribution. Students should have a knowledge of elementary economics, or be engaged in marketing.

# Education

*Staff Tutor in Charge: Nana Tsao, B.A., Dip. Ed. (H.K.) Telephone No. 468161 Ext. 306*

---

**RESEARCH METHODS IN EDUCATION & PSYCHOLOGY** Prof. N.K. Henderson, **94**  
Ph.D. (London); B.A., M.Ed. (Melb); A.B.Ps.S.; F.C.P.; Professor of Education.  
*Wednesdays, 5.30-6.30 p.m., starting October 1, 1969. University Main Building,*  
20 meetings. *Fee: \$60*

An introduction to the main methods and results of modern educational and psychological research, as well as a non-mathematical introduction to statistical techniques and experimentation. Topics include the nature and problems of research, test construction methods, how to write a thesis or research report, studies of method, and results of some outstanding modern research studies in these fields. This year a special feature of the course will be the interpretation & application of recent research results to school problems in Hong Kong.

The course is suitable for graduates working for higher degrees and others interested in systematic research; M.A. (Ed.) candidates preparing for their qualifying examination in Research Methods and also teachers and school administrators.

---

**SCHOOL ORGANIZATION AND ADMINISTRATION** Prof. N.K. Henderson, **95**  
Ph.D. (London); B.A., M.Ed. (Melb); A.B.Ps.S.; F.C.P.; Professor of Education.  
*Thursdays, 6.15-7.30 p.m., starting October 2, 1969. University Main Building. 15*  
meetings. *Fee: \$60*

An introduction to the principles and problems of school management in the light of modern management studies and the findings of social psychology — with the emphasis on the professional tasks of school principals in Hong Kong. There will be lectures, discussions, film-sessions and full notes, and an invitation will be given to bring current practical administration problems to the symposium. Provision will be made for the organizational problems of subject-masters, careers specialists, school counsellors and supervisors, as well as for education students specializing in administration areas.

# English Studies

Staff Tutor in Charge: D.J.H. Macintosh, M.A. (Cantab.) Telephone No. H-468161 Ext. 304

## English as a Second Language

A sound working mastery of the fundamentals of English is one of the greatest needs in Hong Kong life. To meet this, the Department offers a carefully integrated and intensive scheme. This programme – “Use of English” I and II – is designed to develop and improve skills in written and oral English for people such as clerks, secretaries, junior executives, post-secondary students, teachers and others whose work, e.g. in commerce, industry, government and teaching, requires a thorough command of basic English.

As with all Extra-Mural courses these are not intended for students in Secondary Schools.

*The courses are examinable and those successfully completing Part II will qualify for a certificate in Advanced Use of English.*

Details of entry requirements are given with the course particulars below. This is essentially a 2 year scheme with Part I leading by examination results to Part II. However, applicants wishing to enter Part II immediately can do so provided they satisfy the entry requirements (See “Use of English” II).

---

### USE OF ENGLISH I

Classes will be held both in Hong Kong and Kowloon as follows:

- 96** HONG KONG: A panel of University Graduates in English. *Mondays and Thursdays, 6.15-7.45 p.m., starting October 2, 1969.* University Main Building. 48 meetings, twice weekly. *Composite Fee:* (Tuition and Examination) **\$215**

The aim of this course is to increase the Student's ability to handle the English language commencing with intensive oral work designed to eradicate faults in spoken English. This will be followed by drills of a remedial nature providing sound practice in the effective use of the language.

*Entry Requirements:*

Hong Kong English School Certificate or Hong Kong Chinese School Certificate pass in English. These should be of recent date. Preference will be given to those with a credit. Candidates are requested to enclose a photostat copy of the appropriate certificate along with their application form. Students will be allocated to classes according to qualifications to ensure the best teaching situation. There may be minor re-allocation after the first meeting with class tutors.

Parallel courses will be offered in Hong Kong and Kowloon and students should indicate their preference for location. This will be met if at all possible.

The number of classes offered is at the discretion of the Department, but every effort will be made to accommodate all those eligible.

*Details of Syllabus:*

A careful balance will be kept between spoken and written English, including essential revision of grammar and vocabulary-building. Use will be made of a wide range of selected reading material relevant to Hong Kong to develop powers of comprehension. More formal English practice will include precis, report and simple creative writing.

---

**KOWLOON:** A panel of University Graduates in English. *Tuesdays and Thursdays, 6-7.30 p.m., starting October 2, 1969.* Training Unit, Resettlement Department, Hotung House, Hankow Road, Tsimshatsui, Kowloon. 48 meetings, twice weekly. *Composite Fee:* (Tuition and Examination) \$215

97

*The course is examinable and intended to lead on to "Use of English" II.*

---

## USE OF ENGLISH II

Classes will be held both in Hong Kong and Kowloon if numbers justify as follows:

**HONG KONG:** A panel of University Graduates in English. *Mondays and Wednesdays, 6.15-7.45 p.m., starting October 1, 1969.* University Main Building. 48 meetings, twice weekly. *Composite Fee:* (Tuition and Examination) \$215

98

*Entry Requirements:*

Pass in terminal examination of "Use of English" I, Matriculation or recent G.C.E. O-Level English. There will also be selection by interview.

*Details of Syllabus:*

The aim of the course is to improve the student's grasp of idiomatic English through exercises in advanced comprehension and interpretation. It will involve wide and careful reading, including books and cyclostyled material, of varied styles and content-matter. This will develop the student's ability to read deeply and critically. Comprehension will be of two types: the writing of a precis after intensive study of a passage; and the answering of brief questions after rapid reading of a prose passage on a general topic, as training in quick assessment of essential points. The material used will include articles from newspapers or

periodicals on social, political and economic themes. Essay work will involve writing explanations and reports on the basis of information supplied, the purpose of this being to expand the student's ability to write clearly and logically in a given set of circumstances familiar to him.

On completing the course students may sit the examination leading to the Certificate in Advanced Use of English.

- 
- 99** **KOWLOON:** A panel of University Graduates in English. *Mondays and Thursdays, 6.00-7.30 p.m., starting October 2, 1969.* Training Unit, Resettlement Department, Hotung House, Hankow Road, Tsimshatsui, Kowloon. 48 meetings, twice weekly. *Composite Fee: (Tuition and Examination) \$215*

On completing this course students may sit the examination leading to the Certificate in Advanced Use of English.

- 
- 100** **COMPARATIVE PHONETICS OF ENGLISH AND MANDARIN** Mr. Raymond Huang, M.A. (Leeds), IPA Cert. Phon. (London), P.G.C. Ed. (London), L.R.A.M., L.T.C.L., (Lond.) *Fridays, 6.15-7.15 p.m., starting October 3, 1969.* University Main Building, H.K.U. 24 meetings. *Fee: \$85*

There will be a comparative analysis of the vowels, consonants, stress and intonation in English and Mandarin. Reference to Cantonese sounds will also be made.

It includes the use of pronouncing dictionaries in English, Mandarin and Cantonese.

The course will be valuable to teachers of English whose native speech is Mandarin. It will also be useful to English learners of Chinese who have some previous knowledge of Mandarin.

*The tutor is Principal, Sir Robert Black College of Education, Author of "English Pronunciation Explained with Diagrams" & "English Speech Training" and Co-author of "Intonation in Idiomatic English".*

- 
- 101** **INTONATION & IDIOMATIC ENGLISH** Mr. Raymond Huang, M.A. (Leeds), IPA Cert. Phon. (London), P.G.C.Ed. (London), L.R.A.M., L.T.C.L., (Lond.) *Fridays, 7.30-8.30 p.m., starting October 3, 1969.* University Main Building, H.K.U. 24 meetings. *Fee: \$85*

By showing the contrasts in stress and intonation between English and Chinese (Cantonese, Mandarin and Swatow) the tutor will help the Chinese student to grasp:

- (1) The tonal and rhythmic system of his mother tongue and
- (2) how errors in his English speech arise from his native language habits.

Methods to correct errors will be suggested and graded aural-oral exercises on English Intonation will be provided. Intonation practice will be related to everyday idiomatic English in order to increase the student's range of expression.

*The tutor is Principal, Sir Robert Black College of Education, Author of "English Pronunciation Explained with Diagrams" & "English Speech Training" and Co-author of "Intonation in Idiomatic English".*



## English for Teachers

**TEACHING ENGLISH AS A SECOND LANGUAGE** Miss Valerie C. Vince, B.A. (B'ham), Dip.Ed. (Lond.). *Mondays, 6.00-7.00 p.m., starting October 6, 1969.* University of Hong Kong, Language Centre. 10 meetings. Enrolment limited to 12. *Fee: \$50* **102**

This course is designed to deal with various aspects of the teaching of English as a second language, with particular reference to elementary and intermediate levels. It aims to cover topics such as methods of presentation, structural drill, oral pattern practice, teaching of reading, written composition. Attention will also be given to the selection, grading and writing of materials according to the needs of the students, and the use and preparation of audio-visual aids.

---

**ENGLISH TEACHING TECHNIQUES** Mr. William Cheng, B.A., Dip.Ed. (H.K.U.), Dip. in App. Ling. (Edin.) Education Officer. *Mondays, 6.15-7.15 p.m., starting October 13th 1969.* University Main Building, H.K.U. 20 meetings. *Fee: \$70* **103**

Planned to assist secondary school teachers of English this course will deal with up-to-date techniques applicable to the main areas of the curriculum. The basic problems of language teaching will be outlined and then dealt with in detail as follows:-

1. Principles of limitation, arrangement and presentation.
2. Reading: Intensive; English prose and poetry.
3. Vocabulary, dictation.
4. Composition: Oral preparation, outlining and class discussion, marking.
5. Comprehension and precis writing.
6. The novel.

---

## English Studies for Commercial Use

**ENGLISH FOR HIGHER COMMERCIAL STUDIES** Mr. Jeffrey Liang, B.A. (H.K.). *Fridays, 6.15-8.15 p.m., starting October 10, 1969.* University Main Building, H.K.U. 24, two-hour sessions. *Fee: \$120* **104**

A course specially intended for candidates preparing for the Chartered Institute of Secretaries Intermediate Examination. Entry will be restricted to students who

- (a) have registered for the C.I.S. Examination and also
- (b) hold a Hong Kong English School Certificate with a Pass in English or a Hong Kong Chinese School Certificate with a Credit in English.

## English for Critical Appreciation

- 105** **"MAKE IT NEW": A PRACTICAL APPROACH TO FOUR OF SHAKESPEARE'S PLAYS** Mr. R. Kirkpatrick, B.A. (Oxon.), Assistant Lecturer, Department of English, University of Hong Kong. *Wednesdays, 6.30-7.30 p.m., starting October 1, 1969.* Drama Workshop, University of Hong Kong. 10 meetings. *Fee: \$35*

Mr. Kirkpatrick is noted for his interest in drama as staged and he will discuss a number of plays from the viewpoint of production. He will deal with interpretations that have been presented in recent productions of the plays or which might have appeal to a modern audience.

Plays to be discussed:

Hamlet  
Troilus and Cressida  
Twelfth Night  
The Tempest  
(all in the "Signet" Shakespeare)

- 
- 106** **BRITISH & AMERICAN CONTEMPORARY LITERATURE** Mrs. Emily Fox Kales, B.A. (Barnard); M.A. (New York). *Wednesdays, 2.30-3.30 p.m., starting October 1, 1969.* Extra-Mural Town Centre. 12 meetings. *Fee: \$35*

The class will read and discuss major British and American novelists of the 20th century (e.g. Faulkner, Fitzgerald, Joyce, Graham Greene, D.H. Lawrence). A major aim of the course will be to teach the art of "slow reading"; that is, the ability to analyze a novel not merely as a good story, but as a literary form composed of such techniques as characterization, symbolism, structure, and style. At the same time, the class will also attempt to define the predominant themes of our times as they are expressed in the novels studied.

---

# Geology and Geography

*Staff Tutor in Charge: Jon A. Prescott, B. Arch. (Liv.); M.C.D., A.R.I.B.A., A.M.T.P.I.  
Telephone No. H-468161 Ext. 305*

The current Geography and Geology programme emphasizes on the one hand up-dating courses for teachers, e.g. Geography of United States and Canada, and on the other techniques and methods in geographical research, especially in urban and human geography. This reflects the current trend in geographical studies in Hong Kong.

Interested laymen as well as professionals of other disciplines should also find the programme appealing and are welcome to enrol.

---

**TECHNIQUES OF URBAN ANALYSIS** *Wednesdays, 6.15-8.15 p.m. (and one weekend to be decided by class) starting October 15, 1969. University Main Building, ten, 2-hour sessions.* **107**  
*Fee: \$120*

Tutors: from the Department of Geography, University of Hong Kong.  
Dr. T. G. McGee, M.A., Ph. D. (NZ), Senior Lecturer, H.K.U.  
Mr. D. Drakakis-Smith, M.A. (Aberdeen), Lecturer, H.K.U.  
Mr. P. Shoebridge, B.A. (Durham), Lecturer, H.K.U.  
Mr. S. Richards, B.Sc. (Econ.) (Lond.), Lecturer, H.K.U.

Designed for people interested in research techniques, this course provides a broad introduction to the rapidly changing and developing technical aspects of urban analysis. It will cover such topics as:

- Techniques of Urban Delimitation,
- Techniques of Urban Field Observation,
- Techniques of Demographic Analysis,
- The analysis of urban systems,
- The analysis of city economic structure,
- The utilization of air photographs in urban analysis,
- The analysis of urban-rural relations.

Practical work would be included in the course. Enrolment will be strictly restricted to 30 persons.

---

- 
- 108** **GEOGRAPHY OF UNITED STATES AND CANADA** Dr. C.B. Varney, B.A. (Colorado); A.M. (Clark); Ph. D. (Clark); Senior Lecturer, United College, Chinese University of Hong Kong. *Thursdays, 5.30-7.00 p.m., starting October 16, 1969.* Extra-Mural Town Centre. 10 meetings. *Fee: \$70*

The course is specifically designed for teachers of geography to update their knowledge of the United States and Canada, though secondary school teachers of other subjects are also welcome to join. Its emphasis will be on changes of patterns of population, agriculture, forestry, mining, fishing, manufacturing, and transportation, both regionally and nationally. Causes and effects of the changes will also be discussed. Lectures will be illustrated wherever possible.

Participants are assumed to have a basic knowledge of the landform and and climate of the United States and Canada.

- 
- 109** **GEOGRAPHY IN THE FIELD (PHYSICAL)** Mr. Tam Sai Wing, B.A. (H.K.), Demonstrator, Dept. of Geography & Geology, H.K.U. *Tuesdays, 6.15-7.15 p.m., and field trips on Saturdays/Sundays, starting October 28, 1969.* University Main Building, H.K.U. 12 meetings. *Fee: \$60*

The course fee does not include expenses incurred on the excursions. Enrolment is strictly limited to 30 persons. Participants should be physically fit and capable of climbing and hiking.

The operation of physical processes on geological structure giving rise to special topographical features will be discussed in lectures and studied in detail during field trips. Methods of field investigation will be considered.

There will be 6 indoor lectures and 6 field trips. Places to be visited include: Ma Sze Chau/Lai Chi Chong, Deep Water Bay Road/Pokfulam Road, Castle Peak/Devil's Peak Area, Yuen Long Plain/Pak Tam (Sai Kung Peninsula), Boulder Point (Sai Kung Peninsula)/Rocky Harbour, Ma On Shan/Cha Ko Ling.

- 
- 110** **QUANTITATIVE TECHNIQUES IN HUMAN GEOGRAPHY** Mr. Stewart F. Richards, B.Sc. (Econ.) (Lond.) *Wednesdays, 6.15-7.15 p.m., starting March 11, 1970.* University Main Building, H.K.U. 10 meetings. *Fee: \$60*

Maximum enrolment is limited to 20 persons.

- 
- 111** **GEOGRAPHY IN THE FIELD (PHYSICAL)** Mr. Tam Sai Wing, B.A. (H.K.), Demonstrator, Dept. of Geography & Geology, H.K.U. *Tuesdays, 6.15-7.15 p.m., field trips on Saturdays/Sundays, starting Feb. 17, 1970.* University Main Building, H.K.U. 12 meetings *Fee: \$60*

- 
- 112** **GEOGRAPHY IN THE FIELD (HUMAN)** Mr. D.W. Drakakis-Smith, M.A., Dip. Ed. (Aberdeen), Lecturer, Dept. of Geog. & Geol., H.K.U.

A series of 12 lectures and field trips to focus on urban studies. Commencing Spring 1970.

**PRIOR ENROLMENT IS ESSENTIAL**

Failure to enrol prior to the opening of a particular course, may, mean the cancellation of that course. Prior enrolment is the only way the Department of Extra-Mural Studies has of judging the response to its courses. Your co-operation is therefore invited in sending your application forms to the Department as soon as possible.

# History and International Affairs

Staff tutor in Charge: Nana Tsao, B.A., Dip. Ed. (H.K.) Telephone No. 468161 Ext. 306

---

- 113** CHINA'S RELATIONS WITH THE WEST (with special reference to Anglo-Chinese relations 1839-1916) Dr. K.C. Chan (Mrs.), B.A. (H.K.); Ph.D. (London), Lecturer, Department of History, H.K.U. *Tuesdays, 5.30-6.45 p.m., starting October 7, 1969.* Extra-Mural Town Centre. 10 meetings. *Fee: \$35*

This series of lectures attempts to analyse in historical terms China's relations with the West between 1839-1916. Topics will include:

- The Ch'ing treatment of Non-Chinese peoples within the Chinese Empire;
- The tributary system;
- Ch'ing's relations with the West up to the 1830's;
- The first and second Anglo-Chinese wars;
- The Tsungli Yamen and the Wai-wu Pu;
- The Scramble for concessions and the Boxer Rising;
- Foreign Christian Missionary activities;
- Railway concessions;
- The Constitutional and Revolutionary Movements;
- Yuan Shih-k'ai and John N. Jordan (British Minister to Peking).

---

- 114** DEVELOPMENT OF THE CHINESE PROTESTANT CHURCH IN HONG KONG  
Rev. Carl T. Smith, A.B. (De Pauw); B.D. (Union Theological Seminary, N.Y.),  
Lecturer, Theology Division, Chung Chi College, Chinese University. *Wednesdays, 5.45-6.45 p.m., starting October 1, 1969.* Extra-Mural Town Centre. 10 meetings. *Fee: \$30*

Along with a general survey of the development of the Chinese Protestant Church in Hong Kong, special attention will be paid to the following:

- The gathering and organization of congregations by various missionary groups during the Nineteenth Century.
- Gutzlaff, the Chinese Christian Union and their relation to the Taiping movement.
- The role of the Church and its members in the social, economic and political development of Hong Kong.
- The missionary activity of the local Christians and their relation to the development of Christian communities among the overseas Chinese.

---

---

**POLITICS IN CHINESE COMMUNISM** Dr. Lee Ngok, M.A., Dip. Ed. (H.K.); Ph.D. (London), Lecturer, Department of History, University of Hong Kong. *Thursdays, 7.00-8.00 p.m., starting September 25, 1969.* City Hall, Committee Room South, 7/F., Hong Kong. 10 meetings. *Fee: \$40*

115

This course provides a critical study of politics in Chinese Communism. Major topics for discussion will include:

The Communist Party hierarchy & its relations with the Army, Administration & the Masses.  
The People's Liberation Army – its origin, military tactics & principles, types of warfare.  
The Village: the base for mass mobilization; its political & economic significance.  
Ideology: from Marxism – Leninism to Mao's thought; orthodoxy & sinification.  
Biographical sketches of major Communist leaders in China.

(It is desirable that participants should possess some background knowledge of the History of Modern China.)

---

**THE INFLUENCE OF SEA POWER ON MODERN EAST ASIAN HISTORY** Dr. N.R. Bennett, B.Sc. (Econ.), Ph.D. (London), Lecturer, Department of History, H.K.U. *Tuesdays, 6.15-7.15 p.m., starting January 20, 1970.* University Main Building, H.K.U. 12 meetings. *Fee: \$40*

116

What is sea power? What part does it play in the history & international relationship of China & Japan? This course attempts to explore & interpret the influence of sea power on Modern East Asian history. Topics, with a series of case studies, will include:

Strategy & Asian geography;  
Sea power & the opening of China & Japan;  
Sea power & the Informal Empire: The Gunboat;  
Sea power & modernization: Japan's Quest & China's Failure;  
Sea power & technological change: The Sino-Japanese War 1894-95;  
Sea power & diplomacy: Naval factors in the Anglo-Japanese Alliance;  
The Russo-Japanese War;  
Sea power and power politics: The Japanese-American arms race 1907-1922;  
Disarmament & diplomacy: The Washington Agreements;  
The new era in the Far East: Sea power & Asian security 1918-1914;  
The Second World War.

---

# Oriental Languages

Staff Tutor in Charge: Nana Tsao, B.A., Dip. Ed. (H.K.) Telephone No. 468161 Ext. 306

---

The Oriental Languages Programme, taught in English except if otherwise stated, offers continuous study of Chinese (Cantonese and Mandarin) and Japanese over a period of up to two years. A good standard of English is essential for admission.

**THE CHINESE PROGRAMME** is designed to cover the basic spoken language used in everyday life in two sessional series spanning just under eleven months, as compared to two academic years formerly. It is also designed to allow several in-take periods at different levels and at different times of the day, so that prospective students no longer have to wait for a year to join a basic course. Moreover, there will no longer be a break of five months between courses in the summer.

Cantonese students are further provided with a third sessional series, and are there given the choice to start written work or to further their spoken competence or both.

Course fees for courses 117 to 131 inclusive with the exception of nos. 126 and 127 include \$20 for 12 hours of laboratory work at Caritas House, Caine Road, of which at least 3 hours will be conducted by tutor at course time.

- 
- 117** MANDARIN I Mr. Shih Wan-chu, B.A., Instructor, Language School, University of Hong Kong. *Mondays & Thursdays, 6.15-7.15 p.m., from October 2, 1969*, at Main Building, H.K.U. Fee: \$200 for 40 meetings.
- 

Textbook: *Beginning Chinese*, by John De Francis, Yale University Press

- 118** MANDARIN I Mr. Shih Wan-chu, B.A., Instructor, Language School, University of Hong Kong. *Mondays & Thursdays, 7.30-8.30 p.m., from April 2, 1970*. Fee: \$200 for 40 meetings.
- 

Textbook: *Beginning Chinese*, by John De Francis, Yale University Press

- 119** CANTONESE I Mr. Paul Fong, B.A., Dip. Ed. (H.K.) *Mondays & Thursdays, 6.15-7.15 p.m., from September 22, 1969*, at University Main Building. Fee: \$200 for 40 meetings.
- 

- 120** CANTONESE I Mr. Francis Sham, B.A. (Sun Yat-sen), Language School, H.K.U. *Tuesdays & Fridays, 6.15-7.15 p.m., from October 3, 1969*, at University Main Building. Fee: \$200 for 40 meetings.
- 

- 121** CANTONESE I Mr. Paul Fong, B.A., Dip. Ed. (H.K.). *Mondays & Thursdays, 7.30-8.30 p.m., from March 19, 1970*. Fee: \$200 for 40 meetings.
-



---

**MANDARIN II** Mr. Shih Wan-chu, B.A., Instructor, Language School, University of Hong Kong. *Mondays & Thursdays, 7.30-8.30 p.m., from October 2, 1969*, at University Main Building. Fee: \$200 for 40 meetings. **122**

Textbook: *Chinese Dialogues*, Yale University, Mirror.

---

**MANDARIN II** Mr. Shih Wan-chu, B.A., Instructor, Language School, University of Hong Kong. *Mondays & Thursdays, 6.15-7.15 p.m., from April 2, 1970*. Fee: \$220 for 40 meetings. **123**

Textbook: *Chinese Dialogues*, Yale University, Mirror Series.

---

**CANTONESE II** Mr. Paul Fong, B.A., Dip. Ed. (H.K.) *Mondays & Thursdays, 7.30-8.30 p.m., from September 22, 1969*, at University Main Building. Fee: \$220 for 40 meetings. **124**

**CANTONESE II** Mr. Paul Fong, B.A., Dip. Ed. (H.K.) *Mondays & Thursdays, 6.15-7.15 p.m., from March 19, 1970*. Fee: \$220 for 40 meetings. **125**

**CANTONESE III** Mr. C.S. Hung, B.A. (Chinan), Instructor, Language School, University of Hong Kong. *Wednesdays, 7.30-8.30 p.m., from October 15*, at University Main Building. Fee: \$200 for 34 meetings. **126**

**CHINESE CHARACTERS (in Cantonese)** Mr. Paul Fong, B.A., Dip. Ed. (H.K.) *Wednesdays, 6.15-7.15 p.m., from October 15 1969*, at University Main Building. Fee: \$200 for 34 meetings. **127**

---

## Day Time Programme

**CANTONESE I** Mr. Francis Sham, B.A. (Sun Yat-sen), Language School, University of Hong Kong. *Tuesdays & Fridays, 2.00-3.00 p.m., from October 3, 1969*, at Extra-Mural Town Centre **128**

**CANTONESE I** Mr. C.S. Hung, B.A. (Chinan), Instructor, Language School, University of Hong Kong. *Mondays & Thursdays, 2.00-3.00 p.m., from October 1970*. Fee: \$200 for 40 meetings. **129**

**CANTONESE II** Mr. C.S. Hung B.A. (Chinan), Instructor, Language School, University of Hong Kong. *Mondays & Thursdays, 2.00-3.00 p.m., from March 23, 1969*. at Extra-Mural Town Centre. Fee: \$220 for 40 meetings. **130**

**CANTONESE II** Mr. Francis Sham, B.A. (Sun Yat-sen), Language School, University of Hong Kong. *Tuesdays & Fridays, 2.00-3.00 p.m., from March 24, 1970*. Fee: 220 for meetings. **131**

---

---

**THE JAPANESE PROGRAMME** is designed to meet the need of both Chinese speaking and non-Chinese speaking students, who will both cover an identical syllabus in two academic years. However, with Chinese speaking students, the emphasis is on written as well as spoken Japanese, whereas with non-Chinese speaking students, for practical reasons, the emphasis will be mainly on spoken Japanese.

---

- 132** **JAPANESE I A.** Miss Ip Kock-hung, B.A. (CUHK); M.A. (Kyoto); Lecturer, M.O.D., Chinese Language School. *Tuesdays & Fridays, 6.15-7.15 p.m., starting October 7, 1969.* University Main Building. 48 meetings, twice weekly. *Fee: \$200*

Medium of Teaching. Cantonese

Mainly designed for Chinese speaking students, this course aims at providing beginners with a firm foundation in colloquial Japanese; and in basic grammar. Students are required to have some knowledge of Chinese and to do at least four hours of home-work every week.

Textbook: *Japanese Text Book*. The Japanese Language Research Institute, Waseda University, Japan.

---

- 133** **JAPANESE I B.** Mr. Robert Wang, R.A. (Waseda, Tokyo), Japanese Teacher, *Tuesdays & Fridays, 6.15-7.15 p.m., starting October 7, 1969.* University Main Building. 48 meetings, twice weekly. *Fee: \$200*

Medium of Teaching: English

Mainly designed for non-Chinese speaking students, this course aims at providing beginners with a firm foundation in colloquial Japanese and in basic grammar. Sufficient time will be devoted to oral practice.

Textbook: *Japanese Text Book*, Japanese Language Research Institute, Waseda University, Tokyo.

---

- 134** **JAPANESE II** Miss Ip Kock-hung, B.A. (CUHK), M.A. (Kyoto); Lecturer, M.O.D., Chinese Language School. *Tuesdays & Fridays, 7.30-8.30 p.m., starting October 7, 1969.* University Main Building. 48 meetings, twice weekly. *Fee: \$220*

Medium of Teaching: Japanese/English

Besides serving as an advanced course in colloquial Japanese, this course will include more literary and grammatical exercise.

Textbook: *Japanese Text Book*, Japanese Language Research Institute, Waseda University, Tokyo.

---

# European Languages

*Staff Tutor in Charge:* D.J.H. Macintosh, M.A. (Cantab) *Telephone No.* 468161 *Ext.* 304

The European language programme, taught in English, offers continuous study of any one such language over a period of two or three years. At the end of that time, a student with no previous knowledge of the language chosen should, if he has done the work recommended by the tutor (which should not be less than three or four hours a week in addition to classwork) have a competent command of the spoken and a basic knowledge of the written language.

Each sessional course is by itself a self-contained unit. Students should therefore enrol at the level appropriate to their knowledge of the language.

A good standard of English is essential for admission.

## FIRST YEAR COURSES

These sessional courses are intended for beginners. The aim is to give students the facility and confidence to express themselves orally and to understand simple daily conversation in the language, while sufficient attention will also be given to building up a basic written vocabulary, and to basic grammar.

---

<b>FRENCH I</b> Mrs. D. McLachlan. <i>Tuesdays &amp; Fridays from October 7, 6.15-7.15 p.m.,</i> at University Main Building. <i>Fee: \$200</i> for 48 meetings. Textbook: <i>Living French</i> , by T.W. Knight.	<b>135</b>
<b>GERMAN I</b> Dr. H. Von Hoyningen-Huene, D.M. (Berlin). <i>Mondays &amp; Thursdays from October 6, 6.15-7.15 p.m.,</i> at University Main Building. <i>Fee: \$200</i> for 48 meetings. Textbook: <i>Deutsche Sprachlehre fur Auslander</i> , by Schulz-Griesbach.	<b>136</b>
<b>ITALIAN I</b> Miss Elena Carbonaro, B.A. (Rome), Italian Consulate General, <i>Mondays &amp; Thursdays, from October 6, 6.15-7.15 p.m.,</i> at University Main Building. <i>Fee: \$200</i> for 48 meetings.	<b>137</b>
<b>RUSSIAN I</b> Mr. J.R. Canning, B.A. (Lond.). <i>Wednesdays &amp; Fridays, from October 15, 6.15-7.15 p.m.,</i> at Main Building, University of Hong Kong. <i>Fee: \$250</i> for 40 meetings. Textbook: <i>A New Russian Grammar</i> , Semeonoff.	<b>138</b>
<b>SPANISH I</b> Mr. F.V. Borboa, B.S. (Mexico). <i>Wednesdays &amp; Fridays, from October 8, 7.00-8.00 p.m.,</i> in Committee Room South, City Hall. <i>Fee: \$200</i> for 48 meetings. Textbook: <i>El Espanol Al Dia</i> , Book One, by L.H. Turk & E.M. Allen.	<b>139</b>

---

## SECOND YEAR COURSES

These sessional courses are intended for those who have completed course I or have attained an elementary knowledge of the language by some other means. While the emphasis will continue to be on the spoken language used in everyday situations, more attention will be devoted to grammar, comprehension and simple constructions.

- 
- 140** **FRENCH II** Mrs. D. McLachlan. *Tuesdays & Fridays, from October 21, 7.30-8.30 p.m.*, at University Main Building. *Fee: \$220 for 48 meetings.*  
Textbook: *Living French* by T.W. Knight (Chapter 15 to the end)
- 
- 141** **GERMAN II** Dr. H. Von Hoyningen-Huene, D.M. (Berlin). *Mondays & Thursdays, from October 6, 7.30-8.30 p.m.*, at University Main Building. *Fee: \$220 for 48 meetings.*  
Textbook: *Deutsche Sprachlehre für Ausländer*, by Schulz-Griesbach.
- 
- 142** **ITALIAN II** Miss Elena Carbonaro, B.A. (Rome), Italian Consulate General, *Mondays & Thursdays, from October 6, 7.30-8.30 p.m.*, at University Main Building. *Fee: \$200 for 48 meetings.*
- 
- 143** **SPANISH II** Mr. F.V. Borboa, B.S. (Mexico). *Wednesdays & Fridays, from October 8, 8.00-9.00 p.m.*, in Committee Room South, City Hall. *Fee: \$220 for 48 meetings.*  
Textbook: *El Español Al Día*, Book Two, by L.H. Turk & E.M. Allen.
- 

## THIRD YEAR COURSES

These sessional courses, intended for those who have completed a second year course or who have reached a similar standard by some other means, are only offered when sufficient demand is anticipated or in response to students' requests. The work of the class will include grammar, reading and constant practice in conversation.

- 
- 145** **FRENCH III** Mrs. D. McLachlan. *Mondays & Thursdays, from October 6, 7.30-8.30 p.m.*, at University Main Building. *Fee: \$250 for 48 meetings.*  
Textbook: *Modern Method French Course*, Book 5, by E.B. Crampton & C.E. Loveman.
-

# Law

*Staff Tutor in Charge:* Priscilla Tso, B.A. Dip. Ed. (H.K.), Dip. Ad. Ed. (Manch.)  
*Telephone No.* H-468161 Ext. 303

The courses in this section are designed to be of assistance to those preparing for the London University External LL.B., Solicitor and Bar Examinations and such professional examinations as the Chartered Institute of Secretaries, Association of Certified and Corporate Accountants, etc. Those intending to sit these examinations should make their own arrangements.

---

**ENGLISH MERCANTILE LAW** Mr. Charles Lee, LL.M. (Lond.). *Mondays, 5.45-8.00 p.m., starting September 22, 1969.* Extra-Mural Town Centre. 15 meetings. **146**  
*Fee: \$105*

A course preparing candidates for the Final Part I Examination of the Chartered Institute of Secretaries and the Intermediate Examination of the Association of Certified and Corporate Accountants. It will deal with general principles of the law of contract, negotiable instruments, sale of goods, hire purchase, carriage of goods by land, sea and air, agency, partnership, bankruptcy, guarantee and indemnity, insurance, bailment, lien, arbitration and bill of sale.

---

**PRINCIPLES OF ENGLISH LAW** Mr. Frank Addison, Senior Crown Counsel, *Thursdays, 5.45-8.00 p.m., starting September 25, 1969.* Extra-Mural Town Centre. 15 meetings. **147**  
*Fee: \$105*

A course preparing candidates for the Intermediate Examination of the Chartered Institute of Secretaries. The course covers the nature and sources of English Law; Common Law; equity and custom; the Judicature Acts; statute law; judicial precedent; legal persons and personal relations; real property and personal property; wills and intestacy; general principles of contract and torts.

---

**COMPANY LAW** Mr. David Ling, Solicitor. *Wednesdays, 7.00-8.00 p.m., starting September 24, 1969.* Extra-Mural Town Centre. 25 meetings. **148**  
*Fee: \$90*

A course preparing candidates for the A.C.C.A. Section III, C.I.S. Final Part II and Solicitor's Part II Examinations. The course will deal with the following topics: The principle of corporate personality and of limited liabilities; formation; memorandum and articles and alterations thereto; contracts and dealings with companies, share capital; allotment and transfer of shares; dividend; debentures; directors; shareholders' meetings; protection of minority shareholders; private companies; winding up (in outline only); reconstruction and amalgamation; holding and subsidiary companies.

---

**CRIMINAL LAW** Mr. Winston Chu, LL.B., Solicitor. *Thursdays, 7.00-8.00 p.m., starting September 25, 1969.* Extra-Mural Town Centre. 30 meetings. **149**  
*Fee: \$105*

This course covers the classification of crimes: general principles of responsibility; general defences; offences against the person; offences against property; offences against public order and the administration of justice; highway offences; libel; bigamy.

The following courses prepare candidates for the London University External LL.B. Intermediate Examination.

- 
- 150** ENGLISH LEGAL SYSTEM Mr. J.F. Mathews, Crown Counsel. *Tuesdays, 7.00-8.00 p.m., starting September 23, 1969.* Extra-Mural Town Centre. 30 meetings. *Fee: \$105*
- 
- 151** CONSTITUTIONAL LAW Mr. E.R. Astin, LL.B. (London.) Crown Counsel. *Tuesday, 8.15-9.15 p.m., starting September 23, 1969.* Extra-Mural Town Centre. 30 meetings. *Fee: \$105*
- 
- 152** ROMAN LAW Mr. F.G. Cooke, M.A., LL.B., Barrister-at Law, Senior Crown Counsel. *Thursdays, 5.45-6.45 p.m., starting September 25, 1969.* Extra-Mural Town Centre. 35 meetings. *Fee: \$130*
- 
- 153** LAW OF CONTRACT Mr. T.J. Van Rees, *Thursdays, 7.00-8.00 p.m., starting September 25, 1969.* Extra-Mural Town Centre. 30 meetings. *Fee: \$105*
-

# Librarianship

*Staff Tutor in Charge: Priscilla Tso, B.A., Dip. Ed. (H.K.), Dip. Ad. Ed. (Manch.),  
Telephone No. 468161 Ext. 303*

The Intermediate Part I course is designed for those wishing to take up Librarianship as their profession. The course, of 11 months' duration, prepares candidates for the December 1970 United Kingdom Library Association Intermediate Part I Examination.

Those who do not wish to take the professional examination but are working as Library Assistants or in school, children and government department libraries or are otherwise interested in the subject, are advised to take the certificate course for library assistants.

---

**LIBRARIANSHIP: INTERMEDIATE PART I COURSE** *Mondays & Thursdays, 6.15-8.30 p.m., starting September 22, 1969.* University Main Building, University of Hong Kong. 76 Lectures twice weekly (2 hours each session), 9 sessions Practical Work (3 hours each). *Fee: \$600*

154

Tutors from the library of the University of Hong Kong:

- Dr. L.B. Kan, B.Sc., (H.K.), M.A., M.A., M.L.S. (Calif.), Ph. D. (H.K.), Sub-Librarian. (Tutor-in-Charge).
- Miss Colleen Cheung, B.A., Dip. Ed. (HK), A.L.A., Asst. Librarian.
- Mrs. Euphine M. Chung, B.A., Dip. Ed. (HK), M.S.L.S. (Col.), Asst. Librarian.
- Mrs. Lily H.S. Lee, B.A. (Nanyang), M.L.S. (Atlanta), Asst. Librarian.
- Mr. John C.S. Lam, B.A. (HK), M.L.S. (Hawaii), Asst. Librarian.

A comprehensive course specially designed to prepare candidates for the United Kingdom Library Association Intermediate Part I Examination. The Examination can be taken in Hong Kong in June and December.

Students taking these courses now advertised are advised to sit for the Examination in December 1970.

Library Association Part I Examination:-

- Paper 1: The Library and the Community
- Paper 2: Government and Control of Libraries
- Paper 3: Organization of Knowledge.
- Paper 4: Bibliographical control and service.

Minimum Entry Qualifications: Hong Kong University Matriculation or its equivalent. Enrolment is limited to 25 persons.

*Closing date for applications: September 12, 1969.*

Applicants are requested to enclose photostat copies of the appropriate certificates along with their application forms.

---

**CERTIFICATE COURSE FOR LIBRARY ASSISTANTS** *Tuesdays & Fridays, 6.15-7.15 p.m., starting September 23, 1969.* University Main Building, University of Hong Kong.

**Tutors:**

Dr. L.B. Kan, B.Sc., (H.K.), M.A., M.L.S. (Calif.), Ph. D. (H.K.), Sub-Librarian, University Library. (Tutor-in-Charge).

Miss Colleen Cheung, B.A., Dip. Ed. (HK), A.L.A., Asst. Librarian, University Library.

Mr. John C.S. Lam, B.A. (HK), M.L.S. (Hawaii), Asst. Librarian, University Library.

Mrs. W. Steynberg, A.S.A.L.A., Librarian, Fisheries Research Station.

The course consists of four sections:

Part 1:	Library Routines & Methods		
	No. of Meetings:	38	Fee: \$120
Part 2:	General Library Principles & Practice		
	No. of Meetings:	14	Fee: \$ 50
Part 3:	Children's Libraries — including school libraries		
	No. of Meetings:	10	Fee: \$ 45
Part 4:	Practical Work & Visits to Libraries		
	Time: March 24-26 & March 31, April 1-2, 1970.		
	No. of Meetings: 6 morning & 2 afternoon sessions of 3 hours each (excluding visits)		Fee: \$120

The combined fee for the whole course is \$300 (including examination fee).

Enrolment is limited to 30 persons. Priority will be given to those working in libraries.

*Closing date for applications:* September 9, 1969.

Applicants are requested to enclose photostat copies of the appropriate certificates along with their application forms.

The course is planned in co-operation with the Hong Kong Library Association and is designed to provide a non-professional training for Library Assistants and those working in children's libraries.

**Examination Requirements:-**

- (1) Hong Kong English School Leaving Certificate or Chinese School Leaving Certificate with Credit in English or its equivalent;
- (2) Hong Kong Library Association membership (tutors will assist students to apply for membership after the commencement of the course);
- (3) 75% attendance at lectures. Practical work and visits are compulsory.

Date of Examination: June 13, 1970

If successful, candidates will be awarded a certificate issued jointly by the Hong Kong Library Association and the Department of Extra-Mural Studies.

Applicants are advised not to take any other public examination in the same year.



# Mathematics

*Staff Tutor in Charge: Priscilla Tso, B.A. Dip. Ed. (H.K.), Dip. Ad. Ed. (Manch.)  
Telephone No. H-468161 Ext. 303*

---

**MODERN MATHEMATICS FOR TEACHERS I** Mr. Tsui See Ming, B.A., Dip. Ed. (HK). *Fridays, 7.00-8.30 p.m., starting September 26, 1969.* Committee Room North, City Hall. 15 meetings. **156**  
*Fee: \$75*

A course designed for secondary school teachers. The following topics will be dealt with: the concept of number, logic, deductive methods in mathematics, probability (a new approach), groups, and geometric transformations.

---

**INTRODUCTION TO CALCULUS** Mr. Lee Kwok Pun, B.A. (HK) & Mr. Tsang Yok Sing, B.A. (HK). *Fridays, 7.30-9.00 p.m., starting October 3, 1969.* University Main Building. 10 meetings. **157**  
*Fee: \$50*

The following topics will be covered: Limits, Gradients, Derived Functions. Differentials, differential coefficients; applications to geometry and kinematics. Differentiation of algebraic functions. Maxima and minima. Integration as opposite of differentiation. Areas; trigonometric functions. Integration by summation; volumes; mean values. Methods of Integration. Logarithmic and Exponential Functions. Hyperbolic Functions; systematic integration.

---

**MODERN MATHEMATICS FOR PARENTS I** Mr. Tsui See Ming, B.A., Dip. Ed. (HK). *Fridays, 5.30-6.30 p.m., starting September 26, 1969.* Committee Room North, City Hall. 15 meetings. **158**  
*Fee: \$50*

The first of a series of three courses intended to introduce the basic principles of modern mathematics to parents and interested laymen. It will deal with topics taken from the syllabuses of lower forms in secondary schools.

---

**MODERN MATHEMATICS IN PRIMARY SCHOOLS** **159**  
Commencing in Spring 1970

---

# Philosophy & Psychology

Enquiries: Telephone No. H-468161 Ext. 301

## Philosophy

- 160** **LOGIC: A MODERN INTRODUCTION** Mr. Law Yip-wang, M.A. (Hawaii & UCLA). Mondays, 7.00-8.00 p.m., starting October 6, 1969. Extra-Mural Town Centre. 12 meetings. *Fee: \$40*

### 邏 輯 新 引

本課程共十二講，旨在介紹現代邏輯的一些初步概念，並從現代邏輯的觀點討論若干傳統邏輯的題材，內容包括選取推論，條件推論，二難式，位換，對當關係，三段式，類，二元關係等等。歡迎初學者參加。

本課程將以殷海光先生的「邏輯新引」為主要參考書，並由講者略加修訂與補充。

主 講 人：羅業宏碩士

講 授 語 言：粵 語

地 點：香港大學校外課程部市區中心

時 間：一九六九年十月六日起每星期一下午七時至八時

學 費：四十元

- 
- 161** **LOGIC AND LANGUAGE** Dr. D.Y.F. Ho, Lecturer, Dept. of Psychology, University of Hong Kong. Mondays, 7.30-8.30 p.m., starting October 13th, 1969. Extra-Mural Town Centre. 10 meetings. *Fee: \$30*

The series will deal with logic as an art of reasoning that can be applied to everyday problems. The rules of correct thinking will be applied to topics — social and political — that people argue about in daily life. By using examples of faulty arguments the lecturer will show how confusions arise out of a misuse logic and language.

- 
- 162** **AN OUTLINE OF MODERN PHILOSOPHY.** Mr. T.C. Goodrich, B.A. (Birmingham). Twenty one-hour meetings. *Commences January 1970.*
-

**THE PSYCHOLOGY OF ADJUSTMENT** Mr. J.P. Yap, B.A. (Aust.). *Fridays, 5.45-6.45 p.m., starting October 10, 1969.* Extra-Mural Town Centre. 10 meetings. **163**  
*Fee: \$35*

Adjustment problems and techniques in everyday situations concerning people within the age group of 18 to 45 will be the main theme of the course. Thus adjustments of individuals within the family, adjustments to work and marriage, group adjustments, adjustments for old age and other relevant topics will be thoroughly examined and discussed.

The course is open to people of all professions but its total enrolment is restricted to about 20 persons.

---

**PSYCHOLOGY OF ADVERTISING** Dr. Tam Wai-hon. *Tuesdays, 6.00-7.00 p.m., starting Sept. 30, 1969.* British Council Library, Kowloon. 12 meetings. **164**  
*Fee: \$45*

## 廣 告 心 理 學

廣告為工商業謀推銷其產品及貨品，使大眾週知之一種宣傳方法，本科討論有效廣告應知之各種方法，技術；廣告之各種媒介物如報紙，雜誌，廣播電視等等；廣告之物質及心理因子，吸引注意及深度或動機的研究等等。凡十二講，歡迎學員參與討論。

主 講 人：譚維漢博士

講授語言：粵語

地 點：九龍英國文化協會講室

時 間：一九六九年九月三十日起每星期二下午六時至七時

學 費：四十五元

---

**SOCIAL PSYCHOLOGY** Dr. Tam Wai-hon, M.A.; Ed. D. (Calif) *Tuesdays, 6.00-7.00 p.m., starting February 17, 1970.* 12 meetings. **165**  
*Fee: \$40*

## 社 會 心 理 學

主 講 人：譚維漢博士

講授語言：粵語

時 間：一九七〇年二月十七日起每星期二下午六時至七時

學 費：四十元

- 
- 166** **CHILD GUIDANCE: CONVERSATION WITH MOTHERS** Dr. D.Y.F. Ho, B.Sc. (Arcadia); M.A. (Roosevelt); Ph. D. (I.I.T.), Lecturer, Dept. of Psychology, University of Hong Kong. *Mondays, 5.45-6.45 p.m., starting October 6, 1969. Extra-Mural Town Centre. 10 meetings. Fee: \$35*

### 與家長兒童指導

本課程以小組討論形式切實研究並指導個別問題，對家長提供有關教養子女之心理學知識，無論其子女為健康或具有心理困擾者，此等家長均將從本課程獲到助益。為方便討論，限收二十名，額滿即止。共十講。

主 講 人：港大心理學系講師何友暉博士

講授語言：粵語

地 點：香港大學校外課程部市區中心

時 間：一九六九年十月六日起每星期一下午五時四十五分至六時四十五分

學 費：三十五元

- 
- 167** **COUNSELLING AND PSYCHOTHERAPY** Dr. D.Y.F. Ho, B.Sc. (Arcadia); M.A. (Roosevelt); Ph. D. (I.I.T.), Lecturer, Dept. of Psychology, H.K.U. *Mondays, 5.45-6.45 p.m., starting February 16, 1970. 10 meetings. Fee: \$35*

### 輔導與心理治療

主 講 人：港大心理學系講師何友暉博士

講授語言：粵語

時 間：一九七〇年二月十六日起每星期一下午五時四十五分至六時四十五分

學 費：三十五元

Staff Tutor in Charge: Priscilla Tso. B.A., Dip. Ed., (H.K.), Dip. Ad. Ed. (Manch.)  
Telephone No. 458161 Ext. 308

## Astronomy and Physics

**INTRODUCTION TO OBSERVATIONAL ASTRONOMY** Mr. Liu Hing Chai, B.A. (HK). *Fridays, 8.15-9.45 p.m., starting 26th September, 1969.* Extra-Mural Town Centre. 14 meetings. **168**  
Fee: \$65

### 天文觀測方法入門

本課程共分十四講，目的在介紹普通天文觀測方法，觀測範圍包括：

- 星座之認識
- 星圖之使用
- 太陽、月球，行星表面之觀測
- 流星，彗星之觀測
- 雙星，變星之觀測
- 星團，星雲之觀測

除上述十四講外，另有戶外觀測若干次，利用望遠鏡進行，觀察星空中一般現象，但觀測次數及日期時間，將視天氣情況而定。

主講人：廖慶齊先生

講授語言：粵語

地點：香港大學校外課程部市區中心

時間：一九六九年九月廿六日起每星期五下午八時十五分至九時四十五分

學費：六十五元

---

**ASTRONOMY IN THE UNITED STATES TODAY** Mr. Liu Hing Chai, B.A. (HK). *Fridays, 7.00-8.00 p.m., starting October 3, 1969.* Extra-Mural Town Centre. 12 meetings. **169.**  
Fee: \$35

### 美國天文教育與研究近況

本課程共十二講，每週一次，內容報導美國近期在天文研究及天文教育兩方面之情況，並兼述美國天文愛好者之組織及活動，每講用幻燈片輔助解釋。

主講人：廖慶齊先生

講授語言：粵語

地點：香港大學校外課程部市區中心

時間：一九六九年十月三日起每星期五下午七時至八時

學費：三十五元

- 
- 170 MODERN DEVELOPMENTS IN PHYSICS** Dr. D.G. Rivers, M.Sc. (Lond.), Ph. D. (Durham), A. Inst. P., Lecturer, Dept. of Physics, H.K.U. & Dr. E.C.M. Young, B.Sc. (H.K.), Ph. D. (Bristol), Lecturer, Dept. of Physics, H.K.U. *Fridays, 6.00-7.30 p.m., starting Sept. 26, 1969.* Chemistry Lecture Room, Chemistry Building, 1st floor, H.K.U. 10 meetings. *Fee: \$50*

A course for Advanced Level Physics teachers' and interested laymen. It is designed to introduce modern trends and developments in Physics in the 20th century. Emphasis will be placed on the understanding of physical concepts rather than on rigorous mathematical treatment.

Topics covered will include:- the rise of modern physics; nuclear fission and nuclear reactors; thermonuclear energy; particle accelerators; elementary particles; cosmic radiation; the unity of the universe; the solar system; the formation of galaxies; the expanding universe.

Advanced level physics teachers who wish to have their fees refunded by the Director of Education are required to complete an application form (obtainable from the Department of Extra-Mural Studies, H.K.U.) which must be returned *directly* to the Director of Education before the commencement of the course. This applies to *all* teachers whether in Government or private schools.

## Botany and Biology

- 171 THE ORIGIN OF LIFE: FROM MOLECULES TO MAN** Dr. M. McCabe, B.Sc., Ph. D. (Lond.) Lecturer, Dept. of Biochemistry, H.K.U. *Tuesdays, 6.00-7.30 p.m., starting September 23, 1969.* Extra-Mural Town Centre. 10 meetings. *Fee: \$50*

A course for teachers and interested laymen.

The last few years have seen spectacular advances in the biological sciences, which have thrown new light on an old problem, namely how did life originate, and how has man come to evolve.

The significance of the continuing process of evolution is stressed, as our technology rapidly produces new evolutionary pressures, both on man and other organisms in the world.

- 
- 172 HOW YOUR BODY WORKS** Dr. Chi-Chin Liang. *Tuesdays, 5.30-7.00 p.m., starting September 23, 1969.* Extra-Mural Town Centre. 18 meetings. *Fee: \$80*

### 人體的功能

本課程以最簡明的方法，深入淺出，解釋人體的生理機能，體內各器官的相關作用及如何保持身心健康等。共十八講，每講輔以實物示範及圖片說明。

主 講 人：梁其瑾博士

講授語言：粵語

地 點：香港大學校外課程部市區中心

時 間：一九六九年九月廿三日起每星期二下午五時卅分至七時。

學 費：八十元

## University Certificated Courses in Engineering

* AIR-CONDITIONING ENGINEERING	(12)
INDUSTRIAL ENGINEERING	(15)
REFRIGERATION ENGINEERING	(13)
MECHANICAL DESIGN	(14)
APPLIED TRANSISTOR ELECTRONICS	(16)
FUNDAMENTALS OF DIGITAL COMPUTERS	(17)

The above courses lead to the award of University Certificates. For details, apply for separate booklet.

\* *started in July 1969.*

---

# Urban & Regional Planning

*Staff Tutor:* Jon A. Prescott, B. Arch. (Liv.); M.C.D.; A.R.I.B.A.; A.M.T.P.I.  
*Telephone No.* 458161 Ext. 308 or 226613

Arrangements exist at the moment for those who wish to sit, in Hong Kong, for the examinations of the Town Planning Institute (London). Enquiry should be made to the Secretary of the Institute in London at least twelve months prior to the examination. (Full details are available from the Hon. Secretary of the Hong Kong Branch of the Town Planning Institute, P.O. Box 15299, Hong Kong.) *The present examination arrangements stand until 1970. only.*

## Traffic Engineering

**173** **TRAFFIC ENGINEERING** *Thursdays, 7.00-9.00 p.m., starting 25th September, 1969.* Extra Mural Town Centre. 40 meetings. *Fee: \$200*

Director of Studies: Mr. K.F. Nip, M.A., M.Sc., A.M.I.C.E., A.M. Inst. H.E.  
Tutors: Mr. W.C. Bell, D.I.C., A.M.I.C.E., Assistant Government Civil Engineer  
(Traffic and Transport) Public Works Department.  
Dr. J.J. Raftery, M.E., N.U.I., Ph. D. (Leeds) M.I.C.E.  
Mr. C.R. Saunders, B.Sc., D.I.C., M.I.C.E.  
Mr. K.E. Softly, M.I.C.E., A.M.I., Mun. E.

The Traffic Engineering Course is designed to give the fundamentals of traffic engineering and instruction ranges from consideration of vehicle operating characteristics, geometric design of roadways and intersection design (Hong Kong practice), traffic signals, control devices and aids, grade separation, parking and the problems of long range urban traffic planning and the use of the Computer. The course is planned particularly for officers of the Public Works Department, Police and other government employees, but is open to others interested.



---

**PUBLIC AWARENESS AND PARTICIPATION IN THE PLANNING PROCESS**

174

Mr. T.P. Byrnes, A.A.I.A., M.C.P., Lecturer in Planning, University of Hong Kong  
*Tuesdays 6.00-8.00 p.m., starting 23rd September, 1969.* Extra Mural Town Centre.  
10 meetings once weekly. *Fee: \$55*

Decisions made in the field of Urban or Rural planning, which are of fundamental importance in the creation of the environment in which we live, are frequently incomprehensible to the average citizen even should he be fully aware of them before their effect is manifested in physical reality.

This situation for example in the United States has resulted in the appearance of a form of intermediary, a professional 'advocate planner' whose prime purpose is to advise and explain from a non official, but informed, level the significance of planning proposals at their formative stages. The importance of the awareness of what is planned by the general public as well as the property owner and developer, and even his participation in the decision making processes of Planning will be discussed, in the course of this series of talks.

The structure of Hong Kong's planning machinery will be examined, and conclusions drawn on the effectiveness of the relationships existing at present.

---

**PLANNING STUDIO** Jon A. Prescott, B. Arch., M.C.D., A.R.I.B.A., A.M.T.P.I. and a Panel of Town Planning Institute Members. *Tuesdays 8.00-10.00 p.m., starting 30th September, 1969.* Extra Mural Town Centre.

175

Arrangements will be made in the light of particular student requirements to assist with Town Planning Institute Submissions. Please contact organiser as early as possible so that the work can be scheduled.

---

*See also*

**TECHNIQUES OF URBAN ANALYSIS**

(107) Page 49

**BACKGROUND TO JAPAN**

(178) Page 10

A study in connection with man made environment  
Arts & Architecture

---

# PROFESSIONAL and VOCATIONAL COURSES

## ART & DESIGN CERTIFICATE COURSES

### CHARTERED INSTITUTE OF SECRETARIES INTERMEDIATE EXAMINATION

Economics for Intermediate Examinations  
General Principles of English Law  
Accountancy for Intermediate Examinations  
English for Higher Commercial Studies

### CHARTERED INSTITUTE OF SECRETARIES FINAL EXAMINATION

Company Secretaryship  
Accountancy for Final Examinations  
Company Law and Partnership  
English Mercantile Law

### CORPORATION OF SECRETARIES INTERMEDIATE EXAMINATION

Accountancy for Intermediate Examinations  
Economics for Intermediate Examinations  
English for Higher Commercial Studies  
General Principles of English Law

### CORPORATION OF SECRETARIES FINAL EXAMINATION

#### *Part I*

Economics for Intermediate Examinations  
Company Secretaryship

#### *Part II*

Accountancy for Intermediate Examinations  
Company Law and Partnership

### INSTITUTE OF BANKERS

#### *Part I*

English for Higher Commercial Studies  
Economics for Intermediate Examinations  
General Accounting  
General Principles of English Law

#### *Part II*

Accountancy for Intermediate Examinations  
Practical Banking

AUSTRALIAN SOCIETY OF ACCOUNTANTS

*Part I*

Accountancy for Intermediate Examinations  
Auditing

*Part II*

Company Law and Partnership

*Part III*

Accountancy for Final Examinations  
Auditing

ASSOCIATION OF CERTIFIED AND  
CORPORATE ACCOUNTANTS  
INTERMEDIATE EXAMINATION

*Part I*

Accountancy for Intermediate Examinations  
Economics for Accounting Students  
Cost Accounting

*Part II*

Accountancy for Intermediate Examinations  
Auditing

ASSOCIATION OF CERTIFIED AND  
CORPORATE ACCOUNTANTS  
FINAL EXAMINATION

*Part I*

Accountancy for Final Examinations  
Company Law and Partnership  
Cost Accounting

*Part II*

Accountancy for Final Examinations  
Managerial Accounting  
Auditing  
English Mercantile Law

ASSOCIATION OF INTERNATIONAL  
ACCOUNTANTS  
INTERMEDIATE EXAMINATION

*Part I*

Accountancy for Intermediate Examinations  
Auditing

*Part II*

Company Law and Partnership  
Economics for Intermediate Examinations

ASSOCIATION OF INTERNATIONAL  
ACCOUNTANTS  
FINAL EXAMINATION

*Part I*

Accountancy for Final Examinations  
Auditing

*Part II*

Company Law and Partnership  
Cost Accounting

# SPECIAL TRAINING COURSES

---

The department welcomes enquiries and requests from business organizations, government, voluntary bodies or private institutions for specially designed training courses, whether pre-service, in-service or up-grading, to meet their specific training needs

# INDEX TO COURSES

Page	Course
39	81 ACCOUNTING, General
39	82 ACCOUNTANCY, for Intermediate Examinations
39	83 ACCOUNTANCY, for Final Examinations
26	53 ADVERTISING, Professional Practice in
65	164 ADVERTISING, Psychology of
25	50 ADVERTISING, Studio II
26	51 ADVERTISING, Studio III
19	28 AESTHETICS, Introduction to ideas on
18	27 ANATOMY for Art Students
19	29 ART I, History of, Introductory Course
22	39 ART II, History of
22	40 ART III, History of
7	176 ARCHAEOLOGY, A Practical Introduction to
67	168 ASTRONOMY, Introduction To Observational
67	169 ASTRONOMY, In The United States Today
40	85 AUDITING
37	77 BANKING, Practical
68	172 BODY, How Your works
33	67 BOOK OF CHANGES, The
7	177 BRONZE AGE CHINA, The Art of
42	91 BUSINESS, How To Manage A New
63	157 CALCULUS, Introduction to
29	57 CALLIGRAPHY, Theory And Practice Of Chinese
29	58 CALLIGRAPHY, Theory And Practice Of Chinese
54	119 CANTONESE I
54	121 CANTONESE I
55	128 CANTONESE I
55	129 CANTONESE I
54	120 CANTONESE II
55	124 CANTONESE II
55	125 CANTONESE II
55	130 CANTONESE II
55	131 CANTONESE II
55	126 CANTONESE III

# INDEX TO COURSES

Page	Course	
66	166	CHILD GUIDANCE: Conversation With Mothers
32	66	CHINA In The Last Century
52	113	CHINA'S Relations With The West
55	127	CHINESE CHARACTERS (in Cantonese)
31	63	CHINESE CLASSICS, Theory And Practice In Translation Of
33	68	CHINESE CUSTOMS AND TRADITIONS, Understanding
52	114	CHINESE PROTESTANT CHURCH In Hong Kong, Development of the
30	60	CHUAN-TSU
17	21	COLOUR, Relationship of
69	17	DIGITAL Computers Certificated Course on fundamentals of
66	167	COUNSELLING AND PSYCHOTHERAPY
40	84	COST ACCOUNTING
18	26	DESIGN, Introduction To Three Dimensional
69	14	DESIGN MECHANICAL, Certificated Course in
20	33	DESIGN, Three Dimensional
17	22	DRAUGHTSMANSHIP I, Techniques of
17	23	DRAWING, Basic Vision & Techniques of
20	34	DRAWING & PAINTING, A Beginner's Course In
21	35	DRAWING & PAINTING, A Beginner's Course In
53	116	EAST ASIAN HISTORY, The Influence of Sea Power on Modern
35	71	ECONOMICS for Accounting Students
34	70	ECONOMICS for Intermediate Examinations
43	94	EDUCATION & PSYCHOLOGY, Research Methods In
47	104	ENGLISH for Higher Commercial Studies
46	101	ENGLISH, Intonation & Idiomatic
47	103	ENGLISH, Teaching Techniques
44	96	ENGLISH I, Use of
45	98	ENGLISH II, Use of

# INDEX TO COURSES

Page	Course
45	97 ENGLISH I, Use of – Kowloon
46	99 ENGLISH II, Use of – Kowloon
69	15 ENGINEERING INDUSTRIAL Certificated Course in
69	13 ENGINEERING REFRIGERATION Certificated Course in
69	12 ENGINEERING AIR-CONDITIONING Certificate Course in
37	78 EXPORT DOCUMENTATION AND PROCEDURES
21	37 FINE ART STUDIO
17	20 FORMAL RELATIONSHIPS AND TEXTURES
57	135 FRENCH I
58	140 FRENCH II
58	145 FRENCH III
50	108 GEOGRAPHY Of United States And Canada
50	112 GEOGRAPHY In The Field (Human)
50	109 GEOGRAPHY In The Field (Physical)
50	111 GEOGRAPHY In The Field (Physical)
50	110 GEOGRAPHY Quantitative Techniques In Human
57	136 GERMAN I
58	141 GERMAN II
32	65 HISTORY Main Points In Chinese
37	79 HOSPITAL ADMINISTRATION An Introduction To
38	80 HOSPITAL ADMINISTRATION Practical Aspects Of
42	92 INDUSTRIAL RELATIONS WORKSHOP
42	90 INDUSTRY Health And Safety In
24	44 INTERIOR STUDIO II
24	45 INTERIOR STUDIO III
24	48 INTERIOR WORK Professional Practice In
36	76 INVESTMENT
57	137 ITALIAN I
58	142 ITALIAN II
10	178 JAPAN, The New
56	132 JAPANESE IA
56	133 JAPANESE IB
56	134 JAPANESE II
11	19 JAPANESE TRADITIONAL DESIGN, The Bases Of



# Extra Mural Studies 校外課程 Application for Enrolment 報名申請書

每一種課程請用別紙填寫

PLEASE USE A SEPARATE FORM FOR EACH COURSE

**A**

課程號碼  
課程名稱  
姓名  
前已讀其他校外課程名稱

COURSE NO. FEE ENCLOSED \$  
COURSE NAME 附學費  
NAME in full (Mr./Mrs./Miss) CASH/CHEQUE NO.

English in block letters – surname first  
Chinese Chinese  
Chinese 中文

What Extra Mural Courses have you previously attended?

NAME IN FULL (Mr./Mrs./Miss) English in block letters – surname first  
英文 Chinese  
Chinese 中文

通訊處  
ADDRESS for correspondence

辦事處地址  
OFFICE ADDRESS

電話  
TELEPHONE NOS. Home 住宅 Office 辦事處

國籍  
NATIONALITY Age 年齡 (please tick age group)

職業  
OCCUPATION 18-19  
20-29  
30-39  
40-49  
50-59  
over 60

學歷  
SCHOOL and highest class reached

大專學歷  
HIGHER and/or FURTHER EDUCATION

DATE 日期

SIGNATURE 簽字

X

DATE REG. NO. COURSE NO. AMOUNT

X

DATE REG. NO. COURSE NO. AMOUNT

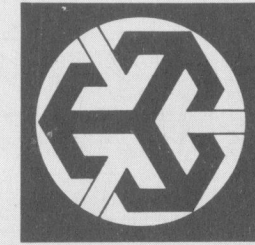

If you are applying by post and require an acknowledgment of your application, please complete this part

Note: This application acknowledgment is not complete without validation by official printing machine entry of the details at X above at the University or Town Centre office of the Department of Extra-Mural Studies, University of Hong Kong.

NAME  
FULL POSTAL  
ADDRESS

Fees are not refundable once the course has commenced. Please see overleaf.



**預早報名之重要**

為早修讀本品課程者應儘早報名，如不預早報名則引致各該課程短期開課或取消。預先報名乃是指本品得知各界對種種課程及課程之興趣，故報名表格應存中寄回本部。

香港大學校外課程部

UNIVERSITY OF HONG KONG

DEPARTMENT OF EXTRA-MURAL STUDIES

A 與 B 聯填完後附學費  
支票，香港大學校外課程  
部。

THE WHOLE OF THIS FORM TOGETHER WITH THE APPROPRIATE FEE SHOULD BE  
SENT TO THE DIRECTOR OF EXTRA MURAL STUDIES  
THE UNIVERSITY OF HONG KONG

繳費可用支票或現金，如  
用支票請抬頭「香港大學  
」并加橫線「寄本部」。

PAYMENT MAY BE MADE IN CASH OR BY CHEQUE AT THE UNIVERSITY OR BY POST  
CHECKS SHOULD BE CROSSED AND MADE PAYABLE TO "UNIVERSITY OF HONG KONG"

除非課程臨時取消或改期，請依照公  
佈日期上課，本部不另通知。如報名  
申請未被接受，學費將退還，但課程  
開始後，學費通常不能退還。

THE ISSUE OF AN ENROLMENT APPLICATION ACKNOWLEDGMENT DOES NOT OF ITSELF  
CONSTITUTE ACCEPTANCE OF THE APPLICATION, BUT IF YOU DO NOT HEAR OTHERWISE  
BEFORE A COURSE STARTS, YOU MAY ASSUME YOU HAVE BEEN ACCEPTED. IF FOR  
ANY REASON YOU ARE NOT ACCEPTED YOUR FEE WILL BE RETURNED, BUT OTHERWISE  
FEES ARE NOT NORMALLY REFUNDABLE

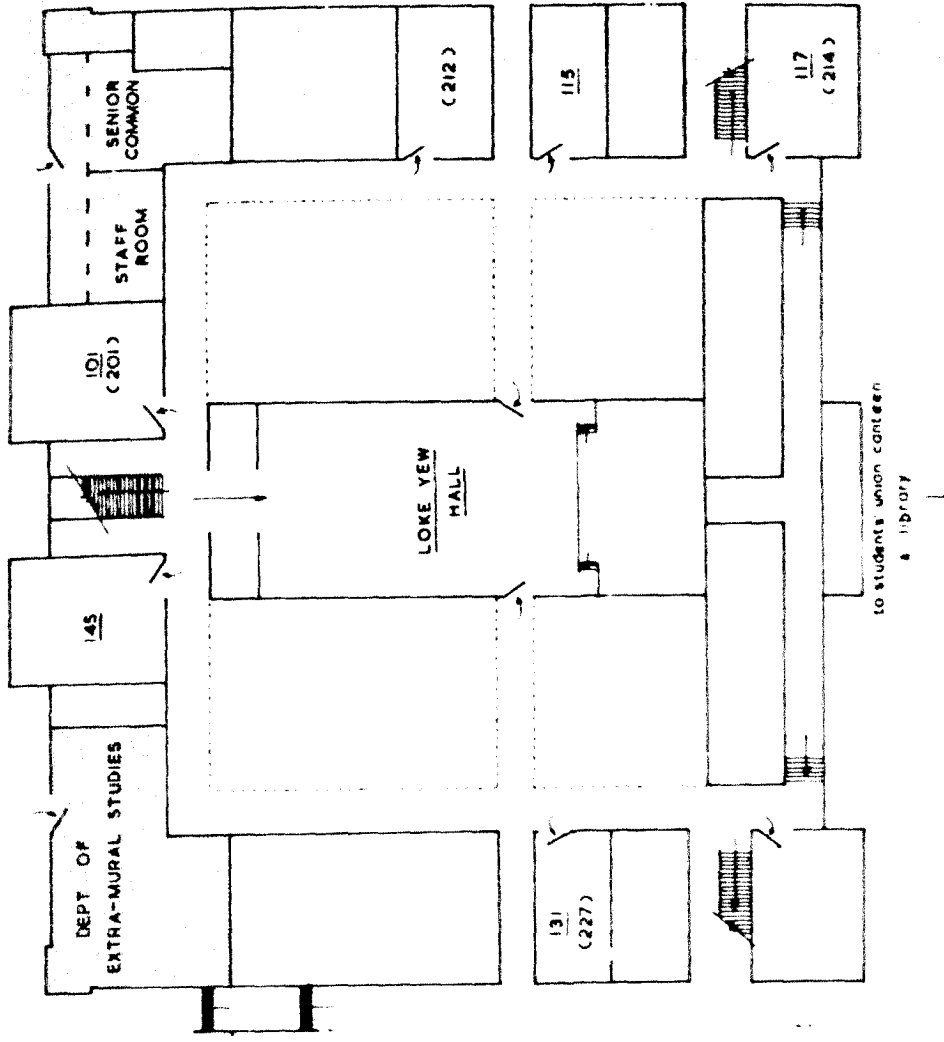

**GROUND PLAN OF UNIVERSITY OF HONG KONG MAIN BUILDING**  
 Showing room locations used for Extra Mural Studies courses. Please  
 see inside of front cover for University general layout.

Extra Mural Studies  
University of Hong Kong



香港大學校外課程手冊  
一九六九至一九七零

Prospectus 1969-1970