

香港大學校外課程手冊

一九七〇至一九七一

SPRING SUPPLEMENT

PROSPECTUS 1970-71



2 DEC 1994

Extra Mural Studies

University of Hong Kong

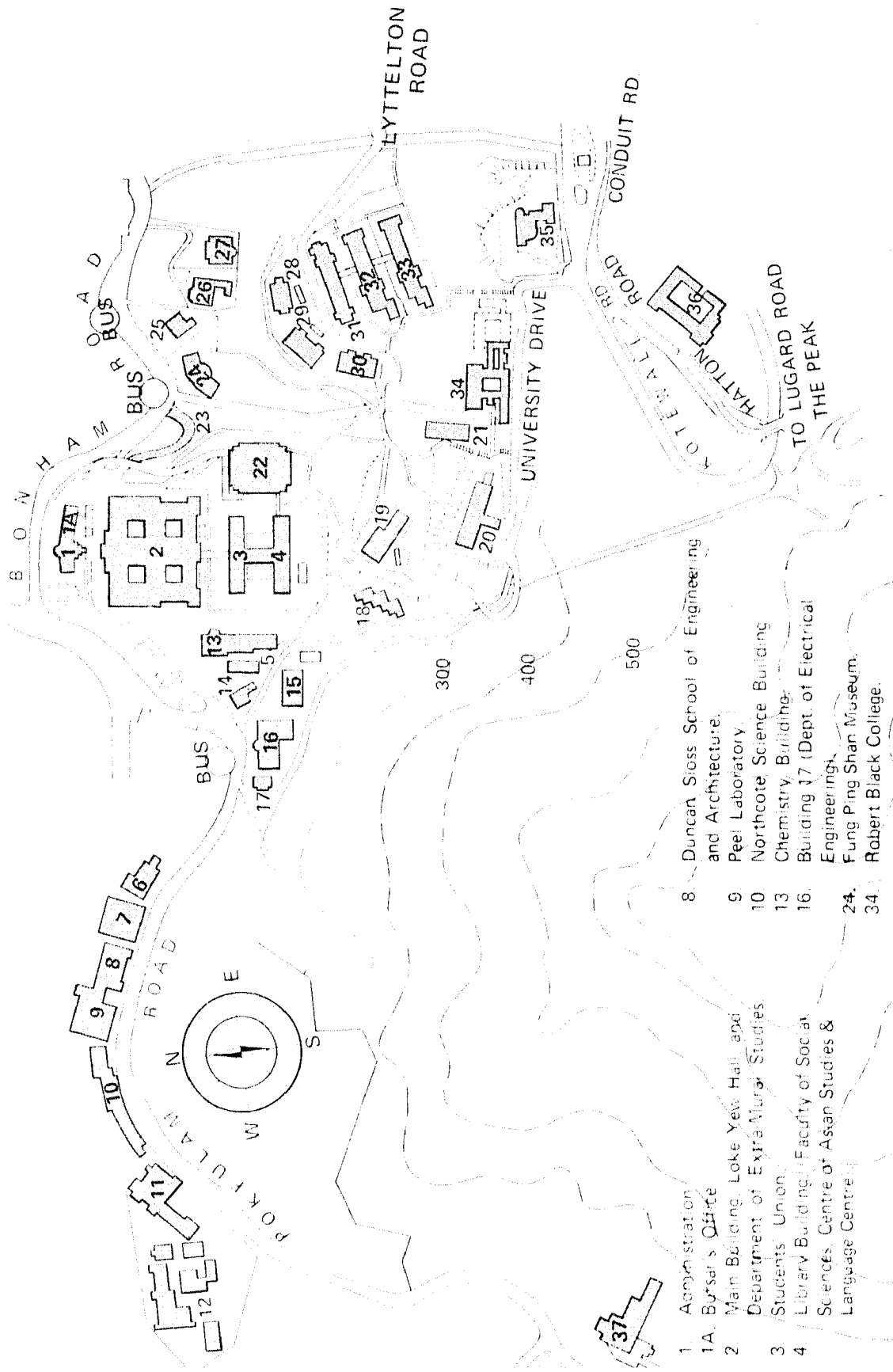

- 1. Administration
- 1A. Bursar's Office
- 2. Main Building, Loke Yew Hall, and Department of Extra-Mural Studies
- 3. Students' Union
- 4. Library Building, Faculty of Social Sciences, Centre of Asian Studies & Language Centre
- 5. Peet Laboratory
- 6. Northcote Science Building
- 7. Chemistry Building
- 8. Duncan Sloss School of Engineering and Architecture
- 9. Peet Laboratory
- 10. Northcote Science Building
- 13. Chemistry Building
- 16. Building 17 (Dept. of Electrical Engineering)
- 24. Fung Ping Shan Museum
- 34. Robert Black College

UNIVERSITY OF HONG KONG GENERAL LAYOUT

Please see inside of rear cover for enlarged plan of Main Building (2) and location of rooms

University of Hong Kong



Extra Mural Studies



STAFF

Director

R.A. Williams, M.A. (Wales)

Deputy Director

J.W. England, B.A. (Nottingham)

Senior Staff Tutor

K.N. Vaid, B.Sc. (Punjab)

M.A. (Delhi)

Dip.S.W.P. (The Hague)

Assistant to the Director

Mrs. Priscilla Tso, B.A., Dip.Ed. (H.K.)

Dip.Ad.Ed. (Manc.)

Staff Tutors

Mrs. Nana Tsao, B.A., Dip.Ed. (H.K.)

C.K. Leung, M.A. (H.K.) (on leave)

Jon A. Prescott, B.Arch., M.C.D. (Liv.),

A.R.I.B.A., A.M.T.P.I.

D.J.H. Macintosh, M.A. (Cantab.),

P.G.C.E. (Lond.)

T.W. Casey, B.A. (Nottingham)

Keith Sayer, B.Sc. (Manchester)

Secretary

Mrs. Yvonne Wong

We would like to record our grateful acknowledgement to the following individuals, schools and organizations for permission to use their premises:-

*The Management of City Hall
The Government Printer
Government Training Division
Hong Kong Baptist College
King's College
University Hall
Wah Yan College*

ACKNOWLEDGEMENTS

PRIOR ENROLMENT IS ESSENTIAL

Failure to enrol prior to the opening of a particular course, may mean the cancellation of that course. Prior enrolment is the only way the Department of Extra-Mural Studies has of judging the response to its courses. Your cooperation is therefore invited in sending your application forms to the Department as soon as possible.

GENERAL INFORMATION

1. There are normally no entry requirements except that applicants should be over 18 years of age. Occasionally to have the full benefit of a course applicants must possess certain defined qualifications. Applicants are therefore advised to read the description of a course carefully. Professional courses usually have clearly defined entry requirements.
2. The Director may at his discretion refuse to admit an applicant.
3. Unless otherwise arranged no Extra-Mural lectures will be held:-
 - a) on any public holidays.
 - b) at a storm warning signal of No. 5 or above.
 - c) during the following holiday period:-
January 25 -31, 1971 inclusive (Lunar New Year)
4. The course fee will cover the entire duration of a course or part of a course. Fees are not refundable once the course has commenced.
5. Certificates of Attendance are issued, on payment of 50 cents, to those who have attended not less than two-thirds of a course of at least 20 meetings in duration.
6. Closing date for enrolment: one week before the starting date of a course. Late enrolments may not be accepted.
7. For enquiries, please ring either H-468161 Ext. 309 or H-456451 during office hours.

HOW TO ENROL

1. Complete the attached enrolment form and mail it to the Director, Department of Extra-Mural Studies, University of Hong Kong. Forms are also available on request. To ensure that a class can take place, the Department would appreciate early enrolment by applicants.
2. You should send your application form together with the appropriate fee either in the form of a postal order, money order or crossed cheque made out in favour of the UNIVERSITY OF HONG KONG.
3. You will be notified if you are not admitted because of over-subscription or other reasons. The Department will NOT notify successful applicants who are expected to attend the first meeting of the class at the place and time advertised.
4. Applicants can also enrol in person at the following places:-
 - i) Department of Extra-Mural Studies, University of Hong Kong, University Main Building, Ground Floor, Pokfulam Road, Hong Kong. (during office hours) (Buses Nos. 3, 4, 7, 23). Tel: H-468161 Ext. 309.
 - ii) Extra-Mural Town Centre, Universal House, 11th Floor, 151 Des Voeux Road Central, Hong Kong. Tel: H-456451 (entrance from Gilman Street). (From 10 a.m. to 8 p.m.)

入學須知

1. 學員申請資格，除特別規定學歷之課程外，其他課程，祇需要年齡超過十八歲者，不限資格，均可申請入學。學員應詳閱課程簡介。
2. 學員被取錄與否概由校外課程部主任審核報名申請書後決定之。
3. 除特殊情形外，本部在下列期間不授課：
甲：本港公眾假期。
乙：本港天文臺懸掛五號或以上風球之後。
丙：農曆新年假期：一九七一年一月廿五日至卅一日。
4. 本手冊內之學費係指課程之全期學費。課程開始後，學費通常不能退回。
5. 授課時間通常每講一小時。
6. 凡課程在廿講以上而學員上課次數超過三分之二者，得向本部繳費五角後申請發給聽講證書。
7. 學員應於開課一星期前報名，過期報名可能不被接受。又任何課程額滿後，即隨時截止報名，故學員應儘早報名。
8. 本部詢問電話：H-468161 (內線309) 或H-456451。

報名手續

1. 填妥附於本手冊之報名申請書後，逕寄香港大學校外課程部主任收。申請書可隨時向本部索取。
2. 繳費可用支票，銀行本票，或郵政滙票，以「香港大學」名義抬頭，並加橫線，連同申請書逕寄港大校外課程部主任收。如用現金則請至本部繳納。
3. 如申請人已獲取錄，本部不再通知，可依時上課。如未獲取錄，則另函通知。
4. 申請人亦可親往下列地點報名：
甲、薄扶林道香港大學校外課程部（辦公時間內）。
電話：H-468161 (內線309)
乙、香港德輔道中一百五十一號環球大廈十二樓（入口在機利文街）校外課程部市區中心。電話：H-456451（上午十時至下午八時）。

SPECIAL TRAINING COURSES

The department welcomes enquiries and requests from business organizations, government, voluntary bodies or private institutions for specially designed training courses, whether pre-service, in-service or up-grading, to meet their specific training needs.

Contents



	Page
ART & ARCHITECTURE	9
ECONOMICS, COMMERCE, MANAGEMENT	12
EDUCATION	17
ENGINEERING	19
ENGLISH STUDIES	20
Courses in the Use of English (First Year)	
English Speech	
Courses in Spoken English	
English for Teachers	
Courses in Critical Appreciation	
GEOGRAPHY	26
HISTORY	27
LANGUAGES	28
European	
LAW	29
MATHEMATICS	30
MUSIC	32
ORIENTAL LANGUAGES & STUDIES	33
PHILOSOPHY, PSYCHOLOGY	35
POLITICAL SCIENCE	37
SCIENCE	38
PUBLIC LECTURE	40
INDEX TO COURSES	41

PRIOR ENROLMENT IS ESSENTIAL

Failure to enrol prior to the opening of a particular course, may, mean the cancellation of that course. Prior enrolment is the only way the Department of Extra-Mural Studies has of judging the response to its courses. Your co-operation is therefore invited in sending your application forms to the Department as soon as possible.

Art and Architecture

Staff Tutor in Charge: Jon A. Prescott, B.Arch., M.C.D., (Liv.); A.R.I.B.A.; A.M.T.P.I.
Telephone No. H-456430

WHAT IS DESIGN? Jon A. Prescott, B.Arch., M.C.D., A.R.I.B.A., A.M.T.P.I. **17**
Mondays, 5.30 - 7.00 p.m., starting February 15, 1971. Extra-Mural Town Centre.
5 meetings followed by discussion. Fee: \$35

As soon as two people start to talk about design, misunderstandings arise. Some of these misunderstandings are caused by an overlapping vocabulary, but many are due to fundamental differences in values and in thinking. These meetings and discussions aim to explain what Design is about.

CIVILIZATION – SIR KENNETH CLARKE Discussion Panel drawn from Jon A. Prescott (Chairman), Henry Steiner, Tao Ho, Michael Griffith, Thomas Almberg, Cesar A. Guillen-Nunez and others. **19**
Thursdays, 5.45 – 7.45 p.m., starting February 4, 1971. Extra-Mural Town Centre. 13 meetings. Fee: \$50

A series of 13 colour films written and narrated by Lord (Kenneth) Clarke and produced by BBC Television have been made available in Hong Kong by Hutchinson International Ltd. One of these films will be shown weekly in the first hour of this programme and the second hour will be devoted to the contributions and thoughts of a panel of experts in the field of the Visual Arts.

This series of films was hailed by critics in Britain in the most glowing terms.

Enrolment is limited to 40 persons.

THE BRONZES OF SHANG & CHOU CHINA James C.Y. Watt, M.A.(Oxon), Assistant Curator, City Art Gallery & Museum. **20**
Mondays, 7.45 – 8.45 & 9.00 – 10.00 p.m., starting February 8, 1971. Extra-Mural Town Centre. 4 meetings. Fee: \$40

The Bronze Art of Shang & Chou China represents a peak of achievement rarely surpassed. This illustrated course will relate the visual and formal achievement to the historical background and social organisation.

236 CREATIVE PAINTING Tse Kung Wah, C.A. (Education Dept., Victoria). *Tuesdays, 9.30-11.30 a.m., starting February 9, 1971. Extra-Mural Town Centre. 12 meetings.*
Fee: \$70

A course designed to initiate the student in the use of different media and experimental technique. The media will consist of oils, oil-pastels, acrylic, and other mixed-media including commercial media.

A basic introductory course for beginners, though also of interest to those with some experience of painting.

Enrolment is limited to 20 persons.

237 BEGINNERS BASIC ART Miss Martha Lesser, B.S. (N.Y.U.). *Wednesdays, 10.30 a.m.-12.30 p.m., starting February 10, 1971. Extra-Mural Town Centre. 12 meetings.*
Fee: \$80

Drawing and painting for beginners. The tutor will discuss line, form and colour and the use of various basic techniques and media, such as collage, water colour, pastels, acrylic, as a means of introduction to practical work.

Work will be carried out in the Studio and also on field trips.

The fee does not include transportation costs or materials which will be made available at the class for purchase.

Enrolment is limited to 15 persons.

238 LIFE DRAWING Wong Tak Tsun. *Fridays, 6.00-8.00 p.m., starting February 12, 1971. Extra-Mural Town Centre. 12 meetings.*
Fee: \$70

The basic concepts of life drawing will be considered and different models will be used to help the student understand the nature of anatomy in its painting and social context. An additional charge for the model of \$25 will be levied, payable at the Town Centre.

Enrolment is limited to 20 persons.

249 HISTORY OF ART: THREE ARTISTS Cesar A. Guillen-Nunez, B.A. (Hons) Courtauld Institute of Art, London University. *Fridays, 5.45-6.45 p.m., starting February 5, 1971. Extra-Mural Town Centre. 12 meetings.*
Fee: \$70

An art historical account of the life and works of Michelangelo, Rembrandt and Delacroix. This course should be of interest to all lovers of the great masters.

Enrolment is limited to 20 persons.

TECHNICAL DOCUMENTATION FOR THE BUILDING INDUSTRY IN HONG KONG Michael Munday, A.R.I.B.A., Dip.Arch. (Leics). *April 28, 1971. Extra-Mural Town Centre. One day symposium.*

24

The symposium aims to bring together local and overseas experts in the field both to review developments in other parts of the world, and to discuss their relevance to the current and future working of the Building Industry professions in Hong Kong.

Participation will be by invitation, & details will be published in due course.

THE SHAPE OF TOWNS Jon A. Prescott, B.Arch., M.C.D., A.R.I.B.A., A.M.T.P.I. *Mondays, 5.30-7.00 p.m., starting March 29, 1971. Extra-Mural Town Centre. 5 meetings followed by discussion .* *Fee: \$35*

152

The physical shape of Towns is the result of a whole range of different influences. Perhaps most important is however the society which generates the town, its attitudes and beliefs. After a brief categorisation of some different formal characteristics of traditional towns these lectures will use local examples to illustrate the continuum of development found in our contemporary settlements, the history, present and future development of Hong Kong will be used to illustrate both particular and general ideas, and the significance of Hong Kong's achievements related to some of the ideas of the rest of the world.

Staff Tutor in Charge: Mrs. Priscilla Tso, B.A., Dip. Ed. (H.K.), Dip. Ad. Ed. (Manc.). Telephone No.: H-468161 Ext. 303

HINDU ART OF INDIA: AN INTRODUCTION Mrs. Vidya Dehejia, M.A., Ph.D. (Cantab.). *Tuesdays, 6.00-7.30 p.m., starting February 16, 1971. Extra-Mural Town Centre. 10 meetings.* *Fee: \$45*

228

This illustrated course will provide an introduction to the Hindu art of India. The course will examine briefly the religion and mythology of Hinduism as a background to the art. It will also discuss the origin of the Hindu temple and trace its evolution; deal with Hindu rock-cut cave temples including Elephanta and Ellora, examine the erotic temple sculpture of north India and follow the development of the temple in south India and its culmination in the form of a temple-town.

Economics Commerce Management

Staff Tutor in Charge: T.W. Casey, B.A. (Nottm.)
Telephone No.: H-468161 Ext. 305

239 PUBLIC RELATIONS N.G.R. Chesnay. *Thursdays, 5.45-6.45 p.m., starting February 25, 1971. Extra-Mural Town Centre. 10 meetings.* Fee: \$40

The necessity for good Public Relations is becoming increasingly evident in Hong Kong and is vital to the well-being of the community. Its role as an aid to modern marketing, as a means of conveying ideas and policies, and in assisting companies and institutions in developing sound reputations and relationships will be discussed. There will be some examination of the theory and techniques of public relations and the qualifications that help to make a successful public relations officer or consultant. No previous knowledge of the subject is assumed. The course will also include practical exercises.

31 STATISTICAL METHODS II Lau Nai-Keung, B.Soc.Sc. (H.K.), Demonstrator in Statistics, University of Hong Kong. *Fridays, 7.00-8.30 p.m., starting February 26, 1971. University Main Building. 15 meetings.* Fee: \$80

A course designed for those who have taken Statistical Methods I or its equivalent. Suitable for those taking Elements of Statistical Methods (two papers) in Part Two examination of the Institute of Statisticians and for those who wish to acquire basic statistics useful in business, industrial and social research. Topics to be covered are: Introductory Probability. Estimation. Test of Hypothesis. Chi-square Test and t-test. Analysis of Variance. Experimental Design. Non-parametric Methods.

Textbook: W.J. Dixon & F.J. Massey, Jr.,
Introduction to Statistical Analysis, (3rd Ed.),
International Student Edition.

33 METHODS OF OPERATIONAL RESEARCH Leung Chi-Kun, B.Sc. (C.U.H.K.), B.Sc. (Special) (H.K.), M.Sc. (Lond.), Lecturer in Statistics, University of Hong Kong. *Wednesdays, 7.00-8.00 p.m., starting February 24, 1971. University Main Building. 12 meetings.* Fee: \$50

The course is intended for graduates in mathematics, computer science, engineering, business administration, accounting, and economics or other persons with a good knowledge of algebra and calculus. The topics will cover: Linear, Non-Linear, and Dynamic Programming. Game Theory. Queueing Theory. Network Theory. Critical Path Analysis. Inventory Models.

Textbook: R.L. Ackoff & M.W. Sasieni,
Fundamentals of Operations Research,
Sydney: Wiley International Edition, 1968.

MANAGEMENT OF INDUSTRIAL RELATIONS K.N. Vaid, M.A. (New Delhi), Dip.S.W.P. (The Hague), and J.W. England, B.A. (Nottm.) *Fridays, 2.30-5.00 p.m., starting March 5, 1971. Extra Mural Town Centre. 10 meetings.* *Fee: \$800*

240

With the increased use of sophisticated technology in business and industry, the professionalization of management, and rising expectations of the workforce, the traditional styles of managing industrial relations become less relevant to the needs of an enterprise.

Consequently, this course seeks to identify more relevant methods of handling industrial relations in the dynamic situation of the enterprise. More specifically, it deals with the logic, methods and techniques of

- Collective Bargaining
- Conflict Channelization
- Joint Committees
- Salary and Wage Administration
- Employee Relations

The course will comprise lectures and case discussions prepared specially for the purpose. This will be supplemented by essential and general reading material.

Participation will be limited to 15 managers responsible for handling industrial relations, training, manpower planning, wages and salaries, and allied staff matters, in large corporations.

FINANCIAL MANAGEMENT FOR NON-SPECIALISTS Kenneth Ko, M.A. (McGill), B.Com. (Sir George Williams). *Thursdays, 7.00-8.00 p.m., starting February 18, 1971. Extra-Mural Town Centre. 16 meetings.* *Fee: \$75*

241

This course is designed for Junior Executives and Middle Managers not working in the financial area of Management, who have a basic appreciation of accounting, and who wish to improve their knowledge of the techniques of Financial Management. Topics to be covered will include the interpretation of balance sheets, cost control, budgets and forecasting, problems of cash flow and funds flow, project analysis for long-range planning, inventory methods, and effective uses of bank credit.

Recommended reading: Charles T. Horngren, "Accounting in Management Control", Prentice Hall.
P. Hunt, C.M. Williams and C. Donaldson, "Basic Business Finance", Richard Irwin Inc.

242 INVESTMENT I Francis C.Y. Chan, M.B.A. *Wednesdays, 6.00-7.00 p.m., starting February 24, 1971. Lecture Room North, 8/F., City Hall. 14 meetings. Fee: \$55*

投資學 (一)

本課程共十四講，對有關投資的研究與處理之問題，有詳盡之討論。內容包括投資的目的，證券，互惠投資基金，參考資料之取得，購售手續，證券市場，有價證券之分析，時效問題，經紀人關係等。

主 講 人：陳暢餘碩士。

講授語言：粵語。

地 點：香港大會堂九樓北演講廳。

時 間：一九七一年二月廿四日起每星期三下午六時至七時。

學 費：五十五元。

43 INVESTMENT II Peter P. Woo, B.S., Ch.E. (Columbia), M.B.A. *Wednesdays, 5.45-6.45 p.m., starting February 24, 1971. Extra-Mural Town Centre. 14 meetings. Fee: \$60*

投資學 (二)

這科高級投資課程將包括證券的本身基本情形及股市趨勢分析。損益表以及資產負債表將會作深入的研究及分析。並特別注重各種工業股之市價與盈利比率。個別行業之基本分析，買賣以及劃線圖表之走勢及技術性之研究。(共十四講)。

主 講 人：胡平碩士。

講授語言：粵語。

地 點：香港大學校外課程部市區中心。

時 間：一九七一年二月廿四日起每星期三下午五時四十五分至六時四十五分。

學 費：六十元。

PRACTICAL BANKING II T.Y. Chan, B.A. (Lingnan). *Tuesdays, 7.00-8.00 p.m., starting February 16, 1971. Extra-Mural Town Centre. 12 meetings.* *Fee: \$45*

45

銀行實務 (二)

本課程共十二講，繼續講述銀行實務，特別注意進出口押匯及跟單商業信用証。關於香港新銀行條例，中央銀行及其他重要問題，亦加以研討。

主 講 人：陳天元先生

講授語言：粵語（輔以英語）

地 點：香港大學校外課程部市區中心

時 間：一九七一年二月十六日起每星期二下午七時至八時

學 費：四十五元

FACTORY OPERATION AND SCIENTIFIC MANAGEMENT Wong Man-tun, B.A. (Lingnan), M.A. (Nanking). *Thursdays, 8.15-9.15 p.m., starting February 18, 1971. Extra-Mural Town Centre. 20 meetings.* *Fee: \$70*

243

工廠建設與科學管理

本課程共二十講，內容包括如何籌建工廠及在工廠建成後進行科學管理等問題。建設工廠主要是爲了發展工業，繁榮經濟，而科學管理則主要是爲了提高生產水平。

工廠建設方面主要研究工業發展之重要性，建廠計劃書之編製，主要產品種類之選擇，生產規模之確定，廠區廠址之選擇，廠址總體設計與車間（工場）之組織設計等。工廠管理方面則主要探討組織管理之理論及以生產爲中心之生產管理，勞動組織，材料供應，產品銷售，技術管理（包括新產品發展管理，產品質量管理，設備維修管理）及安全生產等。

本課程適合工業投資者及實際從事工廠管理之人士與其他有興趣人士選讀

主 講 人：王文敦碩士。

講授語言：粵語（輔以英語）。

地 點：香港大學校外課程部市區中心。

時 間：一九七一年二月十八日起每星期四下午八時十五分至九時十五分。

學 費：七十元。

244 **INDUSTRIALISATION AND THE WORKERS** Guest speakers. *Wednesdays, 6.00-7.30 p.m., starting March 3, 1971. Committee Room North, 7/F., City Hall. 10 meetings.* *Fee: \$50*

Without workers no enterprise will function. Without highly motivated and adjusted people no business or economy will grow. The important influences on labour's willingness and ability to contribute to industry will be analysed, with particular reference to Hong Kong. A course with special interest for government officers, company executives, trade union leaders, and social workers interested in and dealing with labour and industrial development in Hong Kong.

Specialist speakers will cover the following topics:

1. People in Industry – the limits to achievement.
2. Features of Hong Kong economy.
3. Technological change and labour.
4. Business organisation and labour.
5. Management styles and labour.
6. Manpower requirements and the educational system.
7. The standard of living.
8. Social services.
9. The legal framework.
10. Labour in Industrialisation – a perspective.

245 **SOCIAL AND ECONOMIC PROFILE OF HONG KONG** Various speakers. *Fridays, 5.45-6.45 p.m., starting February 26, 1971. Extra-Mural Town Centre. 6 meetings.* *Fee: \$25*

A lecture series which will interest teachers of Economic and Public Affairs as well as those generally interested in Hong Kong. Various specialists will deal with Industry; Banking and Finance; Management and Labour; Housing; the Legal System; and the Constitution.

Education

Staff Tutor in Charge: Mrs. Nana Tsao, B.A., Dip. Ed. (H.K.)
Telephone No.: H-468161 Ext. 306

FURTHER STUDIES IN SCHOOL GUIDANCE AND COUNSELLING: A SECOND-LEVEL COURSE FOR TEACHERS, CAREER MASTERS AND COUNSELLORS. 218
N.K. Henderson, Ph.D. (London), B.A., M.Ed. (Melb.), A.B.Ps.S., F.C.P., Professor of Education, University of Hong Kong. *Thursdays, 6.15-7.15 p.m., starting February 18, 1971. University Main Building. 15 meetings.* *Fee: \$60*

This course is for those who have already completed an introductory course in school guidance and counselling, or those who have had some training or practical experience in this work as careers master, counsellor, guidance-teacher or tutor. Topics will include more about the principles and techniques of child guidance, something further about psychological tests and their interpretation and use, interviewing etc., and the study of the nature and treatment of the more common clinical problems likely to be met with in school guidance and counselling work. There will be ample time for discussion, and films and slides will be available as well as test and case-history material for analysis and discussion.

Fee refund: Careers teachers of member Schools of the Hong Kong Association of Career Masters who wish to have their fees refunded by the Director of Education are required to complete an application form (obtainable from the Department of Extra-Mural Studies, University of Hong Kong) which must be returned directly to the Director of Education before the commencement of the course.

THE ORGANISATION AND ADMINISTRATION OF PHYSICAL EDUCATION. 219
W.K. Low, M.Sc., (Indiana), D.L.C., Cert.Ed. (Nott.), Director of Physical Education, University of Hong Kong. *Tuesdays, 6.15-7.15 p.m., starting February 23, 1971. University Main Building. 12 meetings.* *Fee: \$55*

It has been recognised in business, industry and in education that special courses in administration are invaluable in the preparation of personnel for this type of service. This course in administration of physical education is useful not only to those who eventually become administrators but also to teachers and youth leaders who must know how to operate within the framework of an organization under the direction of an administrator. Topics to be discussed include: the nature and process of administration; the physical education service programme; personnel and functions of the staff; facilities; intramural and inter-group activities; budget and finance; purchase and care of equipment; public relations in physical education; legal liabilities for injury etc.

220

UNDERSTANDING AND HELPING THE MENTALLY HANDICAPPED CHILD. – AN APPRECIATION OF THE PROBLEM Mr. F.C. Tang, B.A. (Toronto), B.Ed. (New Brunswick), Principal, Lions Morninghill School, and a panel of Speakers. Mondays, 6.15-7.45 p.m., starting February 22, 1971. University Main Building. 20 meetings. Fee: \$100

(The course is sponsored by the Hong Kong Association for Mentally Handicapped Children and Young Persons).

低能（智力）兒童的管教

本課程之目的為使社會人士，家長，及直接為低能兒童工作之教師，護士，社會工作者，或訓導員，對低能兒童有基本之了解，並在管教方面，有正確之認識。

課程內容包括緒論，社會對低能兒童之照顧，低能兒童之成因及本質（包括醫療方面），低能兒童之需要，及其在家庭，學校，社會及職業方面之適應問題，教育問題，職業訓練等等。

講授方面以粵語為主。由本港對低能兒童有研究及有直接工作經驗之專業人士擔任。方式包括專題講座，電影，討論及參觀低能兒童訓練機構等。（共二十講）

主 講 人：香港晨崗學校校長鄧福泉先生及本港對低能兒童有研究及直接工作經驗之專業人士擔任。

地 點：香港大學校本部。

時 間：一九七一年二月廿二日起每星期一下午六時十五分至七時四十五分。

學 費：一百元。

（本課程由香港低能兒童教育協進會贊助）。

See also:

- 214 English in Translation (page 23)
 - 222 Music Teaching in Primary Schools (page 32)
 - 230 Introduction to Calculus (page 30)
 - 231 The Teaching of Modern Mathematics in Primary Schools (page 30)
 - 233 An Introduction to Biochemistry (page 38)
-

Engineering

Staff Tutor in Charge: Mrs. Priscilla Tso, B.A., Dip. Ed. (H.K.), Dip. Ad. Ed. (Manch.).
Telephone No. H-468161 Ext. 303

Non-Certificated Courses

Tutors: Lecturers in Electrical Engineering, University of Hong Kong.

10

PRINCIPLES OF AMPLIFIER DESIGN *Mondays, 6.30-8.30 p.m., starting February 8, 1971. Building 17, University of Hong Kong. 10 meetings. Fee: \$80*

Outline of Syllabus: RC Coupled; Transformer Coupled; Cascaded Stages; High Input Impedance Techniques; Stagger Tuning & Damping; Broadbanding Techniques; Linvill's Method; Direct Coupled & Common-mode Operation; Differential Amplifiers; Chopper.

INDUSTRIAL ELECTRONICS AND ULTRASONICS *Tuesdays, 6.30-8.30 p.m., starting March 2, 1971. Building 17, University of Hong Kong. 10 meetings. Fee: \$80*

11

Outline of Syllabus: Principles of Electronic Devices; Controlled Rectifier Circuits; Electronic Motor Control; Induction and Dielectric Heating; Principles of Ultrasonic Wave Propagation; Ultrasonic Generators and Receivers; Applications of Ultrasonics in Measurements; Non-Destructive Testings: processing and medical purposes.

English Studies

Staff Tutor in Charge: D.J.H. Macintosh, M.A. (Cantab.), P.G.C.E. (Lond.).
Telephone No.: H- 456443

Courses in the Use of English (First Year)

A sound working knowledge of English is one of the greatest needs in Hong Kong life today. To meet this need the Department offers a carefully devised and integrated series of courses in the Use of English which are aimed at improving the students' ability to speak, write and understand English. General courses are offered for those who wish for a greater fluency in English for everyday purposes while the courses in English for Commercial Practice are more specifically related to the kinds of English used in commerce and industry.

All these courses comprise a continuous programme leading to the award of the Department's Certificate in the Use of English on successful completion of the final year.

Although the two main courses in the Use of English Programme are Use of English I and II, the only new courses to be offered in the Spring and Summer of 1971 are at First Year level (Use of English I). Those who successfully complete these courses may proceed to one of the Second Year courses in the Academic Year 1971/72.

As with all Extra-Mural courses, these are not intended for students in secondary schools.

The tutors for all these courses will be drawn from a panel of university graduates.

Entrance Requirements: A pass in English Language in the Hong Kong English or Chinese Certificate of Education or equivalent.

Closing Date for applications: 1st February 1971. As the number of places in these courses is limited, early application is strongly recommended.

GENERAL COURSES.

In order to improve the basic skills in English of the students, intensive tuition will be given in speaking, writing and the understanding of written and spoken English. The tutors will set assignments to be completed at home, and these will then be marked and discussed in class with the students. A large number of articles on topical subjects and short stories are available for comprehension and appreciation, and at all times the students will be given plenty of opportunity to express their own ideas. Throughout the courses the importance of the oral usage of English will be emphasized.

Reports will be submitted at the end of the courses on all sponsored students.

In Hong Kong: Hong Kong University Main Building. 201
Mondays & Wednesdays, 6.15-7.45 p.m.,
starting February 8, 1971. 44 meetings.
Composite Fee (Tuition and Examination): \$205.

In Kowloon: Hong Kong Baptist College, 224, Waterloo Road. 202
Tuesdays & Thursdays, 6.15-7.45 p.m.,
starting February 9, 1971. 44 meetings.
Composite Fee (Tuition and Examination): \$205.

COMMERCIAL PRACTICE COURSES

These courses, which are ideally suited to the needs of those engaged in commerce and industry, provide intensive tuition in the uses of English most commonly required in commercial situations, and also, as in the general courses, in the basic skills of English, including oral usage. Considerable attention, therefore, will be paid to letter and memorandum writing and to the comprehension of commercial texts and topical articles.

In Hong Kong: Hong Kong University Main Building. 203
Tuesdays & Thursdays, 6.15-7.45 p.m.,
starting February 9, 1971. 44 meetings.
Composite Fee (Tuition and Examination): \$205.

In Kowloon: Hong Kong Baptist College, 224, Waterloo Road. 204
44 meetings.
Composite Fee (Tuition and Examination): \$205.

Mondays & Wednesdays, 6.15-7.45 p.m.,
starting February 8, 1971.

Mondays & Fridays, 6.15-7.45 p.m., 205
starting February 8, 1971.

PRIOR ENROLMENT IS ESSENTIAL

Failure to enrol prior to the opening of a particular course, may, mean the cancellation of that course. Prior enrolment is the only way the Department of Extra-Mural Studies has of judging the response to its courses. Your co-operation is therefore invited in sending your application forms to the Department as soon as possible.

English Speech

- 206** **INTONATION IN IDIOMATIC ENGLISH** Raymond Huang, M.A. (Leeds), I.P.A. Cert.Phon., P.G.C.Ed., L.R.A.M., L.T.C.L. (London). *Mondays, 7.00-8.30 p.m., starting March 1, 1971. City Hall, 7th Floor, Committee Room South. 16 meetings.*
Fee: \$90

By showing the contrasts in stress and intonation between English and Chinese (Cantonese and Mandarin) the tutor will help the Chinese student to grasp:

- (1) The tonal and rhythmic system of his mother tongue and
- (2) how errors in his English speech arise from his native language habits.

Methods of correcting errors will be suggested and graded aural-oral exercises on English Intonation will be provided. Intonation practice will be related to everyday idiomatic English in order to increase the student's range of expression.

The tutor is Principal, Queen's College and formerly Principal, Sir Robert Black College of Education. He is also author of a number of books on phonetics, including "English Pronunciation Explained with Diagrams", and co-author of "Intonation in Idiomatic English".

Courses in Spoken English

In all these courses modern language laboratory teaching methods will be used to give the maximum opportunity for speaking English. The tuition in Spoken English I will be aimed at improving the students' pronunciation and intonation and giving them plenty of opportunity in asking and answering oral questions. In Spoken English II, which is primarily intended for those who have completed the previous course, the emphasis will be on conversational English in different situations.

The tutors for all these courses will be drawn from a panel of university graduates.

In order to allow the tutors to pay the maximum amount of attention to individual students, enrolment is limited to 15 persons in each course.

All the courses will be held in the language laboratory of the Language Centre at Hong Kong University.

SPOKEN ENGLISH I. *10 meetings. Fee: \$40.*

- 207** *Fridays, 6.15-7.45 p.m., starting February 5, 1971. (course fully subscribed)*
- 208** *Fridays, 6.15-7.45 p.m., starting April 30, 1971.*
- 209** *Thursdays, 6.15-7.45 p.m., starting May 6, 1971.*
-

SPOKEN ENGLISH II. 10 meetings. Fee: \$40.

Mondays, 6.15-7.45 p.m., starting April 26, 1971. 210

Tuesdays, 6.15-7.45 p.m., starting May 4, 1971. 211

Wednesdays, 6.15-7.45 p.m., starting May 5, 1971. 212

English for Teachers

ENGLISH TEACHING TECHNIQUES William Cheng, B.A., M.A. (Ed.) (H.K.), Dip. in App. Ling. (Edin.). *Mondays, 6.15-7.45 p.m., starting February 8, 1971. University Main Building. 12 meetings.* 213
Fee: \$75

Planned to assist secondary school teachers of English, this course will deal with up-to-date techniques applicable to the most important areas of the curriculum. The basic principles of language teaching will be discussed in detail with particular relation to the following topics:

1. The teaching of vocabulary;
2. The teaching of reading;
3. The teaching of English grammar;
4. The teaching of oral and written English;
5. The presentation of set books and the teaching of poetry;
6. Language testing.

The tutor is Principal, New Territories Heung Yee Kuk Yuen Long District Secondary School and a former senior lecturer in English at Sir Robert Black College of Education.

Fee Refund: Teachers of English at Advanced or Certificate of Education levels who wish to have their fees refunded by the Director of Education are required to complete an application form (obtainable from the Department of Extra - Mural Studies, University of Hong Kong) which must be returned directly to the Director of Education before the commencement of the course. This applies to all teachers whether in Government or private schools.

ENGLISH IN TRANSLATION Jao Yu-Wei, M.A. (Edin.). *Fridays, 6.15-7.45 p.m., starting February 12, 1971. University Main Building. 16 meetings.* 214
Fee: \$100

The importance of English-Chinese/Chinese-English translation is daily becoming more evident in Hong Kong. This course in practical translation is therefore offered for those who are already engaged in translation in the Government Service or in commerce and industry. Applicants should have a fair proficiency in English and Mandarin and/or Cantonese.

The tutor, who has had considerable experience in teaching translation methods in Hong Kong, Singapore and Taiwan, was previously employed by international agencies of the United Nations as a translator.

Courses in Critical Appreciation

- 215** **READING AND DISCUSSION** Miss J.B. Boozer, M.A. (New York), Assistant Lecturer in English, United College, C.U.H.K. *Fridays, 6.15-7.45 p.m., starting February 12, 1971. University Main Building. 10 meetings. Fee: \$45*

A further course, principally intended for those who have completed the 'Use of English II' course or who are following it this year, but also suitable for those others who have a fairly fluent command of English. Various types of non-literary English, including newspaper reports, editorials and articles will be examined critically and discussed in class.

Textbook: W.E.K. Anderson: *The Written Word* (O.U.P.). This book may be obtained from the Hong Kong Book Centre, Des Voeux Road, Central.

-
- 216** **THE MODERN NOVEL** P.H. Collin, M.A. (Oxon.), Lecturer in French, Department of European Language and Literature, University of Hong Kong. *Tuesdays, 6.15-7.15 p.m., starting February 9, 1971. University Main Building. 10 meetings. Fee: \$45*

What forms can the modern novel take? In what way does the modern novel reflect the society which produced it? In this course novels from five countries written between 1920 and 1960 are considered against their cultural backgrounds. Each novel will be the subject of one lecture by the tutor, and one hour's discussion in the following session.

The novels to be studied are:

Kafka:	The Trial
Camus:	The Outsider
Lampedusa:	The Leopard
Murdoch:	The Flight from the Enchanter
Abe:	The Woman in the Dunes

These books are obtainable from the Hong Kong Book Centre, Des Voeux Road, Central.

Note: students are urged to read 'The Trial' before the first session.

RUSSIAN LIFE, 1900—1960. Serge Quested, formerly Lecturer in Russian, University of Malaya. *Fridays, 6.15-7.15 p.m., starting March 12, 1971. University Main Building. 10 meetings.* **217**
Fee: \$45

This course will provide an insight into various aspects of Russian life, as seen by a number of Soviet writers, since the beginning of this century. The specific topics that will be considered are conditions in late Tsarist Russia, the Revolution and the Civil War and life in Russia under the Soviets.

The novels in question will be studied with a view to considering their structure, strength and failings of the translations and the adequacy of the pictures they present of contemporary Russian life. Each novel will be the subject of at least one lecture by the tutor, and one hour's discussion in the following session.

The novels to be studied are:

- M. Gorky: Childhood
- M. Sholokhov: And Quiet Flows the Don
- B. Pasternak: Dr. Zhivago
- I. Solzhenitsyn: One Day in the Life of Ivan Denisovitch

These books are obtainable from the Hong Kong Book Centre, Des Voeux Road, Central.

Note: students are urged to read 'Childhood' before the first session.

PRIOR ENROLMENT IS ESSENTIAL

Failure to enrol prior to the opening of a particular course, may, mean the cancellation of that course. Prior enrolment is the only way the Department of Extra-Mural Studies has of judging the response to its courses. Your co-operation is therefore invited in sending your application forms to the Department as soon as possible.

Geography

Staff Tutor in Charge: Jon A. Prescott, B.Arch., M.C.D., (Liv.); A.R.I.B.A., A.M.T.P.I.
Telephone No.: H-456430

86 **MAN AND HIS ENVIRONMENT** Armando da Silva, M.A. (California), and John Pitman, B.Sc. (Hull), Department of Geography, University of Hong Kong. *Thursdays, 6.15-7.45 p.m., starting February 25, 1971, University Main Building. 6 meetings and 6 field trips* *Fee: \$60*

The emphasis in these lectures will be on the relationship between men and the land, both in rural and urban conditions. Topics which will be discussed will include fishponds, village ecology, water supplies, environmental pollution, and waste disposal.

Potential students are warned that the field trips may involve a considerable amount of walking. Enrolment will be limited to 30 persons.

History

Staff Tutor in Charge: Mrs. Nana Tsao, B.A., Dip. Ed. (H.K.)
Telephone No: H-468161 Ext. 306

REVOLUTION IN EUROPE 1789-1968. Dr. A. Birch, M.A., Ph.D. (Manc.). Reader, Department of History, University of Hong Kong. *Tuesdays, 6.15-7.45 p.m., starting February 23, 1971. University Main Building. 12 meetings.* *Fee: \$55*

221

This course will consider a number of revolutionary "contexts" in the light of the personalities, programmes and "processes" thrown up in these convulsions of society. In a short series of classes such as this, it will, of course, be impossible to consider all the revolutionary situations in the old and new countries of Europe. The method adopted will be to take a number of "case-studies" and to examine the problems of power, class and ideology. These case studies will include the French Revolutions of 1789 and 1848, the Commune of 1871, the Russian Revolutions of 1905 and 1917. There will also be some discussion of the twentieth century revolutions of the **Left** and the **Right**. Finally, an attempt will be made to consider revolutions which can be broadly described as anarchistic and influenced by non-European political thought. This course is directed to the intelligent general student. It will be useful for teachers of history and of public affairs; but the value of this approach should result from the insights to be gained by this multi-disciplinary organization of the topic.

European Language

Staff Tutor in Charge: D.J.H. Macintosh, M.A. (Cantab.), P.G.C.E. (Lond.)
Telephone No.: H-456443

223 INTRODUCTION A L'HISTOIRE POLITIQUE ET SOCIALE DE LA FRANCE MODERNE J. Warin, M.A. (Paris), French Consul, Hong Kong. *Fridays, 5.45-6.45 p.m., starting February 5, 1971. Extra-Mural Town Centre. 12 meetings. Fee: \$50*

La III^e République, l'Affaire Dreyfus, la Grande Guerre, le Front Populaire, Vichy, la Résistance, la Guerre d'Algérie, la période Gaulliste ... autant d'étapes qui jalonnent l'histoire de la France depuis une centaine d'années. Comment ces événements reflétaient-ils, et reflètent-ils encore, les faiblesses et les grandeurs du peuple français?

Ces conférences visent surtout ceux qui, ayant achevé deux années d'études linguistiques à l'Alliance Française, desirent elargir leurs connaissances de la langue française a travers une introduction à l'histoire politique et sociale de la France moderne.

PRIOR ENROLMENT IS ESSENTIAL

Failure to enrol prior to the opening of a particular course, may, mean the cancellation of that course. Prior enrolment is the only way the Department of Extra-Mural Studies has of judging the response to its courses. Your co-operation is therefore invited in sending your application forms to the Department as soon as possible.

Law

Staff Tutor in Charge: Mrs. Priscilla Tso, B.A., Dip. Ed. (H.K.), Dip. Ad. Ed. (Manch.)
Telephone No.: H-468161 Ext. 303

Law for Laymen

LANDLORD AND TENANT Michael Hon, Assistant Crown Counsel, *Fridays, 6.00-7.00 p.m., starting February 19, 1971. Extra-Mural Town Centre. 8 meetings.* **229**

Fee: \$25

The course aims to introduce the law of landlord and tenant and to discuss how the law affects the interests of both landlord and tenant in Hong Kong. Topics such as the disposal of land in Hong Kong and incidents arising therefrom; the legal aspect of sale and purchase of houses; the obligations and privileges of vendors, purchasers, lessors and lessees will be dealt with.

Mathematics

Staff Tutor in Charge: Mrs. Priscilla Tso, B.A., Dip.Ed. (H.K.), Dip.Ad.Ed. (Manc.).
Telephone No.: H-468161 Ext. 303

- 230** **INTRODUCTION TO CALCULUS** C.B. Spencer, Ph.D. (Liv.), Lecturer in Mathematics, H.K.U. *Wednesdays, 7.00-8.30 p.m., starting February 10, 1971. Extra-Mural Town Centre. 15 meetings.* *Fee: \$75*

The following topics will be covered: limits, gradients, derived functions. Differentials, differential coefficients; applications to geometry and kinematics. Differentiation of algebraic functions. Maxima and minima. Integration as opposite of differentiation. Areas; Trigonometric functions. Integration by summation; volumes; mean values. Methods of integration. Logarithmic and exponential functions. Hyperbolic functions; systematic integration.

- 231** **THE TEACHING OF MODERN MATHEMATICS IN PRIMARY SCHOOLS** Ho Siu Lun, B.Sc. (Lond.). *Wednesdays, 5.30-6.30 p.m., starting February 10, 1971. Extra-Mural Town Centre. 10 meetings.* *Fee: \$35*

小學新數教學

本課程共十講，每講一小時，專為小學教師而設，旨在介紹小學數學之新教學方法。內容包括新教學法之原理及實踐。

主 講 人：何兆倫先生。

講授語言：粵語。

地 點：香港大學校外課程部市區中心。

時 間：一九七一年二月十日起每星期三下午五時卅分至六時卅分。

學 費：三十五元。

MODERN MATHEMATICS IN SECONDARY SCHOOLS II Tsui See Ming, B.A.,
Dip.Ed. (H.K.). Mondays, 5.45-6.45 p.m., starting February 8, 1971. Extra-Mural
Town Centre. 12 meetings. *Fee: \$45*

232

中學新數教學（乙部）

此課程共十二講，每講一小時，繼前講“中學新數教學”，
續論本港中學一至三年之新數課程，專為家長及一般社會人士而
設。

主 講 人：徐思明先生。

講授語言：粵語。

地 點：香港大學校外課程部市區中心。

時 間：一九七一年二月八日起每星期一下午五時四十五分至
六時四十五分。

學 費：四十五元。

PRIOR ENROLMENT IS ESSENTIAL

Failure to enrol prior to the opening of
a particular course, may mean the cancellation
of that course. Prior enrolment is the only
way the Department of Extra-Mural Studies
has of judging the response to its courses. Your
co-operation is therefore invited in sending
your application forms to the Department as
soon as possible.

Music

*Staff Tutor in Charge: Mrs. Nana Tsao, B.A., Dip. Ed. (H.K.).
Telephone No.: H-468161 Ext. 306*

-
- 222** **MUSIC TEACHING IN PRIMARY SCHOOLS** Mrs. Chan Liu Po-shiu, L.R.S.M., L.T.S.C., A.I.E. (London), Teacher's Cert. (N.C.E.), Lecturer in Music, Sir Robert Black College of Education. *Tuesdays, 6.45-7.45 p.m., starting February 23, 1971. Sir Robert Black College of Education, Hok Yuen Street, Hunghom, Kowloon. 12 meetings. Fee: \$65*

小學音樂教學

此課程共十二講，每講一小時。課程內容包括小學音樂教師之修養；音樂室之佈置；小學音樂課程；節奏及音準之練習；律動教材及教授法，新歌，輪唱，二，三，四部合唱之教授法；節奏樂，音樂欣賞之教授法；音樂課教具（特別介紹電五線板及活動視聽五線板之用途）；自由創作音樂之發展及音樂教案及記錄之寫法。另有小學音樂示範及學員實際教學練習。

主 講 人：陳廖寶韶女士。

講授語言：粵語。

地 點：九龍紅磡鶴園街柏立基教育學院。

時 間：一九七一年二月廿三日起每星期二下午六時四十五分至七時四十五分。

學 費：六十五元。

Oriental Languages & Studies

Staff Tutor in Charge: Mrs. Nana Tsao, B.A., Dip. Ed. (H.K.).
Telephone No.: H-468161 Ext. 306.

Evening Programme

MANDARIN I Shih Wan-chu, B.A. (Peking Normal University), Instructor in Mandarin, University of Hong Kong. *Mondays & Thursdays, 7.30-8.30 p.m., starting March 29, 1971. University Main Building. 40 meetings.* **107**
Fee: \$200

MANDARIN II Shih Wan-chu, B.A. (Peking Normal University), Instructor in Mandarin, University of Hong Kong. *Mondays & Thursdays, 6.15-7.15 p.m., starting March 29, 1971. University Main Building. 40 meetings.* **108**
Fee: \$220

CANTONESE I Paul Fong, B.A., Dip. Ed. (H.K.). *Mondays & Thursdays, 7.30-8.30 p.m., starting March 29, 1971. University Main Building. 40 meetings.* **109**
Fee: \$200

CANTONESE II Paul Fong, B.A., Dip Ed. (H.K.). *Mondays & Thursdays, 6.15-7.15 p.m., starting March 29, 1971. University Main Building. 40 meetings.* **110**
Fee: \$220

Day Time Programme

CANTONESE I Francis Sham, B.A. (Sun Yat-sen), Instructor in Cantonese, *Mondays & Thursdays, 2.00-3.00 p.m., starting March 29, 1971. Extra-Mural Town Centre. 40 meetings.* **111**
Fee: \$200

CANTONESE II Francis Sham, B.A. (Sun Yat-sen), Instructor in Cantonese. *Tuesdays & Fridays, 2.00-3.00 p.m., starting March 30, 1971. Extra-Mural Town Centre. 40 meetings.* **112**
Fee: \$220

-
- 226 KUO YU (MANDARIN). Pai Hsuan-chih, B.A. (Lingnan). *Mondays & Wednesdays, 6.15-7.15 p.m., starting February 22, 1971. University Main Building. 40 meetings.*
Fee: \$200

國 語

本課程共四十講，包括十二小時於錄音室練習，每週二講，每講一小時。內容有國語注音符號（包括注音字母及大陸現行標準拼音法），國，粵語發音，語法與詞句之差異，國語會話及文章選讀等。

本課程限收廿五人，如報名人數衆多或國語程度高低不一，主理導師將審核分班或決定取錄。

主 講 人：白選之先生。

講授語言：粵語。

地 點：香港大學校本部。

時 間：一九七一年二月廿二日起每星期一及星期三下午六時十五分至七時十五分。

學 費：二百元。

-
- 137 UNDERSTANDING CHINESE CUSTOMS & TRADITIONS Mrs. M. Topley, Ph. D. (London). *Wednesdays, 6.15-7.15 p.m., starting February 24, 1971. University Main Building. 12 meetings.*
Fee: \$40

This series of lectures is designed for those who wish to learn something of the role of Chinese customs and traditional ways of thought in Hong Kong life today. It will also discuss changes in some of the traditional patterns of thought and behaviour. Topics to be included are Chinese family and marriage; child-rearing and the position of women; Chinese names; clan and ancestor worship; geomancy; Chinese traditional medicine; religion; and popular festivals.

Philosophy Psychology

Enquiries: J.W.England, B.A. (Nottm.), Deputy Director.
Telephone No.: H-468161 Ext. 301

Philosophy

THE AGE OF REASON T.C. Goodrich, B.A. (Birm.), Lecturer in Philosophy, **224**
University of Hong Kong. *Mondays, 6.15-7.15 p.m., starting February 22, 1971.*
University Main Building. 5 meetings. Fee: \$15

A brief survey of developments in western philosophy in the seventeenth and eighteenth centuries. The theme will be the impact of Newtonian science on ways of thinking about religion. Thinkers to be particularly studied will be Descartes, Spinoza and Leibniz.

A useful introductory book is "The Age of Reason" ed. Stuart Hampshire, in Mentor Books.

MORALITY AND CONDUCT Ian Watson, B.A. (Melb.), M.A. (McMaster), Lecturer **225**
in Philosophy, University of Hong Kong. *Wednesdays, 7.30-8.30 p.m., starting*
February 24, 1971. University Main Building. 10 meetings. Fee: \$35

Starting with the assumption that we all want to know what is right, and that we therefore all want to know how we ought to behave towards other people, this course examines a number of possible answers, offered by philosophers, to the two questions:

- (i) What, in general, makes conduct right?
 - (ii) How do we find out what, in particular, is right?
-

Psychology

- 246** **PSYCHOLOGY AND YOU** Tam Wai-hon, B.A., Ed.D. (Calif.) *Tuesdays, 6.00-7.00 p.m., starting February 23, 1971. Extra-Mural Town Centre. 12 meetings. Fee: \$40*

心理學與你

在今日之複雜世界，沒有人能不懂些心理知識。本科之主旨在討論心理學上有些有興趣而又實用的問題。如預料行爲，你與你的子女之智力，怕狗或黑之原故，視覺的正確性，證據的可靠性，錯覺，閱讀能力與記憶力之增進及夢等等。（共十二講）。

主 講 人：譚維漢博士。

講授語言：粵語。

地 點：香港大學校外課程部市區中心。

時 間：一九七一年二月廿三日起每星期二下午六時至七時。

學 費：四十元。

-
- 247** **ABNORMAL PSYCHOLOGY** James McGuire, M.A. (Glasgow). *Thursdays, 6.15-7.45 p.m., starting February 25, 1971. University Main Building. 10 meetings. Fee: \$50*

What is 'abnormal' behaviour? The main varieties of abnormal behaviour will be described including Neuroses and Psychoses, Schizophrenia, organic disorders such as alcoholism, drug addiction, paresis, and the effects of brain damage. Methods of assessment and treatment will be discussed.

In addition to his academic studies of these problems the tutor has worked as a psychiatric nurse.

-
- 248** **PSYCHOLINGUISTICS – THE STUDY OF THE PSYCHOLOGY OF LANGUAGE** Brian M. Young, B.Sc. (Edin.), Assistant Lecturer in Psychology, University of Hong Kong. *Fridays, 6.15-7.15 p.m., starting February 26, 1971. University Main Building. 10 meetings. Fee: \$35*

This course assumes no previous knowledge of either psychology or linguistics but the topics discussed are complex and intellectually provoking. Areas of discussion include: the ideas of Noam Chomsky and their effect on the psychology of language, the relationship between language and thinking and the work of Benjamin Lee Whorf, the development of language in children, bilingualism in Hong Kong and Chinese linguistics and psycholinguistics.

Political Science

*Staff Tutor in Charge: Mrs. Nana Tsao, B.A., Dip.Ed. (H.K.).
Telephone No.: H-468161 Ext. 306*

HOW PEOPLE BEHAVE IN POLITICS – AN INTRODUCTION TO POLITICAL BEHAVIOUR P.B. Harris, B.A. (Wales), B.Sc. (Econ.), Ph.D. (London). D.Litt. (Natal.), Professor of Political Science, University of Hong Kong. *Wednesdays, 6.15-7.45 p.m., starting February 24, 1971. University Main Building. 10 meetings. Fee: \$40* **227**

How do people and nations behave in Politics? What are the factors which determine a person's political behaviour? Why do inter-state relations break down? In this 10 meeting course, Professor Harris will give an introductory survey to factors affecting the political behaviour of the Individual, the Group and the Party, and further discuss such topics as the origin of War and Conflict; Conventional and Nuclear Warfare and the Prospect of Arms Control.

Science

Staff Tutor in Charge: Mrs. Priscilla Tso, B.A., Dip. Ed. (H.K.), Dip. Ad. Ed. (Manch.).
Telephone No.: H-468161 Ext. 303

- 146** **CONCEPTS OF MODERN PHYSICS** E.C.M. Young, Ph.D. (Bristol), Lecturer in Physics, University of Hong Kong. *Fridays, 6.15-7.45 p.m., starting February 19, 1971. Northcote Science Building, University of Hong Kong, Pokfulam Road, Hong Kong. 10 meetings.* *Fee: \$50*

A course for physics teachers and interested laymen. It is designed to introduce the basic principles of modern physics with emphasis on the understanding of physical concepts.

The following topics will be discussed: relativity, quantum theory, atomic structure, solid state, the atomic nucleus and elementary particles.

Fee refund: Teachers of Physics at Advanced or Certificate of Education levels who wish to have their fees refunded by the Director of Education are required to complete an application form (obtainable from the Department of Extra-Mural Studies, University of Hong Kong) which must be returned directly to the Director of Education before the commencement of the course. This applies to all teachers whether in Government or private schools.

- 233** **AN INTRODUCTION TO BIOCHEMISTRY** Keith Sayer, B.Sc. (Manchester). *Tuesdays, 5.30-7.00 p.m., starting February 9, 1971. Extra-Mural Town Centre. 12 meetings.* *Fee: \$60*

This series of lectures will introduce the student to some of the basic concepts of modern biochemistry. It will be of particular interest to teachers of A-level biology. A sound knowledge of chemistry would be advantageous. The following topics will be covered: experimental methods in biochemistry; the nature and function of enzymes; bioenergetics; biochemical genetics.

Fee refund: Teachers of Biology at Advanced Level who wish to have their fees refunded by the Director of Education are required to complete an application form (obtainable from the Department of Extra-Mural Studies, University of Hong Kong) which must be returned directly to the Director of Education before the commencement of the course. This applies to all teachers whether in Government or private schools.

HOW YOUR BODY WORKS II Chi-Chin LIANG, B.Sc.(Tsing Hua), Ph.D.(Lond.).
Fridays, 7.00-8.30 p.m., starting February 12, 1971. Extra-Mural Town Centre. 12 meetings.

234

Fee: \$45

人體功能 (乙部)

本課程共十二講，每講一小時半，續前講“人體功能”，着重討論人和環境的關係，內容包括：自然環境對生理之影響，人類對環境之適應，壽命和疾病，人與社會之關係，現代生活方式對人類之影響等。

主 講 人：梁其瑾博士。

講授語言：粵語。

時 間：一九七一年二月十二日起每星期五下午七時至八時卅分。

地 點：香港大學校外課程部市區中心。

學 費：四十五元。

AN OUTLINE OF STELLAR ASTRONOMY Liu Hing Chai, B.A. (H.K.), *Fridays, 8.15-9.45 p.m., starting February 12, 1971. Extra-Mural Town Centre. 12 meetings.*

235

Fee: \$55

恆星天文學概論

本課程用通俗方式闡述恆星天文學之基本概念與方法，全部十二講，內容包括：

恆星天文學之研究對象及意義。

恆星之物理性質。

恆星之距離，運動與空間分佈。

星團，星協，星族。

星際物質。

銀河系之結構。

河外星系及總星系等。

主 講 人：廖慶齊先生。

講授語言：粵語。

地 點：香港大學校外課程部市區中心。

時 間：一九七一年二月十二日起每星期五下午八時十五分至九時四十五分。

學 費：五十五元。

Public Lecture

公開講座

ARTISTIC POT PLANTS (BONSAI)

Mr. Wu Yee-sun, Chairman, Wing Lung Bank Ltd. *Wednesday, February 10, 1971, 7.00-8.30 p.m. Lecture Room North, City Hall.*

The lecture will be illustrated with slides and delivered in Cantonese with English translation.

The following topics will be discussed: origin and history; bonsai and the art of living; shaping and layout; methods of cultivation; selection of vessels.

盆 景 藝 術

本講座設於香港太會堂九樓北演講廳，定於一九七一年二月十日星期三下午七時至八時卅分舉行，敦請永隆銀行董事長伍宜孫先生用粵語講述（英語譯述），輔以幻燈片，不設門券，歡迎各界蒞聽，題材如下：

中國盆景之沿革
盆景藝術之今昔
盆景與人生
造型佈局之研究
盆樹之培植
配盆之重要

INDEX TO COURSES

Page	Course	
19	10	AMPLIFIER DESIGN, Principles of
10	237	ART, Beginners' Basic
10	249	ART, History of three Artists
39	235	ASTRONOMY Stellar, An Outline of
15	45	BANKING II, Practical
38	233	BIOCHEMISTRY, An Introduction to
39	234	BODY, How Yours Work II
9	20	BRONZES of Shang & Chou China
11	24	BUILDING INDUSTRY in Hong Kong, Technical Documentation for the
30	230	CALCULUS, Introduction to
33	109	CANTONESE I
33	111	CANTONESE I (Daytime)
33	110	CANTONESE II
33	112	CANTONESE II (Daytime)
34	137	CHINESE CUSTOMS & TRADIT- IONS, Understanding
9	19	CIVILIZATION – Sir Kenneth Clarke
9	17	DESIGN, What is
10	238	DRAWING, Life
19	11	ELECTRONICS & ULTRASONICS, Industrial
22	206	ENGLISH, Intonation in Idiomatic
22	207-209	ENGLISH I, Spoken
23	210-212	ENGLISH II, Spoken
23	213	ENGLISH, Teaching Technique
21	203-205	ENGLISH, the Use of – Commercial Practice Courses
21	201-202	ENGLISH, the Use of – General Courses
15	243	FACTORY OPERATION & SCIEN- TIFIC MANAGEMENT
13	241	FINANCIAL MANAGEMENT for Non-Specialists
28	223	FRANCE MODERNE, Introduction A L'histoire Politique et Sociale de la
11	228	HINDU ART of India: an introduc- tion
13	240	INDUSTRIAL RELATIONS, Manage- ment of

INDEX TO COURSES

Page	Course
16	244 INDUSTRIALISATION & THE WORKERS
14	242 INVESTMENT I
14	43 INVESTMENT II
34	226 KUO YU (Mandarin)
29	229 LANDLORD AND TENANT
26	86 MAN & HIS ENVIRONMENT
33	107 MANDARIN I
33	108 MANDARIN II
30	231 MATHEMATICS in Primary Schools, the Teaching of Modern
31	232 MATHEMATICS in Secondary Schools II, Modern
18	220 MENTALLY HANDICAPPED CHILD, Understanding & Helping the
35	225 MORALITY AND CONDUCT
32	222 MUSIC teaching in Primary Schools
24	216 NOVEL, the modern
12	33 OPERATIONAL RESEARCH, Methods of
10	236 PAINTING, Creative
17	219 PHYSICAL EDUCATION, the Organization & Administration of
38	146 PHYSICS, Concepts of Modern
37	227 POLITICS, How People Behave in: an introduction to political behaviour
36	247 PSYCHOLOGY, Abnormal
36	246 PSYCHOLOGY AND YOU
36	248 PSYCHOLINGUISTICS – the Study of the Psychology of Language
12	239 PUBLIC RELATIONS
24	215 READING AND DISCUSSION
35	224 REASON, the Age of
27	221 REVOLUTION in Europe 1789-1968
25	217 RUSSIAN LIFE 1900-1960
17	218 SCHOOL GUIDANCE & COUNSELLING, Further Studies in
16	245 SOCIAL & ECONOMIC PROFILE OF HONG KONG
12	31 STATISTICAL METHODS II
11	152 TOWNS, the Shape of
23	214 TRANSLATION, English in

預早報名之重要

有志修讀本部課程者應儘早報名，如不預先報名可引致各該課程延期開課或取消。預先報名乃是使本部得知各界對種種課程反應之唯一途徑，故報名表格應儘速寄回本部

PRIOR ENROLMENT IS ESSENTIAL

Failure to enrol prior to the opening of a particular course, may mean the cancellation of that course. Prior enrolment is the only way the Department of Extra-Mural Studies has of judging the response to its courses. Your cooperation is therefore invited in sending your application forms to the Department as soon as possible.

香港大學校外課程部

申請書填妥後附學費送交香港大學校外課程主任，

繳費可用支票或現金，如用支票請抬頭「香港大學」并加橫線逕寄本部。

除非課程臨時取消或改期，請依照公佈日期上課，本部不另通知。如報名申請未被接受，學費將退還，但課程開始後，學費通常不能退還。

UNIVERSITY OF HONG KONG DEPARTMENT OF EXTRA-MURAL STUDIES

THE WHOLE OF THIS FORM TOGETHER WITH THE APPROPRIATE FEE SHOULD BE SENT TO THE DIRECTOR OF EXTRA MURAL STUDIES THE UNIVERSITY OF HONG KONG

PAYMENT MAY BE MADE IN CASH OR BY CHEQUE AT THE UNIVERSITY OR BY POST. CHEQUES SHOULD BE CROSSED AND MADE PAYABLE TO "UNIVERSITY OF HONG KONG".

THE ISSUE OF AN ENROLMENT APPLICATION ACKNOWLEDGMENT DOES NOT OF ITSELF CONSTITUTE ACCEPTANCE OF THE APPLICATION, BUT IF YOU DO NOT HEAR OTHERWISE BEFORE A COURSE STARTS YOU MAY ASSUME YOU HAVE BEEN ACCEPTED. IF FOR ANY REASON YOU ARE NOT ACCEPTED YOUR FEE WILL BE RETURNED, BUT OTHERWISE FEES ARE NOT NORMALLY REFUNDABLE.



Extra Mural Studies 校外課程

Application for Enrolment 報名申請書

每一種課程請用別紙填寫

PLEASE USE A SEPARATE FORM FOR EACH COURSE

A

課程號碼

課程名稱

姓名

前已讀其他校外課程名稱

COURSE NO.

COURSE NAME

NAME in full (Mr./Mrs./Miss)

English
英文
Chinese
中文

in block letters—surname first

FEE ENCLOSED \$
附學費

CASH/CHEQUE NO.

What Extra Mural Courses have you previously attended?

姓名

通訊處

辦事處地址

電話

國籍

職業

學歷

大專學歷

NAME IN FULL (Mr./Mrs./Miss)

English
英文
Chinese
中文

in block letters—surname first

ADDRESS for correspondence

OFFICE ADDRESS

TELEPHONE NOS. Home 住宅

Office 辦事處

NATIONALITY

Age 年齡 (please tick age group)

18-19
20-29
30-39
40-49
50-59
over 60

OCCUPATION

SCHOOL and highest class reached

HIGHER and/or FURTHER EDUCATION

DATE 日期

SIGNATURE 簽字

For Office Use →

DATE

REG. NO.

COURSE NO.

AMOUNT

X

For Office Use →

DATE

REG. NO.

COURSE NO.

AMOUNT

X



If you are applying by post and require an acknowledgment of your application, please complete this part

Note: This application acknowledgment is not complete without validation by official printing machine entry of the details at X above at the University or Town Centre office of the Department of Extra-Mural Studies, University of Hong Kong

NAME

FULL POSTAL ADDRESS

Fees are not refundable once the course has commenced.

Please see overleaf.

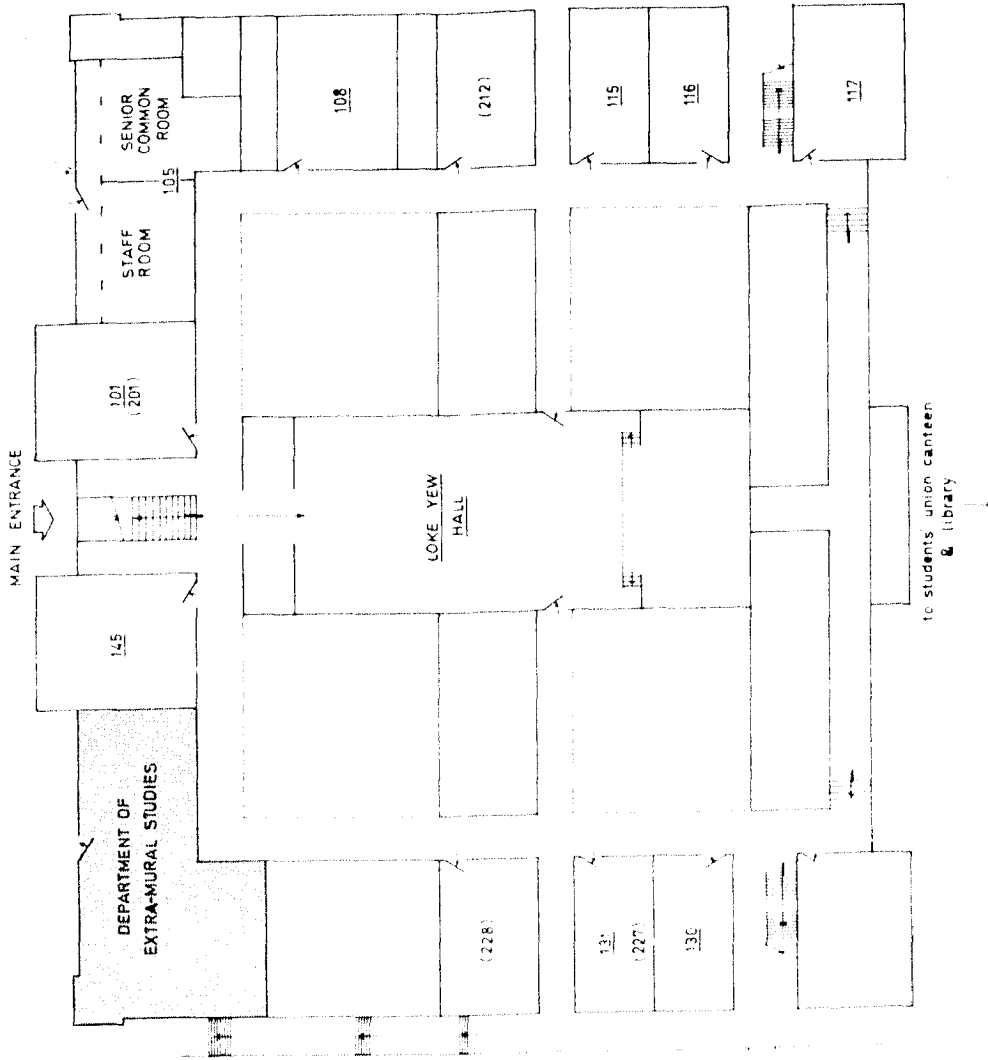

GROUND PLAN OF UNIVERSITY OF HONG KONG MAIN BUILDING

showing location of rooms used for extra mural courses. Please see inside of front cover for University general layout.



HONG KONG PRINTING PRODUCTS CO.

TELEPHONE H 615027 H 615479

香港大學校外課程手冊

一九七〇至一九七一

SPRING SUPPLEMENT

PROSPECTUS 1970-71



2 DEC 1994

Extra Mural Studies

University of Hong Kong