

SPRING SUPPLEMENT

1971-1972



香港大學校外課程手冊

一九七一至一九七二年度春季

Extra Mural Studies

University of Hong Kong

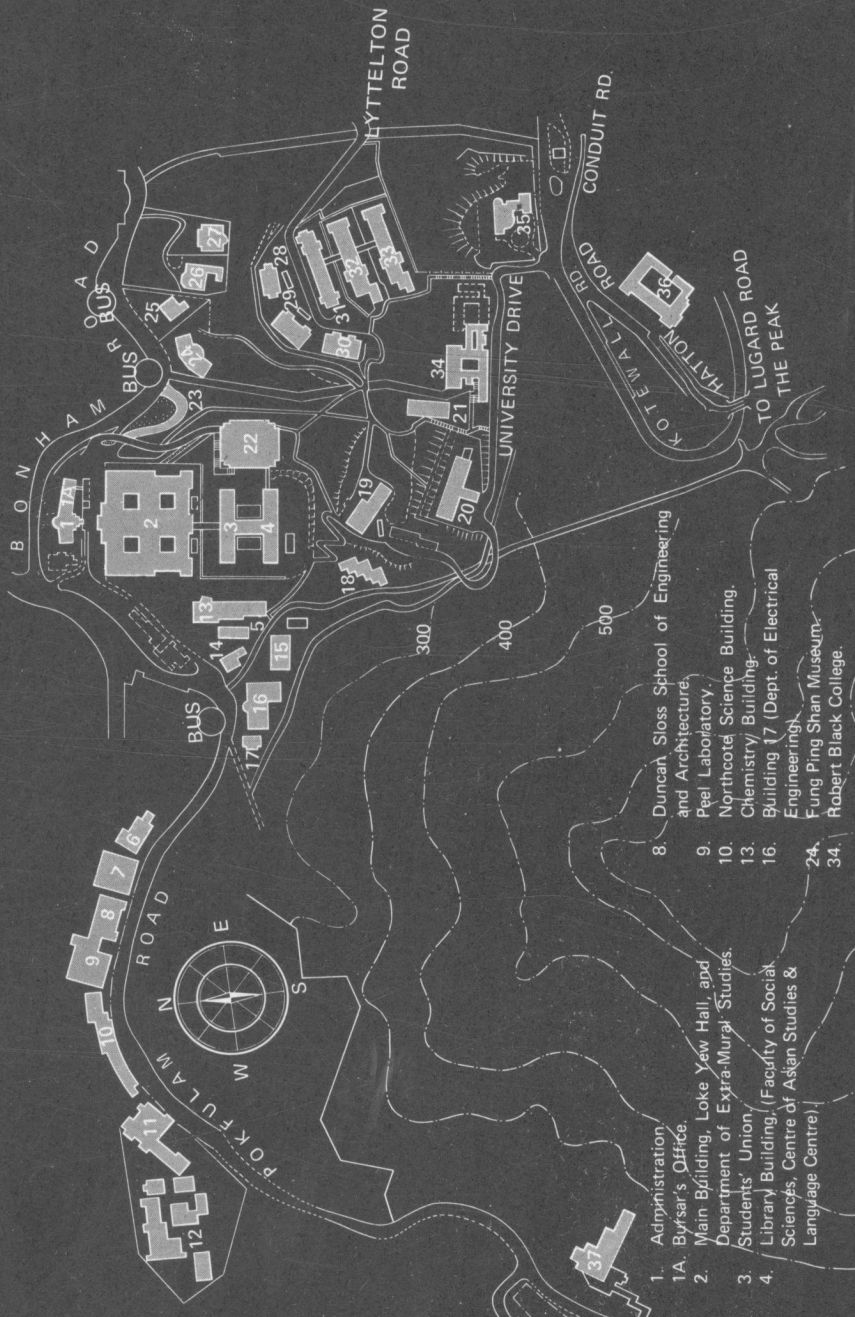

1. Administration
- 1A. Byrnes's Office
2. Main Building, Loke Yew Hall, and Department of Extra-Mural Studies
3. Students' Union
4. Library Building, (Faculty of Social Sciences, Centre of Asian Studies & Language Centre)

8. Duncan Sloss School of Engineering and Architecture
9. Peel Laboratory
10. Northcote Science Building
13. Chemistry Building
16. Building 7 (Dept. of Electrical Engineering)
24. Fung Ping Shan Museum
34. Robert Black College

UNIVERSITY OF HONG KONG GENERAL LAYOUT

Please see inside of rear cover for enlarged plan of Main Building (2) and location of rooms

University of Hong Kong



Extra Mural Studies



STAFF

Director

R.A. Williams, M.A.(Wales)

Senior Staff Tutor

K.N. Vaid, B.Sc.(Punjab), M.A.(Delhi),
Dip.S.W.P.(The Hague)

Assistant to the Director

Mrs. Priscilla Tso, B.A., Dip.Ed.(H.K.),
Dip.Ad.Ed.(Manc.) (*on leave*)

Staff Tutors

C.K. Leung, M.A.(H.K.)
Jon A. Prescott, B. Arch., M.C.D.(Liv.),
A.R.I.B.A., M.R.T.P.I.
D.J.H. Macintosh, M.A.(Cantab.),
P.G.C.E.(Lond.)
T.W. Casey, B.A.(Nottm.)
Keith Sayer, B.Sc.(Manc.)
N.P. Lee, B.A., Dip.Soc.St.(H.K.)

Secretary

Mrs. Yvonne Wong

PRIOR ENROLMENT IS ESSENTIAL

Failure to enrol prior to the opening of a particular course may mean the cancellation of that course. Prior enrolment is the only way the Department of Extra-Mural Studies has of judging the response to its courses. Your co-operation is therefore invited in sending your application forms to the Department as soon as possible.

GENERAL INFORMATION

1. There are normally no entry requirements except that applicants should be over 18 years of age. Occasionally to have the full benefit of a course applicants must possess certain defined qualifications. Applicants are therefore advised to read the description of a course carefully. Professional courses usually have clearly defined entry requirements.
2. The Director may at his discretion refuse to admit an applicant.
3. Unless otherwise arranged, no Extra-Mural lectures will be held:-
 - a) on any public holidays.
 - b) at a storm warning signal of No. 5 or above. (After the typhoon passes, if the No. 5 signal is lowered before 3 p.m., classes will take place as normal. If the signal is lowered after 3 p.m., classes will be cancelled that evening.)
 - c) during the following holiday period:-
February 14-20, 1972 inclusive (Lunar New Year)
4. Fees are not refundable once the course has commenced.
5. Certificates of Attendance are issued, on payment of 50 cents, to those who have attended not less than two-thirds of a course of at least 20 meetings in duration.
6. Closing date for enrolment: Unless otherwise stated, one week before the starting date of a course. Late enrolments may not be accepted. To ensure that a class can take place, the Department would appreciate early enrolment by applicants.
7. For enquiries, please ring either H-468161 Ext. 307 or 308, or H-456451, during office hours.
8. Complete the attached enrolment form and mail it to the Director, Department of Extra-Mural Studies, University of Hong Kong. Most certificate courses specify special forms to be filled in that are available on request from the Department.
9. You should send your application form together with the appropriate fee either in the form of a postal order, money order or crossed cheque made out in favour of the UNIVERSITY OF HONG KONG.
10. You will be notified if you are not admitted because of over-subscription or other reasons. **THE DEPARTMENT WILL NOT NOTIFY SUCCESSFUL APPLICANTS WHO ARE EXPECTED TO ATTEND THE FIRST MEETING OF THE CLASS AT THE PLACE AND TIME ADVERTISED.**
11. All candidates for certificate courses will be notified about the decision on their applications. Only those candidates who are notified as 'admitted' are entitled to attend classes.
12. Applicants can also enrol in person at the following places:-
 - i) Department of Extra-Mural Studies, University of Hong Kong, University Main Building, Ground Floor, Pokfulam Road, Hong Kong (during office hours) (Buses Nos. 3, 4, 7, 23). Tel: H-468161 Ext. 307 or 308.
 - ii) Extra-Mural Town Centre, Universal House, 11th Floor, 151 Des Voeux Road Central, Hong Kong. Tel: H-456451 (entrance from Gilman Street). (From 10 a.m. to 8 p.m.)

HOW TO ENROL

入學須知

1. 除特別規定學歷之課程外，其他課程，祇需要年齡超過十八歲者，不限資格，均可申請入學。學員應詳閱課程簡介。
2. 學員被取錄與否概由校外課程部主任審核報名申請書後決定之。
3. 除特殊情形外，本部在下列期間不授課：
甲：本港公眾假期。
乙：本港天文臺懸掛五號或以上風球之後。（颱風過後，如五號風球在下午三時以前除下，則照常上課，如風球在下午三時以後除下，則當晚課程全部取消。）
丙：農曆新年假期：一九七二年二月十四日至二十日。
4. 課程開始後，學費通常不能退回。
5. 凡課程在廿講以上而學員上課次數超過三分之二者，得向本部繳費五角後申請發給聽講證書。
6. 截止報名日期：除特定情形之外，每一課程開課前一星期即截止報名，過期報名或不受理。
7. 本部詢問電話：H-468161（內線307或308）或H-456451。
8. 填妥附於本手冊之報名申請書後，逕寄香港大學校外課程部主任收。證書課程通常需用之特種申請書，可向本部另行索取。
9. 繳費可用支票，銀行本票，或郵政滙票，以「香港大學」名義抬頭，並加橫線，連同申請書逕寄港大校外課程部主任收。如用現金則請至本部繳納。
10. 如申請人已獲取錄，本部不再通知，可依時上課。如未獲取錄，則另函通知。
11. 申請修讀證書課程者被錄取與否則由本部個別通知，祇有被錄取者得出席上課。
12. 申請人亦可親往下列地點報名：
甲、薄扶林道香港大學校外課程部（辦公時間內）。
電話：H-468161（內線307或308）。
乙：香港德輔道中一百五十一號環球大廈十二樓（入口在機利文街）校外課程部市區中心。
電話：H-456451（上午十時正至下午八時正）

報名手續

SPECIAL TRAINING COURSES

The Department welcomes enquiries and requests from business organizations, government, voluntary bodies or private institutions for specially designed training courses whether pre-service, in-service or up-grading, to meet their specific training needs.

Contents



	Page
PUBLIC LECTURE	8
ARCHITECTURE & PLANNING	9
ART & DESIGN	11
Appreciation	
Education	
Practical Painting; Printmaking; Drawing	
Advanced Level Fine Art	
Interior Design	
ECONOMICS, COMMENCE, MANAGEMENT	17
EXECUTIVE DEVELOPMENT	21
EDUCATION	23
ENGLISH STUDIES	25
English for Teachers	
English Speech	
Spoken English	
English in Translation	
Critical Appreciation	
GEOGRAPHY & GEOLOGY	29
HISTORY	32
LAW	33
MATHEMATICS	34
ORIENTAL LANGUAGES	35
PHILOSOPHY, PSYCHOLOGY & SOCIAL WORK	37
SCIENCE	39

盆景藝術

由永隆銀行董事長伍宜孫先生主講
一九七二年三月十七日星期五下午七時半至九時。
大會堂劇院

本講座為伍宜孫先生第二次演講盆景藝術。用粵語講述，全部英語翻譯，並放映幻燈片詳細說明。不設門券，歡迎各界蒞聽。
題材如下：

- (一) 盆栽古樹今昔風格。
- (二) 盆栽古樹型格分析。
- (三) 坭石技巧。
- (四) 寄植(造林)各法。
- (五) 盆景佈局。

ARTISTIC POT PLANTS (BONSAI)

Mr. Wu Yee-sun, Chairman, Wing Lung Bank Ltd.

7.30-9.00 p.m., Friday, March 17, 1972
City Hall Theatre

This second lecture will emphasize the artistic aspects of bonsai and will be amply illustrated with slides. It will be delivered in Cantonese with English translation. The following topics will be discussed:

- (a) origin and evolution;
- (b) analysis of shapes and forms;
- (c) techniques of rock-clinging plants;
- (d) different styles of grouping;
- (e) arrangement of landscapes.

Architecture & Planning

Staff Tutor in Charge: Jon A. Prescott, B. Arch., M.C.D. (Liv.), A.R.I.B.A., M.R.T.P.I.
Telephone No.: H-456430

Architecture

The programme of Seminars for Architectural Studies and short courses in Building Technology is presented in joint sponsorship with the Hong Kong Society of Architects, an allied Society of the Royal Institute of British Architects, London.

THE QUALITY OF MAN'S ENVIRONMENT *The seminars will be held at fortnightly intervals commencing on Wednesdays, 6.15 p.m., for approximately 1½ hours, starting March 22, 1972. Extra-Mural Town Centre 10 meetings. Fee: \$100*

200

A series of seminars to be held round the theme and report of a Smithsonian Institution Symposium. There will be a principal speaker to introduce the aspect chosen for each seminar and, where applicable, and practical, film and other visual material will be introduced. Sessions are planned as follows:

1. The Natural History of Urbanism. Values, Process and Form.
2. Architectural Form and Social Institutions.
3. The Sense of Place.
4. The Stewardship of the Earth.
5. Pastoral Ideals and City Troubles.
6. Why we want our Cities Ugly.
7. Human needs and inhuman cities.
8. Science and the City.
9. The Conservation of Cultural Property.
10. Man and His Environment. Adaptation and Interactions.

Participation will be by invitation but applications are welcome from others interested. Entry will be severely limited to ensure a size of gathering compatible with easy discussion.

Planning

201 **TOWN PLANNING IN HONG KONG** *Wednesdays, 6.00-7.00 p.m., starting January 19, 1972. Extra Mural Town Centre. 8 meetings.* *Fee: \$50*

Tutors: Chan Hung-Kwan M.A.(H.K.), M.T.C.P.(Syd.)
Lo Chai-wan M.A.(H.K.), M.Phil.(Lond.), M.R.T.P.I.
Pun Kwok-shing M.A.(H.K.), M.T.C.P.(Syd.), M.R.A.P.I.

Consideration will be given to various aspects of the practice of Town Planning in Hong Kong, including Planning Law, Government Structure, types of plans prepared. Development control and public participation in the planning process. Specific examples of planning schemes in Hong Kong will be discussed.

202 **THE SHAPE OF TOWNS** Jon A. Prescott, B.Arch.(Hons), M.C.D.(Liv.), A.R.I.B.A., M.R.T.P.I. *Tuesdays 2.30-4.00 p.m., starting March 21, 1972. Extra-Mural Town 5 meetings followed by discussion.* *Fee: \$35*

The physical Shape of Towns is the result of a whole range of different influences. Perhaps most important is however the society which generates the town, its attitudes and beliefs. After a brief categorisation of some different formal characteristics of traditional towns, these lectures will use local examples to illustrate the continuum of development found in our contemporary settlements. The history, present and future development of Hong Kong will be used to illustrate both particular and general ideas, and the significance of Hong Kong's achievements related to some of the ideas of the rest of the world.

Art & Design

Staff Tutor in Charge: Jon A. Prescott, B.Arch., M.C.D.(Liv.), A.R.I.B.A., M.R.T.P.I.
Telephone No.: H-456430

Appreciation

CHINESE CERAMICS – AN INTRODUCTORY SURVEY Michael Lau, B.A. 26
Dip.Ed.(HK), M.A., Ph.D.(Harv.), Curator of Fung Ping Shan Museum. *Tuesdays,*
6.00-7.00 p.m., starting February 22, 1972. Extra-Mural Town Centre. 10 meetings
plus 2 museum visits. Fee: \$70

A general survey of the development of Chinese ceramics to provide a framework for further study. The lectures will cover the whole range from painted pottery of the neolithic periods to Porcelain of the Ch'ing.

The lectures will be well illustrated and reference made to actual examples on show in the museum.

CIVILISATION – A PERSONAL VIEW Mondays, 8.00-10.00 p.m., starting February 28, 1972. Extra-Mural Town Centre. 7 meetings. 203
Fee: \$50

A series of 13 films written and narrated by Lord Clark and produced by B.B.C. Television.

Two films will be shown each week and each will be followed by a discussion of a panel of critics with knowledge of different aspects of the visual arts.

Discussion Panel drawn from Cesar A. Guillen-Nunez, Henry Steiner, Michael Griffith, Jon A. Prescott and others.

Enrolment is limited by the size of the 'theatre' to 40 persons.

Education

- 204 **SEMINAR IN EDUCATION FOR ART & DESIGN** *Wednesday, 7.45 p.m., starting January 19, 1972. Extra-Mural Town Centre. 1 meeting.* *Fee: \$10*

A seminar to discuss the general pattern and approach to Art & Design Education in relation to the demands of to-days society on the artist/designer. Those taking part received their education in various parts of the world and the common factors as well as the differences of approach should prove stimulating.

Speakers: John Nye/Australia
Michael Griffith/U.K.
Martha Lesser/U.S.A.
Penny Boys/U.K
Werner Hahn/Germany

- 205 **TEACHING ART IN SECONDARY SCHOOLS** Penny Boys, N.D.D.(St. Martins) A.T.D.(Leics) *Wednesdays, 7.45-9.15 p.m., starting January 26, 1972. Extra-Mural Town Centre. 15 meetings.* *Fee: \$140*

Education at Secondary School level in Art & Design subjects cannot but be considered important, and the increasing awareness of the need for post school training in this field has emphasised a situation where insufficient attention has been focussed in the past. This course will be a practical one aimed at the rationalisation of the art teachers' problems, frequently made the more difficult because classes are held in accommodation not designed specifically for the subject.

Practical Painting; Printmaking; Drawing

These are practical classes in the visual arts, with emphasis on imaginative painting or drawing, designed to encourage growth of individual creative powers. Work will be carried on in various media. Instruction is individual, classes being restricted in size and enrolment is open to students at different stages, beginners being particularly welcome. Materials required will be discussed at the initial meeting in each case, and students must provide all materials necessary or buy the same through the tutor. In classes where a model is used, there will be an additional modelling fee.

Each series will consist of 12 weeks in the Spring Term.

12 meetings either 9.30 a.m.-12.00 noon or 2.00-4.30 p.m. or evening as detailed.
Fee: \$100

All classes begin during the week commencing January 24, 1972.

Morning Sessions 9.30 a.m. - 12.00 noon

PAINTINGS IN OIL & RELATED MEDIA Martha Lesser, B.S.(N.Y.U.) *Tuesdays or Thursdays. Extra-Mural Town Centre.* 206

Aimed at beginners and intermediate level students. Emphasis will be on techniques and use of different materials.

GRAPHIC WORKSHOP Diane Hughes, Dip.A.D.(Camberwell) A.T.C.(Hornsey) and others as guest tutors. *Thursdays, Extra-Mural Town Centre.* 207

Silk Screen, Lithography, Etching and Wood Block techniques. Students are preferred who have basic drawing ability.

There will be an additional equipment charge of approximately \$30 payable at the Town Centre.

(Tear along this line)

INSTRUCTION IN PRACTICAL PAINTING/DRAWING/PRINTMAKING ETC.

In view of the constant demand for practical classes in Art & Design subjects, the department would value the return of the attached form by anyone who would like to attend classes but has not been able to because of the time for which the instruction has been scheduled, or the failure to provide the right subject matter.

I am interested in instruction in

- Basic Drawing
- Life Drawing
- Portraiture
- Water Colour Painting
- Painting in Oil/Acrylic
- Printmaking, Lithography, Etching, Screen Print and Wood Block
- Exploration of new media
- Three Dimensional Work (Fine Art)
- Design (state area of specific interest)
- Other areas not mentioned above:-

.....

.....

.....

.....

I can attend instruction on

	a.m.	p.m.	evening
Monday			
Tuesday			
Wednesday			
Thursday			
Friday			
Saturday			
Sunday			

I would welcome all day Sunday
or weekend instruction Yes
No

Please complete Details overleaf

Afternoon Sessions 2.00 - 4.30 p.m.

208 PAINTING IN OIL & ACRYLIC Joanna Campbell, D.A.(Edinburgh), *Tuesdays. Extra-Mural Town Centre.*

A continuation of a beginners class with special emphasis on individual development.

209 FUNDAMENTALS OF DRAWING Martha Lesser, B.S.(N.Y.U.), *Wednesdays. Extra-Mural Town Centre.*

Various media. Elements of line, form, tone, space and movement.

A minimum of 4 hours private work will be required for each class session.

A model will be used for a limited number of sessions for which there will be an additional charge of approximately \$25 payable at the Town Centre.

Name English Chinese

Address
(Home) Telephone

(Office)
. Telephone

Address to which further communication is to be sent. Home/Office

Previous experience in subjects requested. (State if working in Design field)
.
.
.

Qualifications if any in Art & Design.
.
.
.

PORTRAITURE IN VARIOUS MEDIA Diane Hughes, Dip.A.D.(Camberwell), A.T.C.(Hornsey). *Fridays, Extra-Mural Town Centre.* 210

Students of varying ability will be accepted and beginners are welcome.

A model will be used for which there will be an additional charge of approximately \$40 payable at the Town Centre.

Evening Sessions

PAINTING STUDIO Part II Kwong Yeu Ting, M.Sc.(Kansas), *Mondays, 6.00-8.00 p.m., Extra-Mural Town Centre.* 211

The continuation of an introductory course using oil and acrylic media through a series of developed exercises. Practical colour mixing, textures and surface will be discussed, alongside formal problems.

Advanced Level Fine Art

This Course specifically aims at students who have obtained the Certificate in Fundamentals of Art & Design and who wish to further develop their individual ability and interest, or who have had considerable experience in the chosen field.

Entry will be only after interview in the latter cases.

All classes begin during the week commencing January 24, 1972. 12 meetings.

Fee: \$100

GRAPHIC WORKSHOP Direction: John Nye, Dip.Art (Fine Art) R.M.I.T., T/T.T.C.(Vict.), and guest tutors. *Fridays, 6.30-9.00 p.m., Extra-Mural Town Centre.* 212

Facilities in Wood Block Printing, Screen Printing and Lithography or Etching.

There will be an additional materials and equipment charge of approximately \$30 payable at the Town Centre.

213 室內設計應用營做法概論

課程之主要目標在向執業室內設計及裝修工程的人士簡介營造法之概念。營造法式為其作業日常面對的問題，故應有明確的認識。室內設計者能夠了解其工作場所之樓宇結構與設備方式的原則，即不致造成損害原有建築物的錯誤。對樓宇設備各方面具有一般之知識，可以預測各專門工程的需要，預留應付的方法，避免工程上無謂的損失。

營造法之精微要點，為着意闡述之課題，使學者領悟優良構造之重要，能將其引用於室內裝修工程。

課程科目大略

建築營造法：建築基礎緒論，穩定性，重量分佈，複雜地盤處理，打樁。不智之擾動。承重牆及桁架之結構。牆壁種類，間牆。門窗構造，防水，防風，隔熱，隔聲處理。

樓梯構造，欄杆與安全。

屋頂工程，防水，日晒影嚮與隔熱設備。防水封蓋之重要。擾動與不良好重修之後果。

隔熱與隔聲工程原則，重修應注意要點。

結構工程大綱：工程原則及計算方式淺說。割拆之危險，過重及誤解“安全因數”之危險。何種情況須邀請工程師協助。

建築法規與防火條例：法定規律意義解釋。故意違例之危險。須邀請建築師協助之情況。

樓宇設備：潔具，渠管，水電，電梯，空氣調節等設備原則概論。

面層裝飾：油漆，灰水，樓面，牆紙，批擋，灰漿。材料種類與質地。造法。

本課程專為現役室內設計及裝修工程執業成員而設。用粵語講述，必要時引用英文名詞，但皆輔以詳細解釋，及讀音指導。

聽講者須作繪畫精良之筆記，及研究圖。

AN INTRODUCTION TO BUILDING TECHNOLOGY FOR INTERIOR DESIGNERS Chang Juncan A.A. Dip.(London), Architect. *Wednesdays, 7.15-8.45 p.m., starting January 19, 1972. 30 meetings.* *Fee: \$240*

(This course will be conducted in Cantonese)

Economics Commerce Management

Staff Tutor in Charge: T.W. Casey, B.A.(Nottm.)
Telephone No.: H-468161 Ext. 305

INTERNATIONAL MONETARY RELATIONS K.Chan, B.A.(H.K.), M.B.A. 49
(Queen's) Demonstrator in Economics, University of Hong Kong. *Fridays, 6.15-7.15 p.m., starting February 25, 1972. University Main Building. 8 meetings. Fee: \$35*

This course provides the basic analytical framework for understanding international monetary relations and problems. Topics include: balance of payments and its adjustment, currency devaluation and revaluation, reserve currencies and Euro-Dollar, gold problem, S.D.R. and other proposals for international monetary reforms.

Some previous knowledge of Economics desirable, though not essential.

投 資 學 (一)

214

本課程共十四講，對有關投資的研究與處理之問題，有詳盡之討論。內容包括投資的目的，證券，互惠投資基金，參考資料之取得，購售手續，證券市場，有價證券之分析，時效問題，經紀人關係等。

主 講 人：陳暢餘碩士（工商管理學）。

講授語言：粵語。

地 點：香港大學校外課程部市區中心。

時 間：一九七二年二月廿三日起每星期三下午六時至七時。

學 費：五十五元。

INVESTMENT I Francis C.Y. Chan, M.B.A. *Wednesdays, 6.00-7.00 p.m., starting February 23, 1972. Extra Mural Town Centre. 14 meetings. Fee: \$55*

215 BASIC ECONOMICS Laurence Pang, B.A.(H.K.) *Tuesdays, 5.30-7.00 p.m., starting February 8, 1972. Extra Mural Town Centre. 16 meetings. Fee: \$80*

A series of lectures and discussions on basic economics designed for beginners. The course will cover both descriptions of economic institutions and tools of elementary economic analysis. Examples, as far as possible, will be taken from the Hong Kong economy.

60 投資學 (二)

這科高級投資課程將包括證券的本身基本情形及股市趨勢分析。損益表以及資產負債表將會作深入的研究及分析。並特別注重各種工業股之市價與盈利比率。個別行業之基本分析，買賣以及劃線圖表之走勢及技術性之研究。(共十四講)。

主 講 人：胡平碩士。

講授語言：粵語。

地 點：香港大學校外課程部市區中心。

時 間：一九七二年三月七日起每星期二下午五時四十五分至六時四十五分。

學 費：六十元。

INVESTMENT II Peter P.Woo, B.S., Ch.E.(Columbia), M.B.A. *Tuesdays, 5.45-6.45 p.m., starting March 7, 1972. Extra Mural Town Centre. 14 meetings. Fee: \$60*

66 銀行實務 (二)

本課程共十二講，繼續講述銀行實務，特別注意進出口押匯及跟单商業信用証。關於香港新銀行條例，中央銀行及其他重要問題，亦加以研討。

主 講 人：陳天元先生。

講授語言：粵語(輔以英語)。

地 點：香港大學校外課程部市區中心。

時 間：一九七二年二月廿一日起每星期一下午七時至八時。

學 費：四十五元。

PRACTICAL BANKING II T.Y. Chan, B.A.(Lingnan). *Mondays, 7.00-8.00 p.m., starting February 21, 1972. Extra Mural Town Centre. 12 meetings. Fee: \$45*

PRACTICAL ASPECTS OF TAXATION J.K.S. Thong, F.A.C.C.A., F.C.I.S. *Mondays, 8.15-9.15 p.m., starting February 21, 1972. Extra Mural Town Centre. 15 meetings.* 216
Fee: \$60

The principles of assessing incomes liable to Taxation and the problems arising. The various functions of the Department of the Inland Revenue including the duties and powers of the Assessors, the Board of Inland Revenue and the Board of Review. The practical problems of submitting tax returns, expenses claims and appealing against tax assessments. It is suitable for business executives as well as those wanting a basic knowledge of how taxes on corporations and individuals are levied and paid.

PUBLIC RELATIONS N.G.R. Chesney. *Mondays, 5.45-6.45 p.m., starting February 21, 1972. Extra Mural Town Centre. 10 meetings.* 217
Fee: \$40

The necessity for good public relations is becoming increasingly evident in Hong Kong and is vital to the well-being of the community. Its role as an aid to modern marketing, as a means of conveying ideas and policies, and in assisting companies and institutions in developing sound reputations and relationships will be discussed. There will be some examination of the techniques of public relations and the qualifications that help to make a successful public relations officer or consultant. No previous knowledge of the subject is assumed.

工廠建設與科學管理

69

本課程共十三講。內容包括如何籌建工廠及在工廠建成後進行科學管理等問題。建設工廠主要是爲了發展工業，繁榮經濟，而科學管理則主要是爲了提高生產水平。

工廠建設方面主要研究工業發展之重要性，建廠計劃書之編製，主要產品種類之選擇，生產規模之確定，廠區廠址之選擇，廠址總體設計與車間（工場）之組織設計等。工廠管理方面則主要探討組織管理之理論及以生產爲中心之生產管理，勞動組織，材料供應，產品銷售，技術管理（包括新產品發展管理，產品質量管理，設備維修管理）及安全生產等。

本課程適合工業投資者及實際從事工廠管理之人仕與其他有興趣人仕選讀。

主 講 人：王文敦碩士。

講授語言：粵語（輔以英語）。

地 點：香港大學校外課程部市區中心。

時 間：一九七二年二月廿四日起每星期四下午八時十五分至九時四十五分。

學 費：七十元。

FACTORY OPERATION AND SCIENTIFIC MANAGEMENT Wong Man-tun, B.A.(Lingnan), M.A. (Nanking). *Thursdays, 8.15-9.45 p.m., starting February 24, 1972. Extra Mural Town Centre. 13 meetings.* *Fee: \$70*

70

MANAGERIAL SKILLS FOR THE TECHNICAL MAN K.N. Vaid, B Sc. (Punjab), M.A. (Delhi), Dip.S.W.P. (The Hague). *Thursdays, 6.00-8.30 p.m., starting January 6, 1972. Extra-Mural Town Centre. 10 meetings.* *Fee: \$250*

Scores of technical men get promoted to managerial positions because they have proved to be good technicians. Soon, they find that qualities that made them outstanding employees do not necessarily make them successful managers. They must pick up new skills, whether in the school of hard knocks, or in a formal training programme. This course is geared to the needs of technical men newly promoted to managerial positions.

This course is designed to meet the needs of those who have had several years of experience as technical executives but are new to managerial jobs. Engineers, accountants, marketing experts, and others who have been recently promoted or are soon to be promoted to senior positions as departmental heads are likely to benefit from this programme.

Lectures and case studies based on Hong Kong experience will cover the following topics:

- The enterprise – its policy and management style.
- Handling subordinates and use of authority.
- How to become a good team member and a good subordinate.
- Management of plans, projects and programmes.
- Introducing change.
- Techniques of achieving results.

Enrolment is limited to 20 persons, and candidates sponsored by their firms will be preferred.

See also:

Commercial Geography for the Associateship Examination of the Institute of Chartered Shipbrokers. (Page 31)

Executive Development

Staff Tutor in Charge: K.N. Vaid, B.Sc. (Punjab), M.A. (Delhi), Dip. S.W.P. (The Hague)
Telephone No.: H-468161 Ext. 301

Certificate in Social and Legal Studies

This course is concerned with the scientific study of social deviance and crime in Hong Kong. It considers the socio-economic environment in the Colony with special reference to the causation of deviance behaviour amongst various groups in the community; analyses various kinds of criminal behaviour in the light of existing theories, and finally goes on to spell out the legal framework relevant to the detection and prevention of crime in the Colony.

229

The course is particularly suitable to those who are professionally concerned with detection, prevention and treatment of crime, and others working in the fields of juvenile delinquency, social pathology, after-care and rehabilitation of offenders, etc. Members of the police force and prison services, probation officers, after-care workers and personnel of agencies concerned with the rehabilitation of drug addicts, gamblers, alcoholics, prostitutes, young offenders and the like will benefit from the course.

The course is spread over 25 weeks, three meetings and 6 teaching hours per week. Lectures include subject specialists drawn from University and outside.

Candidates who are successful in the examination will be awarded a Certificate.

Fee: \$600 per participant.
No. of Students: 30

The course will start on Tuesday, February 22, 1972.

The course scheduled for 1972 has been fully subscribed. Enquiries are welcome from agencies/Government departments who wish to reserve seats for 1973.

230 SEMINAR ON WORKERS' EDUCATION AND TRADE UNION LEADERSHIP TRAINING.
3 evening meetings, March, 1972.

The Seminar has the following objectives:

- To review the existing programmes of workers' education and leadership training undertaken in the Colony by different agencies.
- To assess the nature and level of training needs in this area.
- To discuss the methods of training, mechanisms of inter-agency co-operation, and the role of Government and international bodies therein.

The participation in the seminar will be by invitation. Persons engaged/interested in the subject are requested to contact the Department for invitations.

There are no fees for the Seminar. Each participant will contribute \$15 towards tea and other incidental expenses.

SPECIAL TRAINING COURSES

The Department welcomes enquiries and requests from business organizations, government, voluntary bodies or private institutions for specially designed training courses whether pre-service, in-service or up-grading, to meet their specific training needs.

Education

Staff Tutor in Charge: C.K. Leung, M.A. (H.K.)
Telephone No.: H-468161 Ext. 309

低能（智力）兒童的管教

109

本課程之目的為使社會人士，家長，及直接為低能兒童工作之教師，護士，社會工作者，或訓導員，對低能兒童有基本之了解，並在管教方面，有正確之認識。

課程內容包括緒論，社會對低能兒童之照顧，低能兒童之成因及本質（包括醫療方面），低能兒童之需要，及其在家庭，學校，社會及職業方面之適應問題，教育問題，職業訓練等等。

講授方面以粵語為主。由本港對低能兒童有研究及有直接工作經驗之專業人士擔任。方式包括專題講座，電影，討論及參觀低能兒童訓練機構等。

主 講 人：香港晨崗學校校長鄧福泉先生及本港對低能兒童有研究及直接工作經驗之專業人士擔任。

講授語言：粵語。

地 點：香港大學校本部。

時 間：一九七二年二月廿四日起每星期四下午六時十五分至七時四十五分。共十四講。

學 費：八十元。

（本課程由香港低能兒童及青年教育協進會贊助）

UNDERSTANDING AND HELPING THE MENTALLY HANDICAPPED CHILD. — AN APPRECIATION OF THE PROBLEM F.C. Tang, B.A.(Toronto), B.Ed. (New Brunswick), Principal, Lions Morninghill School, and a panel of speakers. *Thursdays, 6.15-7.45 p.m., starting February 24, 1972. University Main Building. 14 meetings. Fee: \$80*

(The course is sponsored by the Hong Kong Association for Mentally Handicapped Children and Young Persons Ltd.)

78

PSYCHOLOGY UNDERLYING CAREERS WORK AND SCHOOL COUNSELLING
N.K. Henderson, Ph.D.(London), B.A., M.Ed.(Melb), A.B.Ps.S., F.C.P., Professor of
Education, University of Hong Kong. *Thursdays, 6.15-7.45 p.m., starting February*
24, 1972. Room 122, University Main Building. 12 meetings. Fee: \$65

A refresher course suited to the needs of both those already engaged in careers masters work and educational guidance, and those who want an introduction to the theory and practice of school counselling. It will particularly assist those wishing to specialize at some stage in this new and developing area of education in Hong Kong. The course will also help those studying educational psychology. Topics will cover the psychological principles underlying modern guidance techniques, interviewing, vocational advisory services, the study of some guidance-type tests and psychological problem cases, etc. Full notes, reading lists, copies of vocational inventories and the like will be issued free to participants, and there will be film sessions, psychological case-studies, etc. and time will be allowed for discussion.

See also:

English Teaching Techniques (Page 25)

Modern Mathematics in Primary School (Page 34)

學習與智能之發展 (Learning and Intellectual Development) (Page 38)

PRIOR ENROLMENT IS ESSENTIAL

Failure to enrol prior to the opening of a particular course may mean the cancellation of that course. Prior enrolment is the only way the Department of Extra-Mural Studies has of judging the response to its courses. Your co-operation is therefore invited in sending your application forms to the Department as soon as possible.

English Studies

Staff Tutor in Charge: D.J.H. Macintosh, M.A.(Cantab.), P.G.C.E.(Lond.)
Telephone No.: H-456443

CHANGES IN THE ENGLISH LANGUAGE Michael Smithies, M.A. (Oxon), M.A.(Calif.), L-es-L(Paris), F.R.A.S., Assistant Registrar, University of Hong Kong. *Thursdays, 5.45-7.15 p.m., starting January 27, 1972. Extra-Mural Towns Centre. 8 meetings.* *Fee: \$45*

224

English is a living language which has undergone many changes and been influenced by other languages over the years. This course will be an investigation into the formation of new words and changes in the form, meaning, spelling and pronunciation of English from the fourteenth century to the present day. Attention will be paid to outside influences on the language, particularly from Asia and the Americas.

This course is intended for all those who are interested in the development of English and in order to obtain the maximum benefit from it, applicants should have a fairly good command of English.

English for Teachers

ENGLISH TEACHING TECHNIQUES William Cheng, B.A., M.A. (Ed.) (H.K.), Dip. in App. Ling. (Edin.). *Tuesday, 6.30-8.00 p.m., starting January 25, 1972. University Main Building. 12 meetings.* *Fee: \$80.*

223

Planned to assist secondary school teachers of English, this course will deal with up-to-date techniques applicable to the most important areas of the curriculum. The basic principles of language teaching will be discussed in detail with particular relation to the following topics:

1. The teaching of vocabulary;
2. The teaching of reading;
3. The teaching of English grammar;
4. The teaching of oral and written English;
5. The presentation of set books and the teaching of poetry;
6. Language testing.

The tutor is Principal, New Territories Heung Yee Kuk Yuen Long District Secondary School and a former lecturer in English at Sir Robert Black College of Education.

Fee Refund: Teachers of English at Advanced or Certificate of Education levels who wish to have their fees refunded by the Director of Education are required to complete an application form (obtainable from the Department of Extra-Mural Studies, University of Hong Kong) which must be returned directly to the Director of Education before the commencement of the course. This applies to all teachers whether in Government or private schools.

English Speech

- 222 PRONUNCIATION CORRECTION AND SPEECH TRAINING** Raymond Huang, M.A. (Leeds), I.P.A.Cert. Phon., P.G.C.E., L.R.A.M., L.T.C.L. *Mondays, 7.00-8.30 p.m., starting February 21, 1972. City Hall Committee Room South, 16 meetings.*
Fee: \$100

The tuition in this course will be aimed at eradicating common errors in English Speech, articulation and intonation and rhythm. The basic causes of the difficulties that are encountered by Cantonese-speaking students will be analysed, methods of correction suggested and graded and aural-oral exercises provided.

The tutor is Principal, Queen's College and formerly Principal, Sir Robert Black College of Education. He is also author of a number of books on Phonetics, including "English Pronunciation Explained with Diagrams" and "English Speech Training".

-
- 228 PUBLIC SPEAKING** S.W.O'C Rainbird, B.A.(Oxon), M.B.I.M., Assistant Colonial Secretary, and others. *Wednesdays, 6.15-7.45 p.m., starting January 26, 1972. Government Training Division, Lee Gardens, 2nd floor, Hysan Avenue, Causeway Bay. 12 meetings.*
Fee: \$80.

This course is designed to help people who speak in public to be more effective. Publicity staff of voluntary agencies and other organisations who may not have received formal training in their work will find the course particularly useful.

The course consists of a minimum of lectures on the subjects listed below, but is essentially practical in nature. Students can expect to become more effective by giving speeches themselves and by learning how to evaluate others.

The lecture content of the course will be based on the following:-

1. How to Prepare the Speech.
2. Techniques of Delivery.
3. Reading Speeches.
4. Impromptu Speaking.
5. Introducing & Thanking Speakers.
6. Visual Aids for Public Speakers.
7. How to be Interviewed.
8. The occasion and the Speech.
9. Evaluating Speeches.

Note: *This course will not provide basic tuition in oral English, and so applicants for it should have a good command of English. Enrolment is limited to twenty students and may be by selection of those best qualified to benefit from the course.*

Spoken English

In all these courses modern language laboratory teaching methods will be used to give the maximum opportunity for speaking English. The tuition in Spoken English I will be aimed at improving the students' pronunciation and intonation and giving them plenty of opportunity in asking and answering oral questions. In Spoken English II the emphasis will be on conversational English in different situations.

The tutors for all these courses will be drawn from a panel of university graduates.

In order to allow the tutors to pay the maximum amount of attention to individual students, enrolment is limited to 15 persons in each course.

All the courses will be held in the language laboratory of the Language Centre at Hong Kong University.

SPOKEN ENGLISH I. 10 meetings. Fee: \$45

Thursdays, 6.30-8.00 p.m., starting January 27, 1972.

219

SPOKEN ENGLISH II. 10 meetings. Fee: \$45

Wednesdays, 6.30-8.00 p.m., starting January 26, 1972.

221

Note: As these courses are concerned with different aspects of spoken English, students may attend Spoken English I and II concurrently if they wish to do so.

English in Translation

The importance of English/Chinese and Chinese/English translation is daily becoming more evident. The Department of Extra-Mural Studies therefore offers courses in this skill at two levels. The first of these is intended for those who have had little or no experience of it and the second for those who have completed the first course satisfactorily or who have had a certain amount of experience. In both courses the teaching will be directly related to the translation needs of Hong Kong, and in the second course considerable attention will be paid to the translation of technical and legal terms.

On completion of the first course students may sit a test which, if they pass satisfactorily, will qualify them to proceed to the second course. Those who complete both courses consecutively may apply for a Certificate of Attendance.

All applicants are expected to have a good knowledge of English and Cantonese and/or Mandarin. Applicants holding the Department's Certificates in the Use of English and/or in the Use of English for Commercial Practice are ideally qualified for these courses.

The tutor, who has had considerable experience of teaching translation methods in Hong Kong, Singapore and Taiwan, was previously employed by international agencies of the United Nations as a translator.

225 **ENGLISH IN TRANSLATION I** Jao Yu Wei, M.A.(Edin.) *Wednesdays, 6.30-8.00 p.m., starting February 23, 1972. University Main Building. 16 meetings. Fee: \$100*

226 **ENGLISH IN TRANSLATION II** Jao Yu Wei, M.A.(Edin.) *Fridays, 6.30-8.00 p.m., starting February 25, 1972. University Main Building. 16 meetings. Fee: \$100*

Critical Appreciation

126 **THE MODERN NOVEL** P.H. Collin, M.A.(Oxon), Lecturer in French, Department of European Language and Literature, University of Hong Kong. *Wednesdays, 6.30-7.30 p.m., starting January 26, 1972. University Main Building. 10 meetings. Fee: \$45.*

What forms can the modern novel take? In what ways does the modern novel reflect the society which produced it? In this course novels from five countries written since 1920 are considered against their cultural backgrounds. Each novel will be the subject of one lecture by the tutor who will then lead a discussion on it during the following meeting.

The novels to be studied are:

Kafka	:	The Trial
Faulkner	:	The Sound and the Fury
Camus	:	The Outsider
Lampedusa	:	The Leopard
Abe	:	The Woman in the Dunes

These books are obtainable from the Hong Kong Book Centre, Des Voeux Road Central.

Note: Students are urged to read 'The Trial' before the first meeting.

227 **READING AND DISCUSSION** J.E. Clemens, B.A.(Melbourne), *Fridays, 6.30-8.00 p.m., starting January 28, 1972. University Main Building. 10 meetings. Fee: \$50.*

A further course, principally intended for those who have completed the 'Use of English II' course or who are following it this year, but also suitable for those others who have a fair command of English. Various types of non-literary English, including newspaper reports, editorials and articles will be examined critically and discussed in class.

Textbook: W.E.K. Anderson: *The Written Word* (O.U.P.). This book may be obtained from the Hong Kong Book Centre, Des Voeux Road, Central.

Geography & Geology

*Staff Tutor in Charge: C.K. Leung, M.A.(H.K.)
Telephone No.: H-468161 Ext. 309*

地理學方法入門

136

量化和電腦化的新方法在地理學上的應用，在今日的英、美、和歐陸學者中已經十分普遍。

本課程為一實驗性初階課程。一方面介紹若干較新的地理學方法，另一方面希望通過中文的傳導媒介，使這些方法得以普及。內容包括抽樣；典型的建立（models construction）；擴散研究（diffusion studies）；模擬（simulation）；體系和體系分析（systems and systems analysis）；遠距感應（remote sensing）；資料系統（information system）等等。

主 講 人：趙子能博士，羅楚鵬博士，及梁志强碩士。

講授語言：粵語及英語。

地 點：香港大學校外課程市區中心。

時 間：一九七二年二月二十二日起每星期二下午五時四十五分至六時四十五分。共八講。

學 費：三十元。

INTRODUCTION TO GEOGRAPHIC METHODOLOGY T.N. Chiu, M.A.(H.K.), Ph.D.(Lond.); C.P. Lo, M.A.(H.K.), Ph.D.(Glasgow); and C.K. Leung, M.A.(H.K.).
Tuesdays, 5.45-6.45 p.m., starting February 22, 1972. Extra-Mural Town Centre. 8 meetings. Fee: \$30

137

RESOURCES AND MAN C.K. Leung, M.A.(H.K.) & Luke S.K. Wong, M.A.(H.K.).
Tuesdays, 7.00-8.15 p.m., starting February 22, 1972. Extra-Mural Town Centre. 8 meetings. *Fee: \$30*

Oriented towards secondary school geography teachers teaching regional and human geography, this course is an exploration into the relation between human societies and their geographical environment. Stress will be put on the use of land and natural resources with global cognizance and in an ecological context. Major topics to be discussed will include: the utilization and management of resources; the relationship between population, resources, and technology; and contemporary ideas of the balance and imbalance of the man-environment system.

Some prior knowledge of world physical and human geography will be preferred.

Enrolment is limited to 25 persons for good interaction.

138

THEMES OF CHANGE IN MONSOON ASIA S.F. Richards, B.Sc.(Econ.) (London).
Lecturer in Geography, H.K.U. *Tuesdays, 6.15-7.45 p.m., University Main Building. 8 meetings on Jan. 25, Feb. 1, 8, 22, 29, Apr. 4, 11 & 18.* *Fee: \$45*

Growing global concern with development and the developing countries directs fresh attention to Monsoon Asia, where the Green Revolution provides new hope in agriculture, where Japan's success in industrialization and trade sharply contrasts potential but undeveloped wealth in Indonesia and poverty in India, and where the great nations are fostering regional co-operation while also involved in intra-national wars.

The course will be of particular interest to those teaching about these areas and those who follow contemporary problems in Monsoon Asia.

139

GEOGRAPHY IN THE FIELD (HUMAN) K.Y. Wong, B.A.(H.K.), Department of Geography & Geology, H.K.U. *Wednesdays, 6.15-7.15 p.m., starting January 26, 1972. University Main Building. 12 meetings including 6 Saturday/Sunday field trips.* *Fee: \$60*

This is an introductory course to human geography in the field, with some emphasis on the urban geography in Hong Kong. The lectures will include urban land use zoning theories, urban development and urban renewal in Hong Kong, industrial land use and the development of industrial townships, and problems of mixed land uses in urban and rural areas. Every lecture is followed by a field trip to substantiate the materials and information presented.

Potential students are warned that the field trips may involve a considerable amount of walking. The course fee does not include expenses incurred on the excursions.

Enrolment is limited to 25 persons.

礦物和地質

231

本課程專為愛好礦物和地質者而設，旨在使非專業或業餘人士對普通礦物和岩石的特性和用途有所認識，從而瞭解沉積過程，岩漿活動，地質構造，化石，和本港地質史。野外觀察則注重於礦物，岩石及化石標本之採集，和香港地形概況。

主 講 人：林健枝先生。

講授語言：粵語（輔以英語）。

地 點：香港大學校本部。

時 間：一九七二年二月二十四日起每星期四下午七時至八時。共八講，另加二至四次野外觀察。

學 費：四十五元。

MINERALS AND GEOLOGY K.C. Lam, B.A.(H.K.). Department of Geography & Geology, H.K.U. *Thursdays, 7.00-8.00 p.m., starting February 24, 1972. University Main Building. 8 meetings plus 2-4 field trips.* Fee: \$45

COMMERCIAL GEOGRAPHY K.Y. Wong, B.A.(H.K.) Department of Geography & Geology, H.K.U. *Wednesdays, 7.30-8.30 p.m., starting January 26, 1972. University Main Building. 8 meetings.* Fee: \$40

232

This course is offered in conjunction with the local Institute of Chartered Shipbrokers and is an extension to the **Shipping and Shipbroking Practice Course** offered by the Department in the autumn of 1971.

Largely based on the syllabus of the Associateship Examination, it will outline some physical and economic elements of general world commercial geography such as climatic influences, physical settings, natural products and industrial regions. Discussion topics include the world's seaborne trade, routes and distances, reasons for location and development of ports, and canals and navigable waterways.

Further readings will be detailed to the candidates at the end of each meeting.

Enrolment is limited to 25 persons. Priority will be given to intending candidates for the Associateship Examination of the Institute of Chartered Shipbrokers.

History

Staff Tutor in Charge: C.K. Leung, M.A.(H.K.)
Telephone No.: H-468161 Ext. 309

233 **MAO TSE-TUNG AND COMMUNISM 1921-1971** Lee Ngok, M.A., Dip.Ed.(H.K.),
Ph.D.(London), Lecturer in History, University of Hong Kong. *Wednesdays,*
6.15-7.45 p.m., starting January 26, 1972. University Main Building. 10 meetings.
Fee: \$50

A study on (1) Mao's biography; (2) Political and military development of the Chinese Communist movement since 1921.

Lectures will be given to trace the growth of Mao's political power and the formulation of his thought. Emphasis will also be on the political and ideological difference between Mao and Liu Shao-Chi in the post-1949 period. The Cultural Revolution will be studied from the political and military perspectives.

Some prior knowledge of Chinese politics will be an advantage.

Enrolment is limited to 25 persons.

PRIOR ENROLMENT IS ESSENTIAL

Failure to enrol prior to the opening of a particular course may mean the cancellation of that course. Prior enrolment is the only way the Department of Extra-Mural Studies has of judging the response to its courses. Your co-operation is therefore invited in sending your application forms to the Department as soon as possible.

Staff Tutor in Charge: C.K. Leung, M.A.(H.K.)
Telephone No.: H-468161 Ext. 309

市民與法律

234

本課程共十五講，每週一次，旨在引起市民對法律之興趣與認識，主要內容包括：

- (一) 本港法庭的司法程序，律師和法庭的種類。
- (二) 政府的法律援助。
- (三) 刑事法和民事法的分別，民事不法行為的訴訟，誹謗和疏忽等。
- (四) 道路交通法例。
- (五) 勞工和僱傭法例。
- (六) 合約的種類，成立和實行。

主 講 人：韓譚春先生。

講授語言：粵語。

地 點：香港大學校外課程部市區中心。

時 間：一九七二年一月廿八日起每星期五下午五時卅分至七時。

學 費：五十五元。

LAW AND THE CITIZEN Michael Hon, Barrister-at-Law (Middle Temple). *Fridays, 5.30-7.00 p.m., starting January 28, 1972. Extra-Mural Town Centre. 15 meetings.*
Fee: \$55

Mathematics

Staff Tutor in Charge: Keith Sayer, B.Sc.(Manc.)
Telephone No.: H-468161 Ext. 451

- 155 **MODERN MATHEMATICS IN PRIMARY SCHOOLS** Robert L. Brown. *Wednesdays, 6.15-7.15 p.m., starting January 26, 1972. Wah Yan College, Waterloo Road, Kowloon, 12 meetings.* *Fee: \$50*

The course aims to introduce parents and interested laymen to some of the basic principles of modern mathematics and to examine recent changes in the approach to the teaching of mathematics in primary schools. It will deal with topics selected from the syllabus of primary schools. Students will be asked to participate in practical work.

Enrolment will be limited to 25 persons.

PRIOR ENROLMENT IS ESSENTIAL

Failure to enrol prior to the opening of a particular course may mean the cancellation of that course. Prior enrolment is the only way the Department of Extra-Mural Studies has of judging the response to its courses. Your co-operation is therefore invited in sending your application forms to the Department as soon as possible.

Oriental Languages

Staff Tutor in Charge: C.K. Leung, M.A.(H.K.)
Telephone No.: H-468161 Ext. 309

The Oriental Languages Programme is taught in English unless otherwise stated. A good standard of English is essential for admission.

Laboratory assistance for Mandarin I and II, Kuo Yu, and Cantonese I and II is available at Caritas House, Caine Road, at \$25 for 12 hours of study. Students of these courses will be given one hour of conducted laboratory exercise during course time to familiarise themselves with the system.

國語

235

本課程共四十一講（包括錄音室練習一小時），每週二講，每講一小時。內容有國語注音符號（包括注音字母及大陸現行標準拼音法），國、粵語發音，語法與詞句之差異，國語會話及文章選讀等。

主 講 人：白選之先生。

講授語言：粵語。

地 點：香港大學校本部。

時 間：一九七二年二月八日起每星期二及星期五下午七時三十分至八時三十分。共四十一講。

學 費：一百五十元。

KUO YU (MANDARIN) Pai Hsuan-chih, B.A.(Lingnan). *Thursdays & Fridays, 7.30-8.30 p.m., starting February 8, 1972. University Main Building. 40 meetings plus 1 lab. session. Fee: \$150*

MANDARIN I

The main emphasis of this course will be on spoken Mandarin and ample opportunity will be given for practising pronunciation and short sentence construction orally.

Textbook: *Beginning Chinese* by John De Francis, Yale University Press.

Shih Wan-chu, B.A.(Peking Norma University), Instructor in Mandarin, University of Hong Kong. *Mondays & Thursdays, 7.30-8.30 p.m., starting February 28, 1972. University Main Building. 50 meetings plus 1 lab. session. Fee: \$250*

171

MANDARIN II

This course is intended for students who have completed Mandarin I or those who can prove that they have done a reasonable amount of Mandarin in the past. Some characters and idiomatic expressions will be introduced and students will be taught to read simple passages.

Textbook: *Beginning Chinese* by John De Francis, Yale University Press.

- 172 Shih Wan-chu, B.A.(Peking Normal University), Instructor in Mandarin, University of Hong Kong. *Mondays & Thursdays, 6.15-7.15 p.m., starting May 1, 1972. University Main Building. 30 meetings plus 1 lab. session. Fee: \$180*
-

CANTONESE I

The main emphasis of this course will be on spoken Cantonese and ample opportunity will be given for practising pronunciation and short sentence construction orally. Specially prepared and graded texts will be supplied.

- 174 C.S. Hung, B.A.(Chinan), Instructor in Chinese, University of Hong Kong. *Tuesdays & Fridays, 6.15-7.15 p.m., starting February 8, 1972. University Main Building. 40 meetings plus 1 lab. session. Fee: \$200*
- 175 Francis Sham, B.A.(Sun Yat-sen). Instructor in Cantonese. *Mondays & Thursdays, 2.00-3.00 p.m., starting March 27, 1972. Extra-Mural Town Centre. 40 meetings plus 1 lab. session. Fee: \$200*
-

CANTONESE II

This course, intended for students who have completed Cantonese I or who can prove that they have had equivalent training in Cantonese, will concentrate on oral expressions and idioms. Specially prepared and graded texts will be supplied.

- 176 Paul Fong, B.A., Dip.Ed.(H.K.). *Mondays & Thursdays, 6.15-7.15 p.m., starting March 27, 1972. University Main Building. 40 meetings plus 1 lab. session. Fee: \$220*
-

CANTONESE III

Students who have attended Cantonese I and II will find this course extremely useful. The syllabus covers more advanced knowledge of grammar, useful colloquial expressions, idioms and proverbs in daily use in Hong Kong. In addition, some stories relevant to Chinese history and culture will be introduced.

- 177 Paul Fong, B.A., Dip.Ed.(H.K.). *Wednesdays, 7.30-8.30 p.m., starting January 26, 1972. University Main Building. 30 meetings. Fee: \$160*
-

Philosophy, Psychology & Social Work

Staff Tutor in Charge: Miss N.P. Lee, B.A., Dip. in Soc.St.(H.K.)
Telephone No.: H-468161 Ext. 308

Philosophy

思想、語言、與繆誤

236

本課程共十講，目的在培養批判的思考能力，題材深入淺出，大多採自日常生活及報章雜誌，務求學理切合實際，使學員因此增強分析及推理能力，判別是非對錯，達於正確的思想，適合高中及大專程度之人士。

主 講 人：羅業宏先生，黃展驥先生。

講授語言：粵語。

地 點：香港大學校外課程部市區中心。

時 間：由一九七二年二月三日起每星期四下午七時三十分至九時，共十講。

學 費：四十元。

FALLACIES IN LANGUAGE AND THOUGHT Law Yip-wang, M.A. (Hawaii & U.C.L.A.) and Wong Chih-kee, B.A.(National Taiwan) *Thursdays, 7.30-9.00 p.m., starting February 3, 1972. Extra-Mural Town Centre. 10 meetings. Fee: \$40*

Psychology

CONTEMPORARY ISSUES IN CHILD PSYCHOLOGY Brian M. Young, B.Sc. (Edin.), Assistant lecturer in Psychology, University of Hong Kong. *Thursdays, 7.00-8.00 p.m., starting January 13, 1972. City Hall Committee Room South. 8 meetings. Fee: \$30*

237

This is an appreciation course intended for all those interested in child psychology. Some of the issues dealt with will be: maternal deprivation and its effect on the child, 'critical periods' in child development, the thought of the child as assessed by Piaget and others, children's language. It is hoped that this course will be of value to those who deal with children professionally, e.g. nursery workers, teachers, and social workers, as well as of interest to the public at large.

238 學習與智能之發展

本課程共十講，主旨在介紹及討論有關學習與如何加強學習能力之若干理論及其應用，並就心理學上對「動物之能否思想」的比較性研究所得資料，加以闡述發展人類智能之主要論著。

主 講 人：伍錫洪先生。

講授語言：粵語。

地 點：香港大學校外課程部市區中心。

時 間：一九七二年一月二十日起每星期四下午七時至八時。

學 費：三十五元。

LEARNING AND INTELLECTUAL DEVELOPMENT Ng Sik-hung, B.Soc.Sc.(H.K.).
Thursdays, 7.00-8.00 p.m., starting January 20, 1972. Extra-Mural Town Centre. 10 meetings. Fee: \$35

Social Work

239 在感化、康復、老人、兒童院內推行社會工作

本課程共十講，旨在協助與上列各類福利機構有關之工作人員，如何更有效地推行社會工作，除講授外，並有討論。限收廿五人，在上述有關機構工作者得優先取錄。

主 講 人：吳夢珍女士。

講授語言：粵語（輔以英語）。

地 點：大會堂南會議室。

時 間：一九七二年四月十二日起每星期三下午七時至八時。

學 費：四十元。

SOCIAL WORK IN RESIDENTIAL INSTITUTIONS. Miss Agnes Ng, M.S.W. (British Columbia). *Wednesdays, 7.00-8.00 p.m., starting April 12, 1972. City Hall Committee Room South. 10 meetings. Fee: \$40*

Science

Staff Tutor in Charge: Keith Sayer, B.Sc. (Manchester)
Telephone No.: H-468161 Ext. 451

Certificate in Digital Computer Programming

Mondays & Thursdays, 7.00-8.15 p.m., 8.30-9.45 p.m., starting January 17, 1972. Peel Laboratory, Department of Mechanical Engineering, University of Hong Kong, Pokfulam Road, Hong Kong. **240**
Fee: \$450 (including examination fee)

Tuesdays & Fridays, 7.00-8.15 p.m., 8.30-9.45 p.m., starting January 18, 1972. Extra-Mural Town Centre, Universal House, 11/fl., 151 Des Voeux Road Central, Hong Kong. **241**
Fee: \$450 (including examination fee)

These courses are designed for people with no previous knowledge of computer programming. They aim to provide a thorough grounding in programming techniques and to train independent computer programmers.

Tutors: C.L. Chow, B.Sc.(Waseda), D.I.C., Ph.D.(London),
Lecturer in Mechanical Engineering,
University of Hong Kong.
P.W. Poon, B.A.(H.K.), M.Sc.(London),
Assignment Officer, Government Organizational Surveys Unit.

No. of Meetings: 40, twice weekly. Each period will consist of 2½ hours.

Minimum Entry Qualifications: Applicants should have 5 subjects including English and Mathematics at Grade E or above in the Hong Kong Certificate of Education, or equivalent.

An examination will be conducted at the end of the course. The award of an extra-mural certificate is conditional on passing the written examination, completing the set projects and attending at least 75% of the lectures.

Students are expected to do a certain amount of work in their own time and are advised not to take any other public examination in the same year.

Syllabus

1. Introduction: computer concepts & hardware; number & character systems; problem definition & description; computer language development.
2. Fortran-IV: elements of language; arithmetic control, input/output & allocation; subscripting & flow-charts; subroutines & flow-charts; compatibility; overwriting; efficiency; examples.
3. Cobol: elements of Full Cobol; descriptions & procedures; data division; environment & identification division; additional procedure division; object program efficiency; examples.
4. More Advanced Studies: basic arithmetic & decision operations; symbolic coding & program; assembly & execution; address modification & index register; direct & indirect addressing; subroutines.
5. Projects: the organization, writing & running of projects on digital computers form an integral part of the course.

Ample computer time will be provided for problem exercises & projects.

Closing date for applications: January, 6, 1972

Applicants must enclose photostat copies of appropriate certificates along with their application forms.

242 天文愛好者與望遠鏡

本課程目的在使天文愛好者認識天文望遠鏡的種類和應用，並介紹製造簡單天文望遠鏡的方法。全部共十二講，每講用幻燈片輔助解釋，內容包括：望遠鏡演進史。望遠鏡的種類與原理。天文愛好者的望遠鏡。光學部份的設計與製造。望遠鏡的裝配，使用與保養。天文愛好者的觀測室等。

主 講 人：廖慶齊先生。

講授語言：粵語。

地 點：香港大學校外課程部市區中心。

時 間：一九七二年一月廿八日起每星期五下午七時至八時卅分。

學 費：五十五元。

THE AMATEUR ASTRONOMER AND HIS TELESCOPE Liu Hing Chai, B.A.(H.K.)
Fridays, 7.00-8.30 p.m., starting January 28, 1972. Extra-Mural Town Centre. 12 meetings. *Fee: \$55*

預早報名之重要

及早報名乃是使本司得知各界對該課程反應之唯一途徑。如不及早報名則往往引致各課程延期或取消。故有志修讀本課程者，請速向本司報名。

PRIOR ENROLMENT IS ESSENTIAL

Failure to enrol prior to the opening of a particular course, may mean the cancellation of that course. Prior enrolment is the only way the Department of Extra Mural Studies has of judging the response to its courses. Your cooperation is therefore invited in sending your application forms to the Department as soon as possible.

香港大學校外課程部

申請書填寫後附學費支票
香港大學校外課程部主任

繳費可用支票或現金，如用支票請填上「香港大學」名義抬頭，并加橫線，註明本司。

除非課程臨時取消或改期，請依照公佈日期上課，本部不另通知。如報名申請未被接受，學費將是還，但課程開始後，學費通常不能退還。

UNIVERSITY OF HONG KONG DEPARTMENT OF EXTRA-MURAL STUDIES

THE WHOLE OF THIS FORM TOGETHER WITH THE APPROPRIATE FEE SHOULD BE SENT TO THE DIRECTOR OF EXTRA MURAL STUDIES THE UNIVERSITY OF HONG KONG

PAYMENT MAY BE MADE IN CASH OR BY CHEQUE AT THE UNIVERSITY OR BY POST. CHEQUES SHOULD BE CROSSED AND MADE PAYABLE TO UNIVERSITY OF HONG KONG.

THE ISSUE OF AN ENROLMENT APPLICATION ACKNOWLEDGMENT DOES NOT OF ITSELF CONSTITUTE ACCEPTANCE OF THE APPLICATION. BUT IF YOU DO NOT HEAR OTHERWISE BEFORE A COURSE STARTS YOU MAY ASSUME YOU HAVE BEEN ACCEPTED. IF FOR ANY REASON YOU ARE NOT ACCEPTED YOUR FEE WILL BE RETURNED BUT OTHERWISE FEES ARE NOT NORMALLY REFUNDABLE.

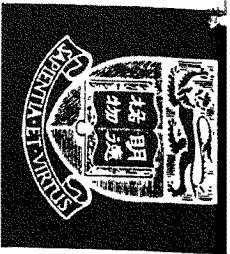

Extra Mural Studies 校外課程

Application for Enrolment 報名申請書

每一申請書祇適用於一種課程

PLEASE USE A SEPARATE FORM FOR EACH COURSE

A

課程號碼
課程名稱

COURSE NO. _____ FEE ENCLOSED \$ _____
COURSE NAME _____ 附學費
CASH/CHEQUE NO. _____

姓名

NAME in full (Mr./Mrs./Miss)

English _____
英文 (in block letters—surname first)
Chinese _____
中文

曾修讀之其他
校外課程

What Extra Mural Courses have you previously attended?

姓名

NAME IN FULL (Mr./Mrs./Miss)

English _____
英文 (in block letters—surname first)
Chinese _____
中文

通訊處

ADDRESS for correspondence _____

辦事處地址

OFFICE ADDRESS _____

電話

TELEPHONE NOS.

Home 住宅 _____

Office 辦事處 _____

B

國籍

NATIONALITY _____

Age 年齡 (please tick age group)

職業

OCCUPATION _____

學歷

SCHOOL and highest class reached _____

18-19
20-29
30-39
40-49
50-59
over 60

大專學歷

HIGHER and/or FURTHER EDUCATION _____

DATE 日期 _____

SIGNATURE 簽字 _____

For Office Use →

DATE

REG. NO.

COURSE NO.

AMOUNT

X

For Office Use →

DATE

REG. NO.

COURSE NO.

AMOUNT

X

Please complete this part if you require an acknowledgment of your application.

Note: This application acknowledgment is not complete without validation by official printing machine entry of the details at X above at the University or Town Centre office of the Department of Extra-Mural Studies, University of Hong Kong.

NAME
FULL POSTAL ADDRESS

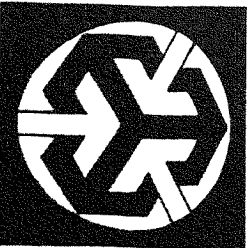

Fees are not refundable once the course has commenced.

Please see overleaf.

GROUND PLAN OF UNIVERSITY OF HONG KONG MAIN BUILDING

showing location of rooms used for extra mural courses. Please see inside of front cover for University general layout.

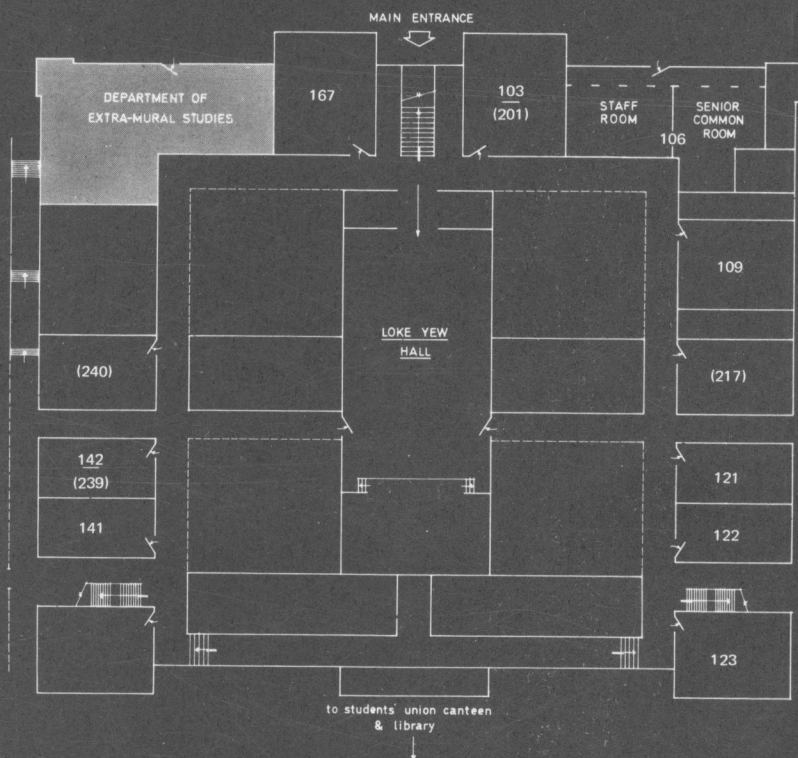

SPRING SUPPLEMENT

1971-1972



香港大學校外課程手冊

一九七一至一九七二年度春季

Extra Mural Studies

University of Hong Kong