

香港大學校外課程手冊

一九七六年春季

SPRING PROSPECTUS
1976



Extra Mural Studies

University of Hong Kong

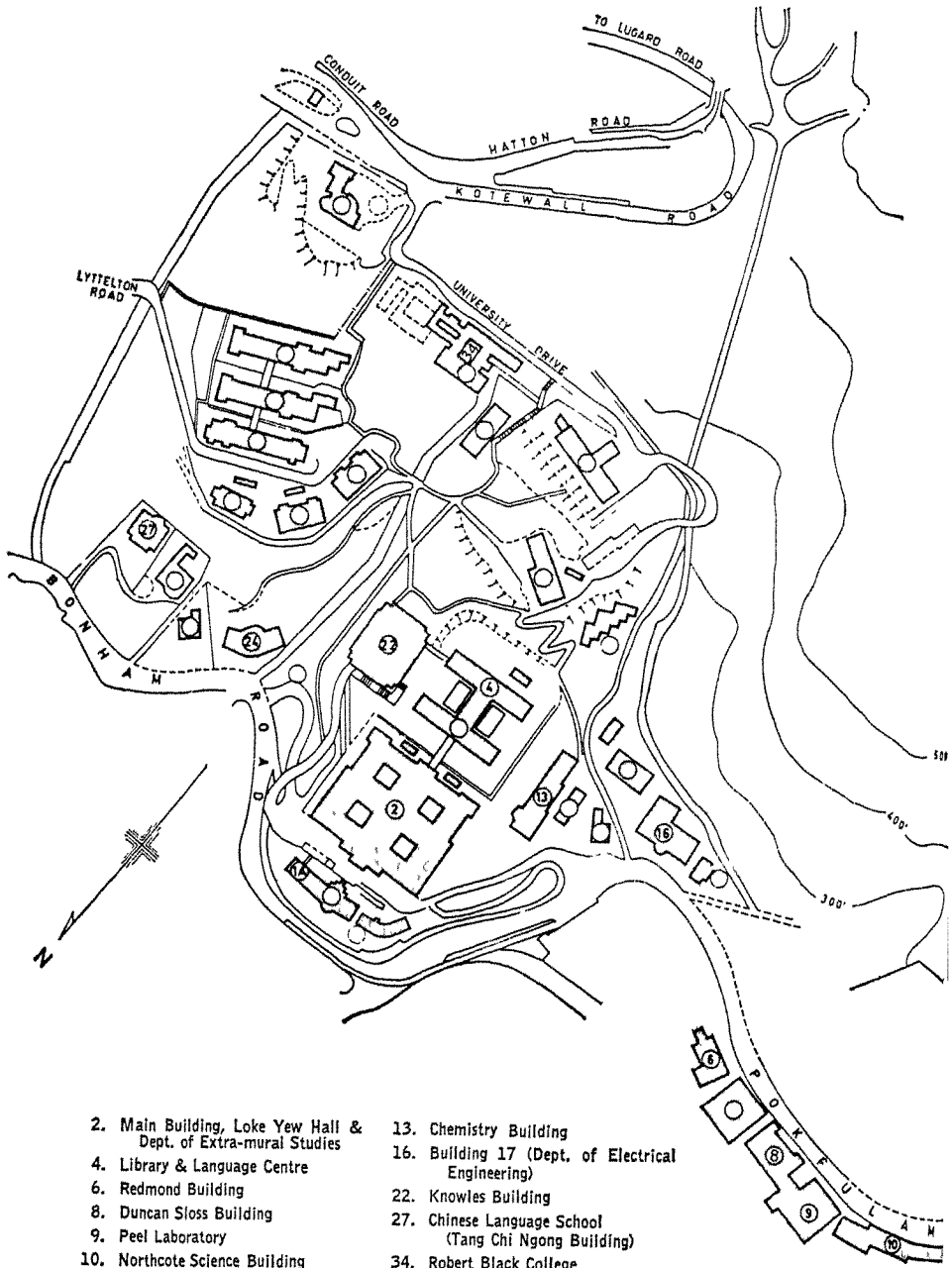

- | | |
|----------------------------------------------------------------|-------------------------------------------------------|
| 2. Main Building, Loke Yew Hall & Dept. of Extra-mural Studies | 13. Chemistry Building |
| 4. Library & Language Centre | 16. Building 17 (Dept. of Electrical Engineering) |
| 6. Redmond Building | 22. Knowles Building |
| 8. Duncan Sloss Building | 27. Chinese Language School (Tang Chi Ngong Building) |
| 9. Peel Laboratory | 34. Robert Black College |
| 10. Northcote Science Building | |

UNIVERSITY OF HONG KONG GENERAL LAYOUT
 Please see inside of rear cover for enlarged plan of Main Building (2) and location of rooms



Extra Mural Studies

University of Hong Kong

DIRECTOR

R. A. Williams, *M.A. (Wales)*

SENIOR STAFF TUTORS

Duncan Macintosh, *M.A. (Cantab.), P.G.C.E. (Lond.), F.R.S.A.*
S. G. Redding, *M.A. (Cantab.), Ph.D. (Manc.)*

ASSISTANT TO THE DIRECTOR

Mrs. Priscilla Tso, *B.A., Dip.Ed. (H.K.), Dip.Ad.Ed. (Manc.)*

STAFF TUTORS

J. P. Bensly, *M.A. (Oxford), M.A. (Reading)*
Susan Cameron, *B.A. (Leicester), Dip.I.A. (Bradford)*
T. W. Casey, *B.A. (Nott.), M.B.I.M.*
D. R. Kemp, *M.Sc., Ph.D., Dip. Microbiol. (London)*
Miss N. P. Lee, *B.A., Dip.Soc. St. (H.K.)*
Martha Lesser, *B.S. (N.Y.U.)*
Wilson W. S. Ng, *M.Sc., Dip. Applied Microbiol. (Strath)*
H. K. Wong, *B.A. (H.K.), M.A. (Brunel), Dip.Soc.St. (H.K.)*
O. H. H. Wong, *M.A. (H.K.), Ph.D. (Cantab.)*

STUDIO ASSISTANT

Christine A. Thery, *B.A. (Winchester)*

SECRETARY

Mrs. Yvonne Wong

SPECIAL COURSES

The Department welcomes enquiries and requests from business organizations, government, voluntary bodies or private institutions for specially designed courses to meet their specific education needs.

PRIOR ENROLMENT IS ESSENTIAL

Failure to enrol prior to the opening of a particular course may mean the cancellation of that course. Prior enrolment is the only way the Department of Extra-Mural Studies has of judging the response to its courses. Your co-operation is therefore invited in sending your application forms to the Department as soon as possible.

GENERAL INFORMATION

1. There are normally no entry requirements except that applicants should be over 18 years of age. Occasionally to have the full benefit of a course applicants must possess certain defined qualifications. Applicants are therefore advised to read the description of a course carefully. Professional courses usually have clearly defined entry requirements.
2. The Director may at his discretion refuse to admit an applicant.
3. Unless otherwise arranged, no Extra-Mural lectures will be held:
 - (a) on any public holidays.
 - (b) at a storm warning signal of No. 8 or above. (After the typhoon passes, if the No. 8 signal is lowered before 3 p.m., classes will take place as normal. If the signal is lowered after 3 p.m., classes will be cancelled that evening.)
4. Fees are not refundable once the course has commenced.
5. Certificates of Attendance are issued, on payment of 50 cents, to those who have attended not less than two-thirds of a course of at least 20 meetings in duration.
6. Closing date for enrolment: one week before the starting date of a course. Late enrolments may not be accepted.
7. For enquiries, please ring either 5-468161 Ext. 307 or 308, or 5-450021 (3 lines), during office hours.

HOW TO ENROL

8. Complete the attached enrolment form and mail it to the Director, Department of Extra-Mural Studies, University of Hong Kong. Forms are also available on request. To ensure that a class can take place, the Department would appreciate early enrolment by applicants.
9. You should send your application form together with the appropriate fee either in the form of a postal order, money order or crossed cheque made out in favour of the UNIVERSITY OF HONG KONG.
10. You will be notified if you are not admitted because of over-subscription or other reasons. **THE DEPARTMENT WILL NOT NOTIFY SUCCESSFUL APPLICANTS WHO ARE EXPECTED TO ATTEND THE FIRST MEETING OF THE CLASS AT THE PLACE AND TIME ADVERTISED.**
11. Applicants can also enrol in person at the following places:
 - (i) Department of Extra-Mural Studies, University of Hong Kong, University Main Building, Ground Floor, Pokfulam Road, Hong Kong (during office hours) (Buses Nos. 3, 3A, 4, 7, 71, 23, 103). Tel: 5-468161 Ext. 307 or 308.
 - (ii) Extra-Mural Town Centre, Universal House, 11th Floor, 151 Des Voeux Road Central, Hong Kong, Tel: 5-450021 (3 lines) (entrance from Gilman Street). (From 9 a.m. to 6. p.m.)

入 學 須 知

1. 除特別規定學歷之課程外，祇需要年齡超過十八歲者，不限資格，均可申請入學。學員應詳閱課程簡介。
2. 學員被取錄與否，概由校外課程部主任審核報名申請書後決定之。
3. 除特殊情形外，本部在下列期間不授課：
甲：本港公眾假期。
乙：本港天文臺懸掛八號或以上風球之後。（颱風過後，如八號風球在下午三時以前除下，則照常上課，如風球在下午三時以後除下，則當晚課程全部取消。）
4. 課程開始後，學費通常不能退回。
5. 凡課程在廿講以上而學員上課次數超過三分之二者，得向本部繳費五角後申請發給聽講證書。
6. 學員應於開課一星期前報名，過期報名可能不被接受。又任何課程額滿後，即隨時截止報名，故學員應儘早報名。
7. 本部詢問電話：5-468161（內線307或308）
或5-450021（3線）

報 名 手 續

8. 填妥附於本手冊之報名申請書後，逕寄香港大學校外課程部主任收。申請書可隨時向本部索取。
9. 繳費可用支票，銀行本票，或郵政滙票，以「香港大學」名義抬頭，並加橫線，連同申請書逕寄香港大學校外課程部主任收。如用現金則請至本部繳納。
10. 如申請人已獲取錄，本部不再通知，可依時上課。如未獲取錄，則另函通知。
11. 申請人亦可親往下列地點報名：
甲、香港大學校外課程部。
薄扶林道香港大學正座地下（辦公時間內）。
（下列各線巴士均經本部：3, 3A, 4, 7, 71, 23, 103）。
電話：5-468161（內線307或308）。
乙、校外課程部市區中心。
香港德輔道中一百五十一號環球大廈十二樓（入口在機利文街）。（上午九時至下午六時）。
電話：5-450021（3線）。

CONTENTS

	Page
ART & DESIGN - - - - -	7
Practical Drawing, Painting, and Printmaking, Graphic Design	
Art Appreciation	
BUSINESS STUDIES - - - - -	16
ECONOMICS & STATISTICS - - - - -	19
MANAGEMENT STUDIES - - - - -	21
EDUCATION - - - - -	25
ENGLISH STUDIES - - - - -	27
Return to English, English for Teachers, English for Appreciation	
EUROPEAN LANGUAGES - - - - -	31
GEOGRAPHY & GEOLOGY - - - - -	32
HISTORY - - - - -	35
JOURNALISM & COMMUNICATION - - - - -	37
LAW - - - - -	39
MUSIC - - - - -	41
ORIENTAL LANGUAGES - - - - -	44
Mandarin, Cantonese, Japanese	
ORIENTAL STUDIES - - - - -	53
Chinese Literature, Art, Philosophy, Japanese Studies	
PHILOSOPHY & PSYCHOLOGY - - - - -	58
POLITICAL SCIENCE - - - - -	62
SCIENCE - - - - -	64
SOCIAL WORK & SOCIOLOGY - - - - -	67
HOUSING MANAGEMENT - - - - -	71

Art & Design

Staff Tutor : Martha Lesser, Telephone 5-450021

Courses in Art & Design and related areas are open to students of all levels of development unless otherwise stated.

CERTIFICATE SUBJECTS: Year I, Term II, and Year II, Term II

A limited number of places in certificate classes will be available to non-certificate students. These classes are listed below, Course Nos. 226 to 227, and 228 to 234. Please note that most of the practical courses require a minimum of four hours additional outside work. Applications for these should be sent to the *Extra-Mural Town Centre* only. In the event of over-subscription an interview may be required.

226. Introduction to Three-Dimensional Design. Fay Ming-gi, M.F.A., (University of California). *Mondays, 8.00 p.m.-10.00 p.m., starting February 16, 1976. Extra-Mural Town Centre. 14 meetings. Fee: \$140*

We live in a three-dimensional world, yet we often are not aware of the types of three-dimensional space and the effects these have upon us. Through the use of simple materials such as wire, cardboard, string, wood and found objects, students will explore three-dimensional design from the linear to the solid. In addition to studio work, there will be discussions on the work of modern sculptors.

227. Woodcut and Relief Printmaking. Diane Jones-Parry, Dip.A.D. (Camberwell), A.T.C. (Hornsey). *Wednesdays, 8.00 p.m.-10.00 p.m., starting February 18, 1976. Extra-Mural Town Centre. 14 meetings. Fee: \$140 plus \$30 materials fee*

The relief print is one of the most ancient forms of printmaking, and wood the most traditional material. Carving a line or shape demands gestures that are both satisfying and intrinsic, and are quite unlike holding a brush or pen. An exciting aspect of contemporary relief printmaking is the use of new and varied materials such as plastics, cardboard, and "found" objects. Students will explore both traditional and contemporary relief printmaking, and will develop and produce prints in both black and white, and colour.

Students will be expected to provide most drawing and cutting materials. An additional charge of \$30 will be collected at the first meeting to cover the cost of inks and sundries.

228. Photography: An Introduction. Andrew Mitchell. *Wednesdays OR Fridays, 6.30 p.m.-8.30 p.m., starting February 18 and 20, 1976, respectively. Extra-Mural Town Centre. 14 meetings.*

Fee: \$140 plus \$25 materials fee

The basic studio and darkroom techniques of black and white, and colour photography will be discussed. Theories of photography, both aesthetic and philosophic, will also be explored. Students will be encouraged to experiment in the media, and class critiques will be held on the results.

Enrolment is limited to 15 persons.

229. Photography: An Intermediate Course. Dinshaw Balsara, *Thursdays, 7.00-9.00 p.m., starting February 19, 1976. Extra-Mural Town Centre. 14 meetings.*

Fee: \$180 plus \$20 materials fee

A course in black and white and colour photography for those already familiar with the basic technical aspects of photography and photographic equipment. The emphasis will be on 'seeing' and 'shooting'. There will be approximately five class field trips to a variety of sites on Saturday or Sunday afternoons, and class critiques will be held on the results of these, as well as of independent field trips. In addition there will be lectures and discussions on the work of well-known photographers.

Enrolment is limited to 15 persons.

230. Photography as an Aid to the Graphic Designer. Philip Tse. *Tuesdays, 7.00 p.m.-9.00 p.m., starting February 17, 1976. Extra-Mural Town Centre. 14 meetings.*

Fee: \$140 plus \$25 materials fee

Photography, because it achieves optical effects never known before, plays a vital part today in a designer's work, and techniques of photography open up completely new vistas. Tuition will include studio and darkroom procedure within the designer's capabilities, detailing some of the many effects which can be achieved by simple manipulation at the developing and printing stages. Colour work, distortion of straightforward images, special screening effects, photo layout, photo mural, graphic art photography, photo dyeing techniques and advertising photography will be discussed. Emphasis will be on practical darkroom work, and there will be a visit to a printer's darkroom.

This intermediate level course is intended for those with a basic knowledge of darkroom procedure.

Enrolment is limited to 15 persons.

231. History of Chinese Art Part II: Three-Dimensional Art Forms.
S. C. Chuang, B.A. (Taiwan University), M.A. (Princeton University).
*Tuesdays, 8.15 p.m.-9.45 p.m., starting February 17, 1976. Extra-Mural
Town Centre. 14 meetings.* **Fee: \$140**

The three-dimensional Chinese art forms of bronze, pottery and porcelain will be dealt with in this part of the course. Emphasis will be on sculpture and in order to properly introduce this subject it will be sub-divided into two sections. The first section will deal in chronological order with indigenous Chinese sculptures from the point of view of styles and the various media in which they are produced such as clay, stone, bronze, wood, dry-lacquer, and ivory. The second section will deal with the style and iconography of Buddhist sculpture, both Indian prototypes and the Chinese modifications. In the area of Chinese bronze, ritual vessels, bronze weapons, and mirrors will be considered. Chinese pottery and porcelain will be discussed and will cover Painted and Black potteries of the Neolithic period up to 19th century export ware.

Lectures will be illustrated by many slides and brief outline sheets will be provided.

232. Advanced Painting Workshop. Martha Lesser, B.S. (N.Y.U.).
*Mondays, 6.00 p.m.-8.00 p.m., starting February 16, 1976. Extra-Mural
Town Centre. 14 meetings.* **Fee: \$140**

When one has developed the basic skills of applying paint to canvas or paper, it is time to explore more deeply the aesthetic and philosophic concepts of painting; to carry the "craft and techniques" of painting towards "art and communication". Through critiques and discussions as well as practical work, emphasis will be placed on learning to discover and communicate one's own concepts in painting. Technical exploration of media will be encouraged, and students will be free to use a wide variety of materials.

Enrolment will be limited to 17 persons, and in the event of over-subscription an interview may be required. The studio will be available for work until 9.30 p.m. though formal instruction will end at 8.00 p.m.

233. Experimental Fabric Printing. Diane Jones-Parry, Dip.A.D. (Camberwell), A.T.C. (Hornsey). *Tuesdays, 6.30 p.m.–8.30 p.m., starting February 17, 1976. Pokfulam Studio, 144 Pokfulam Road. 14 meetings.*
Fee: \$140 plus \$30 materials fee

Fabric printing and dyeing forms a part of our lives, as it is used to decorate our clothing and our surroundings. The methods of decorating cloth are varied. This course offers students the opportunity to experiment and explore the potentials of pattern and printmaking on fabric. The student cannot hope to compete with the perfectly matched patterns of the machine and modern technology, but he can aim to become a “handicrafts person”, using traditional methods of wood and lino-block, stencil and silkscreen, and batik and tiedye.

Students will be expected to provide most of their own materials. An additional charge of \$30 per person, to cover the cost of dyes and inks, will be payable at the first class meeting.

Enrolment is limited to 15 persons.

**234. 書道基本
(Basic Chinese Calligraphy)**

主 講 人：翟仕堯。

講授語言：粵語。

地 點：香港大學校外課程部市區中心。

時 間：一九七六年二月十九日起逢星期四；下午八時至十時。（共十四講）。

學 費：一百四十元。

目 的：旨在通過對中國歷代書體沿革，諸家風格與筆墨理法之了解，使學員對中國傳統書道重新獲得明確辨認；藉以觸發現代書道之探索與發展。除堂課練習外，學員並須以課外時間做習作。

PRACTICAL DRAWING, PAINTING, AND PRINTMAKING

These are practical studio classes in the Visual Arts with emphasis on artistic skills and creative growth of the individual. Work will be carried out in the various media described.

Students must provide all necessary materials, some of which will be available for purchase through the department. Materials will be discussed at the first class meeting. Where a model is used an additional fee will be charged.

- 235. Experimental Fabric Printing.** Diane Jones-Parry, Dip.A.D. (Camberwell), A.T.C. (Hornsey). *Tuesdays, 10.00 a.m.–12.00 noon, starting February 17, 1976. Pokfulam Studio, 144 Pokfulam Road. 14 meetings.*
Fee: \$140 plus \$30 materials fee

This course is suitable for beginners and more advanced students.

See entry for Course No. 233 for a further description.

Enrolment is limited to 15 persons.

- 236. Life Drawing.** Elise Parkin. *Tuesdays, 9.30 a.m.–12.00 noon, starting March 2, 1976. Extra-Mural Town Centre. 10 meetings.*
Fee: \$100 plus \$50 model fee

Students will be taught to co-ordinate hand and eye by drawing the human form in movement and at rest. Life drawing is a continuing discipline if we are to interpret and communicate what we “see” with accuracy and sensitivity.

Both beginners and more advanced students will be welcome.

- 237. Life Drawing.** Peter Chancellor, Dip.A.D. (Birmingham), A.T.D. (London). *Thursdays, 8.00 p.m.–10.00 p.m., starting February 19, 1976. Extra-Mural Town Centre. 10 meetings.* **Fee: \$100** plus \$50 model fee

Drawing from the human figure in movement and at rest has long been considered one of the better ways to train correlation of hand and eye. It is part of a continuing discipline of drawing and design. Students will come to understand the structure and proportion of the human figure, and will be encouraged to draw freely and with vigour.

Enrolment is limited to 20 persons.

238. Painting Workshop in Oil, Acrylic, and Related Media. Martha Lesser, B.S. (N.Y.U.). *Wednesdays, 10.15 a.m.-12.15 p.m., starting February 18, 1976. Extra-Mural Town Centre. 14 meetings. Fee: \$140*

Through paint, and the related media of collage, drawing, transfer and others, students will explore aesthetic and philosophic concepts of painting. Emphasis will be placed on learning to discover and communicate one's own ideas through visual and technical means. This is an intermediate level course and some previous experience in drawing, painting, or related skills is essential.

Enrolment is limited to 18 persons, and in the event of over-subscription an interview will be required.

239. Painting in Water-based Mixed Media. Philip Seth, B.F.A., (San Francisco Art Institute). *Thursdays, 10.00 a.m.-12.30 p.m., starting February 19, 1976. Extra-Mural Town Centre. 14 meetings. Fee: \$150*

There are many techniques which can be used in conjunction with traditional water-based media. Among these are collage, staining, masking out, resist, and others. In a series of eight freely structured projects, using still life and life models as subjects, students will explore these techniques, their effects, and their uses.

Some previous experience in water-based media would be an advantage, but is not essential.

**240. 油 畫
(Painting in Oil)**

主 講 人：郭倩如女士。

講授語言：粵語。

地 點：香港大學校外課程部市區中心。

時 間：一九七六年二月十八日起每星期三下午六時半至八時半。（共十四講）。

學 費：一百四十元。

本課程講授有關油畫初步知識，包括色彩關係，調色處理等。課程以臨摹，寫生為主。

（二小時講課另加一小時自修）

名額限收二十名。

241. 素描
(Monochrome Drawing)

主 講 人：郭倩如女士。

講授語言：粵語。

地 點：香港大學校外課程部市區中心。

時 間：一九七六年二月二十日起每星期五下午六時半
至八時半。（共十四講）。

學 費：一百四十元（包括聘請模特兒費用二十元）。

本課程為繪圖愛好者所設，強調基礎訓練，使學者認識素描的基本概念，掌握整體的觀察方法，及初步明白構圖，明暗，透視，比例，空間感的處理。在寫實的基礎上可依據自己的興趣去發展和變化。課程以寫生為主，對象包括靜物，人物。

名額限收二十名。

GRAPHIC DESIGN

242. **Problem Solving in Graphic Design.** Basil Pao, B.F.A. (Art Centre College of Design, L.A.). *Mondays, 6.30 p.m.-8.00 p.m., starting February 16, 1976. Extra-Mural Town Centre. 14 meetings. Fee: \$140*

The basic concepts of graphic design "problem solving" will be discussed. Class exercises will follow the various stages of design problems, from visual research and ideas, to an understanding of how, when, and where to use the various tools of photography, illustration, typography, etc.

Guest speakers from the graphic design profession will also address the course.

ART APPRECIATION

These are lecture and discussion courses open to all students regardless of previous Art History study.

243. An Introduction to the Art of South-East Asia. Mrs. Rajeshwari Ghose, B.A.Hons. (Calcutta), M.A. (H.K.). *Fridays, 6.00-7.30 p.m., starting February 27, 1976. Extra-Mural Town Centre. 16 meetings. Fee: \$75*

This illustrated course will provide an introduction to the Hindu and Buddhist art of South-east Asia. It will commence with a general survey of the area, trace the progress of the two religions and study the transformations that they underwent in their adopted lands. It will then proceed to a regional study of Burma, Indonesia, Indochina and Thailand, and will examine at length the art of Burma, Cambodia, Laos, Thailand, Indonesia (including Bali), Borneo and Sumatra.

244. Traditional Chinese Performing Arts in Hong Kong. Helga Werle, Programme Coordinator, Hong Kong Arts Centre. *Wednesdays, 6.15 p.m.-7.45 p.m., starting March 3, 1976. Extra-Mural Town Centre. 10 meetings. Fee: \$60*

There is a great variety of traditional Chinese performing arts to be found in Hong Kong. Many of us, even some of us who were born here, do not know how to appreciate them. People from various provinces of China have brought their own forms of drama to Hong Kong and have added these to the existing ones. We, in Hong Kong, are lucky to be in the unique position to witness six different styles of opera, four styles of puppet opera, and several types of ceremonial dances. All of these will be studied in their relationship to other theatre forms of Asia.

When possible group visits will be arranged to certain performances.

245. The Development of Chinese Theatre Costumes. Delia Kwan, B.A. (Berkeley), M.F.A. (N.Y.U.). *Thursdays, 6.15 p.m.-7.45 p.m., starting March 4, 1976. Extra-Mural Town Centre. 10 meetings. Fee: \$80*

Social, economic, and political progress in Chinese society is reflected in the clothing of the people. Accordingly the historical development of styles of dress and theatre costumes, the silhouette, masks, accessories, and colours and motifs of fabrics will be discussed from pre-T'ang days through to the Republic.

In addition to slides and diagrams, each lecture will be illustrated with examples of costumes from the periods discussed and demonstrations given of the proper ways to assemble and wear them.

246. Arts and Crafts Workshop for Parents and Teachers. Kathleen Brinkley-Rogers, B.F.A. (Univ. of Illinois). *Fridays, 6.00 p.m.-8.00 p.m., starting February 20, 1976. Extra-Mural Town Centre. 14 meetings.*

Fee: \$140

It is important for a child's growth and development to have creative activities, such as arts and crafts, integrated into the home and school life. Such activities help develop a child's intellect, imagination and dexterity skills. In this course, parents and teachers will experiment with a variety of projects such as simple batik, clay modelling, costumes for creative play, collage, paper sculpture, and others, all of which can be adjusted to the different age levels of children. Students will also construct visual aids for teaching skills such as colour identification, shapes and textures.

Enrolment is limited to 20 persons.

See also :

327. 中國陶瓷藝的發展. (Page 55)

Business Studies

Staff Tutor : Susan Cameron, Telephone 5-468161 Ext. 305

247. Company Secretaryship. J. A. Ellis, E.D., F.T.I.A., A.A.S.A., A.A.I.M., A.C.I.S., M.I.T.O. *Fridays, 6.15-7.45 p.m., starting February 20, 1976. Room 415, Knowles Building, University of Hong Kong. 15 meetings.* **Fee: \$85**

The practical aspects of the Company Secretary's job will be described with special reference to the procedures and administration of companies registered under the Hong Kong Companies Ordinance. This course is suitable for students who wish to acquire a basic knowledge of Secretarial Practice for practical use as well as for students taking professional examinations.

248. Management Mathematics. C. K. Butt, B.Comm. (McGill), M.Sc. (Berkeley). *Fridays, 7.45-9.15 p.m., starting February 13, 1976. Extra-Mural Town Centre. 15 meetings.* **Fee: \$90**

Instead of being satisfied with feasible solutions, businessmen nowadays are looking for optimal solutions. This course serves as an introduction to how various quantitative and mathematical techniques can be applied to business problems and to the decision-making processes of management in order to reach these optimal solutions. The techniques include linear programming, statistical decision theory, net work analysis, mathematical inventory theory queuing and game theory. Designed to be of general interest the course will, however, be particularly relevant to students taking the Section 2 Paper 12 of the A.C.A. examinations.

249. Cost Accounting for Management. John Lynch, A.C.M.A., F.C.C.A., A.M.B.I.M., A.S.C.A. *Wednesdays, 6.30-8.00 p.m., starting February 11, 1976. Room 721, Knowles Building, University of Hong Kong. 15 meetings.* **Fee: \$85**

Cost Accounting is an integral part of the management process. It provides management not only with records of the costs of products, operations or functions, and compares these with predetermined budgets and standards but also provides data for special cost studies involving alternative choices of action, thus assisting management in making decisions with respect to sales policies, production methods, purchasing procedures, financial plans and capital structure.

Recommended texts :

H. J. Wheldon, *Cost Accounting & Costing Methods.*

Buyers & Holmes, *Principles of Cost Accountancy.*

W. Harper, *Cost Accountancy M & E Handbook.* (All published by Macdonald & Evans.)

250. Accounting for Solicitors. S. E. C. Purvis, B.A. (Reading), Assistant Lecturer in Accountancy, University of Hong Kong. *Thursdays, 6.15-7.45 p.m., starting February 12, 1976. Room 415, Knowles Building, University of Hong Kong. 12 meetings.* **Fee: \$60**

Designed to be of assistance to candidates sitting Part II of the Law Society's Qualifying Examinations, this course will include accounting for Clients' and Trust Monies; treatment of disbursements on behalf of clients, outstanding costs at the balance sheet date; preparation of final accounts; evaluation of business proposals.

Recommended texts :

Solicitors Accounts, Compensation Fund and Practice Rules (The Law Society).

P. Harrison & A. G. Hillman, *Book Keeping & Accountancy for Solicitors* (Butterworth & Co.).

251. Hong Kong Taxation: Law and Practice (2). Charles Lo, LL.B. (Lond.), F.H.K.S.A., C.P.A., and Ambrose Lau, LL.B. (Lond.), Solicitor. *Thursdays, 5.45-6.45 p.m., starting March 11, 1976. Extra-Mural Town Centre. 10 meetings.* **Fee: \$50**

The provisions of the Estate Duty Ordinance will be studied. Under discussion will be the legal methods available for the distribution and disposition of property including settlements made inter vivos or by will, policies of insurance, gifts and annuities.

This course is a continuation of the part 1 course. Students should have a knowledge of accountancy and general principles of taxation law.

Recommended texts :

Estate Duty Ordinance.

Barry Pinson, *Revenue Law.*

Beatties' Elements of Estate Duty.

252. Giant Corporations: their role in the business world. Irene Chung Yee Au, B.Sc., M.B.A. *Tuesdays, 6.00-7.30 p.m., starting February 10, 1976. Extra-Mural Town Centre. 12 meetings.* **Fee: \$60**

The growth of the MNC's or multi-national corporations of today, is a twentieth century phenomenon with powerful effects on life in many countries. Their increasing importance gives rise to the need for better understanding of their methods of operation. The management of these very large enterprises is examined in terms of the opportunities and problems they face, their techniques and operations, and their need to adapt to different business and social environments.

253. 銀行實務 (二)
(Practical Banking II)

主 講 人：曾夢燕小姐，曾啓堅先生。

講授語言：粵語。

地 點：香港大學校外課程部市區中心。

時 間：一九七六年二月九日起每星期一下午六時至七時三十分。(共十講)。

學 費：五十五元。

本課程乃銀行實務(一)之延續課程，對銀行業務作進一步之介紹，其內容包括銀行法例，支票實務，票據法，出入口業務及財務貸款等之闡釋。

See also :

280. Economic Geography. (Page 32)

292. 商人及其法律概論. (Page 40)

293. Business Law. (Page 40)

PRIOR ENROLMENT IS ESSENTIAL

Failure to enrol prior to the opening of a particular course may mean the cancellation of that course. Prior enrolment is the only way the Department of Extra-Mural Studies has of judging the response to its courses. Your co-operation is therefore invited in sending your application forms to the Department as soon as possible.

Economics & Statistics

Staff Tutor : Susan Cameron, *Telephone* 5-468161 *Ext.* 305

254. 中國經濟 (The Economy of China)

主 講 人：劉佩瓊碩士（香港理工學院經濟系講師）。

講授語言：粵語。

時 間：一九七六年二月十九日起每星期四下午七時十五分至八時四十五分。（共十二講）。

地 點：香港大學校外課程部市區中心。

學 費：六十元。

此課程旨在簡介中華人民共和國的經濟發展過程。就其理論基礎，實際歷史及地理背景分析農業方面的土改、合作化、人民公社及工商業方面國營、公私合營等社會主義經濟改造過程。特別就工業、農業、財政、政府計劃，所得分配政策和國際貿易討論。講者就需要供應有關重要文件資料及介紹有關經濟學理論。

歡迎有熱誠，愛好討論的朋友參加，介紹方面將盡量遷就初學者。

255. An Introduction to Demography. Kwan Ying-keung, B.Soc.Sc. (H.K.), M.Sc. (London). *Tuesdays, 7.15-8.45 p.m., starting February 10, 1976. Extra-Mural Town Centre. 12 meetings.* **Fee: \$60**

Population studies provide an essential basis for analyzing social and economic trends and for planning public projects. The basic concepts of demography will be introduced and then applied to the discussion of both the social and the economic causes and consequences of population growth. To give the concepts local relevance, the focal point of discussion will be the pattern and effect of population growth on social welfare, housing, transport and urban planning in Hong Kong.

256. Methods of Survey Sampling. John Lee Chun-ming, B.A. (H.K.), Cert. in Survey Sampling (Mich.). *Wednesdays, 6.00-7.30 p.m., starting March 3, 1976. Extra-Mural Town Centre. 14 meetings.* **Fee: \$70**

Survey sampling plays a vital role in research, particularly in areas such as sociology, economics, marketing, and industry. This course provides a working knowledge of practical sampling methods, including both sample selection and estimation. Topics to be covered include: basic sampling concepts; stratified, systematic and cluster sampling; selection with probabilities proportional to size; the economic design of surveys; area sampling; multistage sampling; biases and nonsampling errors.

This course is suitable for researchers and survey designers/analysts, as well as candidates preparing for the Institute of Statisticians examinations.

Recommended Text: L. Kish, *Survey Sampling* (Wiley).

257. Elements of Statistical Theory II. Ma Ming-ching, B.Sc. (Washington). *Wednesdays, 6.15-7.45 p.m., starting February 18, 1976. Room 231, Knowles Building, University of Hong Kong. 12 meetings.* **Fee: \$60**

A course for those who have taken Elements of Statistical Theory I or its equivalent. Advanced topics to be covered include: elementary experimental design; analysis of variance; nonparametric tests; correlation and regression analysis; index numbers; time series analysis.

Management Studies

Staff Tutor : Terry Casey, Telephone 5-468161 Ext. 306

258. Corporate Strategy. S. G. Redding, M.A. Ph.D. *Mondays, 6.15-7.45 p.m., starting January 12, 1976. Room 230, Knowles Building, University of Hong Kong. 6 meetings.* **Fee: \$60**

It is necessary for executives, particularly those at senior levels to have an overall view of the organization and the way in which it adapts for survival. With a general introduction to organization theory, this series of seminars will go on to examine various approaches to corporate strategy formulation, the way in which organizations change their shapes and internal structures, and the adaptive mechanisms for scanning the environment. This course will be of interest to those dealing with boardroom level problems.

259. Techniques of Financial Management. Vincent Ng, B.S., M.B.A., M.S. (U.C.L.A.). *Mondays, 8.00-9.30 p.m., starting February 9, 1976. Room 231, Knowles Building, University of Hong Kong. 12 meetings.* **Fee: \$70**

The application of financial procedures affects every Manager in a business organization. Whilst a detailed knowledge of such procedures may not be necessary in the case of a non-finance Manager, an awareness of the financial implications and of alternative methods of financial control can be invaluable to the operational Manager. The speaker will examine the main features of business finance, such as source funding, ratios as a system of financial analysis, projection of business results through cash forecasting, operating budgets, budgetary control, and analysis of capital investment decisions. Case studies drawn from local and foreign sources will be used to illustrate the techniques in question.

Designed for practising Managers in the non-financial area, this course will put the various techniques of financial control in the context of other organizational activities and examine the human implications of financial systems.

260. Personnel Management: theory and practice. Terry Casey, B.A. (Nottingham), M.B.I.M. *Tuesdays, 6.15-7.45 p.m., starting February 10, 1976. Room 121, University Main Building. 8 meetings. Fee: \$50*

The development of sound personnel policies in a business organization is now widely accepted as the cornerstone to the successful pursuit of other managerial policies. Intended for junior executives in the Personnel function and for other non-specialists who wish to improve their knowledge of the function, the course will examine the role of the Personnel Manager in terms of direct operational responsibilities and as adviser in human relations to the organization. Stress will be laid on ways of developing Personnel Policies which are appropriate for the culture and business environment in which the Company is operating.

261. Materials Management: A Modern Interpretation. Ronald C. Blyth, M.Tech. (Brunel), M.Inst.P.S., D.M.S. A.M.B.I.M. *Thursdays, 5.45-7.15 p.m., starting February 5, 1976. Extra-Mural Town Centre. 12 meetings. Fee: \$60*

Materials Management is one of the major functions in industrial, commercial and governmental organisations. The term indicates an attempt to manage and control the total flow of materials from selection of supplier, through inventory control into production, and, in certain cases, after processing into the finished product, distribution to the customer.

This course will benefit managers who are responsible for all or part of the purchasing, inventory control or stores activities. Topics covered will include various management techniques which can be applied specifically to the solving of materials management problems.

262. Organization and Methods. Peter Wroe, M.Sc. (Cranfield), A.F.R.A.S., A.M.B.I.M., M.I.M.C. *Fridays, 5.30-7.00 p.m., starting February 6, 1976. Extra-Mural Town Centre. 12 meetings. Fee: \$60*

The techniques of a sound Organization and Methods approach to the running of a business enterprise are being adopted by an increasing number of companies in the modern world. Designed for office, line and general managers, this course will cover the application of O. & M. techniques from basic fact finding, the analysis of bad procedures through to the specialized techniques of an advanced nature. Specifically, the speaker will examine the problems of forms layout and design, the selection and usage of office machines, clerical aids, together with the supporting role of statistical techniques and of critical path analysis. Examples will be used to show the successful application of O. & M. techniques, taking into account the human implications of changes made.

263. Case Studies in Operational Research. R. J. M. Bailey, B.Sc. (Auckland), M.Sc. (Sussex). F.S.S. *Wednesdays 6.15-7.45 p.m., starting February 11, 1976. Room 415, Knowles Building, University of Hong Kong. 10 meetings.* **Fee: \$75**

Managers and their advisory staff who wish to gain a deeper insight into the formulation of Operational Research Models and the selection of techniques for their solution will find this course of particular interest. A basic knowledge of Operational Research techniques will be assumed. Emphasis will be placed on the formulation and classification of models rather than on the mathematical details of techniques. For each model classification there will be a description of the techniques available followed by an illustrative case study in which students will be encouraged to contribute partial solutions. Where appropriate, the use of standard computer techniques and packages will be explained.

The course has been designed as a follow-up to the Introduction to Operational Research courses run by the Department.

264. Ergonomics: The Study of People at Work. Brian Peacock, B.Tech. (Loughborough), Ph.D. (Birmingham), Lecturer in Industrial Engineering, University of Hong Kong. *Fridays, 6.15-7.45 p.m., starting February 6, 1976. Room 231, Knowles Building, University of Hong Kong. 12 meetings.* **Fee: \$60**

Productivity, motivation and health in any system can be improved by considering human capabilities and limitations. The course aims to outline the ranges of human variability with respect to size, strength, endurance, and abilities such as vision, manual dexterity, memory, decision-making and communication. The application of Ergonomics in job, workplace and equipment design will be also discussed. The ideas developed in this course will be of particular relevance to Production Managers, Personnel Managers, Safety Officers, Supervisors and to executives in the field of General Management whose responsibilities lead them to seek the improvement of the employee's contentment and effectiveness in the industrial context.

265. 發展中之航運業
(Liner Shipping in the World Economy)

主 講 人：蔡秀煜先生。

講授語言：粵語。

地 點：香港大學校外課程部市區中心。

時 間：一九七六年二月十日起每星期二下午五時三十分至七時。（共十二講）。

學 費：七十元。

近幾年來，爲了適應世界航運的急劇發展，本港海運業務亦相應有所變動，對有關管理人才的需求亦因此大爲增加。

本課程除了包括一般船務知識外，並著重介紹近年來貨運技術，特別是貨箱運輸技術的發展情況，貨運公會與付貨人協會之關係及發展中國家與先進國家在航運方面之利益衝突等。適合船務公司的一般管理人員及對航運有興趣的人仕參加。

See also :

248. Management Mathematics. (Page 16)

249. Cost Accounting for Management. (Page 16)

252. Giant Corporations: their role in the business world. (Page 17)

Diploma in Management Studies

The University Diploma course in Management Studies is open to graduates and to other suitably qualified candidates. Those selected will be expected to attend for two evenings a week and to be given release by their employers for one afternoon a week over the two-year duration of the course. Applications for the 1976 September intake should be sent to the Department not later than June 15, 1976. Further details of the course content may be obtained by writing to the Department of Extra-Mural Studies.

Certificate in Recreational Management

The Extra-Mural Certificate Course in Recreational Management is designed to offer professional training for community recreation leaders, teachers, officials of sporting clubs and others who are employed or intend to be employed in the field. The duration of the course will be one evening a week over seven months beginning in February 1976. Applications from graduates and other suitably qualified candidates should reach the Department no later than January 15, 1976. Further details of the course may be obtained by writing to the Department of Extra-Mural Studies.

Education

Staff Tutor : Mrs. Priscilla Tso, Telephone 5-468161 Ext. 303

266. Administration in Secondary Schools. M. A. Brimer, M.A. (Cantab.), Cert.Ed. (Brist.), Professor of Education, Charles Lowe, B.A. (Cantab.), Dip.Ed. (Lond.), Lecturer in Education, University of Hong Kong, and others. *Mondays, 6.15-7.45 p.m., starting February 9, 1976. Room 415, Knowles Building, University of Hong Kong. 10 meetings and 1 weekend (April 10 & 11, 1976).* **Fee: \$130**

The purpose of this programme of lectures, discussions and workshops is to provide an opportunity for practising, recently appointed head teachers to review the organisation of, and administrative practices in, secondary schools. Materials derived from working school situations will be presented and the problems outlined. The course will be task-oriented in seeking answers to the problems, and there will be a week-end programme in which syndicate studies will be conducted. The course will be taught by a team drawn from the University and Government Departments of Education.

Enrolment is limited to 24 persons.

Introductory Reading : Elizabeth Richardson, *The Teacher, the School and the Task of Management.* (Heinemann, 1973.)

267. 低能兒童（中度）教學研究 (Practical Techniques with the Mentally Handicapped)

主 講 人：鄧福泉先生。

講授語言：粵語。

地 點：香港大學校外課程部市區中心。

時 間：一九七六年五月七日起每星期二及星期五下午七時四十五分至九時十五分。（共十八講）。

學 費：一百二十元。

本課程內容包括低能兒童身心方面的發展；學習上的各種因素；設計教學法；程序教學法；準確教學法；語言及數學教學法；行為矯正法；言語的領畧和表達能力；課程設計，時間表編排，觀察及報告編寫，教具製作等；活動設計及與家長方面的合作等。

申請者如會參加本部「低能（智力）兒童的管教」課程並為現任低能兒童（中度）訓練中心工作人員將獲優先取錄。限收二十人。

（本課程由香港低能兒童教育協進會贊助）

截止報名日期：一九七六年四月二十七日。

See also :

- 246. **Arts and Crafts Workshop for Parents and Teachers.** (Page 15)
- 275. **Teaching English as a Second Language.** (Page 29)
- 332. **Introduction to the Philosophy of Science.** (Page 58)
- 343. **Hong Kong Ecology.** (Page 65)
- 286. 中國史籍論畧. (Page 36)
- 325. 中國古典文學選講. (Page 54)

UNIVERSITY ENTRANCE

The attention of extra-mural students is drawn to the following regulation of the University of Hong Kong regarding admission to the University:

‘A mature person without formal academic qualifications who is aged 30 or over on September 1 of the year in which admission is sought may be exempted completely from University entrance requirements but shall not be eligible for admission to the Faculty of Medicine. Applications for exemption on grounds of mature age must be supported by certified true copies of a birth certificate or a statutory declaration and of any academic qualifications.’

Enquiries about this exemption clause should be addressed to the Registrar, University of Hong Kong.

English Studies

Staff Tutor : Duncan Macintosh, *Telephone* 5-456443

ENGLISH LANGUAGE COURSES

RETURN TO ENGLISH

It often happens that young people who completed their formal education a few years ago and who have been employed in office work ever since feel that they need to improve their English if they are going to be able to develop as fully as they should in their work. The 'Return to English' programme is therefore intended for those office workers who wish to revise their knowledge of English so that they can carry out their duties more effectively. The tutors will provide thorough tuition in the basic principles of English and appropriate exercises so that students attending them may have frequent practice in those aspects of English that most frequently present problems to those who have stopped studying the language for a few years.

Applicants who have previously wanted to enrol in the Department's Use of English courses, but who have not been accepted, may wish to join one of these courses as a preparation before applying for a place again in a Use of English course in the year 1976/77.

Entrance Qualifications

A Pass in English in the Hong Kong Certificate of Education, English or Chinese.

Textbook

R. O'Neill: Kernel Lessons Intermediate, Students' Book.

This book is obtainable from the Hong Kong Book Centre in Des Voeux Road Central and the Swindon Book Company in Lock Road, Kowloon.

Courses

In Hong Kong

268. University of Hong Kong, Knowles Building, Room 418.
Tuesdays, 6.15-7.45 p.m., starting February 10, 1976.
12 meetings. **Fee: \$75**
269. Hong Kong Technical Teachers' College, 373 Queen's Road East, room to be announced.
Tuesdays, 6.15-7.45 p.m., starting February 10, 1976.
12 meetings. **Fee: \$75**

270. Wah Yan College, Queen's Road East, Room 4B.
Fridays, 6.15-7.45 p.m., starting February 13, 1976.
12 meetings. **Fee: \$75**
271. Government Training Division, Lee Gardens, 2nd floor,
Hysan Avenue, Causeway Bay, Room 30.
Tuesdays, 6.15-7.45 p.m., starting February 10, 1976.
12 meetings. **Fee: \$75**
272. Government Training Division, Lee Gardens, 2nd floor
Hysan Avenue, Causeway Bay, Room 30.
Thursdays, 6.15-7.45 p.m., starting February 12, 1976.
12 meetings. **Fee: \$75**

In Kowloon

273. Wah Yan College, Waterloo Road, rooms to be announced.
Fridays, 6.15-7.45 p.m., starting February 13, 1976.
12 meetings. **Fee: \$75**

274. **Intonation in Idiomatic English.** Raymond Huang, B.A. (Lingnan), M.A. (Leeds), I.P.A. Cert. Phon., P.G.C.E. (London), L.R.A.M., L.T.C.L. (London), President, Lingnan College and Principal, Lingnan Middle School. *Fridays, 6.15-7.45 p.m., starting February 13, 1976. Room 3A, Wah Yan College, Queen's Road East. 16 meetings.* **Fee: \$110**

By showing the contrast in stress and intonation between English and Chinese (Cantonese and Mandarin) the tutor will help the Chinese student to grasp:

- (1) The tonal and rhythmic system of his mother tongue and
- (2) how errors in his English speech arise from his native language habits.

Methods of correcting errors will be suggested and graded aural-oral exercises on English Intonation will be provided. Intonation practice will be related to everyday idiomatic English in order to increase the student's range of expression.

Enrolment limited to 30 students.

The tutor is author of a number of books on phonetics, including 'English Pronunciation Explained with Diagrams' and co-author of 'Intonation in Idiomatic English', Books I & II.

ENGLISH FOR TEACHERS

275. Teaching English as a Second Language: The Oral Structural Approach. William Cheng, B.A., M.A. (Ed.) (H.K.U.), Dip. in App. Ling. (Edin.), Principal, Queen's College, Hong Kong. *Fridays, 6.15-7.45 p.m., starting February 13, 1976. Room 4B1, Wah Yan College, Queen's Road East, Hong Kong. 12 meetings.* **Fee: \$75**

The Provisional Syllabus for English (Forms I-V) advocates the use of the 'universally accepted "oral-structural" approach to modern language teaching' and states on Page 131 'a teaching programme that takes these principles into account is likely to be more successful, other things being equal, than one that does not.'

A detailed explanation of the principles of the oral-structural approach will be given in the introductory lecture of the course. Subsequent lectures will be devoted to the application of the principles to the teaching of vocabulary, grammatical structures and the active use of language for communication.

The topics to be considered will include:

- (a) Principles of the oral-structural approach
- (b) Vocabulary teaching
- (c) Teaching grammatical structures
- (d) Listening and speaking skills
- (e) Language testing.

Fee Refund: Teachers at Advanced or Certificate of Education levels attending this course who wish to have their fees refunded by the Director of Education are required to complete an application form (obtainable from the Department of Extra-Mural Studies, University of Hong Kong) which must be returned directly to the Director of Education before the commencement of the course. This applies to all teachers whether in Government or private schools.

ENGLISH FOR APPRECIATION

276. The Poetry of Donne and Shakespeare. R. Kirkpatrick, B.A. (Oxon.), Lecturer in English, University of Hong Kong. *Thursdays, 6.15-7.45 p.m., starting February 12, 1976. Room 230, Knowles Building, University of Hong Kong. 10 meetings.* **Fee: \$60**

It is widely recognized that in these two poets, Donne and Shakespeare, one may find expressed some of the qualities which are most essentially characteristic of English Literature. A detailed study of both Donne and Shakespeare will be undertaken, and the tutor will also explain and illustrate the features which are common to these two writers as representative of the sixteenth and seventeenth century culture. An attempt will also be made to demonstrate why the qualities which Donne and Shakespeare share have been valued so highly by literary critics. Copies of the poems to be discussed during the course will be made available.

277. The Short Story. S. Sergi, M.A. (Cantab.), M.A. (Ottawa).
*Tuesdays, 6.15-7.45 p.m., starting February 10, 1976. Room 743, Knowles
Building, University of Hong Kong. 10 meetings.* **Fee: \$60**

“A man ought to read just as inclination leads him; for what he reads as a task will do him little good” wrote Dr. Johnson. This brief course on the short story is intended as an introduction to the genre and encouragement to those who attend it to read more of the works of the authors the course will consider. The tutor will guide the students and will lead discussions on the way short stories can illustrate various aspects of life. Copies of the stories to be considered will be made available, and these will include humorous, mystery and ghost stories as well as others dealing with love, death and the roles that luck and social customs play in our destinies.

278. Reading and Discussion. J. R. Henderson, B.A. (Leeds). *Fridays,
6.15-7.45 p.m., starting February 13, 1976. Room 5C, Wah Yan College,
56 Waterloo Road, Kowloon. 10 meetings.* **Fee: \$60**

Different writers employ a variety of different styles with which to express their ideas in a number of different situations. The style used when the writer wishes to persuade his readers of something, for example, is different from the style he uses when he wishes merely to give factual information, and this, in turn, is different from the style used when he expresses a personal opinion. The aim of this further course, which is suited to those who already have quite a good command of English, is to consider the various styles that a writer can use and the various effects that they can achieve. The tutor will lead the discussions on a variety of different texts and will explain the effect that the writers wanted to achieve.

Enrolment will be limited to 25 persons and may be by selection of those most qualified to benefit from the course. All applicants should have obtained a Pass in English at G.C.E. ‘O’ level or equivalent.

Textbook: H. L. B. Moody, *Varieties of English* (Longman) which may be obtained from the Swindon Book Company, Lock Road, Kowloon.

European Languages

Staff Tutor : Duncan Macintosh, *Telephone* 5-456443

279. Spanish I. T. Quejada, B.S.E. (San Augustin), M.Theol. (Santo Tomas), Chancellor, Spanish Consulate-General. *Thursdays, 5.30-7.00 p.m., starting February 12, 1976. Extra-Mural Town Centre. 20 meetings.*
Fee: \$150

Those who have no previous knowledge of Spanish will find this short and intensive course for complete beginners in the language of considerable value. The tutor will teach the class to a level where they can understand elementary texts in Spanish and carry on simple conversations. Those who complete it satisfactorily will be qualified to join the Department's Spanish II course in the year 1976-77.

Enrolment limited to 30 persons.

Textbook : El Espanol Al Dia, Book I, obtainable from the Hong Kong Book Centre, Des Voeux Road Central.

Geography & Geology

Staff Tutor : O. H. H. Wong, *Telephone* 5-468161 *Ext.* 309

280. Economic Geography. M. C. Kwan, B.A., M.N.R.M. (Manitoba), A.M.B.I.M., A.M.Inst.T.A. *Tuesdays, 6.00-7.30 p.m., starting February 17, 1976. Extra-Mural Town Centre. 16 meetings.* **Fee: \$85**

The study of economic geography is of particular benefit to those engaged in commerce, and is of special relevance to the many people in Hong Kong whose living is bound up with export and import. World economic geography is dealt with under a number of themes which bring together more detailed regional studies from each continent, the overall aim being an understanding of the location of economic activity.

The syllabus will also be of interest to people studying for examinations such as those of the Institute of Bankers (Part I). The main themes dealt with are:

- (1) *Energy and Power.* The primary sources of energy: coal, petroleum, natural gas, and water power; the secondary sources of power derived from them; nuclear energy and sources of nuclear fuel.
- (2) *Agriculture and Industry.* The production and utilization of primary raw materials and foodstuffs. Environmental factors in agricultural production. The geographical location and localization of manufacturing industry.
- (3) *Trade Centres and Market Areas.* The functions of towns and service centres. Urban regions. Ports and their hinterlands.
- (4) *Transport and Distribution.* Geographical aspects of inland and overseas transport. Trade routes and communications.
- (5) *World Population.* World population trends and distribution; the geographical background to population growth and economic development. Urban growth and rural depopulation.

281. Quantitative Methods & Statistics in Geography. Larry C. H. Chow, B.S. (Central Missouri State), M.S. (Nebraska-Omaha), Part-time Lecturer, H.K. Baptist College. *Mondays, 6.20–7.50 p.m., starting March 8, 1976. Room 230, Knowles Building, University of Hong Kong. 10 meetings.* **Fee: \$55**

Quantitative techniques are playing an increasingly important role in geographical analysis in recent years. They help to measure, present and analyse geographical problems with greater precision and rigour. Not all quantitative techniques involve complex and difficult mathematics: certain commonly used ones are relatively simple but very useful.

This course will deal with some of these basic techniques; the topics covered will include, among others: simple sampling techniques; elementary statistics like the mean, the median, standard deviation, variance, simple regression analysis, Kendall's tau etc.; the use of charts and graphs, such as the bar graph, the graduated circle, the histogram and so on.

Priority will be given to post-secondary students and geography teachers.

282. Geography in the Field (Physical). C. Y. Jim, B.A. (H.K.), Demonstrator in Geography and Geology, University of Hong Kong. *Mondays, 8.00–9.00 p.m., starting February 16, 1976. Room 230, Knowles Building, University of Hong Kong. 7 meetings plus 3 field trips.* **Fee: \$75**

An introductory course on geology, weathering and soil science, illustrated by local examples as far as possible. The topics to be discussed will include: weathering—its processes and products; pedogenesis in the tropical and subtropical realm with special emphasis on laterization; survey of recent trends in soil classification; studies on selected local soils. Three field trips will be organized to illustrate the criteria, problems and techniques of study on the related topics.

Priority will be given to Post-secondary students and geography teachers.

Enrolment is limited to 35 persons.

283. **建築業上之實用地質及地工學**
(Some Practical Geological and Geotechnical Problems in the Construction Industry)

主 講 人：黃康祐博士
(特許工程師，英國土木工程學會會員)。

講授語言：粵語為主，輔以英語。

地 點：香港大學校外課程部市區中心。

時 間：一九七六年二月廿八日起每星期六上午九時至十二時半。(共四個上午)。

學 費：六十五元。

近年來，因實際之需要，更大及更重之建築物，不斷建於不大適合之基礎物質上。為要維持建築物之安全，及降低成本，對基礎物質之特性，其穩固法，并各種基礎之施工方法及設計，均必需有深切之認識。由此之故，地質學及近年發展迅速之地工學，已漸被廣泛應用於基礎工程之建築。

故本課程主旨為討論幾項在建築業上甚為實用之地質及地工問題。內容包括：(一)地質數據之收集及應用，并特別注重圖解法。(二)各種地工學問題，例如斜坡及基礎之穩固性，工地之實地試驗，及測量儀器之裝置。(三)地工學近年之發展，并考慮其在本港應用之可能性。

凡由各有關機構介紹前來就讀者，得獲優先取錄機會。

History

Staff Tutor : O. H. H. Wong, *Telephone* 5-468161 *Ext.* 309

284. Personalities & Politics in Contemporary China. Owen H. H. Wong, M.A. (H.K.), Ph.D. (Cantab.). *Tuesdays, 6.15-7.45 p.m., starting February 10, 1976. Room 167, University Main Building. 8 meetings.*

Fee: \$45

The political scene, as well as the social and intellectual background of Contemporary China, will be illustrated by reviewing the career of the following political leaders:

1. Political Leaders & Political Patterns in 20th Century China.
2. Sun Yat-sen: Founder of the Republic.
3. Yuan Shih-k'ai: Origin of modern Warlordism.
4. Hu Shih and Ch'en Tu-hsiu: Early Liberalism and Marxism.
5. Chiang Kai-shek: National Unification.
6. Chou En-lai: Diplomat and Statesman.
7. Chiang Ch'ing: Women and Politics in modern China.
8. Mao Tse-tung: Nationalism and Communism.

Little or no previous knowledge of Chinese history will be assumed and participants are advised to take "Mao Tse-tung: His Career & Political Thought" as the follow-up Course.

285. Women and Society in Modern China. T. T. Pang, B.A. Hons. (H.K.), formerly Demonstrator in History, University of Hong Kong. *Wednesdays, 2.15-3.45 p.m., starting April 28, 1976. Extra-Mural Town Centre. 8 meetings.*

Fee: \$45

The metamorphosis of Chinese society is the cause and effect of the drastically changing political scene in the late 19th and early 20th centuries. The impact of the new tides of thought and modernized education on the traditional clan system, gentry privileges and position of women was profound.

Within this framework, the course concentrates on the changing population and class structures, the occupation patterns, the effects of urbanization, industrialization and communication development, as well as social problems and welfare. It also attempts to analyse the changing role and status of Chinese women and will focus on a few prominent personalities like the Empress Dowager, the Soong sisters and Madame Mao Tse-tung as illustrations.

286. 中國史籍論畧
(An Introduction to Chinese Historiography)

主 講 人：龐德新博士。

講授語言：粵語。

地 點：香港大學校外課程部市區中心。

時 間：一九七六年二月廿日起每星期五下午七時十五分至八時四十五分。（共十講）。

學 費：五十五元。

按時代先後，擷取春秋，史記，漢書，資治通鑑，通鑑紀事本末，文獻通考，通志，史通，廿二史劄記等多部舊史，以及近人所作通史，區別其體制，介紹作者之生平與及經營工夫，並闡述此等史籍作為史學著作之價值，使學者畧知國史門徑，而為升堂入室之階。本課程為中學文史教師而設，其他對文史有興趣之社會人仕，亦歡迎選修。

申請教署付還學費手續：凡政府，補助，與私立學校之中四至中七班世界史及中史教師進修此門課程，而欲教育司署支付學費，可向香港大學校外課程部索取表格，於開課前交回教育司署。

287. 現代中國社會政治的變遷（一）（1840—1911）
(Social & Political Changes in Modern China)

主 講 人：朱光振先生（前國立中山大學歷史教授）。

講授語言：粵語。

地 點：九龍柯士甸道聖瑪利書院二十四號室（入口處在金巴利道與柯士甸路交界處）。

時 間：一九七六年二月十七日起每星期二下午七時半至九時。（共十二講）。

學 費：五十五元。

近百多年來，中國的社會，政治，均在不斷演變中。而鴉片戰爭，是新舊中國的轉變點。繼鴉片戰爭連續發生了四大戰役後，中國淪為次殖民地地位。若要研究現代中國的由來，不能不先了解舊中國失敗的根源，及歐美列強在十八九世紀的向外拓展情勢。進而了解中國朝野上下「圖強禦侮」的趨勢。

研究範圍包括：中外歷次交涉及其對中國政治社會之影響；洋務運動；維新運動；辛亥革命運動；五四時代的文化運動；五卅的反帝國主義運動；國民革命時代及其以後的新社會科學運動；而至對日抗戰的救亡運動。從以上各種事變中，認識中國社會，政治的歷史過程，及其構成現代中國的近貌。本期將講至辛亥革命為止。

Journalism and Communication

Staff Tutor : O. H. H. Wong, *Telephone* 5-468161 *Ext.* 309

288. 大眾傳播學 (Mass Communication)

主 講 人：徐天佑碩士（香港浸會學院傳理系講師）。

講授語言：粵語，輔以英語。

地 點：香港大學鈕魯詩樓 415 室。

時 間：一九七六年三月二十三日起每星期二下午六時半至八時。（共十二講）。

學 費：六十五元。

在北美洲許多大學，傳播學（或稱傳理學）已成為必修課程之一，其目的為運用科學方法，分析與研究改善人際間關係。此科對從事文化教育、社會工作、新聞事業，及公共關係者，均會有很大的專業上的幫助。

講授的重點在於研究大眾傳播媒介與社會的關係。研討的範圍包括大眾傳播的過程，傳播組織的特點，內容的控制，受眾的性質及傳播媒介對政治，經濟及社會所產生的可能影响，課程並特介紹及討論香港目前大眾傳播事業的概況。

整個過程着重小組討論，故只限收二十六人，對從事文化教育事業、社會工作及公共關係者，均會有很大的專業上的幫助。

289. 語言傳達學入門
(Introduction to Speech-communication)

主 講 人：劉玉茵碩士。

講授語言：粵語，輔以英語。

地 點：香港大學校外課程部市區中心。

時 間：一九七六年二月十九日起每星期四下午八時至
九時半。（共二十講）。

學 費：一百一十元。

此乃美洲最近新興的一門實用學科，用科學化及系統化的分析，幫助參加者對其語言環境之意義，作有系統的觀察，再用語言為媒介，發揮人與其環境合一化的創造能力。

內容包括語言與傳達的現象；語言與傳達的關係；個人與傳達的關係；傳達時常遇到的阻礙；及勸誘的技巧。

整個過程着重小組討論，故只限收二十六人，對從事文化教育事業、社會工作及公共關係者，均會有很大的專業上的幫助，凡上課次數超過三分之二者，將可申請本部發給之聽講證書。

PRIOR ENROLMENT IS ESSENTIAL

Failure to enrol prior to the opening of a particular course may mean the cancellation of that course. Prior enrolment is the only way the Department of Extra-Mural Studies has of judging the response to its courses. Your co-operation is therefore invited in sending your application forms to the Department as soon as possible.

Law

Staff Tutor : Mrs. Priscilla Tso, *Telephone* 5-468161 *Ext.* 303

290. 住客與業主 (Landlord and Tenant)

主 講 人：韓譚春先生。

講授語言：粵語。

地 點：香港大學校外課程部市區中心。

時 間：一九七六年二月十八日起每星期三下午八時至九時三十分。（共八講）。

學 費：三十五元。

本課程目的在使市民認識香港現行法律對業主及住客的保障，着重說明土地支配權及樓宇的買賣手續。

291. 城市環境衛生與公共衛生法律 (Law of Public Health)

主 講 人：陳永泉法律學士。

講授語言：粵語。

地 點：香港大學校外課程部市區中心。

時 間：一九七六年二月十九日起每星期四下午八時至九時卅分。（共十二講）。

學 費：五十元。

本港各類樓宇之內外或其附近之環境，不時會涉及或妨礙個人或公共衛生者，實屬不鮮。舉例而言：如烟霧、塵埃、垃圾、污水、蚊蟲及不潔或不合法例標準之食品等等問題，皆與市民之公共衛生有密切關係。

本課程之主要目的為使各從業於地產物業、工廠、建築地盤、酒店、飲食業、戲院及超級市場等之管理或主理人士，得以對本港公共衛生法律，有較深之認識及作實例之討論。

課程主要內容包括管理屋宇環境衛生法例；管理垃圾、積水及蚊蟲法例；食物館及食物製造場法例；管理不潔及不符合法例標準食品法例；管理戲院、酒樓茶室及舞池空氣調節法例及保持空氣清潔法例等。

292. 商人及其法律概論
(An Introduction to Law for the Businessman)

主 講 人：陳永泉法律學士。

講授語言：粵語。

地 點：香港大學校外課程部市區中心。

時 間：一九七六年二月十八日起每星期三下午八時至九時卅分。（共十二講）。

學 費：五十元。

本課程旨在介紹在香港經商者對有關法律應有之基本認識。內容包括公司法、契約法、商事法，售賣貨品條例，僱傭條例，職工賠償條例及最近提出之小額錢債審裁處法案等。

293. Business Law. T. K. Ghose, B.A. Hons. (Calcutta), C.A.I.I.B., A.I.B., A.C.I.S., A.M.B.I.M. and William P. K. Lee, Barrister-at-Law (Inner Temple), Crown Counsel. *Wednesdays, 6.15-8.30 p.m., starting February 11, 1976. Room 167, Main Building, University of Hong Kong. 16 meetings.* **Fee: \$130**

A course designed to be of assistance to candidates preparing for the Part II Examination of the Institute of Chartered Secretaries and Administrators. It will deal with general principles of the law of contract, including agency, sale of goods, hire purchase and consumer protection; lien and bailment, commercial arbitration, negotiable instruments with particular reference to cheques and bankers' credits; relationship of banker and customer; legal aspects of the distinctions between various kinds of business organization including forms of incorporated and unincorporated associations; law of bankruptcy; deeds of arrangement; outline of the law including, where appropriate, that deriving from the European Economic Community, relating to monopolies and restrictive trade practices; law of defamation.

See also :

250. Accounting for Solicitors. (Page 17)

Music

Staff Tutor : O. H. H. Wong, *Telephone* 5-468161 *Ext.* 309

294. 古典音樂的認識與欣賞 (Understanding Classical Music)

主 講 人：劉靖之先生, B.A. (Hons.) London, L.R.S.M.,
L.T.S.C., A.Mus., T.C.L.

講授語言：粵語，輔以英語。

地 點：香港大學校本部 217 室。

時 間：一九七六年二月十一日起每星期三下午六時半
至八時。（共十四講）。

學 費：七十元。

在香港，音響器材、唱片和錄音帶頗受大眾歡迎。再加上各種音樂會，欣賞西歐古典音樂成為許多人的愛好。對於那些初入門的人仕，覺得古典音樂過於抽象，難以理解。本課程旨在為這些音樂愛好者，中、小學教師及有意參加各種音樂考試人仕提供一些欣賞古典音樂的基本常識。

在十四講裏，將涉及歐洲古典音樂發展概況，即從萌芽時期到現代音樂的演進；各樂派之源流、風格及影響；傑出作家之代表作品；曲式與樂曲；各種樂器之音色及性能；管弦樂隊之組合等。俾使音樂愛好者在課程結束後，對古曲音樂有着一定程度的認識和欣賞能力。講授將輔以圖片、唱片及錄音帶。

295. **幼兒音樂活動**
(Pre-School Music Activities)

主 講 人：李翕秀舜女士, L.R.S.M., L.T.S.C., L.T.C.L.
(C.M.T.), A.R.C.M.,
(葛亮供師範學院音樂講師)

講授語言：粵語。

地 點：九龍加士居道葛亮供師範學院音樂室。

時 間：一九七六年二月二十日起每星期五下午六時半
至八時。(共十二講)。

學 費：六十五元。

名 額：三十二人。

以討論及示範之形式，提供幼兒音樂教師生動的現代教學方法。講題包括：幼兒教師之準備，幼兒歌曲選材，領唱技巧，音樂欣賞教材，節奏樂器之製作及運用，木笛之運用及簡易吹奏法之介紹，幼兒節奏感及旋律感之誘發和培養，音樂和律動，音樂及語文，美勞科學等之關係，音樂創作活動，其他音樂遊戲。

296. **中國地方音樂**
(Regional Music of China)

主 講 人：關志雄先生。

講授語言：粵語。

地 點：香港大學校外課程部市區中心。

時 間：一九七六年二月廿日起每星期五下午七時三十分至九時正。(共十講)。

學 費：五十元。

由於中國地方音樂種類繁多，並且源遠流長，它們構成中國文化與生活之豐美，實非其他國家音樂所能望其項背的。所以中國地方音樂學今後必然成爲非常重要和值得致力開拓的學科。本課程即按照該門學科的需要而設計，向愛好音樂的人士，尤其是有志深入了解或研習傳統中國音樂的學員，提供種種探討的資料及方法。課程範圍包括：

- (一) 民歌。包括各地山歌、鹹水歌、秧歌等歌謠。
- (二) 說唱音樂。包括南北鼓書、彈詞，與廣東木魚、龍舟、南音，及其他寶卷、梵音、相聲等。
- (三) 戲曲音樂。包括崑劇、京戲、秦腔、黃梅戲、越劇、楚劇、閩劇、漢劇、評戲及廣州大戲等大小戲劇。
- (四) 民族器樂。包括漢族及其他少數民族的創作樂曲，學員可從全部課程中認識中國俗樂的產生，演變，及流布情況，並學習從事蒐集，保存，研究，改良等方法及工作。講授時將輔以錄音帶，並邀請名家示範講解。

297. **自由對位法（二部，三部）**
(Free Counterpoint: Two or Three Parts)

主 講 人：李超源博士, M.M., Ph.D. (S.I.U.),
前新加坡大學音樂系主任。

講授語言：粵語為主，輔以英語。

地 點：九龍加士居道葛量洪師範學院音樂室。

時 間：一九七六年二月十七日起逢星期二晚六時廿分
至七時廿分。（共十二講）。

學 費：五十五元。

對位法為西洋音樂寫作之一種技巧。本課程將提供自由對位，或和聲對位應熟習之基本技巧，包括旋律寫作及旋律結合之各問題。學員應準備寫習作之時間。

參加者應具備起碼的和聲根底，懂得用各和絃及其轉位 (Inversion), 和聲外音 (unessential notes) 並了解轉調 (modulation) 的過程，故應具備皇家學院樂理七級以上程度。

限收廿五人。

298. **合唱之組織及指揮**
(Choral organization and conducting)

主 講 人：李超源博士, M.M., Ph.D. (S.I.U.),
前新加坡大學音樂系主任。

講授語言：粵語。

地 點：九龍加士居道葛量洪師範學院音樂室。

時 間：一九七六年二月十七日起逢星期二晚七時半至
九時。（共十二講）。

學 費：六十五元。

合唱團之組織與指揮，是一項有高度技術與藝術性之工作。現以設計組織一個合唱團為題材，而研究由開始着手至練習之各項基本問題。課程包括組織法，指揮技術，演出之措施等。適合學校及社團人士。參加者應具有閱讀樂譜能力，若有合唱經驗，或能使用鍵盤樂器者更好，唯無此必要。

Oriental Languages

Staff Tutor : O. H. H. Wong, *Telephone* 5-468161 *Ext.* 309

The Oriental Language programme is taught in English, Mandarin and Cantonese as described. A good standard in the appropriate medium is essential to gain full benefit from the course.

Cassette tapes relating to the Mandarin, Cantonese, Japanese, and Putung Hua courses are available for a small fee so that participants may practise by themselves after each lecture. These tapes can be obtained from the Department by those who enrol.

MANDARIN

299. Introductory Mandarin. Tyrone S. C. Wang, B.A. (Yen-Ching), formerly Language Tutor, University of Hong Kong. *Tuesdays and Fridays, 6.05-7.20 p.m., starting March 5, 1976. Room 141, University Main Building. 40 meetings.* **Fee: \$260**

The main emphasis of this course will be on spoken Mandarin and ample opportunity will be given for practising pronunciation and short sentence construction orally.

Textbook: Gardner Tewksbury, *Speak Chinese*, Revised Edition (Available at Hong Kong Book Centre, and Swindon Book Company).

300. Intermediate Mandarin & Character Learning. Tyrone S. C. Wang, B.A. (Yen-Ching), formerly Language Tutor, University of Hong Kong. *Tuesdays and Fridays, 7.30-8.30 p.m., starting March 5, 1976. Room 227, Knowles Building, University of Hong Kong. 40 meetings.* **Fee: \$240**

This course is intended for students who have completed Introductory Mandarin or who can prove that they have done a reasonable amount of Mandarin in the past. Some idiomatic expressions will be introduced and students will be taught to read simple passages.

The study of Chinese characters through Mandarin will include etymology, vocabulary, and classical reference of idioms. Special effort will be made to give students practice in writing characters and in finding characters in Chinese dictionaries.

Textbook: Fred Fang-yu Wang, *Chinese Dialogues* (together with Character Text) (Available at Hong Kong Book Centre and Swindon Book Company).

普通話（國語）
(Putung Hua)

香港人仕對普通話的學習，興趣日益濃厚，有進一步提倡的需要，本部將陸續擴充普通話班，並由本部兼任導師重編各類教材，以適應目前香港的需要，使普通話的教學，更趨系統化，更易為各界人仕接受。

基本普通話（國語）
(Basic Putung Hua)

整個課程共四十五小時，為期半年。內容有國語注音符號（包括注音字母及中國現行標準拼音法），國、粵語發音，語法和詞句的差異，國語會話和文章選讀等。

教材由本部免費供應。

301. 基本普通話（國語）
(Basic Putung Hua)

主 講 人：支字濤先生。

講授語言：普通話。

地 點：香港大學校外課程部市區中心。

時 間：一九七六年二月十六日起每星期一下午七時五十分至十時。（共二十二講）。

學 費：一百五十元。

302. 基本普通話（國語）
(Basic Putung Hua)

主 講 人：支字濤先生。

講授語言：普通話。

地 點：九龍尖沙咀柯士甸道 162 號聖瑪利書院 9 號課室。（入口處在金巴利道與柯士甸道交界處）

時 間：一九七六年二月廿五日起每星期三下午六時半至九時。（共十八講）。

學 費：一百五十元。

303. 基本普通話（國語）
(Basic Putung Hua)

主 講 人：錢武宗儒女士。

講授語言：普通話。

地 點：香港大學鈕魯詩樓 418 室。

時 間：一九七六年三月廿二日起每星期一及星期四下午六時零五分至七時二十分。（共三十六講）。

學 費：一百五十元。

中級普通話（國語）
(Intermediate Putung Hua)

整個課程共四十小時，為期半年，內容有發音，聲調與語法的複習，特重高低聲調的調號，調值與類別，及四音節的變化，並輔以高深的會話與各類文章的選讀，以期學員於結業後，能充分運用標準而流利的普通話，每班限收三十六人。學員上課超過四分之三，而結業考試及格者，將獲本部頒發之中級普通話合格證明書。

教材由本部免費供應。

304. 中級普通話（國語）
(Intermediate Putung Hua)

主 講 人：張丹女士。

講授語言：普通話。

地 點：香港大學鈕魯詩樓 418 室。

時 間：一九七六年三月十五日起每星期一及星期四下午七時二十五分至八時四十分。（共三十二講）。

學 費：一百二十五元（包括考試費十元）。

305. 高級普通話
(Advanced Putung Hua)

主 講 人：張丹女士。

講授語言：普通話。

地 點：香港大學鈕魯詩樓 418 室。

時 間：一九七六年三月三日起每星期三下午六時半至八時半。（共二十講）。

學 費：一百三十五元（包括考試費十元）。

CANTONESE

Cantonese I

The main emphasis of this course will be on basic grammar in spoken Cantonese and ample opportunity will be given for practising pronunciation and short sentence construction orally.

Textbook : Lung Sing, *Basic Cantonese in One Hundred Hours* (Available at Hong Kong Book Centre & Swindon Book Company).

306. Cantonese I. C. Y. Ma, B.A. (Sun Yat-sen). Language Tutor, University of Hong Kong. *Tuesdays and Fridays, 2.00-3.15 p.m., starting February 10, 1976. Extra-Mural Town Centre. 40 meetings. Fee: \$260*

307. Cantonese I. C. S. Hung, B.A. (Chinan), Language Tutor, University of Hong Kong. *Mondays and Thursdays, 6.00-7.15 p.m., starting March 11, 1976. Room 141, University Main Building. 40 meetings. Fee: \$260*

308. Cantonese I for Executives. L. T. Tan, B.A. (Nat. Chi-nan), Language Instructor, University of Hong Kong. *Mondays and Thursdays, 5.45-7.00 p.m., starting March 11, 1976. Extra-Mural Town Centre. 40 meetings. Fee: \$370*

For small group instruction, enrolment is limited to 14.

309. Cantonese I. K. K. Chan, B.A. (C.U.H.K.), formerly Language Tutor, Yale-in-China Chinese Language Centre. *Tuesdays and Thursdays, 6.10-7.25 p.m., starting March 9, 1976. Room 24, St. Mary's Canossian College, 162 Austin Road, Kowloon (Entrance at the junction of Kimberley Road and Austin Avenue, parking space available). 40 meetings. Fee: \$260*

Cantonese II

This course, intended for students who have completed Cantonese I or who can prove that they have had equivalent training in Cantonese, will concentrate on oral expressions and idioms.

Textbook : Lung Sing, *Basic Cantonese in One Hundred Hours*.

310. Cantonese II. C. Y. Ma, B.A. (Sun Yat-sen), Language Tutor, University of Hong Kong. *Mondays and Thursdays, 2.00-3.00 p.m., starting March 15, 1976. Extra-Mural Town Centre. 30 meetings. Fee: \$220*

311. Cantonese II. C. S. Hung, B.A. (Chinan), Language Tutor, University of Hong Kong. *Mondays and Thursdays, 7.30-8.30 p.m., starting March 15, 1976. Room 227, Knowles Building, University of Hong Kong. 30 meetings. Fee: \$220*

For those students who have completed Cantonese II, an extension course can be arranged on request so as to enable them to sit for the Elementary Examination in Cantonese held by the General Chamber of Commerce, four times a year.

Chinese Characters

The study of Characters through Cantonese will include etymology of characters, vocabulary, and classical reference of idioms. Special effort will be made to give students practice in writing characters and in finding characters in Chinese dictionaries.

Priority will be given to students who have completed Cantonese I and II, but those who are doing Cantonese II or who can prove that they have adequate knowledge of Cantonese are also welcome to join.

Textbook: John de Francis, *Character Text for Beginning Chinese* (Yale University Press).

312. Chinese Characters I. Francis Sham, B.A. (Sun Yat-sen). *Wednesdays, 6.10-7.25 p.m., starting March 10, 1976. Room 141, University Main Building. 20 meetings.* **Fee: \$200**

313. Chinese Characters I. C. Y. Ma, B.A. (Sun Yat-sen), Language Tutor, University of Hong Kong. *Tuesdays, 3.30-4.45 p.m., starting March 9, 1976. Extra-Mural Town Centre. 20 meetings.* **Fee: \$200**

314. Chinese Characters II. Francis Sham, B.A. (Sun Yat-sen). *Wednesdays, 7.35-8.35 p.m., starting March 10, 1976. Room 141, University Main Building. 20 meetings.* **Fee: \$250**

Apart from giving the analysis of character structure, order of strokes and etymology, the course will focus on pronunciation, comprehension, usage of single words, compounds and idioms. Students will be provided with adequate practice in reading and writing characters.

Textbook: John de Francis, *Character Text for Beginning Chinese* (Yale University Press).

JAPANESE

日語文憑班 (Certificate Course in Japanese)

宗旨：本課程的開設是完全適應香港環境之所需，提供一項有系統性而分階段的日語訓練，給予一般從事工商、文教等各業人仕一種進修日本語文的機會，以提高他們的工作條件及通過日語的學習，進而加深了解另一種文化。

課程概括：本課程共分初級班、中級班、高級班等三階段，每階段為期半年。初級班着重日語的發音，中日語法的比較，「假名」基本文法，基本常用語句及商業會話等。中級班着重實用日語會話，文法則包括動詞用法及語句結構等等，以期學員於修業期滿後，能應付各種場合之日語交談及閱讀日文報刊。高級班着重較高程度之語言運用，文字寫作及閱讀，較艱深文句之分析，以期學員能充份操縱此種語文。

主講人：初級班由曾經留學日本之華人導師主持，彼等均有多年教授日語經驗，並曾在各大學任教。中級班及高級班由精通中國語文之在職大學日語講師主持，故在學習過程中，學員均不會在聽講時有語言上之困難。

入學及考試：本部只收初級班學生，此等學生將按階段升上中級班及高級班。高級班結業考試合格後，本部將頒發日語文憑。此項文憑之頒發，又需符合下列兩種條件：（1）學員在高級班上課次數超過四份之三；（2）並在學習過程中，充份完成所有習作。

315. 初級日語 (Introductory Japanese)

主講人：陳志誠碩士（香港理工學院講師）。

講授語言：粵語。

地點：香港大學校本部 142 室。

時間：一九七六年三月十一日起每星期一及星期四下午六時零五分至七時二十分。（共四十講）。

學費：一百六十元。

（此課程將於一九七六年秋季重辦）

316. 初級日語
(Introductory Japanese)

主 講 人：詹德湛學士。

講授語言：粵語。

地 點：香港大學校本部 217 室。

時 間：一九七六年三月十一日起每星期一及星期四下午七時十五分至八時半。（共四十講）。

學 費：一百六十元。

（此課程將於一九七六年秋季重辦）

317. 初級日語
(Introductory Japanese)

主 講 人：黃鉅鴻碩士（香港中文大學聯合書院副講師）。

講授語言：粵語。

地 點：九龍柯士甸道 162 號，聖瑪利嘉諾撒女書院，廿四號課室。（入口處在金巴利道與柯士甸道交界處）。

時 間：一九七六年三月八日起每星期一及星期五下午七時四十五分至九時。（共四十講）。

學 費：一百六十元。

（此課程將於一九七六年秋季重辦）

318. 初級日語
(Introductory Japanese)

主 講 人：孫元章學士（前任大阪商科大學語文教師）。

講授語言：粵語。

地 點：香港大學校外課程部市區中心。

時 間：一九七六年三月二日起每星期二及星期五下午八時四十五分至十時。（共四十講）。

學 費：一百六十元。

（此課程將於一九七六年秋季重辦）

**319. 初級日語
(Introductory Japanese)**

主 講 人：黃鉅鴻碩士(香港中文大學聯合書院副講師)。

講授語言：粵語。

地 點：九龍柯士甸道 162 號，聖瑪利嘉諾撒女書院，
廿四號課室。(入口處在金巴利道與柯士甸路
交界處)。

時 間：一九七六年三月八日起每星期一及星期五下午
六時十五分至七時半。(共四十講)。

學 費：一百六十元。

(此課程將於一九七六年秋季重辦)

初級日語班課本：よみかた(日本國際學友會日本語學校
編)

**320. 中級日語
(Intermediate Japanese)**

主 講 人：陳志誠碩士(香港理工學院講師)。

講授語言：日語及粵語。

地 點：香港大學校本部 142 室。

時 間：一九七六年三月八日起每星期一及星期四下午
七時半至八時四十五分。(共四十講)。

學 費：一百六十元。

(此課程將於一九七六年秋季重辦)

**321. 中級日語
(Intermediate Japanese)**

主 講 人：伊達政之(前香港中文大學新亞書院日文講師，
香港第一日文專科學校校長)。

講授語言：日語及國語。

地 點：香港大學校本部 142 室。

時 間：一九七六年三月十二日起每星期二及星期五下
午六時零五分至七時二十分。(共四十講)。

學 費：一百六十元。

課 本：伊達政之編著：最新實用日語讀本(香港第一
日文專科學校發行)。

(此課程將於一九七六年秋季重辦)

322. 高級日語
(Advanced Japanese)

主 講 人：伊達政之。

講授語言：日語及國語。

地 點：香港大學校本部 142 室。

時 間：一九七六年三月十二日起每星期二及星期五下午七時半至八時半。（共四十講）。

學 費：一百六十元。

截止報名日期：一九七六年三月五日。

課 本：伊達政之編著：最新實用日語讀本（香港第一日文專科學校發行）。另加補充教材。

（此課程將於一九七六年秋季重辦）

Oriental Studies

Staff Tutor : O. H. H. Wong, Telephone 5-468161 Ext. 309

LITERATURE

323. **韓柳各體文比較**
(The Prose of Han Yu and Liu Tsung-yuan: A Comparison of Their Styles)

主 講 人：蘇文擢先生（香港中文大學聯合書院中國文學系講師）。

講授語言：粵語。

地 點：香港大會堂九樓北演講室。

時 間：一九七六年二月十一日起每星期三下午八時至九時。（共十六講）。

學 費：五十五元。

上期「韓柳文選講」側重於二家文章風格之異同，本課以古文各種體式為經，每體精選韓柳文各一篇，詳加解說，使學者於二家文章有更具體之領會，從而增加其欣賞或摹寫之興趣。

凡未選修上期課程者亦可參加。

324. **杜工部詩**
(The Poems of Tu Fu)

主 講 人：陳湛銓先生（嶺南書院中國文學教授）。

講授語言：粵語。

地 點：九龍尖沙咀柯士甸道 162 號，聖瑪利嘉諾撒書院廿四號課室。（入口處在金巴利道與柯士甸路交界處）。

時 間：一九七六年二月十九日起每星期四下午七時半至九時。（共十二講）。

學 費：五十五元。

詩聖之製，無須介紹矣！依編年精選講授其古近體詩，先述是年天下大事，次述杜公出處，是正仇兆鰲注，用楊倫圈點而不然者增減之，自編講義，影印派發，評與注皆務精覈詳盡。

325. 中國古典文學選講（第一輯）

(Selected Topics in Chinese Classical Literature)

主 講 人：袁效良先生(前香港電台教育文化節目撰述員)

講授語言：粵語。

地 點：香港大會堂九樓南演講室。

時 間：一九七六年二月廿日起每星期五下午七時至八時。(共十二講)。

學 費：四十元。

中國典籍浩浩，若江海然，非一人之腹所能盡飲也。本課程特濃縮所有代表作，內容包括經史子集精華，選講尚書，詩經，左傳，唐宋古文，唐詩，宋詞，元曲，明小說及清文學名篇。首重詞章之欣賞與理解，其次認識文章之體裁與風格，末則學習寫作淺易文言文，以收實用之效。其他對中國文學有興趣之社會人士亦歡迎參加。

本課程先行選講第一輯，日後繼續編配若干輯，務使學者深得研究中國古典文學之旨趣。本課程為中學國文教師，提供專業上之幫助。

申請教署付還學費手續：凡政府，補助，與私立學校之中四至中七班中文科教師進修此門課程，而欲教育司署支付學費，可向香港大學校外課程部索取表格，於開課前交回教育司署。

326. 中國現代小說

(Modern Chinese Fiction)

主 講 人：郭懿言女士。

講授語言：粵語。

地 點：香港大會堂九樓南演講室。

時 間：一九七六年二月二十日起每星期五下午八時至九時。(共十二講)。

學 費：四十元。

五四為中國文學史上一大轉變，而小說的發展更為新文學發展路向的一個重要部份。本課程把一九一九年至一九四九年間的小說，與及各家風格之異同，作概括性的介紹，以小說的題材為經，時代背景為緯，按作品的內容探討其時代的重要性，並參照西洋文學和晚清小說，以比較文學的方法，溯尋五四小說的發展途徑；並就五十年代以後國內、臺灣、香港各地小說內容的分歧，作簡要的研討。講授時將特別提及魯迅、巴金、茅盾、老舍、郁達夫、沈從文、冰心等人之作品，及其作品所表現之反封建、揭露現實、探討人生、宣傳抗日、革命文學、唯美主義、現實主義、鄉土文學等之特性。

ART

327. 中國陶瓷藝的發展 (The Development of Chinese Ceramics and Porcelain)

主 講 人：何秉聰先生。

講授語言：粵語。

地 點：香港大學校外課程部市區中心。

時 間：一九七六年二月二十日起每星期五下午六時至七時。（共十二講）。

學 費：五十元。

自新石器時代至現在，有關陶瓷製造之發展，包括技法、形制變遷之比較及歷史背景之影響等；廣集前人意見，配合講述者製作經驗，作客觀之總結，附以幻燈片、實物作解釋印証，并參觀本港及鄰近地點之製陶情形及古物收藏，以資參考，使社會上一一般陶瓷愛好者，增加收藏的知識及欣賞的樂趣。

PHILOSOPHY

328. 佛家哲學（三） (Buddhist Philosophy)

主 講 人：羅時憲先生。

講授語言：粵語。

地 點：香港大學校外課程部市區中心。

時 間：一九七六年二月十六日起每星期一下午七時四十五分至九時四十五分（共十二講）。

學 費：五十五元。

佛家思想影響中國及整個亞洲之文化至大，本部特別分期開辦此項課程，以闡釋其源流，派別及思想，主要內容包括：

（一）佛家哲學中的幾個基本原理，（二）佛家思想發展的幾個重要階段，（三）佛教經典形成，（四）原始佛教概觀，（五）大乘空有兩系思想概觀，（六）中國佛教思想概觀，（七）西藏佛教思想概觀。

凡未選修佛家哲學（一）（二）者亦可參加。

329. 中國歷代思想選講
(Selected Chinese Thinkers)

主 講 人：鄭炯堅碩士。

講授語言：粵語。

地 點：香港大學校外課程部市區中心。

時 間：一九七六年二月二十日起每星期五下午六時十五分至七時十五分。（共十二講）。

學 費：四十元。

下列所選講之人物及著作，均特重剖析其「思想」之背景、特質、意義、價值與影響，以期藉着探討前人思想之結晶，引導學員通過自己之慎思明辨，獲得智慧啟發，與生活受用之效果。課程包括：

（一）周易、墨子、老子、莊子、公孫龍子、荀子、韓非子（附析「儒法鬥爭」之癥結），呂不韋（附「雜家」與西方「折衷主義」之比較）。

（二）劉勰、韓愈、柳宗元、施耐庵（附析左右兩派「水滸傳」思想之新批判）。

（三）朱熹及王陽明（附宋時理學特色）。

（四）康有為、梁啟超、陳獨秀、李大釗、魯迅、胡適，（附中西文化交流與影響）。

下期將續辦中國思想家著作選讀與專題研究，使學員能對中國思想有一更全面性與系統性之認識。

330. **Man and Society in Traditional Chinese Thought.** Miss Margaret N. Ng, B.A., M.A. (H.K.), Ph.D. (Boston). *Fridays, 3.45-5.15 p.m., starting February 13, 1976. Extra-Mural Town Centre. 8 meetings.*
Fee: \$45

The questions of man and society have always been a central concern in traditional Chinese thought. What is an ideal society and how can we attain it? How can each person contribute towards it? What is the relation between man and society? This series of lectures attempts to give an introduction to the views of the four major schools of thought, Confucianism, Taoism, Moism and Legalism, on this important matter. Different views are given; but there are interesting common points between them, and they still affect the way of thinking of the modern Chinese. Although this course will concern itself mainly with traditional thought, it is a useful preparation for the understanding of modern China.

JAPANESE STUDIES

331. Japan: Its Old Tradition and Modern Transformation. Jim Bullen, M.A. (Sydney), formerly Lecturer in Japanese Studies, University of New South Wales. *Wednesdays, 7.00-8.00 p.m., starting February 11, 1976. City Hall Lecture Room North, 8th floor. 16 meetings. Fee: \$65*

For a deeper understanding of the different aspects of Japanese life and thought, a general historical and sociological background to modern-day Japan is provided. In particular, the course concentrates on the changes within Japan during the Tokugawa Period (1603-1868) and the industrialization of Japan during the Meiji period (1868-1912). This course also treats the political and social thought of the Japanese people; the background to the postwar Japanese "economic miracle"; the literature, art, and religions of the Japanese people; and the Japanese business and employment systems. Each lecture will have some time devoted to the pronunciation of the Japanese language, including place and family names, and common words in Japanese.

See also :

- 231. **History of Chinese Art.** (Page 9)
- 234. 書道基本. (Page 10)
- 243. **Introduction to the Art of South-East Asia.** (Page 14)
- 244. **Traditional Chinese Performing Arts in Hong Kong.** (Page 14)
- 245. **Development of Chinese Theatre Costumes.** (Page 14)
- 254. 中國經濟. (Page 19)
- 284. **Personalities and Politics in Contemporary China.** (Page 35)
- 285. **Women and Society in Modern China.** (Page 35)
- 286. 中國史籍論畧. (Page 36)
- 287. 現代中國社會政治的變遷. (Page 36)
- 296. 中國地方音樂. (Page 42)
- 339. **The Western Impact on Modern Chinese Political Thought.** (Page 62)
- 340. **Mao Tse-tung: His Career and Political Thought.** (Page 62)
- 341. 毛澤東思想——馬克思列寧主義理論的結合中國實際. (Page 63)
- 351. **Social Services in China to-day.** (Page 70)

Philosophy and Psychology

Staff Tutor : H. K. Wong, Telephone 5-468161 Ext. 308

332. Introduction to the Philosophy of Science. Margaret N. Ng, B.A., M.A. (H.K.), Ph.D. (Boston). *Mondays, 8.00-9.30 p.m., starting February 16, 1976. Room 743, Knowles Building, University of Hong Kong. 12 meetings. Fee: \$70*

Topics discussed will include science as an understanding of the world, science and religion, the role of experience in scientific discovery, the formation, testing and verification of scientific laws and theories, and the relevance of science to life and society, especially the nature and impact of a 'scientific education'. The views of several major schools of thought on these topics will be summarized, examined and discussed. No previous study of the philosophy of science is necessary.

333. Approaches to Psychotherapy & Behaviour Modification. Joseph A. Precker, Ph.D. (Columbia), Lecturer in Psychology, University of Hong Kong. *Tuesdays, 6.00-8.00 p.m., starting February 10, 1976. Room 846, Knowles Building, University of Hong Kong. 5 meetings. Fee: \$40*

This short course will review several of the present-day approaches to psychotherapy and behaviour modification for dealing with non-psychotic persons. Included for discussion, will be "counselling", psychoanalysis, behaviour modification techniques, and milieu therapy. A brief outline of each method will be presented and a critique of the values and limitations of each of the approaches will be discussed.

334. 謬誤與詭辯
(Fallacy and Sophistry)

主 講 人：黃展驥先生。

講授語言：粵語。

地 點：香港大學校外課程部市區中心。

時 間：一九七六年二月二十日起每星期五下午六時至七時三十分。(共八講)。

學 費：五十元。

本港近年來對思想方法漸趨重視，有關「謬誤」與「詭辯」等若干概念常出現於報章、刊物、辯論和談話之中。本課程共八講，每講一小時半。內容包括：

(一) 應否訴諸權威；(二) 應否人身攻擊；(三) 論「不相干」；(四) 詞語的情緒色彩；(五) 以情害意的謬誤；(六) 切斷因果的謬誤；(七) 假值保留的謬誤。

務求學員能養成嚴謹的思考，分析的頭腦，和判別是非對錯的能力。適合高中和大專程度的人士。

335. 民主自由是什麼？
(What is “Freedom” and “Democracy”?)

主 講 人：黃展驥先生。

講授語言：粵語。

地 點：香港大學校外課程部市區中心。

時 間：一九七六年二月十六日起每星期一下午八時至九時三十分。(共十講)。

學 費：六十元。

歷來不少戰爭、暴亂、殺戮，敵對的雙方大多訴說是爲了爭取民主自由。「不自由，毋寧死！」是常聽到的口號。可是：

(一) 自由是什麼呢？是否不受縛束而爲所欲爲？(二) 民主是什麼呢？數年投票一次以更換總統是否民主？爲人民服務是否民主？(三) 民主與自由有什麼關係呢？(四) 十餘年的填鴨式教育是否自由？(五) 推銷員、售貨員、工人階級、白領階級有否自由？(六) 自由與人權有什麼關係？(七) 自由與選擇有什麼關係？(八) 自由與財富有什麼關係？(九) 個人自由與國家自由有什麼關係？

這一連串的問題，就是本課程討論的中心。本課程共十講，每講一小時半。適合高中或以上程度的學員，歡迎自由發言討論。

336. 先進工業文明與現代思潮
(Advanced Industrial Civilization and Modern Thought)

主 講 人：曾澍基先生。

講授語言：粵語，輔以英語。

地 點：香港大學鈕魯詩樓 721 室。

時 間：一九七六年三月九日起每星期二下午七時至八時三十分。（共十二講）。

學 費：七十元。

從內在的精神狀態或外在的社會實況看來，先進的工業文明都正處於危機與劇變的階段。近百年所湧現的各類思潮，亦以不同的方式，直接或間接地顯示其種種的問題及矛盾。本課程將就其中具有特別反映意義的流派：如存在主義、心理分析、馬克思主義和新左思潮等，評介它們的理論要點，並討論其產生背景，以及對社會文化的影響。講者希望透過這些評介和討論，可以使學員對現階段的先進工業文明所面臨的各種問題，有一概括性的理解。

337. 社會心理學簡介
(Elements of Social Psychology)

主 講 人：岑傑興先生。

講授語言：粵語。

地 點：香港大學校外課程部市區中心。

時 間：一九七六年二月二十四日起每星期二下午六時至七時三十分。（共十講）。

學 費：六十元。

社會是由人羣組合而成的團體，人生存於其中，兩者遂產生一些互相的影響，並有莫大的關連。

社會心理學，簡言之是研究社會與人的互相影響作用，本課程乃藉一些日常生活的現象及學者研究，實驗所得，對社會心理學作一簡介，其中包括，如印象的形成、人與人之間的吸引力、偏見及歧視等等。更討論羣體生活對個人的影響，最後並對現社會一些不正常現象及問題作探討。

課題討論所引之例子，將着重趣味化及與日常生活有直接關連者。參加學員無需對心理學有基本認識。

338. 心理學基本原理 (二)
(Basic Principles in Psychology II)

主 講 人：梅錦榮先生。

講授語言：粵語。

地 點：香港大會堂八樓南會議室。

時 間：一九七六年二月十六日起每星期一下午七時至
八時三十分。(共十二講)。

學 費：七十元。

這是心理學基本原理(一)的延續，目的是叫學員能夠對這課題內的其他方面有充份的了解，以達到對心理學基本原理有全面性的認識，內容將包括下列分題：

- 一、情 緒——包括其性質與理論；情緒的發展及其對生理的變化與心理健康的關係。
- 二、動 機——動機的性質，生理與心理的動機；動機的測量法；研究動機應考慮的要點，與及動機理論等。
- 三、衝突與挫折——衝突的性質及其主要形式，挫折的性質；挫折後立即的反應，焦慮及減除焦慮的主要防衛方式。
- 四、知 覺 心 理——感覺與知覺的分別，知覺的組織，知覺防衛機序，錯覺與幻覺及影響知覺的個人及社會因素。
- 五、智 力——智力的定義；智商；智力測驗；心理測驗的效度和信度；智力的成長與衰退；遺傳與環境的因素等。

會修讀心理學基本原理(一)的學員，將被優先考慮參加這課程。

See also:

328. 佛家哲學. (Page 55)

349. 兒童的成長與學習. (Page 69)

Political Science

Staff Tutor : O. H. H. Wong, Telephone 5-468161 Ext. 309

339. The Western Impact on Modern Chinese Political Thought.

Owen H. H. Wong, M.A. (H.K.), Ph.D. (Cantab.), K. C. Fok, M.A. (Hawaii), Lecturer in History, University of Hong Kong. *Thursdays, 6.15-7.45 p.m., starting February 19, 1976. Room 167, University Main Building. 7 meetings.* **Fee: \$45**

The tactics of "playing off one barbarian against another" of the late Ch'ing period; the slogan of "complete Westernization" during the early Republican era; and the recent trend of the "Sinification of Marxism", have all dominated the political scene of modern China. To understand the real background and the extent that Western political thought influences China, the following topics will be chosen for discussion; the Western Influence on the late Ch'ing Diplomacy; Evolutionism and Chinese Reform Movement; the Western Origin of Sun Yat-sen's Principles; early Socialism and Anarchism in China; the prevalent schools of Western Thought during the May 4th Movement; Li Ta-chao and Ch'en Tu-hsiu and Communism; the Impact of Russian Communism on the Nationalist and Communist Parties.

340. Mao Tse-tung: His Career and Political Thought.

Mark J. Sherman, M.A. (N.Y.U.), formerly Assistant Professor in History, N.Y.U. *Tuesdays, 6.15-7.45 p.m., starting April 13, 1976. Room 167, Main Building, University of Hong Kong. 8 meetings.* **Fee: \$45**

Initially the focus will be on understanding the development of Mao in the context of modern China's revolutionary experiences. Since becoming the leader of the Chinese Communist Party, Mao's activities and writings have had significant influence not only in the People's Republic of China but in the entire socialist and democratic world as well. Main themes in the thoughts of Chairman Mao will be examined, such as "Mass Democracy and Political Participation", 'Contradictions in Society', 'Economic Development' and 'Continuous Revolution'.

At all points Mao will be discussed as an integral part of modern China's developmental experience and attention will be paid to the political and economic context of his activities.

341. 毛澤東思想——馬克思列寧主義理論的結合中國實際
(Mao Tse-tung's Thought: The Adaptation of Marxism-Leninism to China's Situation)

主 講 人：金思愷先生
(香港大學亞洲研究中心高級研究員)。

講授語言：國語。

地 點：香港大學校本部 167 室。

時 間：一九七六年二月廿日起每星期五下午六時半至八時。(共十二講)。

學 費：六十元。

毛澤東思想並不是憑空想出來的思想，是從實踐得來又回到實際中去實踐的思想。他不僅發展了馬克思列寧主義，而且將發展了的理論結合起中國與世界的實際中來實踐。上季介紹前一方面，本課程則著重的說明後一方面。本課程適合一般對中國歷史、政治與思想有興趣的人仕選修，為認識當代中國背景的一種途徑。

Science

Staff Tutor : D. R. Kemp, Telephone 5-468161 Ext. 551

342. Basic Principles of Computer Systems. P. P. Melwani, B.Sc. (Eng.) (H.K.). *Fridays, 6.15-7.15 p.m., 7.30-8.30 p.m., starting February 13, 1976. Room DS3, Duncan Sloss Building, University of Hong Kong. 12 meetings.* **Fee: \$100**

The course aims to provide an explanation of how computer systems operate. It is designed for people who have no previous knowledge of computers and is especially suitable for people thinking of taking up data processing as a career, as well as those employees whose work involves contact with computer systems. It may be considered as a preliminary to the "Certificate Course in Digital Computer Programming".

The syllabus will include: number systems and elementary arithmetic procedures; data processing organisation chart; the nature of data processing systems; input; storage; processing; control; output; input/output units; storage units; central processing and control; methods of processing, batch processing; random access; real time.

PRIOR ENROLMENT IS ESSENTIAL

Failure to enrol prior to the opening of a particular course may mean the cancellation of that course. Prior enrolment is the only way the Department of Extra-Mural Studies has of judging the response to its courses. Your co-operation is therefore invited in sending your application forms to the Department as soon as possible.

343. Hong Kong Ecology. Mondays, 6.15-8.15 p.m., starting February 9, 1976. Northcote Science Building, Department of Zoology, Lecture Room 302, Laboratory 213, University of Hong Kong. 14 meetings. Fee: \$130

Tutors: D. S. Hill, M.Sc., Ph.D., F.L.S., M.I.Biol., M.B.O.U.
B. Gott, Ph.D.
B. S. Morton, Ph.D., F.L.S.
R. C. C. Ko, M.Sc., Ph.D.

The course will deal with some basic ecological principles, including environmental factors, biological productivity, food webs, succession, adaptive radiation and aspects of applied ecology. The flora and fauna of Hong Kong will be considered systematically and comparatively under about twelve different local habitat categories. The species of plants and animals included will be the commonest and most abundant locally, but some will be mentioned because of their particular ecological interest.

It is intended to be of especial use to local biology teachers, particularly those at fifth and sixth form level, but also will be useful to any naturalists seriously interested in the local flora and fauna.

Each meeting will consist of a lecture followed by a practical laboratory session or else a double lecture period, and there will be laboratory demonstrations or field excursions to visit specific habitats on Saturdays. The field trips will be on Saturday mornings where possible, but some might be on Saturday afternoons to coincide with low tides.

Fee Refund: Teachers of Biology in fourth, fifth and sixth forms who wish to attend the above course may apply for a fee refund from the Director of Education. Applicants are required to complete an application form (obtainable from the Department of Extra-Mural Studies, University of Hong Kong) which must be returned directly to the Director of Education before the commencement of the course. This applies to all teachers whether in Government, aided or private schools.

344. 天文愛好者與望遠鏡
(The Amateur Astronomer and His Telescope)

主 講 人：廖慶齊先生。

講授語言：粵語。

地 點：香港大學校外課程部市區中心。

時 間：由一九七六年二月二十日起每星期五下午八時
至九時三十分。（共十四講）。

學 費：六十元。

本課程目的在使天文愛好者認識天文望遠鏡的種類和應用，並介紹製造牛頓式天文望遠鏡的方法。每講用幻燈片輔助解釋，內容包括：望遠鏡演進史，望遠鏡的種類和原理，天文愛好者的望遠鏡，光學部份的設計與製造，附件的選擇和應用，望遠鏡的裝配、使用與保養，天文愛好者的觀測室等。

345. 日常營養學
(Nutrition in Everyday Life)

主 講 人：葉陳以利女士。

講授語言：粵語。

地 點：九龍尖沙咀疏利士巴利道
基督教男青年會 Thornton 室。

時 間：一九七六年二月二十日起每星期五下午六時卅
分至八時。（共十六講）。

學 費：七十五元。

本課程旨在介紹一般基本營養學知識，以應用於日常飲食生活，內容包括營養學之意義；食物之主要成份，脂肪蛋白質，維他命及礦物質對人體之功用；嬰兒，兒童，成人，孕婦及老年人所需要之營養；餐膳之計劃，如何利用食物來應付普通的不適，如胃病，過重，糖尿病等；食物營養素之保存方法及烹製時所引起之影響；並通過集體討論，糾正一般人對補品及其他食物之偏嗜與誤解。

See also :

332. Introduction to the Philosophy of Science. (Page 58)

Social Work and Sociology

Staff Tutor : H. K. Wong, *Telephone* 5-468161 *Ext.* 308

346. Some Current Local Research Studies Related to Social Welfare. *Wednesdays, 6.15-8.15 p.m., starting February 18, 1976. Room 121, Main Building, University of Hong Kong. 7 meetings. Fee: \$60*

- (1) Social Policy in Hong Kong, Professor Peter Hodge, M.A., Dip.Soc.St. (Nott.), M.B.A.S.W., Head, Department of Social Work, University of Hong Kong.
- (2) Hong Kong Government and Politics, N. J. Miners, M.A. (Oxon), Ph.D. (Exeter), Senior Lecturer in Political Science, University of Hong Kong.
- (3) Income Distribution in Hong Kong, L. L. C. Chau, M.S., Ph.D. (Wisc.), Lecturer in Economics, University of Hong Kong.
- (4) Growing Up in Hong Kong—A Longitudinal Study, Mrs. F. M. Baber, M.B., Ch.B. (Manc.), D.C.H. (Lond.), M.R.C.P. (Edin.), Honorary Clinical Lecturer in Paediatrics, University of Hong Kong.
- (5) Social Security Systems—A Comparative Study of Hong Kong, Malaysia, Philippines and Singapore, Nelson W. S. Chow, M.A. (Manc.), Dip.Soc.St. (H.K.), Lecturer in Social Work, Institute for Social Work Training.
- (6) Housing Provision and Housing Needs in Hong Kong, Luke S. K. Wong, M.A. (H.K.), Assistant to the Dean of Students, University of Hong Kong.
- (7) Youth Service Provisions in Shek Pai Wan, Mrs. M. J. Carter, B.A. (Exeter), Dip.Ed., Cert.Ed., Dip.Soc.St. (Edin.), Lecturer in Social Work, University of Hong Kong.

All of the research studies in this highly selective list are either recently completed or still in the process of completion. They are of special relevance to the work of social service administrators, social workers, educators, researchers and to the interested public. During these seminar-oriented meetings, the researchers will briefly introduce the purposes and methodology of their study, then concentrate on presenting their findings and recommendations together with the rationales behind them. There will be ample opportunities for discussion and elaboration of those points of interest to the participants. Some selected background materials will be sent to the enrolled audience in advance for more informed discussion.

347. Current Health Issues. Raymond Tang Chiu Ping, B.A. (Tufts), M.P.H. (Yale). *Thursdays, 6.15-7.45 p.m., starting February 12, 1976. Room 248, Knowles Building, University of Hong Kong. 12 meetings.*

Fee: \$75

Health is now regarded as a basic human right. More and more countries, in the underdeveloped world as well as the developed, are paying increasing attention to their health services. At the same time, the disease-oriented, curative, medical approach to health is being seriously questioned.

Current issues in the health field will be discussed, with particular reference to community health. Topics to be covered will be selected from the following: community health, preventive medicine, consumerism in health services, health insurance, allied health professions, health manpower resources, health economics, mental health & social policy, traditional Chinese medicine, the hospital, chronic care, management of geriatrics.

The course is especially suitable for health administrators, nurses, social workers, those involved in mental and community health, and the interested public.

Enrolment is limited to 20 persons.

348. 住院福利工作 (Residential Social Work)

主 講 人：周馬允明女士。

講授語言：粵語，輔以英語。

地 點：香港大學校本部 103 室。

時 間：一九七六年二月十七日起每星期二下午六時三十分至八時。（共十講）。

學 費：六十元。

本課程旨在探討院護福利服務對住院人士身心發展及性格行為之影響，使從事院護工作人員對住院者之特殊需要及行為表現，能有基本之了解及認識，並如何運用院內外環境資源，以達到治療及照顧之功用。

課程包括院護服務之目的，行政制度及發展趨向，並討論院護服務與家庭及社區之關係。香港現行各類院護照顧，如兒童院、安老院、傷殘康復院、青年宿舍、感化院、戒毒治療中心等，亦將詳加一一討論。課程並包括院護福利人員之工作技巧及應有態度，對從事這方面之社會工作者，當更為適合。

**349. 兒童的成長與學習
(Child Growth & Learning)**

主 講 人：蘇華福女士。

講授語言：粵語，輔以英語。

地 點：香港大學校本部 121 室。

時 間：一九七六年二月十九日起每星期四下午六時四十五分至八時十五分。（共十二講）。

學 費：七十元。

兒童期乃是學習及模仿能力最高的時期，若能對這個階段的成長及學習能力加以認識，便能對引導兒童的身心發展，學習及啓示有所幫助，因而培養平衡的性格。講授內容將包括：四歲至十二歲學童的特性，學習的氣氛，及情緒，智力，體能的發展，創作力的培養，玩具與遊戲對學童的啓發，如何運用學習的理論來協助學童充分吸收新智識及引導發展平衡的性格等。

此課程特別適合家長，教師及從事兒童之福利工作者及義務工作人員等。歡迎學員提出實例加以研討。

**350. 社會學導論
(Introduction to Sociology)**

主 講 人：黃紹倫先生（香港大學社會學講師）。

講授語言：粵語。

地 點：香港大學鈕魯詩樓 418 室。

時 間：一九七六年二月十三日起每星期五下午六時四十五分至七時四十五分。（共十二講）。

學 費：七十元。

這課程的重點在介紹社會學的基本概念和重要的理論，例證將盡量取材於香港社會，使理論能夠結合日常經驗，對象主要是可能日後進修社會科學的同學，和希望對我們的社會有一個較深入認識的朋友。

課程內容分三部份：

- (一) 社會學的鳥瞰：社會學發展簡史；社會結構和社會變遷的理論。
- (二) 社會結構各方面的分析，包括人口，家庭，政治組織，經濟組織，信仰和意識形態等。
- (三) 香港社會問題的評論，例如犯罪，貧富懸殊，都市問題等。

351. Social Services in China Today (Part II). Tutor to be announced. Mondays, 6.15-7.45 p.m., starting February 16, 1976. Thornton Room No. 2, 2/F., Y.M.C.A. (New Wing), Salisbury Road, Tsimshatsui, Kowloon. 10 meetings. **Fee: \$60**

“Each village, each brigade in the whole of China is in a state of transformation. Everywhere new methods are being tried out. New methods for the school, new ways in production, new ways in income distribution. . . . And this has meant the liberation of the Chinese people’s power of initiative. . . . Experiments are made, experiences spread, people learn from one another.”—Jan Myrdal.

The ground partly covered in the earlier course will be extended by inviting a number of Chinese specialists to speak on their specialism. Topics to be thus covered will include child rearing and socialization, education, health care, role of women, rehabilitation, and care for the aging.

The overall significance of China’s social experiment will also be discussed. Those who did not attend the Part I course are also welcome to enrol.

Housing Management

*Staff Tutors : Mrs. Priscilla Tso, Telephone 5-468161 Ext. 303;
Mr. H. K. Wong, Telephone 5-468161 Ext. 308.*

Certificate in Housing Management

The aim is to provide a local qualification in Housing Management for people already working in the field and for others hoping to take up housing management as a career. The course is intended to provide a firm grounding in the theory and practice of housing management.

The standard and content of the course and its examinations are designed to be the equivalent of the Diploma in Housing Management sponsored by the United Kingdom Institute of Housing Managers. The syllabus is related to that of the Institute but is strongly geared to local relevance.

The course runs over three academic years. Year I prepares candidates for the Intermediate Examination and Years II and III for the Final Examinations.

A Certificate in Housing Management, issued by the Department of Extra-Mural Studies, University of Hong Kong, will be awarded to a candidate on passing the Final Examination and on producing evidence of having had at least three years' approved experience in housing management work.

Further details are available on request.

Applications for 1976-77 must be submitted between March 1 and May 1, 1976. Preference will be given to applicants sponsored by their employers.

PRIOR ENROLMENT IS ESSENTIAL

Failure to enrol prior to the opening of a particular course may mean the cancellation of that course. Prior enrolment is the only way the Department of Extra-Mural Studies has of judging the response to its courses. Your cooperation is therefore invited in sending your application forms to the Department as soon as possible.

預早報名之重要

及早報名乃是使本部得知各界對種種課程反應之唯一途徑，如不及早報名則往往引致各該課程延期或取消。故有志修讀本部課程者，敬希從速將報名申請書寄回本部。

University of Hong Kong Department of Extra-Mural Studies

香港大學校外課程部

The whole of this form together with the appropriate fee should be sent to
DIRECTOR OF EXTRA MURAL STUDIES
UNIVERSITY OF HONG KONG.

申請書與費後附學費送交香港大學校外課程部主任

Payment may be made in cash or by cheque at the University or by post. Cheques should be crossed and made payable to "University of Hong Kong".

繳費可用支票或現金，如用支票請以「香港大學」名義抬頭，並加橫線，逕寄本部。

The issue of an Enrolment Acknowledgment does not of itself constitute acceptance of the application, but if you do not hear otherwise before a course starts, you may assume you have been accepted. If for any reason you are not accepted your fee will be returned, but otherwise fees are not normally refundable.

除非課程臨時取消或改期，請依照公佈日期上課，本部不另通知。如報名申請未被接受，學費將退還；但課程開始後，學費通常不能退還。



UNIVERSITY OF HONG KONG 香港大學
EXTRA MURAL STUDIES 校外課程

APPLICATION FOR ENROLMENT 報名申請書

Please use a separate form for each course 每一申請書只適用於一項課程

Course No. 課程號碼 _____ Course name 課程名稱 _____

Fee enclosed 附學費 \$ _____ Cash/Cheque No. 現金 支票號碼 _____

Name in full 姓名 (Mr./Mrs./Miss) English 英文 _____
(in block letters—surname first)
Chinese 中文 _____

Courses, if any, previously taken in this subject 如曾修讀與該科目有關之課程，請列出該課程名稱

Name in full 姓名 (Mr./Mrs./Miss) English 英文 _____
(in block letters—surname first)
Chinese 中文 _____

Correspondence address 通訊處 _____

Office address 辦事處地址 _____

Telephone Nos. 電話 Home 住宅 _____

Nationality 國籍 _____

Occupation 職業 _____

Education (please tick) 教育程度 (請加 1 於適當方格內)

- Primary 小學
 Secondary 中學
 Technical or Post-Secondary College 工專或大專

- College of Education 師範
 University 大學
 Post graduate 研究院

Educational qualifications (matriculation, professional, degree etc.) 資歷 (大學入學試、專業、學位等)

Date 日期 _____ Signature 簽字 _____

For Office Use 不必填寫 _____ X

Date 日期 _____ Reg. No. 註冊號碼 _____ Course No. 課程號碼 _____ Amount 金額 _____

For Office Use 不必填寫 _____ X

Date 日期 _____ Reg. No. 註冊號碼 _____ Course No. 課程號碼 _____ Amount 金額 _____

Name 姓名 _____
Full Postal Address 地址 _____

Please also complete this part.

Note: This application acknowledgment is not complete without validation by official printing machine entry of the details at X above at the University or Town Centre office of the Department of Extra-Mural Studies, University of Hong Kong.

請填妥本欄。

注意：本校修讀本部或本部市區中心辦事處收銀機在 X 欄內印出日期、日期等，即未生效。

Fees are not refundable once the course has commenced 課程開始後學費不能退還。 Please see overleaf 請看背面。

GROUND PLAN OF UNIVERSITY OF HONG KONG MAIN BUILDING

showing location of rooms used for extra mural courses. Please see inside of front cover for University general layout.

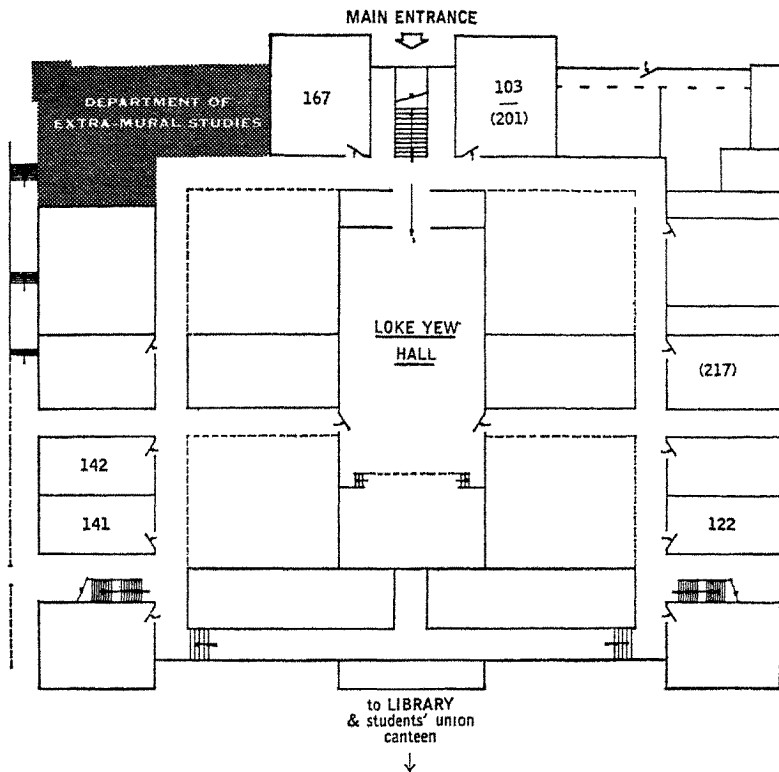

LIBRA PRESS LTD.

56 Wong Chuk Hang Road, Hong Kong

香港大學校外課程手冊

一九七六年春季

SPRING PROSPECTUS
1976



Extra Mural Studies

University of Hong Kong