

Department of
Extra-Mural
Studies
University of
Hong Kong



1966-67
Prospectus

10th
Anniversary

A Message from the Vice-Chancellor

This session marks the tenth anniversary of the opening of the Department of Extra-Mural Studies. In the decade of its existence the Department has forged firm links between the University and the public outside its walls. By providing a wide range of courses, which have attracted students from all walks of life, the University has been able to help meet some of the varied needs of the Hong Kong community, which in turn has had new opportunities of learning more of the University and its varied activities.

May the Extra-Mural Department, in the years to come, continue to grow and develop in the tradition it has already established.

Kenneth Robinson.

SKETCH-MAP OF UNIVERSITY

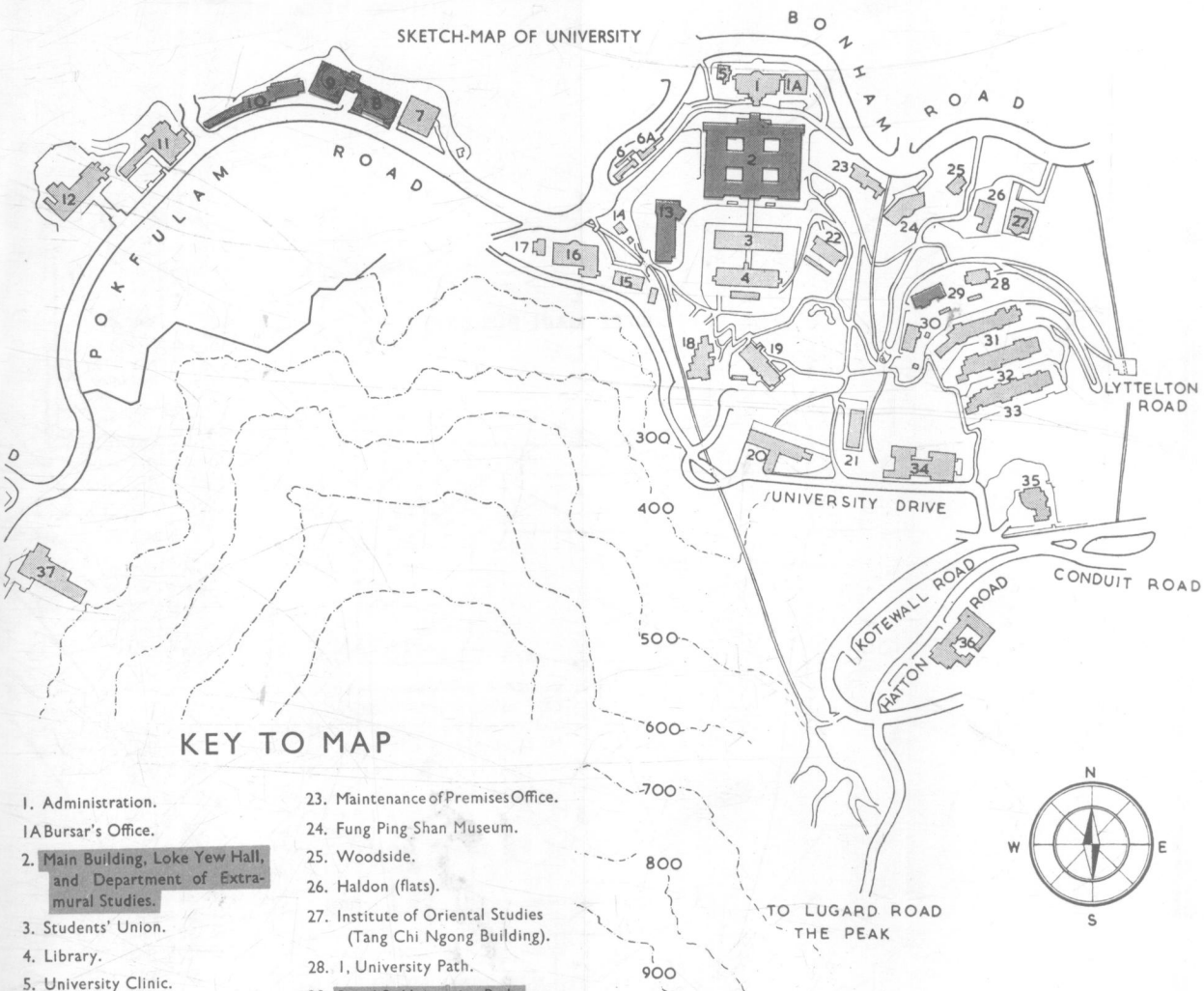

KEY TO MAP

- | | |
|--|--|
| 1. Administration. | 23. Maintenance of Premises Office. |
| 1A Bursar's Office. | 24. Fung Ping Shan Museum. |
| 2. Main Building, Loke Yew Hall, and Department of Extramural Studies. | 25. Woodside. |
| 3. Students' Union. | 26. Haldon (flats). |
| 4. Library. | 27. Institute of Oriental Studies (Tang Chi Ngong Building). |
| 5. University Clinic. | 28. 1, University Path. |
| 6. Hong Kong University Press. | 29. 2 and 3, University Path. |
| 6A Garages. | 30. 4 and 5, University Path. |
| 7. Ho Tung Engineering Workshop. | 31. Lugard Hall. |
| 8. Duncan Sloss School of Engineering and Architecture. | 32. Eliot Hall. |
| 9. Peel Laboratory. | 33. May Hall. |
| 10. Northcote Science Building. | 34. Robert Black College. |
| 11. Lady Ho Tung Hall. | 35. Vice-Chancellor's Lodge. |
| 12. Ricci Hall. | 36. Morrison Hall. |
| 13. Chemistry. | 37. St. John's College. |
| 14. West Gate House. | |
| 15. Geology Laboratory. | |
| 16. Botany, Physics, and Zoology. | |
| 17. Engineering and Statistics. | |
| 18. 3, University Drive (flats). | |
| 19. 8, University Path (flats). | |
| 20. 2, University Drive (flats). | |
| 21. Staff Tennis Court. | |
| 22. 6 and 7, University Path. | |



GROUND PLAN OF THE UNIVERSITY MAIN BUILDING

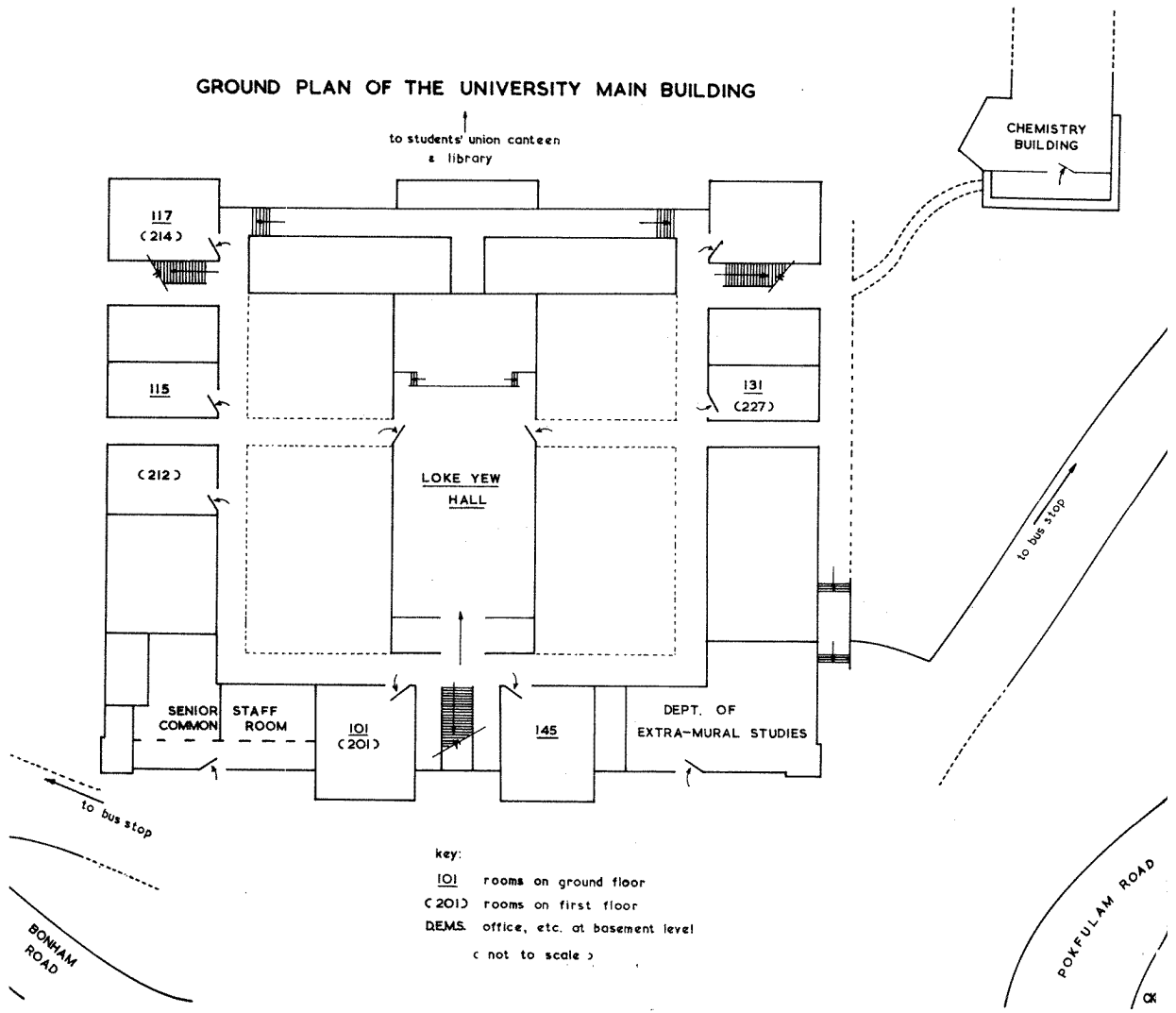

STAFF

Director

Ieuan Hughes, LL.B. (Wales).

Visiting Deputy Director

R. A. Williams, M.A. (Wales).

Assistant to the Director

Mrs. Priscilla Mark Tso, B.A., Dip. Ed. (H.K.)
Dip. Ad. Ed. (Manch.)

Senior Staff Tutor

Mrs. Nana Wong Tsao, B.A., Dip. Ed. (H.K.)

Staff Tutors

Laurence C. T. Pang, B.A. (H.K.)
C. K. Leung, B.A. (H.K.)
John Chan, M.A. (H.K.)

Senior Lecturer (part-time)

Dr. Francis Pan, D.C.S. (New York)

Lecturer in Law

D. M. E. Evans, LL.B., (Wales) B.C.L., (Oxon.)

Secretary

Mrs. Yvonne Wong.

GENERAL INFORMATION

1. There are normally no entry requirements, except that applicants should be over 18 years of age, though occasionally, to have the full benefit of a course, applicants must possess certain defined qualifications. Therefore, applicants are advised to read the description of a course carefully.
2. The Director may, at his discretion, refuse to admit an applicant.
3. Unless otherwise arranged, no Extra-Mural lectures will be held:—
 - a) On all public holidays.
 - b) At a storm warning signal of No. 5 or above.
 - c) During the following holiday periods:
24th December, 1966 to 2nd January, 1967 inclusive (Christmas and New Year)
7th February, to 12th February, 1967 inclusive (Chinese New Year)
4. The course fee will cover the entire duration of a course.
5. Lectures are usually of one hour duration, unless otherwise stated.
6. Certificates of Attendance are issued, on payment of 50 cents, to those who have attended not less than two-thirds of a course of at least 20 meetings in duration.
7. Closing date for enrolment: *One week before the starting date of a course.* Late enrolments may not be accepted. However, applications are normally not accepted once the maximum limit is reached. The Department would therefore appreciate early enrolment by applicants.
8. For enquiries, please ring 451515 or 226529 during office hours.

HOW TO ENROL

1. Complete the attached enrolment form, and mail it to the Director, Department of Extra-Mural Studies, University of Hong Kong. Forms are also available on request.

2. You should send your application form together with the appropriate fee either in the form of postal order, money order or crossed cheque made out in favour of the UNIVERSITY OF HONG KONG.
3. You will be notified if you are not admitted because of over-subscription or other reasons. The Department will NOT notify successful applicants, who are expected to attend the first meeting of the class at the place and time advertised.
4. An official receipt for the tuition fee will be issued in due course by the Bursar's Office.
5. Applicants can also enrol in person at the following places:—
 - (i) Department of Extra-Mural Studies, University of Hong Kong, University Main Building, Ground Floor, Pokfulam Road, (during office hours) (Buses No. 3, 4, 7, 23)
Tel: 451515
 - (ii) Extra-Mural Law Centre, Chiao Shang Building, 8th floor, 92-94 Queen's Road Central, Hong Kong. (opposite the Central Market; above Chinese Merchandise Emporium Ltd., entrance at Cochrane Street)
Tel: 226529

Summary of Extra-Mural Work

	<i>No. of Courses</i>	<i>Students Enrolled</i>
1956-57	12	330
1957-58	24	880
1958-59	44	1,122
1959-60	41	1,114
1960-61	60	2,119
1961-62	94	3,021
1962-63	183	4,103
1963-64	193	5,221
1964-65	281	6,341
1965-66	210	5,667

ACKNOWLEDGEMENTS

We would like to record our grateful acknowledgement to the following schools and organizations for permission to use their premises:—

The British Council,
The U.S.I.S.,
The Management of City Hall,
The Grantham Training College,
King's College,
Wah Yan College, Kowloon.

入 學 須 知

1. 學員申請資格，除特別規定學歷之課程外，其他課程，祇需年齡超過十八歲者，不限資格，均可申請入學。學員應詳閱課程簡介。
2. 學員被取錄與否概由校外課程部主任審核報名申請書後決定之。
3. 除特殊情形外，本部在下列期間不授課：
 - 甲、本港公眾假期。
 - 乙、本港天文臺懸掛五號或以上風球之後。
 - 丙、聖誕節及新年假期：一九六六年十二月廿四日至一九六七年一月二日。
農曆新年假期：一九六七年二月七日至二月十二日。
4. 本手冊內之學費係指課程之全期學費。
5. 授課時間通常為每講一小時。
6. 凡課程在廿講以上而學員上課次數超過三分之二者，得向本部繳費五角後申請發給聽講證書。
7. 學員應於開課一星期前報名，過期報名可能不被接受。又任何課程額滿後，即隨時截止報名，故學員應儘早報名。
8. 本部詢問電話：451515或226529。

報 名 手 續

1. 填妥附於本手冊之報名申請書後，逕寄香港大學校外課程部主任收。申請書可隨時向本部索取。
2. 繳費可用支票，銀行本票，或郵政滙票，抬頭「香港大學」隨同申請書逕寄港大校外課程部主任收。如用現金則請至本部繳納。
3. 如申請人已獲取錄，本部不再通知，可依時上課。如未獲取錄，則另函通知。
4. 學費收據由香港大學會計處寄與申請人。
5. 申請人亦可親往下列地點報名：
 1. 薄扶林道香港大學校外課程部（辦公時間內）。
 2. 香港皇后大道中九十二號僑商大廈九樓（中央市場對面，入口在閣麟街）校外課程部市區中心。

PROFESSIONAL AND VOCATIONAL COURSES

The Department, by special agreement with the *Chartered Institute of Secretaries, London*, acts as local examiner for the four subjects in their Intermediate Examination, namely, Economic Theory, Accounting, General Principles of English Law and English. This "Intermediate Sessional Examination" will be held in May each year. Successful Candidates will then be recognised by the *Chartered Institute of Secretaries, London*, as having satisfied their Intermediate Examination requirements. However only registered students of the *Chartered Institute of Secretaries* who have enrolled for and attended 75% of each of the above four courses, organised by the Department of Extra-Mural Studies, are eligible to sit for it. The purpose of this arrangement is to enable the course syllabuses and the examination papers to be more closely related to local conditions; the questions are set and examination papers are marked by the tutors who lecture on the subjects. Both the examination questions and the papers are sent to the *Institute* for moderation and approval of results.

The Department also offers other professional and vocational courses which are specially designed to follow the syllabuses of the various professional examinations. These professional examinations are the *Chartered Institute of Secretaries* Intermediate and Final Examinations; the *Association of Certified and Corporate Accountants* Intermediate and Final Examinations; the *Corporation of Secretaries* Intermediate and Final Examinations; the *Association of Incorporated Accountants* Intermediate and Final Examinations; the *Royal Institute of Chartered Surveyors* First and Intermediate Examinations; the *Solicitors' Parts I & II* Qualifying Examinations; the *Institute of Bankers* Parts I & II Examinations.

The Department offers a Librarianship Certificate Course in cooperation with the *Hong Kong Library Association*, preparing candidates for the *United Kingdom Library Association* Part I Examination.

In addition the Department offers London LL.B. External Degree courses whereby, through special arrangement with the *University of London*, qualified persons may study for the London LL.B. External Degree after office hours and over a shorter period of time than hitherto possible (that is, in three years instead of five).

Courses designed to form part of the academic training in Housing Management are also offered.

All the above professional and vocational courses are open to all interested, but those wishing to sit for the various examinations should make their own arrangements unless specified otherwise and should ensure beforehand that they have the necessary entry qualifications.

The Department welcomes the opportunity to cooperate with local organizations, and professional institutions to arrange special professional and vocational courses which meet the needs of Hong Kong.

INDEX OF COURSES 1966-67

SCI-12. Summer Courses (Completed)

ARTS, ARCHAEOLOGY AND MUSIC

13. The Study and Practice of Oil Painting
14. Introduction to Archaeology
15. Local Archaeology
16. Ceramics for Beginners
17. Graphic Design
 - Part I: Basic Design*
 - Part II: Experimental Design*
 - Part III: Lettering and Typography*
 - Part IV: Advertising Design*
18. Composition for Painters
19. Buddhist Art in China
20. Intermediate Ceramics
21. The History and Art of Chinese Seals
22. The Study and Practice of Oil Painting
24. Living With Art
25. Graphic Design & Packaging
26. Introductory Course in Industrial Design
27. The Concerto
28. The Sonata

ARCHITECTURE

29. An Introduction to the Principles of Visual Arts
30. Ideal Towns

EDUCATION, PHILOSOPHY AND PSYCHOLOGY

31. Social Psychology 社會心理學
32. Introduction to Contemporary Philosophy
33. Research Methods in Education & Psychology
34. Industrial Psychology
35. Psychology II
36. Introduction to Child Psychology 實用兒童心理摘要
37. Introduction to Adolescent Psychology 實用青年心理探討
38. The Use of Slides and Tape in Lectures to Small Audiences
39. Social Psychology and Our Daily Work With People
40. Introduction to the Philosophy of Religion

ENGLISH LANGUAGE, LITERATURE AND TEACHING

41. Techniques of English Teaching
42. A Practical Guide to Part-Time Broadcasting
43. English for Clerical Workers
44. Play Production for Amateurs
45. Intelligent Reading
46. English for Higher Commercial Studies
47. The Modern Novel
48. Mastering Modern English

49. Modern European Drama
50. Elocution
51. The English We Use (*see also course 159*)
52. Mastering Modern English (*see also course 157*)
53. Comparative Phonetics and Speech Training

GEOGRAPHY AND SOCIOLOGY

54. Teaching of Map Interpretation
55. Geography in the Field
56. Local Physical Geography 本土自然地理
57. Some Aspects of Rural Population in the New Territories—
A Geographical Approach
58. The Role of Religion in Chinese Society
59. Social and Psychological Aspects of Crime
60. Understanding Chinese Customs & Traditions
(*see also course 153*)

HISTORY AND INTERNATIONAL AFFAIRS

61. Aspects of German History 1870-1939
62. Modern European History — The First World War
歐洲近代史
63. Modern China and the Two Revolutions
64. Background to Vietnam 越南史撮要
65. Profile of Hong Kong
66. Personalities in Chinese History

LAW

67. Constitutional Law
68. Law of Contract
69. English Legal System
70. Roman Law
71. Criminal Law
72. Company Law and Partnership
73. General Principles of English Law
74. Peculiarities of Hong Kong Land Law
75. Law for Laymen 市民與法律

MATHEMATICS AND SCIENCES

76. Fundamental Concepts of Elementary Mathematics
77. Modern Mathematics for Parents
78. Modern Mathematics for Parents
79. Birds in Hong Kong
80. Marine Fishes of Hong Kong
81. Reptilian Zoology in Hong Kong
82. Weather and Climate
83. Vegetable Culture in Hong Kong II 香港蔬菜之栽植(二)
84. Floriculture in Hong Kong 香港花卉之栽植
85. Astronomy for Amateurs 簡易天文學講座
 - I. Introduction to Observational Astronomy
 - II. The Amateur Astronomer and His Telescope
 - III. Astronomical Photography for Amateurs
 - IV. An Outline of Stellar Astronomy

ORIENTAL STUDIES

86. Lectures on Chinese Literature
中國文學講壇——唐代文學
87. Historical Studies in China since 17C.
清代以來之中國史學
88. Yuen Wei Shen and His Poetic Works 元 遺山 詩
89. On Chinese Poetry 詩 學 通 論
90. The History and Art of Chinese Calligraphy 書法源流
91. Play Writing and Production 話劇之編寫與演出

OTHER LANGUAGES

92. Cantonese I
93. Cantonese Conversation
94. Chinese Characters
95. German I
96. German II
97. Mandarin I
98. Mandarin II
99. Italian Language, Literature and Culture
100. Japanese I
101. Japanese II
102. Elementary Spanish
103. Reading and Conversational Spanish
104. French for Beginners
105. French II

COMMERCE AND ECONOMICS

106. Accountancy
107. Auditing
108. Cost Accounting
109. Company Secretaryship
110. Managerial Accounting
111. Elementary Accounting
112. Advanced Accountancy
113. Principles of Hong Kong Taxation
114. Accounting and General Commercial Knowledge
會計與商業常識
Part I: Banking & Foreign Exchange
Part II: Insurance & Shipping
Part III: Hong Kong Profits Tax
115. Economic Theory
116. Principles of Economics I
117. Principles of Economics II
118. Practice of Banking
119. International Finance and Trade
120. Money & Banking & World Finance
Part I: Hong Kong's Banking & Monetary System
Part II: International Monetary Cooperation & World Finance
121. Valuation of Land and Buildings — Intermediate
122. Fire Hazards & Insurance for the Business Men
123. Ocean Transport
124. Property Development and Management
125. Business Statistics

126. An Introduction to Hospital Administration
 127. Factory Operation and Scientific Management
 工廠建設與科學管理
Part I: Factory Operation
Part II: Scientific Management
 128. Marketing Management
 129. Industrial Management
 130. Business Management I
 131. Business Management II
 132. Personnel Management
 133. Public Relations
 134. Monetary Theory & Practice I
 135. Monetary Theory & Practice II
 136. Economics for Importers & Exporters I
 137. Economics for Importers & Exporters II

PROFESSIONAL AND VOCATIONAL COURSES

138. Librarianship Certificate Course
 139. Second Year Librarianship Course
 140. An Introduction to Town and Country Planning
Part I: Regional and Land Use Planning
Part I: Urban Planning and Town Design
 141. Housing Management — Social Welfare I
 142. Housing Management — Law of Landlord & Tenant I
 143. Housing Management — Social Welfare II
 144. Housing Management — Law of Landlord & Tenant II
 145. Advertising Certificate Course
 Chartered Institute of Secretaries Intermediate Examination
 Chartered Institute of Secretaries Final Examination
 Association of Certified and Corporate Accountants Inter-
 mediate Examination
 Association of Certified and Corporate Accountants Final
 Examination
 Corporation of Secretaries Intermediate Examination
 Corporation of Secretaries Final Examination
 Australian Society of Accountants
 Institute of Bankers
 Royal Institute of Chartered Surveyors First Examination
 Royal Institute of Chartered Surveyors Intermediate
 Examination
 Association of International Accountants Intermediate
 Examination
 Association of International Accountants Final Examination
 Solicitors' Part I Examination
 Solicitors' Part II Examination
 London L. L. B. External Degree
 1. LL.B. (London) Intermediate Examination
 2. LL.B. (London) Part I Examination
 3. LL.B. (London) Part II Examination

SEMINARS

- International Textile Machinery Seminar
 Exhibition & Seminar on Textile & Fabric Design
 Air Transport Seminar

SPECIAL DAY-TIME PROGRAMME

146. What to Listen for in Music
147. Fine Art Drawing 素描創作
148. The History and Art of Chinese Calligraphy 書法源流
149. Foundations in Cantonese
150. Design and the Home — The History of Interior Design and Household Furniture
151. Lectures on Hong Kong History
152. China — Its Land and People
153. Understanding Chinese Customs and Traditions
154. Some Aspects of China's Literary Tradition
155. Angkor — Art and Civilization
156. Hong Kong Today
157. Mastering Modern English
158. English for Clerical Workers
159. The English We Use

MID-DAY LECTURES

"Aspects of Chinese Art"

PUBLIC EVENING LECTURES

"Hong Kong Economic Scene"

STUDY TOUR

Study Tour to Japan

THE ANNUAL RALLY
WILL BE HELD
ON
SATURDAY, MARCH 11, 1967
AT THE UNIVERSITY

LECTURES
SOCIAL FUNCTION
DINNER
ETC.

THE PROGRAMME

SUMMER COURSES (Completed)

- SC1. GENERAL & ENGLISH PHONETICS
Adviser: Professor A.W.T. Green
Director of Studies: Mr. Raymond Huang
July 19-25, 1966
- SC2. THE APPLICATION OF PHONETICS IN THE TEACHING OF ENGLISH TO CANTONESE PUPILS
Adviser & Director of Studies: as for SC1
July 26-30, 1966
- SC3. SECOND SUMMER COURSE IN MATHEMATICS
Lecturers: Mr. Y. H. Au-Yeung
Dr. Doris Chen
Mr. W.K. Chiu
Mr. L.S. Ko
Dr. K.T. Leung
Mr. S.H. Young
Mr. C.K. Poon
Mr. Y.M. Wong
Mr. K.Y. Woo
July 27 — August 10, 1966
- SC4. CHINESE PAINTING THROUGH THE AGES
Tutor: Mr. S. C. Chuang
July 20 — August 31, 1966
- SC5. INTRODUCTION TO MODERN EUROPEAN PHILOSOPHY
Tutor: Fr. Peter Brady
August 3 — 24, 1966
- SC6. HONG KONG FLOWERING PLANTS
Tutor: Mr. Derek Kemp
August 19 — September 2, 1966
- SC7. PERSPECTIVE ART
Tutor: Mr. K. F. Fung
July 8 — August 26, 1966
- SC8. SOME ASPECTS OF ASTRONOMY
Tutor: Mr. H. C. Liu
August 3 — 24, 1966
- SC9. STUDY TOUR TO CAMBODIA
Leader: Mrs. Priscilla Tso
July 23 — 30, 1966
- SC10. STUDY TOUR TO CHINA
Leader: Mr. Roger A. Williams
August 1 — 14, 1966
- SC.11 GENETICS FOR "A"—LEVEL TEACHERS
Lecturers: Dr. F.S. Dhillon
Dr. K.K. Yeung
July 28 — August 10 & 31, 1966
- SC12. SOME ASPECTS OF SIXTH FORM HISTORY TEACHING: A DISCUSSION OF PROBLEMS
Organizers: Mr. Roger A. Williams
Mrs. Nana Tsao
Speakers: Dr. L.K. Young
Mr. A. Hinton
Mr. J. Stokes
Mr. A.F. Denholm
Mr. J. Shipman
Mrs. L. Mok
Mrs. M. Kennedy
Mrs. I.K. Evan
August 8 — 12, 1966

ARTS, ARCHAEOLOGY & MUSIC

Tutor in Charge: *Nana W. Tsao*

Tel: 440255

13. THE STUDY AND PRACTICE OF OIL PAINTING

Time: Mondays, 6-8 p.m., starting Sept. 19, 1966.

Place: Grantham Training College, Gascoign Rd., Kln.

No. of Meetings: 24, once weekly *Fee:* \$90

Tutor: Mr. Y. T. Kwong, M.Sc. (Kansas)

This course is designed for those who are interested in oil painting, or anyone with a basic knowledge of painting.

Each meeting of the course will consist of two main parts. The first part will deal with the study of oil painting techniques, theory of colour mixing, principles of pictorial composition, new approaches to texture and treatment, and the appreciation of classical and modern art. The second part of the meeting will be a practical one. Criticism and discussion will be given on the completion of each picture.

Students will provide their own materials, which will be announced at the first meeting. *Enrolment is limited to 25.*

14. INTRODUCTION TO ARCHAEOLOGY

Time: Mondays, 5.30-6.30 p.m., starting Sept. 12, 1966.

Place: Lecture Room South, City Hall, 8/F., H.K.

No. of Meetings: 6, once weekly *Fee:* \$15

Tutor: Dr. S. M. Bard

An introduction to Archaeology with special reference to local Archaeology. The lectures will be illustrated and field trips to archaeological sites in Hong Kong will be arranged in conjunction with the next course "Local Archaeology".

Enrolment is limited to 25.

15. LOCAL ARCHAEOLOGY

Time: Mondays, 5.30-6.30 p.m., starting Nov. 21, 1966.

Place: Lecture Room South, City Hall, 8/F., H.K.

No. of Meetings: 4, once weekly *Fee:* \$10

Tutor: Mr. James Watt, Assistant Curator, City Hall Museum.

A brief account of archaeological finds in Hong Kong of both pre-historic and historic date and their significance in relation to local history. The talks will be illustrated with objects and slides.

Enrolment is limited to 30.

16. CERAMICS FOR BEGINNERS

Time: Mondays, 6-8 p.m., starting Sept. 19, 1966.

Place: 2 University Path, H.K. (Residence of Mrs. M. Mellor)

No. of Meetings: 12, once weekly *Fee:* \$100

Tutors: Mrs. M. Mellor

Mrs. L. Y. Y. Stenqvist, Higher Diploma, The National School of Applied Arts, Stockholm, (Sweden)

Students will be taught various methods of building pottery by hand, and of decorating and glazing the ware they produce.

Students will not be called upon to provide pottery equipment, but there will be an extra charge for clay and glazes, at 60C for one hundred grams, to be paid to Mrs. Mellor as each object is finished.

Enrolment is limited to 20. Students of Course "136" of our 1966 Spring Programme will be given priority, provided they send in the applications before Aug. 15, 1966.

17. GRAPHIC DESIGN

THIS COURSE IS COMPOSED OF FOUR PARTS, BUT EACH SECTION IS DISTINCT IN ITSELF AND CAN BE TAKEN SEPARATELY.

PART I: BASIC DESIGN

Time: Mondays, 6-8 p.m., starting Sept. 19, 1966.

Place: King's College, Bonham Rd., Hong Kong.

No. of Meetings: 12, once weekly *Fee:* \$48

Tutor: Miss Pansy Ng, B.F.A. (Maryland Inst.) U.S.A.

This part of the course will introduce basic concepts and practice of contemporary design. Arrangement of fundamental design elements will be taught and theories of repetition, harmony and contrast will be discussed. Problems will be planned so as to enable students to develop a sense for good design.

PART II: EXPERIMENTAL DESIGN

Time: Mondays, 6-8 p.m., starting Jan. 9, 1967.

Place: King's College, Bonham Rd., Hong Kong.

No. of Meetings: 12, once weekly *Fee:* \$48

After a period of disciplined work, students will be encouraged to experiment with greater freedom. Various media will be employed and different design possibilities will be explored. Problems will be planned to stimulate students' imagination and creativity.

Fee for two parts: \$90

Students will provide their own materials which will be announced in class. Enrolment is limited to 25.

PART III: LETTERING AND TYPOGRAPHY

Time: September 1967.

No. of Meetings: 12, once weekly

Fee: \$48

Students will design for the printed page. In this part of the course, the main concern will be the knowledge and construction of various type faces, the arrangement of types and lettering, and the imaginative use of typography to achieve exciting design.

PART IV: ADVERTISING DESIGN

Time: Spring 1968.

No. of Meetings: 12, once weekly

Fee: \$48

Students are now ready to visualize advertisements in magazines and newspapers, and to design brochures and other printed items. The stress here will be on the making of an impressive design as well as the creation of the product's image. Methods of various graphic processes will also be discussed.

Fee for two parts: \$90

Priority will be given to students who have taken Part I & II of this course. Enrolment is limited to 25.

18. COMPOSITION FOR PAINTERS

Time: Tuesdays, 7-9, p.m., starting Sept. 27, 1966.

Place: Committee Room North, City Hall, 7/F., H.K.

No. of Meetings: 12, once weekly

Fee: \$48

Tutor: Mrs. L. Y. Y. Stenqvist, Higher Diploma, The National School of Applied Arts, Stockholm, (Sweden).

This course deals with both theories and practice of pictorial elements. There will be analysis of paintings by famous masters, illustrated by slides. Exercises and discussions will be carried out in class.

Enrolment is limited to 25.

19. BUDDHIST ART IN CHINA

Time: Tuesdays, 5.45-6.45 p.m., starting Oct. 4, 1966.

Place: Extra-Mural Law Centre, Chiao Shang Bldg., 8/F., 92-94 Queen's Rd. C., H.K. (entrance at Cochrane Street)

No. of Meetings: 20, once weekly

Fee: \$50

Tutor: Mr. Chuang Shen, M.A. (Princeton University), Lecturer, Dept. of Chinese, University of Hong Kong.

The content of this illustrated course will chiefly deal with the following three aspects: Buddhist architecture, sculpture, and painting. The newly discovered archaeological material of both Indian and Chinese monumental works will be used to illustrate the artistic transmission of Buddhist art from India via Central Asia and finally to China.

20. INTERMEDIATE CERAMICS

Time: Wednesdays, 6-8 p.m., starting Sept. 28, 1966.

Place: 2 University Path, H.K. (Residence of Mrs. M. Mellor)

No. of Meetings: 12, once weekly

Fee: \$110

Tutors: Mrs. M. Mellor

Mrs. L. Y. Y. Stenqvist, Higher Diploma, The National School of Applied Arts, Stockholm, (Sweden).

This course is for those who either have completed the course "Ceramics for Beginners" or have a sufficient basis of ceramic knowledge. The first course dealt with the basic techniques of building pottery by hand. Now there will be more ventures into forms, more variations and experiments in decorating and glazing. The objects to be produced by students will be both functional and non-functional. There will be an extra charge for clay and glazes, at 60¢ for one hundred grams, to be paid to Mrs. Mellor as each object is finished.

Enrolment is limited to 20.

21. THE HISTORY AND ART OF CHINESE SEALS

Time: Wednesdays, 6.15-7.15 p.m., starting Sept. 21, 1966.

Place: British Council Library, Gloucester Bldg., H.K.

No. of Meetings: 12, once weekly

Fee: \$25

Tutor: Mr. Yau Ka Pok, Dip.H.Ed. (London), F.R.S.H., F.A.P.H.A.

The Chinese seal is not only an expression of art, but is invariably used on works of Chinese paintings and calligraphy. This course aims to provide a general knowledge of Chinese seals for all who are interested.

The course will be amply illustrated with slides and there will be a demonstration of seal engraving. Some previous knowledge of styles of Chinese characters would be useful but not essential.

22. THE STUDY AND PRACTICE OF OIL PAINTING

Time: Thursdays, 6-8 p.m., starting Sept. 22, 1966.

Place: King's College, Bonham Rd., Hong Kong.

No. of Meetings: 24, once weekly

Fee: \$90

Tutor: Mr. Peter Lam, Lecturer in Art, N.T.C.

Each meeting of the course will consist of two main parts. The first part will deal with the study of oil painting techniques, such as the handling of materials, use of instruments, theory of colour mixing, principles of pictorial composition, the new approaches to texture and treatment, and the appreciation of classical and modern art. The second part of the meeting will be a practical one. Criticism and discussion will be given on the completion of each picture.

Students will provide their own materials, which will be announced at the first meeting. *Enrolment is limited to 25.*

23. DESIGN AND THE HOME

Time: Thursdays, 8.15-9.15 p.m., starting Oct. 6, 1966.

Place: Extra-Mural Law Centre, Chiao Shang Bldg., 8/F.,
92-94 Queen's Rd. C., H.K. (entrance at Cochrane Street)

No. of Meetings: 12, once weekly *Fee:* \$35

Tutor: Mr. Alex Bleszynski, School of Design & Graphic Art,
Poland.

Among other topics to be considered will be how to choose furniture, fabrics, floor coverings and accessories.

A short outline will be given of the development of interiors, furniture and decor from the past to the present day, with some suggested ideas for the future.

It is also planned to include (by arrangement) visits to factories.

The course fee does not include expenses incurred in the excursions. *Enrolment is limited to 30.*

24. LIVING WITH ART

Time: Fridays, 8.15-9.15 p.m., starting Oct. 7, 1966.

Place: Extra-Mural Law Centre, Chiao Shang Bldg., 8/F.,
92-94 Queen's Rd. C., H.K. (entrance at Cochrane Street)

No. of Meetings: 10, once weekly *Fee:* \$30

Tutor: Mr. W. W. Chung, Dipl. Arch. (U.C.L.), A.R.I.B.A., Part-time lecturer, Dept. of Architecture, University of H.K.

Art will be interpreted as including painting, sculpture, architecture, garden landscape, townscape and music. The aim will be demonstrate the relationships between the various effects produced by these art forms on human beings under particular environments. The latter will be illustrated by means of the audio visual synchronisation of slides and music.

25. GRAPHIC DESIGN AND PACKAGING

Date: Commencing beginning of 1967.

Tutor: Mr. Henry Steiner, M.F.A. (Yale)

The role of graphic design in relation to corporate image packaging, advertising and architecture will be discussed. These lectures are primarily designed for business men/administrators. Fuller detail will appear in the Spring Programme.

26. INTRODUCTORY COURSE IN INDUSTRIAL DESIGN

Date: Commencing beginning of 1967.

Tutor: Mr. Paul Selinger, M.F.A. (San Francisco Art Inst.), Design Consultant.

Fundamental points of good design in manufactured articles — timber, metal and plastics — will be discussed. The lectures will be accompanied by studio instruction and exercises. Draughting ability will be necessary to take full advantage of the course, but will not be an essential requirement for entry. Full details will be available in the Spring Programme.

27. THE CONCERTO

Time: Tuesdays, 5.45-6.45 p.m., starting Oct. 4, 1966.

Place: 12 Macdonnell Rd., Apt. 1, Hong Kong.

No. of Meetings: 20, once weekly *Fee:* \$50

Tutor: Miss Maple Quon, Conservatory of Music, University of Toronto.

A series of 20 lectures designed to help towards a greater knowledge and appreciation of music. The lectures will trace the development of the concerto from the classical period to recent times. The emphasis will be mainly on the keyboard concertos but some time will be spent on concertos written for other instruments. There will also be a brief examination of concertos featuring more than one "solo" instrument. This course uses different material and demonstration music from the course begun last term, so will be of interest to those who enrolled in last term's Concerto Course, as well as those joining for the first time.

28. THE SONATA

Time: Fridays, 5.45-6.45 p.m., starting Jan. 13, 1967.

Place: 12 Macdonnell Road, Apt. 1, Hong Kong.

No. of Meetings: 12, once weekly *Fee:* \$30

Tutor: Miss Maple Quon, Conservatory of Music, University of Toronto.

A survey of the sonata for keyboard and instrumental works in this form from the early period to contemporary times.



ARCHITECTURE

Tutor in Charge: *Nana W. Tsao*

Tel: 440255

29. AN INTRODUCTION TO THE PRINCIPLES OF VISUAL ARTS

Time: Wednesdays, 8.15-9.45 p.m., starting Sept. 28, 1966.

Place: Extra-Mural Law Centre, Chiao Shang Bldg., 8/F., 92-94, Queen's Rd. C., H.K. (entrance at Cochrane Street)

No. of Meetings: 12, once weekly *Fee:* \$48

Tutor: Mr. Tao Ho, B.A. (Mass.) U.S.A., B.Arch. (Harvard) U.S.A.

The purpose of this illustrated course is to explore various aspects of the Visual Arts such as painting, sculpture, and architecture, as well as to examine the basic principles underlying artistic creations, selected topics to be discussed are the nature of Art; the relationship between Art and Science; the role of the artist in the society; value judgement and criticism in Art; basic design elements and colour theory; the meaning of Cubism; the problem of Abstract Art; the concepts of Time and Space in architecture; and the factors that shape the city.

30. IDEAL TOWNS

Date: Commencing beginning of 1967.

Course Leader: Mr. Jon A. Prescott, B.Arch., A.R.I.B.A., M.C.D., A.M.T.P.I.

A review of the ideas involved in the creation of new "ideal" settlements from historical times to the present day. This course of ten lectures will review, in some depth and with the aid of illustrative material, the British New Towns and will conclude with particular reference to the problems of Hong Kong.



EDUCATION, PHILOSOPHY & PSYCHOLOGY

Tutor in Charge: C. K. Leung

Tel: 440304

社會心理學

本課程共十二講，內容包括：

- (一)個人與社會之相互影響；
- (二)生理特性與人格類型關係；
- (三)人類行為之社會文化基礎；
- (四)人格判斷與測驗；
- (五)初次印象之重要性；
- (六)謠言心理；
- (七)宣傳；
- (八)羣衆心理等等。

主講人：譚維漢博士

教授語言：粵語

地點：九龍華仁書院

時間：一九六六年九月十九日

起每星期一下午七時至八時

學費：二十五元

32. INTRODUCTION TO CONTEMPORARY PHILOSOPHY

Time: Tuesdays, 815-915 p.m., starting September 27, 1966.

Place: Extra-Mural Law Centre, Chiao Shang Bldg., 8/F, 92-94 Queen's Road C., H.K. (Entrance at Cochrane St.)

No. of Meetings: 12, once weekly *Fee:* \$30

Tutor: Fr. Peter Brady, S.J., M.A. (Melb.) Phil.L., S.T.L.

The main trends of Western Philosophy will be surveyed from the beginning of the century. Some of the leading ideas of Dewey, Russell, Bergson, Whitehead, Husserl, will be introduced and some account given of Philosophical Analysis, Existentialism and Thomism.

33. RESEARCH METHODS IN EDUCATION & PSYCHOLOGY

Time: Wednesdays, 5.45-6.45 p.m., starting October 5, 1966.

Place: Room 117, University Main Building, H.K.U.

No. of Meetings: 20, once weekly *Fee:* \$60*

Tutor: Prof. N. K. Henderson, Ph.D. (London); B.A.; M.Ed. (Melb.); A.B.Ps.S.; F.C.P.; Professor of Education, H.K.U.

An introduction to the main methods and results of modern educational & psychological research, as well as a non-mathematical introduction to statistical techniques and experimentation. Topics include the nature and problems of research, test construction methods, how to write a thesis or research report, studies of method, and results of some outstanding modern research studies in these fields.

The course is suitable for graduates (and near graduates) working for higher degrees and others interested in systematic research. It will also prepare M.A.(Ed.) candidates for their qualifying examination in Research Methods.

34. INDUSTRIAL PSYCHOLOGY

Time: Thursdays, 7-8 p.m., starting Oct. 6, 1966.

Place: Extra-Mural Law Centre, Chiao Shang Bldg., 8/F, 92-94, Queen's Rd., C., H.K. (entrance at Cochrane Street.)

No. of Meetings: 10, once weekly. *Fee:* \$30.

Tutor: Mr. R. Neale, C. Eng., (A.C.T. Birm.) A.M.I. Mech., A.M.I. Prod., A.M.B.I.M.

The aim is to provide an insight into the various aspects of industrial and commercial psychology, the complications of which are gradually being realized as industrialization progresses still further in Hong Kong. Lectures will deal with all relevant subjects, ranging from performance studies to the individual labourer's interpretation of the world around him. Ample time will be provided for discussion.

Enrolment limited to 25.

35. PSYCHOLOGY II

Time: Fridays, 6-8 p.m., starting Oct. 7, 1966.

Place: University Main Building.

No. of Meetings: 8, once weekly. *Fee:* \$40

Tutor: Rev. E. Kvan, Cand. Theol. (Copenhagen) Senior Lecturer, Dept. of Philosophy & Psychology, H.K.U.

The course will consist partly of discussions of methods and results of empirical psychology and partly of a set of experiments etc. to be carried out by the participants as a basis for further discussion. The participants should preferably have some knowledge of general academic psychology.

(Day of the week and time can be re-arranged according to the need of the class if necessary.)

36. INTRODUCTION TO CHILD PSYCHOLOGY

實用兒童心理摘要

本課程共十二講，每週一次，目的在增進家長、教師、社會福利工作人員，對近代兒童心理學之理論與實施之認識。課程內容包括：

- (1) 父母之困難
- (2) 兒童之生長與發展
- (3) 個別差異與羣體關係
- (4) 令人操心之兒童
- (5) 特殊兒童(「天才」、「低能」兒童)
- (6) 懲罰、獎勵及其他紀律問題
- (7) 兒童指導

課程為一完整課程，但亦可與明年一月底開課之「實用青年心理探討」相銜接。

主講人：教育司署研究組梁子勤先生

講授語言：粵語

時間：一九六六年九月卅日，每星期四下午五時四十五分至六時四十五分

學費：三十元

地點：香港大學校外課程部市區中心(皇后大道中九十二號僑商大廈九樓)

37. INTRODUCTION TO ADOLESCENT PSYCHOLOGY

<p>學 費：三十元</p>	<p>地 點：香港大學校外課程部市中心 (皇后大道中九十二號僑商大廈九樓)</p>	<p>間 時：一九六七年一月十九日每星期四下午五時四十五分至六時四十五分</p>	<p>講 授 語 言：粵語</p>	<p>主 講 人：教育司署研究組梁子勤先生</p>	<p>本課程為一完整課程，然亦可與本年九月底開課之「實用兒童心理摘要」相銜接。</p> <p>講解以討論方式進行，並有電影輔助。</p> <p>(8) 家長之責任</p> <p>(7) 青年之不規則行為</p> <p>(6) 青年之理想、幻想與信仰</p> <p>(5) 青年對異性之認識</p> <p>(4) 青年之羣性發展</p> <p>(3) 青年情緒之控制</p> <p>(2) 青年期之一般特徵</p> <p>(1) 「青年兒童」</p>	<p>進家長、教師及社會福利工作人員，目的在增進青年之認識。課程內容包括：</p>	<p>實用青年心理探討</p>
-----------------------	--	---	--------------------------	----------------------------------	--	---	------------------------

38. THE USE OF SLIDES AND TAPE IN LECTURES TO SMALL AUDIENCES

Time: Wednesdays, 6-7 p.m., starting Nov. 9, 1966.

Place: University Main Bldg., H.K.U.

No. of Meetings: 6, once weekly

Fee: \$20

Tutor: Dr. John J. Poldy, D.M.D. (Berlin)

A series of lectures and demonstrations to show how slides and tape may be most efficiently used by lecturers and by those who have to give talks to various societies and clubs and to show how the two media can be combined to produce programmes of an informative and/or entertaining nature. Some elementary knowledge of still photography and tape recording will be assumed.

Enrolment is limited to 30.

39. SOCIAL PSYCHOLOGY AND OUR DAILY WORK WITH PEOPLE

Time: Thursdays, 5.45-6.45 p.m., starting January 19, 1967.

Place: Room 117, University Main Building, H.K.U.

No. of Meetings: 12, once weekly

Fee: \$30

Tutor: Prof. N.K. Henderson, Ph.D. (London); B.A., M.Ed. (Melb.); A.B.Ps.S.; F.C.P.; Professor of Education, H.K.U.

An introductory course in modern social psychology for all those who work with people — in schools, youth clubs, hospitals, offices and factories. A brief outline of the methods and results of modern psychology will be given, followed by topics like: understanding our relationships with others, studies in social motivation, personality development and problems, physical, intellectual and emotional aspects of behaviour, modes of adjustment, discipline problems and hints on influencing and managing young people, improving our working relations with others, morale in business and industry, case-studies, mental health aspects. There will be some films and slides, discussion of case-histories and typical problem-situations. Lectures will include ample time for questions, and for free discussion.

40. INTRODUCTION TO THE PHILOSOPHY OF RELIGION

Time: Mondays, 7-8 p.m., starting January 30, 1967.

Place: Wah Yan College, Kowloon.

No. of Meetings: 12, once weekly

Fee: \$30

Tutor: Fr. Peter Brady, S.J., M.A. (Melb.), Phil.L., S.T.L.

The course will outline the historical background to contemporary discussions in the Philosophy of Religion. It will touch on the development of philosophical arguments for the existence of God in ancient and mediaeval European philosophy, Empiricist, Kantian and Existentialist criticism of theistic positions, and the views of some present-day thinkers on the existence and nature of God.

PASS THIS BROCHURE
ON TO A FRIEND.
THE NEXT PROSPECTUS
WILL BE OUT EARLY
IN
JAN. 1967

ENGLISH LANGUAGE, LITERATURE & TEACHING

ALL APPLICANTS SHOULD HAVE AT LEAST SCHOOL CERTIFICATE STANDARD ENGLISH.

Tutor in Charge: *Nana W. Tsao*

Tel. 440255

41. TECHNIQUES OF ENGLISH TEACHING

Time: Mondays, 6-7 p.m., starting September 19, 1966.

Place: University Main Bldg., H.K.U.

No. of Meetings: 20, once weekly *Fee:* \$60

Tutor: Mrs. Harriette Yapp, B.A., Dip.Ed. H.K.; Cert. T.E.P. (Michigan) Lecturer, Dept. of Education, H.K.U.

A survey of the most up-to-date methods of English teaching with special reference to secondary school English in Hong Kong. Particular attention will be paid to the teaching of Grammar and Language Testing. Other topics include: the psychology of language learning; teaching methodology; principles of limitation, arrangement and presentation; vocabulary and written English; the teaching of poetry and literary appreciation.

Enrolment is limited to 40.

42. A PRACTICAL GUIDE TO PART TIME BROADCASTING

Time: Mondays, 8-9 p.m., starting Sept. 12, 1966.

Place: Studio 7A, Radio H.K., Mercury House, 7/F., H.K.

No. of Meetings: 8, once weekly *Fee:* \$40

Tutor: Mr. Timothy Birch, B.A. (Cantab.); Dip.Ed. (Lond.), Head of English Programmes, Radio Hong Kong.

This course will provide a basic introduction to most aspects of broadcasting; writing scripts for radio plays, talks, feature and magazine programmes; the art of the radio interview; working at the microphone; taking part in discussions and talks; production techniques; and outside broadcasting commentating. A visit to Radio Hong Kong will also be arranged.

Enrolment is limited to 25. Priority will be given to students of course No. "142" of our 1966 Spring Programme, provided they enrol at least two weeks before the starting date of the course.

43. ENGLISH FOR CLERICAL WORKERS

Time: Mondays, 8.15-9.15 p.m., starting Oct. 3, 1966.

Place: Extra-Mural Law Centre, Chiao Shang Bldg., 8/F., 92-94 Queen's Rd. C., H.K. (entrance at Cochrane Street)

No. of Meetings: 20, once weekly *Fee:* \$60

Tutor: Mrs. Mary Wong, B.A., (Commerce) (H.K.)

For students whose English has reached a reasonable standard, this course will deal with commercial correspondence, commercial terms, cables, memos, advertisements, reports, references, testimonials, office organization and procedure and interdepartment communication. Stress will be placed on improving students' accurate and effective use of the English Language in writing.

Enrolment is limited to 30.

44. PLAY PRODUCTION FOR AMATEURS

Time: Tuesdays, 6-8 p.m., starting September 20, 1966.

Place: British Council Library, Shui Hing Building, Kowloon.

No. of Meetings: 12, once weekly *Fee:* \$48

Tutor: Mr. Elwyn Roberts, B.A. (Wales), Dip.Ed. (Wales), Head of English Section, St. George's School.

This course on amateur dramatic production is specially designed for school teachers and those interested in play production. It deals with the selection of plays; casting; speech and movement rehearsals; set design; make-up costumes; problems posed by different types of play, and, in particular practical work, using members of the class as producers and actors.

Enrolment is limited to 25.

45. INTELLIGENT READING

Time: Tuesdays, 5.45-6.45 p.m., starting October 11, 1966.

Place: Extra-Mural Law Centre, Chiao Shang Bldg., 8/F., 92-94 Queen's Rd. C., Hong Kong.

No. of Meetings: 20, once weekly *Fee:* \$60

Tutor: Mrs. C. E. Hughes, B.A. (Wales)

The emphasis of this course will be on developing a student's ability to read intelligently and perceptively and to follow closely argued passages with greater ease. Well written extracts give the student an opportunity of studying how a good writer marshals his facts and expounds his ideas. Reading materials by modern writers will be announced at the class.

Enrolment is limited to 30.

46. ENGLISH FOR HIGHER COMMERCIAL STUDIES

Time: Wednesdays, 6-7 p.m., starting October 5, 1966.

Place: University Main Bldg., H.K.U.

No. of Meetings: 24, once weekly *Fee:* \$80

Tutor: Mrs. C. E. Hughes, B.A. (Wales)

A course specially designed for candidates preparing for various professional examinations, e.g., C.I.S., A.C.C.A. It will deal with the specified syllabuses for these examinations.

Enrolment is limited to 30. Preference will be given to students sitting one of the above mentioned professional examinations.

47. THE MODERN NOVEL

Time: Wednesdays, 5.30-6.30 p.m., starting November 2, 1966.

Place: Committee Room North, City Hall, 7/F., Hong Kong.

No. of Meetings: 8, once weekly *Fee:* \$25

Tutor: Mrs. M. Visick, M.A., B.Litt. (Oxon.), Lecturer, Dept. of English, H.K.U.

This course will discuss four representative post-war novels. Those suggested are:

Lawrence Durrell: *Mountolive*

Iris Murdoch: *The Flight from the Enchanter*

Pierre Schwartzbart: *The Last of the Just*

Gunther Grass: *The Tin Drum*.

48. MASTERING MODERN ENGLISH

Time: Thursdays, 8.15-9.15 p.m., starting Oct. 6, 1966.
Place: Extra-Mural Law Centre, Chiao Shang Bldg., 8/F.,
92-94 Queen's Rd. C., H.K. (entrance at Cochrane St.)
No. of Meetings: 20, once weekly *Fee:* \$60
Tutor: Miss Grace Chan, B.A. (Hons.) H.K.

The course will include textual study dealing with comprehension, interpretation, the more complex grammatical forms and idiomatic pattern. Members of the class are expected to participate in discussions and to do written work. Exercises will be taken mainly from D. Collins Leech's "G.C.E. English Language Exercises", supplemented by other texts.

Enrolment is limited to 30.

49. MODERN EUROPEAN DRAMA

Time: Thursdays, 7-8 p.m., starting October 6, 1966.
Place: Extra-Mural Law Centre, Chiao Shang Bldg., 8/F.,
92-94 Queen's Rd. C., Hong Kong.
No. of Meetings: 12, once weekly *Fee:* \$30
Tutor: Mr. W. I. McLachlan, B.A. (Oxon.). Lecturer in Comparative
Literature, Dept. of Modern Languages,
University of Hong Kong.

It is intended to concentrate upon four of the most important and influential of modern European plays:

Ibsen's *Hedda Gabler* (Penguin),
Chekhov's *The Cherry Orchard* (Penguin),
Pirandello's *Henry IV* (Penguin),
Brecht's *Mother Courage* (Methuen).

In the process of considering the grounds for their importance and influence, it will be necessary to define such terms as Realism, Naturalism, Symbolism, Expressionism and Alienation which have become part of the modern theatre critic's vocabulary. Reference will also be made to other works by these authors and to plays by other writers. However, the main aim of the course will be not so much to provide a generalised literary history as to relate certain dramatic styles and conventions to the various social and personal pressures which have made them necessary.

50. ELOCUTION

Time: Thursdays, 6.15-7.15 p.m., starting October 6, 1966.
Place: British Council Library, Gloucester Bldg., H.K.
No. of Meetings: 12, once weekly *Fee:* \$35
Tutor: Mr. Stuart Hill, B.A., L.R.A.M., Dip. Ed. (London)

This course is designed for teachers who wish to further their knowledge of speech techniques, and to assist those whose pupils enter the Speech sections of the Schools' Music Festival.

After initial work on voice production, pronunciation etc., the course will deal with the techniques of speech especially applied to poetry speaking, solo and choral, and prose reading, together with the art of interpretation and expression.

The emphasis will be on practical work. *Enrolment is limited to 20.*

51. THE ENGLISH WE USE

Time: Fridays, 6-7 p.m., starting Sept. 23, 1966.

Place: Wah Yan College, Waterloo Rd., Kln.

No. of Meetings: 20, once weekly

Fee: \$60

Tutor: Mrs. Lu Wang Yuan Chen, B.A. (Tsiang Hua), M.A. (Columbia), Senior Lecturer, Sir Robert Black Training College.

To provide practice in hearing, reading, speaking and writing correct and connected English, as it is normally used for standard purposes. The basis of the course will be a study of passages of English which people have wanted to listen to and read in the twentieth century. These passages provide material for:

- (a) training in the comprehension of continuous speech,
- (b) oral practice to activate passive knowledge of grammatical forms and idiomatic patterns,
- (c) exercise in more complex patterns,
- (d) textual study,
- (e) discussion and free composition.

Enrolment is limited to 30.

Textbook: *The English We Use* (Compiled by R. A. Close, Longmans)

52. MASTERING MODERN ENGLISH

Time: Fridays, 5.45-6.45 p.m., starting Sept. 30, 1966.

Place: Extra-Mural Law Centre, Chiao Shang Bldg., 8/F., 92-94, Queen's Rd. C., Hong Kong.

No. of Meetings: 20, once weekly

Fee: \$60

Tutor: Miss Jane Lai, B.A. (Hons.), H.K., Lecturer, Department of English, University of Hong Kong.

The course will include textual study dealing with comprehension, interpretation, the more complex grammatical forms and idiomatic pattern. Members of the class are expected to participate in discussions and to do written work. Exercises will be taken mainly from G.G. Gentle's "Progressive Exercises in English" & "Advanced English Practice" (Methuen), supplemented by other texts.

Enrolment is limited to 30.

53. COMPARATIVE PHONETICS AND SPEECH TRAINING

Time: Fridays, 6-7 p.m., starting October 14, 1966.

Place: University Main Bldg., H.K.U.

No. of Meetings: 24, once weekly

Fee: \$75

Tutor: Mr. Raymond Huang, B.A. (Lingnan), M.A. (Leeds), I.P.A. Cert, Phon. (London), P.G.C.E. (London), L.R.A.M., L.T.C.L., (London), Senior Lecturer, Sir Robert Black Training College.

The course will be open to those who have attended the Phonetics Courses given at this University.

It will deal with modern phonetic methods and devices with reference to speech training. There will be a phonetic comparison of English and Chinese (Mandarin, Cantonese and Swatow). The comparative analysis will help the student to understand the causes of errors in stress, rhythm, articulation and intonation in English speech. Methods of correction and speech training procedure will be suggested; graded aural-oral exercises will be provided.

GEOGRAPHY & SOCIOLOGY

Tutor in Charge: C. K. Leung

Tel: 440304

54. TEACHING OF MAP INTERPRETATION

Time: Thursdays, 6-7 p.m., starting October 20, 1966.

Place: University Main Bldg., H.K.U.

No. of Meetings: 10, once weekly Fee: \$30

Tutor: Dr. T. N. Chiu, M.A. (H.K.); Ph.D. (London); Lecturer, Dept. of Geography & Geology, H.K.U.

This course is specifically designed as a refresher course for Geography teachers, dealing chiefly with the practical study of landscape types by reference to contoured sheets. Lectures will be illustrated with pictures and examples will be drawn from O.S. one inch maps and maps of other scales and other countries.

Priority for enrolment will be given to teachers, but interested adult members of the public with some knowledge of basic contour patterns are also welcome. Enrolment limited to 30.

55. GEOGRAPHY IN THE FIELD

Time: Wednesdays and Sundays, 8.15-9.15 p.m., starting Oct. 5, 1966.

Place: Extra-Mural Law Centre, Chiao Shang Bldg., 8/F., 92-94, Queen's Rd., C., H.K. (entrance at Cochrane Street.)

No. of Meetings: 12, twice weekly Fee: \$30

Tutor: Mr. Lo Chai-Wan, B.A. (H.K.)

This course provides a geographical introduction to Hong Kong. The operation of geographical processes giving rise to special topographical features, and the influence of geographical environment on the types of land use, pattern and type of population distribution and provision for essential services etc. will be studied in detail during field trips. Methods of field investigation will be dealt with.

There will be 6 indoor lectures and 6 field days. Places to be visited include: Rocky Harbour, Peng Chan (Mirs Bay), Ap Chau (Robinson Island), Chik Keng/Tai Long Wan, Tsuen Wan/Yuen Long, Mines at Needle Hill, Ma On Shan or Cha Kwo Ling, Shek Pik/Ngong Ping/Tung Chung or Tai O, etc.

Course fees do not include expenses incurred on the excursions. Enrolment limited to 35.

56. LOCAL PHYSICAL GEOGRAPHY

本課程共二十講，包括約十四個講課，數次週末實地地理考察及分組研討會，課程內容計有下列各項：

（一）自然地理方法及其研究

（二）沉積岩；（三）火成岩；（四）地質構造；（五）風化；（六）沖卸作用；（七）禿地；（八）河流；（九）海洋侵蝕及沉積；（十）水面升降；（十一）斜坡；（十二）侵蝕輪迴。

講解將着重本土地理及地質範例，並輔以幻燈影片、圖片及地質標本說明。

主講人：香港大學胡鳴高先生，梁志強先生

講授語言：粵語（輔以英語）

時間：一九六六年十月七日每星期五下午五時四十五分至六時四十五分

地點：香港大學校本部

學地費：四十元

本土自然地理

57. SOME ASPECTS OF RURAL POPULATION IN THE NEW TERRITORIES — A GEOGRAPHICAL APPROACH

Time: Fridays, 5.45-6.45 p.m., starting February 24, 1967.

Place: Extra-Mural Law Centre, Chiao Shang Bldg., 8/F., 92-94, Queen's Rd., C., H.K. (entrance at Cochrane Street.)

No. of Meetings: 8, once weekly *Fee:* \$20

Tutor: Mr. C. P. Lo, B.A. (H.K.); Asst. Lecturer, Department of Geography & Geology, H.K.U.

This is intended to be a general introduction to the population geography of the New Territories. The following aspects will be studied:

- (1) population geography as a branch of modern geography, and its relation to demography;
- (2) the geographical characteristics of H.K. & N.T.;
- (3) the peopling of the New Territories;
- (4) the past and present patterns of population distribution;
- (5) demographic characteristics;
- (6) economic structure.

Lectures will be illustrated with maps and slides wherever possible. No previous knowledge of geography will be assumed on the part of the students.

58. THE ROLE OF RELIGION IN CHINESE SOCIETY

Time: Tuesdays, 6.15-7.15 p.m., starting October 25, 1966.

Place: British Council Library, Gloucester Building, H.K.

No. of Meetings: 8, once weekly *Fee:* \$20

Tutor: Dr. M. Topley, B.Sc. Econ.(Lond.); Ph.D.(London)

This course will discuss the traditional role of religion in Chinese society on the one hand, and on the other, the extent to which we can see it having significance in Hong Kong today. The focus will be on religion and its role in the life of ordinary people. Discussion will centre around the "situational" significance of religion: the way it is used in accordance with different social requirements and by individuals in various roles in the society, e.g. in the family, in such occupations as farming, crafts and trades. It will also discuss, in this context, the emergence of different cults and sects, and additionally, the role of the priesthood in popular religious practices, and their formal organization.

59. SOCIAL AND PSYCHOLOGICAL ASPECTS OF CRIME

Time: December 5-12, 1966.

Place: Extra-Mural Law Centre, Chiao Shang Bldg., 8/F., 92-94 Queen's Rd. C., H.K. (entrance at Cochrane Street)

A two-week full-time course organized at the request of the Hong Kong Police Department for selected members of the Police Force and related Government departments. Public inquires are invited.

60. UNDERSTANDING CHINESE CUSTOMS & TRADITIONS

Time: Tuesday, 6.15-7.15 p.m., starting February 21, 1967.

Place: British Council Library, Gloucester Building, H.K.

No. of Meeting: 8, once weekly *Fee:* \$20

Tutor: Dr. M. Topley, B.Sc. Econ. (Lond); Ph. D. (Lond.)

This series of lectures is designed for those who wish to learn something of Chinese life and culture, and will deal with traditional Chinese customs and ways of life existing in Hong Kong; Chinese etiquette and common courtesy, family structure & kinship; wedding & burial ceremonies; ancestor worship; religion & the main festivals celebrated during the year. The lectures will be illustrated with slides wherever possible.



HISTORY & INTERNATIONAL AFFAIRS

Tutor in Charge: *Nana W. Tsao*

Tel: 440255

61. ASPECTS OF GERMAN HISTORY 1870-1939

Time: Mondays, 6.45-7.45 p.m., starting Oct. 3, 1966.

Place: Lecture Room South, City Hall, 8/F., Hong Kong.

No. of Meetings: 10, once weekly *Fee:* \$25

Tutor: Mr. A. F. Denholm, B.A. (Wales), Cert. Ed. (London),
Lecturer, Dept. of History, H.K.U.

A course of lectures dealing with certain aspects of recent German history, including Bismarck, Germany and the Eastern Question, Germany and the First World War and the Peace Settlement, an assessment of Gustav Stresemann, Germany's economic collapse, and finally a consideration of Hitler's Germany. This is primarily designed for "A"-level teachers, and for Fifth Form teachers who will soon be undertaking "A"-level teaching.

62. MODERN EUROPEAN HISTORY — The First World War

學	時	地	講	主	形	歐洲近代史
費	間	點	授	講	勢	
：十元	：一九六六年十月四日起 每星期二下午八時十五 分至九時十五分	：香港大學校外課程部市 區中心	：粵語	：陳璋先生 香港大學校外課程部	：大戰爆發原因，經過及戰後國際之新 形勢。	

第一次世界大戰之探討

本課程共六講，前三講闡述十九

世紀末至二十世紀初歐洲之政治、社

會經濟發展與國際關係，後三講概論

大戰爆發原因，經過及戰後國際之新

形勢。

主講人：陳璋先生

香港大學校外課程部

講授語言：粵語

地點：香港大學校外課程部市

區中心

時間：一九六六年十月四日起

每星期二下午八時十五

分至九時十五分

學費：十元

63. MODERN CHINA AND THE TWO REVOLUTIONS

Time: Wednesdays, 7-8 p.m., starting Sept. 28, 1966.

Place: Committee Room South, City Hall 7/F., H.K.

No. of Meetings: 10, once weekly *Fee:* \$30

Tutor: Mr. William Waung, B.A. (H.K.), A.M. (Harvard), Lecturer,
Dept. of History, University of H.K.

The Revolutions of 1911 and 1949 transformed a tradition-conscious China into a dynamic civilization. They brought to the fore conflicting ideas of nationalism and communism, democracy and totalitarianism. The decades prior to the Revolutions had seen the introduction of new political and ideological factors that came to dominate China. These provided the necessary stimulants for change and change she did. This series of lectures attempts to analyse in historical terms the reasons for this change.

64. BACKGROUND TO VIETNAM

越南史撮要

本課程共八講，講述越南政治史之大綱、社會文化之演變，以及華僑活動之概況，藉以瞭解現今越南問題之歷史背景。

主講人：中文大學高級講師

陳荊和先生

講授語言：國語

地點：香港大會堂八樓

北會議室

時間：一九六六年，十一月二

日起每星期三，下午六
時四十五分至七時四十
五分

學費：廿五元

65. PROFILE OF HONG KONG

Time: Fridays, 8.15-9.15 p.m., starting September 30, 1966.

Place: Extra-Mural Law Centre, Chiao Shang Bldg., 8/F., 92-94, Queen's Rd. C., Hong Kong.

No. of Meetings: 10, once weekly *Fee:* \$25

Tutor: Mr. G. B. Endacott, M.A., B.Litt., Dip.Ed. (Oxon).

The purpose of the course is to take the main social and economic problems that face Hong Kong, give a brief history of how these problems have arisen, and then to examine recent developments and future possibilities.

66. PERSONALITIES IN CHINESE HISTORY

Time: Wednesdays, 5.30-7.00 p.m., starting November 2, 1966.

Place: Lecture Room North, City Hall, 8/F., Hong Kong.

No. of Meetings: 8, once weekly *Fee:* \$12

Tutor: Mr. Ha Wing Ho, B.A. (H.K.)

This course is arranged in conjunction with the Hong Kong Cultural Society. Details are available on application to the Department of Extra-Mural Studies, University of Hong Kong.



L A W

Tutor in Charge: *John Chan*

Tel: 226529

THE FOLLOWING COURSES ARE DESIGNED FOR THOSE WHO INTEND TO SIT THE LL.B. EXTERNAL (LONDON) INTERMEDIATE EXAMINATION IN JUNE, 1968. (THESE COURSES ARE ENTIRELY SEPARATE FROM THOSE TAUGHT UNDER THE SPECIAL ARRANGEMENT DESCRIBED ON PAGE 51 BELOW.)

67. CONSTITUTIONAL LAW

Time: Mondays, 7-8 p.m., starting Oct. 24, 1966.

Place: Extra-Mural Law Centre, 92 Queen's Road Central, H.K.

No. of Meetings: 24, once weekly *Fee:* \$70

Tutor: Mr. N. I. Billingham, Solicitor.

68. LAW OF CONTRACT

Time: Mondays, 8.15-9.15 p.m., starting Oct. 10, 1966.

Place: Extra-Mural Law Centre, 92 Queen's Road Central, H.K.

No. of Meetings: 24, once weekly *Fee:* HK\$70

Tutor: Mr. Henry W. C. Wong, Barrister at Law

69. ENGLISH LEGAL SYSTEM

Time: Tuesdays, 8.15-9.15 p.m., starting Oct. 11, 1966.

Place: Extra-Mural Law Centre, 92 Queen's Road Central, H.K.

No. of Meeting: 24, once weekly *Fee:* HK\$70

70. ROMAN LAW

To be offered in 1967.

71. CRIMINAL LAW

Time: Tuesdays, 7-8 p.m., starting Sept. 20, 1966.

Place: Extra-Mural Law Centre, Chiao Shang Bldg., 8/F., 92-94 Queen's Rd. C., H.K. (entrance at Cochrane Street)

No. of Meetings: 24, once weekly *Fee:* \$70

Tutor: Mr. Winston Chu, LL.B., Solicitor.

This course covers the classification of crimes; general principles of responsibility; general defences; offences against the person; offences against property; offences against public order and the administration of justice; highway offences; libel; bigamy.

72. COMPANY LAW AND PARTNERSHIP

Time: Thursdays, 8.15-9.15 p.m., starting Oct. 6, 1966.
Place: Extra-Mural Law Centre, Chiao Shang Bldg., 8/F., 92-94 Queen's Rd. H.K. (entrance at Cochrane Street)
No. of Meetings: 24, once weekly *Fee:* \$70
Tutor: Mr. Henry Wong, B.A.(H.K.), Solicitor.

Partnership: definition, formation, relations between parties, relations to third parties, liability of parties, dissolution.

Company Law: formation memorandum and articles and alterations thereto, contracts and dealings with companies, share capital, allotment and transfer of shares, dividends, debentures, and directors and shareholders' meetings, private companies, winding up.

73. GENERAL PRINCIPLES OF ENGLISH LAW

Time: Fridays, 8.15-9.15 p.m., starting Sept. 9, 1966.
Place: Extra-Mural Law Centre, Chiao Shang Bldg., 8/F., 92-94 Queen's Rd. C., H.K. (entrance at Cochrane Street)
No. of Meetings: 24, once weekly *Fee:* \$70
Tutor: Mr. Peter Li, B.A., Solicitor.

This course covers the nature and sources of English Law; Common Law; equity and custom; the Judicature Acts; statute law; judicial precedent; legal persons and personal relations; real property and personal property; wills and intestacy; general principles of contract and torts.

It is primarily intended for those who will be sitting for the C.I.S. Intermediate Examination or the Institute of Bankers Part I Examination. Others interested may also attend.

74. PECULIARITIES OF HONG KONG LAND LAW

Time: Mondays, 5.45-6.45 p.m., starting Sept. 12, 1966.
Place: Extra-Mural Law Centre, Chiao Shang Bldg., 8/F., 92-94 Queen's Rd. C., H.K. (entrance at Cochrane Street)
No. of Meetings: 12, once weekly *Fee:* \$30
Tutor: Mr. C. W. Humphreys, B.A.(Oxon.), Solicitor.

This course is specially designed for those who are interested in Hong Kong Land Law. The following topics will be dealt with: land tenure in Hong Kong, sources of Hong Kong law, summary of the provisions regarding rent control and protection of tenure, co-ownership of buildings, mortgages, Land Registration Ordinance, peculiarities of land in the New Territories.

75. LAW FOR LAYMEN

市 民 與 法 律

本課程共二十講，每週一次，旨在引起一般人對法律之興趣與認識，其主要內容包括：

- 一、刑事法；
- 二、民事法；
- 三、英國法律與香港法律之比較；
- 四、中國之習俗法；
- 五、市民，律師，法官，陪審團及其各別職責；
- 六、香港法律援助之展望。

主 講 人：陳子鈞大律師

講 授 語 言：粵語

地 點：香港大學校外課程部市區中心

時 間：一九六六年九月十四日起每星期三下午七時至八時。

學 費：五十元

MATHEMATICS & SCIENCE

Tutor in Charge: *Priscilla Tso*

Tel: 435712

76. FUNDAMENTAL CONCEPTS OF ELEMENTARY MATHEMATICS

Time: Fridays, 7-8 p.m., 8.10-9.10 p.m., starting Sept. 16, 1966.

Place: University Main Building, H.K.U.

No. of Meetings: 36, once weekly

Fee: \$180

Tutors: Dr. C. P. Chang, Lecturer;

Mr. S. Young, Demonstrator;

Mr. Y. H. Au-yeung, Demonstrator, Department of Mathematics, H.K.U.

This course is designed for secondary school teachers who are preparing themselves for teaching modern mathematics to Form I and Form II students who have learned mathematics in primary schools along traditional lines. It is an introduction to the mathematical concepts underlying the traditional computational techniques and it offers a systematic analysis of arithmetic and a presentation of intuitive algebra and geometry. The language used is the clear, precise language of modern mathematics. Sharp distinctions are made between concepts and symbols of mathematics; the former are ideas that we think about and the latter are marks that we write in order to communicate with one another.

ARITHMETIC — Numerals and its history, place value and bases; natural numbers and properties of the basic operations; rational numbers; inequalities and the number line; decimals, irrational numbers, real numbers, the real line.

ALGEBRA — Elementary ideas about sets and variables, two variables and graphs, negative numbers, inequalities, the number line and infinite sets.

GEOMETRY — General principles, measurement, plane and space figures, perimeters, area and volume, similar triangles and trigonometry.

Main Reference Book: *Fundamental Concepts of Elementary Mathematics* by C. F. Brumfiel, R. E. Eicholz & M. E. Sharks, Addison-Wesley Publishing Company Inc. (World Student Series Edition) 1962.

Enrolment is limited to 50.

77. MODERN MATHEMATICS FOR PARENTS

Time: Mondays, 7-8 p.m., starting September 26, 1966.

Place: Committee Room South, City Hall, 7/F.

No of Meetings: 10, once weekly

Fee: \$25

Tutor: Mr. Tsui See Ming, B.A., Dip.Ed.(H.K.)

This is the first of a series of courses intended to introduce the basic principles of modern mathematics to parents and interested laymen. Illustrations will be taken from the syllabus of lower forms in secondary schools. The course will discuss how Modern Mathematics is used in other countries and the reasons for the change in secondary school mathematics in Hong Kong. It will also deal with Elementary Set Theory, Number Systems and Algebraic Operations, Intuitive Geometry, Statistics and Logic.

Enrolment is limited to 30.

78. MODERN MATHEMATICS FOR PARENTS

Time: Wednesdays, 6-7 p.m., starting Sept. 28, 1966.

Place: Wah Yan College, Kowloon.

No. of Meetings: 10, once weekly *Fee:* \$25

Tutor: Mr. Tsui See Ming, B.A., Dip.Ed. (H.K.)

This is the first of a series of courses intended to introduce the basic principles of modern mathematics to parents and interested laymen. Illustrations will be taken from the syllabus of lower forms in secondary schools. The course will discuss how Modern Mathematics is used in other countries and the reasons for the change in secondary school mathematics in Hong Kong. It will also deal with Elementary Set Theory, Number Systems and Algebraic Operations, Intuitive Geometry, Statistics and Logic.

Enrolment is limited to 30.

79. BIRDS IN HONG KONG

Time: Wednesdays, 6-7 p.m., starting September 28, 1966.

Place: University Main Building, H.K.U.

No. of Meetings: 6, once weekly. *Fee:* \$15

Tutor: Miss Maura Benham

This series is designed to show the use birds make of the Hong Kong territory, and by descriptions of birds' appearance, habits and habitat to enable beginners to identify the more common species and enjoy birdwatching. The lectures will be illustrated with slides.

80. MARINE FISHES OF HONG KONG

Time: Wednesdays, 6-7 p.m., starting November 16, 1966.

Place: University Main Building, H.K.U.

No. of Meetings: 10, once weekly and one field trip *Fee:* \$25

Tutor: Mr. William L. Chan, B.Sc., M.A.(Stanford), Systematic Ichthyologist, Acting Senior Research Officer, Fisheries Research Station, Agriculture and Fisheries Department.

An introductory course on ichthyology concentrating on the marine fishes of Hong Kong. Morphology, taxonomy, ecology, behaviour, distribution, and the importance of fish to mankind will be dealt with. The course is designed both for students and teachers of biology and ordinary laymen interested in the natural history of fishes. Fish specimens and colour slides of fishes will be shown. A collecting trip will be arranged.

81. REPTILIAN ZOOLOGY IN HONG KONG

Time: Wednesdays, 6-7 p.m., starting February 22, 1967.

Place: Large Lecture Theatre, Rm. 302, Northcote Science Building, University of Hong Kong, Pokfulam Road, H.K.

No. of Meetings: 12, once weekly and 1 field trip. *Fee:* \$35

Tutor: Mr. Malcolm Peaker, B.Sc.(Sheffield).

The following topics of interest concerning local reptiles will be considered: the characteristics of the reptiles of the Hong Kong area as compared with those found in the rest of the world; some interesting aspects of their movement, structure and adaptations to local environment, for example, food, climate, breeding, behaviour etc.; methods of catching, caring for and studying local reptiles; their economic value and conservation.

Lectures will be illustrated wherever possible with slides, living and preserved specimens.

No prior knowledge of reptiles or zoology is required.

82. WEATHER AND CLIMATE

Time: Wednesdays, 6-7 p.m., starting Oct. 5, 1966.

Place: British Council, Shui Hing Bldg., Kowloon.

No. of Meetings: 10, once weekly

Fee: \$25

Tutor: Mr. Chin Ping-chuen, M.Sc. (Lond.), D.I.C., F.R.Met.S.,
Scientific Officer, Royal Observatory.

This course is intended to provide some background and up-to-date information about the earth's atmosphere as part of man's physical environment. The global distribution of the principal climatic elements will be described and the physical causes of climate will be discussed in terms of geography, radiation, dynamics and air masses. The course will also deal with the three-dimensional structure of weather systems and the physical laws which govern weather processes and atmospheric motion.

83. VEGETABLE CULTURE IN HONG KONG II

香港蔬菜之栽植 (二)

本課程共十講，每週一次，其目的在討論本港夏季普通蔬菜之栽植及田間試驗，以適應本地蔬菜事業之需求。

主 講 人：嶺南大學農學士前任香

港政府農漁處園藝研究
專員陳少孺先生

講授語言：粵語

地 點：九龍華仁書院

時 間：一九六六年九月十五日

起每星期四下午六時至
七時。

學 費：二十五元。

84. FLORICULTURE IN HONG KONG

香港花卉之栽植

本課共十二講，根據本土之氣候及環境，專討論栽植花卉之基本技能，包括花卉之播種，選種，施肥，室內，室外花卉之保養，中國，外國普通花卉之栽培方法，苗圃及花園之管理。

主 講 人：嶺南大學農學士前任香

港政府農林署園藝研究
專員陳少孺先生

講授語言：粵語

地 點：九龍華仁書院

時 間：一九六七年一月十二日

起每星期四下午六時至
七時

學 費：三十元

85. ASTRONOMY FOR AMATEURS

THIS COURSE IS COMPOSED OF FOUR PARTS OFFERED OVER TWO YEARS. EACH SECTION IS DISTINCT IN ITSELF AND MAY BE TAKEN SEPARATELY.

簡易天文學講座

此課程包括四部分，分兩年完成，但每一部分亦可作爲獨立課程修讀

I. INTRODUCTION TO OBSERVATIONAL ASTRONOMY

甲、天文觀測方法入門

本課程共分十四講，目的在介紹普通天文觀測方法，觀測範圍包括：

星座之認識
星圖之使用

太陽、月球、行星表面之觀測

流星、彗星之觀測

雙星、變星之觀測

星團、星雲之觀測

除上述十四講外，另有戶外觀測若干次利用望遠鏡進行，觀察星空中一般現象，但觀測次數及日期時間，將視天氣情況而定。

主講人：廖慶齊先生

講授語言：粵語

地點：香港大學校本部

時間：一九六六年九月廿三日起每星期五下午八時至九時。

學費：四十元。

II. THE AMATEUR ASTRONOMER AND HIS TELESCOPE

乙、天文愛好者與望遠鏡

本課程目的在使天文愛好者認識天文望遠鏡之種類，及製造簡單天文望遠鏡之原理。全部共十二講，內容包括：

望遠鏡演進史

望遠鏡之種類與原理。

天文愛好者之望遠鏡。

光學部分之設計與製造。

望遠鏡之裝配，使用與保養等。

主講人：廖慶齊先生

講授語言：粵語

地點：校外課程部市區中心

時間：一九六七年一月廿日起每星期五下午八時至九時。

學費：三十五元

× × ×
（同時修讀本課程甲、乙兩部者收費六十五元。）

III. ASTRONOMICAL PHOTOGRAPHY FOR AMATEURS

丙、天文攝影要訣

本課程共十二講，以介紹天文愛好者如何利用攝影術進行觀測及記錄星空現象爲目的，課程內容包括。

攝影術與天文學之關係。

拍攝天文照片所需之儀器。

感光片與濾光器之選擇。

星座、太陽、月球、行星、流星、彗星、變星、星團、星雲及銀河等

攝影方法，天文底片之分類，整理與分析。

除上述十二講外，另有天文攝影實習，次數及日期時間，將視天氣情況而定。

主講人：廖慶齊先生

講授語言：粵語

時間：一九六七年九月

時

IV. AN OUTLINE OF STELLAR ASTRONOMY

丁、恒星天文學概論

本課程用通俗方式闡述恒星天文學之基本概念與方法，全部十二講，內容包括：

恒星天文學之研究對象及意義。

恒星之物理性質。

恒星之距離，運動與空間分佈。

星團、星協、星族。

星際物質。

銀河系之結構。

河外星系及總星系等。

主講人：廖慶齊先生

講授語言：粵語

時間：一九六八年春季。

THE ANNUAL RALLY

will be held

on

Saturday, March 11, 1967

at the University

Lectures

Social Function

Dinner

Etc.

ORIENTAL STUDIES

東方文化

Tutor in Charge: John Chan
主理導師：陳璋先生

Tel: 226529

86. LECTURES ON CHINESE LITERATURE

中國文學講壇

唐代文學

本講壇共分四期舉行，每年一期，由香港大學中文系組合專家主講，首期為唐代文學，共十五講，由錢穆博士、羅香林教授、李棻先生、王韶生先生主講，主要講題如下：

(一) 唐代文學思想

(二) 唐代詩歌

(三) 唐人散文

(四) 唐人小說

(五) 唐詩之外國傳播

講授語言：國語

地點：香港大會堂九樓南演講廳

時間：一九六六年九月十六日起每星期五下午七時至

八時

學費：三十元

87. HISTORICAL STUDIES IN CHINA SINCE THE 17TH CENTURY

清代以來之中國史學

本課程在探討清代以來中國史學之演進，其內容包括有清一代各時期史學之特點及其轉變，清季以來新史料之發現，新史學之輸入，古史辨運動，社會史論戰，大學之歷史學系，史學研究團體，中國通史之撰述，史學期刊之發展等項，以期闡析近代中國史學研究之總趨勢。(十二講)

主講人：香港大學中國歷史講師

余秉權先生

講授語言：粵語

地點：香港大學校外課程部市區中心

時間：一九六六年九月十九日起每星期一下午八時十五分至九時十五分

學費：二十元

88. YUEN WEI SHEN AND HIS POETIC WORKS

元遺山詩

本課程分上下兩期，每期十二講，討論遺山詩之精蘊，編年講授，論其世，思其人，賞其文字之美，聲音之工，印發講義。

主講人：陳湛銓先生

講授語言：粵語

地點：香港大學校外課程部市區中心

時間：一九六六年九月十六日起每星期五下午八時四十五分至九時四十五分

學費：二十元

89. ON CHINESE POETRY

詩學通論

本課程，自漢魏以迄唐宋，每一時代舉出代表若干人，及其作品庶以溯其源流而觀其正變，並加評賞，共分十六講，印發講義。

主講人：梁簡能先生

講授語言：粵語

地點：九龍華仁書院

時間：一九六六年九月廿六日

起每星期一下午七時至八時

學費：三十元

90 THE HISTORY AND ART OF CHINESE CALLIGRAPHY

書法源流

本課程共十六講，每週一次，每次二小時，專為愛好研究中國書法者而設，理論與實踐並重，主要講題如下：

(一) 書法與文字之關係

(二) 書法演變

(三) 篆隸行楷之書法介紹

(四) 執筆、運筆、結體

(五) 各體書法示範

主講人：馮康侯先生

講授語言：粵語

地點：香港大學校外課程部市區中心

時間：一九六六年九月廿六日

起每星期一下午七時至九時

學費：五十元

91. PLAY WRITING AND PRODUCTION

話劇之編寫與演出

本課程共十二講，每週一次，前六講關於編劇，後六講關於導演與表演技術，內容包括：情節提煉；人物性格描寫，分幕分場；台詞編寫與表達；衝突；懸疑；驚奇之運用；高潮與氣氛之把握；情調與節奏之處理；舞台調度；角色之誕生與表演等等。

主講人：李援華先生

講授語言：粵語

地點：香港大會堂九樓南演講廳

時間：一九六六年九月廿二日

起每星期四下午七時至八時

學費：三十元

OTHER LANGUAGES

Tutor in Charge: C. K. Leung

Tel: 440304

ALL FIRST YEAR COURSES ARE DESIGNED FOR BEGINNERS.

ALL SECOND YEAR COURSES ARE DESIGNED FOR STUDENTS WHO HAVE SATISFACTORILY COMPLETED A FIRST YEAR COURSE OR WHO CAN SHOW THAT THEY HAVE ATTAINED AN EQUIVALENT STANDARD. THEREFORE FINAL ACCEPTANCE WILL BE SUBJECT TO INTERVIEW BY THE TUTOR IF NECESSARY.

THE FRENCH, GERMAN & SPANISH FIRST YEAR COURSES ARE AIMED AT A SOUND GROUNDING IN CONVERSATIONAL AND WRITTEN USE OF THE LANGUAGE, WHILE THE SECOND YEAR COURSES ARE AIMED AT THE G.E.C. ORDINARY LEVEL EXAMINATIONS WHICH STUDENTS CAN SIT PRIVATELY IF THEY WISH.

OPTIONAL EXAMINATIONS COULD BE OFFERED BY THE DEPARTMENT AT THE END OF EACH COURSE IF REQUESTED BY THE STUDENTS.

92. CANTONESE I

Time: Mondays & Thursdays, 6-7 p.m., starting Sept. 19, 1966.

Place: University Main Bldg., H.K.U.

No. of Meetings: 48, twice weekly *Fee:* \$180

Tutor: Mr. Paul Fong, B.A., Dip.Ed. (H.K.)

The course begins with foundation work in Cantonese study and aims at enabling students to understand and speak simple conversational Cantonese. Specially prepared texts covering grammatical usages and basic Chinese sentence structure will be supplied by the tutor.

93. CANTONESE CONVERSATION

Time: Mondays & Thursdays, 7.15-8.15 p.m., starting Oct. 3, 1966.

Place: University Main Building, H.K.U.

No. of Meetings: 48, twice weekly *Fee:* \$200

Tutor: Mr. Paul Fong, B.A., Dip.Ed. (H.K.)

It is intended to concentrate on the spoken language, expressions and idioms, the aim being to develop thoroughly the students' conversational ability. Specially prepared and well graded texts will be supplied by the tutor.

94. CHINESE CHARACTERS

Time: Wednesdays, 7-8 p.m., starting Oct. 12, 1966.

Place: Extra-Mural Law Centre, Chiao Shang Bldg., 8/F., 92-94 Queen's Rd. C., H.K. (entrance at Cochrane St.)

No. of Meetings: 24, once weekly *Fee:* \$100

Tutor: Mr. Paul Fong, B. A., Dip. Ed. (H.K.)

An adequate basic knowledge of Cantonese is assumed. The course is designed to give students the ability to read Chinese characters. The study of characters will include vocabulary, spoken and literary expressions and idioms, given in the form of simple prose passages. Etymology of Characters and classical reference of idioms will be touched on as the course progresses. Special effort will be made to give students practice in writing characters and to show the various ways of finding characters in Chinese dictionaries. Specially prepared texts, different from the set used in 1965-66, will be supplied by the tutor.

95. GERMAN I

Time: Tuesdays & Fridays, 6-7 p.m., starting Sept. 20, 1966.

Place: University Main Building, H.K.U.

No. of Meetings: 48, twice weekly *Fee:* \$180

Tutor: Dr. Helena Baroness Hoyningen-Huene, Department of
Modern Languages, H.K.U.

This introductory course aims at giving a thorough grounding so as to enable students to read and speak simple German.

Textbook: *Deutsche Sprachlehre für Ausländer*, by Schulz-Griesbach

96. GERMAN II

Time: Tuesdays & Fridays, 7.15-8.15 p.m., starting Oct. 11, 1966.

Place: University Main Building, H.K.U.

No. of Meetings: 30, twice weekly *Fee:* \$120

Tutor: Dr. Helena Baroness Hoyningen-Huene, Department of
Modern Languages, H.K.U.

This course aims at a further detailed study of German Grammar — such as style, syntax, tenses and precis writing. It will include practical exercises in conversation and newspaper-reading as well as the reading of prose passages by famous writers.

Textbook: *Deutsche Sprachlehre für Ausländer*, by Schulz-Griesbach

97. MANDARIN I

Time: Tuesdays & Fridays, 7.15-8.15 p.m., starting Sept. 27, 1966.

Place: University Main Building, H.K.U.

No. of Meetings: 48, twice weekly *Fee:* \$180

Tutor: Mr. Shih Wan-chu, B.A., Instructor in Language School,
H.K.U.

The main emphasis will be on the spoken side of the language. Many opportunities will be given for practising pronunciation and short sentence construction. A reasonable number of characters will be taught.

Textbook: *Speak Chinese*, Yale University, Mirror Series.

98. MANDARIN II

Time: Tuesdays & Fridays, 6-7 p.m., starting Oct. 11, 1966.

Place: University Main Building, H.K.U.

No. of Meetings: 48, twice weekly *Fee:* \$200

Tutor: Mr. Shih Wan-chu, B.A., Instructor in Language School,
H.K.U.

This course is designed to impart to students the ability to speak fluently, to know some characters and idiomatic expressions and to read simple passages.

Textbook: *Chinese Dialogues*, Yale University, Mirror Series.

99. ITALIAN LANGUAGE, LITERATURE AND CULTURE

Time: Tuesdays & Fridays, 6-7 p.m., starting Oct. 4, 1966.

Place: University Main Building, H.K.U.

No. of Meetings: 32, twice weekly *Fee:* \$120

Tutor: Dr. Giulio Costantini, LL.D.(Rome), Head of Cultural Section, Italian Consulate General, formerly professor of History of Western Culture in the Foreign Service Academy and the University of Indonesia.

This introductory course aims at giving a thorough grounding so as to enable students to read and speak simple Italian. The technique of language teaching in relation to the culture and literature of the country will be applied.

(in co-operation with the Italian Consulate General and the Dante Alighieri Society of Hong Kong).

100. JAPANESE I

Time: Mondays & Thursdays, 5.45-6.45 p.m., starting Sept. 19, 1966.

Place: Extra-Mural Law Centre, Chiao Shang Building, 8/F., 92-94 Queen's Rd. C., H.K. (entrance at Cochrane Street)

No. of Meetings: 48, twice weekly *Fee:* \$180

Tutor: Mr. Loh Tse-ye, B.A.(Meiji University).

This course is designed to impart an ability to understand and speak modern colloquial Japanese, and, at the same time, to introduce Katakana and Hiragana and some simple Kanji (characters).

Textbook: *Japanese Reader*, by O. Vaccari, (Maruzen).

101. JAPANESE II

Time: Mondays & Thursdays, 7-8 p.m., starting Oct. 3, 1966.

Place: Extra-Mural Law Centre, Chiao Shang Building, 8/F., 92-94 Queen Rd. C., Hong Kong. (Entrance at Cochrane Street).

No. of Meetings: 48, twice weekly *Fee:* \$200

Tutor: Mr. Loh Tse-ye, B.A. (Meiji University).

Besides serving as an advanced course in colloquial Japanese, this course will include more common literary and colloquial expressions, simple grammatical exercises and some Chinese characters. Some revision of Japanese I course will be done in the first few meetings.

Textbook: *Standard Japanese Reader, Book II and III*, by N. Naganuma.

Students are also advised to obtain either an English/Japanese or a Chinese/Japanese dictionary.

102. ELEMENIARY SPANISH

Time: Mondays & Thursdays, 6-7 p.m., starting October 3, 1966.
Place: University Main Building.
No. of Meetings: 48, twice weekly *Fee:* \$180
Tutor: Mrs. Carmen Tang, B.A. (University of Richmond.)

This course offers to beginners the "feel" of Spanish as it is now spoken and written in Castile and the Spanish-American republics. It aims to give basic training for further development of skill in listening to, speaking, reading, and writing Modern Spanish in a cultural context. English will be the main teaching medium.

Textbook: *Spanish Grammar*, by Eric V. Greenfield, Barnes & Noble Incorp., New York.

103. READING AND CONVERSATIONAL SPANISH

Time: Tuesdays & Fridays, 6-7 p.m., starting October 11, 1966.
Place: University Main Building.
No. of Meetings: 30, twice weekly *Fee:* \$120
Tutor: Mrs. Carmen Tang, B.A. (University of Richmond.)

This course aims to introduce students who already have an elementary knowledge of Spanish to a "comprehensive picture of Spain, her land and people, her history and culture, both in the past and in the present". It is hoped that through the reading selections the student will gain a wide variety of vocabulary, be exposed to a variety of styles, practise conversation and composition. English will be the main teaching medium. Specially prepared reading and conversation pattern exercises will be used in addition to the recommended text.

Textbook: *Cuentos y Comedias de Espana*, by Turk & Brady, Riverside Press, Cambridge.

104. FRENCH FOR BEGINNERS

Time: Monday & Wednesday, 7.15-8.15 p.m., starting September 26, 1966.
Place: University Main Building, H.K.U.
No. of Meetings: 48, twice weekly *Fee:* 180
Tutor: Mrs. Dominique McLachlan

Designed for students with no previous knowledge of the language, the aim is to give a thorough grounding in basic grammar and pronunciation so as to enable students to read and speak simple French.

Textbook: *Living French*, by T. W. Knight.

105. FRENCH II

Time: Mons. & Thurs., 6-7 p.m., starting Nov. 17, 1966.
Place: University Main Building, H.K.U.
No. of Meetings: 40, twice weekly *Fee:* \$160
Tutor: Mrs. Ann Loxton Wong, M.A. Aberdeen (Scotland); Tutor, Modern Languages Dept., University of Hong Kong.

The basic forms of French grammar will be revised and ample opportunity will be given for oral practice and aural work. Attention will also be paid to translation and composition, vocabulary and dictation.

Textbook: *A Complete French Course for First Examinations*, by W.F.H. Whitmarsh (Longmans).

COMMERCE AND ECONOMICS

Tutor in Charge: Laurence Pang

Tel: 440304

106. ACCOUNTANCY

Time: Thursdays, 5.45-6.45 p.m., starting Sept. 15, 1966.

Place: Extra Mural Law Centre, Chiao Shang Bldg., 8/F., 92-94, Queen's Road Central.

No. of Meetings: 30, once weekly *Fee:* \$100

Tutor: Mr. G. J. M. McLeod, Member of Institute of Chartered Accountants; Member of Institute of Cost & Works Accountants.

The functions of accounting and the pattern of business accounts, trial balance, profit and loss account, balance sheet, accounts of sole traders, partnerships, joint stock companies, and other various types of accounts.

It is suggested that students should have some knowledge of basic accounting and preferable that they will soon be taking intermediate examinations of some professional body.

107. AUDITING

Time: Wednesdays, 8.15-9.15 p.m., starting Sept. 28, 1966.

Place: Extra-Mural Law Centre, Chiao Shang Bldg., 8/F., 92-94, Queen's Road Central, Hong Kong.

No. of Meetings: 24, once weekly *Fee:* \$80

Tutor: Mr. A. R. Hamilton, C.A., Chartered Accountant.

This course deals with the following topics:— the principles and objects of auditing, the audit of cash transactions, the audit of trading transaction, the audit of outstanding assets and liabilities, the audit of a limited company, and the liability of auditors. It is suitable for all wanting a basic knowledge of auditing, as well as those preparing for professional examinations.

108. COST ACCOUNTING

Time: Wednesdays, 5.45-6.45 p.m., starting Sept. 28, 1966.

Place: Extra-Mural Law Centre, Chiao Shang Bldg., 8/F., 92-94, Queen's Rd. C., H.K.

No. of Meetings: 24, once weekly *Fee:* \$80

Tutor: Mr. Y. Y. Lam, A.A.C.C.A.

This course deals with the following topics:— the classes of cost accounts, the classification of expenditure, costing for materials including stock control, costing for wages including remuneration system, costing for overhead including treatment of indirect expenses, budgetary control and standard costing, marginal costing. It is suitable for all wanting a basic knowledge of cost accounting, as well as those preparing for professional examinations.

109. COMPANY SECRETARYSHIP

Time: Fridays, 8.15-9.15 p.m., starting Sept. 23, 1966.

Place: Extra-Mural Law Centre, Chiao Shang Bldg., 8/F., 92-94, Queen's Rd. C., Hong Kong.

No. of Meetings: 24, once weekly *Fee:* \$80

Tutor: Mr. J. K. S. Thong, F.C.I.S., F.A.C.C.A.

This course covers the practical work of the company secretary with particular reference to internal administration, business management, and office organisation. It is suitable for all wanting a basic knowledge of secretarial practice, as well as those preparing for professional examinations.

110. MANAGERIAL ACCOUNTING

Time: Thursdays, 7-8 p.m., starting Oct. 13, 1966.

Place: Extra-Mural Law Centre, Chiao Shang Bldg., 8/F., 92-94, Queen's Road Central.

No. of Meetings: 20, once weekly *Fee:* \$65

Tutor: Mr. G. J. M. McLeod, Member of Institute of Chartered Accountants; Member of Institute of Cost & Works Accountants.

Preparation, presentation and interpretation of financial and appropriate statistical information, both routine and special, for use by the Board and all levels of management for the purpose of planning and controlling. The principles and operation of financial analysis used by management including those for budgeting, operation controlling inventories, assessing return on capital employed, evaluation of cash flows etc.

Students should be either accountants responsible for preparing accounting data, budgets etc. for management interpretation or executive staff who must make decisions from data supplied to them by the accounting section of the organisation.

111. ELEMENTARY ACCOUNTING

Time: Thursdays, 8.15-9.15 p.m., starting Oct. 13, 1966.

Place: Extra Mural Law Centre, Chiao Shang Bldg., 8/F., 92-94, Queen's Road Central.

No. of Meetings: 20, once weekly *Fee:* \$65

Tutor: Mr. G. J. M. McLeod, Member of Institute of Chartered Accountants; Member of Institute of Cost & Works Accountants.

Preparation of books of prime entry including day books, journals, cash book and ledgers, preparation of trial balance, profit & loss account and balance sheet of sole proprietors and partnerships. Detailed consideration of elementary bookkeeping procedures and partnership and limited company accounting.

Suitable for all wanting a basic knowledge of bookkeeping and of accountancy.

112. ADVANCED ACCOUNTANCY

Time: Tuesdays, 7-8 & 8.15-9.15 p.m., starting Oct. 18, 1966.

Place: Extra-Mural Law Centre, Chiao Shang Bldg., 8/F., 92-94, Queen's Rd. C., Hong Kong.

No. of Meetings: 20 two-hour sessions, once weekly *Fee:* \$140

Tutor: Mr. O. M. L. Rhys, A.C.A., Chartered Accountant.

The following topics will be covered: — principles of advanced accountancy; amalgamations and reconstructions, liquidations and taxation in company accounts, consolidated accounts; capital structure of companies; sources of company finance; capitalization of profits; financial budgets & forecasting; the Companies Act 1948; investment accounts; interpretation and criticisms of accounts.

Applicants for this course must either have passed the intermediate level or else in the opinion of the tutor have acquired sufficient knowledge of accountancy.

113. PRINCIPLES OF HONG KONG TAXATION

Time: Fridays, 7-8 p.m., starting Oct. 21, 1966.

Place: Extra-Mural Law Centre, Chiao Shang Bldg., 8/F., 92-94, Queen's Rd. C., Hong Kong.

No. of Meetings: 20, once weekly

Fee: \$65

Tutor: Mr. J. K. S. Thong, F.C.I.S., F.A.C.C.A.

This course will provide a comprehensive explanation of the principles of assessing income liable to Hong Kong income tax. Particular attention will be given to various departments of the Inland Revenue, including the powers and duties of the Board of Inland Revenue and the Board of Review.

114. ACCOUNTING AND GENERAL COMMERCIAL KNOWLEDGE

PART I: BANKING AND FOREIGN EXCHANGE

會計與商業常識

本課程共分三節：(一)銀行與外匯，(二)保險與航務，(三)香港利得稅。其講授內容側重個別問題與會計運用之關係，學員可就其本人興趣選修部份或全部課程。

(一) 銀行與外匯

本節共八講，講述銀行業務，利息計算，商業票據，國外匯兌，銀行及外匯等有關問題之會計處理。

主 講 人：盧子葵先生

講授語言：粵語

地 點：香港大學校本部

時 間：一九六六年九月廿日起

每星期二下午六時至七

時

學 費：廿五元

PART II: INSURANCE & SHIPPING

(二) 保險與航務

本節共八講，內容包括提貨憑單，航程帳戶，水火人壽保險，合夥事業，航業及保險等有關問題之會計處理。

主 講 人：盧子葵先生

講授語言：粵語

地 點：香港大學校本部

時 間：一九六六年十一月廿九

日起每星期二下午六時

至七時

學 費：廿五元

PART III: HONG KONG PROFITS TAX

(三) 香港利得稅

本節共十六講，每週二次，討論利息稅，物業稅，薪俸稅，個人入息課稅，折舊計算、各項稅務等有關問題之會計處理。

主 講 人：盧子葵先生

講 授 語 言：粵語

地 點：香港大學校本部

時 間：一九六七年二月廿一日

起每星期二下午六時至
七時及七時十五分至八
時十五分

學 費：五十元

× × ×

(同時修讀全部課程者收費八十元)

115. ECONOMIC THEORY

Time: Tuesdays, 6-7 p.m., starting Sept. 13, 1966.

Place: University Main Bldg., H.K.U.

No. of Meetings: 30, once weekly *Fee:* \$100

Tutor: Mr. Hung Chiu Ling, B.A. (H.K.), Dept. of Economics & Political Science.

This is a course dealing with the basic principles of Economics. It covers the fundamental concepts and tools of modern economic analysis; general principles governing production, distribution and consumption; theories of price, income and employment, money and banking, international trade, public finance and economic growth. This course is specially designed for those who require an introduction to Economics, whether for general interest or for various professional examinations.

116. PRINCIPLES OF ECONOMICS I

Time: Wednesdays, 7-8 p.m., starting Oct. 12, 1966.

Place: Extra-Mural Law Centre, Chiao Shang Bldg., 8/F., 92-94, Queen's Rd. C., H.K.

No. of Meetings: 8, once weekly *Fee:* \$25

Tutor: Laurence Pang, B.A. (H.K.); Staff Tutor, Dept. of Extra-Mural Studies, H.K.U.

An introductory course dealing with basic economic concepts. Topics to be considered include demand and supply analysis, production, factors of production, firms, markets, national income analysis and income fluctuations.

117. PRINCIPLES OF ECONOMICS II

Time: Mondays, 5.45-6.45 p.m., starting Feb. 13, 1967.

Place: Extra-Mural Law Centre, Chiao Shang Bldg., 8/F., 92-94, Queen's Rd. C., H.K.

No. of Meetings: 8, once weekly *Fee:* \$25

Tutor: Mr. Laurence Pang, B.A. (H.K.); Staff Tutor, Dept. of Extra-Mural Studies, H.K.U.

In this section, public finance, budget policy, money and banking, monetary policy and current economic issues will be considered.

118. PRACTICE OF BANKING

Time: Tuesdays, 8.15-9.15 p.m., starting Sept. 27, 1966.
Place: Extra-Mural Law Centre, Chiao Shang Bldg., 8/F., 92-94, Queen's Rd. C., H.K.
No. of Meetings: 12, once weekly *Fee:* \$40
Tutor: Mr. Wong Hing-Nin, B.A. (H.K.); A.I.B.; Chartered Bank.

This series of lectures is designed for those who are connected with or interested in banking. Topics to be covered include relationship of banker and clients, banking operations, the Bills of Exchange Act, 1882, types of account holder, advances to clients, and interpretation of clients' balance sheets.

119. INTERNATIONAL FINANCE AND TRADE

Time: Mondays, 5.45-6.45 p.m., starting Oct. 24, 1966.
Place: Extra-Mural Law Centre, Chiao Shang Bldg., 8/F., 92-94, Queen's Rd. C., H.K. (entrance at Cochrane St.)
No. of Meetings: 12, once weekly *Fee:* \$40
Tutor: Mr. Norman Y. Tao, M.A. (New York)

This course aims at examining some basic principles and techniques of international trade. Reference will be made to the history of international trade; the nature of international trade; international commercial policies; foreign market surveys; international finance; and to banks financing foreign trade.

120. MONEY & BANKING AND WORLD FINANCE

PART I: HONG KONG'S BANKING & MONETARY SYSTEM

Time: Fridays, 7-8 p.m., starting Sept. 30, 1966.
Place: Committee Room South, City Hall, 7/F.
No. of Meetings: 12, once weekly *Fee:* \$40
Tutor: Mr. K. L. Ng, B.A. (H.K.), Statistician, Dept., of Commerce & Industry.

This series of lectures is especially suitable for bank personnel. Topics to be considered include money supply, the Banking Ordinance 1964, clearing house, inter-bank call money market, foreign exchange market, exchange control, structure of interest rates, sterling area and external financial relations.

PART: II:

INTERNATIONAL MONETARY COOPERATION & WORLD FINANCE

Time: Fridays, 7-8 p.m., starting Jan. 13, 1967.
Place: Committee Room South, City Hall, 7/F.
No. of Meetings: 12, once weekly *Fee:* \$40
Tutor: Mr. K.L. Ng, B.A. (H.K.), Statistician, Dept., of Commerce & Industry.

In this section, the theory and practice of foreign exchange, rates of exchange, international key currencies, international balance of payments, gold standard, I.M.F., the World Bank and regional monetary arrangements will be considered.

121. VALUATION OF LAND AND BUILDINGS — INTERMEDIATE

Time: Wednesdays, 5.45-6.45 p.m., starting Sept. 14, 1966.
Place: Extra-Mural Law Centre, Chiao Shang Building, 8/F., 92-94,
Queen's Road C., H.K. (entrance at Cochrane St.)
No. of Meetings: 10, once weekly *Fee:* \$30
Tutor: Mr. C. M. Steward, A.R.I.C.S., Chartered Surveyor, Rating
& Valuation Department.

This course is intended for students who have a basic knowledge of the principles of valuation and will be largely devoted to the explanation and discussion of questions set in recent Intermediate Examinations of professional bodies.

122. FIRE HAZARDS AND INSURANCE FOR THE BUSINESS MEN

Time: Wednesdays, 5.30-6.30 p.m., starting Sept. 21, 1966.
Place: Committee Room North, City Hall, 7/F.
No. of Meetings: 6, once weekly *Fee:* \$20
Tutors: to be announced.

The object of this short course is to examine some aspects of fire hazards and their prevention. Other topics to be discussed include consequential loss, law and claims.

Enrolment is limited to 25.

123. OCEAN TRANSPORT

Time: Fridays, 5.45-6.45 p.m., starting Sept. 30, 1966.
Place: Extra-Mural Law Centre, Chiao Shang Bldg., 8/F., 92-94,
Queen's Rd. C., H.K. (entrance at Cochrane St.)
No. of Meetings: 12, once weekly *Fee:* \$40
Tutors: Members of the shipping department staff, Jardine, Matheson
& Co. Ltd.

The aim of this introductory course is to discuss some aspects of the shipping industry. Topics to be considered include ship design & classification, shipping institutions, liner service, shipment & carriage of cargo, ship managers & agents, conditions of carriage, particular & general average, master, officers and crew.

124. PROPERTY DEVELOPMENT AND MANAGEMENT

Time: Tuesdays, 6-7.30 p.m., starting Oct. 4, 1966.

Place: U.S. Cultural Centre, Lecture Theatre, 1/F., Hing Fat House, Duddell Street, H.K.

No. of Meetings: 7, once weekly *Fee:* \$35

Tutors: Various (see below)

Chairman: Mr. T. A. Roberts.

A course of seven discussion-meetings of 1½ hours each preceded by an introductory lecture. The purpose of the course will be to examine some basic principles and techniques of property investment, development and management.

The programme will include:

1. *Economics of Real Estate* Mr. K. C. Pang, Goodyear Investors, Ltd.
2. *Real Estate As An Investment* Mr. K. C. Pang, Goodyear Investors, Ltd.
3. *Management of Small Properties* Mr. H. C. Griffiths, P. W. D.
4. *Security of Buildings* Mr. H. E. C. Atkinson, Securicor Ltd.
5. *Maintenance & Repairs of Buildings* Mr. F. A. Fosler, The Hongkong & Shanghai Banking Corp.
6. *Dangerous Structures* Mr. J. G. Stean, P. W. D.
7. *Property Recession* Mr. T. A. Roberts, Eric Cumine

Enrolment is limited to 30. Preference will given to those who are working in or connected with the building industry.

125. BUSINESS STATISTICS

Time: Mondays, 8.15-9.15 p.m., starting Oct. 3, 1966.

Place: Extra-Mural Law Centre, Chiao Shang Bldg., 8/F., 92-94, Queen's Rd. C., H.K. (entrance at Cochrane St.)

No. of Meetings: 12, once weekly *Fee:* \$40

Tutor: Mr. Law Tai-Ping, Louis, B.A. (H.K.), Dept. of Commerce & Industry.

An outline of fundamental statistical concepts and the application of statistical methods to modern business problems. The more important uses of statistics in business are to be found in the fields of market research, sales forecasting, quality control and business management. The method of collecting, and application of, business data especially those available in Hong Kong will be discussed. Common errors in the interpretation of figures, ratios and their comparison and the misuses of statistics in business will also be considered.

126. AN INTRODUCTION TO HOSPITAL ADMINISTRATION

Time: Mondays, 6-7 p.m., starting Sept. 26, 1966.

Place: Wah Yan College, Kowloon

No. of Meetings: 24, once weekly *Fee:* \$80

Tutor: Mr. A. E. Starling, F.H.A., F.C.C.S., F.R.S.H., Senior Hospital Secretary.

The series of lectures is designed for those who are connected with or who have some interest in Hospital administration. The course will, so far as possible, follow the syllabus laid down for the Diploma of the Institute of Hospital Administrators and will cover the evolution of the modern general hospital; the basic principles of the National Health Service in the United Kingdom; hospital organisation; internal administration; the relationship of hospital departments one with the other; and practical hospital administration.

127. FACTORY OPERATION & SCIENTIFIC MANAGEMENT

PART: I FACTORY OPERATION

工廠建設與科學管理

本課程分兩階段進行教學，第一階段講「工廠建設」問題，研究如何投資建廠；第二階段講「科學管理」問題，研究如何在工廠建成以後進行科學管理工作，以求獲得高度之生產率及利潤率，故適合有志投資建廠及從事工廠管理之人士選讀。

(一) 工廠建設

本階段共十二講，內容包括建廠計劃書之編製，主要產品種類與生產規模之確定，廠址之選擇，廠址總體設計，車間(工場)設計等本階段之部份內容且為下一階段講題之基礎。

主 講 人：王天民 碩士

講 授 時 間：粵語

地 點：香港大學校外課程部市區中心

時 間：一九六六年九月廿八日起每星期三下午八時十五分至九時十五分

學 費：四十元

PART II: SCIENTIFIC MANAGEMENT

(二) 科學管理

本階段共十二講，內容包括科學管理之基本原則及組織形式，規章制度之製訂與變更，生產過程之組織與計劃管理，勞動管理，材料，技術供應與產品銷售管理，技術管理，安全生產等。

主 講 人：王天民 碩士

講 授 語 言：粵語

地 點：香港大學校外課程部市區中心

時 間：一九六七年一月十八日起每星期三下午八時十五分至九時十五分

學 費：四十元

128. MARKETING MANAGEMENT

Time: Tuesdays, 5.45-6.45 p.m., starting Oct. 4, 1966.

Place: Extra-Mural Law Centre, Chiao Shang Bldg., 8/F., 92-94, Queen's Rd. C., H.K. (entrance at Cochrane St.)

No. of Meetings: 24, once weekly

Fee: \$80

Tutor: Dr. Francis Pan, D.C.S. (New York)

This is a course dealing with the theory and practice of marketing management. Topics to be covered include scope and definition, consumers' acceptance, marketing organisation, market research, marketing channels, salesmanship, publicity and advertising, price policies, credit information, marketing management and socio-legal relationships. It is especially suitable for business executives interested in marketing and distribution.

129. INDUSTRIAL MANAGEMENT

Time: Tuesdays, 7-8 p.m., starting Oct. 4, 1966.

Place: Extra-Mural Law Centre, Chiao Shang Bldg., 8/F., 92-94, Queen's Rd. C., H.K. (entrance at Cochrane St.)

No. of Meetings: 24, once weekly *Fee:* \$80

Tutor: Dr. Francis Pan, D.C.S. (New York)

A general introduction to the basic concepts and techniques of industrial management. Topics to be discussed include elements of economic growth, economics of production, production controls, industrial relations and current problems of industrial management. It will be of particular value to executives of industrial concerns, as well as those who are interested in the study of scientific management of industry.

130. BUSINESS MANAGEMENT I

Time: Fridays, 7-8 p.m., starting Oct. 7, 1966.

Place: Extra-Mural Law Centre, Chiao Shang Building, 8/F., 92-94, Queen's Rd. C., H.K. (entrance at Cochrane St.)

No. of Meetings: 12, once weekly *Fee:* \$40

Tutor: Dr. T. C. Lee, D.C.S. (New York)

A compact introduction to the principles and practice of scientific business management. The course is divided into two Parts. Part I discusses basic concepts. Part II emphasizes techniques. Students may take Part I without enrolling for Part II; but preference will be given to those who have taken Part I when considering applications for Part II.

131. BUSINESS MANAGEMENT II

Time: Fridays, 7-8 p.m., starting Feb. 17, 1967.

Place: Extra-Mural Law Centre, Chiao Shang Bldg., 8/F., 92-94, Queen's Rd. C., H.K. (entrance at Cochrane St.)

No. of Meetings: 10, once weekly *Fee:* \$30

In this section particular emphasis will be paid to time & motion study, quality & material control, & market analysis.

132. PERSONNEL MANAGEMENT

Time: Fridays, 5.45-6.45 p.m., starting Oct. 7, 1966.

Place: Extra-Mural Law Centre, Chiao Shang Bldg., 8/F., 92-94, Queen's Rd. C., H.K. (entrance at Cochrane St.)

No. of Meetings: 12, once weekly *Fee:* \$40

Tutor: Mr. Cecil C. Luk M.B.A. (New York), A.M.B.I.M.

This course is designed to provide an appreciation of and insight into modern personnel management technique for those who are at present in personnel or supervisory positions, or those who are being prepared for these responsibilities. It covers personnel administration, supervision skills and incentives for effective performance. Case studies will be considered and ample time given for discussion.

133. PUBLIC RELATIONS

Time: Wednesdays, 5.45-6.45 p.m., starting Oct. 19, 1966.

Place: U.S. Cultural Centre, Lecture Theatre, Hing Fat House, 1/F.,
Duddell St., H.K.

No. of Meetings: 10, once weekly *Fee:* \$30

Tutor: Mr. B. Wythe, Member of the Public Relations Institute of
Australia.

This course will mainly be concerned with public relations as it is practised today in Hong Kong and other countries. Its role as an aid to modern marketing, as a means of conveying ideas and policies, and in assisting companies and institutions in developing sound reputations and relationships will be discussed. There will be some examination of the techniques of public relations and the qualification that help to make a successful public relations officer or consultant. No previous knowledge is assumed.

Enrolment is limited to 30.

134. MONETARY THEORY & PRACTICE I

Time: Fridays, 8-9 p.m., starting Nov. 18, 1966.

Place: Committee Room South, City Hall, 7/F.

No. of Meetings: 12, once weekly *Fee:* \$40

Tutor: Mr. Peter Ling Ping-Yat, B.A. (H.K.)

A course designed for bank personnel as well as those preparing for the Institute of Bankers examination. Topics to be considered include the nature, functions, forms and value of money, the various monetary systems such as commercial and central banking, structure of interest rates and objectives and techniques of monetary policies.

135. MONETARY THEORY & PRACTICE II

Time: Fridays, 8-9 p.m., starting Feb. 17, 1967.

Place: Committee Room South, City Hall, 7/F.

No. of Meetings: 12, once weekly *Fee:* \$40

Tutor: Mr. Peter Ling Ping-Yat, B.A. (H.K.)

In this section, the theory of balance of payments, international balance of payments and methods of adjusting the balance, the rates of exchange, forms of official intervention and exchange control, sterling and sterling area, U.S. dollar and other international key currencies will be discussed.

136. ECONOMICS FOR IMPORTERS & EXPORTERS I

Time: Mondays, 8-9 p.m., starting Sept. 19, 1966.

Place: Committee Room South, City Hall, 7/F.

No. of Meetings: 14, once weekly *Fee:* \$40

Tutor: Mr. K.L. Ng, B.A. (H.K.), Statistician,
Dept. of Commerce & Industry

The first section of this course deals with basic economic principles. Topics to be considered include theory of international trade and comparative costs, import/export price indices, terms of trade, balance of payments, exchange rates, exchange control, foreign exchange markets, letter of credit and bill of exchange, overseas investments and movements of capital, tariffs and quota restrictions.

137. ECONOMICS FOR IMPORTERS & EXPORTERS II

Time: Mondays, 8-9 p.m., starting Jan. 30, 1967.

Place: Committee Room South, City Hall, 7/F.

No of Meetings: 16, once weekly *Fee:* \$45

Tutor: Mr. K.L. Ng, B.A. (H.K.), Statistician,
Dept. of Commerce & Industry

The second section provides background information about international and regional organizations, such as the Export Credit Insurance Corporation G.A.T.T., and I.M.F., discusses problems in trade and payments such as the types of certification of origin, textile export control and trade financing; and analyses current economic conditions in Hong Kong as well as leading markets for Hong Kong's exports like E.E.C. & E.F.T.A.



PROFESSIONAL AND VOCATIONAL COURSES

ALL COURSES IN THIS SECTION ARE SPECIALLY DESIGNED TO FOLLOW THE SYLLABUSES OF THE VARIOUS PROFESSIONAL EXAMINATIONS (AS LISTED BELOW). THEY ARE OPEN TO ALL INTERESTED, BUT THOSE WISHING TO SIT FOR THE VARIOUS EXAMINATIONS SHOULD MAKE THEIR OWN ARRANGEMENTS UNLESS SPECIFIED OTHERWISE AND SHOULD ENSURE BEFOREHAND THAT THEY HAVE THE NECESSARY ENTRY QUALIFICATIONS. ONLY THOSE WHO HAVE ATTENDED AT LEAST TWO-THIRDS OF THE LECTURES ARE ELIGIBLE TO SIT THOSE PROFESSIONAL EXAMINATIONS CONDUCTED BY THE EXTRA-MURAL DEPARTMENT.

LIBRARIANSHIP

Tutor in Charge: *Priscilla Tso*

Tel: 435712

138. LIBRARIANSHIP CERTIFICATE COURSE

Time: Mondays & Thursdays, 6-7 p.m., starting August 8, 1966.

Place: University Main Building, Hong Kong University.

Tutors: Mrs. B. Gleave, F.L.A. (Tutor-in-Charge)
Miss L. B. Kan, B.Sc. (H.K.), M.A., M.L.S. (Calif.)

This course is planned in co-operation with the Hong Kong Library Association and is designed to provide a thorough training in Librarianship for Library Assistants. The course consists of three sections:—

Part IA — <i>Librarianship</i>		
No. of Meetings: 17	Fee: \$50	
IB — <i>Classification & Cataloguing</i>		
No. of Meetings: 16	Fee: \$50	
Part II — A) <i>General Library Practice</i>		
B) <i>School Library Practice</i>		
No. of Meetings: 22	Fee: \$80	
Part III — <i>Practical Work</i>		
No. of Meetings: 6 morning sessions of 3 hours each.	Fee: \$80	
Reduced fee for the whole course: \$180		

Examination Requirements:

- 1) Hong Kong English School Leaving Certificate or Chinese School Leaving Certificate with Credit in English or its equivalent,
- 2) Hong Kong Library Association Membership,
- 3) 75% attendance.

Date of Examination: April 8, 1967

If successful, candidates will be awarded a certificate issued jointly by the Hong Kong Library Association and the Department of Extra-Mural Studies.

Applicants are advised not to take any other public examinations in the same year.

139. SECOND YEAR LIBRARIANSHIP COURSE

Time: Wednesdays, 6-7 p.m., starting August 24, 1966.
Place: University Main Building, Hong Kong University.
No. of Meetings: 28, once weekly *Fee:* \$120
Tutors: Mrs. B. Gleave, F.L.A. (Tutor-in-Charge),
Miss L. B. Kan, B.Sc. (H.K.), M.A., M.L.S. (Calif.).

This course, arranged in co-operation with the Hong Kong Library Association, is based upon the United Kingdom Library Association Part I Examination. The course is a revision and extension of the work covered in the Librarianship Certificate Course. The Examination will be held in Hong Kong in June and December.

Library Association Part I Examination:—

- Paper 1: The Library and the Community
- Paper 2: Government and control of libraries
- Paper 3: Organization of knowledge
- Paper 4: Bibliographical control and service

Qualifications: H.K. University Matriculation or its equivalent.

Preference will be given to those who have completed the Librarianship Certificate Course.

140. AN INTRODUCTION TO TOWN AND COUNTRY PLANNING

Tutor in Charge: C. K. Leung

Tel: 440304

THIS COURSE IS ORGANIZED UNDER THE AUSPICES OF THE HONG KONG BRANCH OF THE TOWN PLANNING INSTITUTE AND, ALTHOUGH BASED ON THE SYLLABUSES OF THE INTERMEDIATE AND FINAL EXAMINATIONS OF THE TOWN PLANNING INSTITUTE, WILL ALSO BE OF INTEREST TO THE GENERAL PUBLIC.

Tutor: J. M. Wigglesworth, B.Arch., M.C.D., A.R.I.B.A., M.T.P.I.

PART I: REGIONAL AND LAND USE PLANNING

Time: Thursdays, 8.15-9.15 p.m., starting Sept. 15, 1966.
Place: Extra-Mural Law Centre, Chiao Shang Bldg., 8/F., 92-94, Queen's Rd. C., H.K. (entrance at Cochrane Street)
No. of Meetings: 10, once weekly *Fee:* \$30

The expansion of towns and future problems — decentralisation and new towns — The economics and planning of industrial location — traffic in towns — town planning and land economics — the density of residential areas — country planning — regional planning and the basic elements of regions — economic, physical and regional planning techniques — action planning.

Part I is designed for geographers, economists, surveyors, etc. who are interested in the land use aspects of town planning.

PART II: URBAN PLANNING AND TOWN DESIGN

Time: Fridays, 8.15-9.15 p.m., starting Nov. 25, 1966.
Place: Extra-Mural Law Centre, Chiao Shang Bldg., 8/F., 92-94, Queen's Rd. C., H.K. (entrance at Cochrane Street)
No. of Meetings: 10, once weekly *Fee:* \$30

The enclosed place and open planning — the street and high buildings — pedestrian and vehicular segregation — comprehensive development — redevelopment of central areas — shopping centres — the design of residential areas — the layout of residential areas — the influence of climate on layout and design — *fung shui* and townscape in Hong Kong.

Part II is designed for architects, engineers, etc. who are more interested in the environmental and design aspects of planning.

HOUSING MANAGEMENT

Tutor in Charge: *Priscilla Tso*

Tel: 435712

141. SOCIAL WELFARE I

Time: Wednesdays at 6-7 p.m., starting September 7, 1966.

Place: University Main Bldg., H.K.U.

No. of Meetings: 24, once weekly

Tutor: (to be confirmed)

142. LAW OF LANDLORD AND TENANT I

Time: Wednesdays at 7.15-8.15 p.m., starting September 7, 1966.

Place: University Main Bldg., H.K.U.

No. of Meetings: 24, once weekly

Tutor: Mr. Geoffrey Grimmett, Crown Counsel.

143. SOCIAL WELFARE II

Time: Saturdays at 10-12.15 p.m., starting September 10, 1966.

Place: Extra-Mural Law Centre, Chiao Shang Bldg., 8/F., 92-94, Queen's Road C., Hong Kong. (entrance at Cochrane St.)

No. of Meetings: 24, once weekly

Tutor: (to be confirmed)

144. LAW OF LANDLORD AND TENANT II

Time: Wednesdays at 6-7 p.m., starting September 7, 1966.

Place: University Main Bldg., H.K.U.

No. of Meetings: 20, once weekly

Tutor: Mr. Geoffrey Grimmett, Crown Counsel.

These courses lead to the Hong Kong Government Housing Management Part I and Part II Examinations and are open to Hong Kong Housing Authority sponsored students only.

145. ADVERTISING CERTIFICATE COURSE

Time: Wednesdays, 5.45-6.45 p.m., starting Oct. 12, 1966

Place: Extra-Mural Law Centre, Chiao Shang Bldg., 8/fl., 92-94 Queen's Rd. C., Hong Kong.

No. of Meetings: 20, once weekly *Fee:* \$60

Tutors: to be announced

Arranged in co-operation with the Hong Kong Advertisers Association and the "4 A's", this course, aims to provide a training in advertising. Topics to be discussed include merchandising, research, product orientation and market analysis, media characteristics and evaluation of media, creative strategy, writing copy, mechanical production, commercial film production, and career prospects in advertising.

Qualifications: H.K. English School Certificate or its equivalent or nominated by the Hong Kong Advertisers Association or the "4 A's."

Enrolment is limited to 40.

**CHARTERED INSTITUTE OF SECRETARIES
INTERMEDIATE EXAMINATION:**

1. Economic Theory *See Course No. 115.*
 2. General Principles of English Law *See Course No. 73.*
 3. Accountancy *See Course No. 106.*
 4. English for Higher Commercial Studies *See Course No. 46.*
-

**CHARTERED INSTITUTE OF SECRETARIES
FINAL EXAMINATION:**

1. Company Secretaryship *See Course No. 109.*
 2. Advanced Accountancy *See Course No. 112.*
 3. Company Law and Partnership *See Course No. 72.*
-

**ASSOCIATION OF CERTIFIED AND CORPORATE
ACCOUNTANTS INTERMEDIATE EXAMINATION**

Section I

1. Elementary Accounting *See Course No. 111.*
2. Economics and Business Statistics *See Courses Nos. 115
& 125.*
3. Cost Accounting *See Course No. 108.*

Section II

4. Accountancy *See Course No. 106.*
 5. Auditing *See Course No. 107.*
-

**ASSOCIATION OF CERTIFIED AND CORPORATE
ACCOUNTANTS FINAL EXAMINATION**

Section I

1. Advanced Accountancy *See Course No. 112.*
2. Company Law and Partnership *See Course No. 72.*
3. Business Administration *See Courses Nos. 130
& 131.*
4. Cost Accounting *See Course No. 108.*

Section II

5. Advanced Accountancy *See Course No. 112.*
 6. Management Accounting *See Course No. 110.*
 7. Auditing *See Course No. 107.*
-

**CORPORATION OF SECRETARIES INTERMEDIATE
EXAMINATION:**

1. Accountancy *See Course No. 106.*
 2. Economic Theory *See Course No. 115.*
 3. English for Higher Commercial Studies *See Course No. 46.*
 4. General Principles of English Law *See Course No. 73.*
-

**CORPORATION OF SECRETARIES FINAL
EXAMINATION**

Part I

1. Economic Theory *See Course No. 115.*
2. Company Secretaryship *See Course No. 109.*

Part II

3. Accountancy *See Course No. 106.*
4. Company Law and Partnership *See Course No. 72.*

Part III

5. Business Administration *See Courses Nos. 130
& 131.*

AUSTRALIAN SOCIETY OF ACCOUNTANTS

Stage I

1. Accounting and Auditing *See Courses Nos. 106 & 107.*

Stage II

2. Company Law and Partnership *See Course No. 72.*
3. Monetary Theory and Practice *See Courses Nos. 134 & 135*

Stage III

4. Advanced Accounting *See Course No. 112*
 5. Auditing *See Course No. 107*
-

INSTITUTE OF BANKERS

Part I

1. English for Higher Commercial Studies *See Course No. 46.*
2. Economics *See Course No. 115.*
3. Elementary Accounting *See Course No. 111.*
4. General Principles of English Law *See Course No. 73.*

Part II

1. Monetary Theory and Practice *See Courses Nos. 134 & 135.*
 2. Accountancy *See Course No. 106.*
-

ROYAL INSTITUTE OF CHARTERED SURVEYORS FIRST EXAMINATION

1. Economics *See Course No. 115.*
 2. General Principles of English Law *See Course No. 73.*
-

ROYAL INSTITUTE OF CHARTERED SURVEYORS INTERMEDIATE EXAMINATION

1. Principles of Town and Country Planning *See Course No. 140.*
 2. Valuation of Land and Buildings *See Course No. 121.*
-

ASSOCIATION OF INTERNATIONAL ACCOUNTANTS INTERMEDIATE EXAMINATION

Section I

1. Elementary Accounting *See Course No. 111.*
2. Auditing *See Course No. 107.*

Section II

3. Company Law and Partnership *See Course No. 72.*
 4. Economic Theory *See Course No. 115.*
-

ASSOCIATION OF INTERNATIONAL ACCOUNTANTS FINAL EXAMINATION

Section I

1. Accountancy *See Course No. 106.*
2. Auditing *See Course No. 107.*

Section II

3. Company Law and Partnership *See Course No. 72.*
4. Cost Accounting *See Course No. 108.*

SOLICITORS' PART I EXAMINATION:

- | | |
|-----------------------|---------------------------|
| 1. Contract | <i>See Course No. 68.</i> |
| 2. Constitutional Law | <i>See Course No. 67.</i> |
| 3. Criminal Law | <i>See Course No. 71.</i> |
| 4. Legal System | <i>See Course No. 69.</i> |
-

SOLICITORS' PART II EXAMINATION:

- | | |
|--------------------------------|---------------------------|
| 1. Company Law and Partnership | <i>See Course No. 72.</i> |
|--------------------------------|---------------------------|
-

LONDON LL.B. EXTERNAL DEGREE

1. *LL.B. (London) Intermediate*
 - a) Roman Law
 - b) Constitutional Law
 - c) English Legal System
 - d) Law of Contract
2. *LL.B. (London) Part I*
 - a) English Land Law
 - b) Criminal Law
 - c) Law of Trusts
 - d) Law of Tort
3. *LL.B. (London) Part II*
 - a) English Land Law
 - b) Jurisprudence
 - c) Succession
 - d) Mercantile Law

These courses are part of a scheme whereby, through special arrangement with the University of London, qualified persons may study for the London LL.B. external Degree after office hours and over a shorter period of time than hitherto possible (that is, over three years instead of five).

The three courses will commence in October, 1966 and terminate at the end of May, 1967. It is intended that there should be a programme of 40 lectures and fortnightly tutorials on each subject. Examination will be held in June 1967.

The Extra-Mural Law Library is available for the use of the students on weekdays from 9 a.m. to 10 p.m. and on Saturday mornings.

Course fee: \$1,000.

No further applications are invited as February 22, 1966 was set as the closing date.

SEMINARS

INTERNATIONAL TEXTILE MACHINERY SEMINAR

Date: Monday & Tuesday, November 14 & 15, 1966.

Place: Hong Kong Hilton

No. of Lectures: 5 *Fee:* \$60

Speaker: Mr. Armin H. Keller,
President,
International Textile Club,
Zurich, Switzerland.

Moderator: Mr. Kayser Sung,
Managing Editor,
Far Eastern Economic Review Ltd.

PROGRAMME

- | | | |
|---------|----------------|--|
| 1st Day | 2.00—3.45 p.m. | 1. Spinning: Cotton, Wool & Synthetic Fibres |
| | 4.00—5.30 p.m. | 2. Winding, Twisting and Texturizing |
| | 5.30—6.00 p.m. | (Coffee break) |
| | 6.00—7.30 p.m. | 3. Preparation for Weaving, Conventional Looms and Shuttle-less Weaving Machines |
| 2nd Day | 2.00—4.00 p.m. | 4. Dyeing, Printing and Finishing of Woven and Knitting Goods |
| | 4.00—4.30 p.m. | (Coffee break) |
| | 4.30—6.00 p.m. | 5. Knitting, Hosiery, New Manufacturing Technique for Non-Wovens |

EXHIBITION AND SEMINAR ON TEXTILE & FABRIC DESIGN

Date: Easter 1967.

Details will be available in the Spring Programme.

AIR TRANSPORT SEMINAR

The Department of Extra-Mural Studies will hold an intensive two-week seminar on air transportation in January 1967. This seminar will consist of lectures and discussions by expert authorities on the background, current status, techniques and future outlook in the air transportation service. The Chairman will be Mr. Harold T. Wu, Chairman, Airlines Association of Hong Kong.

For further information, please write to the Director of Extra-Mural Studies.

SPECIAL DAY-TIME PROGRAMME

THE DAY-TIME PROGRAMME AT THE EXTRA-MURAL LAW CENTRE IS CONCEIVED TO PROVIDE COURSES FOR CERTAIN GROUPS OF PEOPLE SUCH AS HOUSEWIVES, RETIRED PEOPLE, P.M. OR A.M. TEACHERS, VISITORS WHO ARE HERE FOR A SHORT STAY, SHIFT WORKERS, AND OTHERS IN THE COMMUNITY WHO ARE NOT NECESSARILY OCCUPIED DURING THE DAY, AS WELL AS THOSE WHO COULD BE SPECIALLY RELEASED FROM THEIR WORK TO ATTEND REFRESHER COURSES OR CLASSES THAT COULD HEIGHTEN THEIR WORKING ABILITY. MORNING TEA/COFFEE WILL BE SERVED.

FOR ENQUIRIES AND FURTHER DETAILS, PLEASE CONTACT TUTOR IN CHARGE OF LAW CENTRE, MR. JOHN CHAN, TEL. 226529.

146. WHAT TO LISTEN FOR IN MUSIC

Time: Tuesdays, 10.30-11.30 a.m., starting Sept. 27, 1966.

Place: Extra-Mural Law Centre, Chiao Shang Bldg., 8/F., 92-94, Queen's Rd. C., Hong Kong.

No. of Meetings: 12, once weekly

Fee: \$30

Tutor: Miss Maple Quon, Conservatory of Music, University of Toronto.

This course is designed to introduce the adult music-lover, who has not had the opportunity to study much music previously, to various aspects of music (composers, standard compositions, elementary form, etc.) to enable them to increase their enjoyment. The lectures will be illustrated by demonstration on the piano, recordings, etc.

147. FINE ART DRAWING

學

費：四十八元

時

間：一九六六年九月二十七日起每星期二上午十時至十二時。

地

點：香港大學校外課程部市區中心

講授語言：粵語

主講人：黃瑞瑤（意大利羅馬藝術專）

、質感與星感，構圖等等。

方法。

如木炭，鋼筆以及其他單色畫之制作

素描畫，講述素描畫之重要性及其進展。

素描創作

本課程共十二講，首講介紹名家以後各講實習靈活使用各種材料

148. THE HISTORY AND ART OF CHINESE CALLIGRAPHY

學

費：五十元

時

間：一九六六年九月廿四日起每星期六上午九時半至十一時半

地

點：香港大學校外課程部市區中心

講授語言：粵語

主講人：馮康侯先生

一、書法與文字之關係
二、書法演變
三、篆隸行楷之書法介紹
四、執筆、運筆、結體
五、各體書法示範

本課程共十六講，每週一次，每次二小時，專為愛好研究中國書法者而設。理論與實踐並重，主要講題如下：

書法源流

149. FOUNDATIONS IN CANTONESE

Time: Wednesdays & Fridays, 2-3 p.m., starting Oct. 5, 1966.
Place: Extra-Mural Law Centre, Chiao Shang Bldg., 8/F., 92-94
Queen's Rd. C., H.K. (entrance at Cochrane Street)
No. of Meetings: 48, twice weekly *Fee:* \$180
Tutor: Mr. Francis Sham, B.A., Language School, H.K.U.

With emphasis on the spoken language and the use of Chinese idioms, it provides the students with a basic knowledge of pronunciation, tones, grammatical constructions, and a simple vocabulary for beginners. Ample time will be provided for oral practice.

Supplementary notes and exercises will be supplied by the tutor.

Textbook: *Cantonese Conversation Grammar, Book 1, Part 1*,
by S. L. Wong.

150. DESIGN AND THE HOME

PART II: THE HISTORY OF INTERIOR DESIGN & HOUSEHOLD FURNITURE

Time: Thursdays, 11.30 a.m.-12.30 p.m., starting Oct. 6, 1966.
Place: Extra-Mural Law Centre, Chiao Shang Bldg., 8/F., 92-94
Queen's Rd. C., Hong Kong.
No. of Meetings: 12, once weekly *Fee:* \$35
Tutor: Mr. Alex Bleszynski, School of Design & Graphic Art,
Poland.

This illustrated course will give a historical outline of the main characteristics of particular styles and periods; and discuss the evolution of aesthetic ideas and tastes and their influence on interior décor, furniture design, craftsmanship and materials.

A number of visits will be arranged to private homes and famous collections. Expenses incurred on the excursions are not included in the course fee.

Enrolment is limited to 30.

151. LECTURES ON HONG KONG'S HISTORY

Time: Thursdays, 3-4 p.m., starting Oct. 6, 1966.
Place: Extra-Mural Law Centre, Chiao Shang Bldg., 8/F., 92-94
Queen's Rd. C., Hong Kong.
No. of Meetings: 10, once weekly *Fee:* \$25
Tutor: Mr. G. B. Endacott, M.A., B.Litt., Dip.Ed. (Oxon.)

The course will attempt to cover some of the main facts of Hong Kong's growth from its early colonial days to the present-day industrial and commercial centre. The lecture programme will include: The founding of Hong Kong; social conditions among Chinese and foreigners in the early years to 1895; territorial expansion and urban growth; the growth of Health Services and Sanitary Board; the growth of an educational system; the new post-war community; the Industrial Revolution and constitutional progress.

152. CHINA — ITS LAND AND PEOPLE

Time: Tuesdays, 3-4 p.m., starting Oct. 11, 1966.

Place: Extra-Mural Law Centre, Chiao Shang Bldg., 8/F., 92-94, Queen's Rd. C., H.K. (entrance at Cochrane Street)

No. of Meetings: 10, once weekly *Fee:* \$25

Tutor: Mr. C. K. Leung, B.A. (H.K.); Staff Tutor, Extra-Mural Dept., University of Hong Kong.

An introductory course to the Geography of China. Topics to be discussed will include: its physical structure, climate, agriculture, industry, transport and population. Little or no knowledge of the Geography of China on the part of the participants will be assumed.

It will be of particular interest to people who have a commercial and business interest in China, or those who are likely to visit there, as well as new comers to Hong Kong.

153. UNDERSTANDING CHINESE CUSTOMS AND TRADITIONS

Time: Wednesdays, 3-4 p.m., starting October 12, 1966.

Place: Extra-Mural Law Centre, Chiao Shang Bldg., 8/F., 92-94 Queen's Rd. C., H.K. (entrance at Cochrane St.)

No. of Meetings: 8, once weekly *Fee:* \$20

Tutor: Mrs. Nana W. Tsao, B.A. (H.K.); Dip. Ed. (H.K.); Senior Staff Tutor, Dept. of Extra-Mural Studies, H.K.U.

This series of lectures is designed for those who wish to learn something of Chinese life and culture, and will deal with traditional Chinese customs and ways of life existing in Hong Kong; Chinese etiquette and common courtesy, family structure & kinship; wedding & burial ceremonies; ancestor worship; religion & the main festivals celebrated during the year. The lectures will be illustrated with slides wherever possible.

154. SOME ASPECTS OF CHINA'S LITERARY TRADITION

Time: Mondays, 2.30-3.30 p.m., starting Oct. 24, 1966.

Place: Extra-Mural Law Centre, Chiao Shang Bldg., 8/F., 92-94 Queen's Rd. C., H.K. (entrance at Cochrane St.)

No. of Meetings: 4, once weekly *Fee:* \$10

Tutor: Mr. R. A. Williams, M.A. (Wales); Visiting Deputy Director, Dept. of Extra-Mural Studies, H.K.U.

The lives and works of the three most famous T'ang dynasty poets; a glance at the Chinese theatre; "classical" novels and short-stories; and an unusual link with the present. These are some of the topics to be covered during this short introduction to China's literary heritage.

155. ANGKOR — ART AND CIVILIZATION

Time: Fridays, 11-12 a.m., starting January 20, 1967.

Place: Extra-Mural Law Centre, Chiao Shang Bldg. 8/F., 92-94, Queen's Road C., Hong Kong.

No. of Meetings: 8, once weekly *Fee:* \$15

Tutor: Mrs. Priscilla Tso, B.A., Dip.Ed. (H.K.), Dip.Ad.Ed. (Manch.), Assistant to the Director of Extra-Mural Studies.

An illustrated course dealing with the history, art and culture of Cambodia between the 9th and 15th Century.

156. HONG KONG TODAY

Time: Thursdays, 11.30 a.m. - 12.30 p.m., starting Jan. 12, 1967.

Place: Extra-Mural Law Centre, Chiao Shang Bldg., 8/F., 92-94 Queen's Rd. C., H.K. (Entrance at Cochrane St.)

No. of Meetings: 8 lectures, once weekly plus 4 visits *Fee:* \$25

Tutors: Mr. John Chan, B.A., M.A. (H.K.)

Mr. C. K. Leung, B.A. (H.K.)

Mr. Laurence C. T. Pang, B.A. (H.K.)

Mrs. Nana Tsao, B.A., Dip.Ed. (H.K.)

This series of lectures, designed for those who wish to know more of present day Hong Kong will deal with aspects of its people, current economic issues, social institutions, education and housing, and will be followed by visits to factories, charitable organizations, housing and resettlement estates, and Leper Island.

Course fee does not include expenses incurred on the visits.

IT IS REQUIRED THAT ALL APPLICANTS FOR THE ENGLISH CLASSES SHOULD HAVE AT LEAST SCHOOL CERTIFICATE STANDARD ENGLISH.

157. MASTERING MODERN ENGLISH

Time: Tuesdays, 2.30-3.30 p.m., starting Sept. 27, 1966.

Place: Extra-Mural Law Centre, Chiao Shang Bldg., 8/F., 92-94 Queen's Rd. C., H.K. (entrance at Cochrane Street)

No. of Meetings: 20, once weekly *Fee:* \$60

Tutor: Mrs. A. Ho, B.A., B.Ed., (Melbourne).

The course will include textual study dealing with comprehension, interpretation, the more complex grammatical forms and idiomatic pattern. Members of the class are expected to participate in discussions and to do written work. Exercises will be taken mainly from G. G. Gentle's "Progressive Exercises in English" (Methuen), supplemented by other texts.

Enrolment is limited to 30.

158. ENGLISH FOR CLERICAL WORKERS

Time: Wednesdays, 11.30-12.30 p.m., starting Oct. 5, 1966.

Place: Extra-Mural Law Centre, Chiao Shang Bldg., 8/F., 92-94 Queen's Rd. C., H.K. (entrance at Cochane Street)

No. of Meetings: 20, once weekly *Fee:* \$60

Tutor: Mrs. Mary Wong, B.A. (commerce) H.K.

For students whose English has reached a reasonable standard, this course will deal with commercial correspondence, commercial terms, cables, memos, advertisements, reports, references, testimonials, office organization and procedure, and interdepartmental communication. Strees will be placed on improving students' accurate and effective use of the English Language in writing.

It is anticipated that firms will nominate and release members of their staff to attend this course.

Enrolment is limited to 30.

159. THE ENGLISH WE USE

Time: Thursdays, 2.30-3.30 p.m., starting Oct. 6, 1966.

Place: Extra-Mural Law Centre, Chiao Shang Bldg., 8/F., 92-94 Queen's Rd. C., Hong Kong.

No. of Meetings: 20, once weekly *Fee:* \$60

Tutor: Mrs. Mary Anne E. Wei, B.A. (Hons.) H.K., P.G.C.E. (London)

To provide practice in hearing, reading, speaking and writing correct and connected English. The basis of the course will be a study of passages of English which people have wanted to listen to and read in the twentieth century. These passages provide material for:

- (a) training in the comprehension of continuous speech,
- (b) oral practice to activate passive knowledge of grammatical forms and idiomatic patterns,
- (c) exercise in more complex patterns,
- (d) textual study,
- (e) discussion and free composition.

Textbook: *The English We Use* (Compiled by R. A. Close, Longmans).

Enrolment is limited to 30.

MID-DAY LECTURES

"Aspects of Chinese Art"

at City Hall, Lecture Room North

from 1.15 p.m. — 1.55 p.m.

The present series consists of four lunch-time lectures dealing with Aspects of Chinese Art. A notice will appear in the press on the Monday prior to each lecture. No fees will be charged.

<u>Date</u>	<u>Topic</u>	<u>Speaker</u>
2/11/66	Chinese Ceramics	Mr. Cheng Yu-long
9/11/66	Chinese Seals and Engravings	Mr. Yau Ka-pok
16/11/66	Chinese Jade	To be announced
23/11/66	Chinese Bronze	To be announced

PUBLIC EVENING LECTURES

"Hong Kong Economic Scene"

at City Hall, Lecture Room South, 8/F.

Tuesdays, 7 p.m. — 8.30 p.m.

THE AIM OF THIS PUBLIC LECTURE SERIES IS TO INTRODUCE TO THE PUBLIC AN UP-TO-DATE BACKGROUND OF THE REALITIES AS WELL AS THE UNDERLYING PRINCIPLES AND POLICIES WHICH MAY INFLUENCE OR DETERMINE THE SHAPE OF HONG KONG ECONOMIC THINKING AND ACTION. THIS SERIES IS OPEN TO ALL WHO ARE INTERESTED, FREE OF CHARGE.

<u>Date</u>	<u>Topic</u>	<u>Speaker</u>
4/10/66	Introduction: the performance of the Hong Kong Economy	Prof. R. Hsia, H.K.U.
	The development of trade	Mr. R.C.L. Oliphant, Executive Director, H.K. Trade Development Office
11/10/66	The development of the tourist industry	Mr. J.H. Pain, Assistant Executive Director, H.K. Tourist Association.
18/10/66	Recent development in Hong Kong's textile industry	Mr. Kayser Sung, Managing Editor, Far Eastern Econ. Review.
25/10/66	An analysis of Hong Kong's real estate development	Mr. K.C. Pang, Managing Director, Goodyear Investors Ltd.
1/11/66	The value of regional planning in promoting industrial development	Mr. J.E. Jackson, Chairman, H.K. Branch of Town Planning Institute.
8/11/66	The shipping industry of Hong Kong	Mr. D.K. Newbigging, Jardine, Matheson & Co., Ltd.
15/11/66	The plastic industry & its development	Mr. Dennis Ting, Director, Kader Industrial Co. Ltd.
22/11/66	The role of the electronic industry in Hong Kong's economy	Mr. John Fung, Fabri-Tek H.K. Ltd.
29/11/66	The small scale industries	Mr. K.S. Lo, Managing Director, H.K. Soya Bean Products Co., Ltd.
6/12/66	The banking industry in Hong Kong	Mr. P.A. Graham, Manager, Chartered Bank.
13/12/66	Operation & functions of the H.K. Stock Exchange	Mr. F.A. Silva, Member of the H.K. Stock Exchange Ltd.
20/12/66	The optical industry in Hong Kong	Miss Pauline Chan, Managing Director, W. Haking Industries (Mechanics & Optics) Ltd.

STUDY TOUR

Study Tour to Japan (Summer 1967)

Full details will be announced in the Spring (1967) Programme.

THE ANNUAL RALLY

will be held

on

Saturday, March 11, 1967

at the University

Lectures

Social Function

Dinner

Etc.

PASS THIS BROCHURE

ON TO A FRIEND.

THE NEXT PROSPECTUS

WILL BE OUT EARLY

IN

JAN. 1967

請按下列地址惠寄貴大學校外課程部一九六七年春季課程手冊乙份為荷：

姓名

地址

.....

Please put my name on your mailing list for a copy of the 1967 Extra-Mural Spring Programme:

Name

Address

.....

N.B. To be filled in only by those who have not enrolled as students of 1966-67 Extra-Mural courses.

**The Director,
Department of Extra-Mural Studies,
University of Hong Kong,
Pokfulam Road,
Hong Kong.**

*A Message from
Mr. Gerald Moore, the first
Director of Extra-Mural Studies,
Hong Kong University*

It is strange to think that it is now ten years since the start of extra-mural work in Hong Kong. Its growth since then has certainly justified our bravest dream of 1956. The aim then was to create a movement in adult education which might match the energy and eagerness of the surrounding atmosphere. So far as I can judge, this has now been achieved, and the work of the University among the adult population has become a fully recognized and accepted feature of the Hong Kong scene. However, no such activity can ever rest on its achievements. It must be always on the move, always looking for fresh opportunities and challenges in the society around it. I am confident that you in Hong Kong will meet the coming ten years as effectively as you mastered the first.

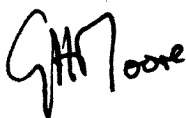
A handwritten signature in black ink, appearing to read "G.M. Moore". The initials "G.M." are written in a stylized, cursive font, followed by the name "Moore" in a similar but slightly more legible script.

一九六六年至六七年

十週年紀念



香港大學校外課程手冊