

设计实践中无所不在的数字化

ubiquitous digitalization in design practice

度态 dotA

Hong Kong - Shenzhen - Beijing

THE UNIVERSITY OF HONG KONG 香港大学
faculty of architecture 建筑学院

数字化是为了实现复杂的建筑？

- 数字化方式除了推动产业外，在思想和方法层面给设计带来哪些变化？
- 建筑的复杂性指什么？
- 复杂的建筑就是好建筑么？
- 形式复杂的建筑就复杂么？形式简单的建筑就简单么？
- 复杂的建筑一定是复杂的实现途径么？
- 复杂的形式与深邃的思考有必然的联系么？
- 越复杂的建筑设计就越有创意么？

1. 复杂的形体、整合的策略

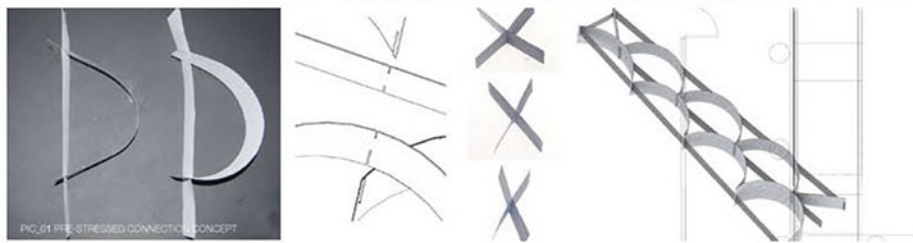
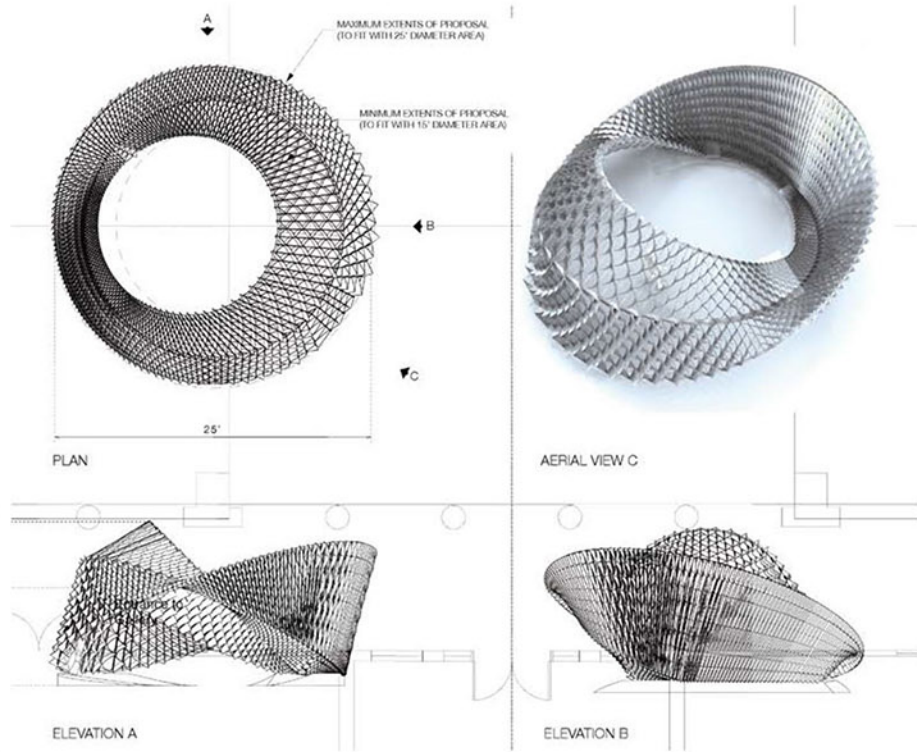
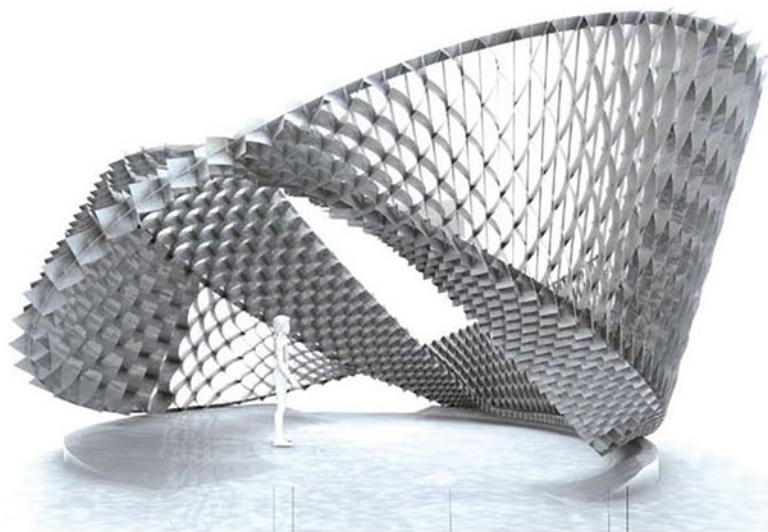

2. 预设的物体、响应的建造

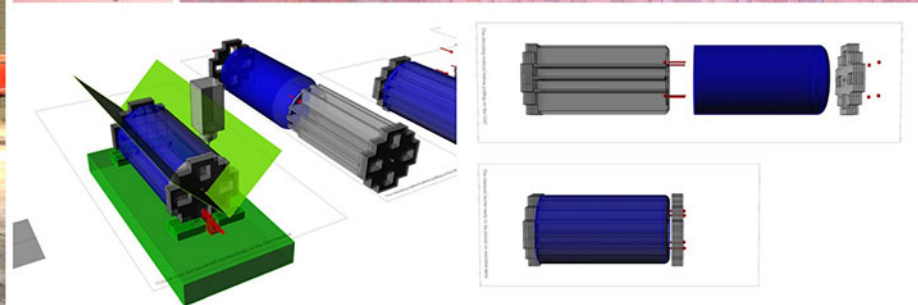
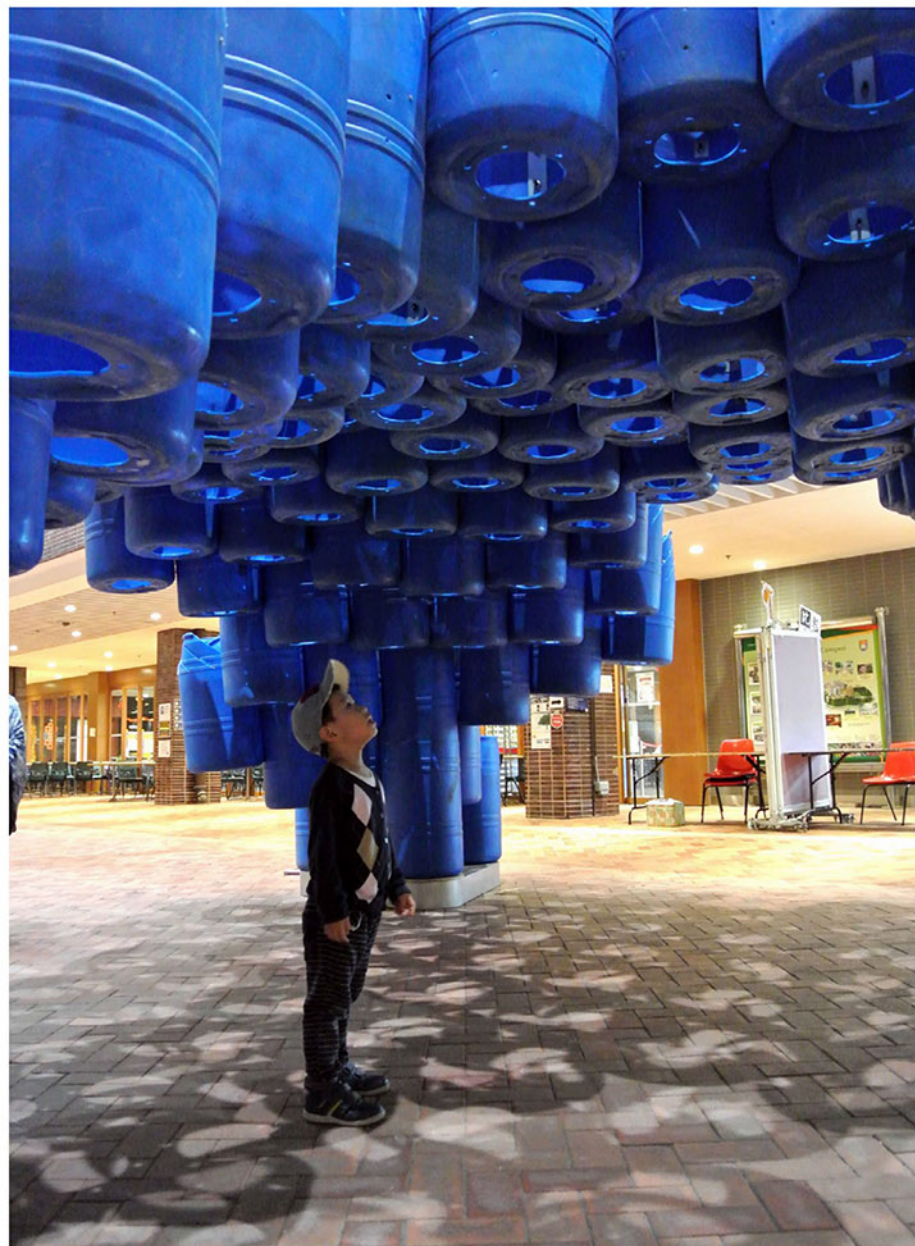

3. 复杂的异形、理性的成形

a thousand inscriptions

千丝万缕

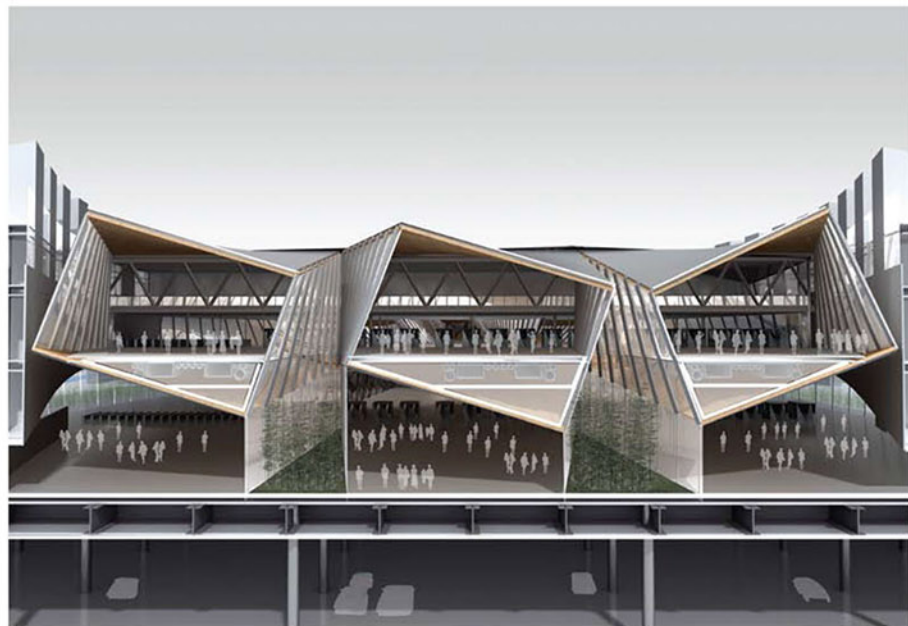
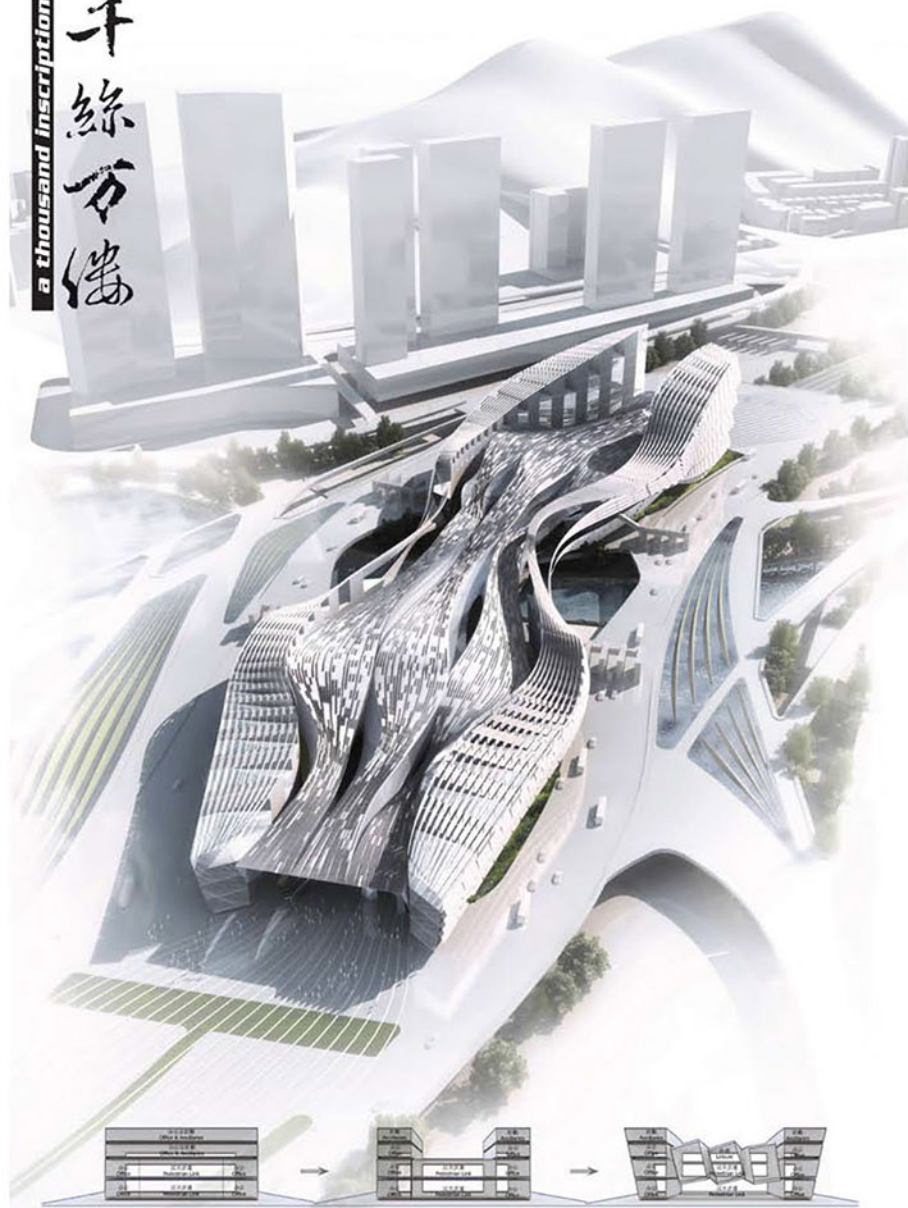

5. 适时的应用、适度的精准

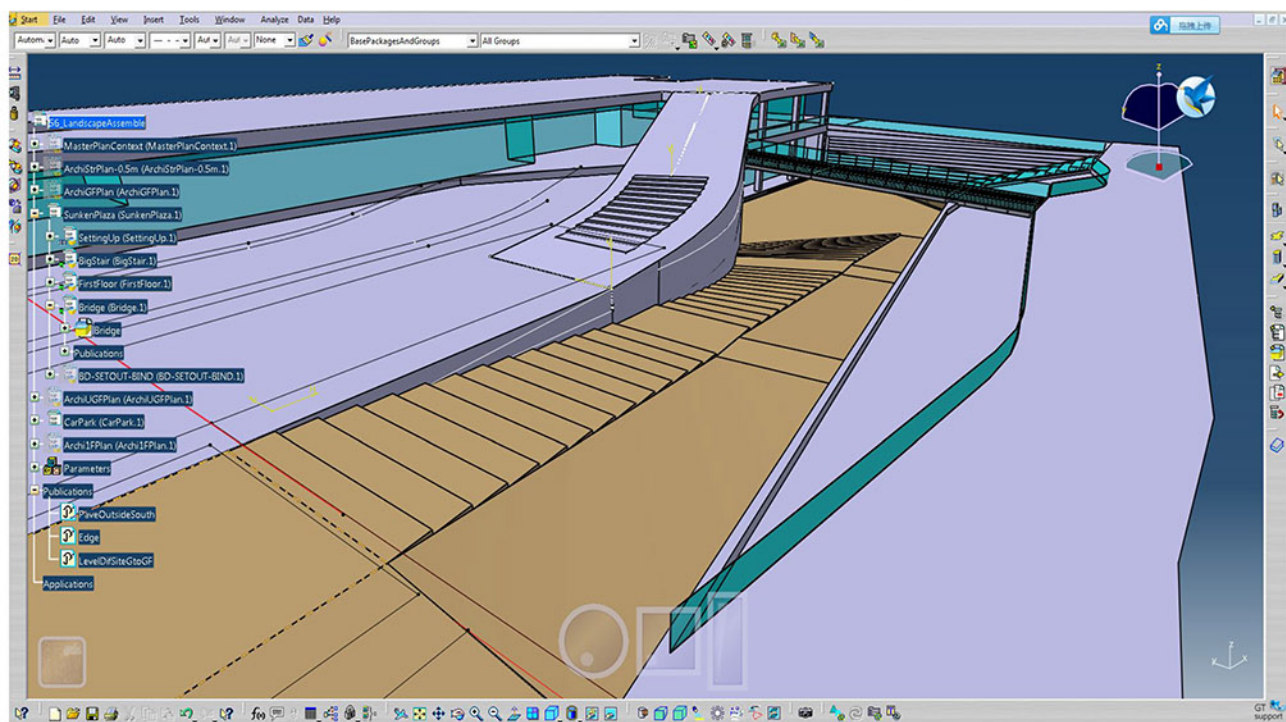

6. 动感的形式、价值的空间



7. 多维度关联、大规模定制

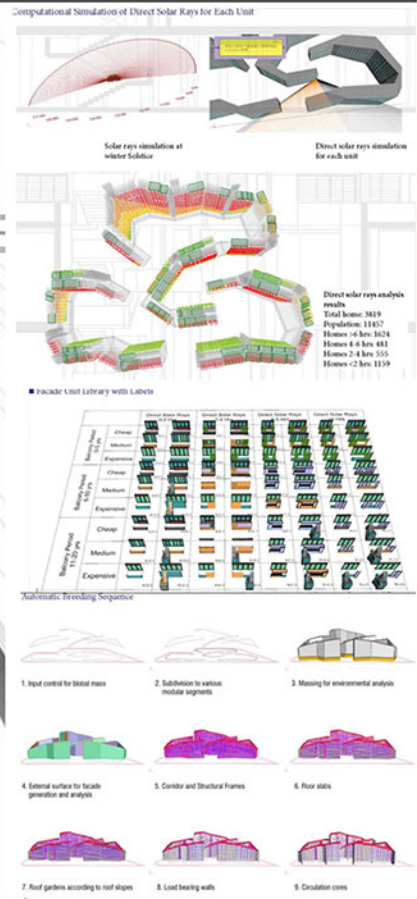

0-5 years

6-10 years

11-20 years

8. 起伏的地景、生成的聚落

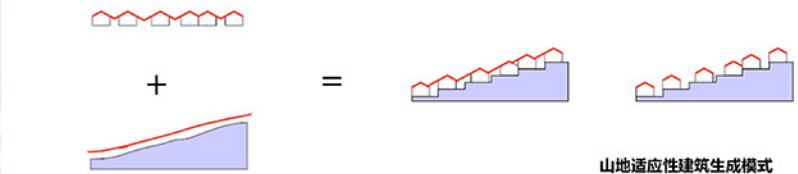

山地适应性建筑生成模式

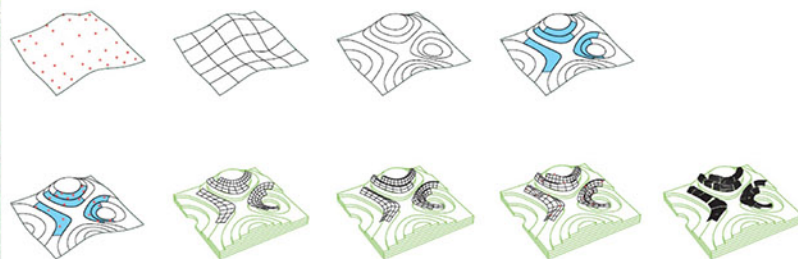

度态 dotA



9. 特殊的材料、探索的形构

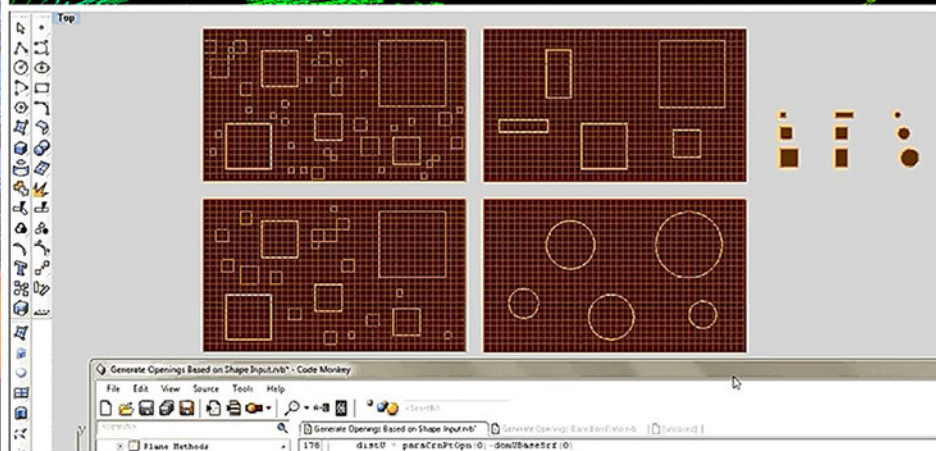
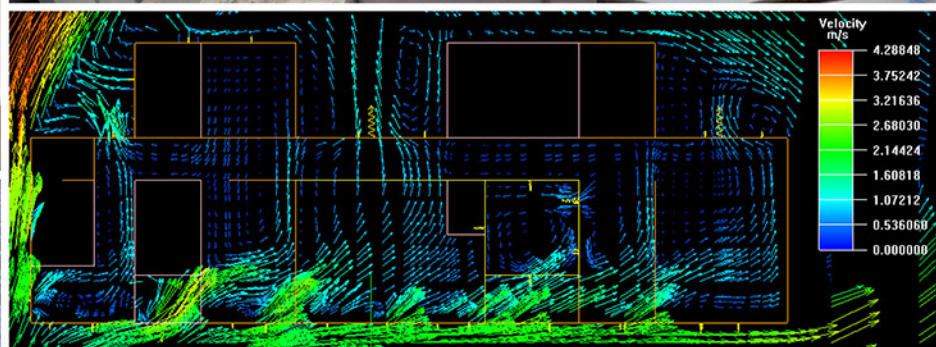

11. 简单的形态、丰富的变化



12. 简单的数字、复杂的设计

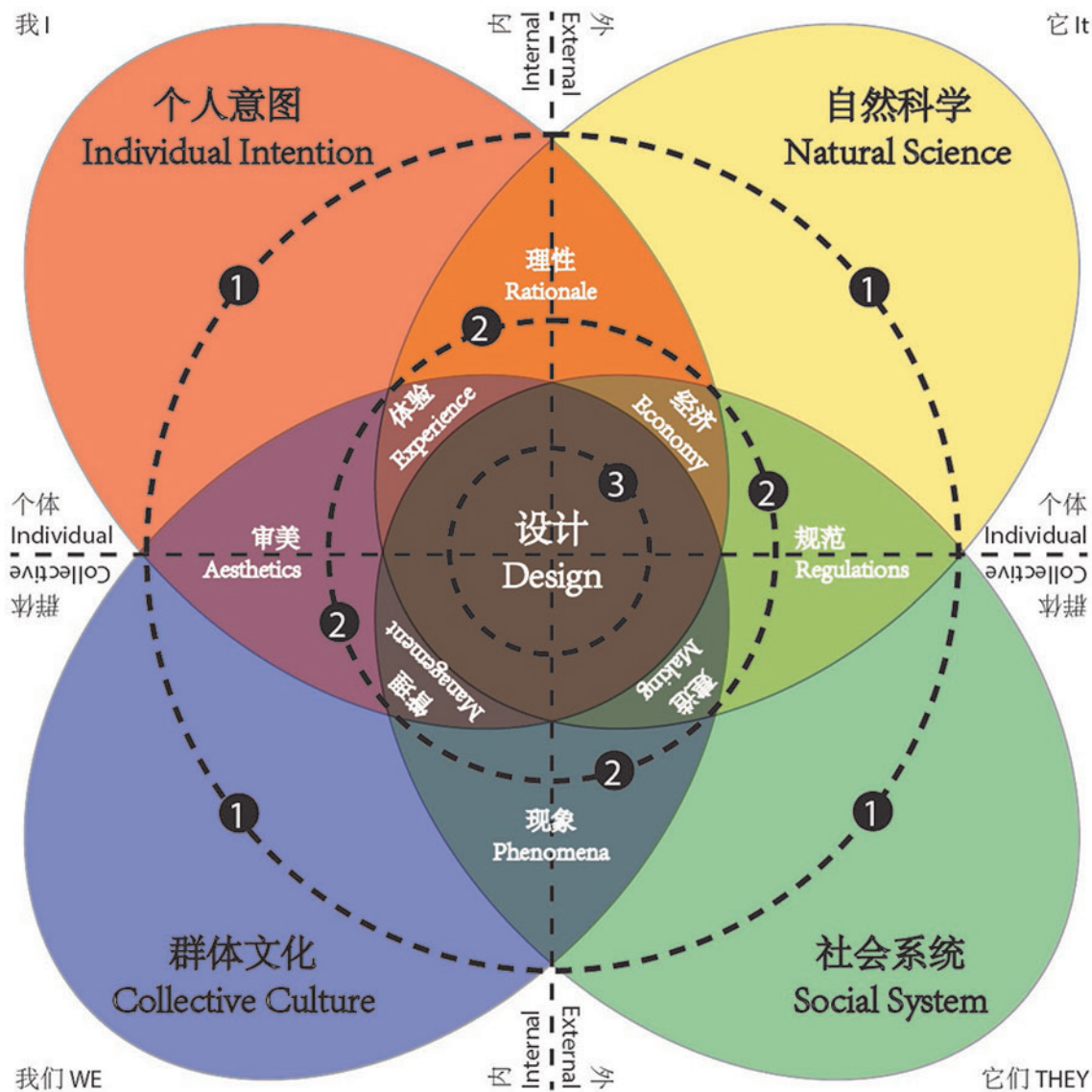

控制之中、意料之外
Under Control, Beyond Expectation